

LEGEND:

 PROPOSED LOCATION



ConocoPhillips Company

**CONVERSE FAMILY #6-1H
SECTION 6, T4S, R63W, 6th P.M.
1980' FSL 260' FEL**



Utah Engineering & Land Surveying
85 South 200 East Vernal, Utah 84078
(435) 789-1017 * FAX (435) 789-1813

ACCESS ROAD MAP	10	09	12	
	MONTH	DAY	YEAR	
SCALE: 1:100,000	DRAWN BY: J.L.H.		REVISED: 00-00-00	

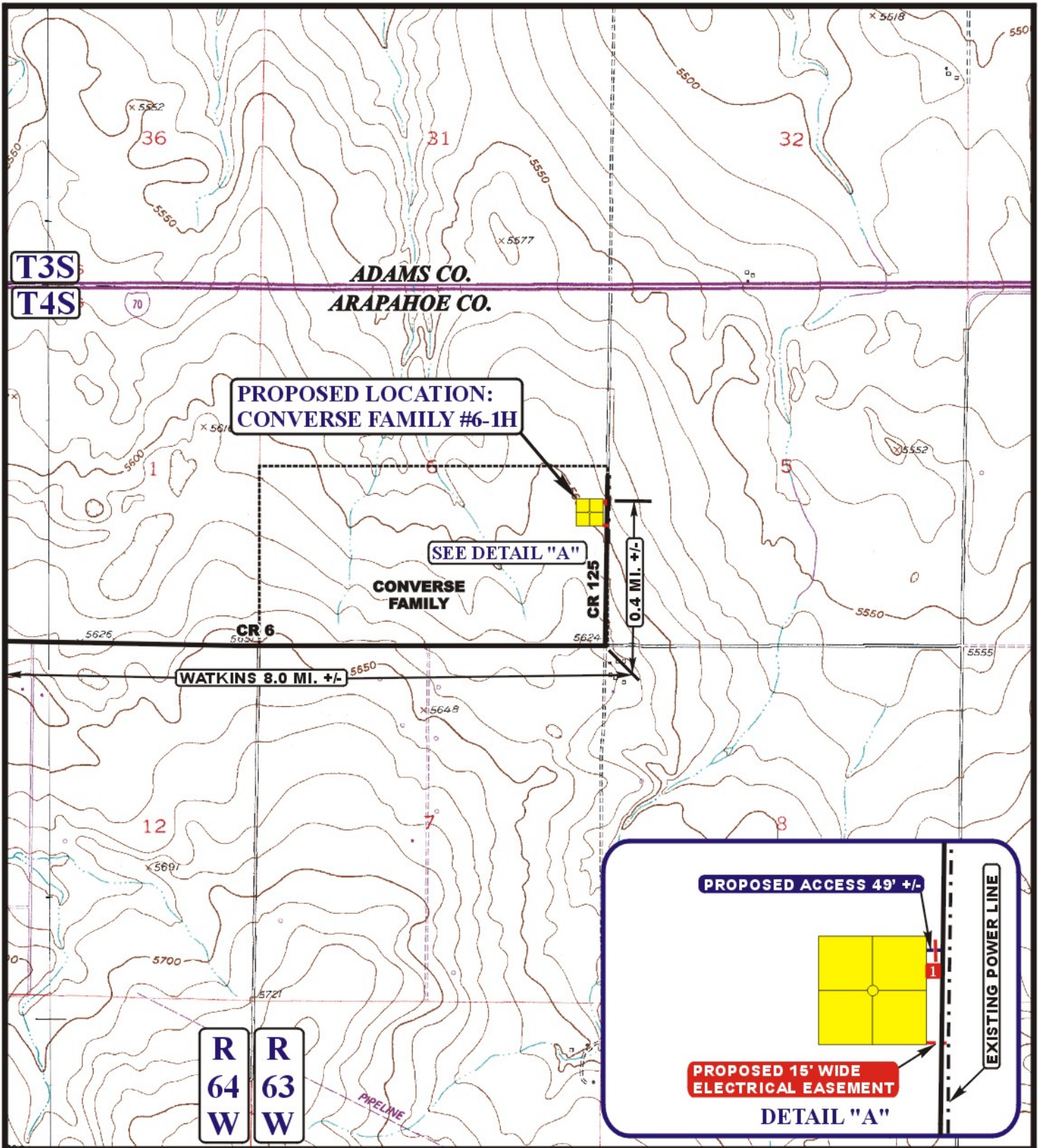

LEGEND:

- EXISTING ROAD
- PROPOSED ACCESS ROAD
- PROPOSED 15' WIDE ELECTRICAL EASEMENT
- EXISTING POWER LINE
- 18" CMP REQUIRED

U&L S Utah Engineering & Land Surveying
 85 South 200 East Vernal, Utah 84078
 (435) 789-1017 * FAX (435) 789-1813



ConocoPhillips Company

CONVERSE FAMILY #6-1H
SECTION 6, T4S, R63W, 6th P.M.
1980' FSL 260' FEL

ACCESS ROAD MAP	10	09	12	B TOPO
	MONTH	DAY	YEAR	
SCALE: 1" = 2000' DRAWN BY: J.L.H. REVISED: 00-00-00				