

ConocoPhillips Company
CONVERSE FAMILY #6-1H
 LOCATED IN ARAPAHOE COUNTY, COLORADO
 SECTION 6, T4S, R63W, 6th P.M.

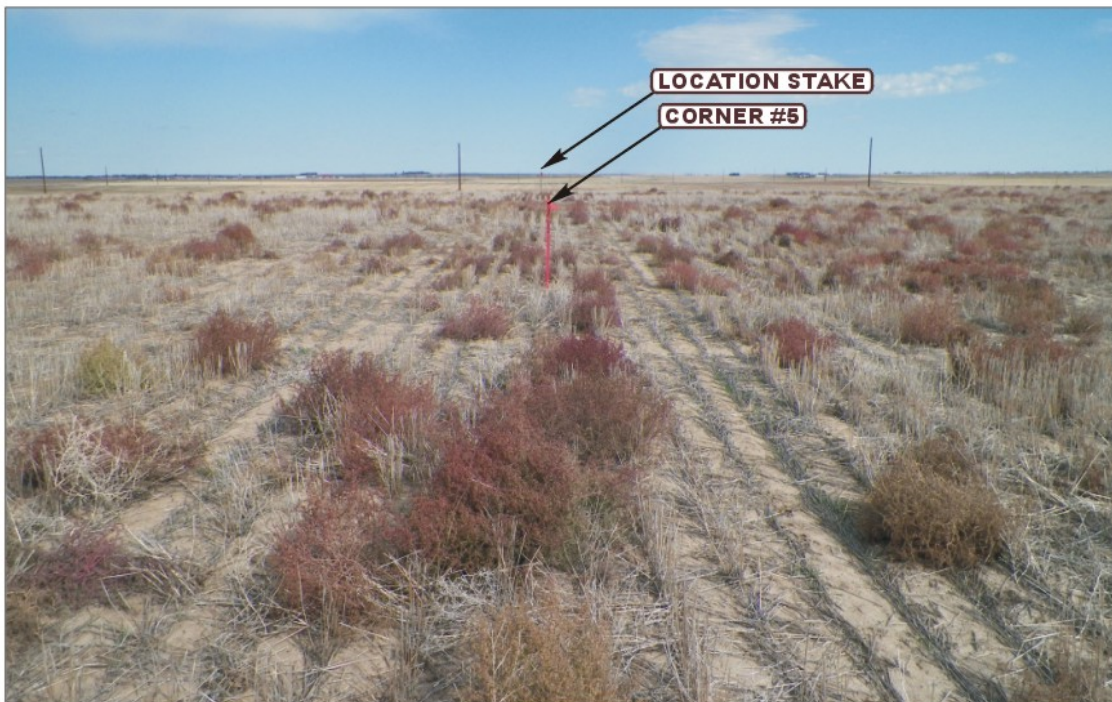

PHOTO: VIEW FROM CORNER #5 TO LOCATION STAKE

CAMERA ANGLE: EASTERLY



PHOTO: VIEW FROM BEGINNING OF PROPOSED ACCESS

CAMERA ANGLE: WESTERLY



U E L S Uintah Engineering & Land Surveying
 85 South 200 East Vernal, Utah 84078
 (435) 789-1017 * FAX (435) 789-1813

LOCATION PHOTOS	10	09	12	PHOTO P1
	MONTH	DAY	YEAR	
TAKEN BY: D.L.S.	DRAWN BY: J.L.H.		REVISED: 00-00-00	

ConocoPhillips Company
CONVERSE FAMILY #6-1H
 LOCATED IN ARAPAHOE COUNTY, COLORADO
 SECTION 6, T4S, R63W, 6th P.M.



PHOTO: VIEW OF LOCATION STAKE

CAMERA ANGLE: NORTHERLY



PHOTO: VIEW OF LOCATION STAKE

CAMERA ANGLE: EASTERLY



UELS Uintah Engineering & Land Surveying
 85 South 200 East Vernal, Utah 84078
 (435) 789-1017 * FAX (435) 789-1813

LOCATION PHOTOS	10	09	12	PHOTO P2
TAKEN BY: D.L.S.	MONTH	DAY	YEAR	
DRAWN BY: J.L.H.	REVISED: 00-00-00			

- Since 1964 -

ConocoPhillips Company
CONVERSE FAMILY #6-1H
 LOCATED IN ARAPAHOE COUNTY, COLORADO
 SECTION 6, T4S, R63W, 6th P.M.



PHOTO: VIEW OF LOCATION STAKE

CAMERA ANGLE: SOUTHERLY



PHOTO: VIEW OF LOCATION STAKE

CAMERA ANGLE: WESTERLY



UELS Uintah Engineering & Land Surveying
 85 South 200 East Vernal, Utah 84078
 (435) 789-1017 * FAX (435) 789-1813

LOCATION PHOTOS	10	09	12	PHOTO P3
	MONTH	DAY	YEAR	
TAKEN BY: D.L.S.	DRAWN BY: J.L.H.		REVISED: 00-00-00	