

LEGEND:

 PROPOSED LOCATION



GREAT WESTERN OIL & GAS COMPANY

Campbell JF PAD 17-41D

SECTION 17, T2N, R65W, 6th PM.
SW 1/4 NE 1/4

U&L
Uintah Engineering & Land Surveying
 85 South 200 East Vernal, Utah 84078
 (435) 789-1017 * FAX (435) 789-1813

ACCESS ROAD
MAP

| | | |
|--------------------|------------------|-------------------|
| 10 MONTH | 01 DAY | 12 YEAR |
|--------------------|------------------|-------------------|

SCALE: 1:100,000 DRAWN BY: M.M. REV: 12-18-12 J.L.H. **A**
TOPO

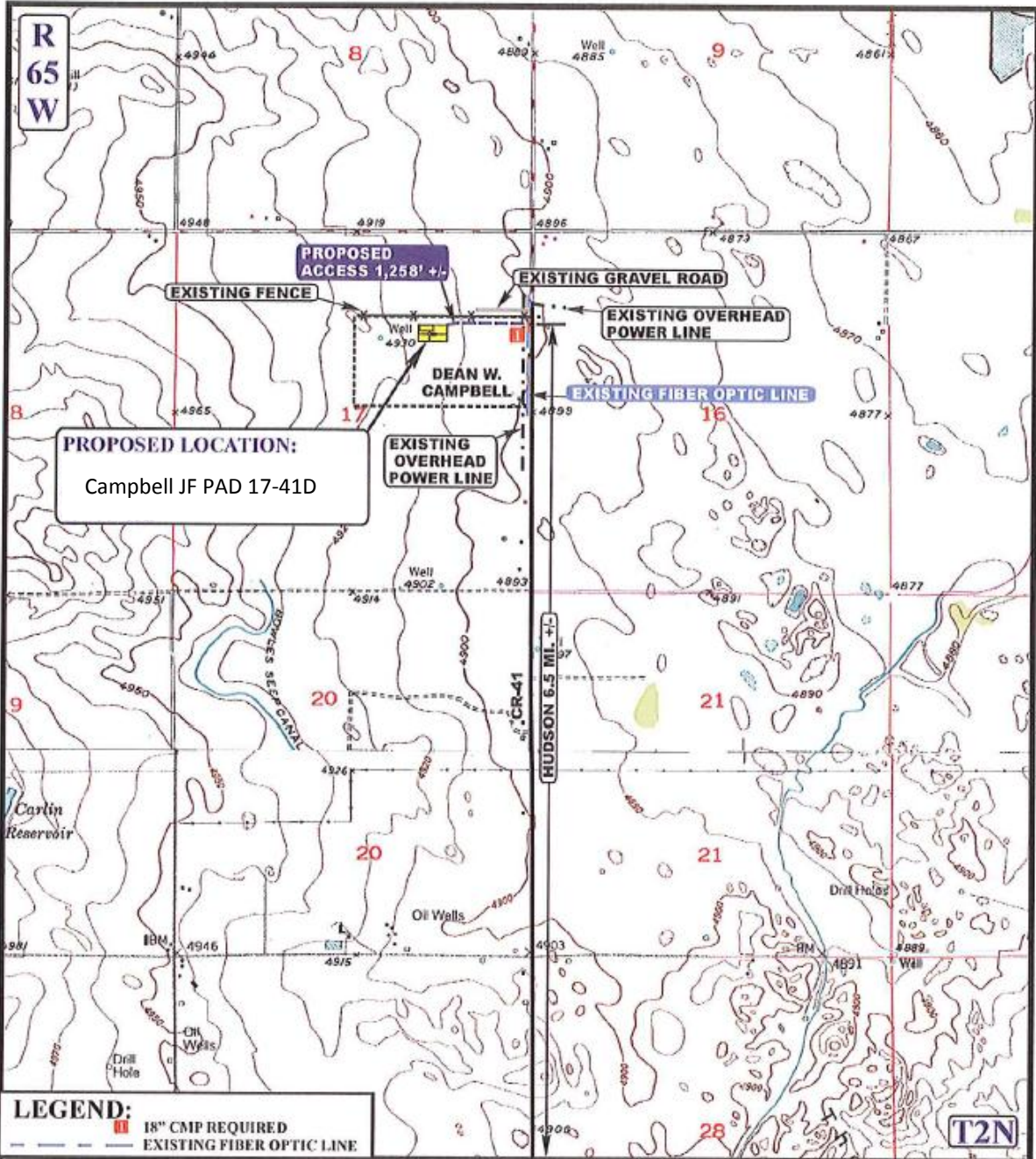

LEGEND:
 18" CMP REQUIRED
 - - - - - EXISTING FIBER OPTIC LINE

_____ EXISTING ROAD
 - - - - - PROPOSED ACCESS ROAD
 - - - - - EXISTING GRAVEL ROAD
 * * * * * EXISTING FENCE
 - - - - - EXISTING OVERHEAD POWER LINE

U&L S Uintah Engineering & Land Surveying
 85 South 200 East Vernal, Utah 84078
 (435) 789-1017 • FAX (435) 789-1813

GREAT WESTERN OIL & GAS COMPANY
 Campbell JF PAD 17-41D
 SECTION 17, T2N, R65W, 6th P.M.
 SW 1/4 NE 1/4

ACCESS ROAD MAP 10 01 12
 MONTH DAY YEAR
 SCALE: 1" = 2000' DRAWN BY: M.M. REV: 12-18-12 J.L.H. **B TOPO**

GREAT WESTERN OIL & GAS COMPANY

Campbell JF PAD 17-41D

SECTION 17, T2N, R65W, 6th P.M.

PROCEED IN A WESTERLY, THEN NORTHWESTERLY, THEN WESTERLY DIRECTION FROM HUDSON, COLORADO ALONG HIGHWAY 52 APPROXIMATELY 2.2 MILES TO THE JUNCTION OF THIS ROAD AND CR-41 TO THE NORTH; TURN RIGHT AND PROCEED IN A NORTHERLY DIRECTION APPROXIMATELY 4.3 MILES TO THE BEGINNING OF THE PROPOSED ACCESS ROAD TO THE WEST; FOLLOW ROAD FLAGS IN A WESTERLY DIRECTION APPROXIMATELY 1258' TO THE PROPOSED LOCATION.

TOTAL DISTANCE FROM HUDSON, COLORADO TO THE PROPOSED LOCATION IS APPROXIMATELY 6.7 MILES.