

TEKTON WINDSOR, LLC

| | | | |
|--------------|------------------|----------|-----------------------------------|
| Location | Windsor, CO, USA | Slot | Slot #4 |
| Field | Windsor Project | Well | PAVISTMA 4 #1-6-32-090-4-NH |
| Installation | Pavistma | Wellbore | PAVISTMA 4 #1-6-32-090-4-NH (PWB) |

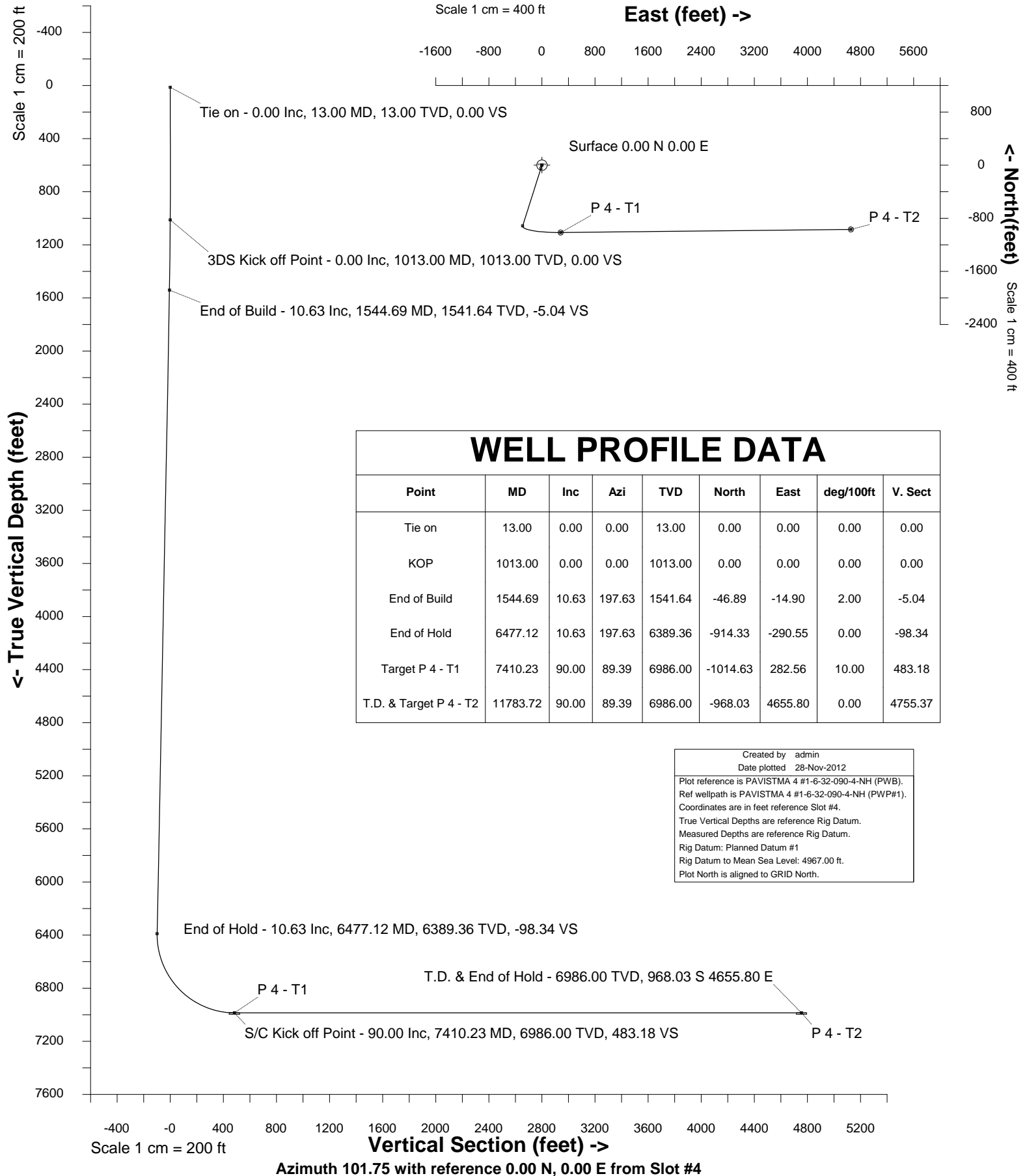



SYSDRILL
Well Design Combined Report
Wellbore: PAVISTMA 4 #1-6-32-090-4-NH (PWB)
Wellpath: PAVISTMA 4 #1-6-32-090-4-NH (PWP#1)

Wellhead Details

| Name | Northing | Easting | Latitude | Longitude | North | East |
|---------|--------------|--------------|----------------|-----------------|--------|-------|
| Slot #4 | 1404354.4554 | 3160123.5363 | N40 26 30.9442 | W104 55 28.9620 | 32.40N | 0.68W |

Site Details

| Name | Northing | Easting | Coord System Name | North Alignment |
|----------|--------------|--------------|---|-----------------|
| Pavistma | 1404322.0586 | 3160124.2135 | CO83-NF on NORTH AMERICAN DATUM 1983 datum | Grid |

Summary Wellpath

| MD[ft] | Inc[deg] | Azi[deg] | TVD[ft] | North[ft] | East[ft] | Dogleg [deg/100ft] | Vertical Section[ft] | Northing | Easting |
|----------|----------|----------|---------|-----------|----------|-----------------------|-------------------------|------------|------------|
| 13.00 | 0.00 | 0.000 | 13.00 | 0.00N | 0.00E | | 0.00 | 1404354.46 | 3160123.54 |
| 1013.00 | 0.00 | 0.000 | 1013.00 | 0.00N | 0.00E | ==> | 0.00 | 1404354.46 | 3160123.54 |
| 1544.69 | 10.63 | 197.630 | 1541.64 | 46.89S | 14.90W | 2.00 | -5.04 | 1404307.57 | 3160108.64 |
| 6477.12 | 10.63 | 197.630 | 6389.36 | 914.33S | 290.55W | ==> | -98.34 | 1403440.16 | 3159833.00 |
| 7410.23 | 90.00 | 89.390 | 6986.00 | 1014.63S | 282.56E | 10.00 | 483.18 | 1403339.87 | 3160406.08 |
| 11783.72 | 90.00 | 89.390 | 6986.00 | 968.03S | 4655.80E | ==> | 4755.37 | 1403386.47 | 3164779.16 |

Interpolated Wellpath

| MD[ft] | Inc[deg] | Azi[deg] | TVD[ft] | North[ft] | East[ft] | Dogleg [deg/100ft] | Vertical Section[ft] | Northing | Easting |
|---------|----------|----------|---------|-----------|----------|-----------------------|-------------------------|------------|------------|
| 0.00 | 0.00 | 0.000 | 0.00 | 0.00N | 0.00E | | 0.00 | 1404354.46 | 3160123.54 |
| 13.00 | 0.00 | 0.000 | 13.00 | 0.00N | 0.00E | ==> | 0.00 | 1404354.46 | 3160123.54 |
| 100.00 | 0.00 | 0.000 | 100.00 | 0.00N | 0.00E | ==> | 0.00 | 1404354.46 | 3160123.54 |
| 200.00 | 0.00 | 0.000 | 200.00 | 0.00N | 0.00E | ==> | 0.00 | 1404354.46 | 3160123.54 |
| 300.00 | 0.00 | 0.000 | 300.00 | 0.00N | 0.00E | ==> | 0.00 | 1404354.46 | 3160123.54 |
| 400.00 | 0.00 | 0.000 | 400.00 | 0.00N | 0.00E | ==> | 0.00 | 1404354.46 | 3160123.54 |
| 500.00 | 0.00 | 0.000 | 500.00 | 0.00N | 0.00E | ==> | 0.00 | 1404354.46 | 3160123.54 |
| 600.00 | 0.00 | 0.000 | 600.00 | 0.00N | 0.00E | ==> | 0.00 | 1404354.46 | 3160123.54 |
| 700.00 | 0.00 | 0.000 | 700.00 | 0.00N | 0.00E | ==> | 0.00 | 1404354.46 | 3160123.54 |
| 800.00 | 0.00 | 0.000 | 800.00 | 0.00N | 0.00E | ==> | 0.00 | 1404354.46 | 3160123.54 |
| 900.00 | 0.00 | 0.000 | 900.00 | 0.00N | 0.00E | ==> | 0.00 | 1404354.46 | 3160123.54 |
| 1000.00 | 0.00 | 0.000 | 1000.00 | 0.00N | 0.00E | ==> | 0.00 | 1404354.46 | 3160123.54 |
| 1013.00 | 0.00 | 0.000 | 1013.00 | 0.00N | 0.00E | ==> | 0.00 | 1404354.46 | 3160123.54 |
| 1100.00 | 1.74 | 197.630 | 1099.99 | 1.26S | 0.40W | 2.00 | -0.14 | 1404353.20 | 3160123.14 |
| 1200.00 | 3.74 | 197.630 | 1199.87 | 5.81S | 1.85W | 2.00 | -0.63 | 1404348.64 | 3160121.69 |
| 1300.00 | 5.74 | 197.630 | 1299.52 | 13.69S | 4.35W | 2.00 | -1.47 | 1404340.77 | 3160119.19 |
| 1400.00 | 7.74 | 197.630 | 1398.82 | 24.87S | 7.90W | 2.00 | -2.68 | 1404329.58 | 3160115.63 |
| 1500.00 | 9.74 | 197.630 | 1497.66 | 39.36S | 12.51W | 2.00 | -4.23 | 1404315.10 | 3160111.03 |
| 1544.69 | 10.63 | 197.630 | 1541.64 | 46.89S | 14.90W | 2.00 | -5.04 | 1404307.57 | 3160108.64 |
| 1600.00 | 10.63 | 197.630 | 1596.00 | 56.61S | 17.99W | ==> | -6.09 | 1404297.84 | 3160105.55 |
| 1700.00 | 10.63 | 197.630 | 1694.29 | 74.20S | 23.58W | ==> | -7.98 | 1404280.26 | 3160099.96 |
| 1800.00 | 10.63 | 197.630 | 1792.57 | 91.79S | 29.17W | ==> | -9.87 | 1404262.67 | 3160094.37 |
| 1900.00 | 10.63 | 197.630 | 1890.85 | 109.37S | 34.76W | ==> | -11.76 | 1404245.09 | 3160088.78 |
| 2000.00 | 10.63 | 197.630 | 1989.13 | 126.96S | 40.34W | ==> | -13.65 | 1404227.50 | 3160083.19 |
| 2100.00 | 10.63 | 197.630 | 2087.42 | 144.55S | 45.93W | ==> | -15.55 | 1404209.91 | 3160077.61 |
| 2200.00 | 10.63 | 197.630 | 2185.70 | 162.13S | 51.52W | ==> | -17.44 | 1404192.33 | 3160072.02 |
| 2300.00 | 10.63 | 197.630 | 2283.98 | 179.72S | 57.11W | ==> | -19.33 | 1404174.74 | 3160066.43 |
| 2400.00 | 10.63 | 197.630 | 2382.26 | 197.31S | 62.70W | ==> | -21.22 | 1404157.16 | 3160060.84 |
| 2500.00 | 10.63 | 197.630 | 2480.55 | 214.89S | 68.29W | ==> | -23.11 | 1404139.57 | 3160055.25 |
| 2600.00 | 10.63 | 197.630 | 2578.83 | 232.48S | 73.87W | ==> | -25.00 | 1404121.98 | 3160049.66 |
| 2700.00 | 10.63 | 197.630 | 2677.11 | 250.07S | 79.46W | ==> | -26.89 | 1404104.40 | 3160044.08 |
| 2800.00 | 10.63 | 197.630 | 2775.39 | 267.65S | 85.05W | ==> | -28.79 | 1404086.81 | 3160038.49 |
| 2900.00 | 10.63 | 197.630 | 2873.68 | 285.24S | 90.64W | ==> | -30.68 | 1404069.23 | 3160032.90 |
| 3000.00 | 10.63 | 197.630 | 2971.96 | 302.83S | 96.23W | ==> | -32.57 | 1404051.64 | 3160027.31 |
| 3100.00 | 10.63 | 197.630 | 3070.24 | 320.41S | 101.82W | ==> | -34.46 | 1404034.05 | 3160021.72 |
| 3200.00 | 10.63 | 197.630 | 3168.53 | 338.00S | 107.41W | ==> | -36.35 | 1404016.47 | 3160016.13 |
| 3300.00 | 10.63 | 197.630 | 3266.81 | 355.59S | 112.99W | ==> | -38.24 | 1403998.88 | 3160010.55 |
| 3400.00 | 10.63 | 197.630 | 3365.09 | 373.17S | 118.58W | ==> | -40.13 | 1403981.30 | 3160004.96 |
| 3500.00 | 10.63 | 197.630 | 3463.37 | 390.76S | 124.17W | ==> | -42.03 | 1403963.71 | 3159999.37 |
| 3600.00 | 10.63 | 197.630 | 3561.66 | 408.35S | 129.76W | ==> | -43.92 | 1403946.12 | 3159993.78 |
| 3700.00 | 10.63 | 197.630 | 3659.94 | 425.93S | 135.35W | ==> | -45.81 | 1403928.54 | 3159988.19 |
| 3800.00 | 10.63 | 197.630 | 3758.22 | 443.52S | 140.94W | ==> | -47.70 | 1403910.95 | 3159982.61 |
| 3900.00 | 10.63 | 197.630 | 3856.50 | 461.11S | 146.52W | ==> | -49.59 | 1403893.37 | 3159977.02 |
| 4000.00 | 10.63 | 197.630 | 3954.79 | 478.69S | 152.11W | ==> | -51.48 | 1403875.78 | 3159971.43 |
| 4100.00 | 10.63 | 197.630 | 4053.07 | 496.28S | 157.70W | ==> | -53.37 | 1403858.19 | 3159965.84 |
| 4200.00 | 10.63 | 197.630 | 4151.35 | 513.87S | 163.29W | ==> | -55.27 | 1403840.61 | 3159960.25 |
| 4300.00 | 10.63 | 197.630 | 4249.63 | 531.45S | 168.88W | ==> | -57.16 | 1403823.02 | 3159954.66 |
| 4400.00 | 10.63 | 197.630 | 4347.92 | 549.04S | 174.47W | ==> | -59.05 | 1403805.44 | 3159949.08 |
| 4500.00 | 10.63 | 197.630 | 4446.20 | 566.63S | 180.06W | ==> | -60.94 | 1403787.85 | 3159943.49 |
| 4600.00 | 10.63 | 197.630 | 4544.48 | 584.21S | 185.64W | ==> | -62.83 | 1403770.27 | 3159937.90 |
| 4700.00 | 10.63 | 197.630 | 4642.77 | 601.80S | 191.23W | ==> | -64.72 | 1403752.68 | 3159932.31 |
| 4800.00 | 10.63 | 197.630 | 4741.05 | 619.39S | 196.82W | ==> | -66.61 | 1403735.09 | 3159926.72 |
| 4900.00 | 10.63 | 197.630 | 4839.33 | 636.97S | 202.41W | ==> | -68.51 | 1403717.51 | 3159921.13 |

All data is in Feet unless otherwise stated
Coordinates are from Slot MD's are from Rig and TVD's are from Rig (Planned Datum #1 4967.0ft above Mean Sea Level)
Vertical Section is from 0.00N 0.00E on azimuth 101.750 degrees
Bottom hole distance is 4755.37 Feet on azimuth 101.75 degrees from Wellhead
Calculation method uses Minimum Curvature method
Prepared by Peterson Energy
Date Printed: 28-Nov-2012



SYSDRILL
Well Design Combined Report
Wellbore: PAVISTMA 4 #1-6-32-090-4-NH (PWB)
Wellpath: PAVISTMA 4 #1-6-32-090-4-NH (PWP#1)

Interpolated Wellpath

| MD[ft] | Inc[deg] | Azi[deg] | TVD[ft] | North[ft] | East[ft] | Dogleg [deg/100ft] | Vertical Section[ft] | Northing | Easting |
|----------|----------|----------|---------|-----------|----------|-----------------------|-------------------------|------------|------------|
| 5000.00 | 10.63 | 197.630 | 4937.61 | 654.56S | 208.00W | ==> | -70.40 | 1403699.92 | 3159915.55 |
| 5100.00 | 10.63 | 197.630 | 5035.90 | 672.15S | 213.59W | ==> | -72.29 | 1403682.34 | 3159909.96 |
| 5200.00 | 10.63 | 197.630 | 5134.18 | 689.73S | 219.17W | ==> | -74.18 | 1403664.75 | 3159904.37 |
| 5300.00 | 10.63 | 197.630 | 5232.46 | 707.32S | 224.76W | ==> | -76.07 | 1403647.16 | 3159898.78 |
| 5400.00 | 10.63 | 197.630 | 5330.74 | 724.91S | 230.35W | ==> | -77.96 | 1403629.58 | 3159893.19 |
| 5500.00 | 10.63 | 197.630 | 5429.03 | 742.49S | 235.94W | ==> | -79.85 | 1403611.99 | 3159887.61 |
| 5600.00 | 10.63 | 197.630 | 5527.31 | 760.08S | 241.53W | ==> | -81.75 | 1403594.41 | 3159882.02 |
| 5700.00 | 10.63 | 197.630 | 5625.59 | 777.67S | 247.12W | ==> | -83.64 | 1403576.82 | 3159876.43 |
| 5800.00 | 10.63 | 197.630 | 5723.87 | 795.25S | 252.71W | ==> | -85.53 | 1403559.23 | 3159870.84 |
| 5900.00 | 10.63 | 197.630 | 5822.16 | 812.84S | 258.29W | ==> | -87.42 | 1403541.65 | 3159865.25 |
| 6000.00 | 10.63 | 197.630 | 5920.44 | 830.43S | 263.88W | ==> | -89.31 | 1403524.06 | 3159859.66 |
| 6100.00 | 10.63 | 197.630 | 6018.72 | 848.01S | 269.47W | ==> | -91.20 | 1403506.48 | 3159854.08 |
| 6200.00 | 10.63 | 197.630 | 6117.01 | 865.60S | 275.06W | ==> | -93.09 | 1403488.89 | 3159848.49 |
| 6300.00 | 10.63 | 197.630 | 6215.29 | 883.19S | 280.65W | ==> | -94.99 | 1403471.30 | 3159842.90 |
| 6400.00 | 10.63 | 197.630 | 6313.57 | 900.77S | 286.24W | ==> | -96.88 | 1403453.72 | 3159837.31 |
| 6477.12 | 10.63 | 197.630 | 6389.36 | 914.33S | 290.55W | ==> | -98.34 | 1403440.16 | 3159833.00 |
| 6500.00 | 10.16 | 185.200 | 6411.87 | 918.36S | 291.37W | 10.00 | -98.32 | 1403436.13 | 3159832.18 |
| 6600.00 | 13.49 | 137.410 | 6509.96 | 935.77S | 284.26W | 10.00 | -87.81 | 1403418.72 | 3159839.29 |
| 6700.00 | 21.41 | 116.430 | 6605.37 | 952.53S | 259.95W | 10.00 | -60.61 | 1403401.96 | 3159863.59 |
| 6800.00 | 30.55 | 106.980 | 6695.21 | 968.12S | 219.20W | 10.00 | -17.53 | 1403386.38 | 3159904.35 |
| 6900.00 | 40.06 | 101.630 | 6776.74 | 982.06S | 163.23W | 10.00 | 40.10 | 1403372.43 | 3159960.31 |
| 7000.00 | 49.75 | 98.070 | 6847.50 | 993.94S | 93.75W | 10.00 | 110.54 | 1403360.56 | 3160029.79 |
| 7100.00 | 59.51 | 95.420 | 6905.32 | 1003.39S | 12.87W | 10.00 | 191.65 | 1403351.11 | 3160110.67 |
| 7200.00 | 69.32 | 93.250 | 6948.46 | 1010.12S | 76.96E | 10.00 | 280.97 | 1403344.37 | 3160200.49 |
| 7300.00 | 79.15 | 91.350 | 6975.59 | 1013.94S | 172.99E | 10.00 | 375.77 | 1403340.56 | 3160296.52 |
| 7400.00 | 88.99 | 89.570 | 6985.91 | 1014.72S | 272.33E | 10.00 | 473.19 | 1403339.77 | 3160395.86 |
| 7410.23 | 90.00 | 89.390 | 6986.00 | 1014.63S | 282.56E | 10.00 | 483.18 | 1403339.87 | 3160406.08 |
| 7500.00 | 90.00 | 89.390 | 6986.00 | 1013.67S | 372.32E | ==> | 570.88 | 1403340.82 | 3160495.85 |
| 7600.00 | 90.00 | 89.390 | 6986.00 | 1012.61S | 472.32E | ==> | 668.56 | 1403341.89 | 3160595.84 |
| 7700.00 | 90.00 | 89.390 | 6986.00 | 1011.54S | 572.31E | ==> | 766.24 | 1403342.96 | 3160695.83 |
| 7800.00 | 90.00 | 89.390 | 6986.00 | 1010.47S | 672.31E | ==> | 863.93 | 1403344.02 | 3160795.82 |
| 7900.00 | 90.00 | 89.390 | 6986.00 | 1009.41S | 772.30E | ==> | 961.61 | 1403345.09 | 3160895.81 |
| 8000.00 | 90.00 | 89.390 | 6986.00 | 1008.34S | 872.30E | ==> | 1059.29 | 1403346.15 | 3160995.80 |
| 8100.00 | 90.00 | 89.390 | 6986.00 | 1007.28S | 972.29E | ==> | 1156.98 | 1403347.22 | 3161095.79 |
| 8200.00 | 90.00 | 89.390 | 6986.00 | 1006.21S | 1072.28E | ==> | 1254.66 | 1403348.28 | 3161195.78 |
| 8300.00 | 90.00 | 89.390 | 6986.00 | 1005.15S | 1172.28E | ==> | 1352.35 | 1403349.35 | 3161295.77 |
| 8400.00 | 90.00 | 89.390 | 6986.00 | 1004.08S | 1272.27E | ==> | 1450.03 | 1403350.41 | 3161395.76 |
| 8500.00 | 90.00 | 89.390 | 6986.00 | 1003.02S | 1372.27E | ==> | 1547.71 | 1403351.48 | 3161495.75 |
| 8600.00 | 90.00 | 89.390 | 6986.00 | 1001.95S | 1472.26E | ==> | 1645.40 | 1403352.55 | 3161595.74 |
| 8700.00 | 90.00 | 89.390 | 6986.00 | 1000.88S | 1572.26E | ==> | 1743.08 | 1403353.61 | 3161695.73 |
| 8800.00 | 90.00 | 89.390 | 6986.00 | 999.82S | 1672.25E | ==> | 1840.76 | 1403354.68 | 3161795.72 |
| 8900.00 | 90.00 | 89.390 | 6986.00 | 998.75S | 1772.25E | ==> | 1938.45 | 1403355.74 | 3161895.71 |
| 9000.00 | 90.00 | 89.390 | 6986.00 | 997.69S | 1872.24E | ==> | 2036.13 | 1403356.81 | 3161995.70 |
| 9100.00 | 90.00 | 89.390 | 6986.00 | 996.62S | 1972.23E | ==> | 2133.82 | 1403357.87 | 3162095.69 |
| 9200.00 | 90.00 | 89.390 | 6986.00 | 995.56S | 2072.23E | ==> | 2231.50 | 1403358.94 | 3162195.68 |
| 9300.00 | 90.00 | 89.390 | 6986.00 | 994.49S | 2172.22E | ==> | 2329.18 | 1403360.00 | 3162295.67 |
| 9400.00 | 90.00 | 89.390 | 6986.00 | 993.43S | 2272.22E | ==> | 2426.87 | 1403361.07 | 3162395.66 |
| 9500.00 | 90.00 | 89.390 | 6986.00 | 992.36S | 2372.21E | ==> | 2524.55 | 1403362.13 | 3162495.65 |
| 9600.00 | 90.00 | 89.390 | 6986.00 | 991.29S | 2472.21E | ==> | 2622.23 | 1403363.20 | 3162595.64 |
| 9700.00 | 90.00 | 89.390 | 6986.00 | 990.23S | 2572.20E | ==> | 2719.92 | 1403364.27 | 3162695.63 |
| 9800.00 | 90.00 | 89.390 | 6986.00 | 989.16S | 2672.19E | ==> | 2817.60 | 1403365.33 | 3162795.62 |
| 9900.00 | 90.00 | 89.390 | 6986.00 | 988.10S | 2772.19E | ==> | 2915.28 | 1403366.40 | 3162895.61 |
| 10000.00 | 90.00 | 89.390 | 6986.00 | 987.03S | 2872.18E | ==> | 3012.97 | 1403367.46 | 3162995.61 |
| 10100.00 | 90.00 | 89.390 | 6986.00 | 985.97S | 2972.18E | ==> | 3110.65 | 1403368.53 | 3163095.60 |
| 10200.00 | 90.00 | 89.390 | 6986.00 | 984.90S | 3072.17E | ==> | 3208.34 | 1403369.59 | 3163195.59 |
| 10300.00 | 90.00 | 89.390 | 6986.00 | 983.84S | 3172.17E | ==> | 3306.02 | 1403370.66 | 3163295.58 |
| 10400.00 | 90.00 | 89.390 | 6986.00 | 982.77S | 3272.16E | ==> | 3403.70 | 1403371.72 | 3163395.57 |
| 10500.00 | 90.00 | 89.390 | 6986.00 | 981.70S | 3372.15E | ==> | 3501.39 | 1403372.79 | 3163495.56 |
| 10600.00 | 90.00 | 89.390 | 6986.00 | 980.64S | 3472.15E | ==> | 3599.07 | 1403373.86 | 3163595.55 |
| 10700.00 | 90.00 | 89.390 | 6986.00 | 979.57S | 3572.14E | ==> | 3696.75 | 1403374.92 | 3163695.54 |
| 10800.00 | 90.00 | 89.390 | 6986.00 | 978.51S | 3672.14E | ==> | 3794.44 | 1403375.99 | 3163795.53 |
| 10900.00 | 90.00 | 89.390 | 6986.00 | 977.44S | 3772.13E | ==> | 3892.12 | 1403377.05 | 3163895.52 |
| 11000.00 | 90.00 | 89.390 | 6986.00 | 976.38S | 3872.13E | ==> | 3989.81 | 1403378.12 | 3163995.51 |
| 11100.00 | 90.00 | 89.390 | 6986.00 | 975.31S | 3972.12E | ==> | 4087.49 | 1403379.18 | 3164095.50 |
| 11200.00 | 90.00 | 89.390 | 6986.00 | 974.25S | 4072.11E | ==> | 4185.17 | 1403380.25 | 3164195.49 |
| 11300.00 | 90.00 | 89.390 | 6986.00 | 973.18S | 4172.11E | ==> | 4282.86 | 1403381.31 | 3164295.48 |
| 11400.00 | 90.00 | 89.390 | 6986.00 | 972.11S | 4272.10E | ==> | 4380.54 | 1403382.38 | 3164395.47 |
| 11500.00 | 90.00 | 89.390 | 6986.00 | 971.05S | 4372.10E | ==> | 4478.22 | 1403383.45 | 3164495.46 |
| 11600.00 | 90.00 | 89.390 | 6986.00 | 969.98S | 4472.09E | ==> | 4575.91 | 1403384.51 | 3164595.45 |
| 11700.00 | 90.00 | 89.390 | 6986.00 | 968.92S | 4572.09E | ==> | 4673.59 | 1403385.58 | 3164695.44 |
| 11783.72 | 90.00 | 89.390 | 6986.00 | 968.03S | 4655.80E | ==> | 4755.37 | 1403386.47 | 3164779.16 |

All data is in Feet unless otherwise stated
Coordinates are from Slot MD's are from Rig and TVD's are from Rig (Planned Datum #1 4967.0ft above Mean Sea Level)
Vertical Section is from 0.00N 0.00E on azimuth 101.750 degrees
Bottom hole distance is 4755.37 Feet on azimuth 101.75 degrees from Wellhead
Calculation method uses Minimum Curvature method
Prepared by Peterson Energy
Date Printed: 28-Nov-2012



SYSDRILL
Well Design Combined Report
Wellbore: PAVISTMA 4 #1-6-32-090-4-NH (PWB)
Wellpath: PAVISTMA 4 #1-6-32-090-4-NH (PWP#1)

Targets

| Name | North[ft] | East[ft] | TVD[ft] | Latitude | Longitude | Northing | Easting | Last Revised |
|----------|-----------|----------|---------|----------------|-----------------|------------|------------|--------------|
| P 4 - T1 | 1014.63S | 282.56E | 6986.00 | N40 26 20.9001 | W104 55 25.3930 | 1403339.87 | 3160406.08 | 19-Oct-2012 |
| P 4 - T2 | 968.03S | 4655.80E | 6986.00 | N40 26 21.0760 | W104 54 28.8316 | 1403386.47 | 3164779.16 | 19-Oct-2012 |

Survey Tool Program

| Reference | Survey Name | MD[ft] | TVD[ft] | Survey Tool | Error Model |
|-----------|-------------|----------|---------|---------------|-------------|
| 9259 | Planned | 11783.72 | 6986.00 | WdW Rate Gyro | Standard |

Notes

All data is in Feet unless otherwise stated
Coordinates are from Slot MD's are from Rig and TVD's are from Rig (Planned Datum #1 4967.0ft above Mean Sea Level)
Vertical Section is from 0.00N 0.00E on azimuth 101.750 degrees
Bottom hole distance is 4755.37 Feet on azimuth 101.75 degrees from Wellhead
Calculation method uses Minimum Curvature method
Prepared by Peterson Energy
Date Printed: 28-Nov-2012



SYSDRILL
Closest Approach + Clearance Factor Summary Report
Wellbore: PAVISTMA 4 #1-6-32-090-4-NH (PWB)
Wellpath: PAVISTMA 4 #1-6-32-090-4-NH (PWP#1)

Ellipse separations are reported ONLY if BOTH wells have uncertainty data
Only Depth and Magnetic Reference Field error terms are correlated across tie points
Cutoff is calculated on CENTRE to CENTRE distance

Summary data uses Closest Approach clearance calculation for all minima
Hole size/Casings ARE included
Hole size/Casings are NOT subtracted from Centre-Centre distance
Confidence limit of 95.00% / 2.80 SD.

Wellbore

| Name | Created | Last Revised |
|-----------------------------------|-------------|--------------|
| PAVISTMA 4 #1-6-32-090-4-NH (PWB) | 13-Nov-2012 | 13-Nov-2012 |

Well

| Name | Government ID | Last Revised |
|-----------------------------|---------------|--------------|
| PAVISTMA 4 #1-6-32-090-4-NH | | 13-Nov-2012 |

Slot

| Name | Grid Northing | Grid Easting | Latitude | Longitude | North | East |
|---------|---------------|--------------|----------------|-----------------|--------|-------|
| Slot #4 | 1404354.4554 | 3160123.5363 | N40 26 30.9442 | W104 55 28.9620 | 32.40N | 0.68W |

Installation

| Name | Easting | Northing | Coord System Name | North Alignment |
|----------|--------------|--------------|---|-----------------|
| Pavistma | 3160124.2135 | 1404322.0586 | CO83-NF on NORTH AMERICAN DATUM 1983 datum | Grid |

Field

| Name | Easting | Northing | Coord System Name | North Alignment |
|-----------------|--------------|--------------|---|-----------------|
| Windsor Project | 3162710.0707 | 1407271.6545 | CO83-NF on NORTH AMERICAN DATUM 1983 datum | Grid |

Clearance Summary

| Offset WellName | Offset Wellbore | Offset Slot | Offset Structure | Separation [ft] | MD[ft] | Diverging From[ft] | Ellipse Separation [ft] | Ellipse MD[ft] | Clearance Factor | Clearance MD[ft] |
|--|--|-------------------------|------------------------------|-----------------|---------|--------------------|-------------------------|----------------|------------------|------------------|
| PAVISTMA 5-1-32 PAVISTMA 5 #1-5-32-09 0-4-NH | PAVISTMA 5-1-32 (AWB) PAVISTMA 5 #1-5-32-090-4 -NH (PWB) | PAVISTMA 5-1-32 Slot #5 | Pavistma | 9.33 | 453.11 | 453.11 | 8.12 | 455.91 | 7.62 | 472.32 |
| PAVISTMA 4-2-32 PAVISTMA 6 #1-4-32-09 0-4-NH | PAVISTMA 4-2-32 (AWB) PAVISTMA 6 #1-4-32-090-4 -NH (PWB) | PAVISTMA 4-2-32 Slot #6 | Pavistma | 23.81 | 659.79 | 7593.32 | 22.33 | 669.17 | 14.74 | 784.00 |
| PAVISTMA 5-3-32 PAVISTMA 7 #1-4-32-09 0-8-CH | PAVISTMA 5-3-32 (AWB) PAVISTMA 7 #1-4-32-090-8 -CH (PWB) | PAVISTMA 5-3-32 Slot #7 | Pavistma | 31.99 | 1013.66 | 11463.13 | 30.38 | 1013.66 | 16.83 | 11512.34 |
| PAVISTMA 8 #1-3-32-09 0-4-NH | PAVISTMA 8 #1-3-32-090-4 -NH (PWB) | Slot #8 | Pavistma | 47.16 | 359.29 | 8173.56 | 46.30 | 359.29 | 25.22 | 1112.08 |
| PAVISTMA 9 #1-3-32-09 0-4-NH | PAVISTMA 9 #1-3-32-090-4 -NH (PWB) | Slot #9 | Pavistma | 47.99 | 1013.66 | 11783.72 | 46.38 | 1013.66 | 19.21 | 11783.72 |
| PAVISTMA 12-32 PAVISTMA 10 #1-3-32-09 0-8-CH | PAVISTMA 12-32 (AWB) PAVISTMA 10 #1-3-32-090-8 -CH (PWB) | PAVISTMA 12-32 Slot #10 | Pavistma (Anadarko) Pavistma | 63.99 | 1013.66 | 11430.32 | 62.38 | 1013.66 | 22.16 | 11561.56 |
| PAVISTMA 11 #1-3-32-09 0-4-NH | PAVISTMA 11 #1-3-32-090-4 -NH (PWB) | Slot #11 | Pavistma | 79.98 | 1013.66 | 1013.66 | 78.37 | 1013.66 | 26.22 | 11659.98 |
| PAVISTMA 12 #1-2-32-09 0-4-NH | PAVISTMA 12 #1-2-32-090-4 -NH (PWB) | Slot #12 | Pavistma | 85.23 | 2391.80 | 7531.94 | 79.69 | 2391.80 | 15.13 | 2457.23 |
| | | | | 95.98 | 1013.66 | 11783.72 | 94.37 | 1013.66 | 26.70 | 11783.72 |
| | | | | 111.98 | 1013.66 | 11417.11 | 110.37 | 1013.66 | 30.15 | 11774.81 |
| | | | | 127.97 | 1013.66 | 11413.00 | 126.36 | 1013.66 | 34.00 | 11783.72 |

All data is in Feet unless otherwise stated
Coordinates are from Slot MD's are from Rig and TVD's are from Rig (Planned Datum #1 4967.0ft above Mean Sea Level)
Vertical Section is from 0.00N 0.00E on azimuth 101.750 degrees
Prepared by Peterson Energy
Date Printed: 28-Nov-2012



SYSDRILL
Closest Approach + Clearance Factor Summary Report
Wellbore: PAVISTMA 4 #1-6-32-090-4-NH (PWB)
Wellpath: PAVISTMA 4 #1-6-32-090-4-NH (PWP#1)

Clearance Summary

| Offset WellName | Offset Wellbore | Offset Slot | Offset Structure | Separation [ft] | MD[ft] | Diverging From[ft] | Ellipse Separation [ft] | Ellipse MD[ft] | Clearance Factor | Clearance MD[ft] |
|------------------------|---------------------------|----------------------------|---------------------|-----------------|----------|--------------------|-------------------------|----------------|------------------|------------------|
| PAVISTMA 19-32 | PAVISTMA 19-32 (AWB) | PAVISTMA 19-32 | Pavistma (Anadarko) | 161.08 | 8196.77 | 8196.77 | 120.79 | 8182.29 | 3.86 | 8149.48 |
| PAVISTMA 11-32 | PAVISTMA 11-32 (AWB) | PAVISTMA 11-32 | Pavistma (Anadarko) | 183.76 | 1938.86 | 8853.92 | 179.01 | 1948.70 | 12.56 | 8853.92 |
| RANCHO WATER VALLEY 13 | RANCHO WATER VALLEY 13 | Slot #13 | Rancho Water Valley | 198.20 | 10105.52 | 10105.52 | 120.28 | 10085.18 | 2.52 | 10085.18 |
| #7-6-33-27 0-6-CH | #7-6-33-270-6 -CH (PWB) | | | | | | | | | |
| FRYE FARM 7-5-32 | FRYE FARM 7-5-32 (AWB) | FRYE FARMS #7-5-32 Slot #5 | Frye Farms | 236.80 | 9660.87 | 9660.87 | 175.48 | 9658.67 | 3.84 | 9642.27 |
| CENTER POINT 5 | CENTER POINT 5 | | Center Point | 254.00 | 11783.72 | 11783.72 | 193.03 | 11783.72 | 4.17 | 11783.72 |
| #8-1-32-18 0-4-NH | #8-1-32-180-4 -NH (PWB) | | | | | | | | | |
| FRYE FARMS 5 | FRYE FARMS 5 | Slot #5 | Frye Farms | 330.11 | 11783.72 | 11783.72 | 279.39 | 11783.72 | 6.51 | 11783.72 |
| #7-9-32-27 0-3-NH | #7-9-32-270-3 -NH (PWB) | | | | | | | | | |
| RANCHO WATER VALLEY 11 | RANCHO WATER VALLEY 11 | Slot #11 | Rancho Water Valley | 502.76 | 11783.72 | 11783.72 | 413.88 | 11783.72 | 5.66 | 11690.93 |
| #7-7-33-27 0-6-CH | #7-7-33-270-6 -CH (PWB) | | | | | | | | | |
| FRYE FARMS 6 | FRYE FARMS 6 | Slot #6 | Frye Farms | 531.66 | 11783.72 | 11783.72 | 511.83 | 11783.72 | 26.80 | 11783.72 |
| #1-6-33-09 0-4-NH | #1-6-33-090-4 -NH (PWB) | | | | | | | | | |
| FRYE FARMS 7 | FRYE FARMS 7 | Slot #7 | Frye Farms | 557.24 | 11783.72 | 11783.72 | 518.95 | 11783.72 | 14.55 | 11783.72 |
| #1-6-33-09 0-4-NH | #1-6-33-090-4 -NH (PWB) | | | | | | | | | |
| CENTER POINT 7 | CENTER POINT 7 | Slot #7 | Center Point | 571.61 | 11783.72 | 11783.72 | 510.55 | 11783.72 | 9.36 | 11783.72 |
| #0-1-33-18 0-4-NH | #0-1-33-180-4 -NH (PWB) | | | | | | | | | |
| FRYE FARMS 1 | FRYE FARMS 1 | Slot #1 | Frye Farms | 660.21 | 11783.72 | 11783.72 | 609.60 | 11783.72 | 13.05 | 11783.72 |
| #7-8-32-27 0-4-NH | #7-8-32-270-4 -NH (PWB) | | | | | | | | | |
| FRYE FARMS 8 | FRYE FARMS 8 | Slot #8 | Frye Farms | 740.20 | 11783.72 | 11783.72 | 692.26 | 11783.72 | 15.44 | 11783.72 |
| #1-5-33-09 0-4-NH | #1-5-33-090-4 -NH (PWB) | | | | | | | | | |
| FRYE FARMS 13 | FRYE FARMS 13 | Slot #13 | Frye Farms | 796.46 | 9548.18 | 9548.18 | 760.09 | 9543.84 | 16.43 | 11783.72 |
| #1-5-5-32-090-6-CH | #1-5-5-32-090 -6-CH (PWB) | | | | | | | | | |
| FRYE FARMS 9 | FRYE FARMS 9 | Slot #9 | Frye Farms | 997.67 | 11783.72 | 11783.72 | 947.44 | 11783.72 | 19.86 | 11783.72 |
| #1-5-33-09 0-4-NH | #1-5-33-090-4 -NH (PWB) | | | | | | | | | |
| RANCHO WATER VALLEY 7 | RANCHO WATER VALLEY 7 | Slot #7 | Rancho Water Valley | 1070.01 | 11783.72 | 11783.72 | 800.03 | 11603.76 | 3.96 | 11603.76 |
| #7-8-33-27 0-5-CH | #7-8-33-270-5 -CH (PWB) | | | | | | | | | |
| RANCHO WATER VALLEY 12 | RANCHO WATER VALLEY 12 | Slot #12 | Rancho Water Valley | 1076.18 | 11783.72 | 11783.72 | 1028.26 | 11783.72 | 22.46 | 11783.72 |
| #7-7-33-27 0-4-NH | #7-7-33-270-4 -NH (PWB) | | | | | | | | | |
| FRYE FARMS #9-7-32 | FRYE FARMS #9-7-32 (AWB) | FRYE FARMS #9-7-32 | Frye Farms | 1102.53 | 11139.08 | 11139.08 | 1054.64 | 11151.45 | 21.28 | 11545.15 |
| FRYE FARMS #9-5-32 | FRYE FARMS #9-5-32 (AWB) | FRYE FARMS #9-5-32 | Frye Farms | 1108.11 | 9829.42 | 9829.42 | 1049.06 | 9822.71 | 18.73 | 9773.50 |
| RANCHO WATER VALLEY 6 | RANCHO WATER VALLEY 6 | Slot #6 | Rancho Water Valley | 1230.37 | 11783.72 | 11783.72 | 1138.84 | 11783.72 | 13.44 | 11659.34 |
| #0-7-4-270-5-NH | #0-7-4-270-5-NH (PWB) | | | | | | | | | |

All data is in Feet unless otherwise stated
Coordinates are from Slot MD's are from Rig and TVD's are from Rig (Planned Datum #1 4967.0ft above Mean Sea Level)
Vertical Section is from 0.00N 0.00E on azimuth 101.750 degrees
Prepared by Peterson Energy
Date Printed: 28-Nov-2012

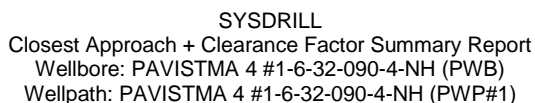

| Offset WellName | Offset Wellbore | Offset Slot | Offset Structure | Separation [ft] | MD[ft] | Diverging From[ft] | Ellipse Separation [ft] | Ellipse MD[ft] | Clearance Factor | Clearance MD[ft] |
|--|---|----------------|------------------------|--------------------|----------|-----------------------|-------------------------------|-------------------|---------------------|---------------------|
| RANCHO WATER VALLEY 10 #7-8-33-27 0-4-NH FRYE | RANCHO WATER VALLEY 10 #7-8-33-270-4 -NH (PWB) FRYE | Slot #10 | Rancho Water Valley | 1276.25 | 11783.72 | 11783.72 | 1244.83 | 11783.72 | 40.62 | 11783.72 |
| FARMS 10 #1-4-33-09 0-4-NH FRYE | FARMS 10 #1-4-33-090-4 -NH (PWB) FRYE | Slot #10 | Frye Farms | 1282.11 | 11783.72 | 11783.72 | 1231.81 | 11783.72 | 25.49 | 11783.72 |
| FARMS 11 #1-4-33-09 0-4-NH FRYE | FARMS 11 #1-4-33-090-4 -NH (PWB) FRYE | Slot #11 | Frye Farms | 1642.39 | 11771.43 | 11771.43 | 1593.01 | 11783.72 | 33.23 | 11783.72 |
| FARMS 12 #1-3-33-09 0-4-NH RANCHO WATER VALLEY 4 #7-1-4-270 -4-NH HILLSIDE 17 #3-1-33-09 0-4-NH | FARMS 12 #1-3-33-090-4 -NH (PWB) RANCHO WATER VALLEY 4 #7-1-4-270-4- NH (PWB) HILLSIDE 17 #3-1-33-090-4 -NH (PWB) | Slot #12 | Frye Farms | 1916.34 | 11735.09 | 11735.09 | 1867.95 | 11758.41 | 39.31 | 11783.72 |
| RANCHO WATER VALLEY 5 #7-2-4-270 -4-NH HILLSIDE 18 #2-1-33-09 0-4-NH | RANCHO WATER VALLEY 5 #7-2-4-270-4- NH (PWB) HILLSIDE 18 #2-1-33-090-4 -NH (PWB) | Slot #4 | Rancho Water Valley | 1952.24 | 11783.72 | 11783.72 | 1780.12 | 11783.72 | 11.34 | 11783.72 |
| RANCHO WATER VALLEY 5 #7-2-4-270 -4-NH HILLSIDE 18 #2-1-33-09 0-4-NH | RANCHO WATER VALLEY 5 #7-2-4-270-4- NH (PWB) HILLSIDE 18 #2-1-33-090-4 -NH (PWB) | Slot #17 | Hillside | 2424.79 | 11783.72 | 11783.72 | 2359.80 | 11783.72 | 37.31 | 11783.72 |
| RANCHO WATER VALLEY 5 #7-2-4-270 -4-NH HILLSIDE 18 #2-1-33-09 0-4-NH | RANCHO WATER VALLEY 5 #7-2-4-270-4- NH (PWB) HILLSIDE 18 #2-1-33-090-4 -NH (PWB) | Slot #5 | Rancho Water Valley | 2479.84 | 11783.72 | 11783.72 | 2281.49 | 11783.72 | 12.50 | 11783.72 |
| HILLSIDE 18 #2-1-33-09 0-4-NH | HILLSIDE 18 #2-1-33-090-4 -NH (PWB) | Slot #18 | Hillside | 2745.47 | 11783.72 | 11783.72 | 2681.45 | 11783.72 | 42.88 | 11783.72 |
| RAINDAN CE 6 #1-2-32-09 0-4-CH HILLSIDE 15 #2-1-33-09 0-4-CH | RAINDANCE 6 #1-2-32-090-4 -CH (PWB) HILLSIDE 15 #2-1-33-090-4 -CH (PWB) | Slot #6 | Raindance | 2792.95 | 5956.36 | 11400.04 | 2643.14 | 11381.11 | 12.56 | 11381.11 |
| RAINDAN CE 5 #1-2-32-09 0-4-NH HILLSIDE 14 #2-1-33-09 0-4-NH | RAINDANCE 5 #1-2-32-090-4 -NH (PWB) HILLSIDE 14 #2-1-33-090-4 -NH (PWB) | Slot #15 | Hillside | 2916.20 | 11783.72 | 11783.72 | 2853.25 | 11783.72 | 46.32 | 11783.72 |
| RAINDAN CE 5 #1-2-32-09 0-4-NH HILLSIDE 14 #2-1-33-09 0-4-NH | RAINDANCE 5 #1-2-32-090-4 -NH (PWB) HILLSIDE 14 #2-1-33-090-4 -NH (PWB) | Slot #5 | Raindance | 2922.09 | 5705.26 | 11399.74 | 2793.68 | 11397.51 | 13.19 | 11381.11 |
| RAINDAN CE 4 #1-1-32-09 0-4-NH CENTER POINT 2 #1-1-33-09 0-4-NH | RAINDANCE 4 #1-1-32-090-4 -NH (PWB) CENTER POINT 2 #1-1-33-090-4 -NH (PWB) | Slot #14 | Hillside | 3071.23 | 11783.72 | 11783.72 | 3007.83 | 11783.72 | 48.44 | 11783.72 |
| RAINDAN CE 4 #1-1-32-09 0-4-NH CENTER POINT 2 #1-1-33-09 0-4-NH | RAINDANCE 4 #1-1-32-090-4 -NH (PWB) CENTER POINT 2 #1-1-33-090-4 -NH (PWB) | Slot #4 | Raindance | 3245.54 | 5656.04 | 11395.47 | 3121.93 | 11397.51 | 14.64 | 11395.47 |
| RAINDAN CE 2 #1-1-32-09 0-4-NH RAINDAN CE 1 #1-1-32 (PWB) RAINDAN CE 9 #1-0-32-09 0-4-NH | RAINDANCE 2 #1-1-32-090-4 -NH (PWB) RAINDANCE 1 #1-1-32 (PWB) RAINDANCE 9 #1-0-32-090-4 -NH (PWB) | Slot #2 | Center Point | 3409.31 | 11783.72 | 11783.72 | 3356.51 | 11783.72 | 64.56 | 11783.72 |
| RAINDAN CE 2 #1-1-32-09 0-4-NH RAINDAN CE 1 #1-1-32 (PWB) RAINDAN CE 9 #1-0-32-09 0-4-NH | RAINDANCE 2 #1-1-32-090-4 -NH (PWB) RAINDANCE 1 #1-1-32 (PWB) RAINDANCE 9 #1-0-32-090-4 -NH (PWB) | Slot #3 | Raindance | 3441.99 | 5787.28 | 11397.51 | 3300.87 | 11397.51 | 15.48 | 11430.32 |
| RAINDAN CE 2 #1-1-32-09 0-4-NH RAINDAN CE 1 #1-1-32 (PWB) RAINDAN CE 9 #1-0-32-09 0-4-NH | RAINDANCE 2 #1-1-32-090-4 -NH (PWB) RAINDANCE 1 #1-1-32 (PWB) RAINDANCE 9 #1-0-32-090-4 -NH (PWB) | Slot #2 | Raindance | 3517.00 | 1013.66 | 11392.19 | 3450.48 | 11397.51 | 16.11 | 11463.13 |
| RAINDAN CE 1 #1-1-32 (PWB) RAINDAN CE 9 #1-0-32-09 0-4-NH | RAINDANCE 1 #1-1-32 (PWB) RAINDANCE 9 #1-0-32-090-4 -NH (PWB) | Slot #1 | Raindance | 3520.41 | 1013.66 | 1013.66 | 3518.78 | 1013.66 | 235.51 | 10544.50 |
| RAINDAN CE 9 #1-0-32-09 0-4-NH | RAINDANCE 9 #1-0-32- | | | | | | | | | |

All data is in Feet unless otherwise stated
 Coordinates are from Slot MD's are from Rig and TVD's are from Rig (Planned Datum #1 4967.0ft above Mean Sea Level)
 Vertical Section is from 0.00N 0.00E on azimuth 101.750 degrees
 Prepared by Peterson Energy
 Date Printed: 28-Nov-2012



SYSDRILL
Closest Approach + Clearance Factor Summary Report
Wellbore: PAVISTMA 4 #1-6-32-090-4-NH (PWB)
Wellpath: PAVISTMA 4 #1-6-32-090-4-NH (PWP#1)

Clearance Summary

| Offset WellName | Offset Wellbore | Offset Slot | Offset Structure | Separation [ft] | MD[ft] | Diverging From[ft] | Ellipse Separation [ft] | Ellipse MD[ft] | Clearance Factor | Clearance MD[ft] |
|---|---|-------------------------|---------------------|-----------------|----------|--------------------|-------------------------|----------------|------------------|------------------|
| #1-0-32-09-09-4-CH RAINDAN CE 7 | #1-0-32-0909-4-CH (PWB) RAINDANCE 7 | Slot #7 | Raindance | 3533.73 | 1013.66 | 11387.59 | 3532.10 | 1013.66 | 48.25 | 11783.72 |
| #1-0-32-09-04-NH HILLSIDE 2-4-32 CENTER POINT 1 | #1-0-32-090-4-NH (PWB) HILLSIDE 2-4-32 (PWB) CENTER POINT 1 | HILLSIDE 2-4-32 Slot #1 | Hillside | 3551.86 | 8690.82 | 8690.82 | 3509.02 | 8713.00 | 74.76 | 9871.92 |
| #1-1-33-09-04-CH CENTER POINT 3 | #1-1-33-090-4-CH (PWB) CENTER POINT 3 | Slot #3 | Center Point | 3578.14 | 11783.72 | 11783.72 | 3524.92 | 11783.72 | 67.24 | 11783.72 |
| #1-1-33-09-04-NH HILLSIDE 9 | #1-1-33-090-4-NH (PWB) HILLSIDE 9 | Slot #9 | Hillside | 3734.95 | 11783.72 | 11783.72 | 3682.00 | 11783.72 | 70.55 | 11783.72 |
| #7-7-29-00-04-NH HILLSIDE 8 | #7-7-29-000-4-NH (PWB) HILLSIDE 8 | Slot #8 | Hillside | 3874.60 | 1013.66 | 11269.37 | 3872.87 | 1013.66 | 51.51 | 11783.72 |
| #7-7-29-00-04-NH HILLSIDE 11 | #7-7-29-000-4-NH (PWB) HILLSIDE 11 | Slot #11 | Hillside | 3881.53 | 1013.66 | 10980.76 | 3879.80 | 1013.66 | 59.26 | 11783.72 |
| #0-7-28-00-04-CH HILLSIDE 5 | #0-7-28-000-4-CH (PWB) HILLSIDE 5 | Slot #5 | Hillside | 3884.45 | 931.64 | 11713.00 | 3882.82 | 948.04 | 43.26 | 11783.72 |
| #6-7-29-00-04-NH HILLSIDE 10 | #6-7-29-000-4-NH (PWB) HILLSIDE 10 | Slot #10 | Hillside | 3886.63 | 1013.66 | 10684.55 | 3884.90 | 1013.66 | 68.88 | 11783.72 |
| #8-7-29-00-04-NH HILLSIDE 4 | #8-7-29-000-4-NH (PWB) HILLSIDE 4 | Slot #4 | Hillside | 3889.41 | 980.85 | 11594.36 | 3887.72 | 997.25 | 46.23 | 11783.72 |
| #5-7-29-00-04-NH HILLSIDE 7 | #5-7-29-000-4-NH (PWB) HILLSIDE 7 | Slot #7 | Hillside | 3891.80 | 1013.66 | 9675.07 | 3890.07 | 1013.66 | 124.94 | 11528.75 |
| #7-7-29-00-04-CH HILLSIDE 6 | #7-7-29-000-4-CH (PWB) HILLSIDE 6 | Slot #6 | Hillside | 3896.32 | 980.85 | 11135.05 | 3894.85 | 997.25 | 78.03 | 11783.72 |
| #6-7-29-00-04-CH HILLSIDE 3 | #6-7-29-000-4-CH (PWB) HILLSIDE 3 | Slot #3 | Hillside | 3901.40 | 980.85 | 10371.69 | 3899.71 | 997.25 | 82.59 | 11783.72 |
| #5-7-29-00-04-NH HILLSIDE 2 | #5-7-29-000-4-NH (PWB) HILLSIDE 2 | Slot #2 | Hillside | 3906.55 | 931.64 | 10225.48 | 3904.92 | 948.04 | 90.68 | 11692.79 |
| #5-7-29-00-04-CH CENTER POINT 4 | #5-7-29-000-4-CH (PWB) CENTER POINT 4 | Slot #4 | Center Point | 3913.62 | 931.64 | 9757.09 | 3911.99 | 948.04 | 122.12 | 11643.58 |
| #1-0-33-09-04-NH CENTER POINT 6 | #1-0-33-090-4-NH (PWB) CENTER POINT 6 | Slot #6 | Center Point | 3971.01 | 11783.72 | 11783.72 | 3918.05 | 11783.72 | 74.98 | 11783.72 |
| #1-0-33-09-04-CH CENTER POINT 8 | #1-0-33-090-4-CH (PWB) CENTER POINT 8 | Slot #8 | Center Point | 4141.28 | 11783.72 | 11783.72 | 4087.74 | 11783.72 | 77.35 | 11783.72 |
| #1-0-33-09-04-NH RANCHO WATER VALLEY #2-6-4 | #1-0-33-090-4-NH (PWB) RANCHO WATER VALLEY #2-6-4 (AWB) | Slot #3 | Rancho Water Valley | 4221.12 | 11783.72 | 11783.72 | 4167.78 | 11783.72 | 79.15 | 11783.72 |
| RANCHO WATER VALLEY 9 | RANCHO WATER VALLEY 9 | Slot #9 | Rancho Water Valley | 4289.89 | 11783.72 | 11783.72 | 4244.13 | 11783.72 | 93.76 | 11783.72 |
| #8-7-33-00 | #8-7-33-000-4 | | | 5288.16 | 11783.72 | 11783.72 | 5202.05 | 11783.72 | 61.41 | 11783.72 |

All data is in Feet unless otherwise stated
Coordinates are from Slot MD's are from Rig and TVD's are from Rig (Planned Datum #1 4967.0ft above Mean Sea Level)
Vertical Section is from 0.00N 0.00E on azimuth 101.750 degrees
Prepared by Peterson Energy
Date Printed: 28-Nov-2012



SYSDRILL
Closest Approach + Clearance Factor Summary Report
Wellbore: PAVISTMA 4 #1-6-32-090-4-NH (PWB)
Wellpath: PAVISTMA 4 #1-6-32-090-4-NH (PWP#1)

Clearance Summary

| Offset WellName | Offset Wellbore | Offset Slot | Offset Structure | Separation [ft] | MD[ft] | Diverging From[ft] | Ellipse Separation [ft] | Ellipse MD[ft] | Clearance Factor | Clearance MD[ft] |
|---|--|-------------|------------------------|-----------------|----------|--------------------|-------------------------|----------------|------------------|------------------|
| 0-4-CH RANCHO WATER VALLEY 8 #8-7-33-00 | -CH (PWB) RANCHO WATER VALLEY 8 #8-7-33-00-4 | Slot #8 | Rancho Water Valley | 5387.95 | 11783.72 | 11783.72 | 5345.11 | 11783.72 | 125.76 | 11783.72 |
| 0-4-NH RANCHO WATER VALLEY 2-8-4 | -NH (PWB) RANCHO WATER VALLEY 2-8-4 (AWB) | Slot #2 | Rancho Water Valley | 5449.50 | 11783.72 | 11783.72 | 5423.35 | 11783.72 | 208.40 | 11783.72 |
| RANCHO WATER VALLEY #3-9-4 | RANCHO WATER VALLEY #3-9-4 (AWB) | Slot #1 | Rancho Water Valley | 6124.22 | 11783.72 | 11783.72 | 6085.97 | 11783.72 | 160.12 | 11783.72 |
| DIAMOND VALLEY SW 9-5-22 | DIAMOND VALLEY SW 1 | Slot #1 | Diamond Valley SW | 10239.91 | 11783.72 | 11783.72 | 10136.26 | 11783.72 | 98.80 | 11783.72 |
| DIAMOND VALLEY SW 2 | #3-7-22-270-6 -NH (PWB) DIAMOND VALLEY SW 2 | Slot #2 | Diamond Valley SW | 10411.12 | 11783.72 | 11783.72 | 10307.52 | 11783.72 | 100.49 | 11783.72 |
| DIAMOND VALLEY SW 3 | #3-7-22-270-6 -CH (PWB) DIAMOND VALLEY SW 3 | Slot #3 | Diamond Valley SW | 10570.92 | 11783.72 | 11783.72 | 10467.14 | 11783.72 | 101.86 | 11783.72 |
| DIAMOND VALLEY SW 4 | #3-6-22-270-6 -NH (PWB) DIAMOND VALLEY SW 4 | Slot #4 | Diamond Valley SW | 10898.32 | 11783.72 | 11783.72 | 10794.40 | 11783.72 | 104.87 | 11783.72 |
| DIAMOND VALLEY SW 8-2-22 | #3-6-22-270-6 -NH (PWB) DIAMOND VALLEY SW 5 | Slot #5 | Diamond Valley SW | 11069.83 | 11783.72 | 11783.72 | 10965.93 | 11783.72 | 106.54 | 11783.72 |
| DIAMOND VALLEY SW 6 | #3-6-22-270-6 -CH (PWB) DIAMOND VALLEY SW 6 (PWB) | Slot #6 | Diamond Valley SW | 11229.39 | 11783.72 | 11783.72 | 11125.36 | 11783.72 | 107.94 | 11783.72 |
| DIAMOND VALLEY SW 7 | DIAMOND VALLEY SW 7 | Slot #7 | Diamond Valley SW | 11560.62 | 11783.72 | 11783.72 | 11456.55 | 11783.72 | 111.08 | 11783.72 |
| DIAMOND VALLEY SW 8 | #3-5-22-270-6 -NH (PWB) DIAMOND VALLEY SW 8 | Slot #8 | Diamond Valley SW | 11673.70 | 11783.72 | 11783.72 | 11569.59 | 11783.72 | 112.13 | 11783.72 |
| DIAMOND VALLEY SW 8-2-22 | #3-5-22-270-6 -CH (PWB) DIAMOND VALLEY SW 8-2-22 (PWB) | Slot #5 | Diamond Valley SW | 11714.38 | 11783.72 | 11783.72 | 11642.13 | 11783.72 | 162.12 | 11783.72 |
| DIAMOND VALLEY SW 9 | DIAMOND VALLEY SW 9 | Slot #9 | Diamond Valley SW | 11888.11 | 11783.72 | 11783.72 | 11783.81 | 11783.72 | 113.99 | 11783.72 |
| DIAMOND VALLEY SW 10 | #3-4-22-270-6 -NH (PWB) DIAMOND VALLEY SW 10 | Slot #10 | Diamond Valley SW | 12219.48 | 11783.72 | 11783.72 | 12115.15 | 11783.72 | 117.12 | 11783.72 |
| DIAMOND VALLEY SW 2 | #3-4-22-270-6 -NH (PWB) DIAMOND VALLEY SW 8-4-22 (PWB) | Slot #2 | Diamond Valley SW | 12436.05 | 11783.72 | 11783.72 | 12392.58 | 11783.72 | 286.08 | 11783.72 |
| DIAMOND VALLEY SW 7 | DIAMOND VALLEY SW 7-3-22 (PWB) | Slot #7 | Diamond Valley SW | 12618.77 | 11783.72 | 11783.72 | 12555.07 | 11783.72 | 198.09 | 11783.72 |
| DIAMOND VALLEY SW 8 | DIAMOND VALLEY SW 6-2-22 (PWB) | Slot #8 | Diamond Valley SW | 12801.76 | 11783.72 | 11783.72 | 12719.14 | 11783.72 | 154.95 | 11783.72 |
| DIAMOND VALLEY | DIAMOND VALLEY SW | Slot #10 | Diamond Valley SW | 13443.14 | 11783.72 | 11783.72 | 13389.65 | 11783.72 | 251.35 | 11783.72 |

All data is in Feet unless otherwise stated
Coordinates are from Slot MD's are from Rig and TVD's are from Rig (Planned Datum #1 4967.0ft above Mean Sea Level)
Vertical Section is from 0.00N 0.00E on azimuth 101.750 degrees
Prepared by Peterson Energy
Date Printed: 28-Nov-2012



SYSDRILL
Closest Approach + Clearance Factor Summary Report
Wellbore: PAVISTMA 4 #1-6-32-090-4-NH (PWB)
Wellpath: PAVISTMA 4 #1-6-32-090-4-NH (PWP#1)

Clearance Summary

| Offset WellName | Offset Wellbore | Offset Slot | Offset Structure | Separation [ft] | MD[ft] | Diverging From[ft] | Ellipse Separation [ft] | Ellipse MD[ft] | Clearance Factor | Clearance MD[ft] |
|--------------------|--------------------|----------------|---------------------|--------------------|--------|-----------------------|-------------------------------|-------------------|---------------------|---------------------|
| SW 10 | 6-4-22 (PWB) | | | | | | | | | |