

NW Cor Sec 34
1953 Brass Cap
0.9' High, Steel
Post
Lat: 39.666061
Long: 108.164131

DATE: 08-13-10
DRAWN BY: C.H.
Revised: 11-23-10 C.H.
Revised: 06-08-12 D.R.B.
Revised: 07-10-12 T.B.
Revised: 12-18-12 T.B.

Encana OIL & GAS (USA) INC.
LOCATION DRAWING FOR
WELL PAD SG E34 496
SECTION 34, T4S, R96W, 6th P.M.
SW 1/4 NW 1/4

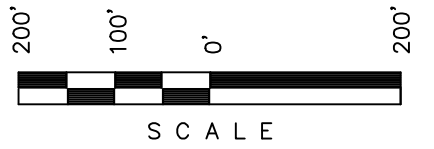

Sheet 6a of 9



CURRENT LAND USE	
CROP LAND:	<input type="checkbox"/> IRRIGATED <input type="checkbox"/> DRY LAND <input type="checkbox"/> IMPROVED PASTURE <input type="checkbox"/> HAY MEADOW <input type="checkbox"/> CRP
NON-CROP LAND:	<input type="checkbox"/> RANGELAND <input type="checkbox"/> TIMBER <input type="checkbox"/> RECREATIONAL <input type="checkbox"/> OTHER (Describe)
SUBDIVIDED:	<input type="checkbox"/> INDUSTRIAL <input type="checkbox"/> COMMERCIAL <input type="checkbox"/> RESIDENTIAL

FUTURE LAND USE	
CROP LAND:	<input type="checkbox"/> IRRIGATED <input type="checkbox"/> DRY LAND <input type="checkbox"/> IMPROVED PASTURE <input type="checkbox"/> HAY MEADOW <input type="checkbox"/> CRP
NON-CROP LAND:	<input type="checkbox"/> RANGELAND <input type="checkbox"/> TIMBER <input type="checkbox"/> RECREATIONAL <input type="checkbox"/> OTHER (Describe)
SUBDIVIDED:	<input type="checkbox"/> INDUSTRIAL <input type="checkbox"/> COMMERCIAL <input type="checkbox"/> RESIDENTIAL

PLANT COMMUNITY	Existing Features	(Distance from CP01B-33)
<input type="checkbox"/> DISTURBED GRASSLAND	Building	N43°E 3.6 Miles
<input type="checkbox"/> NATIVE GRASSLAND	Public Road	S25°E 6.5 Miles
<input type="checkbox"/> SHRUB LAND	Utility	S40°E 4.4 Miles
<input type="checkbox"/> PLAINS RIPARIAN	Railroad	S17°E 13.4 Miles
<input type="checkbox"/> MOUNTAIN RIPARIAN	Property Line	N72°W 2,455'
<input type="checkbox"/> FOREST LAND	Surface Water	S41°W 2,395'
<input type="checkbox"/> WETLANDS AQUATIC		
<input type="checkbox"/> ALPINE		
<input type="checkbox"/> OTHER (Describe):		

ENCANA OIL & GAS
(USA) INC

ENCANA OIL & GAS
(USA) INC

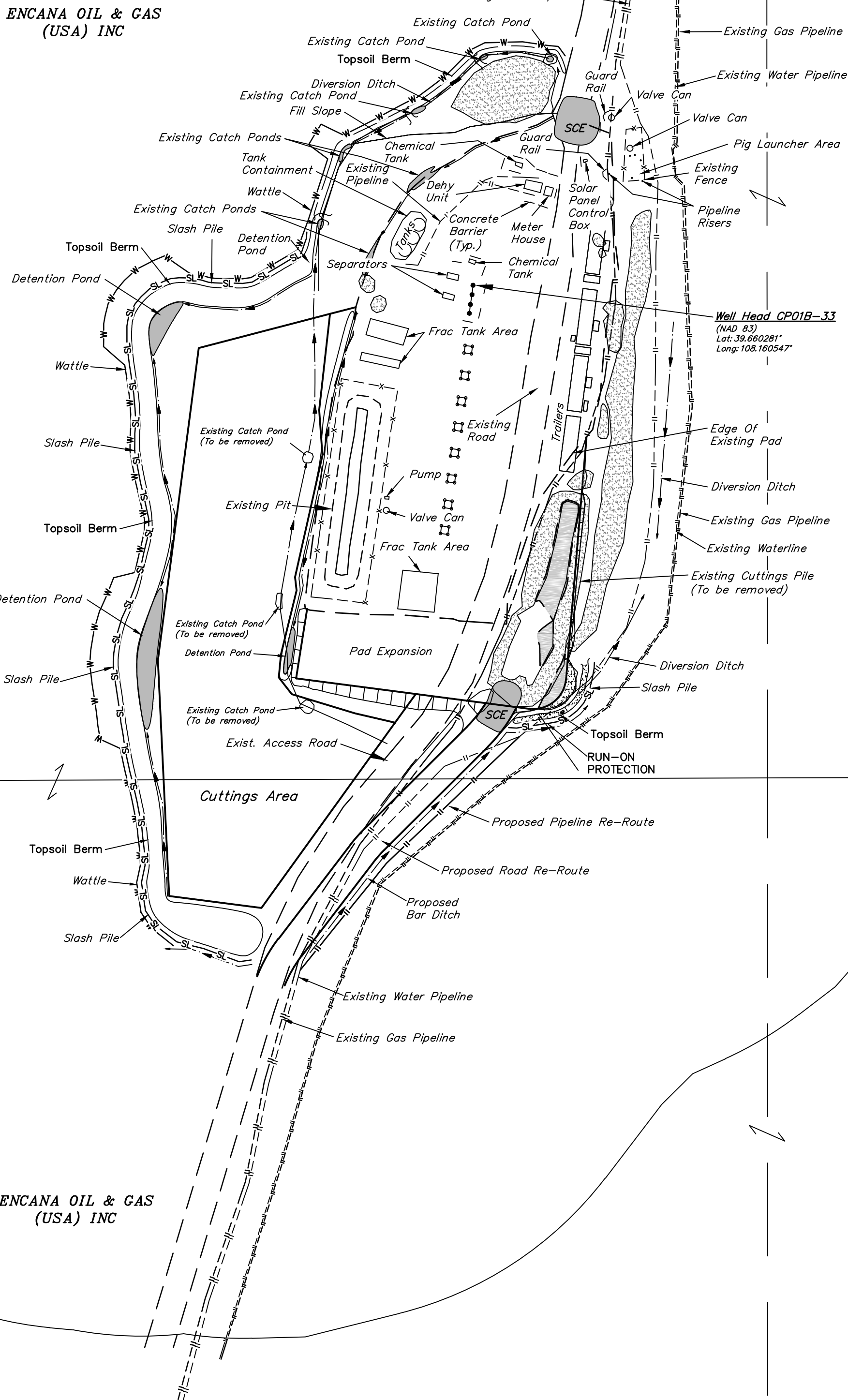

1953 Brass Cap,
0.3' High, Pile of
Stones, Steel Post
Lat: 39.658819
Long: 108.164128

ENCANA OIL & GAS
(USA) INC

ENCANA OIL & GAS
(USA) INC

SW Cor Sec 34
1953 Brass Cap
0.2' High, Pile of
Stones, Steel Post,
E-W Fence Line
Lat: 39.651322
Long: 108.164146