

PRODUCTION FACILITY AS-BUILT

SECTION: 17
TOWNSHIP: 11N
RANGE: 61W

DF RANCH 1161-17-12

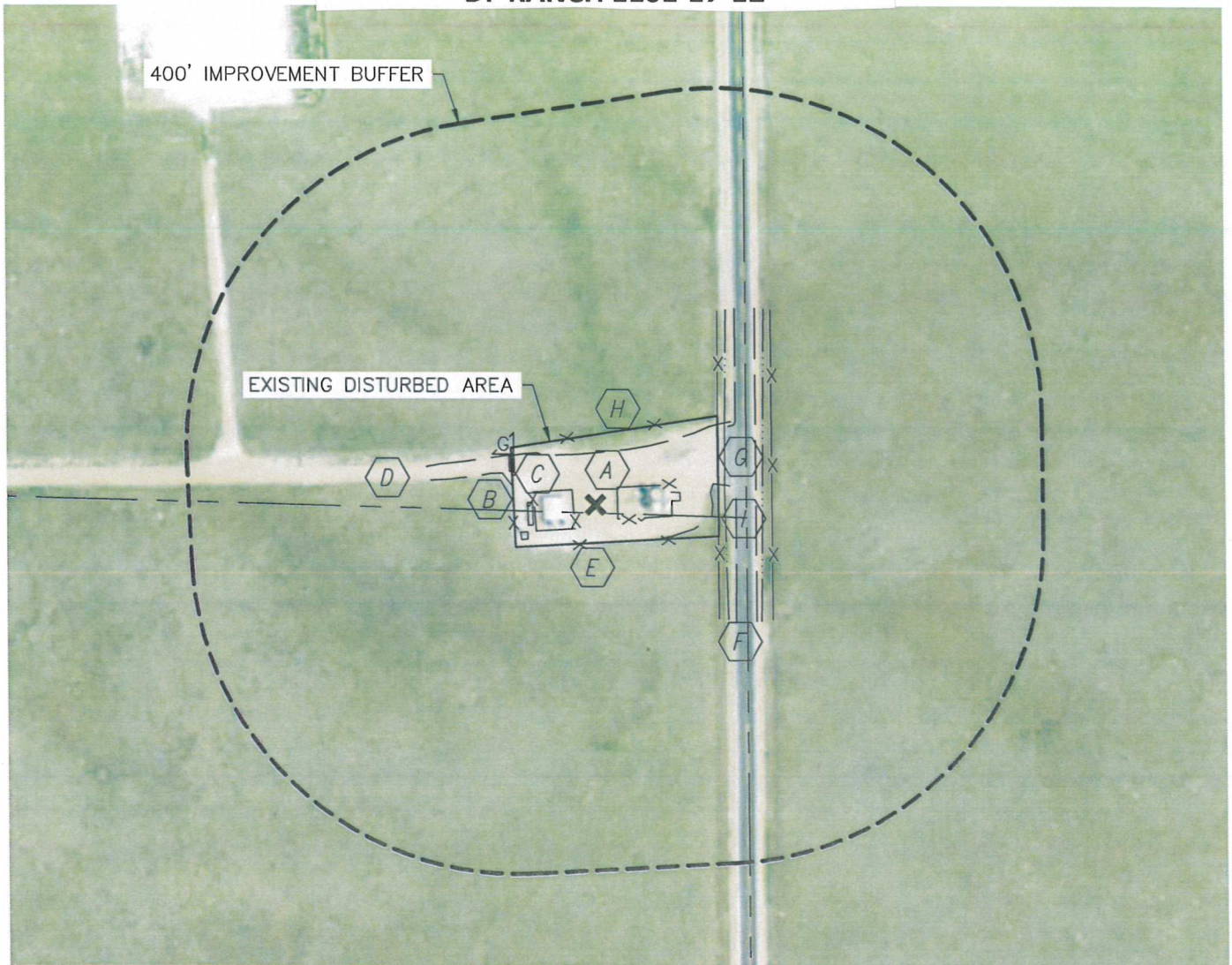

REFERENCE POINT LOCATION:

LAT: 40.92126°N
LONG: 104.22111°W
ELEV: 5328'
PDOP: 1.7
DATE: 11/9/2012
OPERATOR: ADAM KELLY
1/41/4: SE1/4NE1/4
FNL: 2629'
FEL: 186'
DISTANCE TO WELL: ±1845'
ASSOCIATED NEW WELLS:
NONE
ASSOCIATED EXISTING WELLS:
DF RANCH 1161-17-12
DF RANCH 1161-17-42
DF RANCH 17-14

IMPROVEMENTS:

- (A)** EX. PRODUCTION EQUIPMENT (NOBLE) 27' E, 28' & 78' W, 90' SW
- (B)** GAS MARKER 108' NW
- (C)** CATTLE GUARD 108' NW
- (D)** FIELD ROAD 118' NW
- (E)** FENCE 47' S, 85' N, 102' W, 152' & 218' E
- (F)** CR 89 174' E
- (G)** CULVERT 160' NE
- (H)** EDGE OF DISTURBANCE 47' S, 85' N, 102' W, 152' E
- (I)** BARROW DITCH 159' & 206' E

NEAREST: BUILDING 5280'+,
PUBLIC ROAD (CR89) 174' E, ABOVE GROUND UTILITY 1557' SE,
RAILROAD 5280'+, PROPERTY LINE 186' E

LEGEND
X - REFERENCE POINT
ALL DISTANCES ARE APPROXIMATE.

