

T2N, R64W, 6th P.M.

GREAT WESTERN OIL & GAS COMPANY

Well location, LAND JG #31-35D, located as shown in LOT 2 of Section 31, T2N, R64W, 6th P.M., Weld County, Colorado.

### BASIS OF ELEVATION

USGS COOPERATIVE BASE NETWORK CONTROL STATION, DESIGNATION 'HUDSON CC' NGS DATA SHEET LISTS THE NAVD 88 ELEVATION AS BEING 4999 FEET.

### BASIS OF BEARINGS

BASIS OF BEARINGS IS A G.P.S. OBSERVATION.

### LINE TABLE

LINE	DIRECTION	LENGTH
L1	S43°52'19"E	283.12'

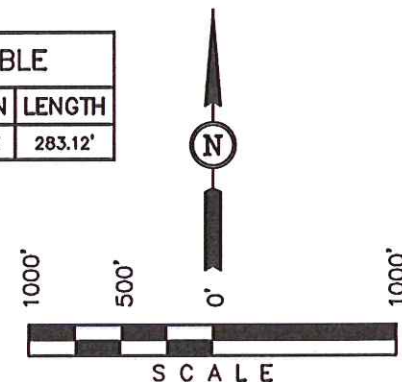

### CERTIFICATE

THIS IS TO CERTIFY THAT THE ABOVE PLAT WAS PREPARED FROM FIELD NOTES OF ACTUAL SURVEYS MADE BY ME OR UNDER MY SUPERVISION AND THAT THE SAME ARE TRUE AND CORRECT TO THE BEST OF MY KNOWLEDGE AND BELIEF.

REGISTERED LAND SURVEYOR  
REGISTRATION NO. 17492  
STATE OF COLORADO

UINTAH ENGINEERING & LAND SURVEYING

85 SOUTH 200 EAST - VERNAL, UTAH 84078

(435) 789-1017

SCALE 1" = 1000'	DATE SURVEYED: 10-18-12	DATE DRAWN: 10-22-12
PARTY Z.B. A.G. J.W.	REFERENCES G.L.O. PLAT	
WEATHER COOL	FILE GREAT WESTERN OIL & GAS COMPANY	

Alum. Cop  
0.5' Below Ground  
LS 23520  
Lat: 40.102328°  
Long: 104.584228°

NOTE:  
SEE ADDENDUM TO LEGAL PLAT FOR  
EXISTING IMPROVEMENTS WITHIN 400'  
OF THE PROPOSED DISTURBANCE.

Alum. Cop  
0.7' Below Ground  
LS 33642  
Lat: 40.094908°  
Long: 104.593792°

Alum. Cop  
0.5' Below Ground  
LS 23520, In Mon. Box  
Lat: 40.095014°  
Long: 104.584339°

Alum. Cop  
0.7' Below Ground  
LS 23520 In Mon. Box  
Lat: 40.087728°  
Long: 104.584453°

Alum. Cop  
1.5' Below Ground  
LS 25937  
Lat: 40.087567°  
Long: 104.593919°

Alum. Cop  
0.2' Below Ground  
LS 25937  
Lat: 40.087417°  
Long: 104.602675°

### LEGEND:

- └ = 90° SYMBOL
- = PROPOSED WELL HEAD.
- ▲ = SECTION CORNERS LOCATED.

NAD 83 (TARGET BOTTOM HOLE)	NAD 83 (SURFACE LOCATION)
LATITUDE = 40°05'14.95" (40.087486)	LATITUDE = 40°05'16.97" (40.088047)
LONGITUDE = 104°35'55.15" (104.598653)	LONGITUDE = 104°35'57.67" (104.599353)
NAD 27 (TARGET BOTTOM HOLE)	NAD 27 (SURFACE LOCATION)
LATITUDE = 40°05'15.01" (40.087503)	LATITUDE = 40°05'17.03" (40.088064)
LONGITUDE = 104°35'53.29" (104.598136)	LONGITUDE = 104°35'55.81" (104.598836)

PDOP = 1.8

N00°03'45"E - 2691.88' (Meas.)

N00°07'03"E - 2692.98' (Meas.)

S89°26'19"W - 2509.68' (Meas.)

S89°26'30"W - 2640.46' (Meas.)

LOT 1

S89°07'51"W - 2478.79' (Meas.)

S89°07'33"W - 2644.80' (Meas.)

LOT 2

LAND JG #31-35D  
Elev. Ungraded  
Ground = 4933'

N00°43'41"E  
2674.65' (Meas.)

N00°38'30"E - 2664.42' (Meas.)

N00°38'17"E - 2654.20' (Meas.)

N00°43'38"E - 2679.09' (Meas.)

S88°41'11"W - 2649.62' (Meas.)

S88°41'15"W  
2450.68' (Meas.)

Target Bottom Hole  
0' FSL  
1126' FWL

209'

929'