

# LOCATION DRAWING

**VEGETATION:**  
STUBBLE

**SURFACE USE:**  
AGRICULTURAL

## REFERENCE POINT

LATITUDE: 40.59648
LONGITUDE: -104.30212
FOOTAGE: 251 FSL 1308 FEL
GROUND ELEVATION: 4889.6
PDOP: 1.7 DATE: 11/26/2012
INSTRUMENT OPERATOR: MARC WOODARD

SE1/4 SE1/4  
SW1/4 SE1/4

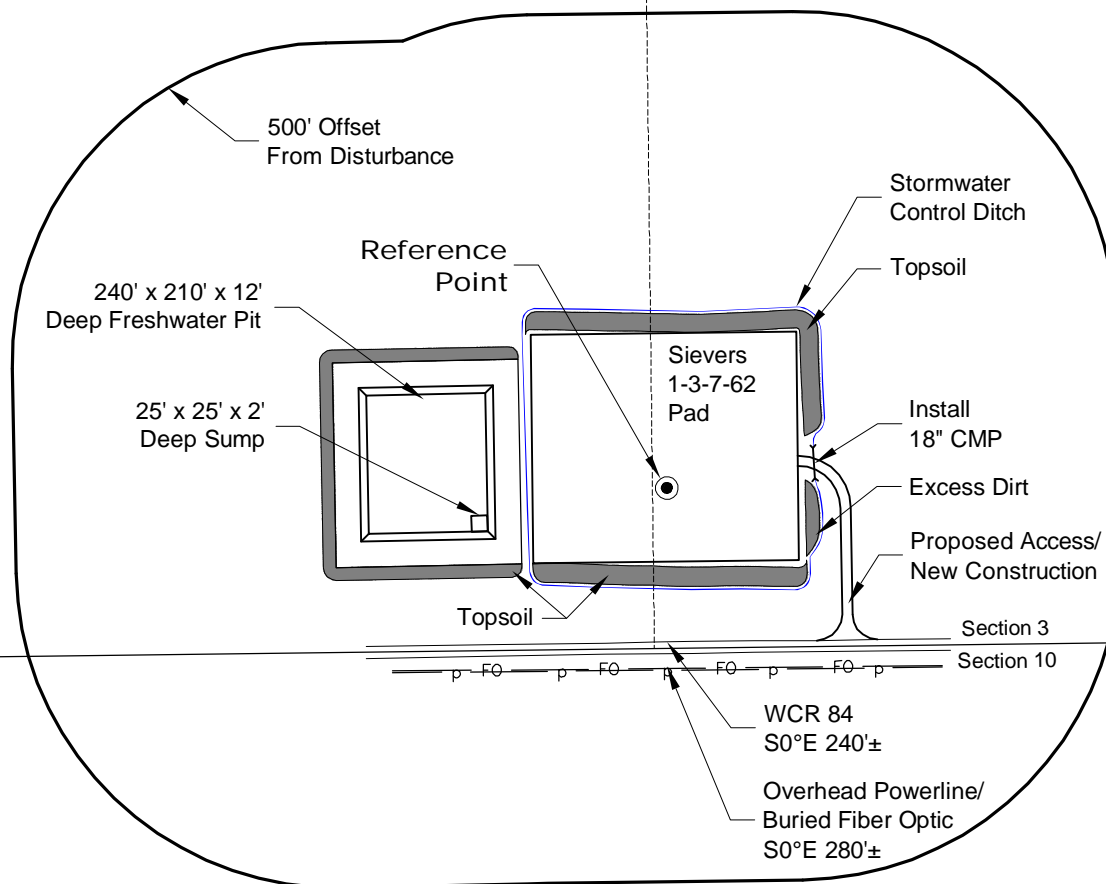

### NOTE-DISTANCE TO NEAREST:

Property Line - S 251'  
Public Road - WCR 84 - S 240'±  
Building - House S84°E 1350'±  
Railroad - S30°W 18 Miles  
Powerline - S 280'±

**DISTURBANCE ACREAGE:**  
4.8± DRILLING OPERATIONS  
2.3± FRESHWATER STORAGE PIT  
1.0± INTERIM RECLAIM

**NOTE:**  
ALL PRODUCTION FACILITIES WILL BE ON PAD.

11/29/12



North

0 300 600  
Graphic Scale in Feet  
1" = 300'



**LAND SURVEYING AND MAPPING**  
**LAFAYETTE - WINTER PARK**  
Ph 303 666 0379 Fx 303 665 6320

**CARRIZO NIOBRARA LLC**  
**SIEVERS 1-3-7-62 PAD**

**SE1/4 SE1/4 SECTION 3 T7N R62W**  
**6th PM WELD COUNTY COLORADO**