

**SWEPI LP**  
**CONSTRUCTION LAYOUT FOR**  
**ILES MOUNTAIN #1-36**  
**SECTION 36, T5N, R92W, 6th. P.M.**  
**2336' FSL 2146' FEL**

**FIGURE #1**

SCALE: 1" = 60'  
DATE: 03-08-11  
DRAWN BY: J.I.  
REVISED: 06-13-12 H.K.W.  
REVISED: 07-20-12 H.K.W.  
REVISED: 07-25-12 H.K.W.

NOTE:  
Earthwork Calculations Require a  
Fill of 2.4' @ the Location Stake.  
All Fill is to be Compacted to a  
Minimum of 95% of the Maximum  
Dry Density Obtained by AASHTO  
Method t-99.

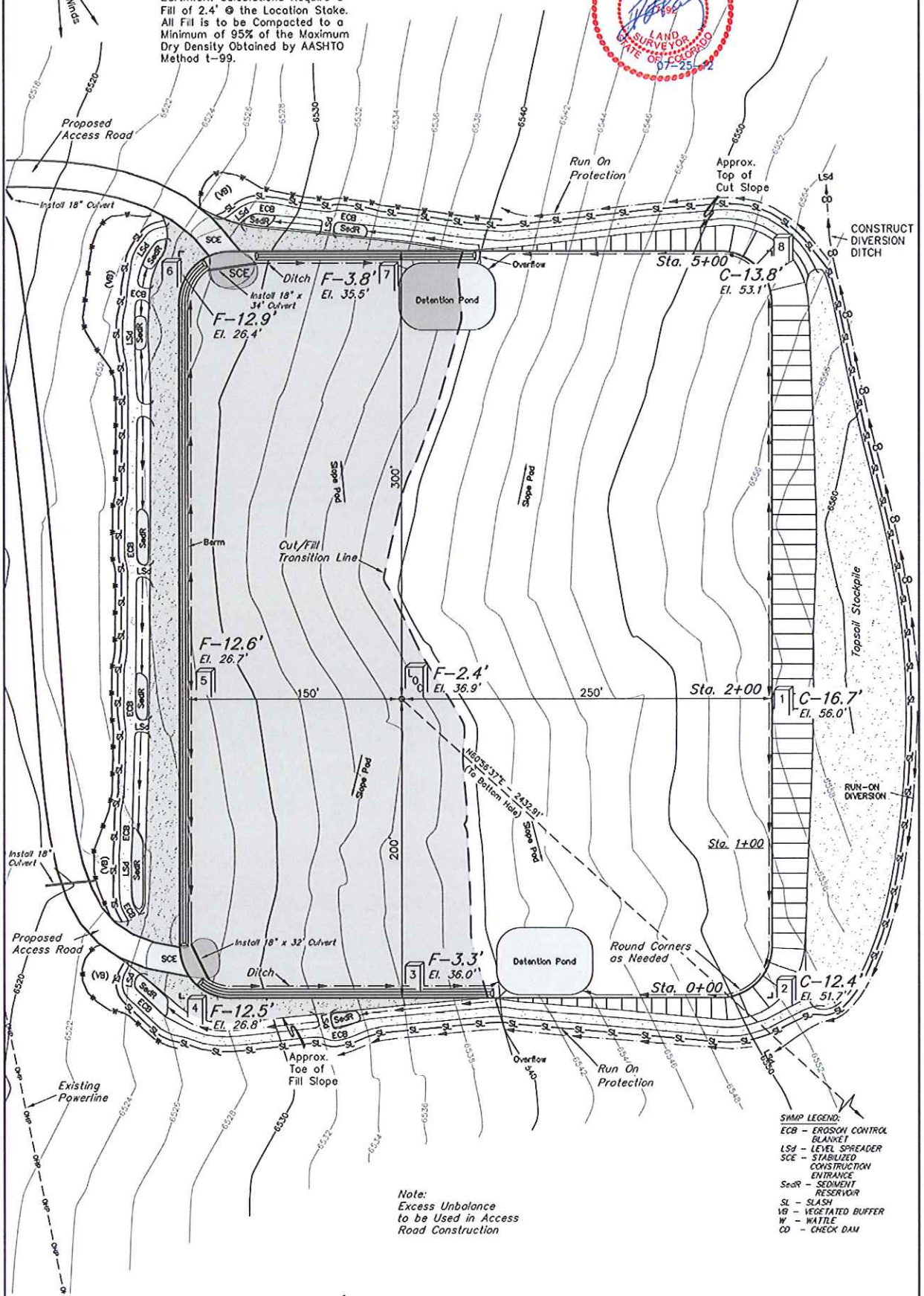

- SYMBOL LEGEND:**
- ECB - EROSION CONTROL BLANKET
  - LSd - LEVEL SPREADER
  - SCE - STABILIZED CONSTRUCTION ENTRANCE
  - SedR - SEDIMENT RESERVOIR
  - SL - SLASH
  - VB - VEGETATED BUFFER
  - W - WATTLE
  - CD - CHECK DAM

Note:  
Excess Unbalance  
to be Used in Access  
Road Construction

Elev. Ungraded Ground At #1-19 Loc. Stake = 6536.9'  
FINISHED GRADE ELEV. AT #1-19 LOC. STAKE = 6539.3'

1" = 40'  
X-Section  
Scale  
1" = 100'  
DATE: 03-08-11  
DRAWN BY: J.I.  
REVISED: 06-13-12 H.K.W.  
REVISED: 07-20-12 H.K.W.

SWEPI LP  
CONSTRUCTION LAYOUT CROSS SECTIONS FOR  
ILES MOUNTAIN #1-36  
SECTION 36, T5N, R92W, 6th. P.M.  
2336' FSL 2146' FEL

FIGURE #2

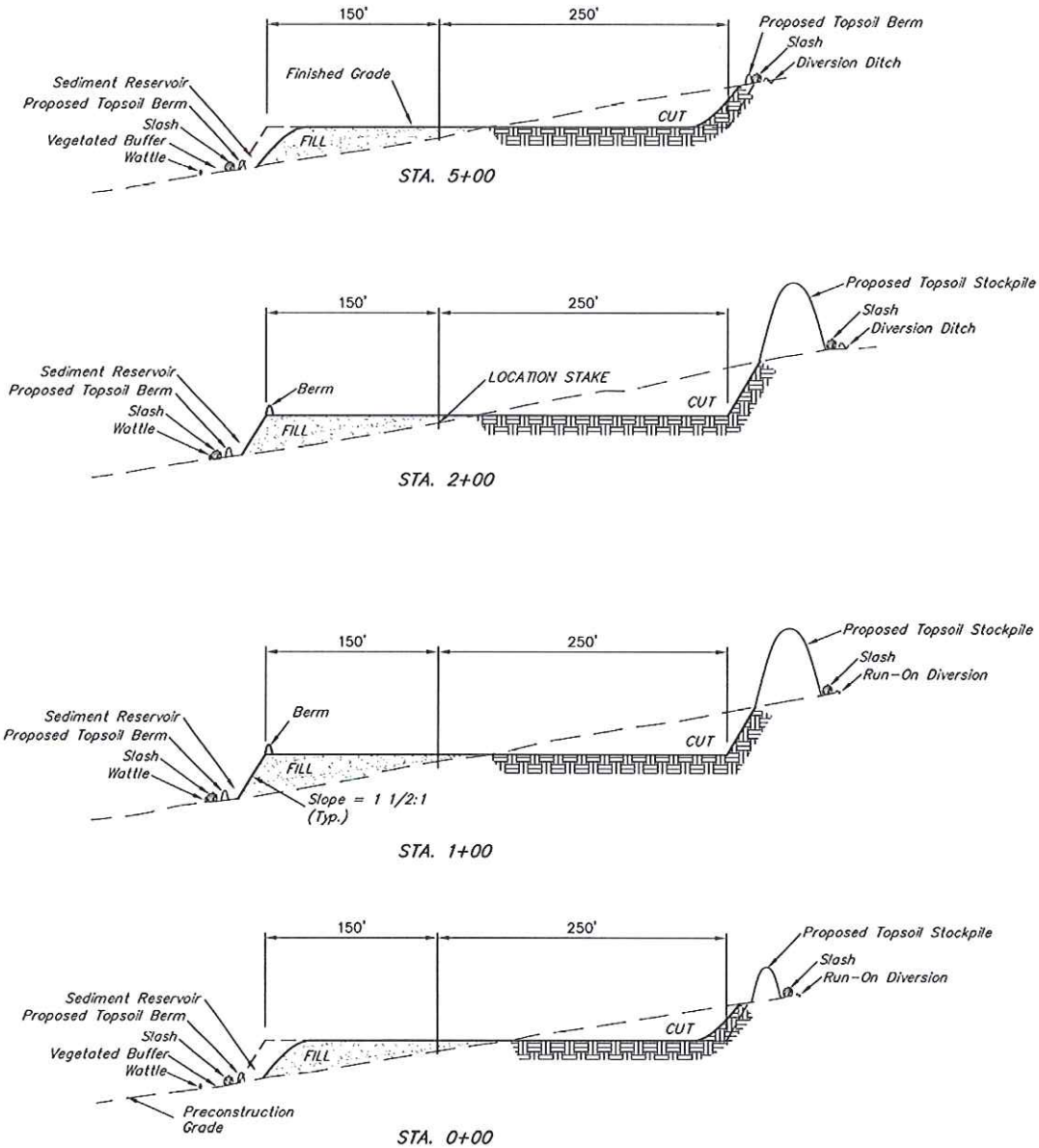

\* NOTE:  
FILL QUANTITY INCLUDES  
5% FOR COMPACTION

Note:  
Excess Unbalance  
to be Used in Access  
Road Construction

APPROXIMATE YARDAGES

(6") Topsoil Stripping = 4,290 Cu. Yds.  
Remaining Location = 35,560 Cu. Yds.  
TOTAL CUT = 39,850 CU. YDS.  
FILL = 26,660 CU. YDS.

EXCESS MATERIAL = 13,190 Cu. Yds.  
Topsoil = 4,290 Cu. Yds.

EXCESS UNBALANCE = 8,900 Cu. Yds.  
(After Interim Rehabilitation)

APPROXIMATE ACREAGES

WELL SITE DISTURBANCE = ± 6.032 ACRES  
ACCESS ROAD DISTURBANCE = ± 0.693 ACRES  
TOTAL = ± 6.725 ACRES

UINTAH ENGINEERING & LAND SURVEYING  
85 So. 200 East • Vernal, Utah 84078 • (435) 789-1017