

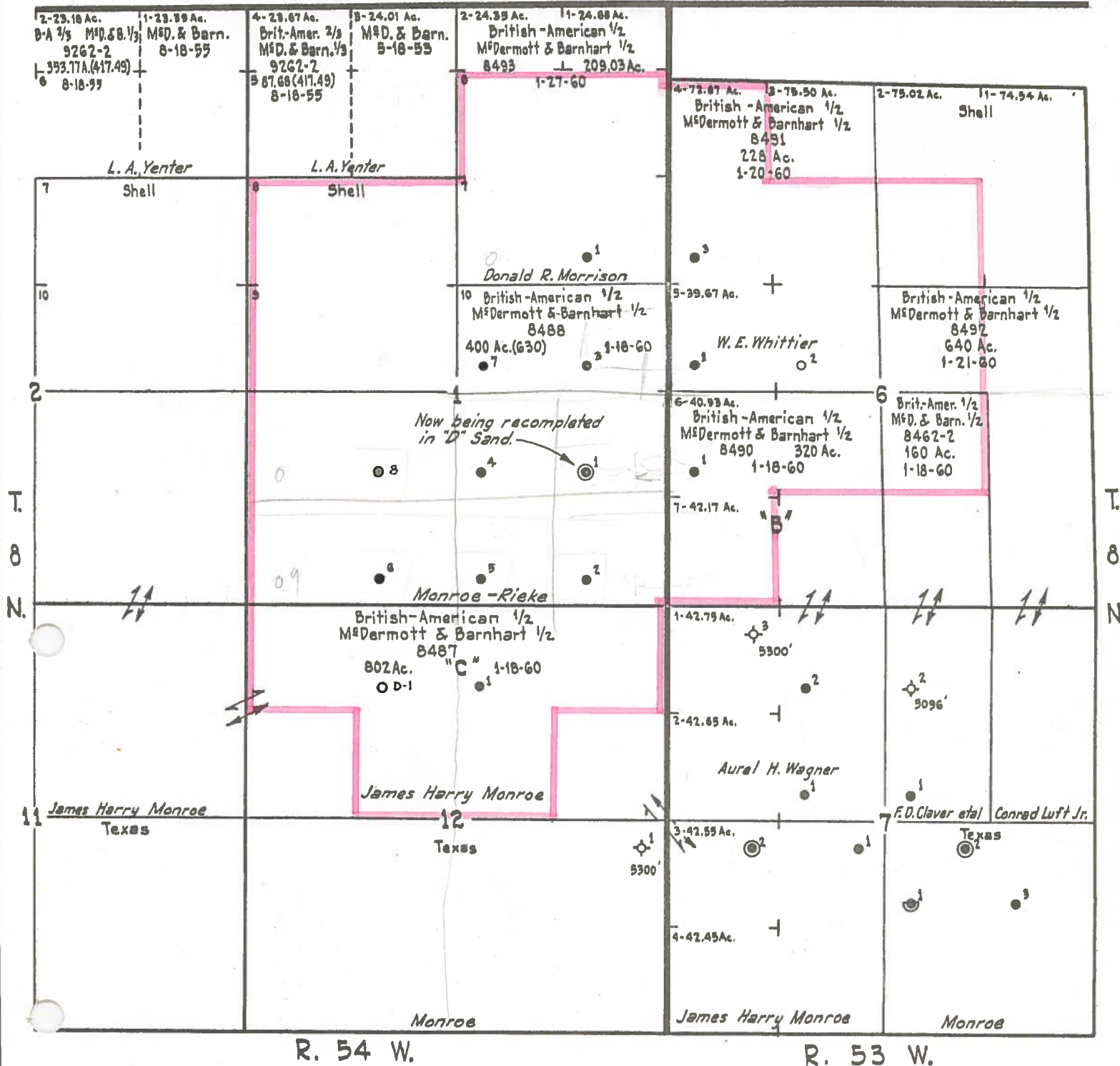

R. 54 W.

R. 53 W.



SCALE



PRODUCING ZONES:

- "D" SAND
- ⊙ "J" SAND
- ⊕ DUAL COMPLETION "D" & "J" SANDS

NORTH WEST GRAYLIN AREA
LOGAN COUNTY, COLORADO

EXHIBIT "A"