

# Reference Area Map

## SMITH 26-22

SE¼ NW¼ SECTION 26, TOWNSHIP 10 NORTH, RANGE 61 WEST OF THE 6TH PRINCIPAL MERIDIAN

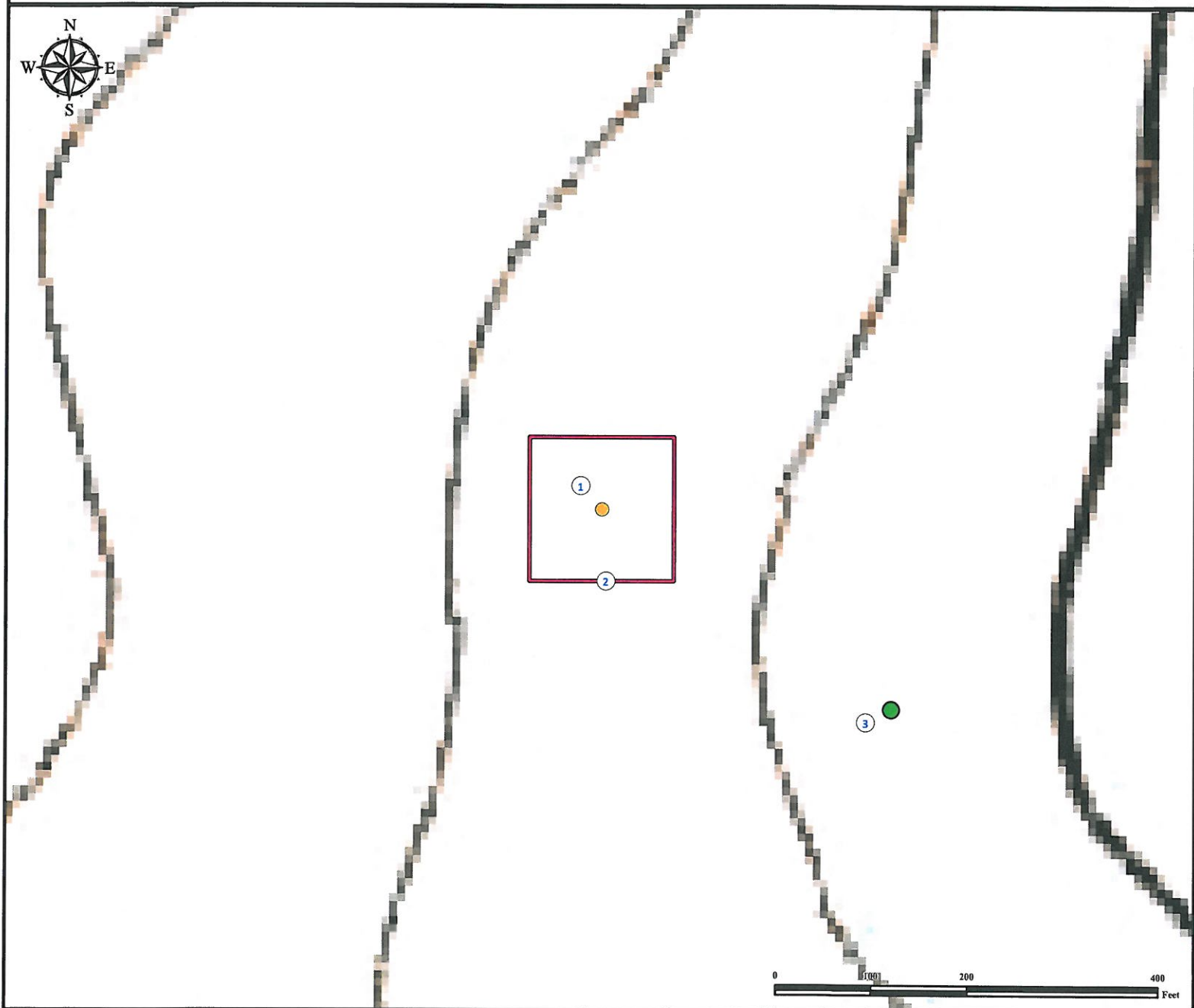

1. Proposed Well SMITH 26-22.

2. Operational Disturbance Area.

3. Reference Photo Point.

### Legend



Proposed Well



Reference Photo Point



Disturbance Area

### Reference Location

\*\* All Measurements are Made from  
Reference Photo Point \*\*

Lat: 40.807428° Long: -104.173307° (NAD83)  
Elevation: 5097 Feet

Surface Use: Rangeland



Use our resources to find yours!

[www.petro-fs.com](http://www.petro-fs.com)

(303) 928-7128

Field Date: 07/23/2012  
Drafting Date: 07/27/2012  
Drafter: DLR  
Revision: 1

Data Sources:

- Topo courtesy of USGS

Prepared for:

