

Lat40°, Inc. 1635 Foxtrail Drive, Suite 325 Loveland, CO 970-776-3321

PRODUCTION FACILITY HYDROLOGY MAP

SAUER F33-76-1HN TANK

SECTION: 33
TOWNSHIP: 5N
RANGE: 65W

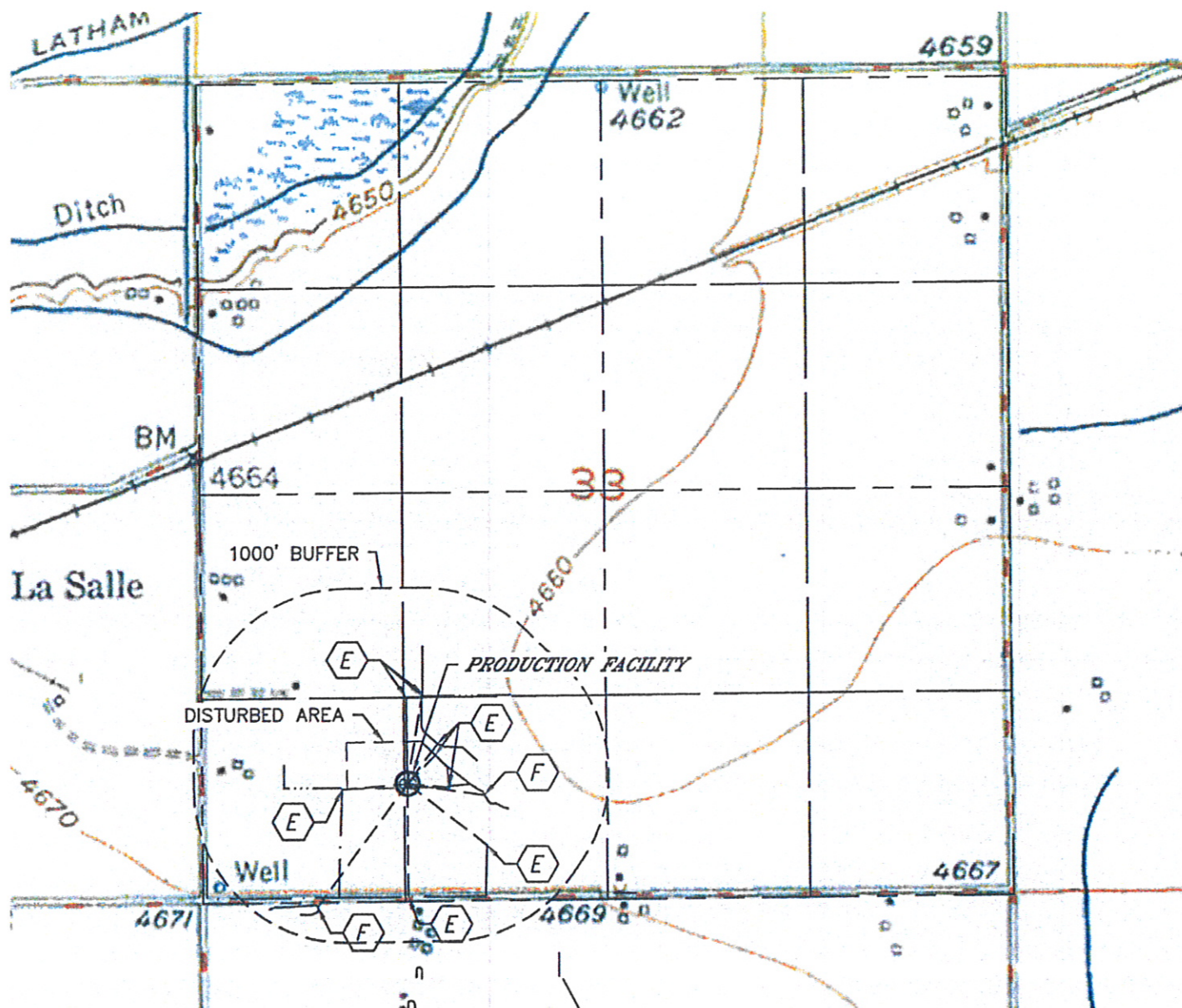

- E** DITCH 260' NE, 274' E, 325' NE, 430' W,
562' N, 580' & 595' NE, 657' SE, 733' S
- F** POND 507' E, 992' SW

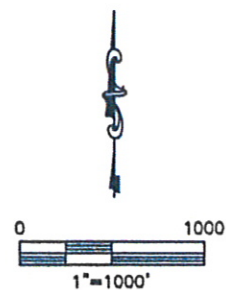

DATE: rev11/13/2012
PROJECT#: 2011334