

# Location Drawing

## DCP 37N-17HZ

### Horizontal Multi Well Pad

NW¼ SE¼ SECTION 8, TOWNSHIP 3 NORTH, RANGE 66 WEST OF THE 6TH PRINCIPAL MERIDIAN

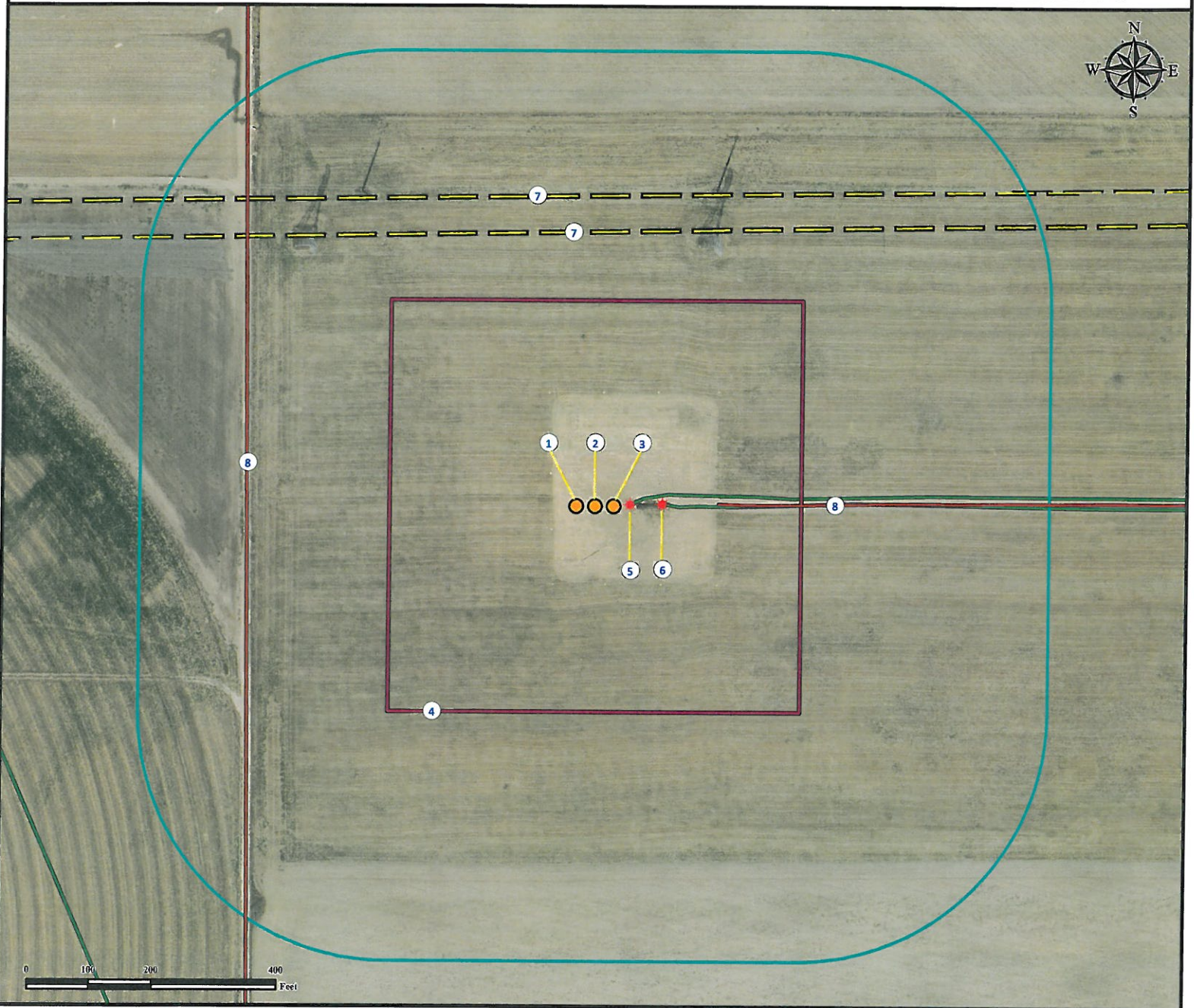

1. Proposed well DCP 15N-17HZ.

4. Operational disturbance area.

7. Transmission lines are  $\pm 442'$  N and  $\pm 500'$  N.

2. Proposed well DCP 37C-17HZ.

5. Existing well DEVON 25-8 is  $\pm 30'$  E.

8. Private roads are  $\pm 147'$  E and  $\pm 592'$  W.

3. Proposed well DCP 37N-17HZ.

6. Existing well HSR-OSTERMILLER 10-8A is  $\pm 79'$  E.

#### Legend

○ Proposed Well

□ Disturbance Area

— Powerline

★ Existing Well

□ 400' Radius

— Private Road

— Underground Pipeline

#### Reference Location

\*\* All Measurements are Made from Reference Well DCP 37N-17HZ\*\*

Lat: 40.237498° Long: -104.799289° (NAD83)  
Elevation: 4869 Feet

Surface Use: Dryland Crop



Use our resources to find yours!  
[www.petro-fs.com](http://www.petro-fs.com)  
(303) 928-7128

Field Date: 02/24/2012  
Drafting Date: 03/05/2012  
Drafter: DMM  
Checked By: BHF

#### Data Sources:

- Aerial courtesy of ANADARKO PETROLEUM CORPORATION

Prepared for:



KERR-MCGEE OIL & GAS ONSHORE LP