



Lat40°, Inc. 1635 Foxtrail Drive, Suite 325 Loveland, CO 970-776-3321

CUT & FILL DIAGRAM

STATE HONE 16-1

SECTION: 16
TOWNSHIP: 2S
RANGE: 55W

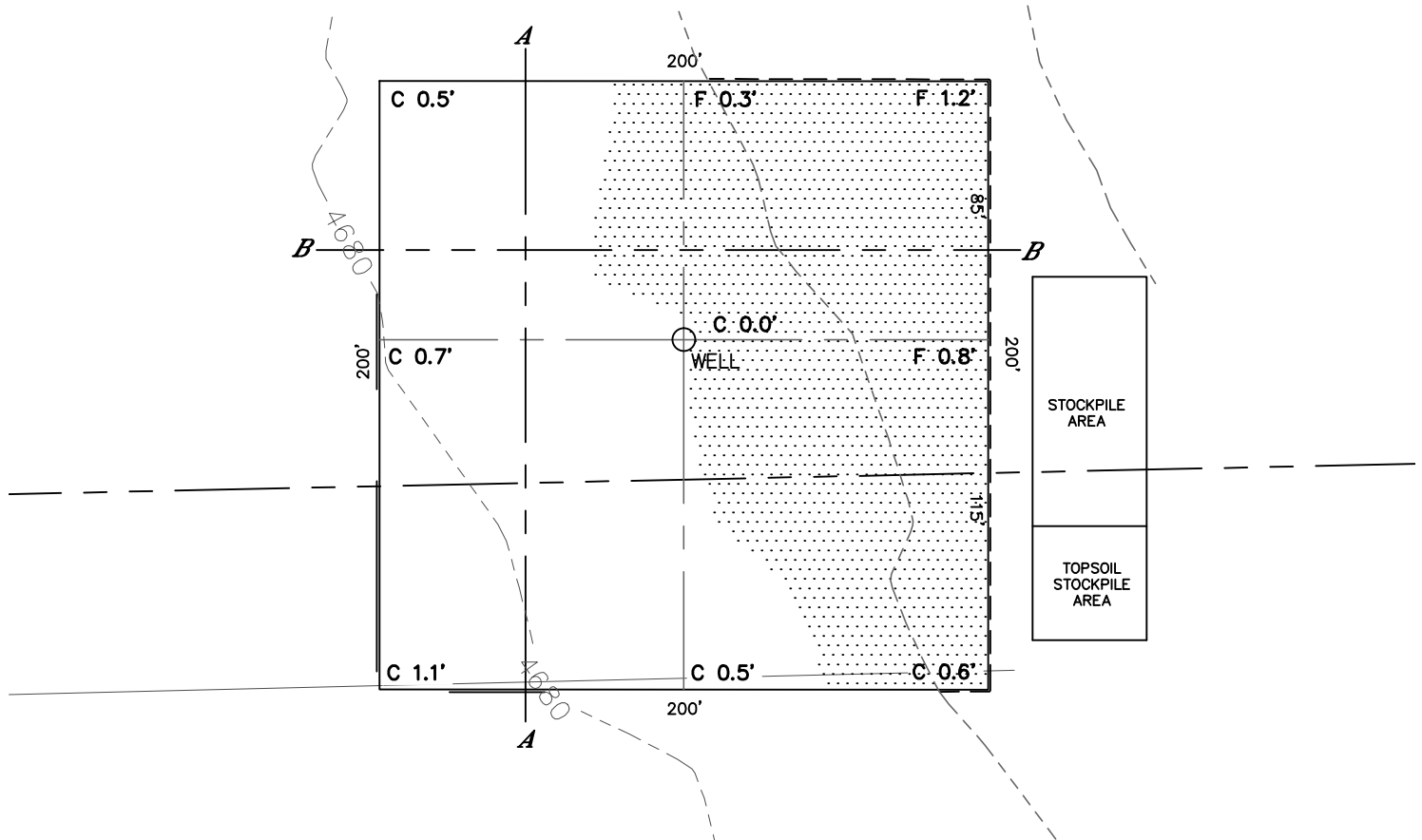

OPERATOR: OVERLAND RESOURCES, LLC
LOCATION: 2600 FNL, 600 FWL
EXISTING ELEV=4679.4'
PROPOSED ELEV=4679.4'
DISTURBANCE= 0.9 ACRES

ESTIMATED EARTHWORK:
TOPSOIL= 1,514 CY
CUT= 295 CY
FILL= 285 CY
STOCKPILE:
EXCESS= 10 CY

NOTE:

- 1) Ground elevations are based on an observed GPS elevation (NAVD 1988 DATUM).
- 2) No allowance has been made for soil expansion or compaction.
- 3) Proposed elevation does not account for top soil removal.
- 4) Top soil volume assumes 12" depth across entire location.
- 5) Fill slopes 2:1
- 6) Cut slopes 1.5:1

LEGEND

EX. CONTOUR	---
PRO. CONTOUR	---
FILL AREA	

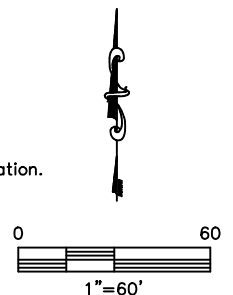

DATE: 11-9-12
PROJECT#: 2012153



Lat40°, Inc. 1635 Foxtrail Drive, Suite 325 Loveland, CO 970-776-3321

CROSS SECTION DIAGRAM

STATE HONE 16-1

SECTION: 16
TOWNSHIP: 2S
RANGE: 55W

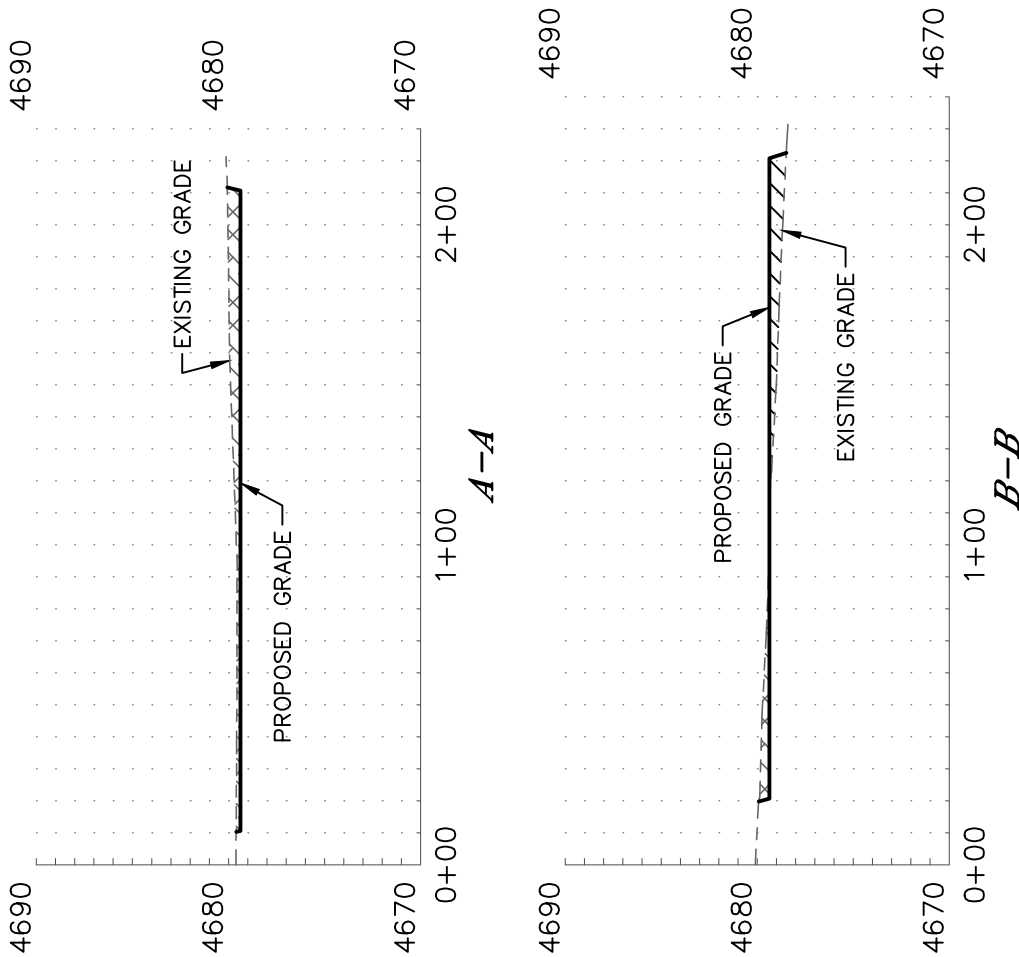

HORIZONTAL SCALE: 1"=60', VERTICAL SCALE: 1"=20'