

Well Name: **Latham 42-1**

Surface Location: Latham 43-1 Pad Sec.1-T4N-R63W
 North American Datum 1983 US State Plane 1983 Colorado Northern Zone

Ground Elevation: 4545.0									
+N/-S	+E/-W	Northing	Easting	Latitude	Longitude	Slot			
0.0	0.0	1368525.62	3312251.43	40.339590	-104.379820				
Original Well Elev		WELL @ 4560.0ft (Original Well Elev)							

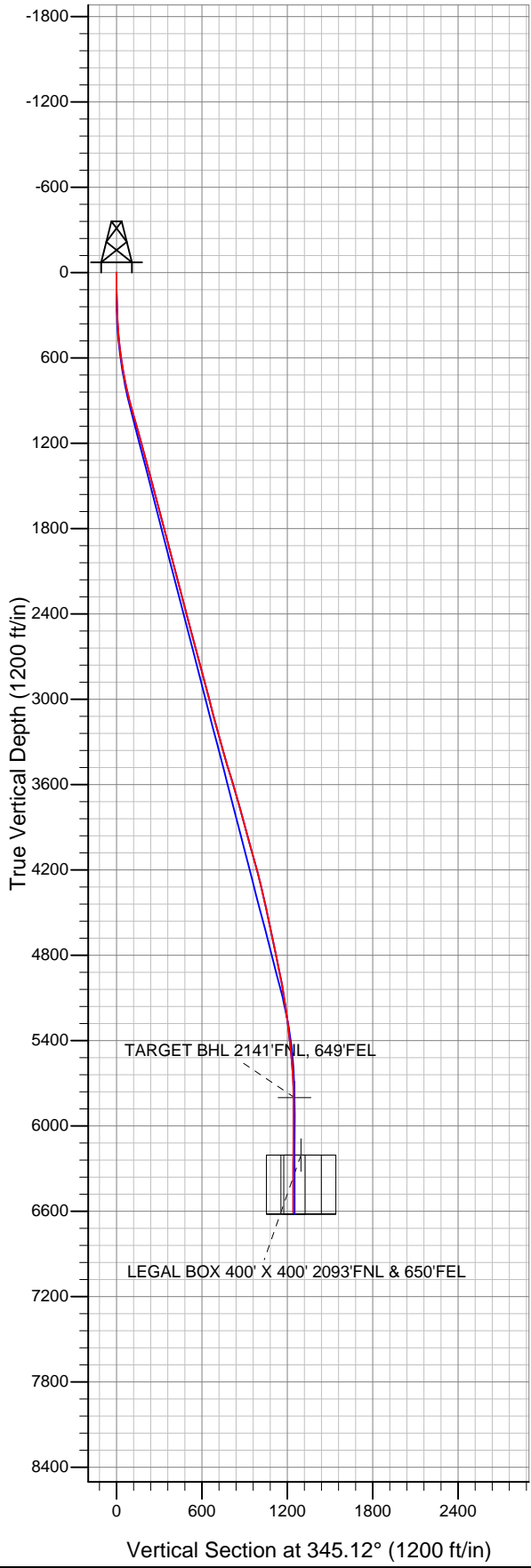

BONANZA CREEK ENERGY OPERATING

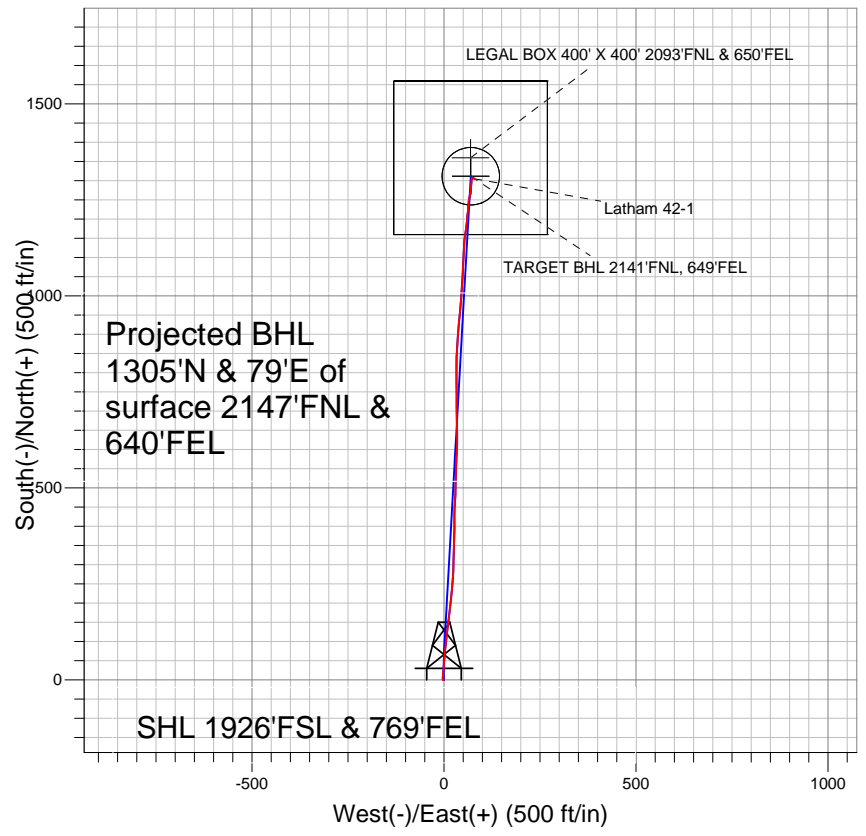

LEGEND

- ◆ Latham 42-1, Wellbore #1, Plan #1 (7-17-12) R V0
- Wellbore #1
- Survey #1

Final Survey Plot

Projected Final Survey -
 6778'MD & 6611'TVD @ 1308'VS
 0.4 deg Inc 86.8 deg AZ

Project: SEC.1-T4N-R63W
 Site: Latham 43-1 Pad Sec.1-T4N-R63W
 Well: Latham 42-1
 Plan: Wellbore #1



Directional

BONANZA CREEK ENERGY OPERATING

SEC.1-T4N-R63W

Latham 43-1 Pad Sec.1-T4N-R63W

Latham 42-1

Wellbore #1

Survey: Survey #1

Standard Survey Report

22 August, 2012

Company:	BONANZA CREEK ENERGY OPERATING	Local Co-ordinate Reference:	Well Latham 42-1
Project:	SEC.1-T4N-R63W	TVD Reference:	WELL @ 4560.0ft (Original Well Elev)
Site:	Latham 43-1 Pad Sec.1-T4N-R63W	MD Reference:	WELL @ 4560.0ft (Original Well Elev)
Well:	Latham 42-1	North Reference:	True
Wellbore:	Wellbore #1	Survey Calculation Method:	Minimum Curvature
Design:	Wellbore #1	Database:	Landmark

Project	SEC.1-T4N-R63W, Weld County, Colorado		
Map System:	US State Plane 1983	System Datum:	Mean Sea Level
Geo Datum:	North American Datum 1983		Using Well Reference Point
Map Zone:	Colorado Northern Zone		Using geodetic scale factor

Site	Latham 43-1 Pad Sec.1-T4N-R63W				
Site Position:		Northing:	1,368,529.49 ft	Latitude:	40.339600
From:	Lat/Long	Easting:	3,312,268.11 ft	Longitude:	-104.379760
Position Uncertainty:	0.0 ft	Slot Radius:	"	Grid Convergence:	0.72 °

Well	Latham 42-1					
Well Position	+N/-S	0.0 ft	Northing:	1,368,525.62 ft	Latitude:	40.339590
	+E/-W	0.0 ft	Easting:	3,312,251.43 ft	Longitude:	-104.379820
Position Uncertainty		0.0 ft	Wellhead Elevation:	ft	Ground Level:	4,545.0 ft

Wellbore	Wellbore #1				
Magnetics	Model Name	Sample Date	Declination (°)	Dip Angle (°)	Field Strength (nT)
	IGRF2010	7/17/2012	8.50	67.03	53,028

Design	Wellbore #1				
Audit Notes:					
Version:	1.0	Phase:	ACTUAL	Tie On Depth:	0.0
Vertical Section:	Depth From (TVD) (ft)	+N/-S (ft)	+E/-W (ft)	Direction (°)	
	0.0	0.0	0.0	345.12	

Survey Program	Date	8/22/2012			
From (ft)	To (ft)	Survey (Wellbore)	Tool Name	Description	
122.0	6,778.0	Survey #1 (Wellbore #1)	MWD	MWD - Standard	

Survey										
Measured Depth (ft)	Inclination (°)	Azimuth (°)	Vertical Depth (ft)	+N/-S (ft)	+E/-W (ft)	Vertical Section (ft)	Dogleg Rate (°/100ft)	Build Rate (°/100ft)	Turn Rate (°/100ft)	
0.0	0.00	0.00	0.0	0.0	0.0	0.0	0.00	0.00	0.00	
122.0	1.60	268.00	122.0	-0.1	-1.7	0.4	1.31	1.31	0.00	
207.0	1.30	340.10	207.0	0.8	-3.2	1.6	2.03	-0.35	84.82	
301.0	2.80	6.80	300.9	4.1	-3.3	4.8	1.85	1.60	28.40	
399.0	4.50	4.30	398.7	10.3	-2.7	10.7	1.74	1.73	-2.55	
457.0	5.10	4.30	456.5	15.1	-2.4	15.2	1.03	1.03	0.00	
579.0	7.90	5.20	577.7	28.9	-1.2	28.2	2.30	2.30	0.74	
702.0	10.80	5.00	699.1	48.8	0.6	47.0	2.36	2.36	-0.16	
827.0	13.40	4.00	821.3	74.9	2.6	71.7	2.09	2.08	-0.80	
952.0	16.40	7.10	942.1	106.9	5.8	101.8	2.48	2.40	2.48	
1,077.0	17.10	7.50	1,061.7	142.6	10.4	135.2	0.57	0.56	0.32	
1,202.0	16.10	6.10	1,181.5	178.1	14.6	168.4	0.86	-0.80	-1.12	
1,326.0	15.70	6.20	1,300.8	211.9	18.2	200.1	0.32	-0.32	0.08	

Company:	BONANZA CREEK ENERGY OPERATING	Local Co-ordinate Reference:	Well Latham 42-1
Project:	SEC.1-T4N-R63W	TVD Reference:	WELL @ 4560.0ft (Original Well Elev)
Site:	Latham 43-1 Pad Sec.1-T4N-R63W	MD Reference:	WELL @ 4560.0ft (Original Well Elev)
Well:	Latham 42-1	North Reference:	True
Wellbore:	Wellbore #1	Survey Calculation Method:	Minimum Curvature
Design:	Wellbore #1	Database:	Landmark

Survey

Measured Depth (ft)	Inclination (°)	Azimuth (°)	Vertical Depth (ft)	+N/-S (ft)	+E/-W (ft)	Vertical Section (ft)	Dogleg Rate (°/100ft)	Build Rate (°/100ft)	Turn Rate (°/100ft)
1,451.0	16.40	4.80	1,420.9	246.3	21.6	232.5	0.64	0.56	-1.12
1,576.0	15.70	2.60	1,541.0	280.7	23.8	265.2	0.74	-0.56	-1.76
1,701.0	15.90	1.70	1,661.3	314.7	25.1	297.8	0.25	0.16	-0.72
1,826.0	15.30	1.50	1,781.7	348.3	26.0	330.0	0.48	-0.48	-0.16
1,950.0	15.70	1.70	1,901.2	381.5	26.9	361.8	0.33	0.32	0.16
2,076.0	14.90	358.30	2,022.7	414.7	27.0	393.9	0.95	-0.63	-2.70
2,201.0	15.00	3.60	2,143.5	446.9	27.5	424.9	1.10	0.08	4.24
2,326.0	15.30	3.40	2,264.2	479.5	29.5	455.9	0.24	0.24	-0.16
2,449.0	14.70	0.40	2,383.0	511.3	30.6	486.3	0.80	-0.49	-2.44
2,573.0	15.10	1.30	2,502.8	543.2	31.0	517.0	0.37	0.32	0.73
2,697.0	16.90	3.10	2,622.0	577.4	32.4	549.7	1.51	1.45	1.45
2,823.0	15.70	1.10	2,742.9	612.7	33.7	583.5	1.05	-0.95	-1.59
2,948.0	15.00	359.00	2,863.5	645.8	33.7	615.5	0.72	-0.56	-1.68
3,072.0	14.90	359.90	2,983.3	677.8	33.4	646.5	0.20	-0.08	0.73
3,198.0	15.20	358.90	3,105.0	710.5	33.1	678.2	0.31	0.24	-0.79
3,323.0	15.80	359.90	3,225.4	743.9	32.7	710.5	0.53	0.48	0.80
3,448.0	15.70	359.90	3,345.7	777.8	32.7	743.3	0.08	-0.08	0.00
3,573.0	17.20	359.60	3,465.6	813.2	32.5	777.6	1.20	1.20	-0.24
3,698.0	17.90	2.70	3,584.8	850.9	33.3	813.8	0.93	0.56	2.48
3,822.0	17.00	4.50	3,703.1	888.0	35.6	849.1	0.85	-0.73	1.45
3,947.0	16.30	5.00	3,822.8	923.7	38.6	882.8	0.57	-0.56	0.40
4,072.0	15.70	5.20	3,943.0	958.0	41.6	915.2	0.48	-0.48	0.16
4,198.0	16.00	3.40	4,064.2	992.3	44.2	947.7	0.46	0.24	-1.43
4,323.0	16.80	4.50	4,184.1	1,027.5	46.7	981.1	0.69	0.64	0.88
4,448.0	14.30	2.60	4,304.5	1,060.9	48.8	1,012.9	2.04	-2.00	-1.52
4,574.0	13.10	2.70	4,426.9	1,090.7	50.2	1,041.3	0.95	-0.95	0.08
4,699.0	12.50	3.30	4,548.8	1,118.4	51.6	1,067.7	0.49	-0.48	0.48
4,824.0	12.80	5.20	4,670.8	1,145.7	53.6	1,093.5	0.41	0.24	1.52
4,949.0	12.50	8.40	4,792.8	1,172.9	56.9	1,119.0	0.61	-0.24	2.56
5,073.0	12.40	6.20	4,913.9	1,199.4	60.3	1,143.7	0.39	-0.08	-1.77
5,199.0	10.30	2.70	5,037.4	1,224.1	62.3	1,167.1	1.75	-1.67	-2.78
5,324.0	9.30	8.20	5,160.6	1,245.2	64.2	1,187.0	1.10	-0.80	4.40
5,449.0	7.50	14.50	5,284.2	1,263.1	67.7	1,203.4	1.62	-1.44	5.04
5,575.0	6.80	2.40	5,409.3	1,278.6	70.1	1,217.7	1.31	-0.56	-9.60
5,700.0	5.50	5.00	5,533.5	1,291.9	70.9	1,230.4	1.06	-1.04	2.08
5,825.0	3.50	3.60	5,658.1	1,301.7	71.7	1,239.7	1.60	-1.60	-1.12
5,950.0	0.40	40.00	5,783.1	1,305.8	72.2	1,243.5	2.55	-2.48	29.12
5,966.9	0.38	46.73	5,800.0	1,305.9	72.3	1,243.6	0.30	-0.12	39.72
TARGET BHL 2141'FNL, 649'FEL									
6,074.0	0.40	94.50	5,907.0	1,306.1	72.9	1,243.6	0.30	0.02	44.62
6,199.0	0.90	86.80	6,032.0	1,306.2	74.3	1,243.3	0.41	0.40	-6.16
6,324.0	0.50	101.20	6,157.0	1,306.1	75.8	1,242.9	0.35	-0.32	11.52
6,371.8	0.50	100.86	6,204.8	1,306.0	76.2	1,242.7	0.01	0.00	-0.72
LEGAL BOX 400' X 400' 2093'FNL & 650'FEL									
6,371.9	0.50	100.86	6,204.9	1,306.0	76.2	1,242.7	0.01	0.00	-0.72
TARGET CIRCLE 2141'FNL & 649'FEL									
6,449.0	0.50	100.30	6,282.0	1,305.9	76.9	1,242.4	0.01	0.00	-0.72
6,574.0	0.40	121.00	6,407.0	1,305.6	77.8	1,241.8	0.15	-0.08	16.56
6,732.0	0.40	86.80	6,565.0	1,305.3	78.8	1,241.3	0.15	0.00	-21.65
6,778.0	0.40	86.80	6,611.0	1,305.3	79.2	1,241.3	0.00	0.00	0.00

Company:	BONANZA CREEK ENERGY OPERATING	Local Co-ordinate Reference:	Well Latham 42-1
Project:	SEC.1-T4N-R63W	TVD Reference:	WELL @ 4560.0ft (Original Well Elev)
Site:	Latham 43-1 Pad Sec.1-T4N-R63W	MD Reference:	WELL @ 4560.0ft (Original Well Elev)
Well:	Latham 42-1	North Reference:	True
Wellbore:	Wellbore #1	Survey Calculation Method:	Minimum Curvature
Design:	Wellbore #1	Database:	Landmark

Checked By: _____	Approved By: _____	Date: _____
-------------------	--------------------	-------------