

**Well Name: KERBS 22-15**

VERTICAL - ORIGINAL HOLE, 10/30/2012 10:09:12 AM

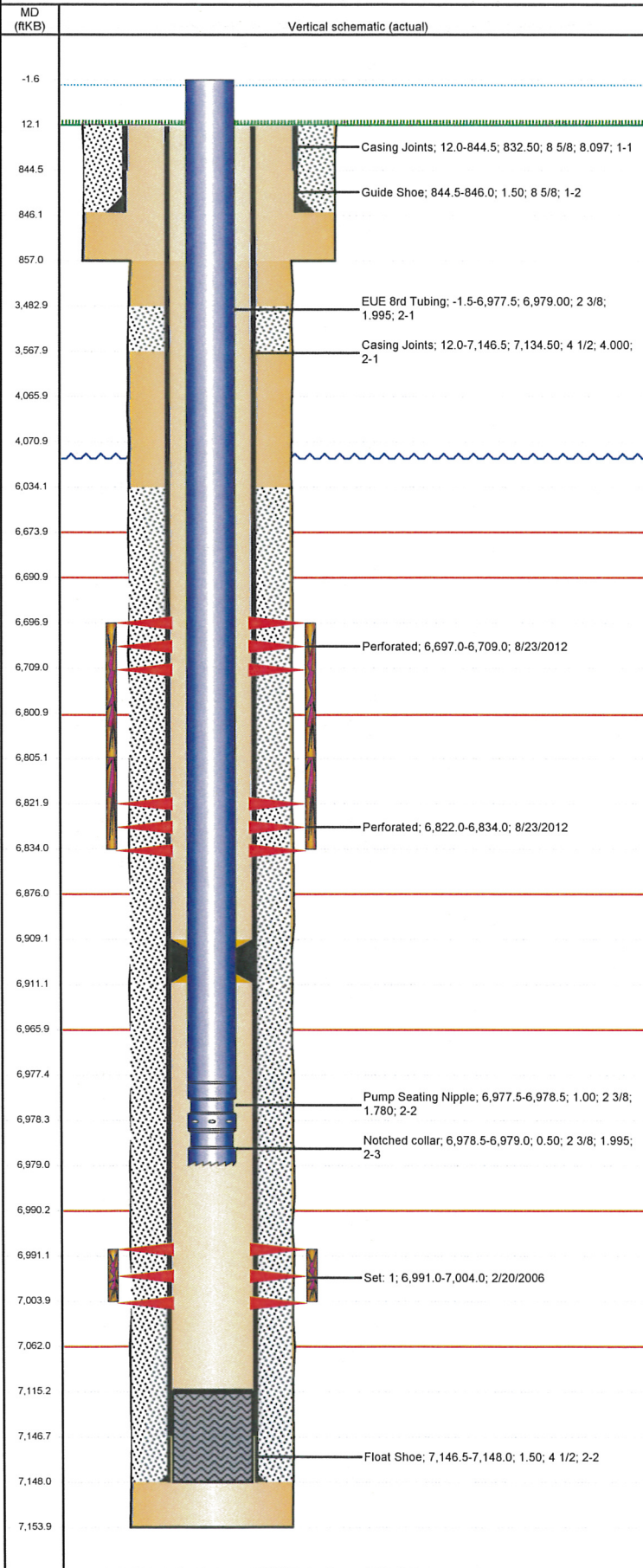

Well Header			
API	Business Unit	District	Well Config
05-123-23548	WATTENBERG	15	VERTICAL
Original KB Elevation (ft)	KB - GL / MSL (ftKB)	Spud Date	P & A Date
4,818.00	12.00	2/9/2006	
Comment			
Directions To Well			
WCR 55 and WCR 70 E. 4/10, S.E. 500', S. 3/10, W 4/10 into			
Current PBTD (ftKB)			
ORIGINAL HOLE - 7,115.0			
Surface Location (Congressional)			
Quarter 1	Quarter 2	Quarter 3	Quarter 4
		SE	NW
Section	Township	Twnshp N...	Range
15	6 N		64 W
Rng E/W Dir			
Bottom Hole Location			
North-South Distance (ft)	From N or S Line	East-West Distance (ft)	From E or W Line
Plug Back Total Depths			
Date	Depth (ftKB)	Method	Com
2/14/2006	7,147.0	CASING TALLY	LATCH DOWN COLLAR
2/20/2006	7,115.0	CASED HOLE LOG	DEPTH LOGGER
Wellbore Sections			
Section Des	Size (in)	Act Top (ftKB)	Act Btm (ftKB)
SURFACE	12 1/4	12.0	857.0
PRODUCTION	7 7/8	857.0	7,154.0
Zone Statuses			
Zone Name	Status Date	Status	Job
CODELL	3/27/2006	PR	DRILLING/COMPLETION - ORIGINAL, 2/9/2006 00:00
CODELL	8/24/2012	PR	RE-FRAC & RECOMPLETE, 7/17/2012 06:00
NIOBRARA	8/24/2012	PR	RE-FRAC & RECOMPLETE, 7/17/2012 06:00
Casing Strings			
Csg Des	Run Date	OD (in)	W/Len (lb/ft)
Grade	Top (ftKB)	Set Depth (ftKB)	
Surface Casing	2/9/2006	8 5/8	24.00
Production	2/15/2006	4 1/2	11.60
		I-80	
		12.0	7,148.0
Cement			
Des	Top (ftKB)	Btm (ftKB)	
SURFACE CASING CEMENT	12.0	846.0	
PRODUCTION CASING CEMENT	3,483.0	3,568.0	
PRODUCTION CASING CEMENT	6,034.0	7,148.0	
Tubing Components			
Item Des	OD (in)	Wt (lb/ft)	Grade
Jts	Len (ft)		
EUE 8rd Tubing	2 3/8	4.70	J-55
Pump Seating Nipple	2 3/8	1.10	J-55
Notched collar	2 3/8	4.70	J-55
			1
			0.50
Perforation Data			
Zone	Bnch/St g	Entered Shot Total	Top (ftKB)
Btm (ftKB)	Date		
NIOBRARA, ORIGINAL HOLE		24	6,697.0
			6,709.0
NIOBRARA, ORIGINAL HOLE		24	6,822.0
			6,834.0
CODELL, ORIGINAL HOLE		52	6,991.0
			7,004.0
			2/20/2006
Stimulations & Treatments			
Bnch/Stg	Date	Zone	Primary Job Type
	2/21/2006	CODELL, ORIGINAL HOLE	DRILLING/COMPLETION - ORIGINAL
Comment			
SCREENED OUT WITH 95,000# PUMPED. FLOWED ONE WELLBORE OF FLUID BACK AND FINISHED FRAC.			
Total Add Amount	Total Clean Volume...	Vol Slurry Tot (gal)	Vol Gas Tot (MCF)
Proppant Bulk Sand 212600 lb		108528.00	
Avg Treat Pressure (psi)	Max Treat Pressure (psi)	Avg Treat Rate (bbl/min)	Max Treat Rate (bbl/min)
3,800.0	5,171.0	20.20	
Bnch/Stg	Date	Zone	Primary Job Type
	8/23/2012	CODELL, ORIGINAL HOLE	RE-FRAC & RECOMPLETE
Comment			
Total Add Amount	Total Clean Volume...	Vol Slurry Tot (gal)	Vol Gas Tot (MCF)
Ottawa 241361.5 lb	140387.10	151349.94	
Avg Treat Pressure (psi)	Max Treat Pressure (psi)	Avg Treat Rate (bbl/min)	Max Treat Rate (bbl/min)
3,675.0	4,424.0	14.10	14.30

**Well Name: KERBS 22-15**

VERTICAL - ORIGINAL HOLE, 10/30/2012 10:09:13 AM

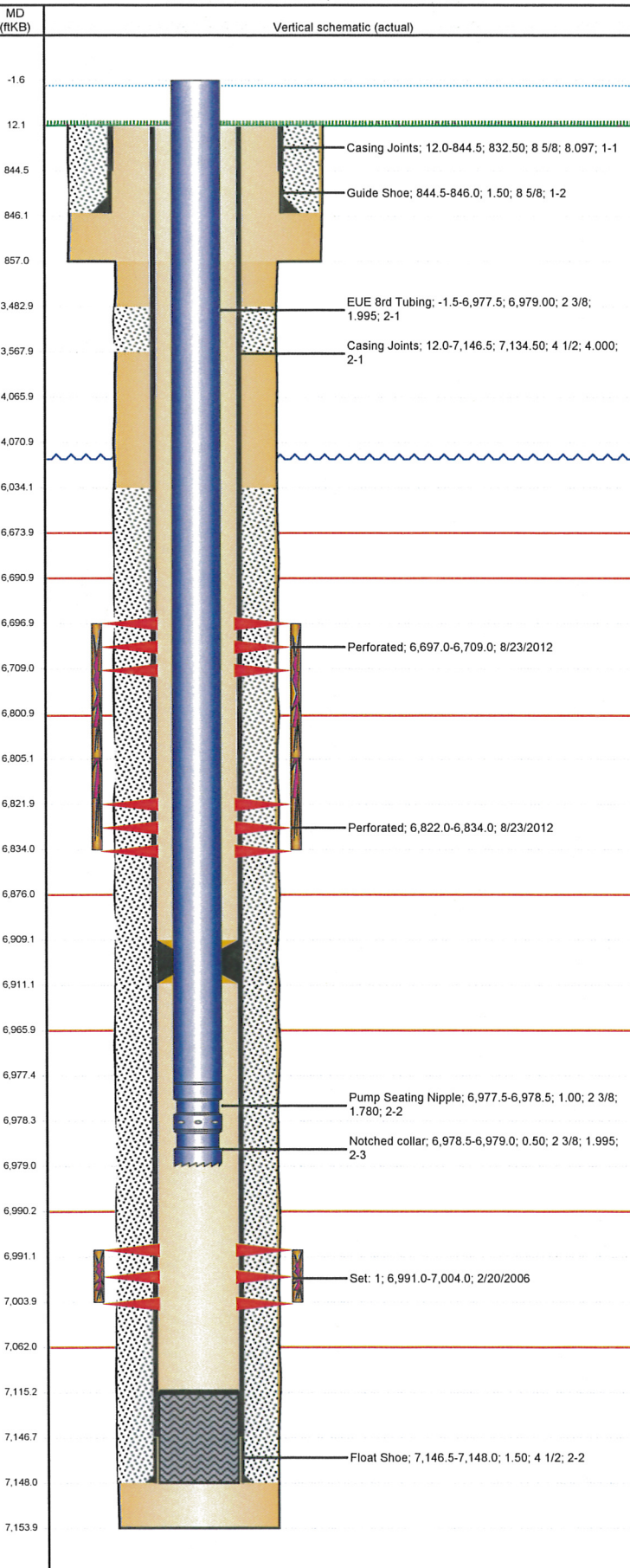

### Stimulations & Treatments

Bnch/Stg	Date	Zone	Primary Job Type	
	8/23/2012	NIOBRARA, ORIGINAL HOLE	RE-FRAC & RECOMPLETE	
Comment				
Total Add Amount		Total Clean Volume...	Vol Slurry Tot (gal)	Vol Gas Tot (MCF)
Ottawa 235485.7 lb		148318.80	158981.76	
Avg Treat Pressure (psi)	Max Treat Pressure (psi)	Avg Treat Rate (bbl/min)	Max Treat Rate (bbl/min)	
4,180.0	4,716.0	44.50	47.40	

### Other In Hole

Run Date	Des	OD (in)	Top (ftKB)	Btm (ftKB)
5/16/2012	Stage Tool	2	4,066.0	4,071.0
8/23/2012	Composite Flow Through Plug	3.99	6,909.0	6,911.0

### Logs

Date	Type	Top (ftKB)	Btm (ftKB)
2/14/2006	COMPENSATED DENSITY	845.0	7,151.0
2/20/2006	CBL/CCL/GR	3,310.0	7,110.0