

KERR-MCGEE OIL & GAS ONSHORE LP

Location: COLORADO Slot: SLOT#23 WEISS 29C-33HZ (712'FSL & 616'FWL, SEC.33)
 Field: WELD COUNTY (KERR MCGEE) Well: WEISS 29C-33HZ
 Facility: SEC.33-T3N-R66W Wellbore: WEISS 29C-33HZ PWB

Plot reference wellpath is WEISS 29C-33HZ (REV-B.0) PWP

True vertical depths are referenced to XTREME 6 (RKB)	Grid System: NAD83 / Lambert Colorado SP, Northern Zone (501), US feet
Measured depths are referenced to XTREME 6 (RKB)	North Reference: True north
XTREME 6 (RKB) to Mean Sea Level: 4931 feet	Scale: True distance
Mean Sea Level to Mud line (At Slot: SLOT#23 WEISS 29C-33HZ (712'FSL & 616'FWL, SEC.33)): 0 feet	Depths are in feet
Coordinates are in feet referenced to Slot	Created by: augunora on 18/Sep/2012

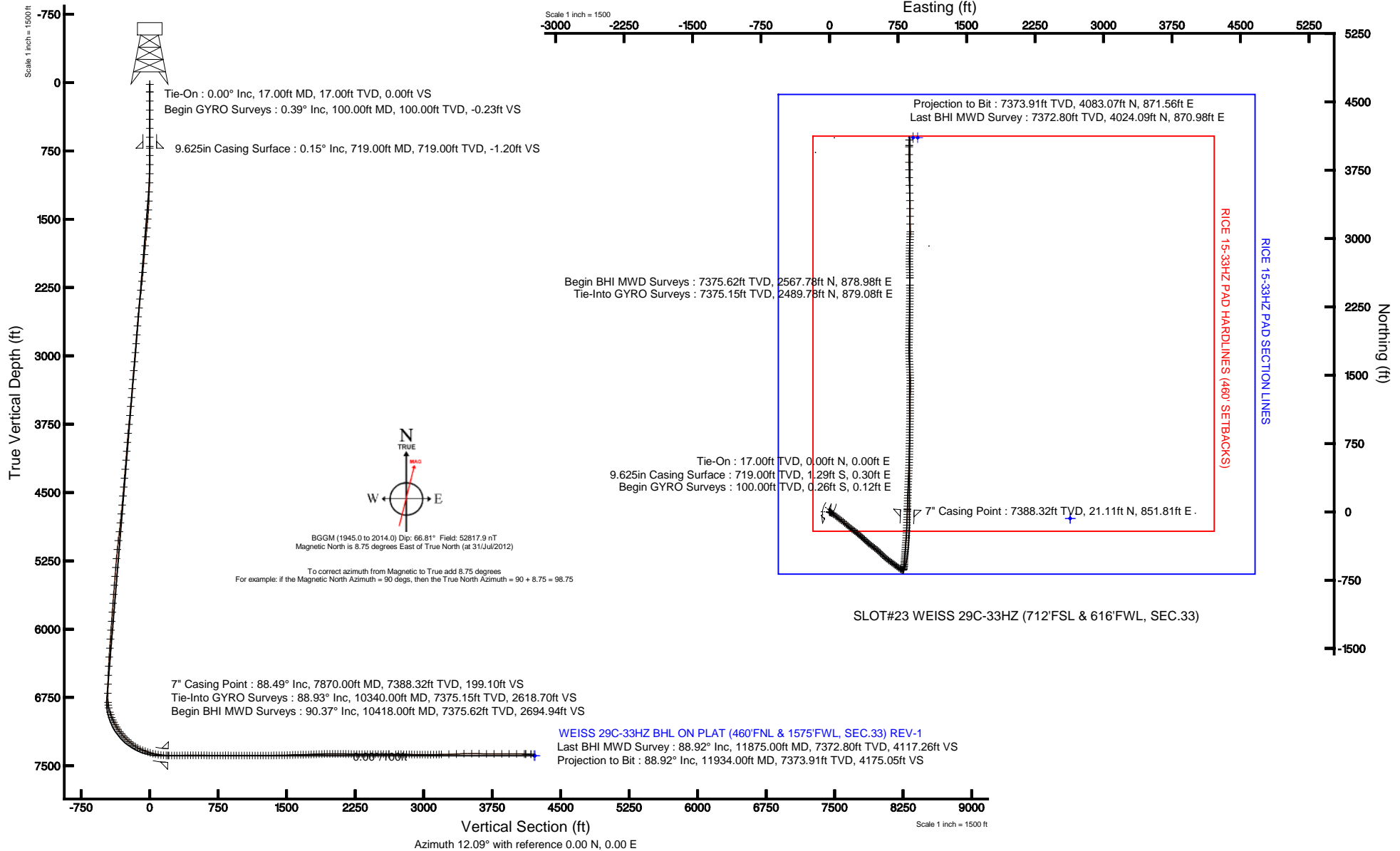



Actual Wellpath Report

WEISS 29C-33HZ AWP

Page 1 of 8



REFERENCE WELLPATH IDENTIFICATION

Operator	KERR-MCGEE OIL & GAS ONSHORE LP	Slot	SLOT#23 WEISS 29C-33HZ (712'FSL & 616'FWL, SEC.33)
Area	COLORADO	Well	WEISS 29C-33HZ
Field	WELD COUNTY (KERR MCGEE)	Wellbore	WEISS 29C-33HZ AWB
Facility	SEC.33-T3N-R66W		

REPORT SETUP INFORMATION

Projection System	NAD83 / Lambert Colorado SP, Northern Zone (501), US feet	Software System	WellArchitect® 3.0.0
North Reference	True	User	Augunora
Scale	0.999958	Report Generated	18/Sep/2012 at 11:57
Convergence at slot	0.46° East	Database/Source file	WA_ANADARKO/WEISS_29C-33HZ_AWB.xml

WELLPATH LOCATION

	Local coordinates		Grid coordinates		Geographic coordinates	
	North[ft]	East[ft]	Easting[US ft]	Northing[US ft]	Latitude	Longitude
Slot Location	74.11	-2635.68	3198553.80	1307812.39	40°10'34.165"N	104°47'21.930"W
Facility Reference Pt			3201189.88	1307759.68	40°10'33.434"N	104°46'47.975"W
Field Reference Pt			3197771.84	1268891.29	40°04'09.600"N	104°47'36.000"W

WELLPATH DATUM

Calculation method	Minimum curvature	XTREME 6 (RKB) to Facility Vertical Datum	4931.00ft
Horizontal Reference Pt	Slot	XTREME 6 (RKB) to Mean Sea Level	4931.00ft
Vertical Reference Pt	XTREME 6 (RKB)	XTREME 6 (RKB) to Mud Line at Slot (SLOT#23 WEISS 29C-33HZ (712'FSL & 616'FWL, SEC.33))	4931.00ft
MD Reference Pt	XTREME 6 (RKB)	Section Origin	N 0.00, E 0.00 ft
Field Vertical Reference	Mean Sea Level	Section Azimuth	12.05°



Actual Wellpath Report

WEISS 29C-33HZ AWP

Page 2 of 8



REFERENCE WELLPATH IDENTIFICATION

Operator	KERR-MCGEE OIL & GAS ONSHORE LP	Slot	SLOT#23 WEISS 29C-33HZ (712'FSL & 616'FWL, SEC.33)
Area	COLORADO	Well	WEISS 29C-33HZ
Field	WELD COUNTY (KERR MCGEE)	Wellbore	WEISS 29C-33HZ AWP
Facility	SEC.33-T3N-R66W		

WELLPATH DATA (217 stations) † = interpolated/extrapolated station

MD [ft]	Inclination [°]	Azimuth [°]	TVD [ft]	Vert Sect [ft]	North [ft]	East [ft]	Latitude	Longitude	DLS [°/100ft]	Comments
0.00†	0.000	155.295	0.00	0.00	0.00	0.00	40°10'34.165"N	104°47'21.930"W	0.00	
17.00	0.000	155.295	17.00	0.00	0.00	0.00	40°10'34.165"N	104°47'21.930"W	0.00	Tie-On
100.00	0.391	155.295	100.00	-0.23	-0.26	0.12	40°10'34.162"N	104°47'21.928"W	0.47	Begin GYRO Surveys
200.00	0.371	156.332	200.00	-0.76	-0.86	0.39	40°10'34.156"N	104°47'21.925"W	0.02	
300.00	0.236	320.182	300.00	-0.90	-1.00	0.39	40°10'34.155"N	104°47'21.925"W	0.60	
400.00	0.183	206.066	400.00	-0.93	-0.99	0.19	40°10'34.155"N	104°47'21.928"W	0.35	
500.00	0.236	98.113	500.00	-1.07	-1.16	0.32	40°10'34.154"N	104°47'21.926"W	0.34	
600.00	0.207	232.459	600.00	-1.19	-1.30	0.38	40°10'34.152"N	104°47'21.925"W	0.41	
700.00	0.107	27.238	700.00	-1.24	-1.33	0.28	40°10'34.152"N	104°47'21.926"W	0.31	
800.00	0.340	3.013	799.99	-0.86	-0.95	0.34	40°10'34.156"N	104°47'21.926"W	0.25	
900.00	1.225	121.428	899.99	-0.92	-1.21	1.27	40°10'34.153"N	104°47'21.914"W	1.42	
1000.00	2.753	123.191	999.92	-2.14	-3.08	4.19	40°10'34.135"N	104°47'21.876"W	1.53	
1100.00	4.000	126.323	1099.75	-4.44	-6.46	9.01	40°10'34.101"N	104°47'21.814"W	1.26	
1200.00	5.005	124.857	1199.44	-7.56	-11.02	15.40	40°10'34.056"N	104°47'21.732"W	1.01	
1300.00	7.742	120.941	1298.81	-11.44	-16.98	24.76	40°10'33.997"N	104°47'21.611"W	2.77	
1400.00	8.953	122.297	1397.75	-16.31	-24.60	37.11	40°10'33.922"N	104°47'21.452"W	1.23	
1500.00	10.961	128.547	1496.24	-23.24	-34.68	51.13	40°10'33.822"N	104°47'21.271"W	2.28	
1600.00	12.385	129.466	1594.17	-32.42	-47.42	66.84	40°10'33.696"N	104°47'21.069"W	1.44	
1700.00	12.502	128.008	1691.82	-42.10	-60.90	83.65	40°10'33.563"N	104°47'20.852"W	0.34	
1800.00	11.659	127.696	1789.61	-51.21	-73.75	100.17	40°10'33.436"N	104°47'20.639"W	0.85	
1900.00	11.567	126.158	1887.56	-59.68	-85.84	116.26	40°10'33.317"N	104°47'20.432"W	0.32	
2000.00	11.996	127.198	1985.45	-68.19	-98.04	132.64	40°10'33.196"N	104°47'20.221"W	0.48	
2100.00	12.026	127.258	2083.26	-77.05	-110.63	149.21	40°10'33.072"N	104°47'20.008"W	0.03	
2200.00	12.647	130.269	2180.96	-86.66	-124.01	165.85	40°10'32.939"N	104°47'19.793"W	0.89	
2300.00	12.790	130.668	2278.50	-97.14	-138.30	182.60	40°10'32.798"N	104°47'19.578"W	0.17	
2400.00	12.399	132.339	2376.10	-107.85	-152.75	198.93	40°10'32.656"N	104°47'19.367"W	0.53	
2500.00	11.478	132.951	2473.93	-118.38	-166.76	214.15	40°10'32.517"N	104°47'19.171"W	0.93	
2600.00	11.440	126.160	2571.94	-127.54	-179.39	229.44	40°10'32.392"N	104°47'18.974"W	1.35	
2700.00	10.996	127.146	2670.03	-135.64	-191.00	245.05	40°10'32.278"N	104°47'18.773"W	0.48	
2800.00	10.487	126.421	2768.28	-143.44	-202.16	259.97	40°10'32.167"N	104°47'18.581"W	0.53	
2900.00	10.570	126.472	2866.60	-150.98	-213.02	274.67	40°10'32.060"N	104°47'18.391"W	0.08	
3000.00	10.756	129.352	2964.87	-159.06	-224.39	289.26	40°10'31.948"N	104°47'18.204"W	0.56	
3100.00	10.952	130.435	3063.08	-167.85	-236.46	303.71	40°10'31.828"N	104°47'18.017"W	0.28	
3200.00	10.624	131.084	3161.31	-176.84	-248.68	317.89	40°10'31.707"N	104°47'17.835"W	0.35	
3300.00	9.899	129.285	3259.71	-185.25	-260.18	331.49	40°10'31.594"N	104°47'17.660"W	0.79	
3400.00	9.462	130.929	3358.29	-193.16	-271.01	344.35	40°10'31.487"N	104°47'17.494"W	0.52	
3500.00	9.678	133.232	3456.90	-201.48	-282.15	356.69	40°10'31.377"N	104°47'17.335"W	0.44	
3600.00	10.032	132.007	3555.42	-210.18	-293.74	369.28	40°10'31.262"N	104°47'17.173"W	0.41	
3700.00	10.508	133.374	3653.82	-219.27	-305.83	382.38	40°10'31.143"N	104°47'17.004"W	0.53	
3800.00	10.804	132.134	3752.10	-228.71	-318.38	395.96	40°10'31.019"N	104°47'16.829"W	0.37	
3900.00	9.794	133.215	3850.48	-237.81	-330.49	409.11	40°10'30.899"N	104°47'16.660"W	1.03	
4000.00	8.543	131.333	3949.20	-245.84	-341.22	420.89	40°10'30.793"N	104°47'16.508"W	1.29	
4100.00	9.683	130.064	4047.94	-253.43	-351.54	432.90	40°10'30.691"N	104°47'16.353"W	1.16	
4200.00	11.521	126.096	4146.23	-261.45	-362.84	447.41	40°10'30.579"N	104°47'16.166"W	1.98	
4300.00	10.751	127.002	4244.35	-269.45	-374.34	462.93	40°10'30.466"N	104°47'15.966"W	0.79	



Actual Wellpath Report

WEISS 29C-33HZ AWP
Page 3 of 8



REFERENCE WELLPATH IDENTIFICATION

Operator	KERR-MCGEE OIL & GAS ONSHORE LP	Slot	SLOT#23 WEISS 29C-33HZ (712'FSL & 616'FWL, SEC.33)
Area	COLORADO	Well	WEISS 29C-33HZ
Field	WELD COUNTY (KERR MCGEE)	Wellbore	WEISS 29C-33HZ AWB
Facility	SEC.33-T3N-R66W		

WELLPATH DATA (217 stations)

MD [ft]	Inclination [°]	Azimuth [°]	TVD [ft]	Vert Sect [ft]	North [ft]	East [ft]	Latitude	Longitude	DLS [°/100ft]	Comments
4400.00	10.843	128.772	4342.58	-277.62	-385.84	477.71	40°10'30.352"N	104°47'15.776"W	0.34	
4500.00	11.159	128.375	4440.74	-286.14	-397.74	492.63	40°10'30.235"N	104°47'15.584"W	0.32	
4600.00	10.651	129.040	4538.93	-294.62	-409.56	507.39	40°10'30.118"N	104°47'15.393"W	0.52	
4700.00	10.899	129.176	4637.17	-303.13	-421.36	521.90	40°10'30.001"N	104°47'15.207"W	0.25	
4800.00	11.689	131.884	4735.23	-312.48	-434.09	536.77	40°10'29.875"N	104°47'15.015"W	0.95	
4900.00	11.618	134.574	4833.17	-322.93	-447.92	551.48	40°10'29.739"N	104°47'14.825"W	0.55	
5000.00	11.161	136.904	4931.20	-333.88	-462.06	565.27	40°10'29.599"N	104°47'14.648"W	0.65	
5100.00	11.871	134.043	5029.19	-344.86	-476.28	579.28	40°10'29.458"N	104°47'14.467"W	0.91	
5200.00	11.364	135.991	5127.14	-355.81	-490.51	593.51	40°10'29.318"N	104°47'14.284"W	0.64	
5300.00	10.869	129.892	5225.27	-365.71	-503.64	607.59	40°10'29.188"N	104°47'14.103"W	1.28	
5400.00	10.219	127.069	5323.58	-373.87	-515.04	621.91	40°10'29.075"N	104°47'13.918"W	0.83	
5500.00	10.747	127.310	5421.91	-381.60	-526.04	636.40	40°10'28.967"N	104°47'13.732"W	0.53	
5600.00	10.085	127.316	5520.26	-389.31	-537.00	650.78	40°10'28.858"N	104°47'13.546"W	0.66	
5700.00	10.089	127.576	5618.72	-396.82	-547.65	664.68	40°10'28.753"N	104°47'13.367"W	0.05	
5800.00	10.359	126.942	5717.13	-404.38	-558.39	678.81	40°10'28.647"N	104°47'13.185"W	0.29	
5900.00	9.545	125.832	5815.62	-411.51	-568.65	692.72	40°10'28.546"N	104°47'13.006"W	0.84	
6000.00	10.238	126.608	5914.14	-418.55	-578.80	706.57	40°10'28.445"N	104°47'12.828"W	0.71	
6100.00	9.575	125.464	6012.65	-425.55	-588.93	720.48	40°10'28.345"N	104°47'12.648"W	0.69	
6200.00	9.904	125.784	6111.20	-432.31	-598.78	734.23	40°10'28.248"N	104°47'12.471"W	0.33	
6300.00	9.513	127.402	6209.77	-439.31	-608.83	747.77	40°10'28.148"N	104°47'12.297"W	0.48	
6400.00	8.945	128.417	6308.48	-446.31	-618.68	760.43	40°10'28.051"N	104°47'12.134"W	0.59	
6500.00	7.433	121.674	6407.46	-451.93	-626.91	772.03	40°10'27.970"N	104°47'11.984"W	1.79	
6600.00	6.052	118.050	6506.76	-455.56	-632.78	782.18	40°10'27.912"N	104°47'11.854"W	1.44	
6700.00	5.913	117.460	6606.22	-458.38	-637.64	791.41	40°10'27.864"N	104°47'11.735"W	0.15	
6800.00	5.670	121.315	6705.71	-461.38	-642.58	800.20	40°10'27.815"N	104°47'11.621"W	0.46	
6900.00	5.256	34.069	6805.40	-458.76	-641.35	806.99	40°10'27.827"N	104°47'11.534"W	7.54	
6930.00	7.900	32.810	6835.20	-455.56	-638.48	808.88	40°10'27.855"N	104°47'11.510"W	8.83	
6960.00	12.060	13.006	6864.75	-450.49	-633.69	810.71	40°10'27.903"N	104°47'11.486"W	17.79	
7010.00	16.133	11.379	6913.23	-438.32	-621.78	813.25	40°10'28.020"N	104°47'11.453"W	8.18	
7040.00	19.026	7.533	6941.83	-429.27	-612.85	814.72	40°10'28.109"N	104°47'11.434"W	10.39	
7070.00	22.622	7.124	6969.86	-418.64	-602.27	816.07	40°10'28.213"N	104°47'11.417"W	12.00	
7100.00	24.298	3.411	6997.38	-406.79	-590.38	817.16	40°10'28.331"N	104°47'11.403"W	7.45	
7130.00	28.805	3.632	7024.21	-393.53	-577.00	817.98	40°10'28.463"N	104°47'11.392"W	15.03	
7160.00	29.323	3.648	7050.43	-379.12	-562.46	818.91	40°10'28.607"N	104°47'11.380"W	1.73	
7190.00	30.813	3.603	7076.40	-364.25	-547.46	819.86	40°10'28.755"N	104°47'11.368"W	4.97	
7220.00	34.543	4.900	7101.64	-348.20	-531.31	821.07	40°10'28.914"N	104°47'11.353"W	12.65	
7250.00	36.629	4.620	7126.04	-330.89	-513.91	822.51	40°10'29.086"N	104°47'11.334"W	6.97	
7280.00	39.296	4.170	7149.69	-312.60	-495.51	823.93	40°10'29.268"N	104°47'11.316"W	8.94	
7310.00	41.699	4.244	7172.50	-293.30	-476.09	825.36	40°10'29.460"N	104°47'11.297"W	8.01	
7340.00	43.854	4.412	7194.52	-273.11	-455.77	826.89	40°10'29.661"N	104°47'11.277"W	7.19	
7370.00	46.827	3.691	7215.61	-251.98	-434.49	828.40	40°10'29.871"N	104°47'11.258"W	10.06	
7400.00	49.355	4.226	7235.64	-229.88	-412.22	829.94	40°10'30.091"N	104°47'11.238"W	8.53	
7430.00	50.698	4.256	7254.91	-207.11	-389.29	831.64	40°10'30.318"N	104°47'11.216"W	4.48	
7460.00	54.523	3.930	7273.13	-183.50	-365.52	833.34	40°10'30.553"N	104°47'11.194"W	12.78	
7490.00	57.213	4.203	7289.96	-158.91	-340.75	835.10	40°10'30.798"N	104°47'11.172"W	9.00	



Actual Wellpath Report

WEISS 29C-33HZ AWP

Page 4 of 8



REFERENCE WELLPATH IDENTIFICATION

Operator	KERR-MCGEE OIL & GAS ONSHORE LP	Slot	SLOT#23 WEISS 29C-33HZ (712'FSL & 616'FWL, SEC.33)
Area	COLORADO	Well	WEISS 29C-33HZ
Field	WELD COUNTY (KERR MCGEE)	Wellbore	WEISS 29C-33HZ AWB
Facility	SEC.33-T3N-R66W		

WELLPATH DATA (217 stations) † = interpolated/extrapolated station

MD [ft]	Inclination [°]	Azimuth [°]	TVD [ft]	Vert Sect [ft]	North [ft]	East [ft]	Latitude	Longitude	DLS [°/100ft]	Comments
7520.00	60.710	3.632	7305.43	-133.47	-315.11	836.86	40°10'31.051"N	104°47'11.149"W	11.77	
7550.00	65.296	4.410	7319.04	-107.01	-288.45	838.73	40°10'31.314"N	104°47'11.125"W	15.46	
7580.00	67.960	3.728	7330.94	-79.74	-260.99	840.69	40°10'31.586"N	104°47'11.100"W	9.12	
7610.00	69.899	2.433	7341.73	-52.09	-233.04	842.19	40°10'31.862"N	104°47'11.080"W	7.62	
7640.00	71.972	2.683	7351.52	-24.13	-204.71	843.45	40°10'32.142"N	104°47'11.064"W	6.95	
7670.00	73.309	2.482	7360.48	4.12	-176.11	844.74	40°10'32.425"N	104°47'11.047"W	4.50	
7700.00	76.259	2.578	7368.35	32.66	-147.19	846.02	40°10'32.710"N	104°47'11.031"W	9.84	
7730.00	79.273	2.159	7374.70	61.56	-117.90	847.23	40°10'33.000"N	104°47'11.015"W	10.14	
7760.00	80.859	1.406	7379.88	90.64	-88.37	848.15	40°10'33.292"N	104°47'11.003"W	5.84	
7790.00	82.351	1.885	7384.26	119.83	-58.70	849.00	40°10'33.585"N	104°47'10.992"W	5.22	
7820.00	88.192	1.842	7386.73	149.24	-28.83	849.98	40°10'33.880"N	104°47'10.980"W	19.47	
7850.00	88.041	2.220	7387.72	178.77	1.13	851.04	40°10'34.176"N	104°47'10.966"W	1.36	
7870.00†	88.495	2.215	7388.32	198.46	21.11	851.81	40°10'34.373"N	104°47'10.956"W	2.27	7" Casing Point
7880.00	88.722	2.212	7388.57	208.31	31.10	852.20	40°10'34.472"N	104°47'10.951"W	2.27	
7910.00	89.134	1.254	7389.13	237.82	61.08	853.10	40°10'34.768"N	104°47'10.940"W	3.48	
7940.00	89.327	1.238	7389.53	267.29	91.07	853.76	40°10'35.065"N	104°47'10.931"W	0.65	
7970.00	91.638	1.443	7389.28	296.76	121.06	854.46	40°10'35.361"N	104°47'10.922"W	7.73	
8000.00	91.311	1.868	7388.51	326.26	151.04	855.33	40°10'35.657"N	104°47'10.911"W	1.79	
8030.00	90.718	2.515	7387.97	355.81	181.01	856.47	40°10'35.954"N	104°47'10.896"W	2.93	
8060.00	91.180	2.450	7387.48	385.39	210.98	857.77	40°10'36.250"N	104°47'10.879"W	1.56	
8090.00	90.868	1.939	7386.94	414.94	240.95	858.92	40°10'36.546"N	104°47'10.865"W	2.00	
8120.00	89.925	2.315	7386.73	444.49	270.93	860.03	40°10'36.842"N	104°47'10.850"W	3.38	
8150.00	90.154	2.469	7386.71	474.07	300.90	861.29	40°10'37.138"N	104°47'10.834"W	0.92	
8180.00	89.989	2.416	7386.68	503.65	330.87	862.56	40°10'37.435"N	104°47'10.818"W	0.58	
8210.00	89.634	2.443	7386.77	533.23	360.85	863.84	40°10'37.731"N	104°47'10.801"W	1.19	
8240.00	89.404	2.511	7387.03	562.81	390.82	865.13	40°10'38.027"N	104°47'10.784"W	0.80	
8270.00	89.304	2.168	7387.36	592.38	420.79	866.36	40°10'38.323"N	104°47'10.769"W	1.19	
8300.00	89.072	2.746	7387.79	621.95	450.76	867.64	40°10'38.619"N	104°47'10.752"W	2.08	
8330.00	88.829	2.692	7388.34	651.55	480.72	869.07	40°10'38.915"N	104°47'10.734"W	0.83	
8360.00	89.066	2.567	7388.89	681.14	510.69	870.44	40°10'39.211"N	104°47'10.716"W	0.89	
8390.00	90.721	1.805	7388.95	710.70	540.66	871.59	40°10'39.508"N	104°47'10.701"W	6.07	
8420.00	90.131	1.465	7388.72	740.20	570.65	872.44	40°10'39.804"N	104°47'10.690"W	2.27	
8450.00	90.700	1.736	7388.50	769.70	600.64	873.28	40°10'40.100"N	104°47'10.679"W	2.10	
8480.00	90.560	1.375	7388.17	799.20	630.62	874.09	40°10'40.397"N	104°47'10.669"W	1.29	
8510.00	90.264	0.937	7387.96	828.66	660.62	874.70	40°10'40.693"N	104°47'10.661"W	1.76	
8540.00	89.634	0.563	7387.99	858.08	690.61	875.09	40°10'40.990"N	104°47'10.656"W	2.44	
8570.00	89.740	0.572	7388.15	887.48	720.61	875.39	40°10'41.286"N	104°47'10.652"W	0.35	
8600.00	89.111	0.539	7388.45	916.87	750.61	875.68	40°10'41.582"N	104°47'10.648"W	2.10	
8630.00	89.381	0.482	7388.85	946.26	780.60	875.95	40°10'41.879"N	104°47'10.645"W	0.92	
8660.00	90.099	0.606	7388.98	975.66	810.60	876.23	40°10'42.175"N	104°47'10.641"W	2.43	
8690.00	90.406	0.945	7388.85	1005.08	840.60	876.64	40°10'42.472"N	104°47'10.636"W	1.52	
8720.00	89.910	1.054	7388.77	1034.52	870.60	877.16	40°10'42.768"N	104°47'10.629"W	1.69	
8750.00	89.330	1.498	7388.97	1064.00	900.59	877.83	40°10'43.064"N	104°47'10.621"W	2.43	
8780.00	91.132	1.764	7388.84	1093.50	930.57	878.68	40°10'43.361"N	104°47'10.610"W	6.07	
8810.00	90.907	1.679	7388.31	1123.01	960.55	879.58	40°10'43.657"N	104°47'10.598"W	0.80	



Actual Wellpath Report

WEISS 29C-33HZ AWP

Page 5 of 8



REFERENCE WELLPATH IDENTIFICATION

Operator	KERR-MCGEE OIL & GAS ONSHORE LP	Slot	SLOT#23 WEISS 29C-33HZ (712'FSL & 616'FWL, SEC.33)
Area	COLORADO	Well	WEISS 29C-33HZ
Field	WELD COUNTY (KERR MCGEE)	Wellbore	WEISS 29C-33HZ AWB
Facility	SEC.33-T3N-R66W		

WELLPATH DATA (217 stations)

MD [ft]	Inclination [°]	Azimuth [°]	TVD [ft]	Vert Sect [ft]	North [ft]	East [ft]	Latitude	Longitude	DLS [°/100ft]	Comments
8840.00	89.722	1.115	7388.15	1152.49	990.54	880.32	40°10'43.953"N	104°47'10.589"W	4.37	
8870.00	89.273	0.839	7388.41	1181.93	1020.54	880.83	40°10'44.250"N	104°47'10.582"W	1.76	
8900.00	89.133	359.976	7388.83	1211.31	1050.54	881.04	40°10'44.546"N	104°47'10.579"W	2.91	
8930.00	89.780	0.019	7389.11	1240.65	1080.53	881.04	40°10'44.843"N	104°47'10.579"W	2.16	
8960.00	89.739	0.277	7389.24	1270.00	1110.53	881.12	40°10'45.139"N	104°47'10.578"W	0.87	
8990.00	91.428	359.828	7388.93	1299.34	1140.53	881.14	40°10'45.436"N	104°47'10.578"W	5.83	
9020.00	91.091	0.278	7388.27	1328.68	1170.52	881.17	40°10'45.732"N	104°47'10.578"W	1.87	
9050.00	90.633	0.612	7387.82	1358.07	1200.52	881.40	40°10'46.028"N	104°47'10.574"W	1.89	
9080.00	90.621	1.181	7387.49	1387.50	1230.51	881.87	40°10'46.325"N	104°47'10.568"W	1.90	
9110.00	90.835	1.182	7387.11	1416.96	1260.50	882.49	40°10'46.621"N	104°47'10.560"W	0.71	
9140.00	90.642	0.601	7386.72	1446.39	1290.50	882.96	40°10'46.918"N	104°47'10.554"W	2.04	
9170.00	91.298	0.057	7386.22	1475.76	1320.49	883.13	40°10'47.214"N	104°47'10.552"W	2.84	
9200.00	92.191	0.318	7385.30	1505.10	1350.48	883.23	40°10'47.510"N	104°47'10.551"W	3.10	
9230.00	92.225	0.207	7384.15	1534.45	1380.46	883.37	40°10'47.807"N	104°47'10.549"W	0.39	
9260.00	92.122	359.964	7383.01	1563.78	1410.43	883.41	40°10'48.103"N	104°47'10.549"W	0.88	
9290.00	92.212	0.234	7381.88	1593.10	1440.41	883.46	40°10'48.399"N	104°47'10.548"W	0.95	
9320.00	91.502	358.608	7380.90	1622.36	1470.39	883.16	40°10'48.695"N	104°47'10.552"W	5.91	
9350.00	90.760	357.520	7380.31	1651.47	1500.37	882.15	40°10'48.992"N	104°47'10.565"W	4.39	
9380.00	90.645	357.163	7379.94	1680.48	1530.34	880.76	40°10'49.288"N	104°47'10.583"W	1.25	
9410.00	91.866	356.569	7379.29	1709.43	1560.28	879.12	40°10'49.584"N	104°47'10.604"W	4.53	
9440.00	92.163	356.299	7378.23	1738.30	1590.21	877.25	40°10'49.879"N	104°47'10.628"W	1.34	
9470.00	91.108	356.414	7377.38	1767.17	1620.13	875.35	40°10'50.175"N	104°47'10.652"W	3.54	
9500.00	92.589	357.378	7376.41	1796.11	1650.07	873.72	40°10'50.471"N	104°47'10.673"W	5.89	
9530.00	92.099	357.572	7375.18	1825.12	1680.02	872.40	40°10'50.767"N	104°47'10.690"W	1.76	
9560.00	92.001	357.896	7374.11	1854.17	1709.98	871.22	40°10'51.063"N	104°47'10.706"W	1.13	
9590.00	91.737	359.258	7373.13	1883.33	1739.95	870.47	40°10'51.359"N	104°47'10.715"W	4.62	
9620.00	91.902	359.375	7372.18	1912.58	1769.93	870.11	40°10'51.655"N	104°47'10.720"W	0.67	
9650.00	91.573	359.680	7371.27	1941.85	1799.92	869.87	40°10'51.952"N	104°47'10.723"W	1.50	
9680.00	89.661	0.606	7370.94	1971.20	1829.91	869.94	40°10'52.248"N	104°47'10.722"W	7.08	
9710.00	90.289	0.723	7370.96	2000.61	1859.91	870.29	40°10'52.545"N	104°47'10.717"W	2.13	
9740.00	89.736	1.676	7370.95	2030.07	1889.90	870.92	40°10'52.841"N	104°47'10.709"W	3.67	
9770.00	89.015	1.034	7371.28	2059.55	1919.89	871.63	40°10'53.137"N	104°47'10.700"W	3.22	
9800.00	89.389	0.788	7371.70	2088.98	1949.89	872.10	40°10'53.434"N	104°47'10.694"W	1.49	
9830.00	89.010	0.941	7372.11	2118.41	1979.88	872.56	40°10'53.730"N	104°47'10.688"W	1.36	
9860.00	89.276	1.016	7372.56	2147.85	2009.87	873.07	40°10'54.026"N	104°47'10.682"W	0.92	
9890.00	89.297	1.031	7372.94	2177.29	2039.87	873.60	40°10'54.323"N	104°47'10.675"W	0.09	
9920.00	89.775	1.303	7373.18	2206.75	2069.86	874.22	40°10'54.619"N	104°47'10.667"W	1.83	
9950.00	89.439	1.434	7373.39	2236.23	2099.85	874.93	40°10'54.916"N	104°47'10.657"W	1.20	
9980.00	88.926	1.359	7373.81	2265.71	2129.84	875.66	40°10'55.212"N	104°47'10.648"W	1.73	
10010.00	90.107	0.448	7374.07	2295.14	2159.83	876.14	40°10'55.508"N	104°47'10.642"W	4.97	
10040.00	89.506	0.474	7374.17	2324.53	2189.83	876.38	40°10'55.805"N	104°47'10.639"W	2.01	
10070.00	90.273	1.005	7374.23	2353.95	2219.83	876.76	40°10'56.101"N	104°47'10.634"W	3.11	
10100.00	89.781	1.180	7374.21	2383.40	2249.82	877.34	40°10'56.398"N	104°47'10.626"W	1.74	
10130.00	89.397	0.920	7374.43	2412.85	2279.82	877.89	40°10'56.694"N	104°47'10.619"W	1.55	
10160.00	89.524	1.032	7374.71	2442.29	2309.81	878.40	40°10'56.990"N	104°47'10.613"W	0.56	



Actual Wellpath Report

WEISS 29C-33HZ AWP

Page 6 of 8



REFERENCE WELLPATH IDENTIFICATION

Operator	KERR-MCGEE OIL & GAS ONSHORE LP	Slot	SLOT#23 WEISS 29C-33HZ (712'FSL & 616'FWL, SEC.33)
Area	COLORADO	Well	WEISS 29C-33HZ
Field	WELD COUNTY (KERR MCGEE)	Wellbore	WEISS 29C-33HZ AWP
Facility	SEC.33-T3N-R66W		

WELLPATH DATA (217 stations)

MD [ft]	Inclination [°]	Azimuth [°]	TVD [ft]	Vert Sect [ft]	North [ft]	East [ft]	Latitude	Longitude	DLS [°/100ft]	Comments
10190.00	91.172	1.158	7374.53	2471.74	2339.80	878.97	40°10'57.287"N	104°47'10.605"W	5.51	
10220.00	90.381	1.105	7374.12	2501.20	2369.79	879.56	40°10'57.583"N	104°47'10.598"W	2.64	
10250.00	89.488	0.238	7374.15	2530.61	2399.79	879.91	40°10'57.880"N	104°47'10.593"W	4.15	
10280.00	89.382	359.131	7374.45	2559.91	2429.79	879.75	40°10'58.176"N	104°47'10.595"W	3.71	
10310.00	89.514	359.386	7374.74	2589.16	2459.79	879.36	40°10'58.472"N	104°47'10.600"W	0.96	
10340.00	88.928	359.542	7375.15	2618.44	2489.78	879.08	40°10'58.769"N	104°47'10.604"W	2.02	Tie-Into GYRO Surveys
10418.00	90.373	0.306	7375.62	2694.69	2567.78	878.98	40°10'59.540"N	104°47'10.605"W	2.10	Begin BHI MWD Surveys
10447.00	90.338	358.300	7375.44	2722.98	2596.77	878.62	40°10'59.826"N	104°47'10.610"W	6.92	
10477.00	89.845	358.525	7375.40	2752.13	2626.76	877.79	40°11'00.123"N	104°47'10.620"W	1.81	
10508.00	88.815	358.307	7375.76	2782.26	2657.75	876.94	40°11'00.429"N	104°47'10.631"W	3.40	
10538.00	88.769	357.758	7376.39	2811.36	2687.72	875.91	40°11'00.725"N	104°47'10.645"W	1.84	
10568.00	88.370	358.345	7377.14	2840.46	2717.70	874.89	40°11'01.021"N	104°47'10.658"W	2.37	
10598.00	88.706	359.568	7377.90	2869.67	2747.68	874.34	40°11'01.317"N	104°47'10.665"W	4.23	
10628.00	88.895	359.146	7378.53	2898.93	2777.67	874.00	40°11'01.614"N	104°47'10.669"W	1.54	
10658.00	89.354	0.187	7378.99	2928.22	2807.67	873.83	40°11'01.910"N	104°47'10.671"W	3.79	
10688.00	89.507	1.408	7379.29	2957.65	2837.66	874.25	40°11'02.207"N	104°47'10.666"W	4.10	
10718.00	89.660	2.975	7379.51	2987.20	2867.64	875.39	40°11'02.503"N	104°47'10.651"W	5.25	
10748.00	89.631	2.467	7379.69	3016.80	2897.60	876.82	40°11'02.799"N	104°47'10.633"W	1.70	
10778.00	89.631	2.658	7379.89	3046.39	2927.57	878.16	40°11'03.095"N	104°47'10.616"W	0.64	
10808.00	90.153	3.168	7379.94	3076.01	2957.53	879.68	40°11'03.391"N	104°47'10.596"W	2.43	
10841.00	91.264	2.153	7379.53	3108.57	2990.50	881.22	40°11'03.717"N	104°47'10.576"W	4.56	
10871.00	91.574	2.475	7378.79	3138.13	3020.46	882.43	40°11'04.013"N	104°47'10.560"W	1.49	
10901.00	91.666	1.032	7377.94	3167.63	3050.44	883.34	40°11'04.309"N	104°47'10.549"W	4.82	
10926.00	91.485	359.798	7377.26	3192.11	3075.42	883.53	40°11'04.556"N	104°47'10.546"W	4.99	
11011.00	91.202	359.528	7375.26	3275.11	3160.40	883.03	40°11'05.396"N	104°47'10.553"W	0.46	
11096.00	92.248	359.778	7372.70	3358.08	3245.36	882.51	40°11'06.236"N	104°47'10.559"W	1.27	
11181.00	92.038	359.413	7369.53	3441.03	3330.30	881.91	40°11'07.075"N	104°47'10.567"W	0.50	
11267.00	89.230	358.510	7368.57	3524.78	3416.27	880.35	40°11'07.924"N	104°47'10.587"W	3.43	
11351.00	88.890	357.758	7369.95	3606.30	3500.21	877.62	40°11'08.754"N	104°47'10.622"W	0.98	
11436.00	89.845	358.237	7370.89	3688.75	3585.15	874.65	40°11'09.593"N	104°47'10.660"W	1.26	
11521.00	89.753	358.595	7371.19	3771.36	3670.12	872.30	40°11'10.433"N	104°47'10.691"W	0.43	
11606.00	90.123	359.180	7371.28	3854.12	3755.10	870.65	40°11'11.273"N	104°47'10.712"W	0.81	
11689.00	89.938	0.466	7371.24	3935.24	3838.10	870.39	40°11'12.093"N	104°47'10.715"W	1.57	
11774.00	89.629	359.479	7371.56	4018.36	3923.10	870.35	40°11'12.933"N	104°47'10.716"W	1.22	
11859.00	89.075	1.061	7372.52	4101.56	4008.09	870.75	40°11'13.773"N	104°47'10.710"W	1.97	
11875.00	88.921	0.562	7372.80	4117.25	4024.09	870.98	40°11'13.931"N	104°47'10.708"W	3.26	Last BHI MWD Survey
11934.00	88.921	0.562	7373.91	4175.06	4083.07	871.56	40°11'14.514"N	104°47'10.700"W	0.00	Projection to Bit



Actual Wellpath Report

WEISS 29C-33HZ AWP

Page 7 of 8



REFERENCE WELLPATH IDENTIFICATION

Operator	KERR-MCGEE OIL & GAS ONSHORE LP	Slot	SLOT#23 WEISS 29C-33HZ (712'FSL & 616'FWL, SEC.33)
Area	COLORADO	Well	WEISS 29C-33HZ
Field	WELD COUNTY (KERR MCGEE)	Wellbore	WEISS 29C-33HZ AWB
Facility	SEC.33-T3N-R66W		

HOLE & CASING SECTIONS - Ref Wellbore: WEISS 29C-33HZ AWB Ref Wellpath: WEISS 29C-33HZ AWP

String/Diameter	Start MD [ft]	End MD [ft]	Interval [ft]	Start TVD [ft]	End TVD [ft]	Start N/S [ft]	Start E/W [ft]	End N/S [ft]	End E/W [ft]
13.5in Open Hole	17.00	719.00	702.00	17.00	719.00	0.00	0.00	-1.29	0.30
9.625in Casing Surface	17.00	719.00	702.00	17.00	719.00	0.00	0.00	-1.29	0.30
8.75in Open Hole	719.00	7880.00	7161.00	719.00	7388.57	-1.29	0.30	31.10	852.20
7in Casing Intermediate	17.00	7870.00	7853.00	17.00	7388.32	0.00	0.00	21.11	851.81
6.125in Open Hole	7870.00	11934.00	4064.00	7388.32	7373.91	21.11	851.81	4083.07	871.56

TARGETS

Name	MD [ft]	TVD [ft]	North [ft]	East [ft]	Grid East [US ft]	Grid North [US ft]	Latitude	Longitude	Shape
RICE 15-33HZ PAD SECTION LINES		-27.00	-73.83	2635.69	3201189.88	1307759.68	40°10'33.434"N	104°46'47.975"W	polygon
RICE 15-33HZ PAD HARDLINES (460' SETBACKS)		7151.00	-73.83	2635.69	3201189.88	1307759.68	40°10'33.434"N	104°46'47.975"W	polygon
WEISS 29C-33HZ BHL (460'FNL & 1525'FWL, SEC.33) REV-2		7391.00	4108.59	915.31	3199436.12	1311928.00	40°11'14.766"N	104°47'10.136"W	point
WEISS 29C-33HZ BHL ON PLAT (460'FNL & 1575'FWL, SEC.33) REV-1		7391.00	4108.59	965.31	3199486.12	1311928.40	40°11'14.766"N	104°47'09.492"W	point

WELLPATH COMPOSITION - Ref Wellbore: WEISS 29C-33HZ AWB Ref Wellpath: WEISS 29C-33HZ AWP

Start MD [ft]	End MD [ft]	Positional Uncertainty Model	Log Name/Comment	Wellbore
17.00	10340.00	Generic gyro - continuous (Standard)	GYRO SURVEYS <100-10340>	WEISS 29C-33HZ AWB
10340.00	11875.00	OnTrak (Standard)	BHI MWD SURVEYS 6 1/8" HOLE <10418-11875>	WEISS 29C-33HZ AWB
11875.00	11934.00	Blind Drilling (std)	Projection to bit	WEISS 29C-33HZ AWB



Actual Wellpath Report

WEISS 29C-33HZ AWP

Page 8 of 8



REFERENCE WELLPATH IDENTIFICATION

Operator	KERR-MCGEE OIL & GAS ONSHORE LP	Slot	SLOT#23 WEISS 29C-33HZ (712'FSL & 616'FWL, SEC.33)
Area	COLORADO	Well	WEISS 29C-33HZ
Field	WELD COUNTY (KERR MCGEE)	Wellbore	WEISS 29C-33HZ AWB
Facility	SEC.33-T3N-R66W		

WELLPATH COMMENTS

MD [ft]	Inclination [°]	Azimuth [°]	TVD [ft]	Comment
17.00	0.000	155.295	17.00	Tie-On
100.00	0.391	155.295	100.00	Begin GYRO Surveys
7870.00	88.495	2.215	7388.32	7" Casing Point
10340.00	88.928	359.542	7375.15	Tie-Into GYRO Surveys
10418.00	90.373	0.306	7375.62	Begin BHI MWD Surveys
11875.00	88.921	0.562	7372.80	Last BHI MWD Survey
11934.00	88.921	0.562	7373.91	Projection to Bit