

TEKTON WINDSOR, LLC

Location	Windsor, CO, USA	Slot	Slot #9
Field	Windsor Project	Well	RANCHO WATER VALLEY 9 #8-7-33-000-4-CH
Installation	Rancho Water Valley	Wellbore	RANCHO WATER VALLEY 9 #8-7-33-000-4-CH (PWB)

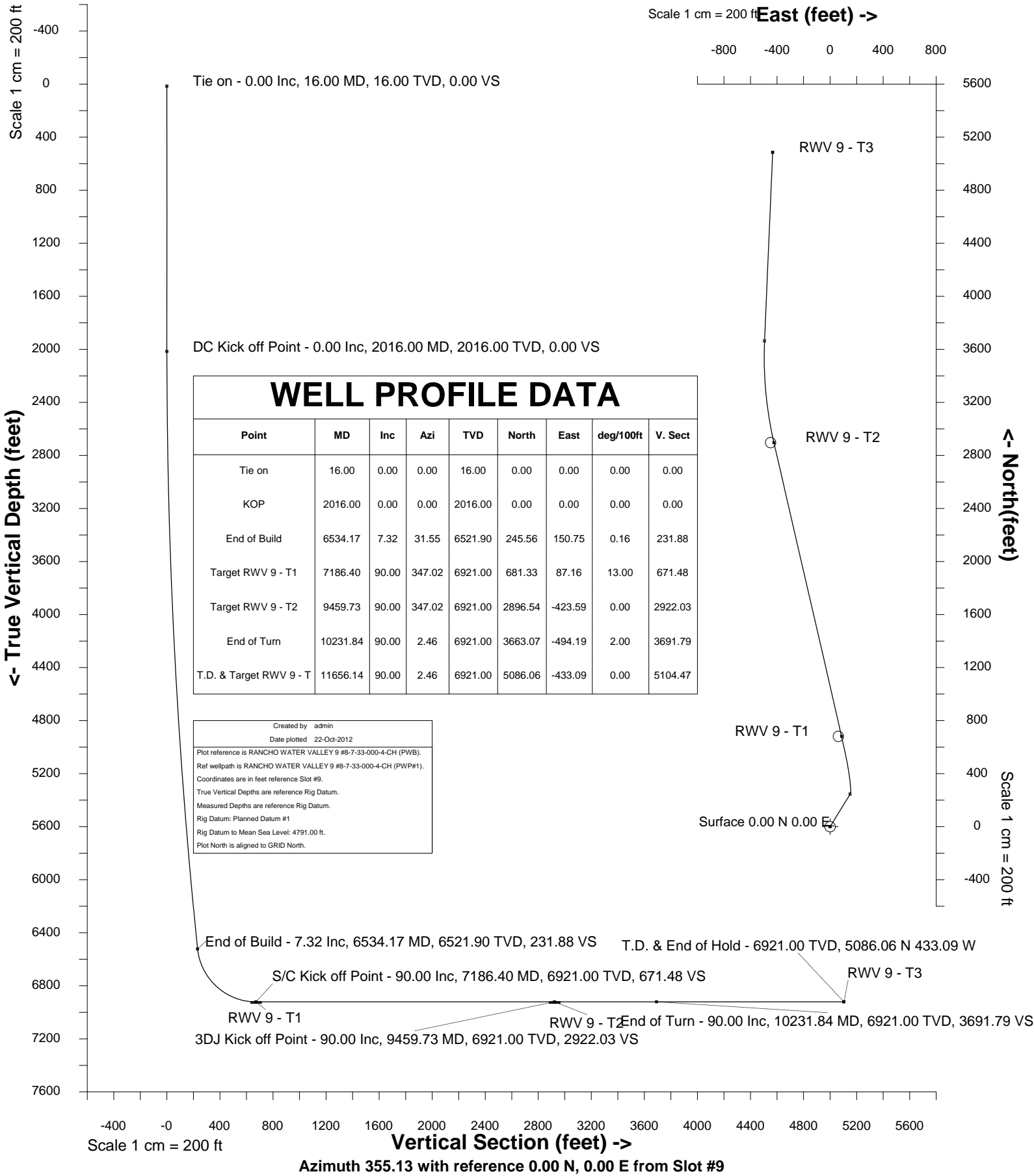



SYSDRILL
Well Design Combined Report
Wellbore: RANCHO WATER VALLEY 9 #8-7-33-000-4-CH (PWB)
Wellpath: RANCHO WATER VALLEY 9 #8-7-33-000-4-CH (PWP#1)

Wellhead Details

Name	Northing	Easting	Latitude	Longitude	North	East
Slot #9	1402073.4735	3170263.1365	N40 26 7.7335	W104 53 18.0240	0.00N	80.73W

Site Details

Name	Northing	Easting	Coord System Name	North Alignment
Rancho Water Valley	1402073.4733	3170343.8622	CO83-NF on NORTH AMERICAN DATUM 1983 datum	Grid

Summary Wellpath

MD[ft]	Inc[deg]	Azi[deg]	TVD[ft]	North[ft]	East[ft]	Dogleg [deg/100ft]	Vertical Section[ft]	Northing	Easting
16.00	0.00	0.000	16.00	0.00N	0.00E		0.00	1402073.47	3170263.14
2016.00	0.00	0.000	2016.00	0.00N	0.00E	==>	0.00	1402073.47	3170263.14
6534.17	7.32	31.550	6521.90	245.56N	150.75E	0.16	231.88	1402319.02	3170413.88
7186.40	90.00	347.020	6921.00	681.33N	87.16E	13.00	671.48	1402754.77	3170350.30
9459.73	90.00	347.020	6921.00	2896.54N	423.59W	==>	2922.03	1404969.90	3169839.56
10231.84	90.00	2.460	6921.00	3663.07N	494.19W	2.00	3691.79	1405736.40	3169768.97
11656.14	90.00	2.460	6921.00	5086.06N	433.09W	==>	5104.47	1407159.33	3169830.06

Interpolated Wellpath

MD[ft]	Inc[deg]	Azi[deg]	TVD[ft]	North[ft]	East[ft]	Dogleg [deg/100ft]	Vertical Section[ft]	Northing	Easting
0.00	0.00	0.000	0.00	0.00N	0.00E		0.00	1402073.47	3170263.14
16.00	0.00	0.000	16.00	0.00N	0.00E	==>	0.00	1402073.47	3170263.14
100.00	0.00	0.000	100.00	0.00N	0.00E	==>	0.00	1402073.47	3170263.14
200.00	0.00	0.000	200.00	0.00N	0.00E	==>	0.00	1402073.47	3170263.14
300.00	0.00	0.000	300.00	0.00N	0.00E	==>	0.00	1402073.47	3170263.14
400.00	0.00	0.000	400.00	0.00N	0.00E	==>	0.00	1402073.47	3170263.14
500.00	0.00	0.000	500.00	0.00N	0.00E	==>	0.00	1402073.47	3170263.14
600.00	0.00	0.000	600.00	0.00N	0.00E	==>	0.00	1402073.47	3170263.14
700.00	0.00	0.000	700.00	0.00N	0.00E	==>	0.00	1402073.47	3170263.14
800.00	0.00	0.000	800.00	0.00N	0.00E	==>	0.00	1402073.47	3170263.14
900.00	0.00	0.000	900.00	0.00N	0.00E	==>	0.00	1402073.47	3170263.14
1000.00	0.00	0.000	1000.00	0.00N	0.00E	==>	0.00	1402073.47	3170263.14
1100.00	0.00	0.000	1100.00	0.00N	0.00E	==>	0.00	1402073.47	3170263.14
1200.00	0.00	0.000	1200.00	0.00N	0.00E	==>	0.00	1402073.47	3170263.14
1300.00	0.00	0.000	1300.00	0.00N	0.00E	==>	0.00	1402073.47	3170263.14
1400.00	0.00	0.000	1400.00	0.00N	0.00E	==>	0.00	1402073.47	3170263.14
1500.00	0.00	0.000	1500.00	0.00N	0.00E	==>	0.00	1402073.47	3170263.14
1600.00	0.00	0.000	1600.00	0.00N	0.00E	==>	0.00	1402073.47	3170263.14
1700.00	0.00	0.000	1700.00	0.00N	0.00E	==>	0.00	1402073.47	3170263.14
1800.00	0.00	0.000	1800.00	0.00N	0.00E	==>	0.00	1402073.47	3170263.14
1900.00	0.00	0.000	1900.00	0.00N	0.00E	==>	0.00	1402073.47	3170263.14
2000.00	0.00	0.000	2000.00	0.00N	0.00E	==>	0.00	1402073.47	3170263.14
2016.00	0.00	0.000	2016.00	0.00N	0.00E	==>	0.00	1402073.47	3170263.14
2100.00	0.14	31.550	2100.00	0.08N	0.05E	0.16	0.08	1402073.56	3170263.19
2200.00	0.30	31.550	2200.00	0.41N	0.25E	0.16	0.39	1402073.88	3170263.39
2300.00	0.46	31.550	2300.00	0.97N	0.60E	0.16	0.92	1402074.44	3170263.73
2400.00	0.62	31.550	2399.99	1.78N	1.09E	0.16	1.68	1402075.25	3170264.23
2500.00	0.78	31.550	2499.98	2.82N	1.73E	0.16	2.66	1402076.30	3170264.87
2600.00	0.95	31.550	2599.97	4.11N	2.52E	0.16	3.88	1402077.58	3170265.66
2700.00	1.11	31.550	2699.96	5.64N	3.46E	0.16	5.32	1402079.11	3170266.60
2800.00	1.27	31.550	2799.94	7.40N	4.55E	0.16	6.99	1402080.88	3170267.68
2900.00	1.43	31.550	2899.91	9.41N	5.78E	0.16	8.89	1402082.89	3170268.91
3000.00	1.59	31.550	2999.87	11.66N	7.16E	0.16	11.01	1402085.14	3170270.30
3100.00	1.76	31.550	3099.83	14.15N	8.69E	0.16	13.36	1402087.63	3170271.82
3200.00	1.92	31.550	3199.78	16.88N	10.37E	0.16	15.94	1402090.36	3170273.50
3300.00	2.08	31.550	3299.72	19.86N	12.19E	0.16	18.75	1402093.33	3170275.33
3400.00	2.24	31.550	3399.65	23.07N	14.16E	0.16	21.78	1402096.54	3170277.30
3500.00	2.40	31.550	3499.56	26.52N	16.28E	0.16	25.05	1402100.00	3170279.42
3600.00	2.57	31.550	3599.47	30.22N	18.55E	0.16	28.53	1402103.69	3170281.69
3700.00	2.73	31.550	3699.36	34.15N	20.97E	0.16	32.25	1402107.62	3170284.10
3800.00	2.89	31.550	3799.24	38.33N	23.53E	0.16	36.19	1402111.80	3170286.67
3900.00	3.05	31.550	3899.11	42.74N	26.24E	0.16	40.36	1402116.22	3170289.38
4000.00	3.21	31.550	3998.96	47.40N	29.10E	0.16	44.76	1402120.87	3170292.24
4100.00	3.38	31.550	4098.79	52.30N	32.11E	0.16	49.39	1402125.77	3170295.24
4200.00	3.54	31.550	4198.61	57.44N	35.26E	0.16	54.24	1402130.91	3170298.40
4300.00	3.70	31.550	4298.41	62.81N	38.56E	0.16	59.32	1402136.29	3170301.70
4400.00	3.86	31.550	4398.20	68.43N	42.01E	0.16	64.62	1402141.90	3170305.15
4500.00	4.02	31.550	4497.96	74.29N	45.61E	0.16	70.15	1402147.76	3170308.74
4600.00	4.19	31.550	4597.70	80.39N	49.35E	0.16	75.91	1402153.86	3170312.49
4700.00	4.35	31.550	4697.43	86.73N	53.25E	0.16	81.90	1402160.20	3170316.38
4800.00	4.51	31.550	4797.13	93.31N	57.28E	0.16	88.11	1402166.78	3170320.42
4900.00	4.67	31.550	4896.81	100.13N	61.47E	0.16	94.55	1402173.60	3170324.61

All data is in Feet unless otherwise stated
Coordinates are from Slot MD's are from Rig and TVD's are from Rig (Planned Datum #1 4791.0ft above Mean Sea Level)
Vertical Section is from 0.00N 0.00E on azimuth 355.130 degrees
Bottom hole distance is 5104.47 Feet on azimuth 355.13 degrees from Wellhead
Calculation method uses Minimum Curvature method
Prepared by Peterson Energy
Date Printed: 22-Oct-2012



SYSDRILL
Well Design Combined Report
Wellbore: RANCHO WATER VALLEY 9 #8-7-33-000-4-CH (PWB)
Wellpath: RANCHO WATER VALLEY 9 #8-7-33-000-4-CH (PWP#1)

Interpolated Wellpath

MD[ft]	Inc[deg]	Azi[deg]	TVD[ft]	North[ft]	East[ft]	Dogleg [deg/100ft]	Vertical Section[ft]	Northing	Easting
5000.00	4.83	31.550	4996.46	107.19N	65.81E	0.16	101.22	1402180.66	3170328.94
5100.00	4.99	31.550	5096.09	114.49N	70.29E	0.16	108.12	1402187.96	3170333.42
5200.00	5.16	31.550	5195.70	122.03N	74.92E	0.16	115.24	1402195.50	3170338.05
5300.00	5.32	31.550	5295.29	129.81N	79.69E	0.16	122.58	1402203.28	3170342.83
5400.00	5.48	31.550	5394.84	137.83N	84.62E	0.16	130.16	1402211.30	3170347.75
5500.00	5.64	31.550	5494.37	146.09N	89.69E	0.16	137.96	1402219.56	3170352.82
5600.00	5.80	31.550	5593.87	154.59N	94.90E	0.16	145.98	1402228.06	3170358.04
5700.00	5.97	31.550	5693.34	163.33N	100.27E	0.16	154.23	1402236.80	3170363.40
5800.00	6.13	31.550	5792.79	172.31N	105.78E	0.16	162.71	1402245.78	3170368.91
5900.00	6.29	31.550	5892.20	181.53N	111.44E	0.16	171.42	1402254.99	3170374.57
6000.00	6.45	31.550	5991.58	190.98N	117.25E	0.16	180.35	1402264.45	3170380.38
6100.00	6.61	31.550	6090.93	200.68N	123.20E	0.16	189.51	1402274.15	3170386.33
6200.00	6.78	31.550	6190.25	210.62N	129.30E	0.16	198.89	1402284.08	3170392.43
6300.00	6.94	31.550	6289.54	220.79N	135.55E	0.16	208.50	1402294.26	3170398.68
6400.00	7.10	31.550	6388.79	231.21N	141.94E	0.16	218.33	1402304.67	3170405.07
6500.00	7.26	31.550	6488.00	241.86N	148.48E	0.16	228.39	1402315.33	3170411.61
6534.17	7.32	31.550	6521.90	245.56N	150.75E	0.16	231.88	1402319.02	3170413.88
6600.00	14.68	7.120	6586.50	257.43N	153.98E	13.00	243.44	1402330.89	3170417.11
6700.00	27.22	357.100	6679.73	293.00N	154.40E	13.00	278.84	1402366.46	3170417.53
6800.00	40.04	353.170	6762.83	348.02N	149.39E	13.00	334.09	1402421.48	3170412.52
6900.00	52.94	350.920	6831.53	419.67N	139.22E	13.00	406.34	1402493.12	3170402.35
7000.00	65.87	349.330	6882.32	504.27N	124.41E	13.00	491.90	1402577.73	3170387.54
7100.00	78.81	348.040	6912.59	597.50N	105.71E	13.00	586.38	1402670.95	3170368.84
7186.40	90.00	347.020	6921.00	681.33N	87.16E	13.00	671.48	1402754.77	3170350.30
7200.00	90.00	347.020	6921.00	694.58N	84.11E	==>	684.94	1402768.02	3170347.24
7300.00	90.00	347.020	6921.00	792.02N	61.64E	==>	783.93	1402865.46	3170324.77
7400.00	90.00	347.020	6921.00	889.46N	39.17E	==>	882.93	1402962.90	3170302.31
7500.00	90.00	347.020	6921.00	986.91N	16.71E	==>	981.93	1403060.34	3170279.84
7600.00	90.00	347.020	6921.00	1084.35N	5.76W	==>	1080.93	1403157.78	3170257.38
7700.00	90.00	347.020	6921.00	1181.79N	28.23W	==>	1179.93	1403255.22	3170234.91
7800.00	90.00	347.020	6921.00	1279.24N	50.70W	==>	1278.93	1403352.66	3170212.44
7900.00	90.00	347.020	6921.00	1376.68N	73.16W	==>	1377.92	1403450.10	3170189.98
8000.00	90.00	347.020	6921.00	1474.12N	95.63W	==>	1476.92	1403547.54	3170167.51
8100.00	90.00	347.020	6921.00	1571.57N	118.10W	==>	1575.92	1403644.98	3170145.04
8200.00	90.00	347.020	6921.00	1669.01N	140.56W	==>	1674.92	1403742.42	3170122.58
8300.00	90.00	347.020	6921.00	1766.45N	163.03W	==>	1773.92	1403839.86	3170100.11
8400.00	90.00	347.020	6921.00	1863.90N	185.50W	==>	1872.92	1403937.30	3170077.65
8500.00	90.00	347.020	6921.00	1961.34N	207.96W	==>	1971.91	1404034.74	3170055.18
8600.00	90.00	347.020	6921.00	2058.78N	230.43W	==>	2070.91	1404132.18	3170032.71
8700.00	90.00	347.020	6921.00	2156.23N	252.90W	==>	2169.91	1404229.62	3170010.25
8800.00	90.00	347.020	6921.00	2253.67N	275.37W	==>	2268.91	1404327.06	3169987.78
8900.00	90.00	347.020	6921.00	2351.12N	297.83W	==>	2367.91	1404424.49	3169965.32
9000.00	90.00	347.020	6921.00	2448.56N	320.30W	==>	2466.91	1404521.93	3169942.85
9100.00	90.00	347.020	6921.00	2546.00N	342.77W	==>	2565.90	1404619.37	3169920.38
9200.00	90.00	347.020	6921.00	2643.45N	365.23W	==>	2664.90	1404716.81	3169897.92
9300.00	90.00	347.020	6921.00	2740.89N	387.70W	==>	2763.90	1404814.25	3169875.45
9400.00	90.00	347.020	6921.00	2838.33N	410.17W	==>	2862.90	1404911.69	3169852.98
9459.73	90.00	347.020	6921.00	2896.54N	423.59W	==>	2922.03	1404969.90	3169839.56
9500.00	90.00	347.820	6921.00	2935.84N	432.36W	2.00	2961.94	1405009.19	3169830.79
9600.00	90.00	349.820	6921.00	3033.94N	451.74W	2.00	3061.32	1405107.29	3169811.41
9700.00	90.00	351.820	6921.00	3132.65N	467.69W	2.00	3161.04	1405206.00	3169795.46
9800.00	90.00	353.820	6921.00	3231.86N	480.19W	2.00	3260.95	1405305.21	3169782.97
9900.00	90.00	355.820	6921.00	3331.45N	489.21W	2.00	3360.94	1405404.79	3169773.94
10000.00	90.00	357.820	6921.00	3431.29N	494.76W	2.00	3460.90	1405504.63	3169768.40
10100.00	90.00	359.820	6921.00	3531.26N	496.81W	2.00	3560.68	1405604.60	3169766.34
10200.00	90.00	1.820	6921.00	3631.25N	495.38W	2.00	3660.19	1405704.58	3169767.78
10231.84	90.00	2.460	6921.00	3663.07N	494.19W	2.00	3691.79	1405736.40	3169768.97
10300.00	90.00	2.460	6921.00	3731.16N	491.27W	==>	3759.39	1405804.49	3169771.89
10400.00	90.00	2.460	6921.00	3831.07N	486.98W	==>	3858.57	1405904.39	3169776.18
10500.00	90.00	2.460	6921.00	3930.98N	482.69W	==>	3957.76	1406004.30	3169780.47
10600.00	90.00	2.460	6921.00	4030.89N	478.40W	==>	4056.94	1406104.20	3169784.76
10700.00	90.00	2.460	6921.00	4130.80N	474.11W	==>	4156.13	1406204.10	3169789.05
10800.00	90.00	2.460	6921.00	4230.70N	469.82W	==>	4255.31	1406304.01	3169793.34
10900.00	90.00	2.460	6921.00	4330.61N	465.53W	==>	4354.49	1406403.91	3169797.63
11000.00	90.00	2.460	6921.00	4430.52N	461.24W	==>	4453.68	1406503.82	3169801.92
11100.00	90.00	2.460	6921.00	4530.43N	456.95W	==>	4552.86	1406603.72	3169806.21
11200.00	90.00	2.460	6921.00	4630.33N	452.66W	==>	4652.04	1406703.62	3169810.50
11300.00	90.00	2.460	6921.00	4730.24N	448.37W	==>	4751.23	1406803.53	3169814.79
11400.00	90.00	2.460	6921.00	4830.15N	444.08W	==>	4850.41	1406903.43	3169819.08
11500.00	90.00	2.460	6921.00	4930.06N	439.79W	==>	4949.60	1407003.34	3169823.37
11600.00	90.00	2.460	6921.00	5029.97N	435.50W	==>	5048.78	1407103.24	3169827.66
11656.14	90.00	2.460	6921.00	5086.06N	433.09W	==>	5104.47	1407159.33	3169830.06

All data is in Feet unless otherwise stated
Coordinates are from Slot MD's are from Rig and TVD's are from Rig (Planned Datum #1 4791.0ft above Mean Sea Level)
Vertical Section is from 0.00N 0.00E on azimuth 355.130 degrees
Bottom hole distance is 5104.47 Feet on azimuth 355.13 degrees from Wellhead
Calculation method uses Minimum Curvature method
Prepared by Peterson Energy
Date Printed: 22-Oct-2012



SYSDRILL
Well Design Combined Report
Wellbore: RANCHO WATER VALLEY 9 #8-7-33-000-4-CH (PWB)
Wellpath: RANCHO WATER VALLEY 9 #8-7-33-000-4-CH (PWP#1)

Targets

Name	North[ft]	East[ft]	TVD[ft]	Latitude	Longitude	Northing	Easting	Last Revised
RWV 9 - T1	681.33N	87.16E	6921.00	N40 26 14.4600	W104 53 16.8360	1402754.77	3170350.30	19-Oct-2012
RWV 9 - T2	2896.54N	423.59W	6921.00	N40 26 36.3840	W104 53 23.2440	1404969.90	3169839.56	19-Oct-2012
RWV 9 - T3	5086.06N	433.09W	6921.00	N40 26 58.0200	W104 53 23.1720	1407159.33	3169830.06	19-Oct-2012

Survey Tool Program

Reference	Survey Name	MD[ft]	TVD[ft]	Survey Tool	Error Model
5276	Planned	11656.14	6921.00	ISCWSA MWD	Rev 0

Notes

All data is in Feet unless otherwise stated
Coordinates are from Slot MD's are from Rig and TVD's are from Rig (Planned Datum #1 4791.0ft above Mean Sea Level)
Vertical Section is from 0.00N 0.00E on azimuth 355.130 degrees
Bottom hole distance is 5104.47 Feet on azimuth 355.13 degrees from Wellhead
Calculation method uses Minimum Curvature method
Prepared by Peterson Energy
Date Printed: 22-Oct-2012



SYSDRILL

Closest Approach + Clearance Factor Summary Report
Wellbore: RANCHO WATER VALLEY 9 #8-7-33-000-4-CH (PWB)
Wellpath: RANCHO WATER VALLEY 9 #8-7-33-000-4-CH (PWP#1)

Ellipse separations are reported ONLY if BOTH wells have uncertainty data
Only Depth and Magnetic Reference Field error terms are correlated across tie points
Cutoff is calculated on CENTRE to CENTRE distance

Summary data uses Closest Approach clearance calculation for all minima
Hole size/Casings ARE included
Hole size/Casings are NOT subtracted from Centre-Centre distance
Confidence limit of 95.00% / 2.80 SD.

Wellbore

Name	Created	Last Revised
RANCHO WATER VALLEY 9 #8-7-33-000-4-CH (PWB)	17-Oct-2012	17-Oct-2012

Well

Name	Government ID	Last Revised
RANCHO WATER VALLEY 9 #8-7-33-000-4-CH		17-Oct-2012

Slot

Name	Grid Northing	Grid Easting	Latitude	Longitude	North	East
Slot #9	1402073.4735	3170263.1365	N40 26 7.7335	W104 53 18.0240	0.00N	80.73W

Installation

Name	Easting	Northing	Coord System Name	North Alignment
Rancho Water Valley	3170343.8622	1402073.4733	CO83-NF on NORTH AMERICAN DATUM 1983 datum	Grid

Field

Name	Easting	Northing	Coord System Name	North Alignment
Windsor Project	3162710.0707	1407271.6545	CO83-NF on NORTH AMERICAN DATUM 1983 datum	Grid

Clearance Summary

Offset WellName	Offset Wellbore	Offset Slot	Offset Structure	Separation [ft]	MD[ft]	Diverging From[ft]	Ellipse Separation [ft]	Ellipse MD[ft]	Clearance Factor	Clearance MD[ft]
RANCHO WATER VALLEY 10 #7-8-33-27 0-4-NH	RANCHO WATER VALLEY 10 #7-8-33-270-4 -NH (PWB)	Slot #10	Rancho Water Valley	12.72	2263.38	7234.88	9.41	2296.18	3.80	2345.40
RANCHO WATER VALLEY 8 #7-8-33-27 0-5-CH	RANCHO WATER VALLEY 8 #7-8-33-270-5 -CH (PWB)	Slot #8	Rancho Water Valley	16.70	1984.50	11656.14	13.71	2000.91	1.76	11656.14
RANCHO WATER VALLEY 11 #7-7-33-27 0-6-CH	RANCHO WATER VALLEY 11 #7-7-33-270-6 -CH (PWB)	Slot #11	Rancho Water Valley	29.04	2148.55	7397.33	26.12	2181.35	2.34	7397.33
RANCHO WATER VALLEY 7 #8-7-33-00 0-4-NH	RANCHO WATER VALLEY 7 #8-7-33-000-4 -NH (PWB)	Slot #7	Rancho Water Valley	33.41	1616.00	6815.03	30.89	1616.00	3.17	6790.93
RANCHO WATER VALLEY 12 #7-7-33-27 0-4-NH	RANCHO WATER VALLEY 12 #7-7-33-270-4 -NH (PWB)	Slot #12	Rancho Water Valley	45.73	2000.91	7565.96	42.89	2017.31	6.02	7578.34
RANCHO WATER VALLEY 6 #0-7-4-270 -5-NH	RANCHO WATER VALLEY 6 #0-7-4-270-5 -NH (PWB)	Slot #6	Rancho Water Valley	49.78	2300.21	6657.04	46.44	2300.21	10.37	6610.49
RANCHO WATER VALLEY #2-6-4	RANCHO WATER VALLEY #2-6-4 (AWB)	Slot #3	Rancho Water Valley	56.80	887.17	887.17	53.41	887.17	15.91	951.04
RANCHO WATER VALLEY 13 #7-6-33-27 0-6-CH	RANCHO WATER VALLEY 13 #7-6-33-270-6 -CH (PWB)	Slot #13	Rancho Water Valley	63.83	1574.40	8048.73	44.85	8054.06	1.86	8054.06
RANCHO	RANCHO	Slot #5	Rancho	64.03	1738.44	1738.44	61.42	1738.44	24.44	1820.46

All data is in Feet unless otherwise stated
Coordinates are from Slot MD's are from Rig and TVD's are from Rig (Planned Datum #1 4791.0ft above Mean Sea Level)
Vertical Section is from 0.00N 0.00E on azimuth 355.130 degrees
Prepared by Peterson Energy
Date Printed: 22-Oct-2012



SYSDRILL
Closest Approach + Clearance Factor Summary Report
Wellbore: RANCHO WATER VALLEY 9 #8-7-33-000-4-CH (PWB)
Wellpath: RANCHO WATER VALLEY 9 #8-7-33-000-4-CH (PWP#1)

Clearance Summary

Offset WellName	Offset Wellbore	Offset Slot	Offset Structure	Separation [ft]	MD[ft]	Diverging From[ft]	Ellipse Separation [ft]	Ellipse MD[ft]	Clearance Factor	Clearance MD[ft]
WATER VALLEY 5 #7-2-4-270-4-NH	WATER VALLEY 5 #7-2-4-270-4-NH (PWB)	Slot #4	Water Valley							
RANCHO WATER VALLEY 4 #7-1-4-270-4-NH	RANCHO WATER VALLEY 4 #7-1-4-270-4-NH (PWB)		Rancho Water Valley	80.73	1500.00	6561.28	78.31	1500.00	32.83	1656.42
RANCHO WATER VALLEY 2-8-4	RANCHO WATER VALLEY 2-8-4 (AWB)		Rancho Water Valley	94.89	1651.37	1651.37	91.26	1656.42	23.72	1853.27
RANCHO WATER VALLEY #3-9-4	RANCHO WATER VALLEY #3-9-4 (AWB)	Slot #1	Rancho Water Valley	130.89	17.00	537.47	129.66	540.93	47.41	1049.46