

TEKTON WINDSOR, LLC			
Location	Windsor, CO, USA	Slot	Slot #7
Field	Windsor Project	Well	RANCHO WATER VALLEY 7 #7-8-33-270-5-CH
Installation	Rancho Water Valley	Wellbore	RANCHO WATER VALLEY 7 #7-8-33-270-5-CH (PWB)

Location	Windsor, CO, USA	Slot	Slot #7
Field	Windsor Project	Well	RANCHO WATER VALLEY 7 #7-8-33-270-5-CH
Installation	Rancho Water Valley	Wellbore	RANCHO WATER VALLEY 7 #7-8-33-270-5-CH (PWB)

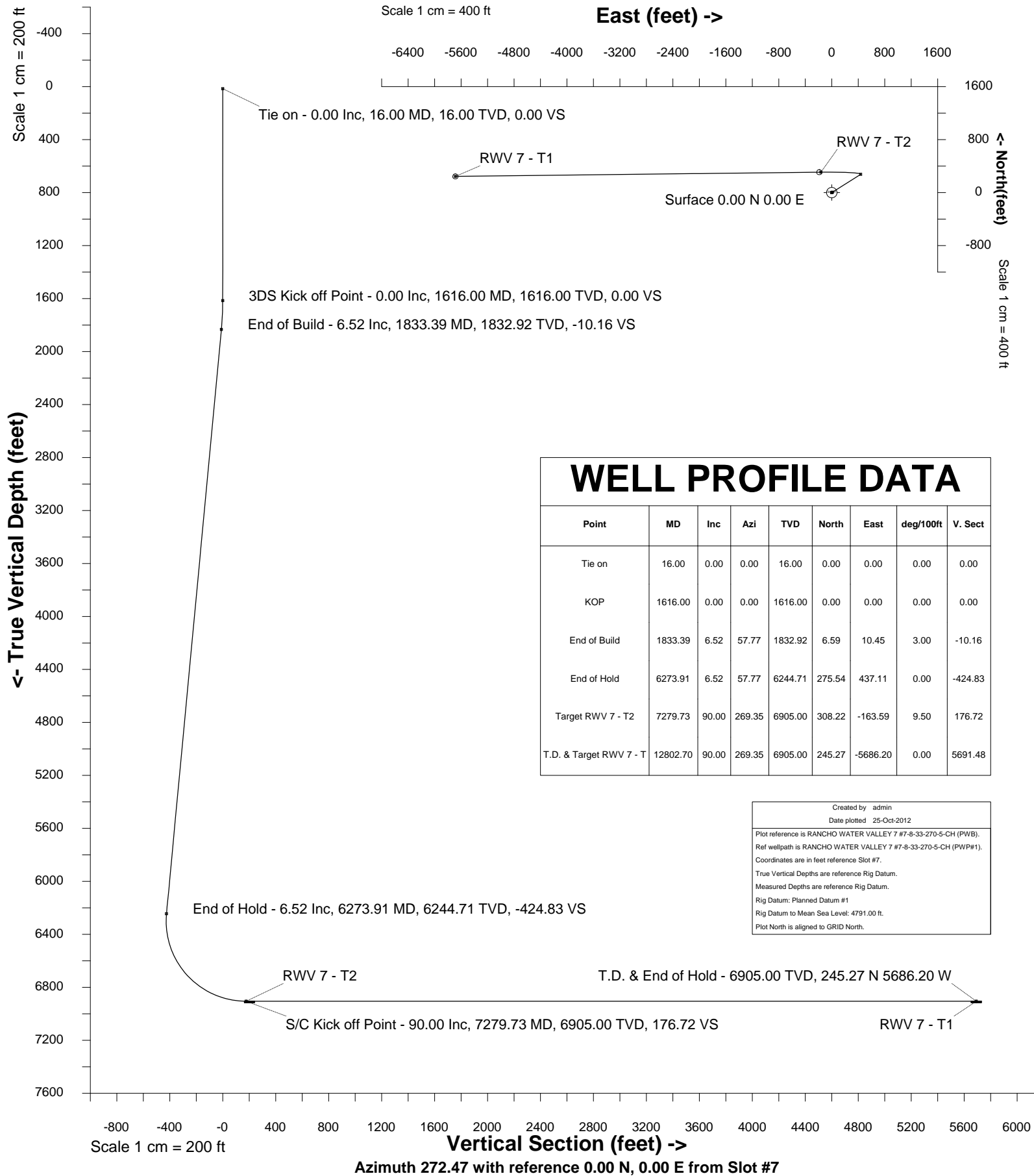



SYSDRILL
Well Design Combined Report
Wellbore: RANCHO WATER VALLEY 7 #7-8-33-270-5-CH (PWB)
Wellpath: RANCHO WATER VALLEY 7 #7-8-33-270-5-CH (PWP#1)

Wellhead Details

Name	Northing	Easting	Latitude	Longitude	North	East
Slot #7	1402073.4734	3170296.5403	N40 26 7.7312	W104 53 17.5920	0.00N	47.32W

Site Details

Name	Northing	Easting	Coord System Name	North Alignment
Rancho Water Valley	1402073.4733	3170343.8622	CO83-NF on NORTH AMERICAN DATUM 1983 datum	Grid

Summary Wellpath

MD[ft]	Inc[deg]	Azi[deg]	TVD[ft]	North[ft]	East[ft]	Dogleg [deg/100ft]	Vertical Section[ft]	Northing	Easting
16.00	0.00	0.000	16.00	0.00N	0.00E		0.00	1402073.47	3170296.54
1616.00	0.00	0.000	1616.00	0.00N	0.00E	==>	0.00	1402073.47	3170296.54
1833.39	6.52	57.770	1832.92	6.59N	10.45E	3.00	-10.16	1402080.06	3170306.99
6273.91	6.52	57.770	6244.71	275.54N	437.11E	==>	-424.83	1402349.00	3170733.63
7279.73	90.00	269.350	6905.00	308.22N	163.59W	9.50	176.72	1402381.68	3170132.96
12802.70	90.00	269.350	6905.00	245.27N	5686.20W	==>	5691.48	1402318.73	3164610.57

Interpolated Wellpath

MD[ft]	Inc[deg]	Azi[deg]	TVD[ft]	North[ft]	East[ft]	Dogleg [deg/100ft]	Vertical Section[ft]	Northing	Easting
0.00	0.00	0.000	0.00	0.00N	0.00E		0.00	1402073.47	3170296.54
16.00	0.00	0.000	16.00	0.00N	0.00E	==>	0.00	1402073.47	3170296.54
100.00	0.00	0.000	100.00	0.00N	0.00E	==>	0.00	1402073.47	3170296.54
200.00	0.00	0.000	200.00	0.00N	0.00E	==>	0.00	1402073.47	3170296.54
300.00	0.00	0.000	300.00	0.00N	0.00E	==>	0.00	1402073.47	3170296.54
400.00	0.00	0.000	400.00	0.00N	0.00E	==>	0.00	1402073.47	3170296.54
500.00	0.00	0.000	500.00	0.00N	0.00E	==>	0.00	1402073.47	3170296.54
600.00	0.00	0.000	600.00	0.00N	0.00E	==>	0.00	1402073.47	3170296.54
700.00	0.00	0.000	700.00	0.00N	0.00E	==>	0.00	1402073.47	3170296.54
800.00	0.00	0.000	800.00	0.00N	0.00E	==>	0.00	1402073.47	3170296.54
900.00	0.00	0.000	900.00	0.00N	0.00E	==>	0.00	1402073.47	3170296.54
1000.00	0.00	0.000	1000.00	0.00N	0.00E	==>	0.00	1402073.47	3170296.54
1100.00	0.00	0.000	1100.00	0.00N	0.00E	==>	0.00	1402073.47	3170296.54
1200.00	0.00	0.000	1200.00	0.00N	0.00E	==>	0.00	1402073.47	3170296.54
1300.00	0.00	0.000	1300.00	0.00N	0.00E	==>	0.00	1402073.47	3170296.54
1400.00	0.00	0.000	1400.00	0.00N	0.00E	==>	0.00	1402073.47	3170296.54
1500.00	0.00	0.000	1500.00	0.00N	0.00E	==>	0.00	1402073.47	3170296.54
1600.00	0.00	0.000	1600.00	0.00N	0.00E	==>	0.00	1402073.47	3170296.54
1616.00	0.00	0.000	1616.00	0.00N	0.00E	==>	0.00	1402073.47	3170296.54
1700.00	2.52	57.770	1699.97	0.98N	1.56E	3.00	-1.52	1402074.46	3170298.10
1800.00	5.52	57.770	1799.72	4.72N	7.49E	3.00	-7.28	1402078.20	3170304.03
1833.39	6.52	57.770	1832.92	6.59N	10.45E	3.00	-10.16	1402080.06	3170306.99
1900.00	6.52	57.770	1899.10	10.62N	16.85E	==>	-16.38	1402084.10	3170313.39
2000.00	6.52	57.770	1998.45	16.68N	26.46E	==>	-25.72	1402090.15	3170323.00
2100.00	6.52	57.770	2097.81	22.74N	36.07E	==>	-35.06	1402096.21	3170332.61
2200.00	6.52	57.770	2197.16	28.80N	45.68E	==>	-44.40	1402102.27	3170342.22
2300.00	6.52	57.770	2296.51	34.85N	55.29E	==>	-53.73	1402108.32	3170351.83
2400.00	6.52	57.770	2395.86	40.91N	64.90E	==>	-63.07	1402114.38	3170361.43
2500.00	6.52	57.770	2495.22	46.97N	74.50E	==>	-72.41	1402120.44	3170371.04
2600.00	6.52	57.770	2594.57	53.02N	84.11E	==>	-81.75	1402126.49	3170380.65
2700.00	6.52	57.770	2693.92	59.08N	93.72E	==>	-91.09	1402132.55	3170390.26
2800.00	6.52	57.770	2793.28	65.14N	103.33E	==>	-100.43	1402138.61	3170399.86
2900.00	6.52	57.770	2892.63	71.19N	112.94E	==>	-109.76	1402144.66	3170409.47
3000.00	6.52	57.770	2991.98	77.25N	122.54E	==>	-119.10	1402150.72	3170419.08
3100.00	6.52	57.770	3091.33	83.31N	132.15E	==>	-128.44	1402156.78	3170428.69
3200.00	6.52	57.770	3190.69	89.36N	141.76E	==>	-137.78	1402162.83	3170438.30
3300.00	6.52	57.770	3290.04	95.42N	151.37E	==>	-147.12	1402168.89	3170447.90
3400.00	6.52	57.770	3389.39	101.48N	160.98E	==>	-156.45	1402174.95	3170457.51
3500.00	6.52	57.770	3488.75	107.53N	170.59E	==>	-165.79	1402181.00	3170467.12
3600.00	6.52	57.770	3588.10	113.59N	180.19E	==>	-175.13	1402187.06	3170476.73
3700.00	6.52	57.770	3687.45	119.65N	189.80E	==>	-184.47	1402193.12	3170486.33
3800.00	6.52	57.770	3786.80	125.70N	199.41E	==>	-193.81	1402199.17	3170495.94
3900.00	6.52	57.770	3886.16	131.76N	209.02E	==>	-203.15	1402205.23	3170505.55
4000.00	6.52	57.770	3985.51	137.82N	218.63E	==>	-212.48	1402211.28	3170515.16
4100.00	6.52	57.770	4084.86	143.87N	228.23E	==>	-221.82	1402217.34	3170524.77
4200.00	6.52	57.770	4184.22	149.93N	237.84E	==>	-231.16	1402223.40	3170534.37
4300.00	6.52	57.770	4283.57	155.99N	247.45E	==>	-240.50	1402229.45	3170543.98
4400.00	6.52	57.770	4382.92	162.04N	257.06E	==>	-249.84	1402235.51	3170553.59
4500.00	6.52	57.770	4482.28	168.10N	266.67E	==>	-259.18	1402241.57	3170563.20
4600.00	6.52	57.770	4581.63	174.16N	276.28E	==>	-268.51	1402247.62	3170572.80
4700.00	6.52	57.770	4680.98	180.21N	285.88E	==>	-277.85	1402253.68	3170582.41
4800.00	6.52	57.770	4780.33	186.27N	295.49E	==>	-287.19	1402259.74	3170592.02
4900.00	6.52	57.770	4879.69	192.33N	305.10E	==>	-296.53	1402265.79	3170601.63

All data is in Feet unless otherwise stated
Coordinates are from Slot MD's are from Rig and TVD's are from Rig (Planned Datum #1 4791.0ft above Mean Sea Level)
Vertical Section is from 0.00N 0.00E on azimuth 272.470 degrees
Bottom hole distance is 5691.48 Feet on azimuth 272.47 degrees from Wellhead
Calculation method uses Minimum Curvature method
Prepared by Peterson Energy
Date Printed: 25-Oct-2012



SYSDRILL
Well Design Combined Report
Wellbore: RANCHO WATER VALLEY 7 #7-8-33-270-5-CH (PWB)
Wellpath: RANCHO WATER VALLEY 7 #7-8-33-270-5-CH (PWP#1)

Interpolated Wellpath

MD[ft]	Inc[deg]	Azi[deg]	TVD[ft]	North[ft]	East[ft]	Dogleg [deg/100ft]	Vertical Section[ft]	Northing	Easting
5000.00	6.52	57.770	4979.04	198.38N	314.71E	==>	-305.87	1402271.85	3170611.24
5100.00	6.52	57.770	5078.39	204.44N	324.32E	==>	-315.20	1402277.91	3170620.84
5200.00	6.52	57.770	5177.75	210.50N	333.92E	==>	-324.54	1402283.96	3170630.45
5300.00	6.52	57.770	5277.10	216.55N	343.53E	==>	-333.88	1402290.02	3170640.06
5400.00	6.52	57.770	5376.45	222.61N	353.14E	==>	-343.22	1402296.08	3170649.67
5500.00	6.52	57.770	5475.80	228.67N	362.75E	==>	-352.56	1402302.13	3170659.27
5600.00	6.52	57.770	5575.16	234.72N	372.36E	==>	-361.90	1402308.19	3170668.88
5700.00	6.52	57.770	5674.51	240.78N	381.96E	==>	-371.23	1402314.25	3170678.49
5800.00	6.52	57.770	5773.86	246.84N	391.57E	==>	-380.57	1402320.30	3170688.10
5900.00	6.52	57.770	5873.22	252.90N	401.18E	==>	-389.91	1402326.36	3170697.71
6000.00	6.52	57.770	5972.57	258.95N	410.79E	==>	-399.25	1402332.42	3170707.31
6100.00	6.52	57.770	6071.92	265.01N	420.40E	==>	-408.59	1402338.47	3170716.92
6200.00	6.52	57.770	6171.27	271.07N	430.01E	==>	-417.92	1402344.53	3170726.53
6273.91	6.52	57.770	6244.71	275.54N	437.11E	==>	-424.83	1402349.00	3170733.63
6300.00	4.60	41.300	6270.67	277.12N	439.05E	9.50	-426.70	1402350.58	3170735.57
6400.00	7.28	297.290	6370.34	283.05N	436.06E	9.50	-423.46	1402356.51	3170732.59
6500.00	16.28	281.170	6468.15	288.68N	416.64E	9.50	-403.81	1402362.15	3170713.16
6600.00	25.64	276.510	6561.44	293.87N	381.31E	9.50	-368.29	1402367.33	3170677.84
6700.00	35.07	274.240	6647.64	298.45N	331.05E	9.50	-317.88	1402371.91	3170627.57
6800.00	44.53	272.840	6724.38	302.32N	267.23E	9.50	-253.95	1402375.78	3170563.76
6900.00	54.00	271.840	6789.56	305.36N	191.60E	9.50	-178.27	1402378.82	3170488.14
7000.00	63.48	271.060	6841.40	307.49N	106.25E	9.50	-92.90	1402380.95	3170402.78
7100.00	72.96	270.400	6878.46	308.65N	13.50E	9.50	-0.19	1402382.11	3170310.04
7200.00	82.44	269.800	6899.75	308.81N	84.09W	9.50	97.32	1402382.27	3170212.45
7279.73	90.00	269.350	6905.00	308.22N	163.59W	9.50	176.72	1402381.68	3170132.96
7300.00	90.00	269.350	6905.00	307.99N	183.85W	==>	196.96	1402381.45	3170112.69
7400.00	90.00	269.350	6905.00	306.85N	283.85W	==>	296.81	1402380.31	3170012.70
7500.00	90.00	269.350	6905.00	305.71N	383.84W	==>	396.66	1402379.17	3169912.71
7600.00	90.00	269.350	6905.00	304.57N	483.83W	==>	496.51	1402378.03	3169812.72
7700.00	90.00	269.350	6905.00	303.43N	583.83W	==>	596.36	1402376.89	3169712.74
7800.00	90.00	269.350	6905.00	302.29N	683.82W	==>	696.21	1402375.75	3169612.75
7900.00	90.00	269.350	6905.00	301.15N	783.82W	==>	796.06	1402374.61	3169512.76
8000.00	90.00	269.350	6905.00	300.01N	883.81W	==>	895.92	1402373.47	3169412.77
8100.00	90.00	269.350	6905.00	298.87N	983.80W	==>	995.77	1402372.33	3169312.78
8200.00	90.00	269.350	6905.00	297.73N	1083.80W	==>	1095.62	1402371.19	3169212.79
8300.00	90.00	269.350	6905.00	296.59N	1183.79W	==>	1195.47	1402370.05	3169112.80
8400.00	90.00	269.350	6905.00	295.45N	1283.78W	==>	1295.32	1402368.91	3169012.81
8500.00	90.00	269.350	6905.00	294.31N	1383.78W	==>	1395.17	1402367.77	3168912.82
8600.00	90.00	269.350	6905.00	293.17N	1483.77W	==>	1495.03	1402366.63	3168812.83
8700.00	90.00	269.350	6905.00	292.03N	1583.76W	==>	1594.88	1402365.49	3168712.84
8800.00	90.00	269.350	6905.00	290.89N	1683.76W	==>	1694.73	1402364.35	3168612.85
8900.00	90.00	269.350	6905.00	289.75N	1783.75W	==>	1794.58	1402363.21	3168512.86
9000.00	90.00	269.350	6905.00	288.61N	1883.74W	==>	1894.43	1402362.07	3168412.87
9100.00	90.00	269.350	6905.00	287.47N	1983.74W	==>	1994.28	1402360.93	3168312.88
9200.00	90.00	269.350	6905.00	286.33N	2083.73W	==>	2094.13	1402359.79	3168212.89
9300.00	90.00	269.350	6905.00	285.19N	2183.72W	==>	2193.99	1402358.65	3168112.90
9400.00	90.00	269.350	6905.00	284.05N	2283.72W	==>	2293.84	1402357.52	3168012.91
9500.00	90.00	269.350	6905.00	282.91N	2383.71W	==>	2393.69	1402356.38	3167912.92
9600.00	90.00	269.350	6905.00	281.77N	2483.70W	==>	2493.54	1402355.24	3167812.93
9700.00	90.00	269.350	6905.00	280.63N	2583.70W	==>	2593.39	1402354.10	3167712.95
9800.00	90.00	269.350	6905.00	279.49N	2683.69W	==>	2693.24	1402352.96	3167612.96
9900.00	90.00	269.350	6905.00	278.35N	2783.69W	==>	2793.09	1402351.82	3167512.97
10000.00	90.00	269.350	6905.00	277.21N	2883.68W	==>	2892.95	1402350.68	3167412.98
10100.00	90.00	269.350	6905.00	276.07N	2983.67W	==>	2992.80	1402349.54	3167312.99
10200.00	90.00	269.350	6905.00	274.93N	3083.67W	==>	3092.65	1402348.40	3167213.00
10300.00	90.00	269.350	6905.00	273.80N	3183.66W	==>	3192.50	1402347.26	3167113.01
10400.00	90.00	269.350	6905.00	272.66N	3283.65W	==>	3292.35	1402346.12	3167013.02
10500.00	90.00	269.350	6905.00	271.52N	3383.65W	==>	3392.20	1402344.98	3166913.03
10600.00	90.00	269.350	6905.00	270.38N	3483.64W	==>	3492.06	1402343.84	3166813.04
10700.00	90.00	269.350	6905.00	269.24N	3583.63W	==>	3591.91	1402342.70	3166713.05
10800.00	90.00	269.350	6905.00	268.10N	3683.63W	==>	3691.76	1402341.56	3166613.06
10900.00	90.00	269.350	6905.00	266.96N	3783.62W	==>	3791.61	1402340.42	3166513.07
11000.00	90.00	269.350	6905.00	265.82N	3883.61W	==>	3891.46	1402339.28	3166413.08
11100.00	90.00	269.350	6905.00	264.68N	3983.61W	==>	3991.31	1402338.14	3166313.09
11200.00	90.00	269.350	6905.00	263.54N	4083.60W	==>	4091.16	1402337.00	3166213.10
11300.00	90.00	269.350	6905.00	262.40N	4183.59W	==>	4191.02	1402335.86	3166113.11
11400.00	90.00	269.350	6905.00	261.26N	4283.59W	==>	4290.87	1402334.72	3166013.12
11500.00	90.00	269.350	6905.00	260.12N	4383.58W	==>	4390.72	1402333.58	3165913.13
11600.00	90.00	269.350	6905.00	258.98N	4483.57W	==>	4490.57	1402332.44	3165813.14
11700.00	90.00	269.350	6905.00	257.84N	4583.57W	==>	4590.42	1402331.30	3165713.16
11800.00	90.00	269.350	6905.00	256.70N	4683.56W	==>	4690.27	1402330.16	3165613.17
11900.00	90.00	269.350	6905.00	255.56N	4783.56W	==>	4790.12	1402329.02	3165513.18
12000.00	90.00	269.350	6905.00	254.42N	4883.55W	==>	4889.98	1402327.88	3165413.19
12100.00	90.00	269.350	6905.00	253.28N	4983.54W	==>	4989.83	1402326.74	3165313.20
12200.00	90.00	269.350	6905.00	252.14N	5083.54W	==>	5089.68	1402325.60	3165213.21

All data is in Feet unless otherwise stated
Coordinates are from Slot MD's are from Rig (Planned Datum #1 4791.0ft above Mean Sea Level)
Vertical Section is from 0.00N 0.00E on azimuth 272.470 degrees
Bottom hole distance is 5691.48 Feet on azimuth 272.47 degrees from Wellhead
Calculation method uses Minimum Curvature method
Prepared by Peterson Energy
Date Printed: 25-Oct-2012



SYSDRILL
Well Design Combined Report
Wellbore: RANCHO WATER VALLEY 7 #7-8-33-270-5-CH (PWB)
Wellpath: RANCHO WATER VALLEY 7 #7-8-33-270-5-CH (PWP#1)

Interpolated Wellpath

MD[ft]	Inc[deg]	Azi[deg]	TVD[ft]	North[ft]	East[ft]	Dogleg [deg/100ft]	Vertical Section[ft]	Northing	Easting
12300.00	90.00	269.350	6905.00	251.00N	5183.53W	==>	5189.53	1402324.46	3165113.22
12400.00	90.00	269.350	6905.00	249.86N	5283.52W	==>	5289.38	1402323.32	3165013.23
12500.00	90.00	269.350	6905.00	248.72N	5383.52W	==>	5389.23	1402322.18	3164913.24
12600.00	90.00	269.350	6905.00	247.58N	5483.51W	==>	5489.09	1402321.04	3164813.25
12700.00	90.00	269.350	6905.00	246.44N	5583.50W	==>	5588.94	1402319.90	3164713.26
12800.00	90.00	269.350	6905.00	245.30N	5683.50W	==>	5688.79	1402318.76	3164613.27
12802.70	90.00	269.350	6905.00	245.27N	5686.20W	==>	5691.48	1402318.73	3164610.57

All data is in Feet unless otherwise stated
Coordinates are from Slot MD's are from Rig and TVD's are from Rig (Planned Datum #1 4791.0ft above Mean Sea Level)
Vertical Section is from 0.00N 0.00E on azimuth 272.470 degrees
Bottom hole distance is 5691.48 Feet on azimuth 272.47 degrees from Wellhead
Calculation method uses Minimum Curvature method
Prepared by Peterson Energy
Date Printed: 25-Oct-2012



SYSDRILL
Well Design Combined Report
Wellbore: RANCHO WATER VALLEY 7 #7-8-33-270-5-CH (PWB)
Wellpath: RANCHO WATER VALLEY 7 #7-8-33-270-5-CH (PWP#1)

Targets

Name	North[ft]	East[ft]	TVD[ft]	Latitude	Longitude	Northing	Easting	Last Revised
RWV 7 - T1	245.27N	5686.20W	6905.00	N40 26 10.5360	W104 54 31.1040	1402318.73	3164610.57	19-Oct-2012
RWV 7 - T2	308.22N	163.59W	6905.00	N40 26 10.7880	W104 53 19.6800	1402381.68	3170132.96	19-Oct-2012

Survey Tool Program

Reference	Survey Name	MD[ft]	TVD[ft]	Survey Tool	Error Model
5201	Planned	12802.70	6905.00	ISCWSA MWD	Rev 0

Notes

All data is in Feet unless otherwise stated
Coordinates are from Slot MD's are from Rig and TVD's are from Rig (Planned Datum #1 4791.0ft above Mean Sea Level)
Vertical Section is from 0.00N 0.00E on azimuth 272.470 degrees
Bottom hole distance is 5691.48 Feet on azimuth 272.47 degrees from Wellhead
Calculation method uses Minimum Curvature method
Prepared by Peterson Energy
Date Printed: 25-Oct-2012



SYSDRILL

Closest Approach + Clearance Factor Summary Report

Wellbore: RANCHO WATER VALLEY 7 #7-8-33-270-5-CH (PWB)
Wellpath: RANCHO WATER VALLEY 7 #7-8-33-270-5-CH (PWP#1)

Ellipse separations are reported ONLY if BOTH wells have uncertainty data
Only Depth and Magnetic Reference Field error terms are correlated across tie points
Cutoff is calculated on CENTRE to CENTRE distance

Summary data uses Closest Approach clearance calculation for all minima
Hole size/Casings ARE included
Hole size/Casings are NOT subtracted from Centre-Centre distance
Confidence limit of 95.00% / 2.80 SD.

Wellbore

Name	Created	Last Revised
RANCHO WATER VALLEY 7 #7-8-33-270-5-CH (PWB)	17-Oct-2012	25-Oct-2012

Well

Name	Government ID	Last Revised
RANCHO WATER VALLEY 7 #7-8-33-270-5-CH		25-Oct-2012

Slot

Name	Grid Northing	Grid Easting	Latitude	Longitude	North	East
Slot #7	1402073.4734	3170296.5403	N40 26 7.7312	W104 53 17.5920	0.00N	47.32W

Installation

Name	Easting	Northing	Coord System Name	North Alignment
Rancho Water Valley	3170343.8622	1402073.4733	CO83-NF on NORTH AMERICAN DATUM 1983 datum	Grid

Field

Name	Easting	Northing	Coord System Name	North Alignment
Windsor Project	3162710.0707	1407271.6545	CO83-NF on NORTH AMERICAN DATUM 1983 datum	Grid

Clearance Summary

Offset WellName	Offset Wellbore	Offset Slot	Offset Structure	Separation [ft]	MD[ft]	Diverging From[ft]	Ellipse Separation [ft]	Ellipse MD[ft]	Clearance Factor	Clearance MD[ft]
RANCHO WATER VALLEY 6 #0-7-4-270-5-NH	RANCHO WATER VALLEY 6 #0-7-4-270-5-NH (PWB)	Slot #6	Rancho Water Valley	8.91	1848.98	12794.87	-11.10	12802.70	0.95	12802.70
RANCHO WATER VALLEY 8 #8-7-33-000-4-0-4-NH	RANCHO WATER VALLEY 8 #8-7-33-000-4-0-4-NH (PWB)	Slot #8	Rancho Water Valley	16.70	1616.00	6748.18	14.16	1616.00	6.54	1640.02
RANCHO WATER VALLEY 5 #7-2-4-270-4-NH	RANCHO WATER VALLEY 5 #7-2-4-270-4-NH (PWB)	Slot #5	Rancho Water Valley	21.63	1869.67	11516.00	18.92	1869.67	3.25	11597.36
RANCHO WATER VALLEY 9 #8-7-33-000-4-0-4-CH	RANCHO WATER VALLEY 9 #8-7-33-000-4-0-4-CH (PWB)	Slot #9	Rancho Water Valley	33.41	1616.00	6958.14	30.89	1616.00	3.12	6949.00
RANCHO WATER VALLEY #2-6-4	RANCHO WATER VALLEY #2-6-4 (AWB)	Slot #3	Rancho Water Valley	39.71	716.77	8738.59	37.22	721.38	6.30	8857.86
RANCHO WATER VALLEY 4 #7-1-4-270-4-NH	RANCHO WATER VALLEY 4 #7-1-4-270-4-NH (PWB)	Slot #4	Rancho Water Valley	46.04	1903.72	11449.73	43.27	1903.72	1.49	11466.13
RANCHO WATER VALLEY 10 #7-8-33-270-4-0-4-NH	RANCHO WATER VALLEY 10 #7-8-33-270-4-0-4-NH (PWB)	Slot #10	Rancho Water Valley	47.32	1616.00	7321.21	44.78	1616.00	2.15	11548.15
RANCHO WATER VALLEY 11 #7-7-33-270-6-0-6-CH	RANCHO WATER VALLEY 11 #7-7-33-270-6-0-6-CH (PWB)	Slot #11	Rancho Water Valley	64.03	1616.00	1616.00	61.51	1616.00	1.35	12802.70
RANCHO	RANCHO	Slot #2	Rancho	71.15	1478.43	7497.01	68.18	1516.00	17.56	7840.80

All data is in Feet unless otherwise stated
Coordinates are from Slot MD's are from Rig and TVD's are from Rig (Planned Datum #1 4791.0ft above Mean Sea Level)
Vertical Section is from 0.00N 0.00E on azimuth 272.470 degrees
Prepared by Peterson Energy
Date Printed: 25-Oct-2012



SYSDRILL
Closest Approach + Clearance Factor Summary Report
Wellbore: RANCHO WATER VALLEY 7 #7-8-33-270-5-CH (PWB)
Wellpath: RANCHO WATER VALLEY 7 #7-8-33-270-5-CH (PWP#1)

Clearance Summary

Offset WellName	Offset Wellbore	Offset Slot	Offset Structure	Separation [ft]	MD[ft]	Diverging From[ft]	Ellipse Separation [ft]	Ellipse MD[ft]	Clearance Factor	Clearance MD[ft]
WATER VALLEY 2-8-4	WATER VALLEY 2-8-4 (AWB)		Water Valley							
RANCHO WATER VALLEY 12 #7-7-33-27	RANCHO WATER VALLEY 12 #7-7-33-270-4	Slot #12	Rancho Water Valley	80.35	1623.61	1623.61	77.83	1623.61	2.18	11646.58
0-4-NH RANCHO WATER VALLEY 13 #7-6-33-27	-NH (PWB) RANCHO WATER VALLEY 13 #7-6-33-270-6	Slot #13	Rancho Water Valley	97.14	1616.00	1616.00	94.63	1616.00	2.83	12802.70
0-6-CH RANCHO WATER VALLEY #3-9-4	-CH (PWB) RANCHO WATER VALLEY #3-9-4 (AWB)	Slot #1	Rancho Water Valley	97.50	17.00	6947.88	96.90	516.00	32.16	8250.91