

US ROCKIES REGION PLANNING

COLORADO NORTHERN ZONE - 83

WELD_DECHANT 28-36HZ PAD

DECHANT 37N-W36HZ

DECHANT 37N-W36HZ

Plan: DECHANT 37N-W36HZ (wp01)

Standard Planning Report

21 March, 2012

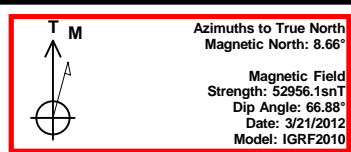
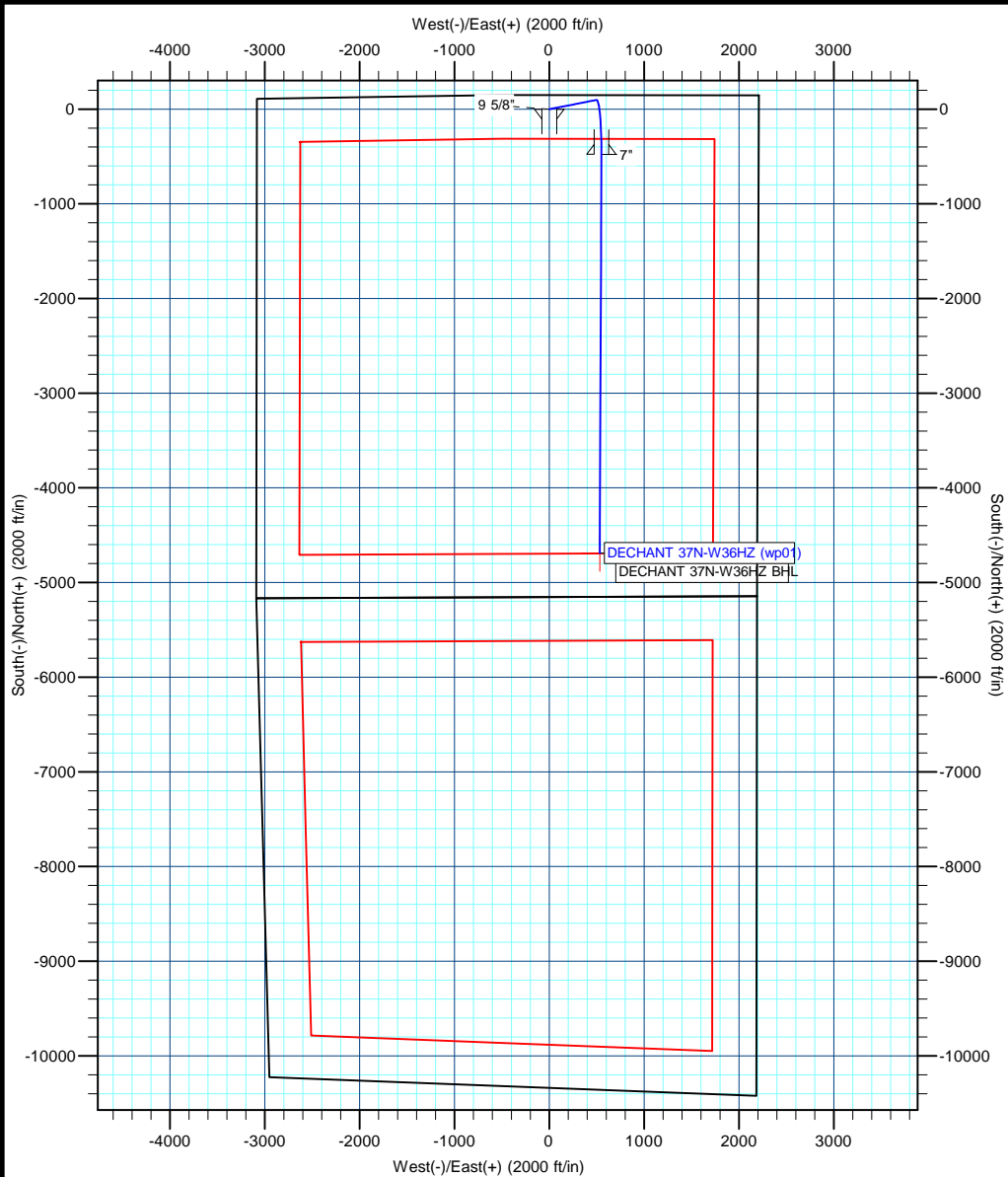

Project: COLORADO NORTHERN ZONE - 83
Site: WELD DECHANT 28-36HZ PAD
Well: DECHANT 37N-W36HZ
Wellbore: DECHANT 37N-W36HZ
Section:
SHL:
Design: DECHANT 37N-W36HZ (wp01)
Latitude: 40.188476
Longitude: -104.610726
GL: 4808.00
KB: GL + RKB @ 4825.00ft

WELL DETAILS: DECHANT 37N-W36HZ

+N/-S	+E/-W	Northing	Ground Level: Easting	4808.00 Latitude	40.188476 Longitude	Slot
0.00	0.00	1312750.21	3248440.61			

SECTION DETAILS

MD	Inc	Azi	TVD	+N/-S	+E/-W	Dleg	TFace	Vsect
0.00	0.00	0.00	0.00	0.00	0.00	0.00	0.00	0.00
900.00	0.00	0.00	900.00	0.00	0.00	0.00	0.00	0.00
1173.16	5.46	78.87	1172.75	2.51	12.77	2.00	78.87	-1.06
6362.86	5.46	78.87	6338.87	97.89	497.57	0.00	0.00	-41.22
7275.42	90.18	180.22	6920.00	-477.00	550.00	10.00	101.29	535.92
7278.69	90.20	180.25	6919.99	-480.27	549.99	1.00	50.57	539.16
1488.98	90.20	180.25	6905.00	-4690.49	531.76	0.00	0.00	4720.54

WELLBORE TARGET DETAILS (MAP CO-ORDINATES AND LAT/LONG)

Name	TVD	+N/-S	+E/-W	Latitude	Longitude	Shape
DECHANT 37N-W36HZ BHL	6905.00	-4690.49	531.76	40.175600	-104.608823	Point

FORMATION TOP DETAILS

TVDPath	MDPath	Formation
3797.00	3809.39	PARKMAN
4367.00	4381.99	SUSSEX
6710.00	6765.46	SHARON SPRINGS
6778.00	6860.42	NIOBRARA A
6798.00	6891.84	NIOBRARA B
6910.00	7166.13	NIOBRARA C

CASING DETAILS

TVD	MD	Name	Size
700.00	700.00	9 5/8"	9-5/8
6920.00	7275.42	7"	7

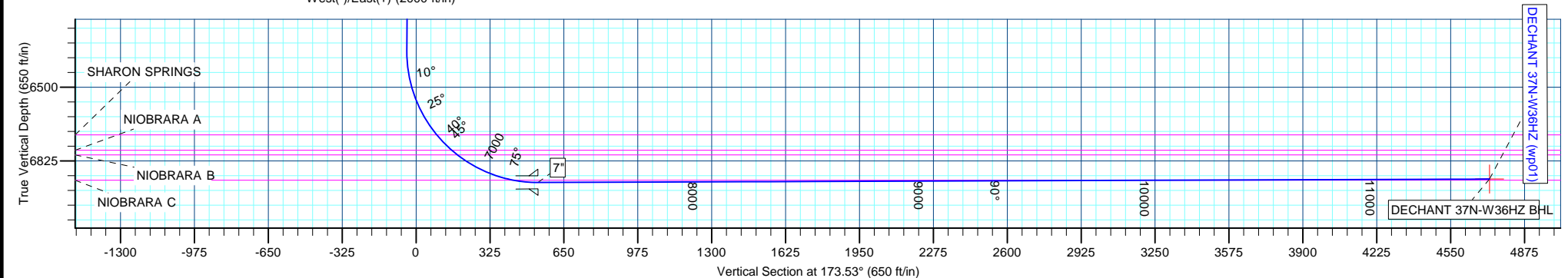

Anadarko Petroleum Corp

Planning Report

Database:	edmp	Local Co-ordinate Reference:	Well DECHANT 37N-W36HZ
Company:	US ROCKIES REGION PLANNING	TVD Reference:	GL + RKB @ 4825.00ft
Project:	COLORADO NORTHERN ZONE - 83	MD Reference:	GL + RKB @ 4825.00ft
Site:	WELD_DECHANT 28-36HZ PAD	North Reference:	True
Well:	DECHANT 37N-W36HZ	Survey Calculation Method:	Minimum Curvature
Wellbore:	DECHANT 37N-W36HZ		
Design:	DECHANT 37N-W36HZ (wp01)		

Project	COLORADO NORTHERN ZONE - 83		
Map System:	US State Plane 1983	System Datum:	Mean Sea Level
Geo Datum:	North American Datum 1983		
Map Zone:	Colorado Northern Zone		

Site	WELD_DECHANT 28-36HZ PAD			
Site Position:		Northing:	1,312,719.83 usft	Latitude: 40.188394
From:	Lat/Long	Easting:	3,248,388.95 usft	Longitude: -104.610912
Position Uncertainty:	0.00 ft	Slot Radius:	13-3/16 "	Grid Convergence: 0.57 °

Well	DECHANT 37N-W36HZ			
Well Position	+N/-S	29.86 ft	Northing:	1,312,750.21 usft
	+E/-W	51.96 ft	Easting:	3,248,440.61 usft
Position Uncertainty		0.00 ft	Wellhead Elevation:	Latitude: 40.188476
				Longitude: -104.610726
				Ground Level: 4,808.00 ft

Wellbore	DECHANT 37N-W36HZ				
Magnetics	Model Name	Sample Date	Declination (°)	Dip Angle (°)	Field Strength (nT)
	IGRF2010	3/21/2012	8.66	66.88	52,956

Design	DECHANT 37N-W36HZ (wp01)			
Audit Notes:				
Version:	Phase:	PLAN	Tie On Depth:	0.00
Vertical Section:	Depth From (TVD) (ft)	+N/-S (ft)	+E/-W (ft)	Direction (°)
	0.00	0.00	0.00	173.53

Plan Sections										
Measured Depth (ft)	Inclination (°)	Azimuth (°)	Vertical Depth (ft)	+N/-S (ft)	+E/-W (ft)	Dogleg Rate (°/100usft)	Build Rate (°/100usft)	Turn Rate (°/100usft)	TFO (°)	Target
0.00	0.00	0.00	0.00	0.00	0.00	0.00	0.00	0.00	0.00	
900.00	0.00	0.00	900.00	0.00	0.00	0.00	0.00	0.00	0.00	
1,173.16	5.46	78.87	1,172.75	2.51	12.77	2.00	2.00	0.00	78.87	
6,362.86	5.46	78.87	6,338.87	97.89	497.57	0.00	0.00	0.00	0.00	
7,275.42	90.18	180.22	6,920.00	-477.00	550.00	10.00	9.28	11.11	101.29	
7,278.69	90.20	180.25	6,919.99	-480.27	549.99	1.00	0.64	0.77	50.57	
11,488.98	90.20	180.25	6,905.00	-4,690.49	531.76	0.00	0.00	0.00	0.00	DECHANT 37N-W36H

Anadarko Petroleum Corp

Planning Report

Database:	edmp	Local Co-ordinate Reference:	Well DECHANT 37N-W36HZ
Company:	US ROCKIES REGION PLANNING	TVD Reference:	GL + RKB @ 4825.00ft
Project:	COLORADO NORTHERN ZONE - 83	MD Reference:	GL + RKB @ 4825.00ft
Site:	WELD_DECHANT 28-36HZ PAD	North Reference:	True
Well:	DECHANT 37N-W36HZ	Survey Calculation Method:	Minimum Curvature
Wellbore:	DECHANT 37N-W36HZ		
Design:	DECHANT 37N-W36HZ (wp01)		

Planned Survey									
Measured Depth (ft)	Inclination (°)	Azimuth (°)	Vertical Depth (ft)	+N/-S (ft)	+E/-W (ft)	Vertical Section (ft)	Dogleg Rate (°/100usft)	Build Rate (°/100usft)	Turn Rate (°/100usft)
0.00	0.00	0.00	0.00	0.00	0.00	0.00	0.00	0.00	0.00
100.00	0.00	0.00	100.00	0.00	0.00	0.00	0.00	0.00	0.00
200.00	0.00	0.00	200.00	0.00	0.00	0.00	0.00	0.00	0.00
300.00	0.00	0.00	300.00	0.00	0.00	0.00	0.00	0.00	0.00
400.00	0.00	0.00	400.00	0.00	0.00	0.00	0.00	0.00	0.00
500.00	0.00	0.00	500.00	0.00	0.00	0.00	0.00	0.00	0.00
600.00	0.00	0.00	600.00	0.00	0.00	0.00	0.00	0.00	0.00
700.00	0.00	0.00	700.00	0.00	0.00	0.00	0.00	0.00	0.00
9 5/8"									
800.00	0.00	0.00	800.00	0.00	0.00	0.00	0.00	0.00	0.00
900.00	0.00	0.00	900.00	0.00	0.00	0.00	0.00	0.00	0.00
Start Build 2.00									
1,000.00	2.00	78.87	999.98	0.34	1.71	-0.14	2.00	2.00	0.00
1,100.00	4.00	78.87	1,099.84	1.35	6.85	-0.57	2.00	2.00	0.00
1,173.16	5.46	78.87	1,172.75	2.51	12.77	-1.06	2.00	2.00	0.00
Start 5189.70 hold at 1173.16 MD									
1,200.00	5.46	78.87	1,199.46	3.01	15.28	-1.27	0.00	0.00	0.00
1,300.00	5.46	78.87	1,299.01	4.84	24.62	-2.04	0.00	0.00	0.00
1,400.00	5.46	78.87	1,398.56	6.68	33.96	-2.81	0.00	0.00	0.00
1,500.00	5.46	78.87	1,498.10	8.52	43.30	-3.59	0.00	0.00	0.00
1,600.00	5.46	78.87	1,597.65	10.36	52.64	-4.36	0.00	0.00	0.00
1,700.00	5.46	78.87	1,697.19	12.19	61.98	-5.13	0.00	0.00	0.00
1,800.00	5.46	78.87	1,796.74	14.03	71.33	-5.91	0.00	0.00	0.00
1,900.00	5.46	78.87	1,896.28	15.87	80.67	-6.68	0.00	0.00	0.00
2,000.00	5.46	78.87	1,995.83	17.71	90.01	-7.46	0.00	0.00	0.00
2,100.00	5.46	78.87	2,095.38	19.55	99.35	-8.23	0.00	0.00	0.00
2,200.00	5.46	78.87	2,194.92	21.38	108.69	-9.00	0.00	0.00	0.00
2,300.00	5.46	78.87	2,294.47	23.22	118.03	-9.78	0.00	0.00	0.00
2,400.00	5.46	78.87	2,394.01	25.06	127.37	-10.55	0.00	0.00	0.00
2,500.00	5.46	78.87	2,493.56	26.90	136.72	-11.33	0.00	0.00	0.00
2,600.00	5.46	78.87	2,593.10	28.74	146.06	-12.10	0.00	0.00	0.00
2,700.00	5.46	78.87	2,692.65	30.57	155.40	-12.87	0.00	0.00	0.00
2,800.00	5.46	78.87	2,792.20	32.41	164.74	-13.65	0.00	0.00	0.00
2,900.00	5.46	78.87	2,891.74	34.25	174.08	-14.42	0.00	0.00	0.00
3,000.00	5.46	78.87	2,991.29	36.09	183.42	-15.19	0.00	0.00	0.00
3,100.00	5.46	78.87	3,090.83	37.92	192.77	-15.97	0.00	0.00	0.00
3,200.00	5.46	78.87	3,190.38	39.76	202.11	-16.74	0.00	0.00	0.00
3,300.00	5.46	78.87	3,289.93	41.60	211.45	-17.52	0.00	0.00	0.00
3,400.00	5.46	78.87	3,389.47	43.44	220.79	-18.29	0.00	0.00	0.00
3,500.00	5.46	78.87	3,489.02	45.28	230.13	-19.06	0.00	0.00	0.00
3,600.00	5.46	78.87	3,588.56	47.11	239.47	-19.84	0.00	0.00	0.00
3,700.00	5.46	78.87	3,688.11	48.95	248.81	-20.61	0.00	0.00	0.00
3,800.00	5.46	78.87	3,787.65	50.79	258.16	-21.39	0.00	0.00	0.00
3,809.39	5.46	78.87	3,797.00	50.96	259.03	-21.46	0.00	0.00	0.00
PARKMAN									
3,900.00	5.46	78.87	3,887.20	52.63	267.50	-22.16	0.00	0.00	0.00
4,000.00	5.46	78.87	3,986.75	54.47	276.84	-22.93	0.00	0.00	0.00
4,100.00	5.46	78.87	4,086.29	56.30	286.18	-23.71	0.00	0.00	0.00
4,200.00	5.46	78.87	4,185.84	58.14	295.52	-24.48	0.00	0.00	0.00
4,300.00	5.46	78.87	4,285.38	59.98	304.86	-25.25	0.00	0.00	0.00
4,381.99	5.46	78.87	4,367.00	61.49	312.52	-25.89	0.00	0.00	0.00
SUSSEX									
4,400.00	5.46	78.87	4,384.93	61.82	314.21	-26.03	0.00	0.00	0.00
4,500.00	5.46	78.87	4,484.47	63.65	323.55	-26.80	0.00	0.00	0.00

Anadarko Petroleum Corp

Planning Report

Database:	edmp	Local Co-ordinate Reference:	Well DECHANT 37N-W36HZ
Company:	US ROCKIES REGION PLANNING	TVD Reference:	GL + RKB @ 4825.00ft
Project:	COLORADO NORTHERN ZONE - 83	MD Reference:	GL + RKB @ 4825.00ft
Site:	WELD_DECHANT 28-36HZ PAD	North Reference:	True
Well:	DECHANT 37N-W36HZ	Survey Calculation Method:	Minimum Curvature
Wellbore:	DECHANT 37N-W36HZ		
Design:	DECHANT 37N-W36HZ (wp01)		

Planned Survey									
Measured Depth (ft)	Inclination (°)	Azimuth (°)	Vertical Depth (ft)	+N/-S (ft)	+E/-W (ft)	Vertical Section (ft)	Dogleg Rate (°/100usft)	Build Rate (°/100usft)	Turn Rate (°/100usft)
4,600.00	5.46	78.87	4,584.02	65.49	332.89	-27.58	0.00	0.00	0.00
4,700.00	5.46	78.87	4,683.57	67.33	342.23	-28.35	0.00	0.00	0.00
4,800.00	5.46	78.87	4,783.11	69.17	351.57	-29.12	0.00	0.00	0.00
4,900.00	5.46	78.87	4,882.66	71.01	360.91	-29.90	0.00	0.00	0.00
5,000.00	5.46	78.87	4,982.20	72.84	370.26	-30.67	0.00	0.00	0.00
5,100.00	5.46	78.87	5,081.75	74.68	379.60	-31.45	0.00	0.00	0.00
5,200.00	5.46	78.87	5,181.29	76.52	388.94	-32.22	0.00	0.00	0.00
5,300.00	5.46	78.87	5,280.84	78.36	398.28	-32.99	0.00	0.00	0.00
5,400.00	5.46	78.87	5,380.39	80.19	407.62	-33.77	0.00	0.00	0.00
5,500.00	5.46	78.87	5,479.93	82.03	416.96	-34.54	0.00	0.00	0.00
5,600.00	5.46	78.87	5,579.48	83.87	426.30	-35.31	0.00	0.00	0.00
5,700.00	5.46	78.87	5,679.02	85.71	435.65	-36.09	0.00	0.00	0.00
5,800.00	5.46	78.87	5,778.57	87.55	444.99	-36.86	0.00	0.00	0.00
5,900.00	5.46	78.87	5,878.12	89.38	454.33	-37.64	0.00	0.00	0.00
6,000.00	5.46	78.87	5,977.66	91.22	463.67	-38.41	0.00	0.00	0.00
6,100.00	5.46	78.87	6,077.21	93.06	473.01	-39.18	0.00	0.00	0.00
6,200.00	5.46	78.87	6,176.75	94.90	482.35	-39.96	0.00	0.00	0.00
6,300.00	5.46	78.87	6,276.30	96.74	491.70	-40.73	0.00	0.00	0.00
6,362.86	5.46	78.87	6,338.87	97.89	497.57	-41.22	0.00	0.00	0.00
Start DLS 10.00 TFO 101.29									
6,400.00	5.97	116.50	6,375.84	97.37	501.03	-40.31	10.00	1.37	101.33
6,500.00	13.71	157.61	6,474.39	84.06	510.23	-26.04	10.00	7.74	41.10
6,600.00	23.23	167.59	6,569.15	53.76	519.00	5.05	10.00	9.52	9.98
6,700.00	33.03	171.91	6,657.24	7.39	527.10	52.03	10.00	9.80	4.32
6,765.46	39.49	173.67	6,710.00	-31.01	531.91	90.73	10.00	9.87	2.69
SHARON SPRINGS									
6,800.00	42.91	174.42	6,735.98	-53.63	534.26	113.47	10.00	9.90	2.15
6,860.42	48.90	175.51	6,778.00	-96.83	538.05	156.83	10.00	9.91	1.82
NIOBRARA A									
6,891.84	52.02	176.01	6,798.00	-121.00	539.84	181.04	10.00	9.93	1.57
NIOBRARA B									
6,900.00	52.83	176.13	6,802.98	-127.45	540.28	187.50	10.00	9.93	1.49
7,000.00	62.77	177.44	6,856.20	-211.83	544.97	271.88	10.00	9.94	1.31
7,100.00	72.72	178.53	6,894.02	-304.21	548.18	364.03	10.00	9.95	1.09
7,166.13	79.30	179.19	6,910.00	-368.33	549.45	427.88	10.00	9.95	0.99
NIOBRARA C									
7,200.00	82.67	179.51	6,915.31	-401.78	549.83	461.16	10.00	9.96	0.96
7,275.42	90.18	180.22	6,920.00	-477.00	550.00	535.92	10.00	9.96	0.94
Start DLS 1.00 TFO 50.57 - 7"									
7,278.69	90.20	180.25	6,919.99	-480.27	549.99	539.16	1.01	0.65	0.77
Start 4210.29 hold at 7278.69 MD									
7,300.00	90.20	180.25	6,919.91	-501.58	549.89	560.33	0.00	0.00	0.00
7,400.00	90.20	180.25	6,919.56	-601.57	549.46	659.64	0.00	0.00	0.00
7,500.00	90.20	180.25	6,919.20	-701.57	549.03	758.95	0.00	0.00	0.00
7,600.00	90.20	180.25	6,918.85	-801.57	548.60	858.27	0.00	0.00	0.00
7,700.00	90.20	180.25	6,918.49	-901.57	548.16	957.58	0.00	0.00	0.00
7,800.00	90.20	180.25	6,918.13	-1,001.57	547.73	1,056.89	0.00	0.00	0.00
7,900.00	90.20	180.25	6,917.78	-1,101.57	547.30	1,156.21	0.00	0.00	0.00
8,000.00	90.20	180.25	6,917.42	-1,201.56	546.86	1,255.52	0.00	0.00	0.00
8,100.00	90.20	180.25	6,917.07	-1,301.56	546.43	1,354.83	0.00	0.00	0.00
8,200.00	90.20	180.25	6,916.71	-1,401.56	546.00	1,454.15	0.00	0.00	0.00
8,300.00	90.20	180.25	6,916.35	-1,501.56	545.57	1,553.46	0.00	0.00	0.00
8,400.00	90.20	180.25	6,916.00	-1,601.56	545.13	1,652.77	0.00	0.00	0.00

Anadarko Petroleum Corp

Planning Report

Database:	edmp	Local Co-ordinate Reference:	Well DECHANT 37N-W36HZ
Company:	US ROCKIES REGION PLANNING	TVD Reference:	GL + RKB @ 4825.00ft
Project:	COLORADO NORTHERN ZONE - 83	MD Reference:	GL + RKB @ 4825.00ft
Site:	WELD_DECHANT 28-36HZ PAD	North Reference:	True
Well:	DECHANT 37N-W36HZ	Survey Calculation Method:	Minimum Curvature
Wellbore:	DECHANT 37N-W36HZ		
Design:	DECHANT 37N-W36HZ (wp01)		

Planned Survey										
Measured Depth (ft)	Inclination (°)	Azimuth (°)	Vertical Depth (ft)	+N/-S (ft)	+E/-W (ft)	Vertical Section (ft)	Dogleg Rate (°/100usft)	Build Rate (°/100usft)	Turn Rate (°/100usft)	
8,500.00	90.20	180.25	6,915.64	-1,701.56	544.70	1,752.09	0.00	0.00	0.00	
8,600.00	90.20	180.25	6,915.29	-1,801.56	544.27	1,851.40	0.00	0.00	0.00	
8,700.00	90.20	180.25	6,914.93	-1,901.55	543.83	1,950.71	0.00	0.00	0.00	
8,800.00	90.20	180.25	6,914.57	-2,001.55	543.40	2,050.03	0.00	0.00	0.00	
8,900.00	90.20	180.25	6,914.22	-2,101.55	542.97	2,149.34	0.00	0.00	0.00	
9,000.00	90.20	180.25	6,913.86	-2,201.55	542.54	2,248.65	0.00	0.00	0.00	
9,100.00	90.20	180.25	6,913.51	-2,301.55	542.10	2,347.96	0.00	0.00	0.00	
9,200.00	90.20	180.25	6,913.15	-2,401.55	541.67	2,447.28	0.00	0.00	0.00	
9,300.00	90.20	180.25	6,912.79	-2,501.54	541.24	2,546.59	0.00	0.00	0.00	
9,400.00	90.20	180.25	6,912.44	-2,601.54	540.80	2,645.90	0.00	0.00	0.00	
9,500.00	90.20	180.25	6,912.08	-2,701.54	540.37	2,745.22	0.00	0.00	0.00	
9,600.00	90.20	180.25	6,911.73	-2,801.54	539.94	2,844.53	0.00	0.00	0.00	
9,700.00	90.20	180.25	6,911.37	-2,901.54	539.50	2,943.84	0.00	0.00	0.00	
9,800.00	90.20	180.25	6,911.01	-3,001.54	539.07	3,043.16	0.00	0.00	0.00	
9,900.00	90.20	180.25	6,910.66	-3,101.53	538.64	3,142.47	0.00	0.00	0.00	
10,000.00	90.20	180.25	6,910.30	-3,201.53	538.21	3,241.78	0.00	0.00	0.00	
10,100.00	90.20	180.25	6,909.95	-3,301.53	537.77	3,341.10	0.00	0.00	0.00	
10,200.00	90.20	180.25	6,909.59	-3,401.53	537.34	3,440.41	0.00	0.00	0.00	
10,300.00	90.20	180.25	6,909.23	-3,501.53	536.91	3,539.72	0.00	0.00	0.00	
10,400.00	90.20	180.25	6,908.88	-3,601.53	536.47	3,639.04	0.00	0.00	0.00	
10,500.00	90.20	180.25	6,908.52	-3,701.53	536.04	3,738.35	0.00	0.00	0.00	
10,600.00	90.20	180.25	6,908.17	-3,801.52	535.61	3,837.66	0.00	0.00	0.00	
10,700.00	90.20	180.25	6,907.81	-3,901.52	535.18	3,936.98	0.00	0.00	0.00	
10,800.00	90.20	180.25	6,907.45	-4,001.52	534.74	4,036.29	0.00	0.00	0.00	
10,900.00	90.20	180.25	6,907.10	-4,101.52	534.31	4,135.60	0.00	0.00	0.00	
11,000.00	90.20	180.25	6,906.74	-4,201.52	533.88	4,234.92	0.00	0.00	0.00	
11,100.00	90.20	180.25	6,906.38	-4,301.52	533.44	4,334.23	0.00	0.00	0.00	
11,200.00	90.20	180.25	6,906.03	-4,401.51	533.01	4,433.54	0.00	0.00	0.00	
11,300.00	90.20	180.25	6,905.67	-4,501.51	532.58	4,532.85	0.00	0.00	0.00	
11,400.00	90.20	180.25	6,905.32	-4,601.51	532.15	4,632.17	0.00	0.00	0.00	
11,488.98	90.20	180.25	6,905.00	-4,690.49	531.76	4,720.54	0.00	0.00	0.00	
TD at 11488.98 - DECHANT 37N-W36HZ BHL										

Design Targets									
Target Name	Dip Angle (°)	Dip Dir. (°)	TVD (ft)	+N/-S (ft)	+E/-W (ft)	Northing (usft)	Easting (usft)	Latitude	Longitude
DECHANT 37N-W36HZ	0.00	0.00	6,905.00	-4,690.49	531.76	1,308,065.29	3,249,019.38	40.175600	-104.608823
- hit/miss target									
- Shape									
- plan hits target center									
- Point									

Casing Points					
Measured Depth (ft)	Vertical Depth (ft)	Name	Casing Diameter (")	Hole Diameter (")	
700.00	700.00	9 5/8"	9-5/8	12-1/4	
7,275.42	6,920.00	7"	7	8-3/4	

Anadarko Petroleum Corp

Planning Report

Database:	edmp	Local Co-ordinate Reference:	Well DECHANT 37N-W36HZ
Company:	US ROCKIES REGION PLANNING	TVD Reference:	GL + RKB @ 4825.00ft
Project:	COLORADO NORTHERN ZONE - 83	MD Reference:	GL + RKB @ 4825.00ft
Site:	WELD_DECHANT 28-36HZ PAD	North Reference:	True
Well:	DECHANT 37N-W36HZ	Survey Calculation Method:	Minimum Curvature
Wellbore:	DECHANT 37N-W36HZ		
Design:	DECHANT 37N-W36HZ (wp01)		

Formations					
Measured Depth (ft)	Vertical Depth (ft)	Name	Lithology	Dip (°)	Dip Direction (°)
3,809.39	3,797.00	PARKMAN		0.00	
4,381.99	4,367.00	SUSSEX		0.00	
6,765.46	6,710.00	SHARON SPRINGS		0.00	
6,860.42	6,778.00	NIOBRARA A		0.00	
6,891.84	6,798.00	NIOBRARA B		0.00	
7,166.13	6,910.00	NIOBRARA C		0.00	

Plan Annotations					
Measured Depth (ft)	Vertical Depth (ft)	Local Coordinates			
		+N/-S (ft)	+E/-W (ft)	Comment	
900.00	900.00	0.00	0.00	Start Build 2.00	
1,173.16	1,172.75	2.51	12.77	Start 5189.70 hold at 1173.16 MD	
6,362.86	6,338.87	97.89	497.57	Start DLS 10.00 TFO 101.29	
7,275.42	6,920.00	-477.00	550.00	Start DLS 1.00 TFO 50.57	
7,278.69	6,919.99	-480.27	549.99	Start 4210.29 hold at 7278.69 MD	
11,488.98	6,905.00	-4,690.49	531.76	TD at 11488.98	