

GREAT WESTERN OIL & GAS COMPANY

ADDENDUM TO LEGAL PLAT FOR

CAMPBELL JF #17-6, #17-13, #17-9,
#17-8 & #17-41

SECTION 17, T2N, R65W, 6th P.M.
SW 1/4 NE 1/4

SCALE: 1" = 200'

DATE: 10-1-12

DRAWN BY: J.W.

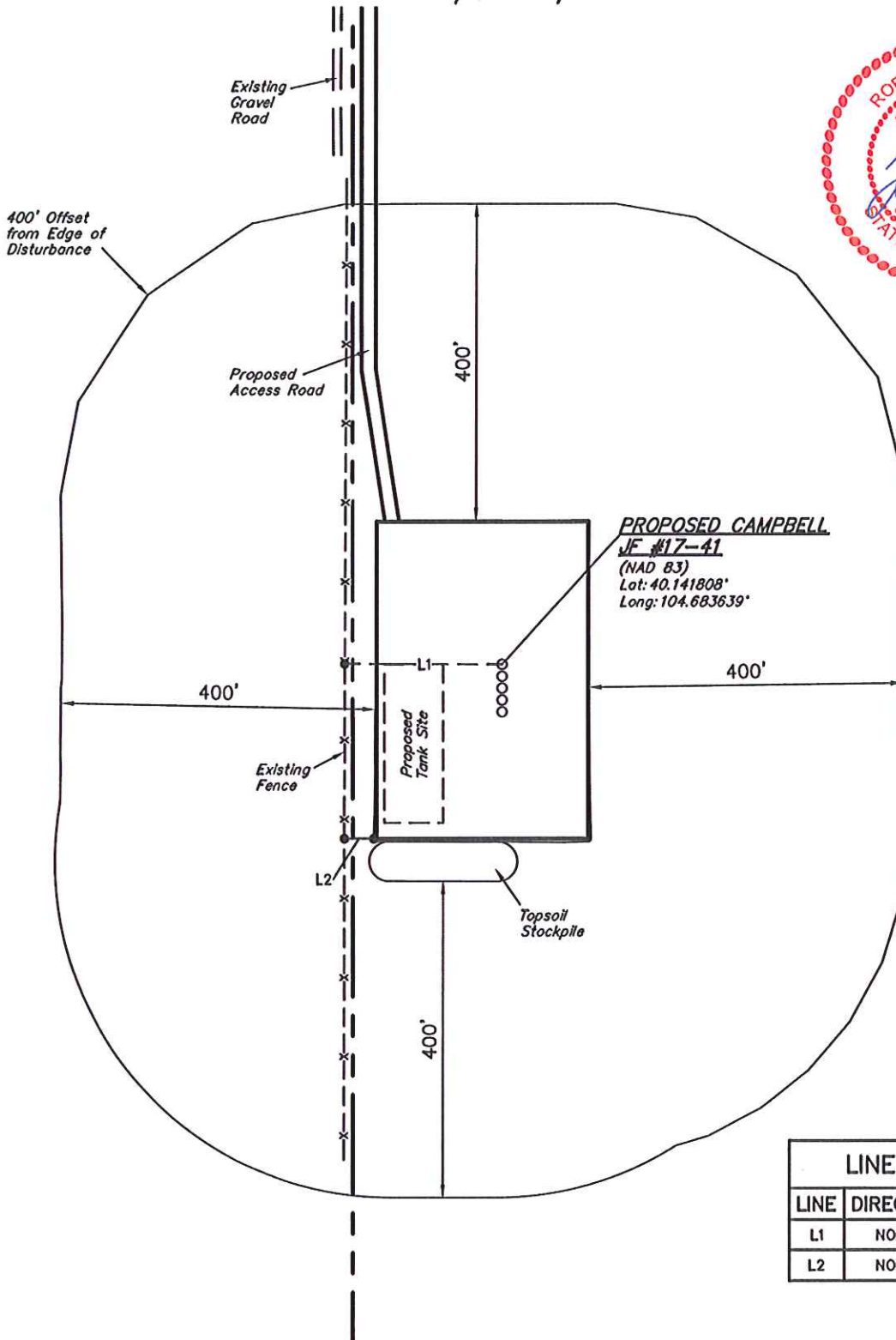

PROPOSED CAMPBELL
JF #17-41
(NAD 83)
Lot: 40.141808'
Long: 104.683639'

LINE TABLE		
LINE	DIRECTION	LENGTH
L1	NORTH	200'
L2	NORTH	36'