

EXISTING GRADE @ CENTERHOLE = 7,583.0'
 FINISHED GRADE ELEVATION = 7581.5'
 CUT SLOPES = 1.5:1
 FILL SLOPES = 1.5:1
 TOTAL CUT FOR WELL PAD = 15,551 C.Y.
 TOTAL FILL FOR WELL PAD = 4,693 C.Y.
 TOPSOIL @ 6" DEPTH = 1,620 C.Y.
 SHRINKAGE (10%) = 1,393 C.Y.
 EXCESS MATERIAL = 7,845 C.Y.
 TOTAL DISTURBANCE = +/- 2.2 AC.
 DISTURBANCE INCLUDES ROAD & PAD

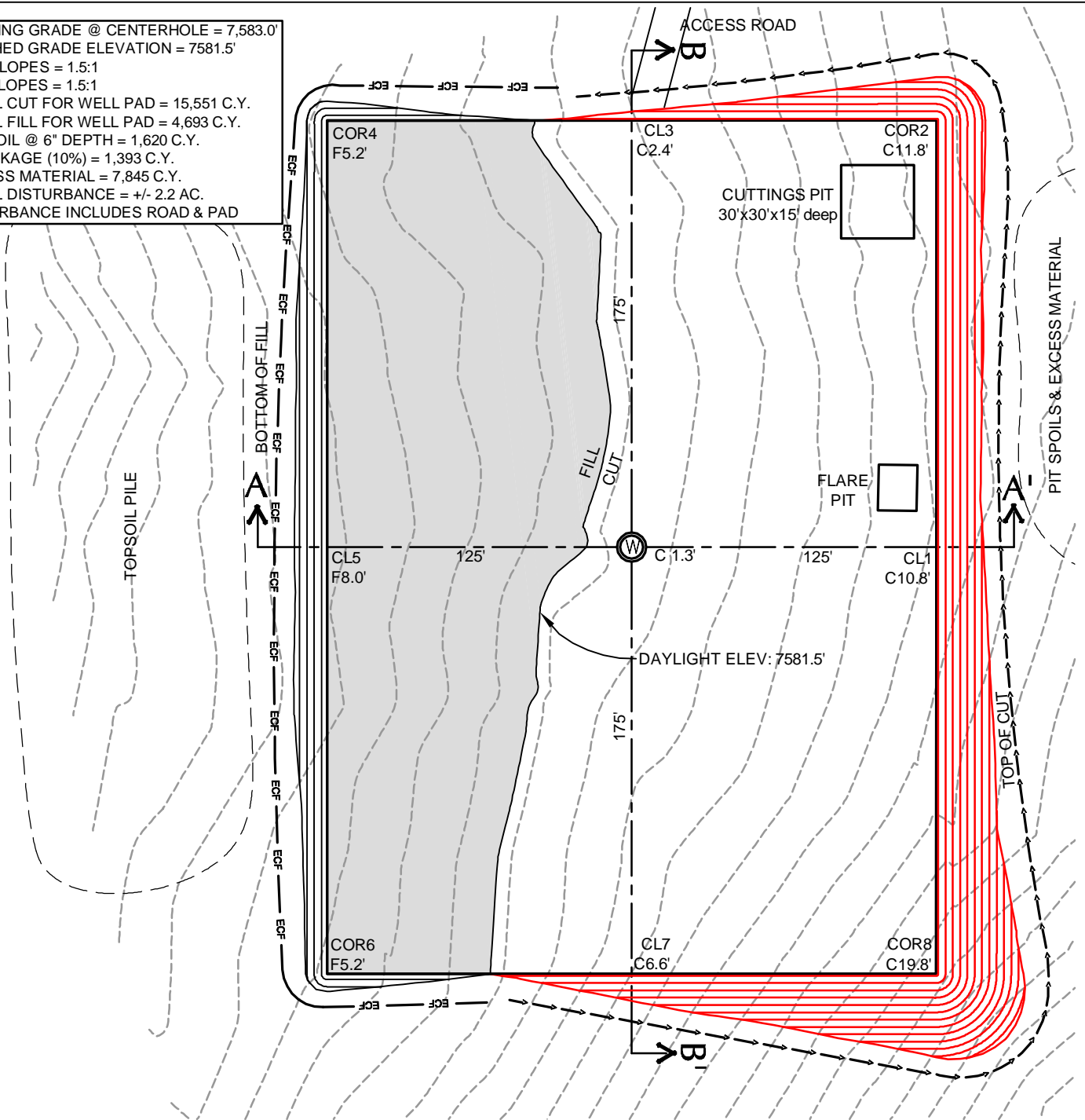

NAD83
 LAT 40°56'53.5"
 (40.948197)
 LONG 107°12'14.1"
 (107.203917)
 STATE PLANE (CO-N)
 N=1,592,805 ft
 E=2,529,308 ft

ENTEK GRB, LLC

FRU FEDERAL 1-1
 PROPOSED LAYOUT
 653' FNL, 659' FEL
 NE $\frac{1}{4}$ NE $\frac{1}{4}$, SECTION 1,
 T.11N., R.88W., 6th PM
 ROUTT COUNTY, COLORADO

NOTES:

1. PDOP VALUE EQUALS 2.6: DATE OF SURVEY 9-09-11
2. GPS OPERATOR: DAVE FEHRINGER

VEGETATION:
 NATIVE GRASSES
 SAGEBRUSH
 SCRUB OAK

SURFACE USE:
 RANGELAND

WELL PAD LEGEND

- PROPOSED WELL LOCATION
- EXISTING CONTOURS (2' INTERVAL)
- PROPOSED CONTOURS (2' INTERVAL)
- ECF EROSION CONTROL FENCE
- STORM WATER CONTROL DITCH



0 30 60
 1" = 60'

CHOICE ENGINEERING SERVICES

404 "N" Street - Suite 201 | Rock Springs, WY 82901
 Phone 307-362-6065 | Fax 307-362-6064

Scale: 1"=60' Date: 09/30/11
 REVISION #
 NAME - DATE

SHEET NO:

2

SECTION A-A'

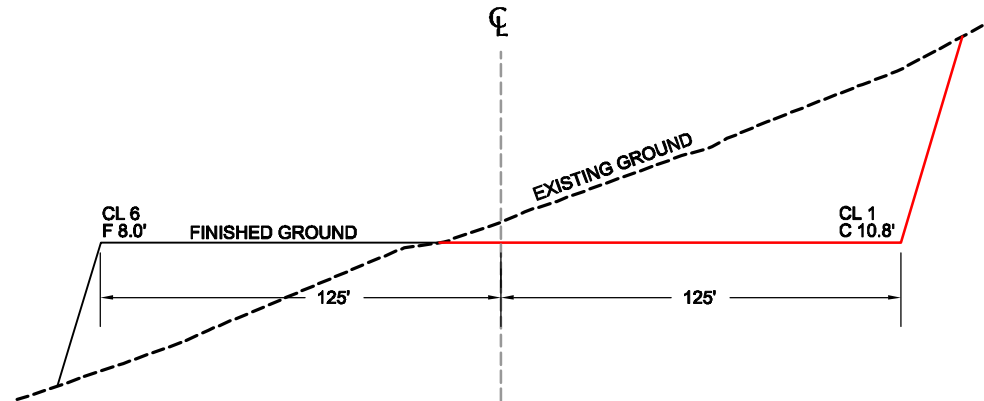

SECTION B-B'

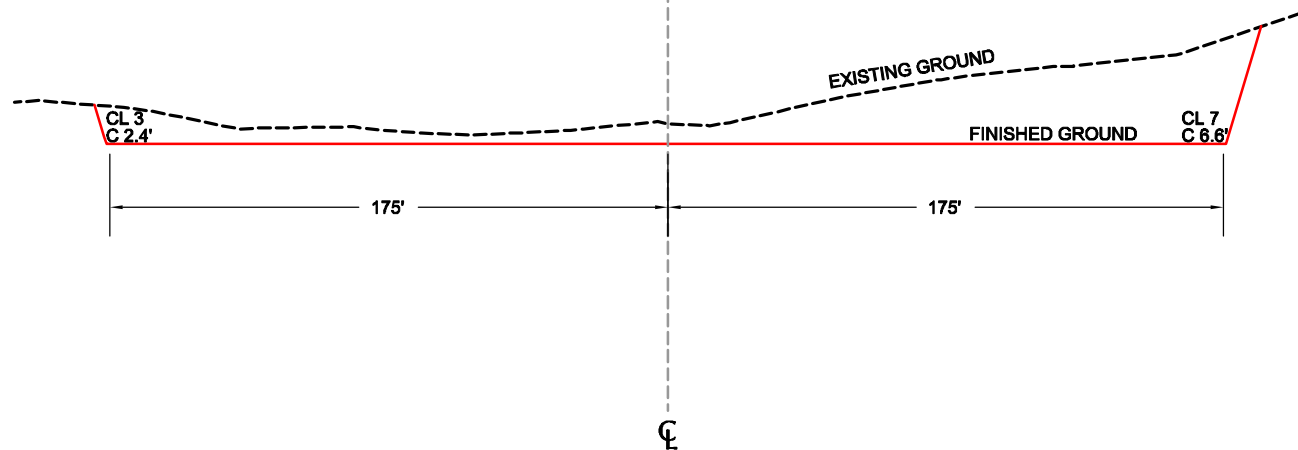

ENTEK GRB, LLC

FRU FEDERAL 1-1
CROSS SECTIONS
653' FNL, 659' FEL
NE $\frac{1}{4}$ NE $\frac{1}{4}$, SECTION 1,
T.11N., R.88W., 6th PM
ROUTT COUNTY, COLORADO

CHOICE ENGINEERING SERVICES

404 "N" Street - Suite 201 | Rock Springs, WY 82901
Phone 307-362-6065 | Fax 307-362-6064

Scale: 1"=50' Date: 09/30/11

REVISION #
NAME - DATE

SHEET NO:

3

0 30 60
1" = 60' HORIZONTAL

0 6 12
1" = 12' VERTICAL

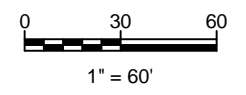
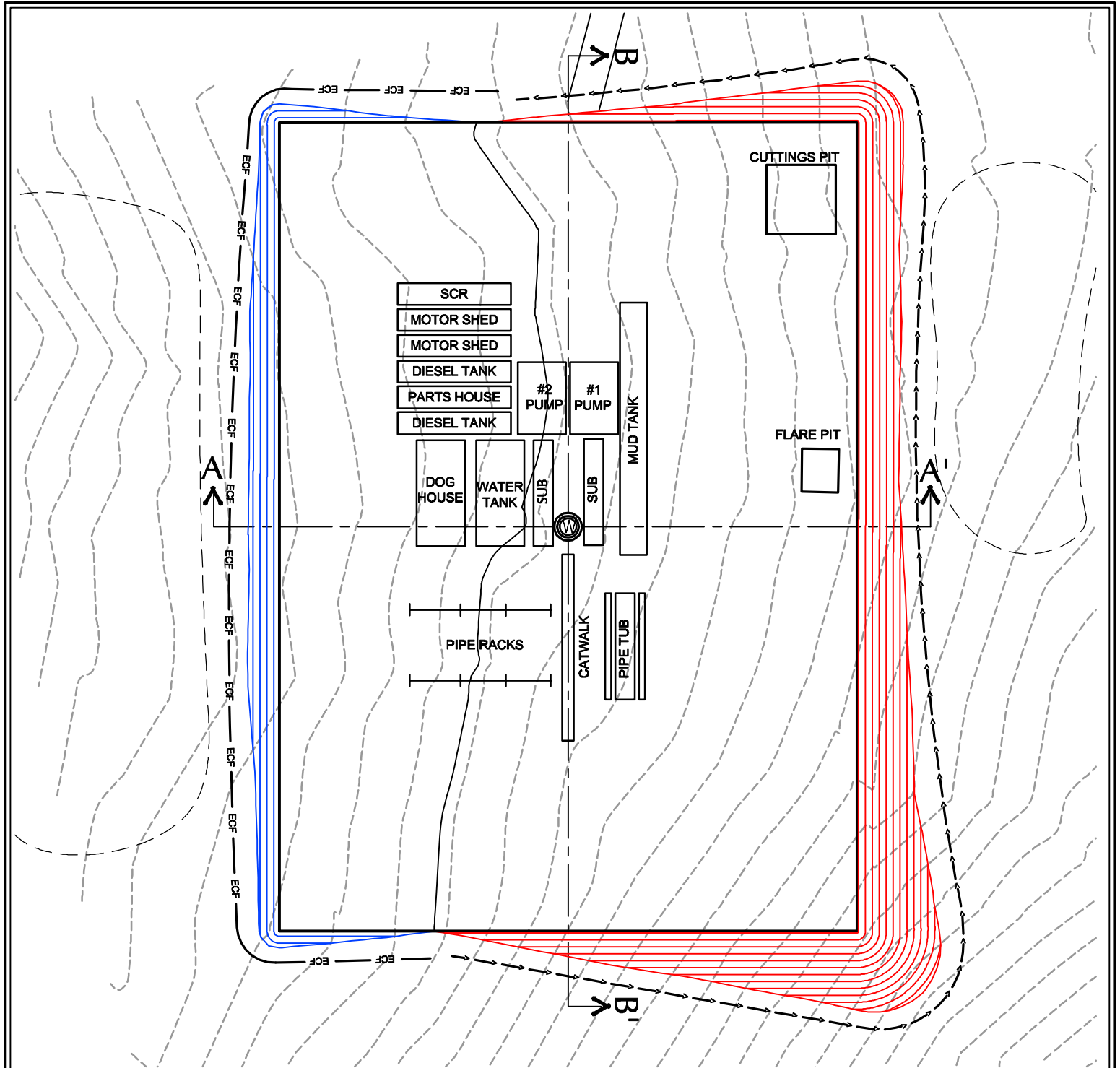

ENTEK GRB, LLC

FRU FEDERAL 1-1
 PROPOSED RIG LAYOUT
 653' FNL, 659' FEL
 NE¼NE¼, SECTION 1,
 T.11N., R.88W., 6th PM
 ROUTT COUNTY, COLORADO

CHOICE ENGINEERING SERVICES

404 "N" Street - Suite 201 | Rock Springs, WY 82901
 Phone 307-362-6065 | Fax 307-362-6064

Scale: 1"=60'	Date: 09/30/11	SHEET NO:
REVISION #	4	
NAME - DATE		

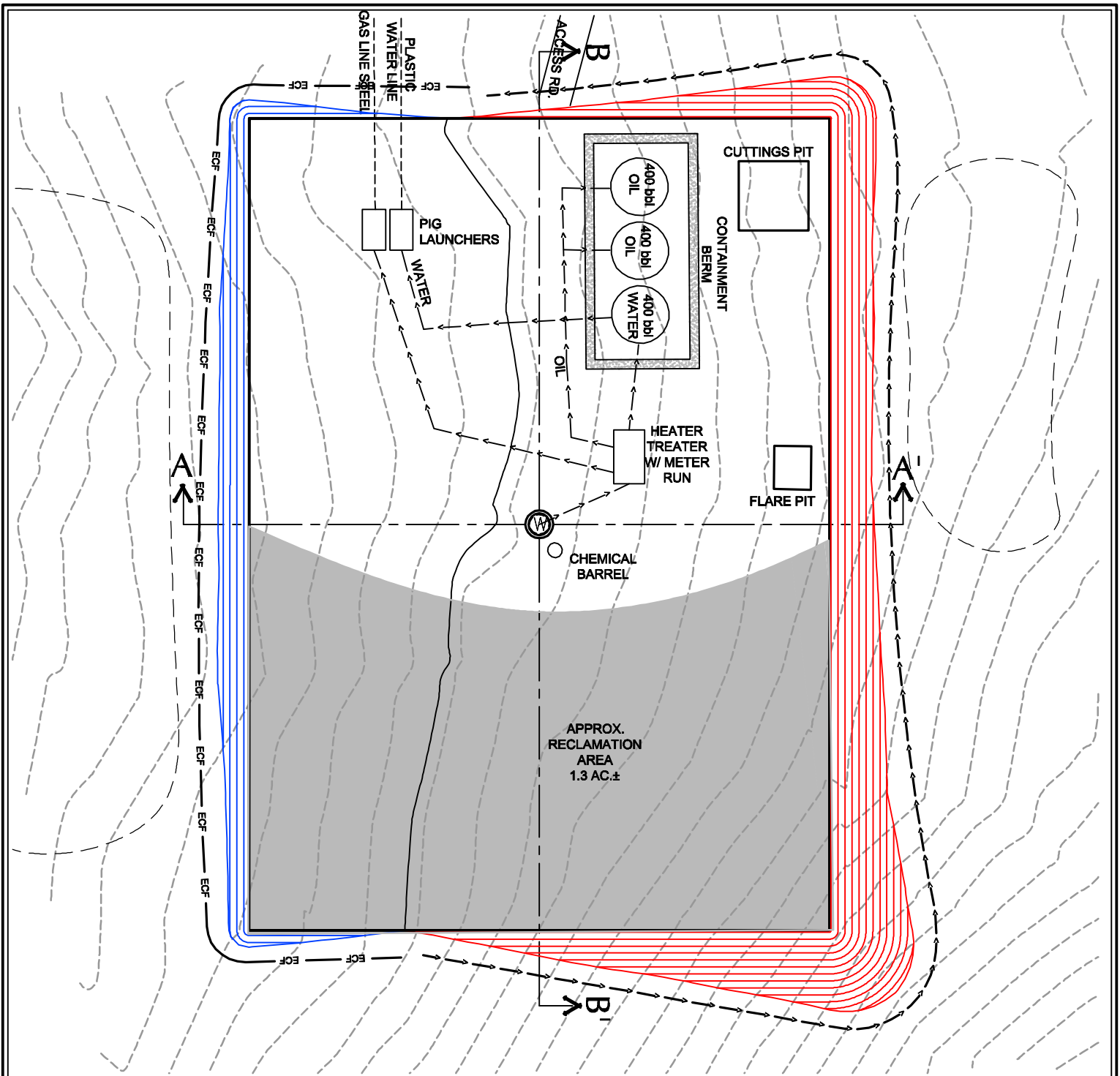

0 30 60
1" = 60'

ENTEK GRB, LLC

FRU FEDERAL 1-1
PROPOSED PRODUCTION FACILITIES
653' FNL, 659' FEL
NE $\frac{1}{4}$ NE $\frac{1}{4}$, SECTION 1,
T.11N., R.88W., 6th PM
ROUTT COUNTY, COLORADO

CHOICE ENGINEERING SERVICES

404 "N" Street - Suite 201 | Rock Springs, WY 82901
Phone 307-362-6065 | Fax 307-362-6064

Scale: 1"=60'	Date: 09/30/11
REVISION # NAME - DATE	

SHEET NO:

5