

Hydrology Map

BDE 27NW

N½ SW¼ SECTION 27, TOWNSHIP 4 NORTH, RANGE 68 WEST OF THE 6TH PRINCIPAL MERIDIAN

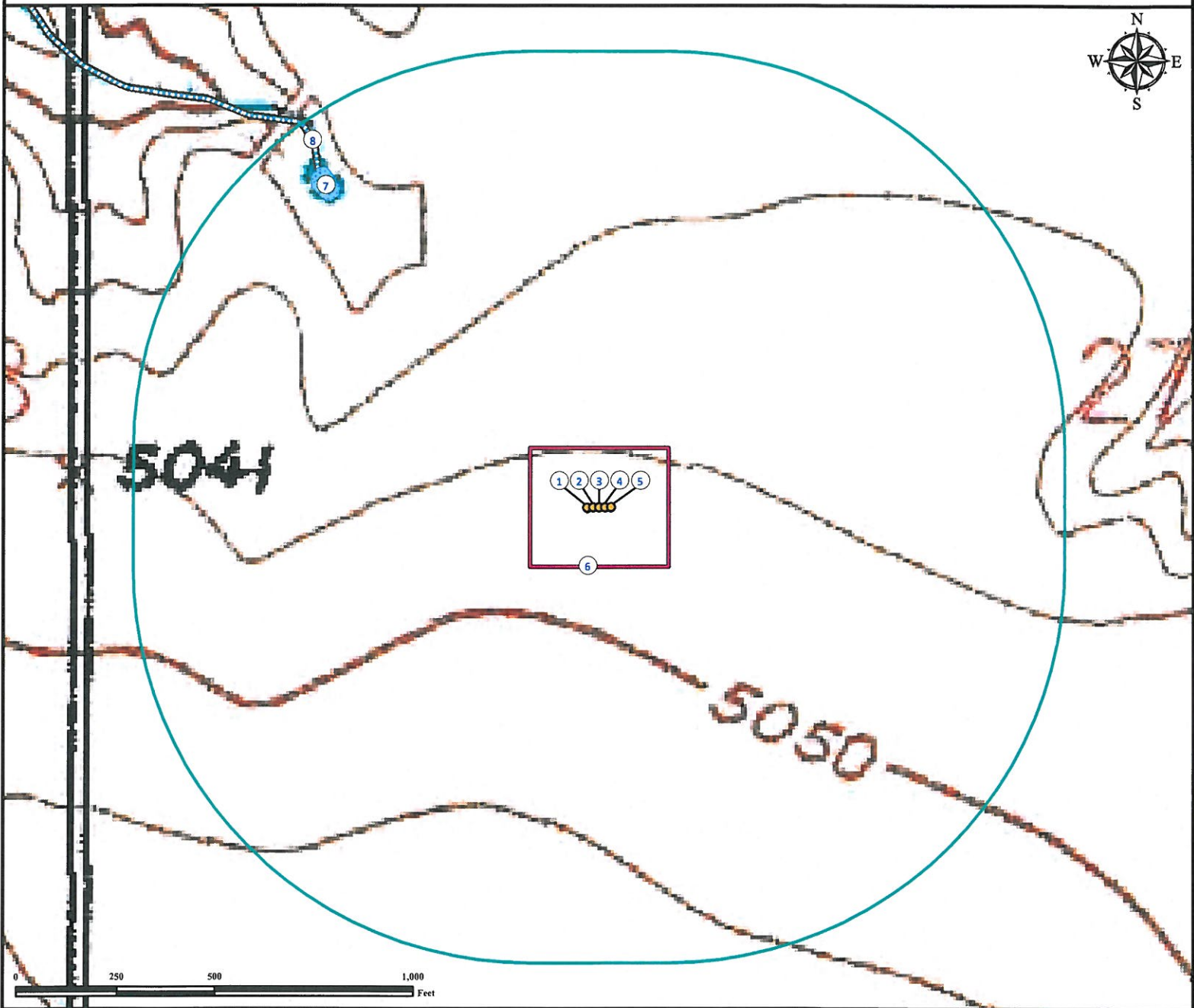

- | | | |
|-----------------------------|----------------------------------|--------------------------------------|
| 1. Proposed well BDE 13-27. | 4. Proposed well BDE 22-27. | 7. Pond is ±1027' NW. |
| 2. Proposed well BDE 12-27. | 5. Proposed well BDE 23-27. | 8. Intermittent Stream is ±1115' NW. |
| 3. Proposed well BDE 27NW. | 6. Operational Disturbance Area. | |

Legend

- | | | |
|---------------------|------------------|------|
| Proposed Well | Disturbance Area | Pond |
| Intermittent Stream | 1000' Radius | |

Reference Location

** All Measurements are Made from Reference Well BDE 27NW **

Lat: 40.283343° Long: -104.993970° (NAD83)
Elevation: 5046 Feet



Use our resources to find yours!
www.petro-fs.com
(303) 928-7128

Field Date: 08/15/2012
Drafting Date: 08/16/2012
Drafter: DLR
Revision:

Data Sources:
- TOPO courtesy USGS
- Water Bodies courtesy of NHD
- Intermittent Stream data courtesy of NHD

Prepared for:

