

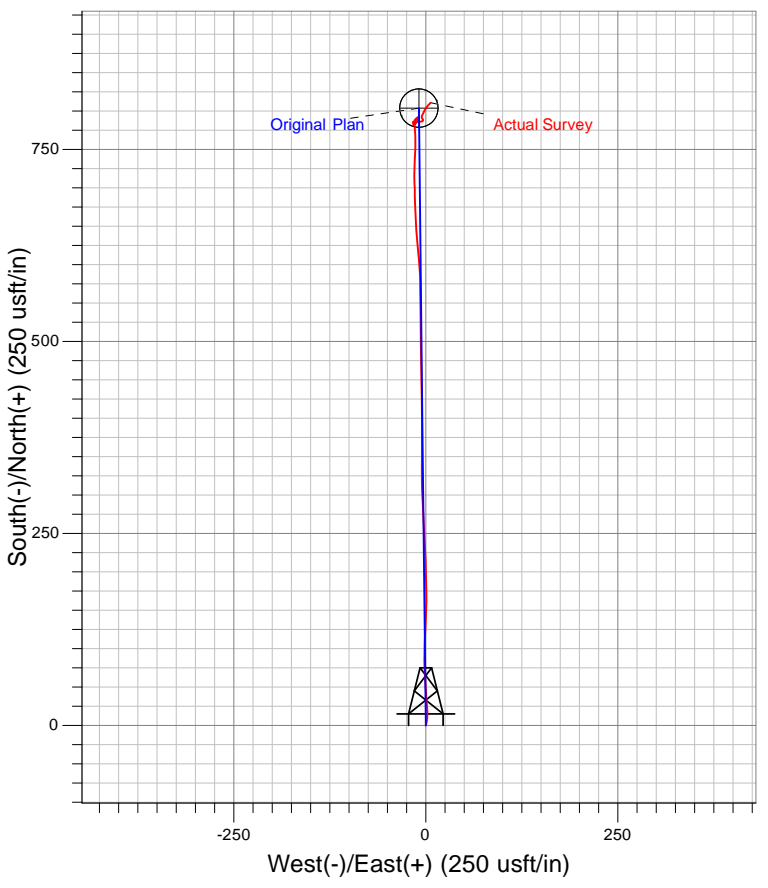

Well Name: KP 533-18  
 Surface Location: KP 34-18 Pad  
 North American Datum 1983 , US State Plane 1983 . Colorado Central Zone  
 Ground Elevation: 5918.0

+N/-S	+E/-W	Northing	Easting	Latitude	Longitude	Slot
0.0	0.0	1621948.40	2409139.20	39° 31' 20.376 N	107° 35' 41.034 W	B2

KELLY BUSHING @ 5944.0usft (Nabors 574 (26' RKB) kjs)

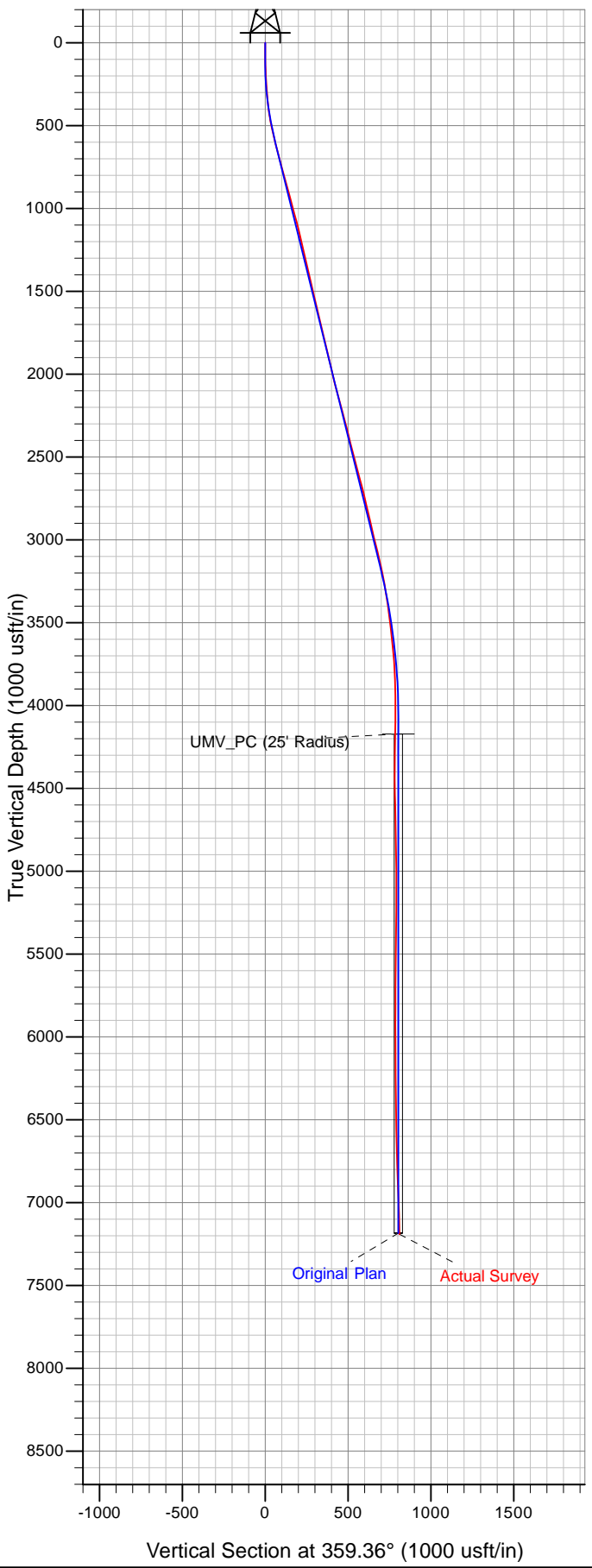

Azimuths to True North  
 Magnetic North: 10.05°  
 Magnetic Field  
 Strength: 52218.6snT  
 Dip Angle: 65.81°  
 Date: 6/4/2012  
 Model: IGRF2010