

Nearest:  
 Building: 4,221' southeast  
 Above Ground Utility: 1,175' east  
 Public Road: 3,926' northwest  
 Property Line: 419' north  
 Railroad: 20,960' southwest

# Location Drawing

JR Land Surveying, LLC  
 8114 Northstar Drive  
 Windsor, Colorado 80528  
 P. 970-576-4641

Existing Well Data:

Ione 31-2  
 Latitude: N 40.17296°  
 Longitude: W 104.74133°  
 FNL: 588'  
 FEL: 1771'  
 ELEV: 5085'  
 PDOP: 1.9

Proposed Well Data:

Ione 1C-2H  
 Latitude: N 40.17344°  
 Longitude: W 104.73981°  
 FNL: 419'  
 FEL: 1347'  
 ELEV: 5078'  
 PDOP: 1.7

Existing Well Data:

Ione #4  
 Latitude: N 40.17185°  
 Longitude: W 104.73846°  
 FNL: 1003'  
 FEL: 975'  
 ELEV: 5083'  
 PDOP: 1.6

Existing Well Data:

Ione 6-0-2  
 Latitude: N 40.17180°  
 Longitude: W 104.73830°  
 FNL: 1022'  
 FEL: 930'  
 ELEV: 5084'  
 PDOP: 1.5

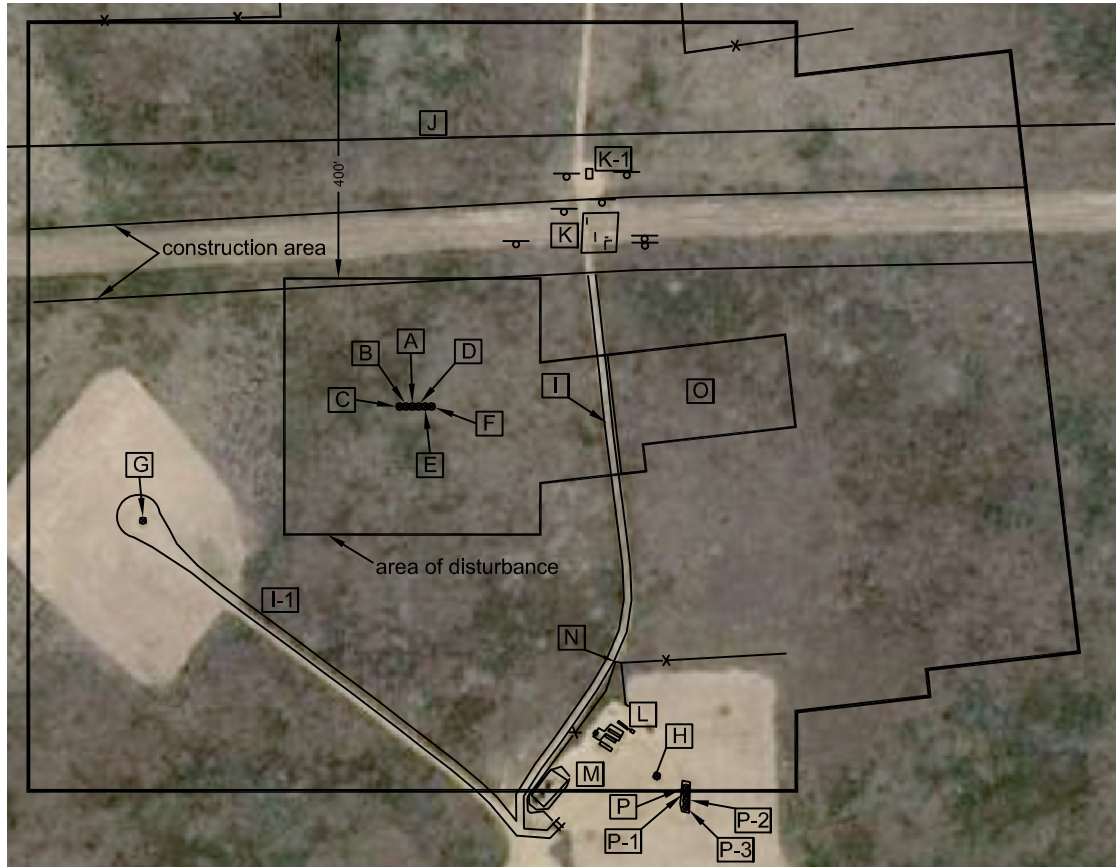

Existing Well Data:

Ione 41-2  
 Latitude: N 40.17177°  
 Longitude: W 104.73830°  
 FNL: 1032'  
 FEL: 930'  
 ELEV: 5084'  
 PDOP: 2.2

Existing Well Data:

Ione 4-2-2  
 Latitude: N 40.17174°  
 Longitude: W 104.73830°  
 FNL: 1042'  
 FEL: 930'  
 ELEV: 5085'  
 PDOP: 2.1

Existing Well Data:

Ione 6-4-2  
 Latitude: N 40.17172°  
 Longitude: W 104.73830°  
 FNL: 1052'  
 FEL: 930'  
 ELEV: 5085'  
 PDOP: 1.6

**Distances listed below are measured from the proposed Ione 1C-2H**

- [A] proposed Ione 1C-2H
- [B] proposed Ione 1B-2H, 10' west
- [C] proposed Ione 1A-2H, 20' west
- [D] proposed Ione 1D-2H, 10' east
- [E] proposed Ione 1E-2H, 20' east
- [F] proposed Ione 1F-2H, 30' east
- [G] existing Ione 31-2, 457' southwest
- [H] existing Ione #4, 692' southeast
- [I] access 296' east
- [I-1] access 402' southwest
- [J] property line 419' north
- [K] fenced in above ground gas lines 357' northeast
- [K-1] fenced in above ground gas line/plugged well 447' northeast
- [L] separators, meter hut, combustor, antenna & above ground pipe 568' southeast
- [M] fenced in tanks 607' southeast
- [N] fence 510' southeast

- [O] proposed facility pads 312' northeast
- [P] existing Ione 6-0-2, 733' southeast
- [P-1] existing Ione 41-2, 741' southeast
- [P-2] existing Ione 4-2-2, 749' southeast
- [P-3] existing Ione 6-4-2, 757' southeast

Legend:  
 - sign (buried utility/gas)

Field observations taken on 7/29/12 by operator John Rice.

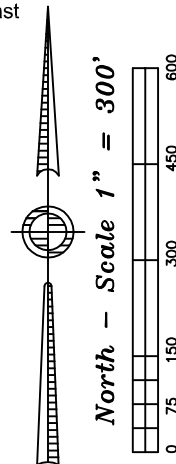

**Ione NWNE  
 Pad Location Drawing**

Improvements extending 400' from disturbance

Township 2 North, Range 66 West,  
 Section 2: NW $\frac{1}{4}$  NE $\frac{1}{4}$   
 Weld County, Colorado

August 13, 2012