

LEGEND

- PROPOSED LOCATION
- EXISTING ROAD



Wasatch Surveying Associates

906 Main Street Evanston, Wyoming 82930
Phone No. (307) 789-4545 Fax 307-789-5722



EnCana Oil & Gas (USA) Inc.

PA-29 WELL PAD-ACCESS ROUTE
SECTION 29, T7S, R95W, 6th, P.M.
GARFIELD COUNTY, COLORADO

TOPO A

PROJECT NUMBER
10-04-14
DATE: 10/21/10
SCALE: 1"=100,000'

8
of 10

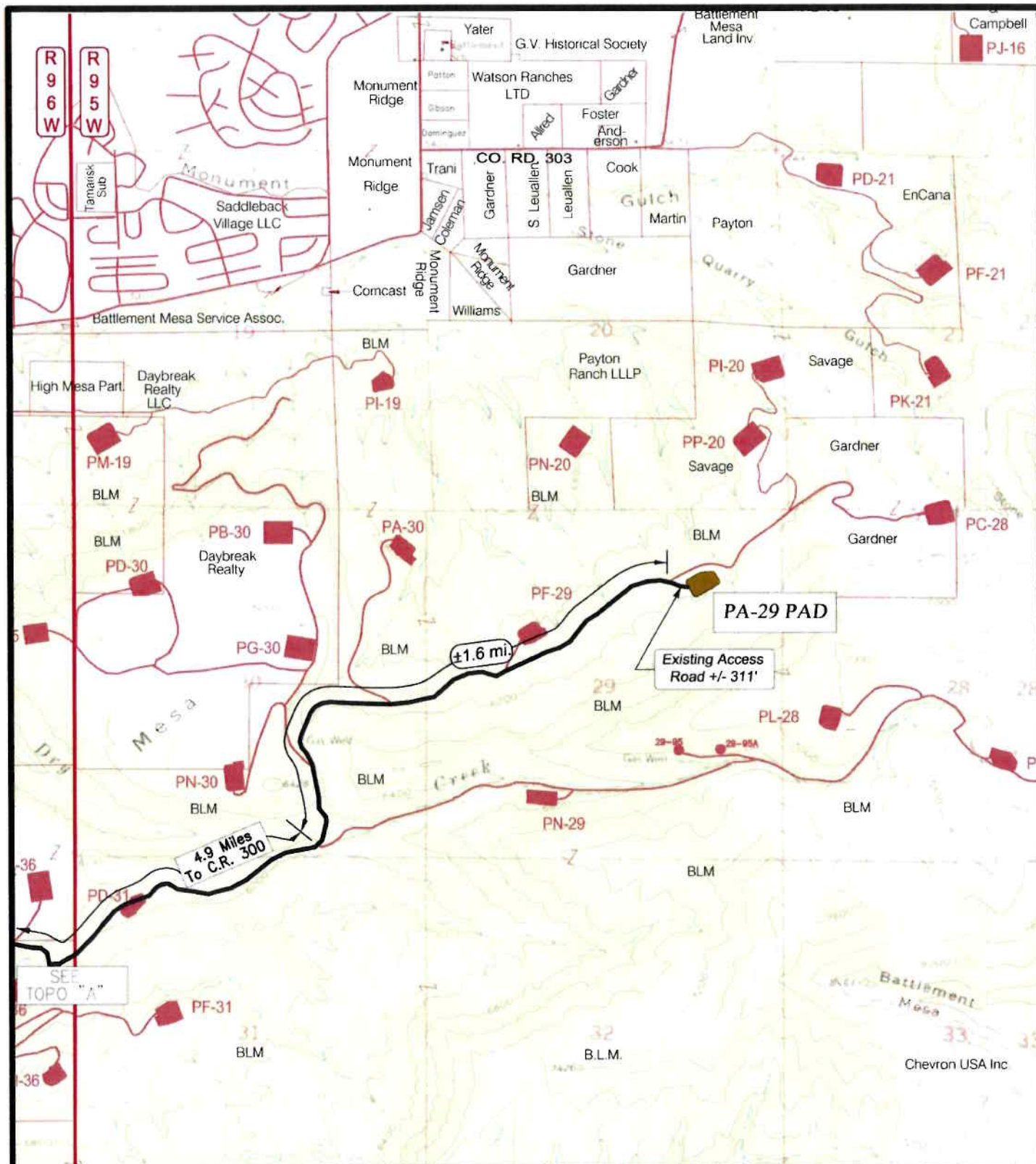

LEGEND

- PA-29 WELL PAD
- EXISTING ROAD



Wasatch Surveying Associates

906 Main Street Evanston, Wyoming 82930
Phone No. (307) 789-4545 Fax 307-789-5722

EnCana Oil & Gas (USA) Inc.

PA-29 Well Pad-Access Route
SECTION 29, T7S, R95W, 6th P.M.
GARFIELD COUNTY, COLORADO

TOPO B

PROJECT NUMBER
10-04-14
DATE: 10/21/10
SCALE: 1" = 2000'

9
of 10

