

Location:	COLORADO	Slot:	SLOT#25 RATTLER 3N-34HZ (200'FSL & 1987'FWL,SEC.34)
Field:	WELD COUNTY (KERR MCGEE)	Well:	RATTLER 3N-34HZ
Facility:	SEC.34-T3N-R66W	Wellbore:	RATTLER 3N-34HZ PWB

Plot reference wellpath is RATTLER 3N-34HZ (REV-B.0) PWP	
True vertical depths are referenced to ENSIGN 145 (RKB)	Grid System: NAD83 / Lambert Colorado SP, Northern Zone (501), US feet
Measured depths are referenced to ENSIGN 145 (RKB)	North Reference: True north
ENSIGN 145 (RKB) to Mean Sea Level: 5003 feet	Scale: True distance
Mean Sea Level to Mud line (At Slot: SLOT#25 RATTLER 3N-34HZ (200FSL & 1987FWL,SEC.34)): 0 feet	Depths are in feet
Coordinates are in feet referenced to Slot	Created by: wlisle02 on 4/30/2012

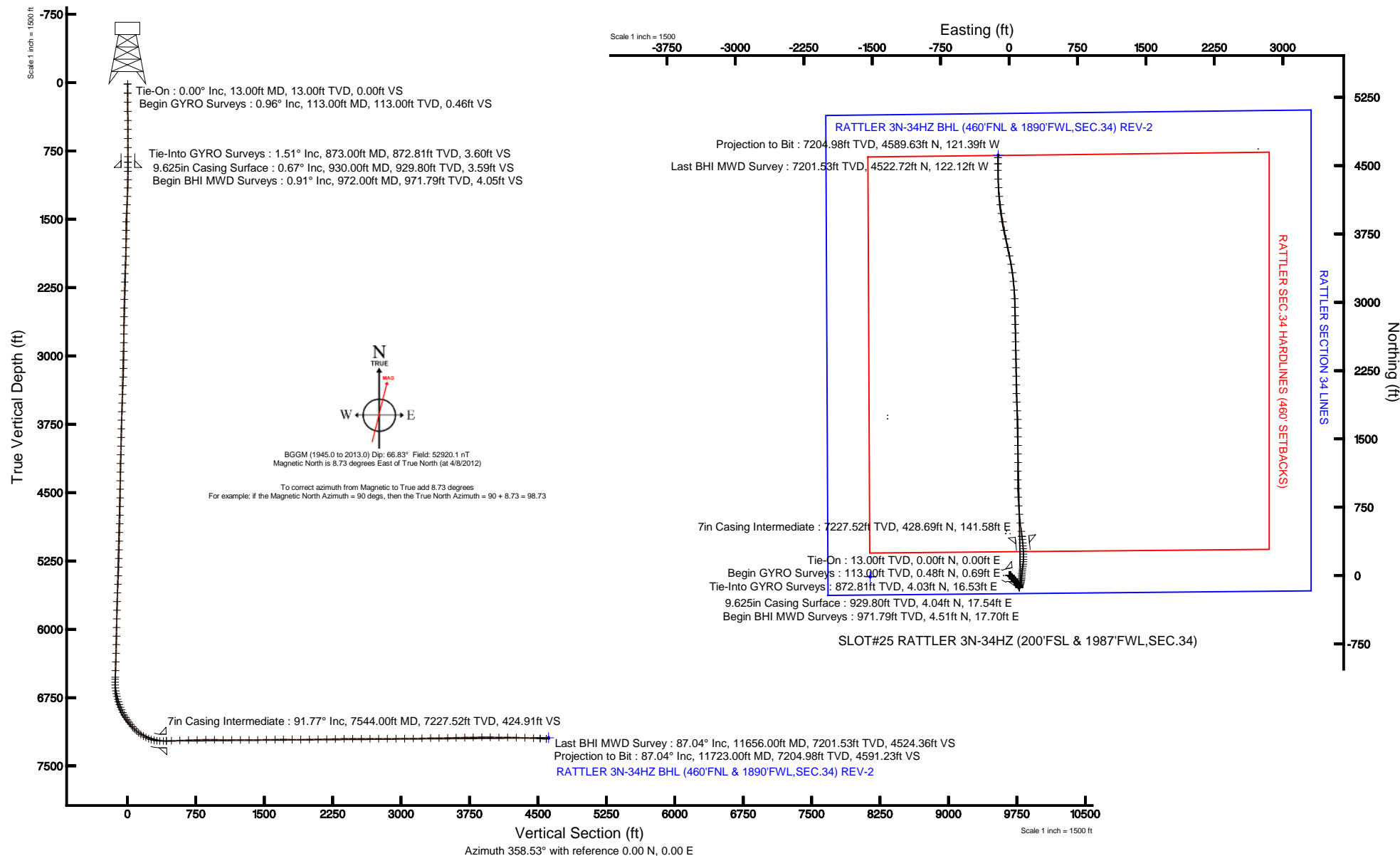



Actual Wellpath Report

RATTLER 3N-34HZ AWP

Page 1 of 7



REFERENCE WELLPATH IDENTIFICATION

Operator	KERR-MCGEE OIL & GAS ONSHORE LP	Slot	SLOT#25 RATTLER 3N-34HZ (200'FSL & 1987'FWL,SEC.34)
Area	COLORADO	Well	RATTLER 3N-34HZ
Field	WELD COUNTY (KERR MCGEE)	Wellbore	RATTLER 3N-34HZ AWB
Facility	SEC.34-T3N-R66W		

REPORT SETUP INFORMATION

Projection System	NAD83 / Lambert Colorado SP, Northern Zone (501), US feet	Software System	WellArchitect® 3.0.2
North Reference	True	User	Wilsjef02
Scale	0.999958	Report Generated	4/30/2012 at 13:38:32
Convergence at slot	0.47° East	Database/Source file	WellArchitectDB/RATTLER_3N-34HZ_AWB.xml

WELLPATH LOCATION

	Local coordinates		Grid coordinates		Geographic coordinates	
	North[ft]	East[ft]	Easting[US ft]	Northing[US ft]	Latitude	Longitude
Slot Location	-1723.09	1334.67	3205208.06	1307415.99	40°10'29.712"N	104°45'56.246"W
Facility Reference Pt			3203859.31	1309127.97	40°10'46.740"N	104°46'13.440"W
Field Reference Pt			3197771.84	1268891.29	40°04'09.600"N	104°47'36.000"W

WELLPATH DATUM

Calculation method	Minimum curvature	ENSIGN 145 (RKB) to Facility Vertical Datum	5003.00ft
Horizontal Reference Pt	Slot	ENSIGN 145 (RKB) to Mean Sea Level	5003.00ft
Vertical Reference Pt	ENSIGN 145 (RKB)	ENSIGN 145 (RKB) to Mud Line at Slot (SLOT#25 RATTLER 3N-34HZ (200'FSL & 1987'FWL,SEC.34))	5003.00ft
MD Reference Pt	ENSIGN 145 (RKB)	Section Origin	N 0.00, E 0.00 ft
Field Vertical Reference	Mean Sea Level	Section Azimuth	358.48°



Actual Wellpath Report

RATTLER 3N-34HZ AWP

Page 2 of 7



REFERENCE WELLPATH IDENTIFICATION

Operator	KERR-MCGEE OIL & GAS ONSHORE LP	Slot	SLOT#25 RATTLER 3N-34HZ (200'FSL & 1987'FWL,SEC.34)
Area	COLORADO	Well	RATTLER 3N-34HZ
Field	WELD COUNTY (KERR MCGEE)	Wellbore	RATTLER 3N-34HZ AWB
Facility	SEC.34-T3N-R66W		

WELLPATH DATA (148 stations) † = interpolated/extrapolated station

MD [ft]	Inclination [°]	Azimuth [°]	TVD [ft]	Vert Sect [ft]	North [ft]	East [ft]	Latitude	Longitude	DLS [°/100ft]	Comments
0.00†	0.000	54.860	0.00	0.00	0.00	0.00	40°10'29.712"N	104°45'56.246"W	0.00	
13.00	0.000	54.860	13.00	0.00	0.00	0.00	40°10'29.712"N	104°45'56.246"W	0.00	Tie-On
113.00	0.960	54.860	113.00	0.46	0.48	0.69	40°10'29.717"N	104°45'56.237"W	0.96	Begin GYRO Surveys
213.00	0.750	62.130	212.98	1.22	1.27	1.95	40°10'29.725"N	104°45'56.221"W	0.24	
313.00	1.170	58.570	312.97	2.02	2.11	3.40	40°10'29.733"N	104°45'56.202"W	0.42	
413.00	1.270	67.380	412.95	2.93	3.07	5.29	40°10'29.742"N	104°45'56.178"W	0.21	
513.00	1.300	78.640	512.92	3.52	3.72	7.43	40°10'29.749"N	104°45'56.150"W	0.25	
613.00	1.600	80.280	612.89	3.91	4.18	9.92	40°10'29.753"N	104°45'56.118"W	0.30	
713.00	1.470	93.140	712.85	4.01	4.34	12.57	40°10'29.755"N	104°45'56.084"W	0.37	
813.00	1.370	91.900	812.82	3.83	4.23	15.05	40°10'29.754"N	104°45'56.052"W	0.10	
873.00	1.510	103.290	872.81	3.59	4.03	16.53	40°10'29.752"N	104°45'56.033"W	0.53	Tie-Into GYRO Surveys
972.00	0.910	352.250	971.79	4.04	4.51	17.70	40°10'29.757"N	104°45'56.018"W	2.04	Begin BHI MWD Surveys
1065.00	0.580	238.190	1064.79	4.53	4.99	17.20	40°10'29.761"N	104°45'56.024"W	1.36	
1156.00	2.270	193.250	1155.76	2.56	2.99	16.39	40°10'29.742"N	104°45'56.035"W	2.09	
1249.00	3.100	170.380	1248.66	-1.71	-1.28	16.39	40°10'29.699"N	104°45'56.035"W	1.44	
1341.00	3.890	154.650	1340.49	-7.03	-6.55	18.14	40°10'29.647"N	104°45'56.012"W	1.34	
1433.00	4.280	138.050	1432.26	-12.50	-11.93	21.77	40°10'29.594"N	104°45'55.965"W	1.35	
1528.00	3.260	109.500	1527.06	-16.17	-15.47	26.69	40°10'29.559"N	104°45'55.902"W	2.22	
1622.00	1.960	98.000	1620.96	-17.39	-16.58	30.80	40°10'29.548"N	104°45'55.849"W	1.48	
1717.00	1.760	80.660	1715.91	-17.46	-16.57	33.85	40°10'29.548"N	104°45'55.810"W	0.63	
1812.00	0.830	134.420	1810.89	-17.76	-16.82	35.78	40°10'29.546"N	104°45'55.785"W	1.51	
1907.00	2.190	172.100	1905.85	-20.05	-19.10	36.52	40°10'29.523"N	104°45'55.775"W	1.70	
2002.00	2.520	177.810	2000.77	-23.95	-22.98	36.85	40°10'29.485"N	104°45'55.771"W	0.43	
2097.00	3.090	152.480	2095.66	-28.34	-27.34	38.12	40°10'29.442"N	104°45'55.755"W	1.42	
2191.00	1.610	141.730	2189.58	-31.67	-30.62	40.10	40°10'29.409"N	104°45'55.729"W	1.64	
2286.00	1.590	135.540	2284.55	-33.71	-32.61	41.85	40°10'29.390"N	104°45'55.707"W	0.18	
2381.00	1.720	142.410	2379.51	-35.82	-34.68	43.65	40°10'29.369"N	104°45'55.684"W	0.25	
2476.00	1.880	145.510	2474.46	-38.28	-37.10	45.40	40°10'29.345"N	104°45'55.661"W	0.20	
2571.00	1.870	103.460	2569.41	-39.99	-38.74	47.79	40°10'29.329"N	104°45'55.630"W	1.42	
2665.00	1.880	89.740	2663.36	-40.42	-39.09	50.82	40°10'29.326"N	104°45'55.591"W	0.48	
2760.00	0.380	131.950	2758.34	-40.67	-39.29	52.61	40°10'29.324"N	104°45'55.568"W	1.70	
2855.00	0.750	112.630	2853.34	-41.14	-39.74	53.42	40°10'29.319"N	104°45'55.558"W	0.43	
2950.00	0.710	113.210	2948.33	-41.64	-40.21	54.54	40°10'29.315"N	104°45'55.543"W	0.04	
3045.00	1.220	148.890	3043.32	-42.77	-41.31	55.60	40°10'29.304"N	104°45'55.530"W	0.81	
3139.00	1.660	160.620	3137.29	-44.93	-43.45	56.57	40°10'29.283"N	104°45'55.517"W	0.56	
3234.00	1.600	171.980	3232.25	-47.56	-46.07	57.21	40°10'29.257"N	104°45'55.509"W	0.35	
3329.00	2.580	158.820	3327.18	-50.89	-49.37	58.17	40°10'29.224"N	104°45'55.497"W	1.14	
3424.00	2.750	157.380	3422.08	-55.03	-53.47	59.82	40°10'29.184"N	104°45'55.475"W	0.19	
3519.00	2.020	167.570	3517.00	-58.80	-57.21	61.06	40°10'29.147"N	104°45'55.459"W	0.89	
3614.00	2.690	161.800	3611.92	-62.58	-60.96	62.11	40°10'29.110"N	104°45'55.446"W	0.75	
3708.00	2.400	142.440	3705.83	-66.29	-64.62	64.00	40°10'29.073"N	104°45'55.422"W	0.96	
3803.00	2.280	117.750	3800.75	-68.82	-67.07	66.89	40°10'29.049"N	104°45'55.384"W	1.06	
3898.00	1.380	122.310	3895.70	-70.38	-68.57	69.53	40°10'29.034"N	104°45'55.350"W	0.96	
3993.00	1.800	141.340	3990.67	-72.21	-70.34	71.42	40°10'29.017"N	104°45'55.326"W	0.70	
4088.00	2.280	145.980	4085.61	-74.99	-73.07	73.41	40°10'28.990"N	104°45'55.300"W	0.53	



Actual Wellpath Report

RATTLER 3N-34HZ AWP

Page 3 of 7



REFERENCE WELLPATH IDENTIFICATION

Operator	KERR-MCGEE OIL & GAS ONSHORE LP	Slot	SLOT#25 RATTLER 3N-34HZ (200'FSL & 1987'FWL,SEC.34)
Area	COLORADO	Well	RATTLER 3N-34HZ
Field	WELD COUNTY (KERR MCGEE)	Wellbore	RATTLER 3N-34HZ AWB
Facility	SEC.34-T3N-R66W		

WELLPATH DATA (148 stations)

MD [ft]	Inclination [°]	Azimuth [°]	TVD [ft]	Vert Sect [ft]	North [ft]	East [ft]	Latitude	Longitude	DLS [°/100ft]	Comments
4183.00	2.040	128.140	4180.54	-77.66	-75.68	75.80	40°10'28.964"N	104°45'55.269"W	0.75	
4277.00	1.570	100.640	4274.49	-79.00	-76.95	78.38	40°10'28.952"N	104°45'55.236"W	1.03	
4372.00	1.730	110.880	4369.45	-79.82	-77.71	81.00	40°10'28.944"N	104°45'55.203"W	0.35	
4467.00	1.590	112.870	4464.41	-80.91	-78.73	83.56	40°10'28.934"N	104°45'55.170"W	0.16	
4562.00	2.030	99.910	4559.37	-81.79	-79.53	86.43	40°10'28.926"N	104°45'55.133"W	0.63	
4657.00	1.450	119.180	4654.32	-82.74	-80.41	89.13	40°10'28.917"N	104°45'55.098"W	0.86	
4752.00	1.300	159.370	4749.30	-84.37	-82.00	90.56	40°10'28.902"N	104°45'55.079"W	1.01	
4847.00	1.730	165.680	4844.27	-86.78	-84.40	91.30	40°10'28.878"N	104°45'55.070"W	0.48	
4942.00	1.750	163.340	4939.22	-89.58	-87.18	92.07	40°10'28.850"N	104°45'55.060"W	0.08	
5036.00	1.380	174.380	5033.19	-92.10	-89.68	92.59	40°10'28.826"N	104°45'55.053"W	0.51	
5131.00	1.210	177.410	5128.16	-94.24	-91.82	92.75	40°10'28.805"N	104°45'55.051"W	0.19	
5226.00	1.300	169.220	5223.14	-96.31	-93.88	92.99	40°10'28.784"N	104°45'55.048"W	0.21	
5321.00	1.440	181.800	5318.11	-98.56	-96.13	93.16	40°10'28.762"N	104°45'55.046"W	0.35	
5416.00	2.250	161.820	5413.06	-101.54	-99.10	93.70	40°10'28.733"N	104°45'55.039"W	1.08	
5511.00	3.560	150.880	5507.94	-105.94	-103.45	95.72	40°10'28.690"N	104°45'55.013"W	1.49	
5605.00	3.340	154.070	5601.77	-111.02	-108.46	98.34	40°10'28.640"N	104°45'54.979"W	0.31	
5700.00	2.130	134.540	5696.66	-114.81	-112.19	100.81	40°10'28.603"N	104°45'54.947"W	1.59	
5795.00	1.740	129.320	5791.61	-117.03	-114.34	103.18	40°10'28.582"N	104°45'54.917"W	0.45	
5890.00	1.660	133.030	5886.57	-118.93	-116.19	105.30	40°10'28.564"N	104°45'54.889"W	0.14	
5985.00	1.430	129.790	5981.53	-120.68	-117.89	107.22	40°10'28.547"N	104°45'54.865"W	0.26	
6080.00	1.180	133.460	6076.51	-122.16	-119.32	108.84	40°10'28.533"N	104°45'54.844"W	0.28	
6174.00	0.940	137.030	6170.49	-123.42	-120.55	110.07	40°10'28.521"N	104°45'54.828"W	0.26	
6269.00	1.910	170.170	6265.46	-125.57	-122.68	110.87	40°10'28.500"N	104°45'54.818"W	1.30	
6364.00	2.210	174.630	6360.40	-128.96	-126.06	111.31	40°10'28.466"N	104°45'54.812"W	0.36	
6459.00	2.060	173.500	6455.33	-132.49	-129.58	111.68	40°10'28.431"N	104°45'54.807"W	0.16	
6531.00	1.800	172.940	6527.29	-134.91	-131.99	111.96	40°10'28.408"N	104°45'54.804"W	0.36	
6554.00	2.000	177.980	6550.28	-135.67	-132.75	112.02	40°10'28.400"N	104°45'54.803"W	1.13	
6586.00	1.490	170.470	6582.27	-136.64	-133.72	112.11	40°10'28.391"N	104°45'54.802"W	1.74	
6617.00	2.240	32.150	6613.26	-136.53	-133.60	112.50	40°10'28.392"N	104°45'54.797"W	11.28	
6649.00	6.780	16.500	6645.15	-134.21	-131.26	113.37	40°10'28.415"N	104°45'54.786"W	14.57	
6681.00	11.140	13.840	6676.75	-129.43	-126.45	114.64	40°10'28.462"N	104°45'54.769"W	13.68	
6712.00	13.330	14.260	6707.05	-123.11	-120.08	116.24	40°10'28.525"N	104°45'54.749"W	7.07	
6744.00	12.860	18.850	6738.22	-116.22	-113.13	118.30	40°10'28.594"N	104°45'54.722"W	3.57	
6776.00	15.560	18.530	6769.23	-108.85	-105.69	120.82	40°10'28.668"N	104°45'54.690"W	8.44	
6807.00	18.120	17.350	6798.90	-100.38	-97.14	123.57	40°10'28.752"N	104°45'54.654"W	8.33	
6839.00	21.680	15.570	6828.99	-90.01	-86.70	126.65	40°10'28.855"N	104°45'54.614"W	11.28	
6870.00	24.330	14.740	6857.52	-78.41	-75.00	129.81	40°10'28.971"N	104°45'54.574"W	8.61	
6902.00	25.030	12.540	6886.60	-65.51	-62.02	132.96	40°10'29.099"N	104°45'54.533"W	3.61	
6934.00	27.860	8.240	6915.25	-51.57	-48.01	135.50	40°10'29.238"N	104°45'54.500"W	10.67	
6965.00	31.390	4.520	6942.19	-36.40	-32.78	137.17	40°10'29.388"N	104°45'54.479"W	12.83	
6997.00	33.880	3.740	6969.14	-19.23	-15.57	138.41	40°10'29.558"N	104°45'54.463"W	7.89	
7029.00	34.790	2.210	6995.56	-1.24	2.45	139.35	40°10'29.736"N	104°45'54.451"W	3.92	
7059.00	35.780	4.110	7020.05	16.03	19.75	140.30	40°10'29.907"N	104°45'54.439"W	4.93	
7092.00	36.920	7.470	7046.63	35.43	39.20	142.28	40°10'30.099"N	104°45'54.413"W	6.95	
7124.00	39.320	8.200	7071.81	54.92	58.77	144.98	40°10'30.293"N	104°45'54.378"W	7.63	



Actual Wellpath Report

RATTLER 3N-34HZ AWP

Page 4 of 7



REFERENCE WELLPATH IDENTIFICATION

Operator	KERR-MCGEE OIL & GAS ONSHORE LP	Slot	SLOT#25 RATTLER 3N-34HZ (200'FSL & 1987'FWL,SEC.34)
Area	COLORADO	Well	RATTLER 3N-34HZ
Field	WELD COUNTY (KERR MCGEE)	Wellbore	RATTLER 3N-34HZ AWB
Facility	SEC.34-T3N-R66W		

WELLPATH DATA (148 stations) † = interpolated/extrapolated station

MD [ft]	Inclination [°]	Azimuth [°]	TVD [ft]	Vert Sect [ft]	North [ft]	East [ft]	Latitude	Longitude	DLS [°/100ft]	Comments
7155.00	43.920	9.100	7094.98	75.18	79.12	148.08	40°10'30.494"N	104°45'54.338"W	14.96	
7187.00	47.330	7.700	7117.35	97.70	101.74	151.42	40°10'30.717"N	104°45'54.295"W	11.11	
7218.00	50.610	6.070	7137.70	120.83	124.96	154.21	40°10'30.947"N	104°45'54.259"W	11.30	
7250.00	55.210	3.830	7156.99	146.19	150.38	156.40	40°10'31.198"N	104°45'54.231"W	15.42	
7282.00	59.340	1.490	7174.29	173.03	177.26	157.63	40°10'31.464"N	104°45'54.215"W	14.30	
7313.00	63.880	0.470	7189.03	200.27	204.52	158.09	40°10'31.733"N	104°45'54.209"W	14.93	
7345.00	68.580	358.910	7201.92	229.54	233.80	157.93	40°10'32.022"N	104°45'54.211"W	15.35	
7376.00	73.160	356.820	7212.08	258.82	263.06	156.83	40°10'32.312"N	104°45'54.226"W	16.09	
7408.00	77.360	355.620	7220.22	289.73	293.93	154.79	40°10'32.617"N	104°45'54.252"W	13.62	
7439.00	83.180	354.710	7225.46	320.22	324.36	152.21	40°10'32.917"N	104°45'54.285"W	19.00	
7471.00	87.870	354.730	7227.95	352.05	356.12	149.28	40°10'33.231"N	104°45'54.323"W	14.66	
7512.00	91.100	353.700	7228.32	392.92	396.90	145.14	40°10'33.634"N	104°45'54.376"W	8.27	
7544.00†	91.769	353.498	7227.52	424.80	428.69	141.58	40°10'33.948"N	104°45'54.422"W	2.19	7" Casing Point
7599.00	92.920	353.150	7225.27	479.53	483.27	135.19	40°10'34.488"N	104°45'54.504"W	2.19	
7694.00	91.590	353.130	7221.53	574.04	577.52	123.85	40°10'35.419"N	104°45'54.650"W	1.40	
7788.00	91.970	354.500	7218.61	667.68	670.92	113.73	40°10'36.342"N	104°45'54.781"W	1.51	
7883.00	91.780	356.350	7215.50	762.49	765.56	106.16	40°10'37.277"N	104°45'54.878"W	1.96	
7978.00	90.330	356.330	7213.76	857.40	860.35	100.09	40°10'38.214"N	104°45'54.957"W	1.53	
8073.00	89.320	358.630	7214.05	952.38	955.25	95.92	40°10'39.152"N	104°45'55.010"W	2.64	
8168.00	89.410	0.820	7215.10	1047.35	1050.24	95.46	40°10'40.090"N	104°45'55.016"W	2.31	
8262.00	89.440	0.070	7216.04	1141.29	1144.23	96.19	40°10'41.019"N	104°45'55.007"W	0.80	
8357.00	90.150	1.030	7216.38	1236.22	1239.22	97.10	40°10'41.958"N	104°45'54.995"W	1.26	
8452.00	90.550	0.530	7215.80	1331.15	1334.21	98.40	40°10'42.897"N	104°45'54.978"W	0.67	
8547.00	90.300	359.760	7215.10	1426.10	1429.21	98.64	40°10'43.835"N	104°45'54.975"W	0.85	
8642.00	90.890	0.160	7214.11	1521.06	1524.20	98.57	40°10'44.774"N	104°45'54.976"W	0.75	
8737.00	91.200	358.580	7212.38	1616.03	1619.18	97.53	40°10'45.713"N	104°45'54.990"W	1.69	
8831.00	89.630	358.000	7211.70	1710.03	1713.13	94.72	40°10'46.641"N	104°45'55.026"W	1.78	
8926.00	89.690	356.320	7212.26	1805.00	1808.01	90.01	40°10'47.579"N	104°45'55.086"W	1.77	
9021.00	90.330	356.940	7212.24	1899.95	1902.84	84.43	40°10'48.516"N	104°45'55.158"W	0.94	
9116.00	90.670	358.570	7211.42	1994.93	1997.76	80.71	40°10'49.454"N	104°45'55.206"W	1.75	
9211.00	91.380	359.130	7209.72	2089.91	2092.73	78.80	40°10'50.392"N	104°45'55.231"W	0.95	
9306.00	91.040	358.850	7207.71	2184.89	2187.69	77.13	40°10'51.331"N	104°45'55.252"W	0.46	
9400.00	91.040	0.040	7206.00	2278.86	2281.67	76.22	40°10'52.260"N	104°45'55.264"W	1.27	
9495.00	91.410	359.160	7203.97	2373.82	2376.65	75.55	40°10'53.198"N	104°45'55.273"W	1.00	
9590.00	90.030	358.660	7202.78	2468.80	2471.62	73.75	40°10'54.137"N	104°45'55.296"W	1.55	
9685.00	90.000	359.260	7202.75	2563.80	2566.60	72.02	40°10'55.075"N	104°45'55.318"W	0.63	
9780.00	90.180	358.640	7202.60	2658.80	2661.59	70.28	40°10'56.014"N	104°45'55.340"W	0.68	
9875.00	90.030	359.440	7202.43	2753.79	2756.57	68.69	40°10'56.952"N	104°45'55.361"W	0.86	
9970.00	89.930	359.060	7202.46	2848.78	2851.56	67.45	40°10'57.891"N	104°45'55.377"W	0.41	
10064.00	90.300	358.820	7202.27	2942.78	2945.55	65.71	40°10'58.820"N	104°45'55.399"W	0.47	
10159.00	90.180	357.110	7201.88	3037.77	3040.48	62.33	40°10'59.758"N	104°45'55.443"W	1.80	
10254.00	90.860	355.560	7201.01	3132.70	3135.28	56.26	40°11'00.695"N	104°45'55.521"W	1.78	
10349.00	91.690	354.030	7198.90	3227.47	3229.86	47.65	40°11'01.630"N	104°45'55.632"W	1.83	
10444.00	91.010	352.870	7196.66	3322.08	3324.21	36.81	40°11'02.562"N	104°45'55.772"W	1.42	
10539.00	90.490	350.080	7195.42	3416.35	3418.15	22.73	40°11'03.490"N	104°45'55.953"W	2.99	



Actual Wellpath Report

RATTLER 3N-34HZ AWP

Page 5 of 7



REFERENCE WELLPATH IDENTIFICATION			
Operator	KERR-MCGEE OIL & GAS ONSHORE LP	Slot	SLOT#25 RATTLER 3N-34HZ (200'FSL & 1987'FWL,SEC.34)
Area	COLORADO	Well	RATTLER 3N-34HZ
Field	WELD COUNTY (KERR MCGEE)	Wellbore	RATTLER 3N-34HZ AWB
Facility	SEC.34-T3N-R66W		

WELLPATH DATA (148 stations)

MD [ft]	Inclination [°]	Azimuth [°]	TVD [ft]	Vert Sect [ft]	North [ft]	East [ft]	Latitude	Longitude	DLS [°/100ft]	Comments
10633.00	91.130	348.590	7194.09	3509.14	3510.51	5.34	40°11'04.403"N	104°45'56.177"W	1.72	
10728.00	91.470	348.390	7191.93	3602.68	3603.58	-13.61	40°11'05.323"N	104°45'56.421"W	0.42	
10823.00	91.330	348.340	7189.61	3696.17	3696.60	-32.77	40°11'06.242"N	104°45'56.668"W	0.16	
10918.00	91.010	349.220	7187.67	3789.79	3789.76	-51.25	40°11'07.162"N	104°45'56.906"W	0.99	
11013.00	90.060	350.020	7186.79	3883.65	3883.20	-68.36	40°11'08.086"N	104°45'57.127"W	1.31	
11108.00	89.690	351.690	7186.99	3977.80	3976.99	-83.46	40°11'09.013"N	104°45'57.321"W	1.80	
11203.00	89.630	352.410	7187.56	4072.20	4071.07	-96.60	40°11'09.942"N	104°45'57.491"W	0.76	
11297.00	89.470	354.830	7188.30	4165.85	4164.48	-107.04	40°11'10.865"N	104°45'57.625"W	2.58	
11392.00	88.360	355.750	7190.09	4260.69	4259.14	-114.84	40°11'11.801"N	104°45'57.726"W	1.52	
11487.00	87.470	358.150	7193.55	4355.58	4353.94	-119.89	40°11'12.738"N	104°45'57.791"W	2.69	
11582.00	87.310	359.250	7197.88	4450.48	4448.81	-122.05	40°11'13.675"N	104°45'57.819"W	1.17	
11656.00	87.040	0.630	7201.53	4524.37	4522.72	-122.12	40°11'14.406"N	104°45'57.820"W	1.90	Last BHI MWD Survey
11723.00	87.040	0.630	7204.98	4591.23	4589.63	-121.39	40°11'15.067"N	104°45'57.810"W	0.00	Projection to Bit

HOLE & CASING SECTIONS - Ref Wellbore: RATTLER 3N-34HZ AWB Ref Wellpath: RATTLER 3N-34HZ AWP

String/Diameter	Start MD [ft]	End MD [ft]	Interval [ft]	Start TVD [ft]	End TVD [ft]	Start N/S [ft]	Start E/W [ft]	End N/S [ft]	End E/W [ft]
12.25in Open Hole	13.00	930.00	917.00	13.00	929.80	0.00	0.00	4.04	17.54
9.625in Casing Surface	13.00	930.00	917.00	13.00	929.80	0.00	0.00	4.04	17.54
8.75in Open Hole	930.00	7568.00	6638.00	929.80	7226.67	4.04	17.54	452.52	138.83
7in Casing Intermediate	13.00	7544.00	7531.00	13.00	7227.52	0.00	0.00	428.69	141.58
6.125in Open Hole	7544.00	11723.00	4179.00	7227.52	7204.98	428.69	141.58	4589.63	-121.39



Actual Wellpath Report

RATTLER 3N-34HZ AWP

Page 6 of 7



REFERENCE WELLPATH IDENTIFICATION

Operator	KERR-MCGEE OIL & GAS ONSHORE LP	Slot	SLOT#25 RATTLER 3N-34HZ (200'FSL & 1987'FWL,SEC.34)
Area	COLORADO	Well	RATTLER 3N-34HZ
Field	WELD COUNTY (KERR MCGEE)	Wellbore	RATTLER 3N-34HZ AWB
Facility	SEC.34-T3N-R66W		

TARGETS

Name	MD [ft]	TVD [ft]	North [ft]	East [ft]	Grid East [US ft]	Grid North [US ft]	Latitude	Longitude	Shape
RATTLER SECTION 34 LINES		19.00	-14.12	-1523.30	3203684.99	1307389.26	40°10'29.572"N	104°46'15.870"W	polygon
RATTLER 3N-34HZ BHL (460'FNL & 1890'FWL,SEC.34) REV-2		7193.00	4614.95	-118.74	3205051.11	1312029.60	40°11'15.317"N	104°45'57.776"W	point
RATTLER 3N-34HZ BHL ON PLAT (460'FNL & 1995'FWL,SEC.34) REV-1		7193.00	4614.95	-13.74	3205156.10	1312030.47	40°11'15.317"N	104°45'56.423"W	point
RATTLER SEC.34 HARDLINES (460' SETBACKS)		7219.00	-14.12	-1523.30	3203684.99	1307389.26	40°10'29.572"N	104°46'15.870"W	polygon

WELLPATH COMPOSITION - Ref Wellbore: RATTLER 3N-34HZ AWB Ref Wellpath: RATTLER 3N-34HZ AWP

Start MD [ft]	End MD [ft]	Positional Uncertainty Model	Log Name/Comment	Wellbore
13.00	873.00	Gyrodata standard - Continuous gyro	GYRODATA SURVEYS <113-873>	RATTLER 3N-34HZ AWB
873.00	7512.00	NaviTrak (Standard)	BHI MWD SURVEYS 8 3/4" HOLE <972-7512>	RATTLER 3N-34HZ AWB
7512.00	11656.00	OnTrak (Standard)	BHI MWD SURVEYS 6 1/8" HOLE <7599-11656>	RATTLER 3N-34HZ AWB
11656.00	11723.00	Blind Drilling (std)	Projection to bit	RATTLER 3N-34HZ AWB



Actual Wellpath Report

RATTLER 3N-34HZ AWP

Page 7 of 7



REFERENCE WELLPATH IDENTIFICATION			
Operator	KERR-MCGEE OIL & GAS ONSHORE LP	Slot	SLOT#25 RATTLER 3N-34HZ (200'FSL & 1987'FWL,SEC.34)
Area	COLORADO	Well	RATTLER 3N-34HZ
Field	WELD COUNTY (KERR MCGEE)	Wellbore	RATTLER 3N-34HZ AWB
Facility	SEC.34-T3N-R66W		

WELLPATH COMMENTS				
MD [ft]	Inclination [°]	Azimuth [°]	TVD [ft]	Comment
13.00	0.000	54.860	13.00	Tie-On
113.00	0.960	54.860	113.00	Begin GYRO Surveys
873.00	1.510	103.290	872.81	Tie-Into GYRO Surveys
972.00	0.910	352.250	971.79	Begin BHI MWD Surveys
7544.00	91.769	353.498	7227.52	7" Casing Point
11656.00	87.040	0.630	7201.53	Last BHI MWD Survey
11723.00	87.040	0.630	7204.98	Projection to Bit