

ENDEAVOUR OPERATING CORPORATION

LOCATION DRAWING

WILEY 22-3-97-1

Pad Location: NWNW SECTION 22, T3N, R97W, 6th P.M.

Section Line

SURFACE USE NOTE:

Surface use of the well site is Livestock Grazing. Vegetation consists mainly of Sagebrush and Native Grasses.

LOCATION
REFERENCE POINT
(22-3-97-1 Well
Pad)

Section Line

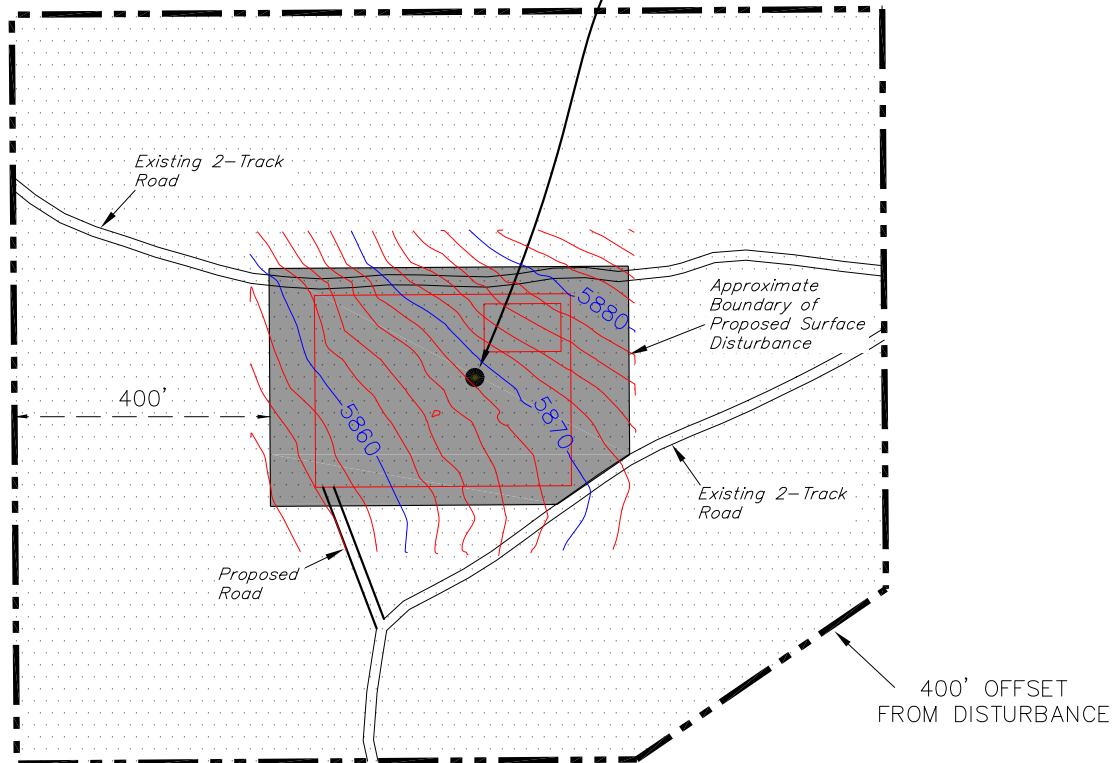

SEC. 22

Distances from Well Head

WELL	BUILDING	ABOVE GROUND UTILITY	PUBLIC ROAD	RAILROAD
22-3	S35°W 2693'	S45°W 28671'	S34°W 18774'	S16°E 52 MILES



SURVEYED BY: S.Y. DATE SURVEYED: 05-11-12
 DRAWN BY: M.W. DATE DRAWN: 05-29-12
 SCALE: 1" = 300' REVISED: M.W. 08-02-12

Tri State
 Land Surveying, Inc.
 180 NORTH VERNAL AVE. VERNAL, UTAH 84078
 (435) 781-2501

SHEET
1b