

# Whiting Oil & Gas

Well Name: **Wildhorse #16-1613H**

Surface Location: Wildhorse #16-1613H Pad Sec.16-T9N-R59W  
North American Datum 1983 , US State Plane 1983 , Colorado Northern Zone

Ground Elevation: 5068.0

+N/-S	+E/-W	Northing	Easting	Latitude	Longitude	Slot
0.0	0.0	1517491.15	3418284.73	40.744128	-103.990400	

RKB - 16.5' WELL @ 5084.5ft (RKB - 16.5')

## WELLBORE TARGET DETAILS

Name	TVD	+N/-S	+E/-W	Shape
HARDLINES BHL 660'FEL	1.0	4079.0	3930.3	Polygon
HARDLINES SHL 660'FSL, 660'FWL	1.0	320.0	53.0	Polygon
SHL 340'FSL, 607'FWL	1.0	0.0	0.0	Point
BHL 1467'FNL, 660'FEL	6264.0	3679.0	3930.3	Point

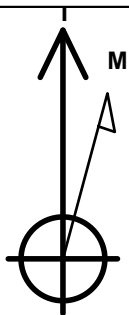

Azimuths to True North  
Magnetic North: 8.33°

Magnetic Field  
Strength: 53279.8nT  
Dip Angle: 67.42°  
Date: 6/27/2012  
Model: IGRF2010

## ANNOTATIONS

TVD	MD	Annotation
6264.0	6561.3	End of Build

Wildhorse #16-1613H Pad Sec.16-T9N-R59W  
Wildhorse #16-1613H  
Plan #1 (6-27-12)  
10:27, June 27 2012

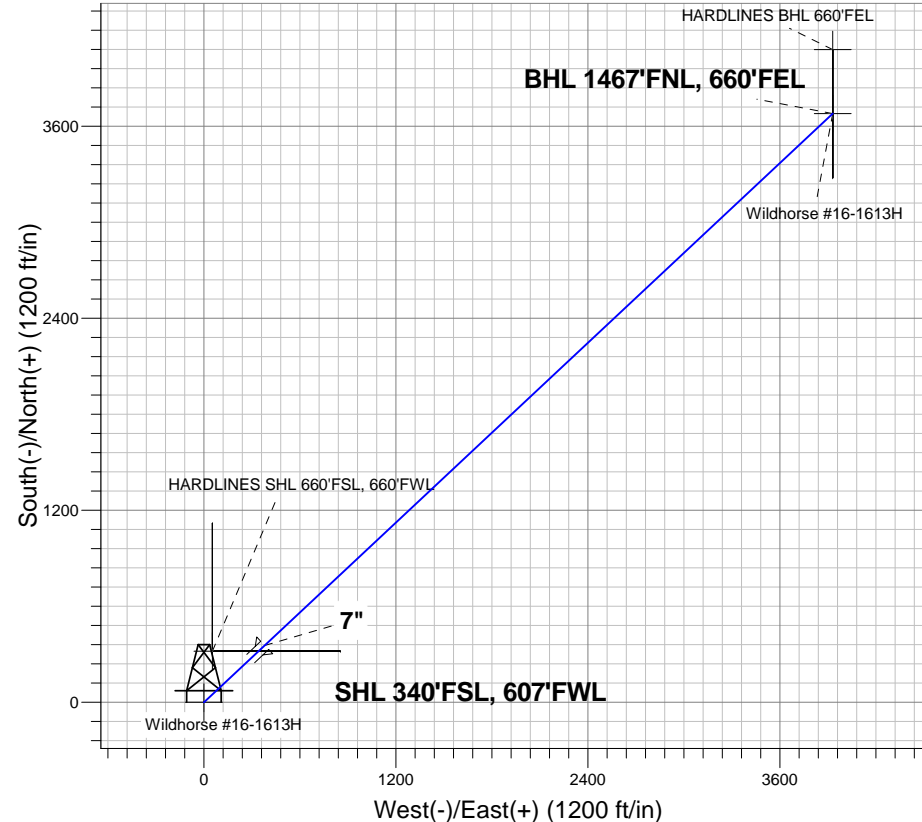

**ENSIGN**  
**Directional**

## SECTION DETAILS

Sec	MD	Inc	Azi	TVD	+N/-S	+E/-W	DLeg	TFace	VSec	Target
1	0.0	0.00	0.00	0.0	0.0	0.0	0.00	0.00	0.0	
2	5743.1	0.00	0.00	5743.1	0.0	0.0	0.00	0.00	0.0	
3	6561.3	90.00	46.89	6264.0	356.0	380.3	11.00	46.89	520.9	
4	11424.0	90.00	46.89	6264.0	3679.0	3930.3	0.00	0.00	5383.5	BHL 1467'FNL, 660'FEL

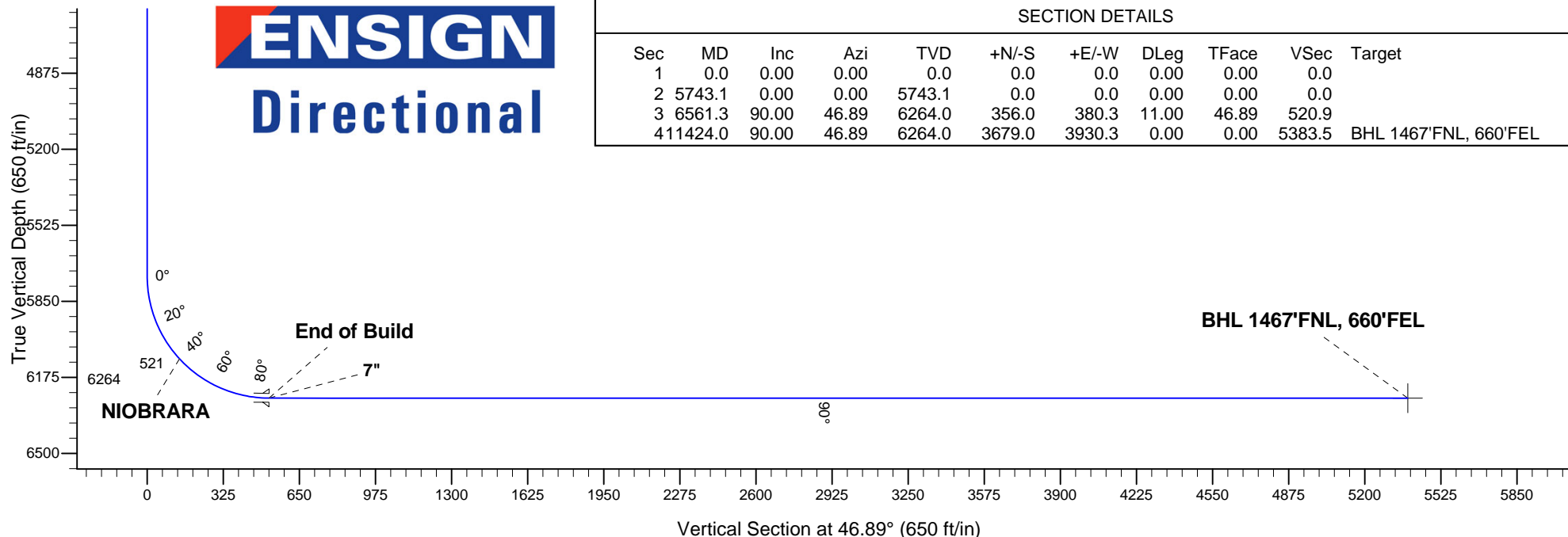



## **Directional**

### **Whiting Oil & Gas**

**SEC.16-T9N-R59W**

**Wildhorse #16-1613H Pad Sec.16-T9N-R59W**

**Wildhorse #16-1613H**

**Wellbore #1**

**Plan: Plan #1 (6-27-12)**

### **Standard Planning Report**

**27 June, 2012**

Plan Sections										
Measured Depth (ft)	Inclination (°)	Azimuth (°)	Vertical Depth (ft)	+N/-S (ft)	+E/-W (ft)	Dogleg Rate (°/100ft)	Build Rate (°/100ft)	Turn Rate (°/100ft)	TFO (°)	Target
0.0	0.00	0.00	0.0	0.0	0.0	0.00	0.00	0.00	0.00	
5,743.1	0.00	0.00	5,743.1	0.0	0.0	0.00	0.00	0.00	0.00	
6,561.3	90.00	46.89	6,264.0	356.0	380.3	11.00	11.00	0.00	46.89	
11,424.0	90.00	46.89	6,264.0	3,679.0	3,930.3	0.00	0.00	0.00	0.00	BHL 1467'FNL, 660

<b>Database:</b>	Landmark	<b>Local Co-ordinate Reference:</b>	Well Wildhorse #16-1613H
<b>Company:</b>	Whiting Oil & Gas	<b>TVD Reference:</b>	WELL @ 5084.5ft (RKB - 16.5')
<b>Project:</b>	SEC.16-T9N-R59W	<b>MD Reference:</b>	WELL @ 5084.5ft (RKB - 16.5')
<b>Site:</b>	Wildhorse #16-1613H Pad Sec.16-T9N-R59W	<b>North Reference:</b>	True
<b>Well:</b>	Wildhorse #16-1613H	<b>Survey Calculation Method:</b>	Minimum Curvature
<b>Wellbore:</b>	Wellbore #1		
<b>Design:</b>	Plan #1 (6-27-12)		

Planned Survey									
Measured Depth (ft)	Inclination (°)	Azimuth (°)	Vertical Depth (ft)	+N/-S (ft)	+E/-W (ft)	Vertical Section (ft)	Dogleg Rate (°/100ft)	Build Rate (°/100ft)	Turn Rate (°/100ft)
0.0	0.00	0.00	0.0	0.0	0.0	0.0	0.00	0.00	0.00
40.0	0.00	0.00	40.0	0.0	0.0	0.0	0.00	0.00	0.00
80.0	0.00	0.00	80.0	0.0	0.0	0.0	0.00	0.00	0.00
120.0	0.00	0.00	120.0	0.0	0.0	0.0	0.00	0.00	0.00
160.0	0.00	0.00	160.0	0.0	0.0	0.0	0.00	0.00	0.00
200.0	0.00	0.00	200.0	0.0	0.0	0.0	0.00	0.00	0.00
240.0	0.00	0.00	240.0	0.0	0.0	0.0	0.00	0.00	0.00
280.0	0.00	0.00	280.0	0.0	0.0	0.0	0.00	0.00	0.00
320.0	0.00	0.00	320.0	0.0	0.0	0.0	0.00	0.00	0.00
360.0	0.00	0.00	360.0	0.0	0.0	0.0	0.00	0.00	0.00
400.0	0.00	0.00	400.0	0.0	0.0	0.0	0.00	0.00	0.00
440.0	0.00	0.00	440.0	0.0	0.0	0.0	0.00	0.00	0.00
480.0	0.00	0.00	480.0	0.0	0.0	0.0	0.00	0.00	0.00
520.0	0.00	0.00	520.0	0.0	0.0	0.0	0.00	0.00	0.00
560.0	0.00	0.00	560.0	0.0	0.0	0.0	0.00	0.00	0.00
600.0	0.00	0.00	600.0	0.0	0.0	0.0	0.00	0.00	0.00
640.0	0.00	0.00	640.0	0.0	0.0	0.0	0.00	0.00	0.00
680.0	0.00	0.00	680.0	0.0	0.0	0.0	0.00	0.00	0.00
720.0	0.00	0.00	720.0	0.0	0.0	0.0	0.00	0.00	0.00
760.0	0.00	0.00	760.0	0.0	0.0	0.0	0.00	0.00	0.00
800.0	0.00	0.00	800.0	0.0	0.0	0.0	0.00	0.00	0.00
840.0	0.00	0.00	840.0	0.0	0.0	0.0	0.00	0.00	0.00
880.0	0.00	0.00	880.0	0.0	0.0	0.0	0.00	0.00	0.00
920.0	0.00	0.00	920.0	0.0	0.0	0.0	0.00	0.00	0.00
960.0	0.00	0.00	960.0	0.0	0.0	0.0	0.00	0.00	0.00
1,000.0	0.00	0.00	1,000.0	0.0	0.0	0.0	0.00	0.00	0.00
1,040.0	0.00	0.00	1,040.0	0.0	0.0	0.0	0.00	0.00	0.00
1,080.0	0.00	0.00	1,080.0	0.0	0.0	0.0	0.00	0.00	0.00
1,120.0	0.00	0.00	1,120.0	0.0	0.0	0.0	0.00	0.00	0.00
1,160.0	0.00	0.00	1,160.0	0.0	0.0	0.0	0.00	0.00	0.00
1,200.0	0.00	0.00	1,200.0	0.0	0.0	0.0	0.00	0.00	0.00
1,240.0	0.00	0.00	1,240.0	0.0	0.0	0.0	0.00	0.00	0.00
1,280.0	0.00	0.00	1,280.0	0.0	0.0	0.0	0.00	0.00	0.00
1,320.0	0.00	0.00	1,320.0	0.0	0.0	0.0	0.00	0.00	0.00
1,360.0	0.00	0.00	1,360.0	0.0	0.0	0.0	0.00	0.00	0.00
1,400.0	0.00	0.00	1,400.0	0.0	0.0	0.0	0.00	0.00	0.00
1,440.0	0.00	0.00	1,440.0	0.0	0.0	0.0	0.00	0.00	0.00
1,480.0	0.00	0.00	1,480.0	0.0	0.0	0.0	0.00	0.00	0.00
1,520.0	0.00	0.00	1,520.0	0.0	0.0	0.0	0.00	0.00	0.00
1,560.0	0.00	0.00	1,560.0	0.0	0.0	0.0	0.00	0.00	0.00
1,600.0	0.00	0.00	1,600.0	0.0	0.0	0.0	0.00	0.00	0.00
1,640.0	0.00	0.00	1,640.0	0.0	0.0	0.0	0.00	0.00	0.00
1,680.0	0.00	0.00	1,680.0	0.0	0.0	0.0	0.00	0.00	0.00
1,720.0	0.00	0.00	1,720.0	0.0	0.0	0.0	0.00	0.00	0.00
1,760.0	0.00	0.00	1,760.0	0.0	0.0	0.0	0.00	0.00	0.00
1,800.0	0.00	0.00	1,800.0	0.0	0.0	0.0	0.00	0.00	0.00
1,840.0	0.00	0.00	1,840.0	0.0	0.0	0.0	0.00	0.00	0.00
1,880.0	0.00	0.00	1,880.0	0.0	0.0	0.0	0.00	0.00	0.00
1,920.0	0.00	0.00	1,920.0	0.0	0.0	0.0	0.00	0.00	0.00
1,960.0	0.00	0.00	1,960.0	0.0	0.0	0.0	0.00	0.00	0.00
2,000.0	0.00	0.00	2,000.0	0.0	0.0	0.0	0.00	0.00	0.00
2,040.0	0.00	0.00	2,040.0	0.0	0.0	0.0	0.00	0.00	0.00
2,080.0	0.00	0.00	2,080.0	0.0	0.0	0.0	0.00	0.00	0.00
2,120.0	0.00	0.00	2,120.0	0.0	0.0	0.0	0.00	0.00	0.00

<b>Database:</b>	Landmark	<b>Local Co-ordinate Reference:</b>	Well Wildhorse #16-1613H
<b>Company:</b>	Whiting Oil & Gas	<b>TVD Reference:</b>	WELL @ 5084.5ft (RKB - 16.5')
<b>Project:</b>	SEC.16-T9N-R59W	<b>MD Reference:</b>	WELL @ 5084.5ft (RKB - 16.5')
<b>Site:</b>	Wildhorse #16-1613H Pad Sec.16-T9N-R59W	<b>North Reference:</b>	True
<b>Well:</b>	Wildhorse #16-1613H	<b>Survey Calculation Method:</b>	Minimum Curvature
<b>Wellbore:</b>	Wellbore #1		
<b>Design:</b>	Plan #1 (6-27-12)		

Planned Survey									
Measured Depth (ft)	Inclination (°)	Azimuth (°)	Vertical Depth (ft)	+N/-S (ft)	+E/-W (ft)	Vertical Section (ft)	Dogleg Rate (°/100ft)	Build Rate (°/100ft)	Turn Rate (°/100ft)
2,160.0	0.00	0.00	2,160.0	0.0	0.0	0.0	0.00	0.00	0.00
2,200.0	0.00	0.00	2,200.0	0.0	0.0	0.0	0.00	0.00	0.00
2,240.0	0.00	0.00	2,240.0	0.0	0.0	0.0	0.00	0.00	0.00
2,280.0	0.00	0.00	2,280.0	0.0	0.0	0.0	0.00	0.00	0.00
2,320.0	0.00	0.00	2,320.0	0.0	0.0	0.0	0.00	0.00	0.00
2,360.0	0.00	0.00	2,360.0	0.0	0.0	0.0	0.00	0.00	0.00
2,400.0	0.00	0.00	2,400.0	0.0	0.0	0.0	0.00	0.00	0.00
2,440.0	0.00	0.00	2,440.0	0.0	0.0	0.0	0.00	0.00	0.00
2,480.0	0.00	0.00	2,480.0	0.0	0.0	0.0	0.00	0.00	0.00
2,520.0	0.00	0.00	2,520.0	0.0	0.0	0.0	0.00	0.00	0.00
2,560.0	0.00	0.00	2,560.0	0.0	0.0	0.0	0.00	0.00	0.00
2,600.0	0.00	0.00	2,600.0	0.0	0.0	0.0	0.00	0.00	0.00
2,640.0	0.00	0.00	2,640.0	0.0	0.0	0.0	0.00	0.00	0.00
2,680.0	0.00	0.00	2,680.0	0.0	0.0	0.0	0.00	0.00	0.00
2,720.0	0.00	0.00	2,720.0	0.0	0.0	0.0	0.00	0.00	0.00
2,760.0	0.00	0.00	2,760.0	0.0	0.0	0.0	0.00	0.00	0.00
2,800.0	0.00	0.00	2,800.0	0.0	0.0	0.0	0.00	0.00	0.00
2,840.0	0.00	0.00	2,840.0	0.0	0.0	0.0	0.00	0.00	0.00
2,880.0	0.00	0.00	2,880.0	0.0	0.0	0.0	0.00	0.00	0.00
2,920.0	0.00	0.00	2,920.0	0.0	0.0	0.0	0.00	0.00	0.00
2,960.0	0.00	0.00	2,960.0	0.0	0.0	0.0	0.00	0.00	0.00
3,000.0	0.00	0.00	3,000.0	0.0	0.0	0.0	0.00	0.00	0.00
3,040.0	0.00	0.00	3,040.0	0.0	0.0	0.0	0.00	0.00	0.00
3,080.0	0.00	0.00	3,080.0	0.0	0.0	0.0	0.00	0.00	0.00
3,120.0	0.00	0.00	3,120.0	0.0	0.0	0.0	0.00	0.00	0.00
3,160.0	0.00	0.00	3,160.0	0.0	0.0	0.0	0.00	0.00	0.00
3,200.0	0.00	0.00	3,200.0	0.0	0.0	0.0	0.00	0.00	0.00
3,240.0	0.00	0.00	3,240.0	0.0	0.0	0.0	0.00	0.00	0.00
3,280.0	0.00	0.00	3,280.0	0.0	0.0	0.0	0.00	0.00	0.00
3,320.0	0.00	0.00	3,320.0	0.0	0.0	0.0	0.00	0.00	0.00
3,360.0	0.00	0.00	3,360.0	0.0	0.0	0.0	0.00	0.00	0.00
3,400.0	0.00	0.00	3,400.0	0.0	0.0	0.0	0.00	0.00	0.00
3,440.0	0.00	0.00	3,440.0	0.0	0.0	0.0	0.00	0.00	0.00
3,480.0	0.00	0.00	3,480.0	0.0	0.0	0.0	0.00	0.00	0.00
3,520.0	0.00	0.00	3,520.0	0.0	0.0	0.0	0.00	0.00	0.00
3,560.0	0.00	0.00	3,560.0	0.0	0.0	0.0	0.00	0.00	0.00
3,600.0	0.00	0.00	3,600.0	0.0	0.0	0.0	0.00	0.00	0.00
3,640.0	0.00	0.00	3,640.0	0.0	0.0	0.0	0.00	0.00	0.00
3,680.0	0.00	0.00	3,680.0	0.0	0.0	0.0	0.00	0.00	0.00
3,720.0	0.00	0.00	3,720.0	0.0	0.0	0.0	0.00	0.00	0.00
3,760.0	0.00	0.00	3,760.0	0.0	0.0	0.0	0.00	0.00	0.00
3,800.0	0.00	0.00	3,800.0	0.0	0.0	0.0	0.00	0.00	0.00
3,840.0	0.00	0.00	3,840.0	0.0	0.0	0.0	0.00	0.00	0.00
3,880.0	0.00	0.00	3,880.0	0.0	0.0	0.0	0.00	0.00	0.00
3,920.0	0.00	0.00	3,920.0	0.0	0.0	0.0	0.00	0.00	0.00
3,960.0	0.00	0.00	3,960.0	0.0	0.0	0.0	0.00	0.00	0.00
4,000.0	0.00	0.00	4,000.0	0.0	0.0	0.0	0.00	0.00	0.00
4,040.0	0.00	0.00	4,040.0	0.0	0.0	0.0	0.00	0.00	0.00
4,080.0	0.00	0.00	4,080.0	0.0	0.0	0.0	0.00	0.00	0.00
4,120.0	0.00	0.00	4,120.0	0.0	0.0	0.0	0.00	0.00	0.00
4,160.0	0.00	0.00	4,160.0	0.0	0.0	0.0	0.00	0.00	0.00
4,200.0	0.00	0.00	4,200.0	0.0	0.0	0.0	0.00	0.00	0.00
4,240.0	0.00	0.00	4,240.0	0.0	0.0	0.0	0.00	0.00	0.00
4,280.0	0.00	0.00	4,280.0	0.0	0.0	0.0	0.00	0.00	0.00

<b>Database:</b>	Landmark	<b>Local Co-ordinate Reference:</b>	Well Wildhorse #16-1613H
<b>Company:</b>	Whiting Oil & Gas	<b>TVD Reference:</b>	WELL @ 5084.5ft (RKB - 16.5')
<b>Project:</b>	SEC.16-T9N-R59W	<b>MD Reference:</b>	WELL @ 5084.5ft (RKB - 16.5')
<b>Site:</b>	Wildhorse #16-1613H Pad Sec.16-T9N-R59W	<b>North Reference:</b>	True
<b>Well:</b>	Wildhorse #16-1613H	<b>Survey Calculation Method:</b>	Minimum Curvature
<b>Wellbore:</b>	Wellbore #1		
<b>Design:</b>	Plan #1 (6-27-12)		

Planned Survey									
Measured Depth (ft)	Inclination (°)	Azimuth (°)	Vertical Depth (ft)	+N/-S (ft)	+E/-W (ft)	Vertical Section (ft)	Dogleg Rate (°/100ft)	Build Rate (°/100ft)	Turn Rate (°/100ft)
4,320.0	0.00	0.00	4,320.0	0.0	0.0	0.0	0.00	0.00	0.00
4,360.0	0.00	0.00	4,360.0	0.0	0.0	0.0	0.00	0.00	0.00
4,400.0	0.00	0.00	4,400.0	0.0	0.0	0.0	0.00	0.00	0.00
4,440.0	0.00	0.00	4,440.0	0.0	0.0	0.0	0.00	0.00	0.00
4,480.0	0.00	0.00	4,480.0	0.0	0.0	0.0	0.00	0.00	0.00
4,520.0	0.00	0.00	4,520.0	0.0	0.0	0.0	0.00	0.00	0.00
4,560.0	0.00	0.00	4,560.0	0.0	0.0	0.0	0.00	0.00	0.00
4,600.0	0.00	0.00	4,600.0	0.0	0.0	0.0	0.00	0.00	0.00
4,640.0	0.00	0.00	4,640.0	0.0	0.0	0.0	0.00	0.00	0.00
4,680.0	0.00	0.00	4,680.0	0.0	0.0	0.0	0.00	0.00	0.00
4,720.0	0.00	0.00	4,720.0	0.0	0.0	0.0	0.00	0.00	0.00
4,760.0	0.00	0.00	4,760.0	0.0	0.0	0.0	0.00	0.00	0.00
4,800.0	0.00	0.00	4,800.0	0.0	0.0	0.0	0.00	0.00	0.00
4,840.0	0.00	0.00	4,840.0	0.0	0.0	0.0	0.00	0.00	0.00
4,880.0	0.00	0.00	4,880.0	0.0	0.0	0.0	0.00	0.00	0.00
4,920.0	0.00	0.00	4,920.0	0.0	0.0	0.0	0.00	0.00	0.00
4,960.0	0.00	0.00	4,960.0	0.0	0.0	0.0	0.00	0.00	0.00
5,000.0	0.00	0.00	5,000.0	0.0	0.0	0.0	0.00	0.00	0.00
5,040.0	0.00	0.00	5,040.0	0.0	0.0	0.0	0.00	0.00	0.00
5,080.0	0.00	0.00	5,080.0	0.0	0.0	0.0	0.00	0.00	0.00
5,120.0	0.00	0.00	5,120.0	0.0	0.0	0.0	0.00	0.00	0.00
5,160.0	0.00	0.00	5,160.0	0.0	0.0	0.0	0.00	0.00	0.00
5,200.0	0.00	0.00	5,200.0	0.0	0.0	0.0	0.00	0.00	0.00
5,240.0	0.00	0.00	5,240.0	0.0	0.0	0.0	0.00	0.00	0.00
5,280.0	0.00	0.00	5,280.0	0.0	0.0	0.0	0.00	0.00	0.00
5,320.0	0.00	0.00	5,320.0	0.0	0.0	0.0	0.00	0.00	0.00
5,360.0	0.00	0.00	5,360.0	0.0	0.0	0.0	0.00	0.00	0.00
5,400.0	0.00	0.00	5,400.0	0.0	0.0	0.0	0.00	0.00	0.00
5,440.0	0.00	0.00	5,440.0	0.0	0.0	0.0	0.00	0.00	0.00
5,480.0	0.00	0.00	5,480.0	0.0	0.0	0.0	0.00	0.00	0.00
5,520.0	0.00	0.00	5,520.0	0.0	0.0	0.0	0.00	0.00	0.00
5,560.0	0.00	0.00	5,560.0	0.0	0.0	0.0	0.00	0.00	0.00
5,600.0	0.00	0.00	5,600.0	0.0	0.0	0.0	0.00	0.00	0.00
5,640.0	0.00	0.00	5,640.0	0.0	0.0	0.0	0.00	0.00	0.00
5,680.0	0.00	0.00	5,680.0	0.0	0.0	0.0	0.00	0.00	0.00
5,720.0	0.00	0.00	5,720.0	0.0	0.0	0.0	0.00	0.00	0.00
5,743.1	0.00	0.00	5,743.1	0.0	0.0	0.0	0.00	0.00	0.00
5,760.0	1.86	46.89	5,760.0	0.2	0.2	0.3	11.00	11.00	0.00
5,800.0	6.26	46.89	5,799.9	2.1	2.3	3.1	11.00	11.00	0.00
5,840.0	10.66	46.89	5,839.4	6.1	6.6	9.0	11.00	11.00	0.00
5,880.0	15.06	46.89	5,878.4	12.2	13.1	17.9	11.00	11.00	0.00
5,920.0	19.46	46.89	5,916.6	20.3	21.7	29.7	11.00	11.00	0.00
5,960.0	23.86	46.89	5,953.8	30.4	32.5	44.5	11.00	11.00	0.00
6,000.0	28.26	46.89	5,989.7	42.4	45.3	62.1	11.00	11.00	0.00
6,040.0	32.66	46.89	6,024.2	56.3	60.1	82.3	11.00	11.00	0.00
6,080.0	37.06	46.89	6,057.0	71.9	76.8	105.2	11.00	11.00	0.00
6,120.0	41.46	46.89	6,088.0	89.2	95.3	130.5	11.00	11.00	0.00
6,131.0	42.67	46.89	6,096.1	94.2	100.7	137.9	11.00	11.00	0.00
<b>NIORARA</b>									
6,160.0	45.86	46.89	6,116.9	108.0	115.4	158.1	11.00	11.00	0.00
6,200.0	50.26	46.89	6,143.6	128.4	137.1	187.8	11.00	11.00	0.00
6,240.0	54.66	46.89	6,168.0	150.0	160.3	219.6	11.00	11.00	0.00
6,280.0	59.06	46.89	6,189.9	172.9	184.7	253.0	11.00	11.00	0.00

<b>Database:</b>	Landmark	<b>Local Co-ordinate Reference:</b>	Well Wildhorse #16-1613H
<b>Company:</b>	Whiting Oil & Gas	<b>TVD Reference:</b>	WELL @ 5084.5ft (RKB - 16.5')
<b>Project:</b>	SEC.16-T9N-R59W	<b>MD Reference:</b>	WELL @ 5084.5ft (RKB - 16.5')
<b>Site:</b>	Wildhorse #16-1613H Pad Sec.16-T9N-R59W	<b>North Reference:</b>	True
<b>Well:</b>	Wildhorse #16-1613H	<b>Survey Calculation Method:</b>	Minimum Curvature
<b>Wellbore:</b>	Wellbore #1		
<b>Design:</b>	Plan #1 (6-27-12)		

Planned Survey									
Measured Depth (ft)	Inclination (°)	Azimuth (°)	Vertical Depth (ft)	+N/-S (ft)	+E/-W (ft)	Vertical Section (ft)	Dogleg Rate (°/100ft)	Build Rate (°/100ft)	Turn Rate (°/100ft)
6,320.0	63.46	46.89	6,209.1	196.9	210.3	288.1	11.00	11.00	0.00
6,360.0	67.86	46.89	6,225.6	221.8	236.9	324.5	11.00	11.00	0.00
6,400.0	72.26	46.89	6,239.2	247.5	264.4	362.1	11.00	11.00	0.00
6,440.0	76.66	46.89	6,249.9	273.8	292.5	400.7	11.00	11.00	0.00
6,480.0	81.06	46.89	6,257.7	300.6	321.1	439.9	11.00	11.00	0.00
6,520.0	85.46	46.89	6,262.4	327.8	350.1	479.6	11.00	11.00	0.00
6,560.0	89.86	46.89	6,264.0	355.1	379.3	519.6	11.00	11.00	0.00
6,561.3	90.00	46.89	6,264.0	355.9	380.3	520.9	11.00	11.00	0.00
End of Build - 7"									
6,600.0	90.00	46.89	6,264.0	382.4	408.5	559.6	0.00	0.00	0.00
6,640.0	90.00	46.89	6,264.0	409.7	437.7	599.6	0.00	0.00	0.00
6,680.0	90.00	46.89	6,264.0	437.1	466.9	639.6	0.00	0.00	0.00
6,720.0	90.00	46.89	6,264.0	464.4	496.1	679.6	0.00	0.00	0.00
6,760.0	90.00	46.89	6,264.0	491.7	525.3	719.6	0.00	0.00	0.00
6,800.0	90.00	46.89	6,264.0	519.1	554.5	759.6	0.00	0.00	0.00
6,840.0	90.00	46.89	6,264.0	546.4	583.7	799.6	0.00	0.00	0.00
6,880.0	90.00	46.89	6,264.0	573.7	612.9	839.6	0.00	0.00	0.00
6,920.0	90.00	46.89	6,264.0	601.1	642.1	879.6	0.00	0.00	0.00
6,960.0	90.00	46.89	6,264.0	628.4	671.3	919.6	0.00	0.00	0.00
7,000.0	90.00	46.89	6,264.0	655.7	700.5	959.6	0.00	0.00	0.00
7,040.0	90.00	46.89	6,264.0	683.1	729.7	999.6	0.00	0.00	0.00
7,080.0	90.00	46.89	6,264.0	710.4	758.9	1,039.6	0.00	0.00	0.00
7,120.0	90.00	46.89	6,264.0	737.7	788.1	1,079.6	0.00	0.00	0.00
7,160.0	90.00	46.89	6,264.0	765.1	817.4	1,119.6	0.00	0.00	0.00
7,200.0	90.00	46.89	6,264.0	792.4	846.6	1,159.6	0.00	0.00	0.00
7,240.0	90.00	46.89	6,264.0	819.8	875.8	1,199.6	0.00	0.00	0.00
7,280.0	90.00	46.89	6,264.0	847.1	905.0	1,239.6	0.00	0.00	0.00
7,320.0	90.00	46.89	6,264.0	874.4	934.2	1,279.6	0.00	0.00	0.00
7,360.0	90.00	46.89	6,264.0	901.8	963.4	1,319.6	0.00	0.00	0.00
7,400.0	90.00	46.89	6,264.0	929.1	992.6	1,359.6	0.00	0.00	0.00
7,440.0	90.00	46.89	6,264.0	956.4	1,021.8	1,399.6	0.00	0.00	0.00
7,480.0	90.00	46.89	6,264.0	983.8	1,051.0	1,439.6	0.00	0.00	0.00
7,520.0	90.00	46.89	6,264.0	1,011.1	1,080.2	1,479.6	0.00	0.00	0.00
7,560.0	90.00	46.89	6,264.0	1,038.4	1,109.4	1,519.6	0.00	0.00	0.00
7,600.0	90.00	46.89	6,264.0	1,065.8	1,138.6	1,559.6	0.00	0.00	0.00
7,640.0	90.00	46.89	6,264.0	1,093.1	1,167.8	1,599.6	0.00	0.00	0.00
7,680.0	90.00	46.89	6,264.0	1,120.4	1,197.0	1,639.6	0.00	0.00	0.00
7,720.0	90.00	46.89	6,264.0	1,147.8	1,226.2	1,679.6	0.00	0.00	0.00
7,760.0	90.00	46.89	6,264.0	1,175.1	1,255.4	1,719.6	0.00	0.00	0.00
7,800.0	90.00	46.89	6,264.0	1,202.4	1,284.6	1,759.6	0.00	0.00	0.00
7,840.0	90.00	46.89	6,264.0	1,229.8	1,313.8	1,799.6	0.00	0.00	0.00
7,880.0	90.00	46.89	6,264.0	1,257.1	1,343.0	1,839.6	0.00	0.00	0.00
7,920.0	90.00	46.89	6,264.0	1,284.5	1,372.2	1,879.6	0.00	0.00	0.00
7,960.0	90.00	46.89	6,264.0	1,311.8	1,401.4	1,919.6	0.00	0.00	0.00
8,000.0	90.00	46.89	6,264.0	1,339.1	1,430.6	1,959.6	0.00	0.00	0.00
8,040.0	90.00	46.89	6,264.0	1,366.5	1,459.8	1,999.6	0.00	0.00	0.00
8,080.0	90.00	46.89	6,264.0	1,393.8	1,489.0	2,039.6	0.00	0.00	0.00
8,120.0	90.00	46.89	6,264.0	1,421.1	1,518.2	2,079.6	0.00	0.00	0.00
8,160.0	90.00	46.89	6,264.0	1,448.5	1,547.4	2,119.6	0.00	0.00	0.00
8,200.0	90.00	46.89	6,264.0	1,475.8	1,576.6	2,159.6	0.00	0.00	0.00
8,240.0	90.00	46.89	6,264.0	1,503.1	1,605.8	2,199.6	0.00	0.00	0.00
8,280.0	90.00	46.89	6,264.0	1,530.5	1,635.0	2,239.6	0.00	0.00	0.00
8,320.0	90.00	46.89	6,264.0	1,557.8	1,664.2	2,279.6	0.00	0.00	0.00
8,360.0	90.00	46.89	6,264.0	1,585.1	1,693.4	2,319.6	0.00	0.00	0.00

<b>Database:</b>	Landmark	<b>Local Co-ordinate Reference:</b>	Well Wildhorse #16-1613H
<b>Company:</b>	Whiting Oil & Gas	<b>TVD Reference:</b>	WELL @ 5084.5ft (RKB - 16.5')
<b>Project:</b>	SEC.16-T9N-R59W	<b>MD Reference:</b>	WELL @ 5084.5ft (RKB - 16.5')
<b>Site:</b>	Wildhorse #16-1613H Pad Sec.16-T9N-R59W	<b>North Reference:</b>	True
<b>Well:</b>	Wildhorse #16-1613H	<b>Survey Calculation Method:</b>	Minimum Curvature
<b>Wellbore:</b>	Wellbore #1		
<b>Design:</b>	Plan #1 (6-27-12)		

Planned Survey									
Measured Depth (ft)	Inclination (°)	Azimuth (°)	Vertical Depth (ft)	+N/-S (ft)	+E/-W (ft)	Vertical Section (ft)	Dogleg Rate (°/100ft)	Build Rate (°/100ft)	Turn Rate (°/100ft)
8,400.0	90.00	46.89	6,264.0	1,612.5	1,722.6	2,359.6	0.00	0.00	0.00
8,440.0	90.00	46.89	6,264.0	1,639.8	1,751.8	2,399.6	0.00	0.00	0.00
8,480.0	90.00	46.89	6,264.0	1,667.1	1,781.0	2,439.6	0.00	0.00	0.00
8,520.0	90.00	46.89	6,264.0	1,694.5	1,810.2	2,479.6	0.00	0.00	0.00
8,560.0	90.00	46.89	6,264.0	1,721.8	1,839.4	2,519.6	0.00	0.00	0.00
8,600.0	90.00	46.89	6,264.0	1,749.1	1,868.6	2,559.6	0.00	0.00	0.00
8,640.0	90.00	46.89	6,264.0	1,776.5	1,897.8	2,599.6	0.00	0.00	0.00
8,680.0	90.00	46.89	6,264.0	1,803.8	1,927.0	2,639.6	0.00	0.00	0.00
8,720.0	90.00	46.89	6,264.0	1,831.2	1,956.3	2,679.6	0.00	0.00	0.00
8,760.0	90.00	46.89	6,264.0	1,858.5	1,985.5	2,719.6	0.00	0.00	0.00
8,800.0	90.00	46.89	6,264.0	1,885.8	2,014.7	2,759.6	0.00	0.00	0.00
8,840.0	90.00	46.89	6,264.0	1,913.2	2,043.9	2,799.6	0.00	0.00	0.00
8,880.0	90.00	46.89	6,264.0	1,940.5	2,073.1	2,839.6	0.00	0.00	0.00
8,920.0	90.00	46.89	6,264.0	1,967.8	2,102.3	2,879.6	0.00	0.00	0.00
8,960.0	90.00	46.89	6,264.0	1,995.2	2,131.5	2,919.6	0.00	0.00	0.00
9,000.0	90.00	46.89	6,264.0	2,022.5	2,160.7	2,959.6	0.00	0.00	0.00
9,040.0	90.00	46.89	6,264.0	2,049.8	2,189.9	2,999.6	0.00	0.00	0.00
9,080.0	90.00	46.89	6,264.0	2,077.2	2,219.1	3,039.6	0.00	0.00	0.00
9,120.0	90.00	46.89	6,264.0	2,104.5	2,248.3	3,079.6	0.00	0.00	0.00
9,160.0	90.00	46.89	6,264.0	2,131.8	2,277.5	3,119.6	0.00	0.00	0.00
9,200.0	90.00	46.89	6,264.0	2,159.2	2,306.7	3,159.6	0.00	0.00	0.00
9,240.0	90.00	46.89	6,264.0	2,186.5	2,335.9	3,199.6	0.00	0.00	0.00
9,280.0	90.00	46.89	6,264.0	2,213.8	2,365.1	3,239.6	0.00	0.00	0.00
9,320.0	90.00	46.89	6,264.0	2,241.2	2,394.3	3,279.6	0.00	0.00	0.00
9,360.0	90.00	46.89	6,264.0	2,268.5	2,423.5	3,319.6	0.00	0.00	0.00
9,400.0	90.00	46.89	6,264.0	2,295.9	2,452.7	3,359.6	0.00	0.00	0.00
9,440.0	90.00	46.89	6,264.0	2,323.2	2,481.9	3,399.6	0.00	0.00	0.00
9,480.0	90.00	46.89	6,264.0	2,350.5	2,511.1	3,439.6	0.00	0.00	0.00
9,520.0	90.00	46.89	6,264.0	2,377.9	2,540.3	3,479.6	0.00	0.00	0.00
9,560.0	90.00	46.89	6,264.0	2,405.2	2,569.5	3,519.6	0.00	0.00	0.00
9,600.0	90.00	46.89	6,264.0	2,432.5	2,598.7	3,559.6	0.00	0.00	0.00
9,640.0	90.00	46.89	6,264.0	2,459.9	2,627.9	3,599.6	0.00	0.00	0.00
9,680.0	90.00	46.89	6,264.0	2,487.2	2,657.1	3,639.6	0.00	0.00	0.00
9,720.0	90.00	46.89	6,264.0	2,514.5	2,686.3	3,679.6	0.00	0.00	0.00
9,760.0	90.00	46.89	6,264.0	2,541.9	2,715.5	3,719.6	0.00	0.00	0.00
9,800.0	90.00	46.89	6,264.0	2,569.2	2,744.7	3,759.6	0.00	0.00	0.00
9,840.0	90.00	46.89	6,264.0	2,596.5	2,773.9	3,799.6	0.00	0.00	0.00
9,880.0	90.00	46.89	6,264.0	2,623.9	2,803.1	3,839.6	0.00	0.00	0.00
9,920.0	90.00	46.89	6,264.0	2,651.2	2,832.3	3,879.6	0.00	0.00	0.00
9,960.0	90.00	46.89	6,264.0	2,678.5	2,861.5	3,919.6	0.00	0.00	0.00
10,000.0	90.00	46.89	6,264.0	2,705.9	2,890.7	3,959.6	0.00	0.00	0.00
10,040.0	90.00	46.89	6,264.0	2,733.2	2,919.9	3,999.6	0.00	0.00	0.00
10,080.0	90.00	46.89	6,264.0	2,760.5	2,949.1	4,039.6	0.00	0.00	0.00
10,120.0	90.00	46.89	6,264.0	2,787.9	2,978.3	4,079.6	0.00	0.00	0.00
10,160.0	90.00	46.89	6,264.0	2,815.2	3,007.5	4,119.6	0.00	0.00	0.00
10,200.0	90.00	46.89	6,264.0	2,842.6	3,036.7	4,159.6	0.00	0.00	0.00
10,240.0	90.00	46.89	6,264.0	2,869.9	3,065.9	4,199.6	0.00	0.00	0.00
10,280.0	90.00	46.89	6,264.0	2,897.2	3,095.1	4,239.6	0.00	0.00	0.00
10,320.0	90.00	46.89	6,264.0	2,924.6	3,124.4	4,279.6	0.00	0.00	0.00
10,360.0	90.00	46.89	6,264.0	2,951.9	3,153.6	4,319.6	0.00	0.00	0.00
10,400.0	90.00	46.89	6,264.0	2,979.2	3,182.8	4,359.6	0.00	0.00	0.00
10,440.0	90.00	46.89	6,264.0	3,006.6	3,212.0	4,399.6	0.00	0.00	0.00
10,480.0	90.00	46.89	6,264.0	3,033.9	3,241.2	4,439.6	0.00	0.00	0.00
10,520.0	90.00	46.89	6,264.0	3,061.2	3,270.4	4,479.6	0.00	0.00	0.00



<b>Database:</b>	Landmark	<b>Local Co-ordinate Reference:</b>	Well Wildhorse #16-1613H
<b>Company:</b>	Whiting Oil & Gas	<b>TVD Reference:</b>	WELL @ 5084.5ft (RKB - 16.5')
<b>Project:</b>	SEC.16-T9N-R59W	<b>MD Reference:</b>	WELL @ 5084.5ft (RKB - 16.5')
<b>Site:</b>	Wildhorse #16-1613H Pad Sec.16-T9N-R59W	<b>North Reference:</b>	True
<b>Well:</b>	Wildhorse #16-1613H	<b>Survey Calculation Method:</b>	Minimum Curvature
<b>Wellbore:</b>	Wellbore #1		
<b>Design:</b>	Plan #1 (6-27-12)		

Planned Survey										
Measured Depth (ft)	Inclination (°)	Azimuth (°)	Vertical Depth (ft)	+N/-S (ft)	+E/-W (ft)	Vertical Section (ft)	Dogleg Rate (°/100ft)	Build Rate (°/100ft)	Turn Rate (°/100ft)	
10,560.0	90.00	46.89	6,264.0	3,088.6	3,299.6	4,519.6	0.00	0.00	0.00	
10,600.0	90.00	46.89	6,264.0	3,115.9	3,328.8	4,559.6	0.00	0.00	0.00	
10,640.0	90.00	46.89	6,264.0	3,143.2	3,358.0	4,599.6	0.00	0.00	0.00	
10,680.0	90.00	46.89	6,264.0	3,170.6	3,387.2	4,639.6	0.00	0.00	0.00	
10,720.0	90.00	46.89	6,264.0	3,197.9	3,416.4	4,679.6	0.00	0.00	0.00	
10,760.0	90.00	46.89	6,264.0	3,225.2	3,445.6	4,719.6	0.00	0.00	0.00	
10,800.0	90.00	46.89	6,264.0	3,252.6	3,474.8	4,759.6	0.00	0.00	0.00	
10,840.0	90.00	46.89	6,264.0	3,279.9	3,504.0	4,799.6	0.00	0.00	0.00	
10,880.0	90.00	46.89	6,264.0	3,307.3	3,533.2	4,839.6	0.00	0.00	0.00	
10,920.0	90.00	46.89	6,264.0	3,334.6	3,562.4	4,879.6	0.00	0.00	0.00	
10,960.0	90.00	46.89	6,264.0	3,361.9	3,591.6	4,919.6	0.00	0.00	0.00	
11,000.0	90.00	46.89	6,264.0	3,389.3	3,620.8	4,959.6	0.00	0.00	0.00	
11,040.0	90.00	46.89	6,264.0	3,416.6	3,650.0	4,999.6	0.00	0.00	0.00	
11,080.0	90.00	46.89	6,264.0	3,443.9	3,679.2	5,039.6	0.00	0.00	0.00	
11,120.0	90.00	46.89	6,264.0	3,471.3	3,708.4	5,079.6	0.00	0.00	0.00	
11,160.0	90.00	46.89	6,264.0	3,498.6	3,737.6	5,119.6	0.00	0.00	0.00	
11,200.0	90.00	46.89	6,264.0	3,525.9	3,766.8	5,159.6	0.00	0.00	0.00	
11,240.0	90.00	46.89	6,264.0	3,553.3	3,796.0	5,199.6	0.00	0.00	0.00	
11,280.0	90.00	46.89	6,264.0	3,580.6	3,825.2	5,239.6	0.00	0.00	0.00	
11,320.0	90.00	46.89	6,264.0	3,607.9	3,854.4	5,279.6	0.00	0.00	0.00	
11,360.0	90.00	46.89	6,264.0	3,635.3	3,883.6	5,319.6	0.00	0.00	0.00	
11,400.0	90.00	46.89	6,264.0	3,662.6	3,912.8	5,359.6	0.00	0.00	0.00	
11,424.0	90.00	46.89	6,264.0	3,679.0	3,930.3	5,383.5	0.00	0.00	0.00	

Casing Points					
Measured Depth (ft)	Vertical Depth (ft)	Name	Casing Diameter (")	Hole Diameter (")	
6,561.3	6,264.0	7"	7	8-3/4	

Formations					
Measured Depth (ft)	Vertical Depth (ft)	Name	Lithology	Dip (°)	Dip Direction (°)
6,131.0	6,096.1	NIORARA		0.00	

Plan Annotations					
Measured Depth (ft)	Vertical Depth (ft)	Local Coordinates		Comment	
		+N/-S (ft)	+E/-W (ft)		
6,561.3	6,264.0	355.9	380.3	End of Build	