



Physical Address: 345 Comanche St.
Mail to: Box 384 Kiowa, CO 80117
Ph. 303-621-8672 - Fax 303-621-2717
www.highprairiesurvey.com

Job # 12139 Snowbird 9-15

Inv # 2016

High Prairie Surveying of Kiowa, Colorado has in accordance with a request from **Night Hawk Production LLC**, has determined the location of **Snowbird 9-15** to be 2116 feet FSL, and 694 feet FEL, (90° off Section lines) of **SECTION 15**, Township **6s**, Range **54w** of the 6th Principal Meridian, **Lincoln County**, Colorado.

Date: Staked on 7/27/12 drawn on 7/28/12.

Re: Staked by Keith Westfall

Drawn: Drawn by Elijah Frane

Location Drawing



There are no apparent improvements within 400' of proposed well pad.

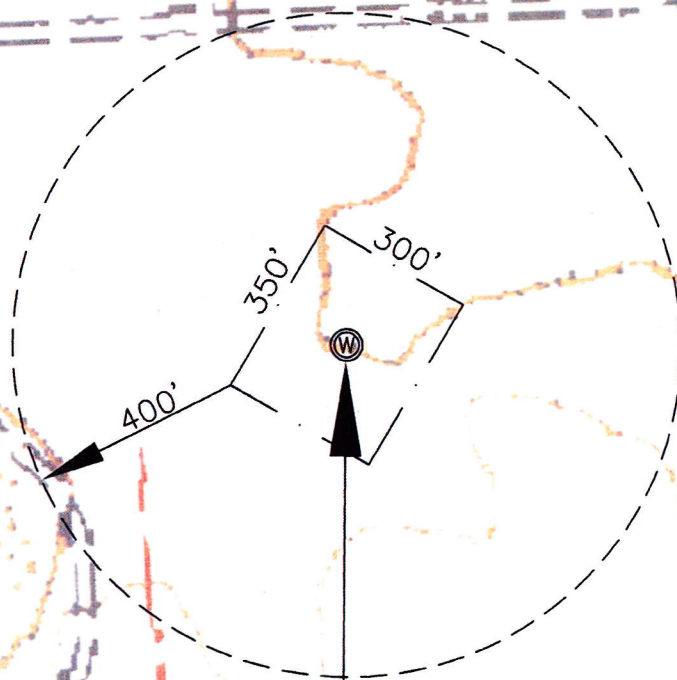

NIGHT HAWK PRODUCTION LLC.
SE 1/4 SEC. 15-6-54W
SNOWBIRD 9-15
LINCOLN, Co. COLORADO