

Well Name: **Badding 8-26SX**

Surface Location: Badding 17-26 Pad Sec.26-T2N-R66W
North American Datum 1983 US State Plane 1983 Colorado Northern Zone

Ground Elevation: 5067.0

+N/-S	+E/-W	Northing	Easting	Latitude	Longitude
0.0	0.0	1284730.23	3212800.15	40.112471	-104.739152

Original Well Elev WELL @ 5081.0ft (Original Well Elev)

Slot

Anadarko, Weld County CO

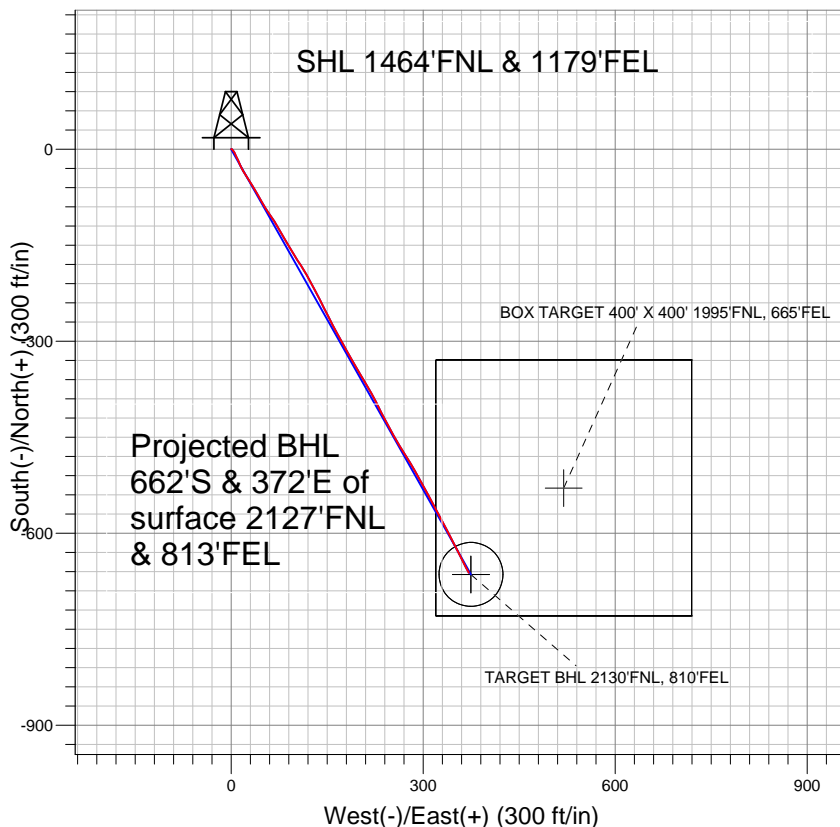
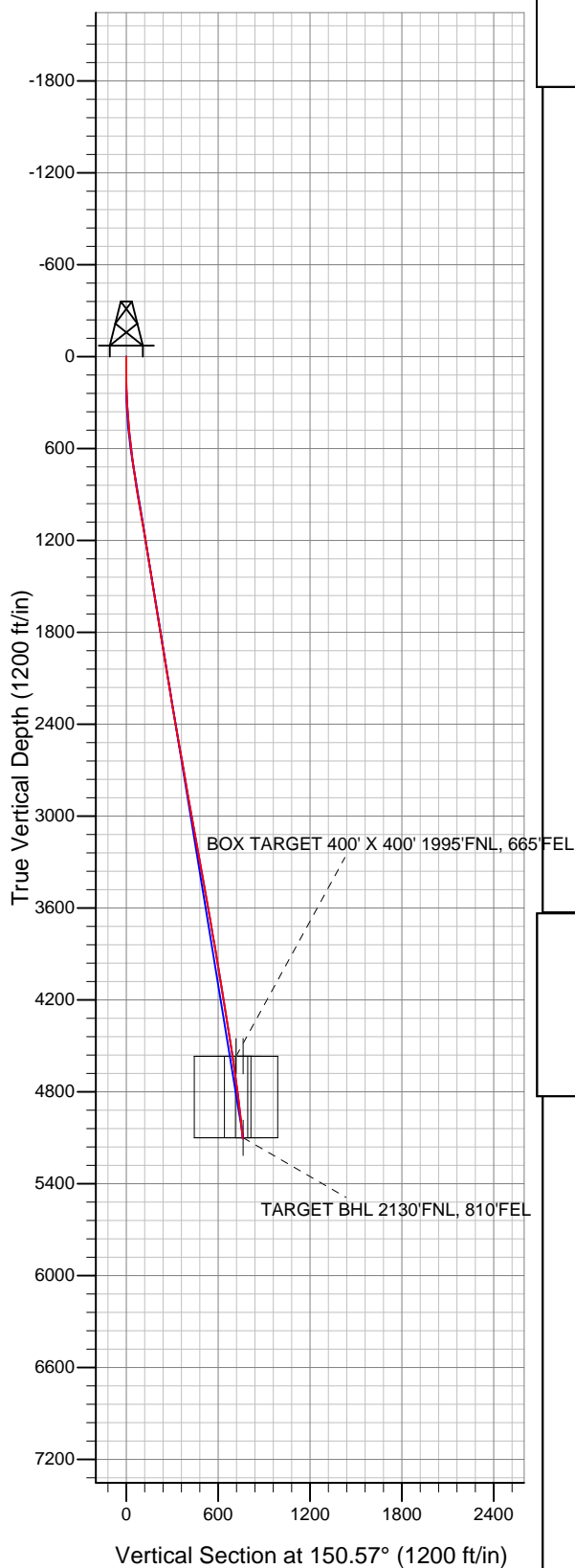

LEGEND

- Badding 8-26SX, Wellbore #1, Plan #1 (5-9-11) V0
- Wellbore #1
- Survey #1

Final Survey Plot

Projected Final Survey -
5165'MD & 5104'TVD @ 759'VS
4.6 deg Inc 148.7 deg AZ

Project: SEC.26-T2N-R66W
Site: Badding 17-26 Pad Sec.26-T2N-R66W
Well: Badding 8-26SX
Plan: Wellbore #1



Directional

Anadarko, Weld County CO

SEC.26-T2N-R66W

Badding 17-26 Pad Sec.26-T2N-R66W

Badding 8-26SX

Wellbore #1

Survey: Survey #1

Standard Survey Report

17 June, 2011

Company:	Anadarko, Weld County CO	Local Co-ordinate Reference:	Well Badding 8-26SX
Project:	SEC.26-T2N-R66W	TVD Reference:	WELL @ 5081.0ft (Original Well Elev)
Site:	Badding 17-26 Pad Sec.26-T2N-R66W	MD Reference:	WELL @ 5081.0ft (Original Well Elev)
Well:	Badding 8-26SX	North Reference:	True
Wellbore:	Wellbore #1	Survey Calculation Method:	Minimum Curvature
Design:	Wellbore #1	Database:	Landmark

Project	SEC.26-T2N-R66W, Weld County, Colorado		
Map System:	US State Plane 1983	System Datum:	Mean Sea Level
Geo Datum:	North American Datum 1983		Using Well Reference Point
Map Zone:	Colorado Northern Zone		Using geodetic scale factor

Site	Badding 17-26 Pad Sec.26-T2N-R66W		
Site Position:		Northing:	1,284,730.44 ft
From:	Lat/Long	Easting:	3,212,820.01 ft
Position Uncertainty:	0.0 ft	Slot Radius:	"
		Latitude:	40.112471
		Longitude:	-104.739081
		Grid Convergence:	0.49 °

Well	Badding 8-26SX		
Well Position	+N/-S	0.0 ft	Northing:
	+E/-W	0.0 ft	Easting:
Position Uncertainty	0.0 ft	Wellhead Elevation:	ft
		Latitude:	40.112471
		Longitude:	-104.739152
		Ground Level:	5,067.0 ft

Wellbore	Wellbore #1				
Magnetics	Model Name	Sample Date	Declination (°)	Dip Angle (°)	Field Strength (nT)
	IGRF2010	5/9/2011	8.84	66.83	52,992

Design	Wellbore #1				
Audit Notes:					
Version:	1.0	Phase:	ACTUAL	Tie On Depth:	0.0
Vertical Section:	Depth From (TVD) (ft)	+N/-S (ft)	+E/-W (ft)	Direction (°)	
	0.0	0.0	0.0	150.57	

Survey Program	Date	6/17/2011			
From (ft)	To (ft)	Survey (Wellbore)	Tool Name	Description	
118.0	5,165.0	Survey #1 (Wellbore #1)	MWD	MWD - Standard	

Survey										
Measured Depth (ft)	Inclination (°)	Azimuth (°)	Vertical Depth (ft)	+N/-S (ft)	+E/-W (ft)	Vertical Section (ft)	Dogleg Rate (°/100ft)	Build Rate (°/100ft)	Turn Rate (°/100ft)	
0.0	0.00	0.00	0.0	0.0	0.0	0.0	0.00	0.00	0.00	
118.0	0.50	50.20	118.0	0.3	0.4	-0.1	0.42	0.42	0.00	
210.0	1.50	132.10	210.0	-0.2	1.6	1.0	1.64	1.09	89.02	
303.0	3.00	148.80	302.9	-3.1	3.8	4.6	1.74	1.61	17.96	
413.0	5.00	155.50	412.6	-9.9	7.2	12.2	1.86	1.82	6.09	
501.0	5.90	155.50	500.2	-17.5	10.7	20.5	1.02	1.02	0.00	
590.0	6.50	154.90	588.7	-26.3	14.7	30.1	0.68	0.67	-0.67	
679.0	7.40	148.60	677.1	-35.7	19.9	40.9	1.32	1.01	-7.08	
767.0	8.40	147.30	764.2	-46.0	26.3	53.0	1.15	1.14	-1.48	
856.0	8.80	148.60	852.2	-57.3	33.3	66.3	0.50	0.45	1.46	
945.0	9.70	150.50	940.1	-69.6	40.6	80.6	1.07	1.01	2.13	
1,033.0	10.20	149.70	1,026.7	-82.8	48.2	95.8	0.59	0.57	-0.91	
1,160.0	9.20	145.70	1,151.9	-100.9	59.6	117.1	0.95	-0.79	-3.15	

Company:	Anadarko, Weld County CO	Local Co-ordinate Reference:	Well Badding 8-26SX
Project:	SEC.26-T2N-R66W	TVD Reference:	WELL @ 5081.0ft (Original Well Elev)
Site:	Badding 17-26 Pad Sec.26-T2N-R66W	MD Reference:	WELL @ 5081.0ft (Original Well Elev)
Well:	Badding 8-26SX	North Reference:	True
Wellbore:	Wellbore #1	Survey Calculation Method:	Minimum Curvature
Design:	Wellbore #1	Database:	Landmark

Survey

Measured Depth (ft)	Inclination (°)	Azimuth (°)	Vertical Depth (ft)	+N/-S (ft)	+E/-W (ft)	Vertical Section (ft)	Dogleg Rate (°/100ft)	Build Rate (°/100ft)	Turn Rate (°/100ft)
1,249.0	9.20	147.40	1,239.8	-112.7	67.4	131.3	0.31	0.00	1.91
1,337.0	9.50	149.80	1,326.6	-124.9	74.8	145.6	0.56	0.34	2.73
1,426.0	9.40	150.40	1,414.4	-137.6	82.1	160.2	0.16	-0.11	0.67
1,515.0	9.10	149.20	1,502.3	-150.0	89.3	174.5	0.40	-0.34	-1.35
1,603.0	9.10	148.60	1,589.1	-161.9	96.5	188.4	0.11	0.00	-0.68
1,692.0	9.30	148.00	1,677.0	-174.0	104.0	202.6	0.25	0.22	-0.67
1,781.0	9.40	146.50	1,764.8	-186.2	111.8	217.1	0.30	0.11	-1.69
1,869.0	9.30	151.80	1,851.7	-198.4	119.1	231.4	0.98	-0.11	6.02
1,958.0	9.00	152.20	1,939.5	-210.9	125.8	245.5	0.34	-0.34	0.45
2,046.0	9.00	151.20	2,026.4	-223.0	132.3	259.3	0.18	0.00	-1.14
2,135.0	9.20	153.70	2,114.3	-235.5	138.8	273.3	0.50	0.22	2.81
2,224.0	9.50	153.30	2,202.1	-248.5	145.3	287.8	0.34	0.34	-0.45
2,312.0	9.60	152.80	2,288.9	-261.5	151.9	302.4	0.15	0.11	-0.57
2,401.0	9.80	152.10	2,376.6	-274.8	158.8	317.3	0.26	0.22	-0.79
2,490.0	10.10	151.90	2,464.3	-288.3	166.0	332.7	0.34	0.34	-0.22
2,578.0	9.90	150.60	2,551.0	-301.7	173.4	348.0	0.34	-0.23	-1.48
2,667.0	9.80	151.50	2,638.7	-315.1	180.8	363.2	0.21	-0.11	1.01
2,756.0	9.80	151.20	2,726.4	-328.4	188.0	378.4	0.06	0.00	-0.34
2,844.0	10.00	148.70	2,813.0	-341.4	195.6	393.5	0.54	0.23	-2.84
2,933.0	9.80	148.70	2,900.7	-354.5	203.6	408.8	0.22	-0.22	0.00
3,021.0	10.00	149.70	2,987.4	-367.5	211.3	423.9	0.30	0.23	1.14
3,110.0	10.60	151.20	3,075.0	-381.4	219.1	439.8	0.74	0.67	1.69
3,199.0	10.20	153.00	3,162.5	-395.6	226.7	455.9	0.58	-0.45	2.02
3,287.0	10.20	153.30	3,249.1	-409.5	233.7	471.5	0.06	0.00	0.34
3,376.0	10.30	152.10	3,336.7	-423.5	241.0	487.3	0.26	0.11	-1.35
3,465.0	10.10	151.40	3,424.3	-437.4	248.4	503.0	0.26	-0.22	-0.79
3,553.0	9.80	151.20	3,511.0	-450.7	255.7	518.2	0.34	-0.34	-0.23
3,642.0	10.00	148.30	3,598.6	-464.0	263.4	533.5	0.60	0.22	-3.26
3,731.0	9.80	147.10	3,686.3	-476.9	271.6	548.8	0.32	-0.22	-1.35
3,819.0	10.10	149.70	3,773.0	-489.8	279.6	564.0	0.61	0.34	2.95
3,908.0	9.80	149.50	3,860.7	-503.1	287.4	579.4	0.34	-0.34	-0.22
3,997.0	9.60	150.20	3,948.4	-516.1	294.9	594.4	0.26	-0.22	0.79
4,085.0	9.40	151.60	4,035.2	-528.8	302.0	608.9	0.35	-0.23	1.59
4,174.0	9.20	152.50	4,123.0	-541.5	308.7	623.3	0.28	-0.22	1.01
4,262.0	8.70	153.50	4,209.9	-553.7	314.9	637.0	0.60	-0.57	1.14
4,351.0	9.00	151.10	4,297.9	-565.8	321.3	650.6	0.53	0.34	-2.70
4,440.0	9.30	152.50	4,385.7	-578.3	328.0	664.8	0.42	0.34	1.57
4,528.0	9.10	152.00	4,472.6	-590.7	334.5	678.8	0.24	-0.23	-0.57
4,617.0	8.30	151.80	4,560.6	-602.6	340.9	692.3	0.90	-0.90	-0.22
4,626.3	8.27	151.75	4,569.8	-603.8	341.5	693.6	0.35	-0.34	-0.54
BOX TARGET 400' X 400' 1995'FNL, 665'FEL									
4,633.3	8.24	151.71	4,576.7	-604.7	342.0	694.7	0.35	-0.34	-0.55
TARGET CIRCLE 2130'FNL, 810'FEL									
4,706.0	8.00	151.30	4,648.7	-613.7	346.9	704.9	0.35	-0.34	-0.57
4,794.0	7.90	153.10	4,735.8	-624.4	352.5	717.1	0.30	-0.11	2.05
4,883.0	7.70	154.00	4,824.0	-635.3	357.9	729.1	0.26	-0.22	1.01
4,972.0	7.00	154.10	4,912.3	-645.5	362.9	740.5	0.79	-0.79	0.11
5,060.0	5.60	153.40	4,999.8	-654.2	367.2	750.2	1.59	-1.59	-0.80
5,115.0	4.60	148.70	5,054.5	-658.4	369.5	755.0	1.97	-1.82	-8.55
5,160.9	4.60	148.70	5,100.3	-661.6	371.4	758.7	0.00	0.00	0.00
TARGET BHL 2130'FNL, 810'FEL									
5,165.0	4.60	148.70	5,104.4	-661.9	371.6	759.0	0.00	0.00	0.00

Company:	Anadarko, Weld County CO	Local Co-ordinate Reference:	Well Badding 8-26SX
Project:	SEC.26-T2N-R66W	TVD Reference:	WELL @ 5081.0ft (Original Well Elev)
Site:	Badding 17-26 Pad Sec.26-T2N-R66W	MD Reference:	WELL @ 5081.0ft (Original Well Elev)
Well:	Badding 8-26SX	North Reference:	True
Wellbore:	Wellbore #1	Survey Calculation Method:	Minimum Curvature
Design:	Wellbore #1	Database:	Landmark

Checked By: _____ Approved By: _____ Date: _____