

Azimuths to True North
Magnetic North: 10.31°

Magnetic Field
Strength: 52224.2snT
Dip Angle: 65.85°
Date: 5/22/2012
Model: IGRF2010

FORMATION TOP DETAILS

TVDPath	MDPath	Formation
1365.0	1401.0	A GROOVE
1530.0	1577.4	B GROOVE
1560.0	1609.5	B GROOVE BASE
2546.0	2663.7	GARDEN GULCH
3477.0	3659.1	WASATCH FM
5962.0	6316.0	WASATCH G
8303.0	8789.9	WILLIAMS FORK
8343.0	8829.9	TOG
12029.0	12516.0	CAMEO
12315.0	12802.0	ROLLINS
12483.0	12970.0	COZZETTE
12677.0	13164.0	CORCORAN
13015.0	13502.0	UPPER SEGO
13165.0	13652.0	SEGO BASE TARGET

Plan #1
8504D-24 L24 496
125XXX; SC

KB @ 8208.0ft (Original Well Elev)
North American Datum 1983
Well 8504D-24 L24 496, True North

Type	Target	Azimuth	Origin	Type	N/S	E/W	From
TD	No Target (Freehand)	353.64	Slot		0.0	0.0	TVD
Name		TVD					
8504D-24 L24 496 TGT		8343.0		+N/-S			Latitude
8504D-24 L24 496 PBHL		13165.0		+E/-W			Longitude
					39° 41' 34.01 N	108° 7' 26.49 W	
					39° 41' 33.91 N	108° 7' 26.71 W	

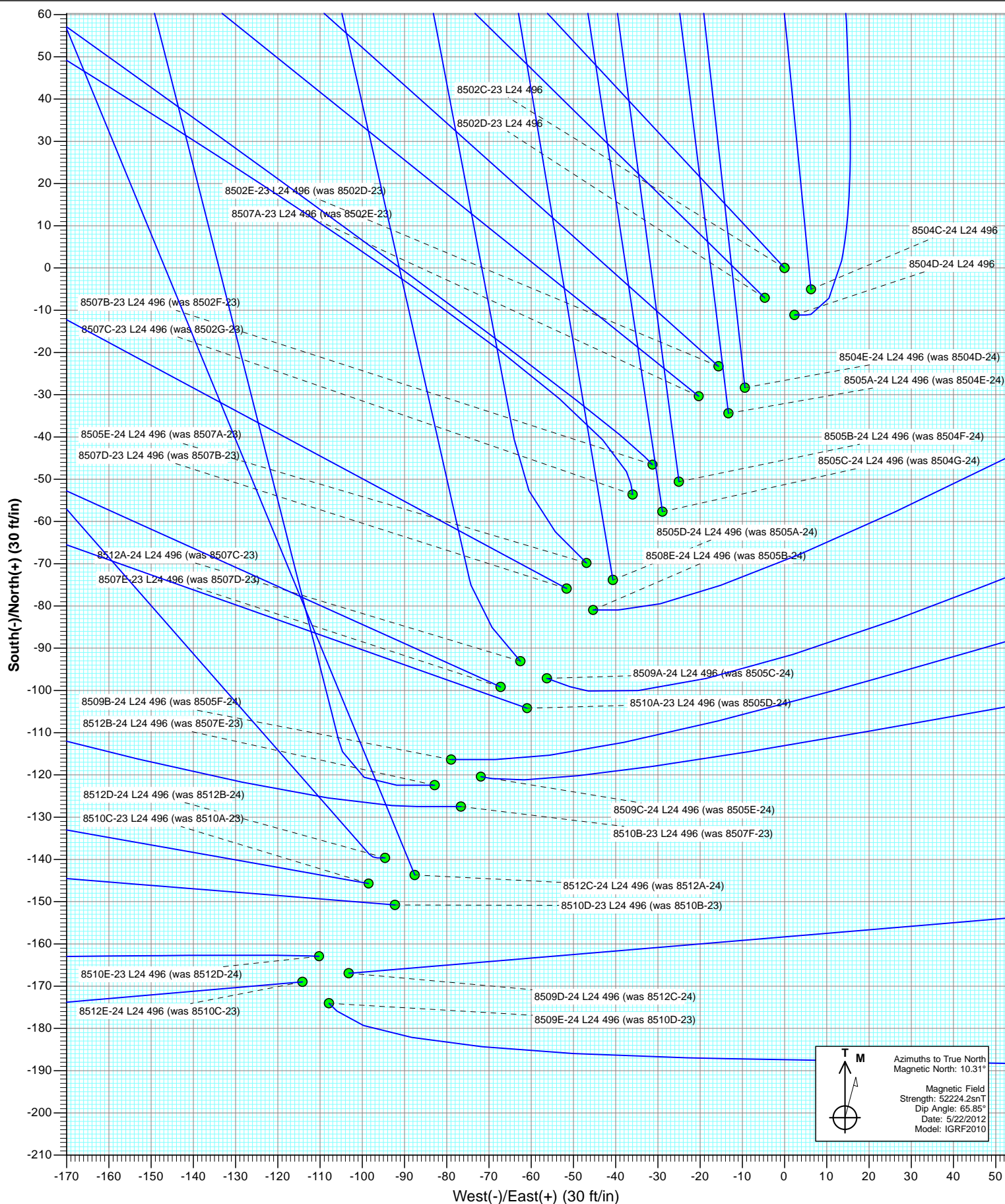

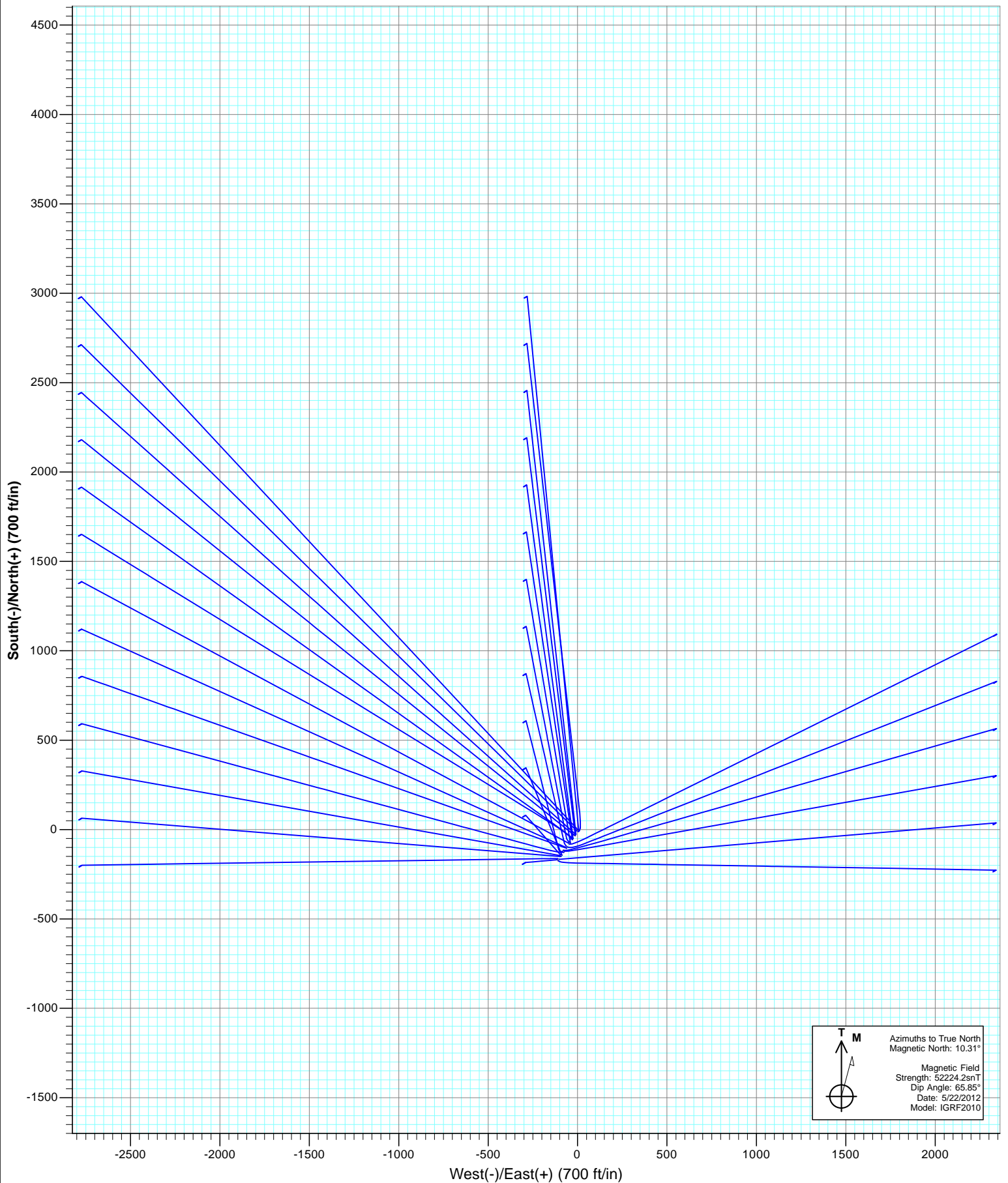

Cathedral Energy Services

Planning Report

Database:	USA EDM 5000 Multi Users DB	Local Co-ordinate Reference:	Well 8504D-24 L24 496
Company:	EnCana Oil & Gas (USA) Inc	TVD Reference:	KB @ 8208.0ft (Original Well Elev)
Project:	Story Gulch	MD Reference:	KB @ 8208.0ft (Original Well Elev)
Site:	L24 496	North Reference:	True
Well:	8504D-24 L24 496	Survey Calculation Method:	Minimum Curvature
Wellbore:	DD		
Design:	Plan #1		

Project	Story Gulch		
Map System:	US State Plane 1983	System Datum:	Mean Sea Level
Geo Datum:	North American Datum 1983		
Map Zone:	Colorado Central Zone		

Site	L24 496			
Site Position:		Northing:	1,685,024.52 ft	Latitude: 39° 41' 5.72 N
From:	Lat/Long	Easting:	2,261,789.15 ft	Longitude: 108° 7' 23.99 W
Position Uncertainty:	0.0 ft	Slot Radius:	13.200 in	Grid Convergence: -1.65 °

Well	8504D-24 L24 496			
Well Position	+N/-S	0.0 ft	Northing:	1,685,154.40 ft
	+E/-W	0.0 ft	Easting:	2,261,882.85 ft
Position Uncertainty		0.0 ft	Wellhead Elevation:	ft
			Ground Level:	8,193.0 ft

Wellbore	DD				
Magnetics	Model Name	Sample Date	Declination (°)	Dip Angle (°)	Field Strength (nT)
	IGRF2010	5/22/2012	10.31	65.85	52,224

Design	Plan #1			
Audit Notes:				
Version:	Phase:	PLAN	Tie On Depth:	0.0
Vertical Section:	Depth From (TVD) (ft)	+N/-S (ft)	+E/-W (ft)	Direction (°)
	0.0	0.0	0.0	353.64

Plan Sections										
Measured Depth (ft)	Inclination (°)	Azimuth (°)	Vertical Depth (ft)	+N/-S (ft)	+E/-W (ft)	Dogleg Rate (°/100ft)	Build Rate (°/100ft)	Turn Rate (°/100ft)	TFO (°)	Target
0.0	0.00	0.00	0.0	0.0	0.0	0.00	0.00	0.00	0.00	
275.0	0.00	0.00	275.0	0.0	0.0	0.00	0.00	0.00	0.00	
375.0	3.00	90.00	375.0	0.0	2.6	3.00	3.00	0.00	90.00	
1,083.6	20.72	353.59	1,068.1	126.0	7.2	3.00	2.50	-13.61	-104.12	
8,139.2	20.72	353.59	7,667.2	2,607.0	-271.7	0.00	0.00	0.00	0.00	
8,829.9	0.00	0.00	8,343.0	2,729.8	-285.5	3.00	-3.00	0.00	180.00	8504D-24 L24 496 TC
8,924.6	0.24	239.68	8,437.6	2,729.7	-285.7	0.25	0.25	-127.15	239.68	
13,652.0	0.24	239.68	13,165.0	2,719.9	-302.5	0.00	0.00	0.00	0.00	8504D-24 L24 496 PE
13,802.0	0.24	239.68	13,315.0	2,719.5	-303.1	0.00	0.00	0.00	0.00	

Cathedral Energy Services

Planning Report

Database:	USA EDM 5000 Multi Users DB	Local Co-ordinate Reference:	Well 8504D-24 L24 496
Company:	EnCana Oil & Gas (USA) Inc	TVD Reference:	KB @ 8208.0ft (Original Well Elev)
Project:	Story Gulch	MD Reference:	KB @ 8208.0ft (Original Well Elev)
Site:	L24 496	North Reference:	True
Well:	8504D-24 L24 496	Survey Calculation Method:	Minimum Curvature
Wellbore:	DD		
Design:	Plan #1		

Planned Survey

Measured Depth (ft)	Inclination (°)	Azimuth (°)	Vertical Depth (ft)	+N/-S (ft)	+E/-W (ft)	Vertical Section (ft)	Dogleg Rate (°/100ft)	Build Rate (°/100ft)	Comments / Formations
0.0	0.00	0.00	0.0	0.0	0.0	0.0	0.00	0.00	
100.0	0.00	0.00	100.0	0.0	0.0	0.0	0.00	0.00	
200.0	0.00	0.00	200.0	0.0	0.0	0.0	0.00	0.00	
275.0	0.00	0.00	275.0	0.0	0.0	0.0	0.00	0.00	KOP @ 275'
300.0	0.75	90.00	300.0	0.0	0.2	0.0	3.00	3.00	
375.0	3.00	90.00	375.0	0.0	2.6	-0.3	3.00	3.00	
400.0	2.91	75.52	399.9	0.2	3.9	-0.3	3.00	-0.36	
500.0	4.19	29.78	499.7	4.0	8.2	3.0	3.00	1.28	
600.0	6.68	11.58	599.3	12.8	11.1	11.5	3.00	2.49	
700.0	9.47	3.60	698.3	26.8	12.8	25.2	3.00	2.79	
800.0	12.36	359.28	796.5	45.7	13.2	43.9	3.00	2.89	
900.0	15.29	356.58	893.6	69.5	12.3	67.8	3.00	2.93	
1,000.0	18.24	354.74	989.3	98.3	10.1	96.6	3.00	2.95	
1,083.6	20.72	353.59	1,068.1	126.0	7.2	124.5	3.00	2.96	EOB @ Inc. = 20.72°
1,100.0	20.72	353.59	1,083.5	131.8	6.6	130.3	0.01	0.01	
1,200.0	20.72	353.59	1,177.0	167.0	2.6	165.6	0.00	0.00	
1,300.0	20.72	353.59	1,270.5	202.1	-1.3	201.0	0.00	0.00	
1,400.0	20.72	353.59	1,364.0	237.3	-5.3	236.4	0.00	0.00	
1,401.0	20.72	353.59	1,365.0	237.6	-5.3	236.8	0.00	0.00	A GROOVE
1,500.0	20.72	353.59	1,457.6	272.4	-9.3	271.8	0.00	0.00	
1,577.4	20.72	353.59	1,530.0	299.7	-12.3	299.2	0.00	0.00	B GROOVE
1,600.0	20.72	353.59	1,551.1	307.6	-13.2	307.2	0.00	0.00	
1,609.5	20.72	353.59	1,560.0	311.0	-13.6	310.5	0.00	0.00	B GROOVE BASE
1,700.0	20.72	353.59	1,644.6	342.8	-17.2	342.6	0.00	0.00	
1,800.0	20.72	353.59	1,738.2	377.9	-21.1	378.0	0.00	0.00	
1,900.0	20.72	353.59	1,831.7	413.1	-25.1	413.3	0.00	0.00	
2,000.0	20.72	353.59	1,925.2	448.3	-29.0	448.7	0.00	0.00	
2,100.0	20.72	353.59	2,018.8	483.4	-33.0	484.1	0.00	0.00	
2,200.0	20.72	353.59	2,112.3	518.6	-36.9	519.5	0.00	0.00	
2,300.0	20.72	353.59	2,205.8	553.8	-40.9	554.9	0.00	0.00	
2,400.0	20.72	353.59	2,299.3	588.9	-44.8	590.3	0.00	0.00	
2,500.0	20.72	353.59	2,392.9	624.1	-48.8	625.6	0.00	0.00	
2,600.0	20.72	353.59	2,486.4	659.2	-52.7	661.0	0.00	0.00	
2,663.7	20.72	353.59	2,546.0	681.7	-55.3	683.6	0.00	0.00	GARDEN GULCH
2,700.0	20.72	353.59	2,579.9	694.4	-56.7	696.4	0.00	0.00	
2,800.0	20.72	353.59	2,673.5	729.6	-60.6	731.8	0.00	0.00	
2,900.0	20.72	353.59	2,767.0	764.7	-64.6	767.2	0.00	0.00	
3,000.0	20.72	353.59	2,860.5	799.9	-68.5	802.6	0.00	0.00	
3,100.0	20.72	353.59	2,954.1	835.1	-72.5	838.0	0.00	0.00	
3,200.0	20.72	353.59	3,047.6	870.2	-76.5	873.3	0.00	0.00	
3,300.0	20.72	353.59	3,141.1	905.4	-80.4	908.7	0.00	0.00	
3,400.0	20.72	353.59	3,234.7	940.6	-84.4	944.1	0.00	0.00	
3,500.0	20.72	353.59	3,328.2	975.7	-88.3	979.5	0.00	0.00	
3,600.0	20.72	353.59	3,421.7	1,010.9	-92.3	1,014.9	0.00	0.00	
3,659.1	20.72	353.59	3,477.0	1,031.7	-94.6	1,035.8	0.00	0.00	WASATCH FM
3,700.0	20.72	353.59	3,515.2	1,046.0	-96.2	1,050.3	0.00	0.00	
3,800.0	20.72	353.59	3,608.8	1,081.2	-100.2	1,085.7	0.00	0.00	
3,900.0	20.72	353.59	3,702.3	1,116.4	-104.1	1,121.0	0.00	0.00	
4,000.0	20.72	353.59	3,795.8	1,151.5	-108.1	1,156.4	0.00	0.00	
4,100.0	20.72	353.59	3,889.4	1,186.7	-112.0	1,191.8	0.00	0.00	
4,200.0	20.72	353.59	3,982.9	1,221.9	-116.0	1,227.2	0.00	0.00	
4,300.0	20.72	353.59	4,076.4	1,257.0	-119.9	1,262.6	0.00	0.00	

Cathedral Energy Services

Planning Report

Database:	USA EDM 5000 Multi Users DB	Local Co-ordinate Reference:	Well 8504D-24 L24 496
Company:	EnCana Oil & Gas (USA) Inc	TVD Reference:	KB @ 8208.0ft (Original Well Elev)
Project:	Story Gulch	MD Reference:	KB @ 8208.0ft (Original Well Elev)
Site:	L24 496	North Reference:	True
Well:	8504D-24 L24 496	Survey Calculation Method:	Minimum Curvature
Wellbore:	DD		
Design:	Plan #1		

Planned Survey									
Measured Depth (ft)	Inclination (°)	Azimuth (°)	Vertical Depth (ft)	+N/-S (ft)	+E/-W (ft)	Vertical Section (ft)	Dogleg Rate (°/100ft)	Build Rate (°/100ft)	Comments / Formations
4,400.0	20.72	353.59	4,170.0	1,292.2	-123.9	1,298.0	0.00	0.00	
4,500.0	20.72	353.59	4,263.5	1,327.4	-127.8	1,333.3	0.00	0.00	
4,600.0	20.72	353.59	4,357.0	1,362.5	-131.8	1,368.7	0.00	0.00	
4,700.0	20.72	353.59	4,450.5	1,397.7	-135.7	1,404.1	0.00	0.00	
4,800.0	20.72	353.59	4,544.1	1,432.8	-139.7	1,439.5	0.00	0.00	
4,900.0	20.72	353.59	4,637.6	1,468.0	-143.7	1,474.9	0.00	0.00	
5,000.0	20.72	353.59	4,731.1	1,503.2	-147.6	1,510.3	0.00	0.00	
5,100.0	20.72	353.59	4,824.7	1,538.3	-151.6	1,545.7	0.00	0.00	
5,200.0	20.72	353.59	4,918.2	1,573.5	-155.5	1,581.0	0.00	0.00	
5,300.0	20.72	353.59	5,011.7	1,608.7	-159.5	1,616.4	0.00	0.00	
5,400.0	20.72	353.59	5,105.3	1,643.8	-163.4	1,651.8	0.00	0.00	
5,500.0	20.72	353.59	5,198.8	1,679.0	-167.4	1,687.2	0.00	0.00	
5,600.0	20.72	353.59	5,292.3	1,714.2	-171.3	1,722.6	0.00	0.00	
5,700.0	20.72	353.59	5,385.8	1,749.3	-175.3	1,758.0	0.00	0.00	
5,800.0	20.72	353.59	5,479.4	1,784.5	-179.2	1,793.4	0.00	0.00	
5,900.0	20.72	353.59	5,572.9	1,819.6	-183.2	1,828.7	0.00	0.00	
6,000.0	20.72	353.59	5,666.4	1,854.8	-187.1	1,864.1	0.00	0.00	
6,100.0	20.72	353.59	5,760.0	1,890.0	-191.1	1,899.5	0.00	0.00	
6,200.0	20.72	353.59	5,853.5	1,925.1	-195.0	1,934.9	0.00	0.00	
6,300.0	20.72	353.59	5,947.0	1,960.3	-199.0	1,970.3	0.00	0.00	
6,316.0	20.72	353.59	5,962.0	1,965.9	-199.6	1,975.9	0.00	0.00	WASATCH G
6,400.0	20.72	353.59	6,040.6	1,995.5	-202.9	2,005.7	0.00	0.00	
6,500.0	20.72	353.59	6,134.1	2,030.6	-206.9	2,041.0	0.00	0.00	
6,600.0	20.72	353.59	6,227.6	2,065.8	-210.9	2,076.4	0.00	0.00	
6,700.0	20.72	353.59	6,321.1	2,101.0	-214.8	2,111.8	0.00	0.00	
6,800.0	20.72	353.59	6,414.7	2,136.1	-218.8	2,147.2	0.00	0.00	
6,900.0	20.72	353.59	6,508.2	2,171.3	-222.7	2,182.6	0.00	0.00	
7,000.0	20.72	353.59	6,601.7	2,206.4	-226.7	2,218.0	0.00	0.00	
7,100.0	20.72	353.59	6,695.3	2,241.6	-230.6	2,253.4	0.00	0.00	
7,200.0	20.72	353.59	6,788.8	2,276.8	-234.6	2,288.7	0.00	0.00	
7,300.0	20.72	353.59	6,882.3	2,311.9	-238.5	2,324.1	0.00	0.00	
7,400.0	20.72	353.59	6,975.9	2,347.1	-242.5	2,359.5	0.00	0.00	
7,500.0	20.72	353.59	7,069.4	2,382.3	-246.4	2,394.9	0.00	0.00	
7,600.0	20.72	353.59	7,162.9	2,417.4	-250.4	2,430.3	0.00	0.00	
7,700.0	20.72	353.59	7,256.5	2,452.6	-254.3	2,465.7	0.00	0.00	
7,800.0	20.72	353.59	7,350.0	2,487.8	-258.3	2,501.1	0.00	0.00	
7,900.0	20.72	353.59	7,443.5	2,522.9	-262.2	2,536.4	0.00	0.00	
8,000.0	20.72	353.59	7,537.0	2,558.1	-266.2	2,571.8	0.00	0.00	
8,100.0	20.72	353.59	7,630.6	2,593.2	-270.1	2,607.2	0.00	0.00	
8,139.2	20.72	353.59	7,667.2	2,607.0	-271.7	2,621.1	0.00	0.00	Strt 3° Drop
8,200.0	18.90	353.59	7,724.4	2,627.5	-274.0	2,641.7	3.00	-3.00	
8,300.0	15.90	353.59	7,819.8	2,657.2	-277.3	2,671.6	3.00	-3.00	
8,400.0	12.90	353.59	7,916.7	2,681.9	-280.1	2,696.4	3.00	-3.00	
8,500.0	9.90	353.59	8,014.7	2,701.6	-282.3	2,716.2	3.00	-3.00	
8,600.0	6.90	353.59	8,113.6	2,716.1	-284.0	2,730.8	3.00	-3.00	
8,700.0	3.90	353.59	8,213.2	2,725.4	-285.0	2,740.2	3.00	-3.00	
8,789.9	1.20	353.59	8,303.0	2,729.4	-285.5	2,744.2	3.00	-3.00	WILLIAMS FORK
8,800.0	0.90	353.59	8,313.1	2,729.6	-285.5	2,744.4	3.00	-3.00	
8,829.9	0.00	0.00	8,343.0	2,729.8	-285.5	2,744.6	3.00	-3.00	EOD @ Inc. = 0° - TOG
8,900.0	0.18	239.68	8,413.1	2,729.8	-285.6	2,744.6	0.25	0.25	
8,924.6	0.24	239.68	8,437.6	2,729.7	-285.7	2,744.6	0.25	0.25	
9,000.0	0.24	239.68	8,513.1	2,729.5	-285.9	2,744.4	0.00	0.00	

Cathedral Energy Services

Planning Report

Database:	USA EDM 5000 Multi Users DB	Local Co-ordinate Reference:	Well 8504D-24 L24 496
Company:	EnCana Oil & Gas (USA) Inc	TVD Reference:	KB @ 8208.0ft (Original Well Elev)
Project:	Story Gulch	MD Reference:	KB @ 8208.0ft (Original Well Elev)
Site:	L24 496	North Reference:	True
Well:	8504D-24 L24 496	Survey Calculation Method:	Minimum Curvature
Wellbore:	DD		
Design:	Plan #1		

Planned Survey									
Measured Depth (ft)	Inclination (°)	Azimuth (°)	Vertical Depth (ft)	+N/-S (ft)	+E/-W (ft)	Vertical Section (ft)	Dogleg Rate (°/100ft)	Build Rate (°/100ft)	Comments / Formations
9,100.0	0.24	239.68	8,613.1	2,729.3	-286.3	2,744.3	0.00	0.00	
9,200.0	0.24	239.68	8,713.1	2,729.1	-286.7	2,744.1	0.00	0.00	
9,300.0	0.24	239.68	8,813.1	2,728.9	-287.0	2,743.9	0.00	0.00	
9,400.0	0.24	239.68	8,913.1	2,728.7	-287.4	2,743.8	0.00	0.00	
9,500.0	0.24	239.68	9,013.1	2,728.5	-287.7	2,743.6	0.00	0.00	
9,600.0	0.24	239.68	9,113.1	2,728.3	-288.1	2,743.4	0.00	0.00	
9,700.0	0.24	239.68	9,213.1	2,728.1	-288.4	2,743.3	0.00	0.00	
9,800.0	0.24	239.68	9,313.1	2,727.9	-288.8	2,743.1	0.00	0.00	
9,900.0	0.24	239.68	9,413.1	2,727.7	-289.1	2,742.9	0.00	0.00	
10,000.0	0.24	239.68	9,513.1	2,727.5	-289.5	2,742.7	0.00	0.00	
10,100.0	0.24	239.68	9,613.1	2,727.3	-289.9	2,742.6	0.00	0.00	
10,200.0	0.24	239.68	9,713.1	2,727.0	-290.2	2,742.4	0.00	0.00	
10,300.0	0.24	239.68	9,813.1	2,726.8	-290.6	2,742.2	0.00	0.00	
10,400.0	0.24	239.68	9,913.1	2,726.6	-290.9	2,742.1	0.00	0.00	
10,500.0	0.24	239.68	10,013.1	2,726.4	-291.3	2,741.9	0.00	0.00	
10,600.0	0.24	239.68	10,113.1	2,726.2	-291.6	2,741.7	0.00	0.00	
10,700.0	0.24	239.68	10,213.1	2,726.0	-292.0	2,741.6	0.00	0.00	
10,800.0	0.24	239.68	10,313.1	2,725.8	-292.4	2,741.4	0.00	0.00	
10,900.0	0.24	239.68	10,413.1	2,725.6	-292.7	2,741.2	0.00	0.00	
11,000.0	0.24	239.68	10,513.1	2,725.4	-293.1	2,741.1	0.00	0.00	
11,100.0	0.24	239.68	10,613.1	2,725.2	-293.4	2,740.9	0.00	0.00	
11,200.0	0.24	239.68	10,713.1	2,725.0	-293.8	2,740.7	0.00	0.00	
11,300.0	0.24	239.68	10,813.1	2,724.8	-294.1	2,740.6	0.00	0.00	
11,400.0	0.24	239.68	10,913.1	2,724.5	-294.5	2,740.4	0.00	0.00	
11,500.0	0.24	239.68	11,013.1	2,724.3	-294.8	2,740.2	0.00	0.00	
11,600.0	0.24	239.68	11,113.1	2,724.1	-295.2	2,740.1	0.00	0.00	
11,700.0	0.24	239.68	11,213.1	2,723.9	-295.6	2,739.9	0.00	0.00	
11,800.0	0.24	239.68	11,313.1	2,723.7	-295.9	2,739.7	0.00	0.00	
11,900.0	0.24	239.68	11,413.0	2,723.5	-296.3	2,739.6	0.00	0.00	
12,000.0	0.24	239.68	11,513.0	2,723.3	-296.6	2,739.4	0.00	0.00	
12,100.0	0.24	239.68	11,613.0	2,723.1	-297.0	2,739.2	0.00	0.00	
12,200.0	0.24	239.68	11,713.0	2,722.9	-297.3	2,739.1	0.00	0.00	
12,300.0	0.24	239.68	11,813.0	2,722.7	-297.7	2,738.9	0.00	0.00	
12,400.0	0.24	239.68	11,913.0	2,722.5	-298.1	2,738.7	0.00	0.00	
12,500.0	0.24	239.68	12,013.0	2,722.3	-298.4	2,738.6	0.00	0.00	
12,516.0	0.24	239.68	12,029.0	2,722.2	-298.5	2,738.5	0.00	0.00	CAMEO
12,600.0	0.24	239.68	12,113.0	2,722.0	-298.8	2,738.4	0.00	0.00	
12,700.0	0.24	239.68	12,213.0	2,721.8	-299.1	2,738.2	0.00	0.00	
12,800.0	0.24	239.68	12,313.0	2,721.6	-299.5	2,738.1	0.00	0.00	
12,802.0	0.24	239.68	12,315.0	2,721.6	-299.5	2,738.0	0.00	0.00	ROLLINS
12,900.0	0.24	239.68	12,413.0	2,721.4	-299.8	2,737.9	0.00	0.00	
12,970.0	0.24	239.68	12,483.0	2,721.3	-300.1	2,737.8	0.00	0.00	COZZETTE
13,000.0	0.24	239.68	12,513.0	2,721.2	-300.2	2,737.7	0.00	0.00	
13,100.0	0.24	239.68	12,613.0	2,721.0	-300.6	2,737.5	0.00	0.00	
13,164.0	0.24	239.68	12,677.0	2,720.9	-300.8	2,737.4	0.00	0.00	CORCORAN
13,200.0	0.24	239.68	12,713.0	2,720.8	-300.9	2,737.4	0.00	0.00	
13,300.0	0.24	239.68	12,813.0	2,720.6	-301.3	2,737.2	0.00	0.00	
13,400.0	0.24	239.68	12,913.0	2,720.4	-301.6	2,737.0	0.00	0.00	
13,500.0	0.24	239.68	13,013.0	2,720.2	-302.0	2,736.9	0.00	0.00	
13,502.0	0.24	239.68	13,015.0	2,720.2	-302.0	2,736.9	0.00	0.00	UPPER SEGO
13,600.0	0.24	239.68	13,113.0	2,720.0	-302.3	2,736.7	0.00	0.00	
13,652.0	0.24	239.68	13,165.0	2,719.9	-302.5	2,736.6	0.00	0.00	TD @ 13,652' MD - SEGO BASE TARGET

Cathedral Energy Services

Planning Report

Database:	USA EDM 5000 Multi Users DB	Local Co-ordinate Reference:	Well 8504D-24 L24 496
Company:	EnCana Oil & Gas (USA) Inc	TVD Reference:	KB @ 8208.0ft (Original Well Elev)
Project:	Story Gulch	MD Reference:	KB @ 8208.0ft (Original Well Elev)
Site:	L24 496	North Reference:	True
Well:	8504D-24 L24 496	Survey Calculation Method:	Minimum Curvature
Wellbore:	DD		
Design:	Plan #1		

Planned Survey

Measured Depth (ft)	Inclination (°)	Azimuth (°)	Vertical Depth (ft)	+N/-S (ft)	+E/-W (ft)	Vertical Section (ft)	Dogleg Rate (°/100ft)	Build Rate (°/100ft)	Comments / Formations
13,700.0	0.24	239.68	13,213.0	2,719.7	-302.7	2,736.5	0.00	0.00	
13,802.0	0.24	239.68	13,315.0	2,719.5	-303.1	2,736.4	0.00	0.00	Permit TD @ 13,802' MD

Targets

Target Name - hit/miss target - Shape	Dip Angle (°)	Dip Dir. (°)	TVD (ft)	+N/-S (ft)	+E/-W (ft)	Northing (ft)	Easting (ft)	Latitude	Longitude
8504D-24 L24 496 TGT - plan hits target center - Point	0.00	0.00	8,343.0	2,729.8	-285.5	1,687,891.31	2,261,676.27	39° 41' 34.01 N	108° 7' 26.49 W
8504D-24 L24 496 PBHI - plan hits target center - Rectangle (sides W30.0 H50.0 D0.0)	0.00	0.00	13,165.0	2,719.9	-302.5	1,687,881.85	2,261,658.97	39° 41' 33.91 N	108° 7' 26.71 W

Formations

Measured Depth (ft)	Vertical Depth (ft)	Name	Lithology	Dip (°)	Dip Direction (°)
1,401.0	1,365.0	A GROOVE			
1,577.4	1,530.0	B GROOVE			
1,609.5	1,560.0	B GROOVE BASE			
2,663.7	2,546.0	GARDEN GULCH			
3,659.1	3,477.0	WASATCH FM			
6,316.0	5,962.0	WASATCH G			
8,789.9	8,303.0	WILLIAMS FORK			
8,829.9	8,343.0	TOG			
12,516.0	12,029.0	CAMEO			
12,802.0	12,315.0	ROLLINS			
12,970.0	12,483.0	COZZETTE			
13,164.0	12,677.0	CORCORAN			
13,502.0	13,015.0	UPPER SEGO			
13,652.0	13,165.0	SEGO BASE TARGET			

Plan Annotations

Measured Depth (ft)	Vertical Depth (ft)	Local Coordinates		Comment
		+N/-S (ft)	+E/-W (ft)	
275.0	275.0	0.0	0.0	KOP @ 275'
1,083.6	1,068.1	126.0	7.2	EOB @ Inc. = 20.72°
8,139.2	7,667.2	2,607.0	-271.7	Strt 3° Drop
8,829.9	8,343.0	2,729.8	-285.5	EOD @ Inc. = 0°
13,652.0	13,165.0	2,719.9	-302.5	TD @ 13,652' MD
13,802.0	13,315.0	2,719.5	-303.1	Permit TD @ 13,802' MD