

# BONANZA CREEK ENERGY OPERATING

## Well Name: PARK T-P-4HZ

Surface Location: PARK T-P-4HZ PAD SEC.4- T4N-R63W  
North American Datum 1983 , US State Plane 1983Colorado Northern Zone

Ground Elevation: 4625.0

+N/-S	+E/-W	Northing	Easting	Latitude	Longitude	Slot
0.0	0.0	1366453.21	3296012.31	40.334450	-104.438160	

ENSIGN RIG 128 KB 15' RKB @ 4640.0ft (ENSIGN RIG 128 KB 15')

## FINAL SURVEY

Projected Bottom Hole Location  
11120' MD 6399' TVD 4701' N & 447' W of SHL

90.40 degree Incl @ 354.50 degree AZM

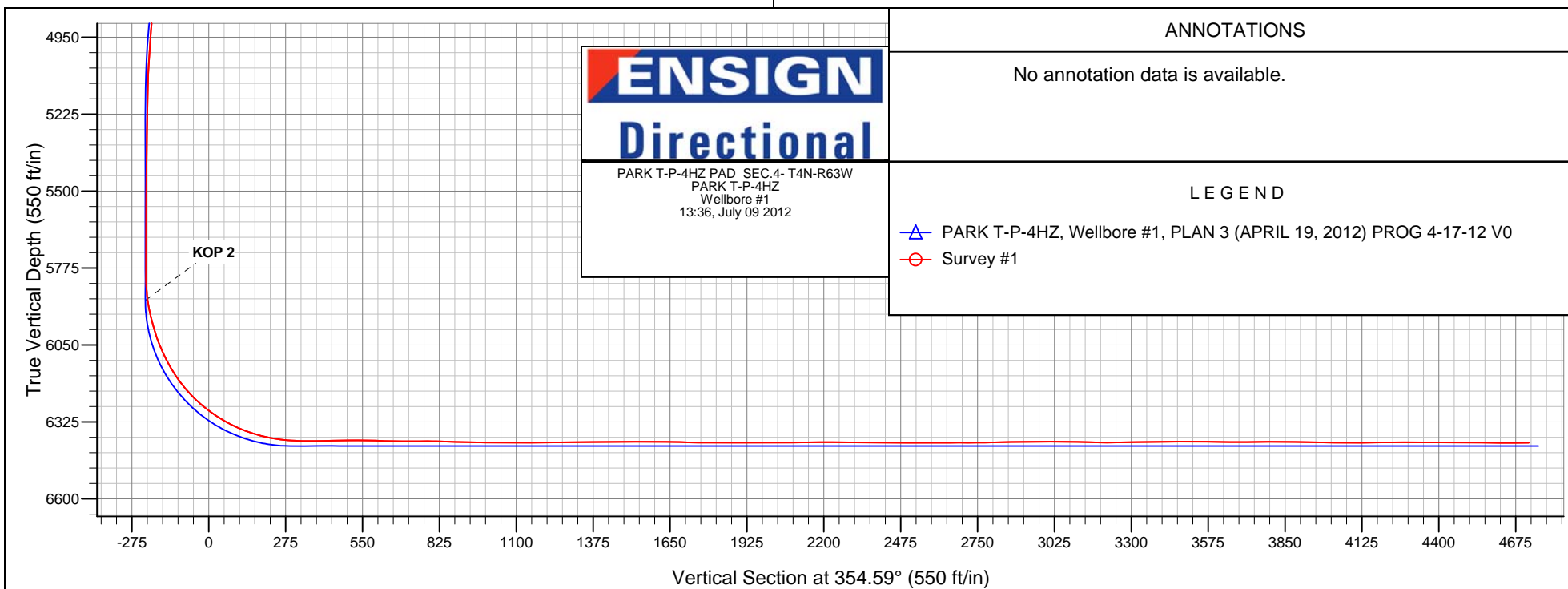
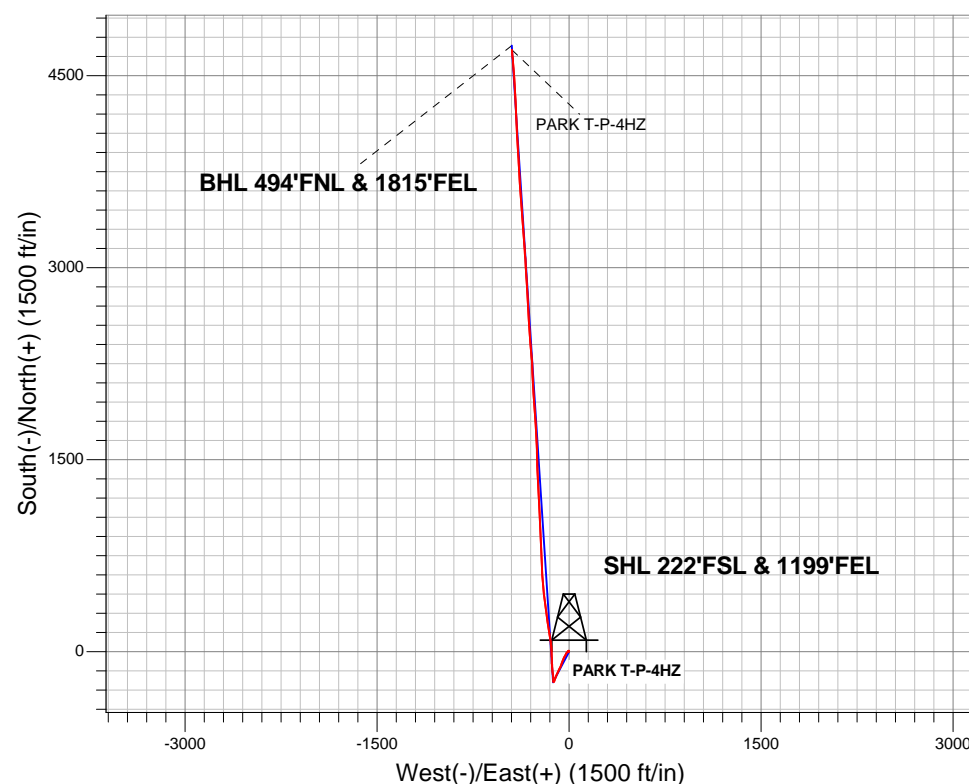



# **BONANZA CREEK ENERGY OPERATING**

**SEC.4-T4N-R63W**

**PARK T-P-4HZ PAD SEC.4- T4N-R63W**

**PARK T-P-4HZ**

**Wellbore #1**

**Survey: Survey #1**

## **Standard Survey Report**

**09 July, 2012**

<b>Company:</b>	BONANZA CREEK ENERGY OPERATING	<b>Local Co-ordinate Reference:</b>	Well PARK T-P-4HZ
<b>Project:</b>	SEC.4-T4N-R63W	<b>TVD Reference:</b>	RKB @ 4640.0ft (ENSIGN RIG 128 KB 15')
<b>Site:</b>	PARK T-P-4HZ PAD SEC.4- T4N-R63W	<b>MD Reference:</b>	RKB @ 4640.0ft (ENSIGN RIG 128 KB 15')
<b>Well:</b>	PARK T-P-4HZ	<b>North Reference:</b>	True
<b>Wellbore:</b>	Wellbore #1	<b>Survey Calculation Method:</b>	Minimum Curvature
<b>Design:</b>	Wellbore #1	<b>Database:</b>	Landmark

<b>Project</b>	SEC.4-T4N-R63W, Weld County, Colorado		
<b>Map System:</b>	US State Plane 1983	<b>System Datum:</b>	Mean Sea Level
<b>Geo Datum:</b>	North American Datum 1983		Using Well Reference Point
<b>Map Zone:</b>	Colorado Northern Zone		Using geodetic scale factor

Site		PARK T-P-4HZ PAD SEC.4- T4N-R63W			
Position:		Northing:	1,366,451.03ft	Latitude:	40.334444
From:	Lat/Long	Easting:	3,296,011.50ft	Longitude:	-104.438163
Position Uncertainty:	0.0 ft	Slot Radius:	"	Grid Convergence:	0.69 °

Well	PARK T-P-4HZ					
Well Position	+N/-S	0.0 ft	Northing:	1,366,453.21 ft	Latitude:	40.334450
	+E/-W	0.0 ft	Easting:	3,296,012.31 ft	Longitude:	-104.438160
Position Uncertainty		0.0 ft	Wellhead Elevation:	ft	Ground Level:	4,625.0 ft

Wellbore	Wellbore #1				
Magnetics	Model Name	Sample Date	Declination (°)	Dip Angle (°)	Field Strength (nT)
	IGRF2010	3/7/2012	8.58	67.03	53,057

Design	Wellbore #1			
Audit Notes:				
Version:	1.0	Phase:	ACTUAL	Tie On Depth: 0.0
Vertical Section:	Depth From (TVD) (ft)	+N/-S (ft)	+E/-W (ft)	Direction (°)
	0.0	0.0	0.0	354.59

Survey Program		Date	7/9/2012		
From (ft)	To (ft)	Survey (Wellbore)	Tool Name	Description	
760.0	11,120.0	Survey #1 (Wellbore #1)	MWD	MWD - Standard	

Survey										
Measured Depth (ft)	Inclination (°)	Azimuth (°)	Vertical Depth (ft)	+N/-S (ft)	+E/-W (ft)	Vertical Section (ft)	Dogleg Rate (°/100ft)	Build Rate (°/100ft)	Turn Rate (°/100ft)	
0.0	0.00	0.00	0.0	0.0	0.0	0.0	0.00	0.00	0.00	
1.0	0.00	300.70	1.0	0.0	0.0	0.0	0.00	0.00	0.00	
HARDLINE 460'FSL										
10.8	0.01	300.70	10.8	0.0	0.0	0.0	0.06	0.06	0.00	
HARDLINE 460'FNL										
760.0	0.40	300.70	760.0	1.4	-2.3	1.6	0.05	0.05	0.00	
1,010.0	0.50	269.90	1,010.0	1.8	-4.1	2.2	0.10	0.04	-12.32	
1,226.0	0.30	263.10	1,226.0	1.7	-5.6	2.3	0.10	-0.09	-3.15	
1,360.0	0.30	88.60	1,360.0	1.7	-5.6	2.2	0.45	0.00	-130.22	
1,594.0	0.60	74.70	1,594.0	2.0	-3.8	2.4	0.14	0.13	-5.94	
1,777.0	0.30	318.10	1,777.0	2.6	-3.2	2.9	0.43	-0.16	-63.72	
1,962.0	0.20	270.80	1,962.0	3.0	-3.9	3.4	0.12	-0.05	-25.57	
2,146.0	0.10	342.80	2,146.0	3.2	-4.2	3.6	0.11	-0.05	39.13	

<b>Company:</b>	BONANZA CREEK ENERGY OPERATING	<b>Local Co-ordinate Reference:</b>	Well PARK T-P-4HZ
<b>Project:</b>	SEC.4-T4N-R63W	<b>TVD Reference:</b>	RKB @ 4640.0ft (ENSIGN RIG 128 KB 15')
<b>Site:</b>	PARK T-P-4HZ PAD SEC.4- T4N-R63W	<b>MD Reference:</b>	RKB @ 4640.0ft (ENSIGN RIG 128 KB 15')
<b>Well:</b>	PARK T-P-4HZ	<b>North Reference:</b>	True
<b>Wellbore:</b>	Wellbore #1	<b>Survey Calculation Method:</b>	Minimum Curvature
<b>Design:</b>	Wellbore #1	<b>Database:</b>	Landmark

### Survey

Measured Depth (ft)	Inclination (°)	Azimuth (°)	Vertical Depth (ft)	+N/-S (ft)	+E/-W (ft)	Vertical Section (ft)	Dogleg Rate (°/100ft)	Build Rate (°/100ft)	Turn Rate (°/100ft)
2,330.0	0.60	342.10	2,330.0	4.2	-4.6	4.6	0.27	0.27	-0.38
2,513.0	0.30	20.40	2,513.0	5.6	-4.7	6.0	0.22	-0.16	20.93
2,698.0	0.30	320.90	2,698.0	6.4	-4.8	6.9	0.16	0.00	-32.16
2,823.0	0.20	306.70	2,823.0	6.8	-5.2	7.3	0.09	-0.08	-11.36
2,948.0	1.40	197.50	2,947.9	5.5	-5.9	6.0	1.18	0.96	-87.36
3,074.0	2.90	228.00	3,073.9	1.9	-8.7	2.7	1.46	1.19	24.21
3,198.0	3.60	225.60	3,197.7	-2.9	-13.8	-1.6	0.57	0.56	-1.94
3,323.0	6.70	216.60	3,322.1	-11.5	-21.0	-9.5	2.56	2.48	-7.20
3,447.0	8.20	204.60	3,445.1	-25.4	-29.0	-22.5	1.74	1.21	-9.68
3,572.0	9.10	207.10	3,568.7	-42.3	-37.2	-38.6	0.78	0.72	2.00
3,698.0	8.30	205.40	3,693.2	-59.4	-45.6	-54.8	0.67	-0.63	-1.35
3,822.0	8.40	199.60	3,815.9	-76.0	-52.5	-70.7	0.68	0.08	-4.68
3,947.0	8.30	199.20	3,939.6	-93.1	-58.5	-87.2	0.09	-0.08	-0.32
4,073.0	8.10	199.70	4,064.3	-110.1	-64.5	-103.5	0.17	-0.16	0.40
4,196.0	9.10	207.40	4,185.9	-126.9	-71.9	-119.5	1.24	0.81	6.26
4,321.0	7.90	209.10	4,309.5	-143.1	-80.6	-134.9	0.98	-0.96	1.36
4,446.0	8.40	204.70	4,433.3	-158.9	-88.6	-149.9	0.64	0.40	-3.52
4,570.0	7.60	199.50	4,556.1	-174.9	-95.1	-165.2	0.87	-0.65	-4.19
4,693.0	8.00	201.90	4,677.9	-190.5	-101.0	-180.1	0.42	0.33	1.95
4,818.0	7.40	203.20	4,801.8	-206.0	-107.5	-194.9	0.50	-0.48	1.04
4,941.0	4.90	201.10	4,924.1	-218.2	-112.5	-206.6	2.04	-2.03	-1.71
5,066.0	3.50	199.00	5,048.7	-226.8	-115.6	-214.8	1.13	-1.12	-1.68
5,191.0	1.20	195.00	5,173.6	-231.6	-117.2	-219.5	1.84	-1.84	-3.20
5,315.0	0.80	205.70	5,297.6	-233.7	-117.9	-221.5	0.35	-0.32	8.63
5,440.0	0.60	221.30	5,422.6	-234.9	-118.7	-222.7	0.22	-0.16	12.48
5,564.0	0.60	231.10	5,546.6	-235.8	-119.7	-223.5	0.08	0.00	7.90
5,762.0	0.40	256.80	5,744.6	-236.6	-121.2	-224.2	0.15	-0.10	12.98
5,790.0	0.40	248.30	5,772.6	-236.7	-121.3	-224.2	0.21	0.00	-30.36
5,821.0	0.50	288.60	5,803.6	-236.7	-121.6	-224.2	1.04	0.32	130.00
5,852.0	2.10	336.40	5,834.6	-236.1	-121.9	-223.6	5.81	5.16	154.19
5,883.0	5.30	345.40	5,865.5	-234.2	-122.5	-221.6	10.46	10.32	29.03
5,915.0	8.90	351.90	5,897.3	-230.3	-123.2	-217.7	11.51	11.25	20.31
5,946.0	12.00	355.00	5,927.7	-224.8	-123.9	-212.1	10.16	10.00	10.00
5,977.0	14.30	357.20	5,957.9	-217.7	-124.3	-205.0	7.59	7.42	7.10
6,008.0	16.20	358.40	5,987.8	-209.6	-124.6	-196.9	6.21	6.13	3.87
6,040.0	18.80	356.50	6,018.4	-200.0	-125.1	-187.3	8.32	8.13	-5.94
6,071.0	21.50	354.20	6,047.5	-189.3	-126.0	-176.6	9.08	8.71	-7.42
6,102.0	24.40	352.60	6,076.0	-177.3	-127.3	-164.5	9.57	9.35	-5.16
6,134.0	27.00	354.20	6,104.8	-163.5	-128.9	-150.7	8.41	8.13	5.00
6,165.0	30.60	354.70	6,132.0	-148.7	-130.4	-135.7	11.64	11.61	1.61
6,196.0	33.80	355.60	6,158.2	-132.2	-131.8	-119.2	10.44	10.32	2.90
6,228.0	37.20	355.20	6,184.3	-113.7	-133.3	-100.6	10.65	10.63	-1.25
6,259.0	40.50	357.30	6,208.4	-94.3	-134.5	-81.2	11.46	10.65	6.77
6,290.0	44.20	358.60	6,231.3	-73.4	-135.3	-60.4	12.26	11.94	4.19
6,321.0	47.90	358.90	6,252.8	-51.1	-135.7	-38.1	11.96	11.94	0.97
6,353.0	51.40	357.70	6,273.5	-26.8	-136.5	-13.8	11.30	10.94	-3.75
6,384.0	54.50	356.50	6,292.2	-2.0	-137.7	11.0	10.47	10.00	-3.87
6,415.0	57.90	356.30	6,309.5	23.7	-139.3	36.7	10.98	10.97	-0.65
6,446.0	60.90	354.90	6,325.2	50.3	-141.4	63.4	10.43	9.68	-4.52
6,477.0	64.40	353.10	6,339.5	77.6	-144.3	90.9	12.41	11.29	-5.81
6,509.0	68.10	351.70	6,352.4	106.7	-148.2	120.2	12.24	11.56	-4.38
6,540.0	71.50	350.70	6,363.1	135.4	-152.6	149.2	11.38	10.97	-3.23
6,571.0	74.70	350.80	6,372.1	164.7	-157.4	178.8	10.33	10.32	0.32
6,602.0	77.80	350.30	6,379.4	194.4	-162.3	208.8	10.12	10.00	-1.61

<b>Company:</b>	BONANZA CREEK ENERGY OPERATING	<b>Local Co-ordinate Reference:</b>	Well PARK T-P-4HZ
<b>Project:</b>	SEC.4-T4N-R63W	<b>TVD Reference:</b>	RKB @ 4640.0ft (ENSIGN RIG 128 KB 15')
<b>Site:</b>	PARK T-P-4HZ PAD SEC.4- T4N-R63W	<b>MD Reference:</b>	RKB @ 4640.0ft (ENSIGN RIG 128 KB 15')
<b>Well:</b>	PARK T-P-4HZ	<b>North Reference:</b>	True
<b>Wellbore:</b>	Wellbore #1	<b>Survey Calculation Method:</b>	Minimum Curvature
<b>Design:</b>	Wellbore #1	<b>Database:</b>	Landmark

Survey										
Measured Depth (ft)	Inclination (°)	Azimuth (°)	Vertical Depth (ft)	+N/-S (ft)	+E/-W (ft)	Vertical Section (ft)	Dogleg Rate (°/100ft)	Build Rate (°/100ft)	Turn Rate (°/100ft)	
6,627.5	80.35	350.62	6,384.3	219.1	-166.5	233.8	10.08	10.00	1.25	
TARGET 1 460'FSL & 1230'FEL										
6,634.0	81.00	350.70	6,385.3	225.4	-167.5	240.2	10.08	10.00	1.24	
6,665.0	84.00	351.20	6,389.4	255.7	-172.3	270.9	9.81	9.68	1.61	
6,689.0	86.40	351.90	6,391.4	279.4	-175.9	294.7	10.41	10.00	2.92	
6,743.0	89.70	352.90	6,393.2	332.9	-183.0	348.7	6.39	6.11	1.85	
6,774.0	90.60	352.80	6,393.1	363.6	-186.9	379.6	2.92	2.90	-0.32	
6,805.0	91.20	352.90	6,392.7	394.4	-190.7	410.6	1.96	1.94	0.32	
6,837.0	91.40	352.90	6,391.9	426.1	-194.7	442.6	0.63	0.63	0.00	
6,867.0	91.10	353.50	6,391.3	455.9	-198.2	472.6	2.24	-1.00	2.00	
6,898.0	90.70	354.90	6,390.8	486.8	-201.4	503.6	4.70	-1.29	4.52	
6,929.0	89.90	355.70	6,390.6	517.7	-203.9	534.6	3.65	-2.58	2.58	
6,961.0	88.80	356.30	6,391.0	549.6	-206.1	566.6	3.92	-3.44	1.88	
6,992.0	88.00	356.60	6,391.9	580.5	-208.0	597.5	2.76	-2.58	0.97	
7,023.0	88.50	356.80	6,392.8	611.4	-209.8	628.5	1.74	1.61	0.65	
7,055.0	88.90	356.50	6,393.5	643.4	-211.7	660.5	1.56	1.25	-0.94	
7,086.0	89.50	356.60	6,394.0	674.3	-213.6	691.5	1.96	1.94	0.32	
7,117.0	89.80	357.20	6,394.2	705.3	-215.2	722.4	2.16	0.97	1.94	
7,147.0	90.70	357.20	6,394.0	735.2	-216.7	752.4	3.00	3.00	0.00	
7,178.0	90.20	357.30	6,393.8	766.2	-218.2	783.4	1.64	-1.61	0.32	
7,209.0	88.80	357.90	6,394.0	797.2	-219.5	814.3	4.91	-4.52	1.94	
7,240.0	87.80	358.00	6,395.0	828.1	-220.6	845.2	3.24	-3.23	0.32	
7,271.0	87.80	357.90	6,396.2	859.1	-221.7	876.2	0.32	0.00	-0.32	
7,302.0	88.00	357.70	6,397.3	890.1	-222.9	907.1	0.91	0.65	-0.65	
7,333.0	88.90	357.30	6,398.1	921.0	-224.2	938.1	3.18	2.90	-1.29	
7,365.0	89.40	357.70	6,398.6	953.0	-225.6	970.0	2.00	1.56	1.25	
7,396.0	90.20	357.30	6,398.7	983.9	-227.0	1,001.0	2.89	2.58	-1.29	
7,427.0	90.00	357.50	6,398.7	1,014.9	-228.4	1,031.9	0.91	-0.65	0.65	
7,458.0	90.50	357.50	6,398.5	1,045.9	-229.8	1,062.9	1.61	1.61	0.00	
7,490.0	89.60	357.70	6,398.5	1,077.9	-231.1	1,094.8	2.88	-2.81	0.63	
7,521.0	90.20	357.90	6,398.6	1,108.8	-232.3	1,125.8	2.04	1.94	0.65	
7,552.0	90.10	357.50	6,398.5	1,139.8	-233.5	1,156.7	1.33	-0.32	-1.29	
7,584.0	90.80	357.20	6,398.2	1,171.8	-235.0	1,188.7	2.38	2.19	-0.94	
7,615.0	90.40	356.60	6,397.9	1,202.7	-236.7	1,219.7	2.33	-1.29	-1.94	
7,646.0	90.20	356.60	6,397.7	1,233.7	-238.5	1,250.7	0.65	-0.65	0.00	
7,677.0	90.60	356.80	6,397.5	1,264.6	-240.3	1,281.6	1.44	1.29	0.65	
7,708.0	90.70	356.80	6,397.2	1,295.6	-242.0	1,312.6	0.32	0.32	0.00	
7,740.0	91.00	357.00	6,396.7	1,327.5	-243.8	1,344.6	1.13	0.94	0.63	
7,771.0	90.80	357.30	6,396.2	1,358.5	-245.3	1,375.6	1.16	-0.65	0.97	
7,802.0	90.60	357.90	6,395.8	1,389.4	-246.6	1,406.5	2.04	-0.65	1.94	
7,834.0	90.00	358.20	6,395.7	1,421.4	-247.7	1,438.4	2.10	-1.88	0.94	
7,865.0	89.20	358.20	6,395.9	1,452.4	-248.7	1,469.4	2.58	-2.58	0.00	
7,896.0	89.30	357.90	6,396.3	1,483.4	-249.7	1,500.3	1.02	0.32	-0.97	
7,928.0	90.00	358.00	6,396.5	1,515.4	-250.9	1,532.3	2.21	2.19	0.31	
7,959.0	90.50	358.40	6,396.3	1,546.4	-251.8	1,563.2	2.07	1.61	1.29	
7,990.0	90.70	358.90	6,396.0	1,577.3	-252.6	1,594.1	1.74	0.65	1.61	
8,022.0	90.00	358.40	6,395.8	1,609.3	-253.3	1,626.0	2.69	-2.19	-1.56	
8,053.0	89.00	357.70	6,396.1	1,640.3	-254.4	1,657.0	3.94	-3.23	-2.26	
8,084.0	88.20	357.20	6,396.8	1,671.3	-255.8	1,687.9	3.04	-2.58	-1.61	
8,116.0	88.80	356.80	6,397.7	1,703.2	-257.4	1,719.9	2.25	1.88	-1.25	
8,147.0	89.20	356.50	6,398.2	1,734.2	-259.2	1,750.9	1.61	1.29	-0.97	
8,178.0	89.30	355.70	6,398.6	1,765.1	-261.4	1,781.9	2.60	0.32	-2.58	
8,210.0	90.00	356.10	6,398.8	1,797.0	-263.6	1,813.9	2.52	2.19	1.25	
8,242.0	90.30	355.70	6,398.7	1,828.9	-265.9	1,845.8	1.56	0.94	-1.25	

<b>Company:</b>	BONANZA CREEK ENERGY OPERATING	<b>Local Co-ordinate Reference:</b>	Well PARK T-P-4HZ
<b>Project:</b>	SEC.4-T4N-R63W	<b>TVD Reference:</b>	RKB @ 4640.0ft (ENSIGN RIG 128 KB 15')
<b>Site:</b>	PARK T-P-4HZ PAD SEC.4- T4N-R63W	<b>MD Reference:</b>	RKB @ 4640.0ft (ENSIGN RIG 128 KB 15')
<b>Well:</b>	PARK T-P-4HZ	<b>North Reference:</b>	True
<b>Wellbore:</b>	Wellbore #1	<b>Survey Calculation Method:</b>	Minimum Curvature
<b>Design:</b>	Wellbore #1	<b>Database:</b>	Landmark

Survey										
Measured Depth (ft)	Inclination (°)	Azimuth (°)	Vertical Depth (ft)	+N/-S (ft)	+E/-W (ft)	Vertical Section (ft)	Dogleg Rate (°/100ft)	Build Rate (°/100ft)	Turn Rate (°/100ft)	
8,272.0	90.00	356.10	6,398.7	1,858.8	-268.1	1,875.8	1.67	-1.00	1.33	
8,303.0	90.10	356.60	6,398.6	1,889.8	-270.0	1,906.8	1.64	0.32	1.61	
8,335.0	89.80	356.30	6,398.7	1,921.7	-272.0	1,938.8	1.33	-0.94	-0.94	
8,366.0	89.50	356.10	6,398.9	1,952.6	-274.1	1,969.8	1.16	-0.97	-0.65	
8,397.0	90.10	356.30	6,399.0	1,983.6	-276.1	2,000.8	2.04	1.94	0.65	
8,429.0	90.70	355.90	6,398.7	2,015.5	-278.3	2,032.8	2.25	1.88	-1.25	
8,459.0	90.50	356.30	6,398.4	2,045.4	-280.4	2,062.8	1.49	-0.67	1.33	
8,490.0	90.70	357.00	6,398.1	2,076.4	-282.2	2,093.7	2.35	0.65	2.26	
8,521.0	90.40	357.00	6,397.8	2,107.3	-283.8	2,124.7	0.97	-0.97	0.00	
8,551.0	90.50	357.90	6,397.6	2,137.3	-285.1	2,154.7	3.02	0.33	3.00	
8,582.0	90.20	358.70	6,397.4	2,168.3	-286.0	2,185.6	2.76	-0.97	2.58	
8,612.0	89.50	358.00	6,397.5	2,198.3	-286.9	2,215.5	3.30	-2.33	-2.33	
8,643.0	90.70	357.20	6,397.4	2,229.2	-288.2	2,246.5	4.65	3.87	-2.58	
8,675.0	89.60	355.70	6,397.3	2,261.2	-290.2	2,278.5	5.81	-3.44	-4.69	
8,706.0	89.00	355.40	6,397.7	2,292.1	-292.6	2,309.5	2.16	-1.94	-0.97	
8,737.0	89.40	355.40	6,398.1	2,323.0	-295.1	2,340.5	1.29	1.29	0.00	
8,768.0	88.90	355.20	6,398.6	2,353.9	-297.6	2,371.5	1.74	-1.61	-0.65	
8,800.0	89.30	354.90	6,399.1	2,385.8	-300.4	2,403.4	1.56	1.25	-0.94	
8,831.0	90.00	354.90	6,399.3	2,416.6	-303.1	2,434.4	2.26	2.26	0.00	
8,862.0	90.70	354.70	6,399.1	2,447.5	-305.9	2,465.4	2.35	2.26	-0.65	
8,893.0	90.50	355.20	6,398.8	2,478.4	-308.7	2,496.4	1.74	-0.65	1.61	
8,925.0	90.10	356.10	6,398.6	2,510.3	-311.1	2,528.4	3.08	-1.25	2.81	
8,956.0	89.20	357.00	6,398.8	2,541.2	-313.0	2,559.4	4.11	-2.90	2.90	
8,987.0	89.30	357.00	6,399.2	2,572.2	-314.6	2,590.4	0.32	0.32	0.00	
9,018.0	90.70	357.70	6,399.2	2,603.2	-316.0	2,621.4	5.05	4.52	2.26	
9,049.0	90.60	357.30	6,398.8	2,634.1	-317.4	2,652.3	1.33	-0.32	-1.29	
9,081.0	89.80	357.00	6,398.7	2,666.1	-319.0	2,684.3	2.67	-2.50	-0.94	
9,112.0	90.00	356.80	6,398.8	2,697.0	-320.6	2,715.3	0.91	0.65	-0.65	
9,143.0	90.20	356.80	6,398.7	2,728.0	-322.4	2,746.2	0.65	0.65	0.00	
9,173.0	90.90	356.50	6,398.4	2,757.9	-324.1	2,776.2	2.54	2.33	-1.00	
9,204.0	91.50	356.60	6,397.8	2,788.9	-326.0	2,807.2	1.96	1.94	0.32	
9,236.0	91.30	356.00	6,397.0	2,820.8	-328.1	2,839.2	1.98	-0.63	-1.88	
9,267.0	91.00	357.00	6,396.4	2,851.7	-329.9	2,870.1	3.37	-0.97	3.23	
9,298.0	90.70	356.80	6,395.9	2,882.7	-331.6	2,901.1	1.16	-0.97	-0.65	
9,329.0	89.90	356.80	6,395.8	2,913.6	-333.3	2,932.1	2.58	-2.58	0.00	
9,361.0	90.30	356.60	6,395.7	2,945.6	-335.2	2,964.1	1.40	1.25	-0.63	
9,392.0	90.20	356.50	6,395.6	2,976.5	-337.1	2,995.0	0.46	-0.32	-0.32	
9,423.0	90.80	356.50	6,395.3	3,007.5	-338.9	3,026.0	1.94	1.94	0.00	
9,455.0	90.00	356.30	6,395.1	3,039.4	-341.0	3,058.0	2.58	-2.50	-0.63	
9,486.0	88.50	356.30	6,395.5	3,070.3	-343.0	3,089.0	4.84	-4.84	0.00	
9,518.0	88.00	356.50	6,396.5	3,102.3	-345.0	3,121.0	1.68	-1.56	0.63	
9,549.0	88.50	355.90	6,397.4	3,133.2	-347.0	3,151.9	2.52	1.61	-1.94	
9,580.0	89.10	356.10	6,398.1	3,164.1	-349.2	3,182.9	2.04	1.94	0.65	
9,610.0	89.70	355.70	6,398.4	3,194.0	-351.3	3,212.9	2.40	2.00	-1.33	
9,642.0	90.20	355.70	6,398.4	3,225.9	-353.7	3,244.9	1.56	1.56	0.00	
9,673.0	90.90	355.70	6,398.1	3,256.8	-356.1	3,275.9	2.26	2.26	0.00	
9,704.0	91.70	355.40	6,397.4	3,287.7	-358.5	3,306.9	2.76	2.58	-0.97	
9,736.0	91.40	355.60	6,396.5	3,319.6	-361.0	3,338.9	1.13	-0.94	0.63	
9,767.0	91.00	355.00	6,395.9	3,350.5	-363.5	3,369.9	2.33	-1.29	-1.94	
9,798.0	90.70	355.70	6,395.4	3,381.4	-366.0	3,400.8	2.46	-0.97	2.26	
9,830.0	90.10	356.50	6,395.2	3,413.3	-368.2	3,432.8	3.12	-1.88	2.50	
9,861.0	90.00	355.70	6,395.2	3,444.3	-370.3	3,463.8	2.60	-0.32	-2.58	
9,892.0	90.50	355.90	6,395.0	3,475.2	-372.6	3,494.8	1.74	1.61	0.65	
9,924.0	90.00	356.10	6,394.9	3,507.1	-374.8	3,526.8	1.68	-1.56	0.63	

<b>Company:</b>	BONANZA CREEK ENERGY OPERATING	<b>Local Co-ordinate Reference:</b>	Well PARK T-P-4HZ
<b>Project:</b>	SEC.4-T4N-R63W	<b>TVD Reference:</b>	RKB @ 4640.0ft (ENSIGN RIG 128 KB 15')
<b>Site:</b>	PARK T-P-4HZ PAD SEC.4- T4N-R63W	<b>MD Reference:</b>	RKB @ 4640.0ft (ENSIGN RIG 128 KB 15')
<b>Well:</b>	PARK T-P-4HZ	<b>North Reference:</b>	True
<b>Wellbore:</b>	Wellbore #1	<b>Survey Calculation Method:</b>	Minimum Curvature
<b>Design:</b>	Wellbore #1	<b>Database:</b>	Landmark

Survey										
Measured Depth (ft)	Inclination (°)	Azimuth (°)	Vertical Depth (ft)	+N/-S (ft)	+E/-W (ft)	Vertical Section (ft)	Dogleg Rate (°/100ft)	Build Rate (°/100ft)	Turn Rate (°/100ft)	
9,955.0	89.20	356.50	6,395.1	3,538.0	-376.8	3,557.8	2.89	-2.58	1.29	
9,986.0	88.60	356.30	6,395.7	3,569.0	-378.8	3,588.8	2.04	-1.94	-0.65	
10,018.0	89.30	355.90	6,396.3	3,600.9	-380.9	3,620.8	2.52	2.19	-1.25	
10,049.0	89.60	355.90	6,396.6	3,631.8	-383.1	3,651.7	0.97	0.97	0.00	
10,080.0	89.80	355.70	6,396.8	3,662.7	-385.4	3,682.7	0.91	0.65	-0.65	
10,111.0	90.50	355.90	6,396.7	3,693.6	-387.7	3,713.7	2.35	2.26	0.65	
10,143.0	90.70	356.10	6,396.3	3,725.6	-389.9	3,745.7	0.88	0.63	0.63	
10,174.0	91.00	356.60	6,395.9	3,756.5	-391.9	3,776.7	1.88	0.97	1.61	
10,205.0	90.60	357.50	6,395.5	3,787.4	-393.5	3,807.7	3.18	-1.29	2.90	
10,237.0	89.40	357.50	6,395.5	3,819.4	-394.9	3,839.6	3.75	-3.75	0.00	
10,268.0	88.40	357.00	6,396.0	3,850.4	-396.4	3,870.6	3.61	-3.23	-1.61	
10,299.0	88.60	356.60	6,396.9	3,881.3	-398.1	3,901.6	1.44	0.65	-1.29	
10,331.0	89.40	356.60	6,397.4	3,913.2	-400.0	3,933.5	2.50	2.50	0.00	
10,362.0	90.00	356.60	6,397.6	3,944.2	-401.8	3,964.5	1.94	1.94	0.00	
10,393.0	89.30	357.00	6,397.8	3,975.1	-403.6	3,995.5	2.60	-2.26	1.29	
10,425.0	88.90	357.30	6,398.3	4,007.1	-405.2	4,027.4	1.56	-1.25	0.94	
10,456.0	89.30	357.30	6,398.8	4,038.1	-406.6	4,058.4	1.29	1.29	0.00	
10,487.0	90.00	357.20	6,398.9	4,069.0	-408.1	4,089.4	2.28	2.26	-0.32	
10,518.0	90.70	357.20	6,398.8	4,100.0	-409.6	4,120.3	2.26	2.26	0.00	
10,550.0	90.50	357.20	6,398.4	4,131.9	-411.2	4,152.3	0.63	-0.63	0.00	
10,580.0	90.70	356.50	6,398.1	4,161.9	-412.8	4,182.3	2.43	0.67	-2.33	
10,612.0	90.20	356.60	6,397.9	4,193.8	-414.8	4,214.3	1.59	-1.56	0.31	
10,643.0	90.20	357.50	6,397.8	4,224.8	-416.3	4,245.2	2.90	0.00	2.90	
10,675.0	90.70	357.50	6,397.5	4,256.8	-417.7	4,277.2	1.56	1.56	0.00	
10,706.0	90.00	357.70	6,397.3	4,287.7	-419.0	4,308.1	2.35	-2.26	0.65	
10,737.0	88.70	357.00	6,397.7	4,318.7	-420.5	4,339.1	4.76	-4.19	-2.26	
10,767.0	89.40	357.50	6,398.2	4,348.7	-421.9	4,369.1	2.87	2.33	1.67	
10,798.0	90.60	357.70	6,398.2	4,379.6	-423.2	4,400.0	3.92	3.87	0.65	
10,829.0	90.50	357.00	6,397.9	4,410.6	-424.6	4,431.0	2.28	-0.32	-2.26	
10,860.0	89.70	356.80	6,397.8	4,441.6	-426.3	4,462.0	2.66	-2.58	-0.65	
10,891.0	89.70	356.30	6,398.0	4,472.5	-428.2	4,492.9	1.61	0.00	-1.61	
10,922.0	89.30	355.60	6,398.2	4,503.4	-430.4	4,523.9	2.60	-1.29	-2.26	
10,953.0	89.00	355.90	6,398.7	4,534.3	-432.7	4,554.9	1.37	-0.97	0.97	
10,985.0	89.40	355.60	6,399.1	4,566.2	-435.0	4,586.9	1.56	1.25	-0.94	
11,016.0	89.60	355.00	6,399.4	4,597.1	-437.6	4,617.9	2.04	0.65	-1.94	
11,047.0	89.80	354.50	6,399.6	4,628.0	-440.4	4,648.9	1.74	0.65	-1.61	
11,070.0	90.40	354.50	6,399.5	4,650.9	-442.6	4,671.9	2.61	2.61	0.00	
11,120.0	90.40	354.50	6,399.2	4,700.7	-447.4	4,721.9	0.00	0.00	0.00	
BHL 460'FNL & 1816'FEL										

Checked By: _____	Approved By: _____	Date: _____
-------------------	--------------------	-------------