

# Great Western H-Y Well Pad FHDP Proposed Conditions Map

Section 29, T6N, R67W,  
6th P.M., NE ¼, NW ¼  
Weld County, CO

Base Plan Note:  
Vertical datum for  
contours shown is  
NAVD 88.

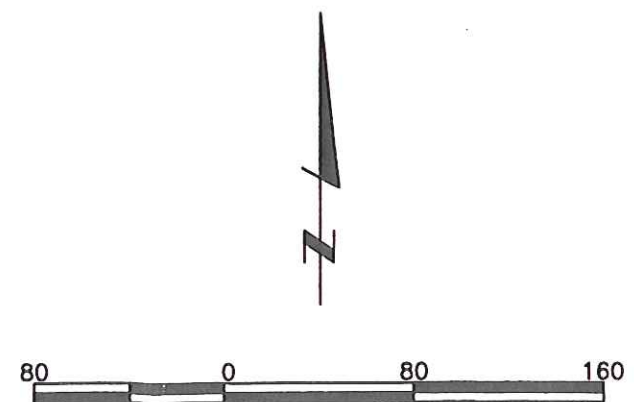
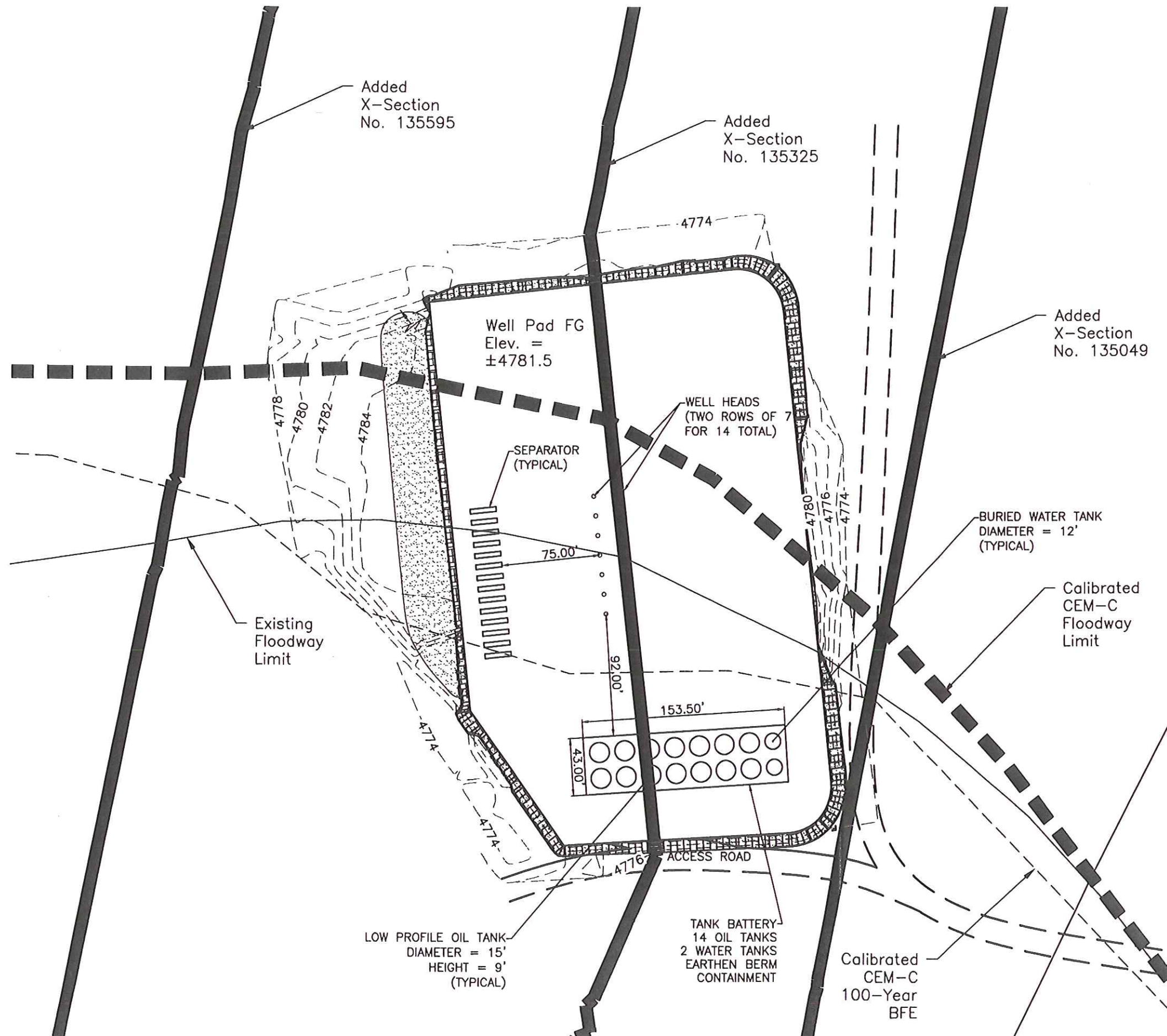

970.226.0342 | P  
970.226.0879 | F

4715 Innovation Drive  
Fort Collins, CO 80525  
www.LRA-Inc.com

**LAMP RYNEARSON  
& ASSOCIATES**



drawn by	designed by	reviewed by	project - task number	date	book and page	revisions
CJS	Engineering	0212016	0212016	07-30-2012		
path\filename	P:\_Engineering\0212016\DRAWINGS\EXHIBITS\FHDP_Submittal	DWG	Proposed	Cond.dwg		