

WPX ENERGY ROCKY MOUNTAIN, LLC
SMITH GULCH FRAC TANK PAD
LOCATED IN GARFIELD COUNTY, COLORADO
SECTIONS 32, T7S, R96W, 6th P.M.



PHOTO: VIEW FROM CORNER #1 TO CENTER STAKE

CAMERA ANGLE: WESTERLY



PHOTO: VIEW FROM BEGINNING OF PROPOSED ACCESS

CAMERA ANGLE: NORTHERLY



UELS Uintah Engineering & Land Surveying
85 South 200 East Vernal, Utah 84078
(435) 789-1017 * FAX (435) 789-1813

LOCATION PHOTOS

6 **15** **12**
MONTH DAY YEAR

TAKEN BY: B.J. DRAWN BY: J.L.G. REVISED: 00-00-00

PHOTO
P1

WPX ENERGY ROCKY MOUNTAIN, LLC
SMITH GULCH FRAC TANK PAD
LOCATED IN GARFIELD COUNTY, COLORADO
SECTIONS 32, T7S, R96W, 6th P.M.

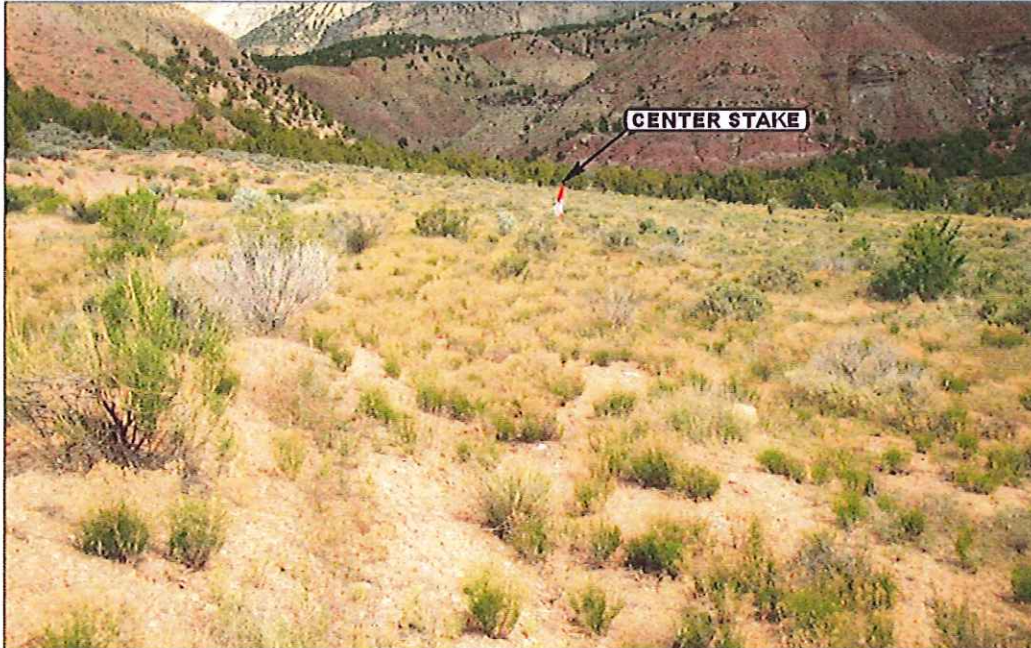

PHOTO: VIEW OF CENTER STAKE

CAMERA ANGLE: NORTHERLY

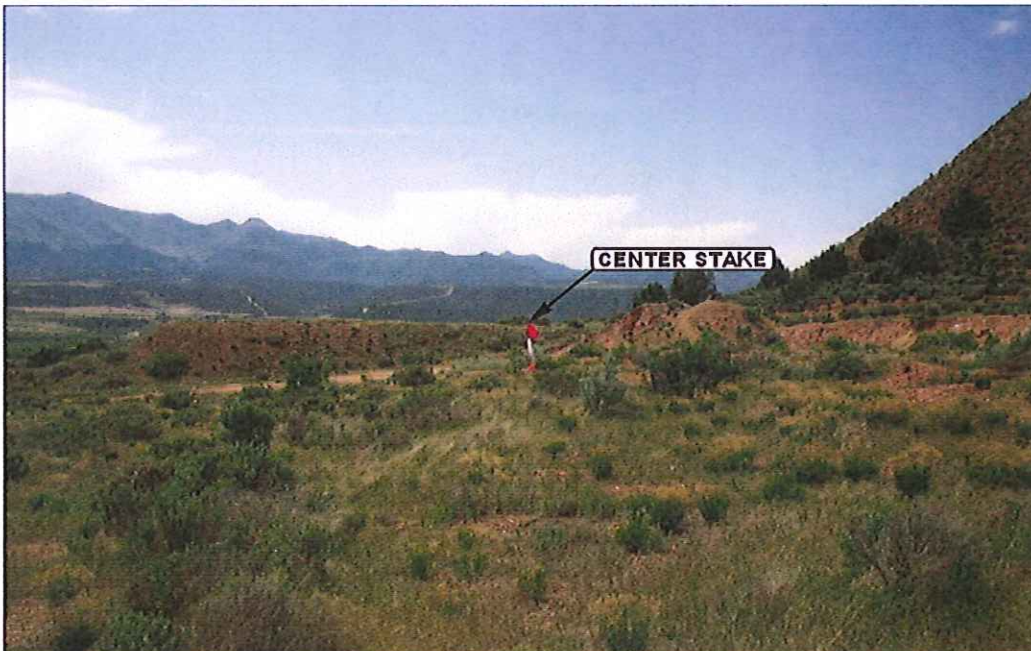

PHOTO: VIEW OF CENTER STAKE

CAMERA ANGLE: SOUTHERLY



UELS Uintah Engineering & Land Surveying
85 South 200 East Vernal, Utah 84078
(435) 789-1017 * FAX (435) 789-1813

LOCATION PHOTOS

06 15 12
MONTH DAY YEAR

TAKEN BY: B.J. DRAWN BY: J.L.G. REVISED: 00-00-00

PHOTO
P2

WPX ENERGY ROCKY MOUNTAIN, LLC
SMITH GULCH FRAC TANK PAD
LOCATED IN GARFIELD COUNTY, COLORADO
SECTIONS 32, T7S, R96W, 6th P.M.

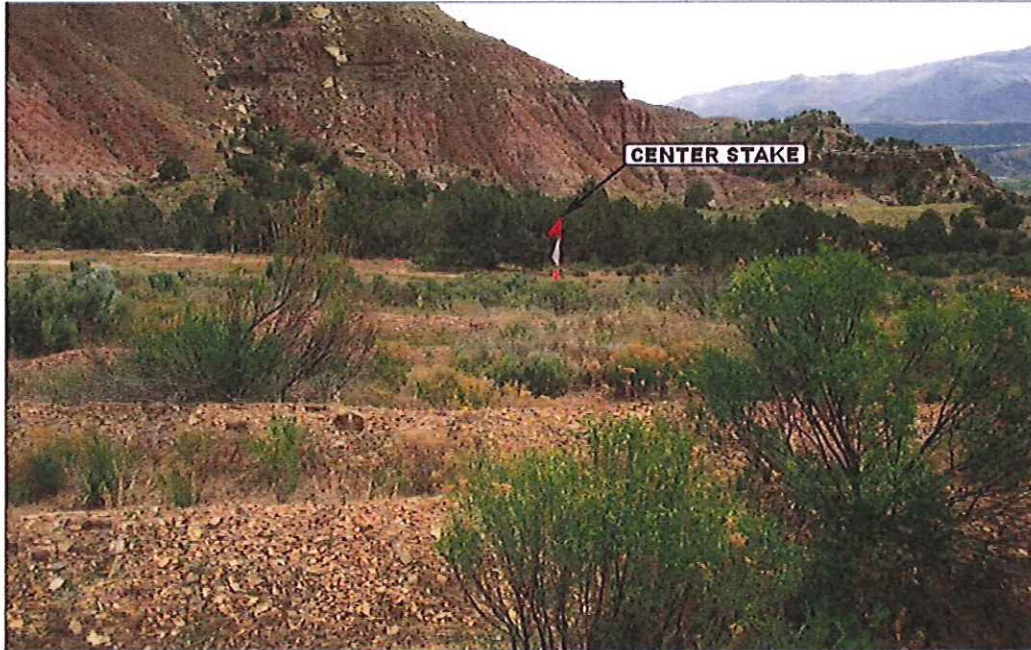

PHOTO: VIEW OF CENTER STAKE

CAMERA ANGLE: EASTERLY



PHOTO: VIEW OF CENTER STAKE

CAMERA ANGLE: WESTERLY



U **E** **L** **S** Uintah Engineering & Land Surveying
85 South 200 East Vernal, Utah 84078
(435) 789-1017 * FAX (435) 789-1813

LOCATION PHOTOS

06 **15** **12**
MONTH DAY YEAR

TAKEN BY: B.J. DRAWN BY: J.L.G. REVISED: 00-00-00

PHOTO
P3