

# CONSTRUCTION LAYOUT DRAWING

1 of 2  
Berm

VEGETATION:  
GRASSLAND PASTURE

SURFACE USE:  
GRAZING

PAD 360'X380' ELEV= 4899.9

DISTURBED AREA=4.2± ACRES

ESTIMATED DIRT QUANTITIES

CUTx10%	FILL	TOPSOIL	EXCESS
8,000	5,190	2,740	70

NOTE: VOLUMES IN CUBIC YARDS. TOPSOIL INCLUDED IN VOLUMES AT A DEPTH OF 6".

240' x 210' x 12' Deep  
Lined Freshwater  
Storage Pit.

25' x 25' x 2' Deep  
Sump

Topsoil

(A) 5+00

4915  
Non-Functional  
Irrigation Ditch

4910

DWG: G:\GEO SURV\Well\North\Corrizo 110004\Well\Plate\Platnik 30-44-9-59\F2A.R1.dwg USER: SFC DATE: Jul 27, 2012 11:42am

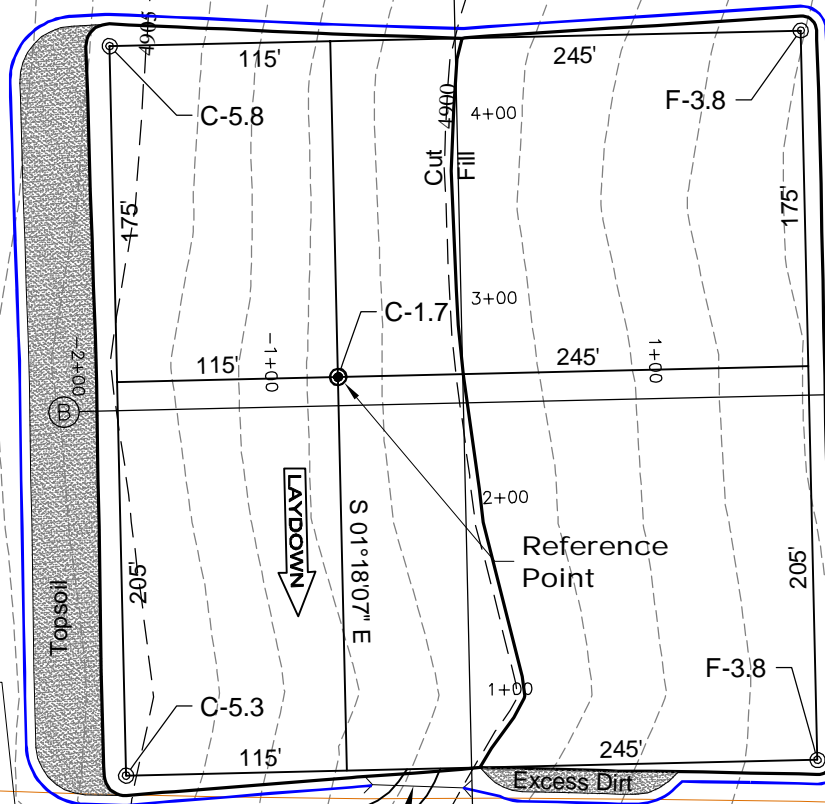

North

0 100 200

Graphic Scale in Feet  
1 inch = 100 feet

Non-Functional  
Irrigation Ditch

Install  
18" CMP

7/27/12

(A) 0+00  
Barbed Wire Fence

NOTE:  
10% ALLOWANCE IS MADE FOR SOIL EXPANSION.



LAND SURVEYING AND MAPPING  
LAFAYETTE - WINTER PARK  
Ph 303 666 0379 Fx 303 665 6320

CARRIZO OIL & GAS, INC  
PTASNIK 30-44-9-59 PAD

SE1/4 SE1/4 SEC. 30 T9N R59W  
6th PM WELD COUNTY COLORADO

# CONSTRUCTION LAYOUT DRAWING

2 of 2

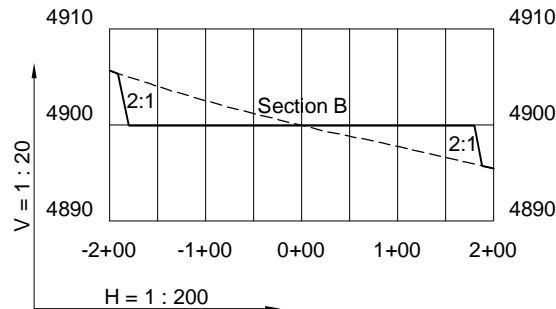
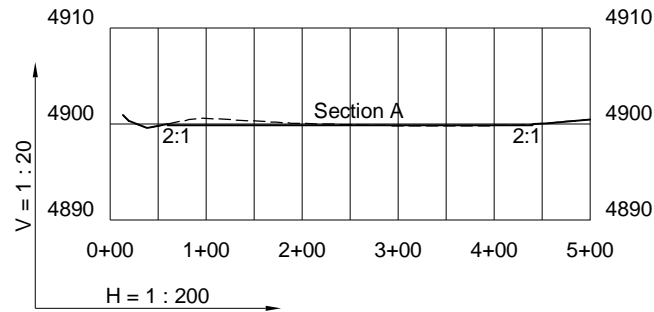

7/27/12

----- Existing Ground  
 \_\_\_\_\_ Proposed Grade



**LAND SURVEYING AND MAPPING**  
**LAFAYETTE - WINTER PARK**  
 Ph 303 666 0379 Fx 303 665 6320

**CARRIZO OIL & GAS, INC**  
**PTASNIK 30-44-9-59 PAD**

**SE1/4 SE1/4 SEC. 30 T9N R59W**  
**6th PM WELD COUNTY COLORADO**