

Location Drawing

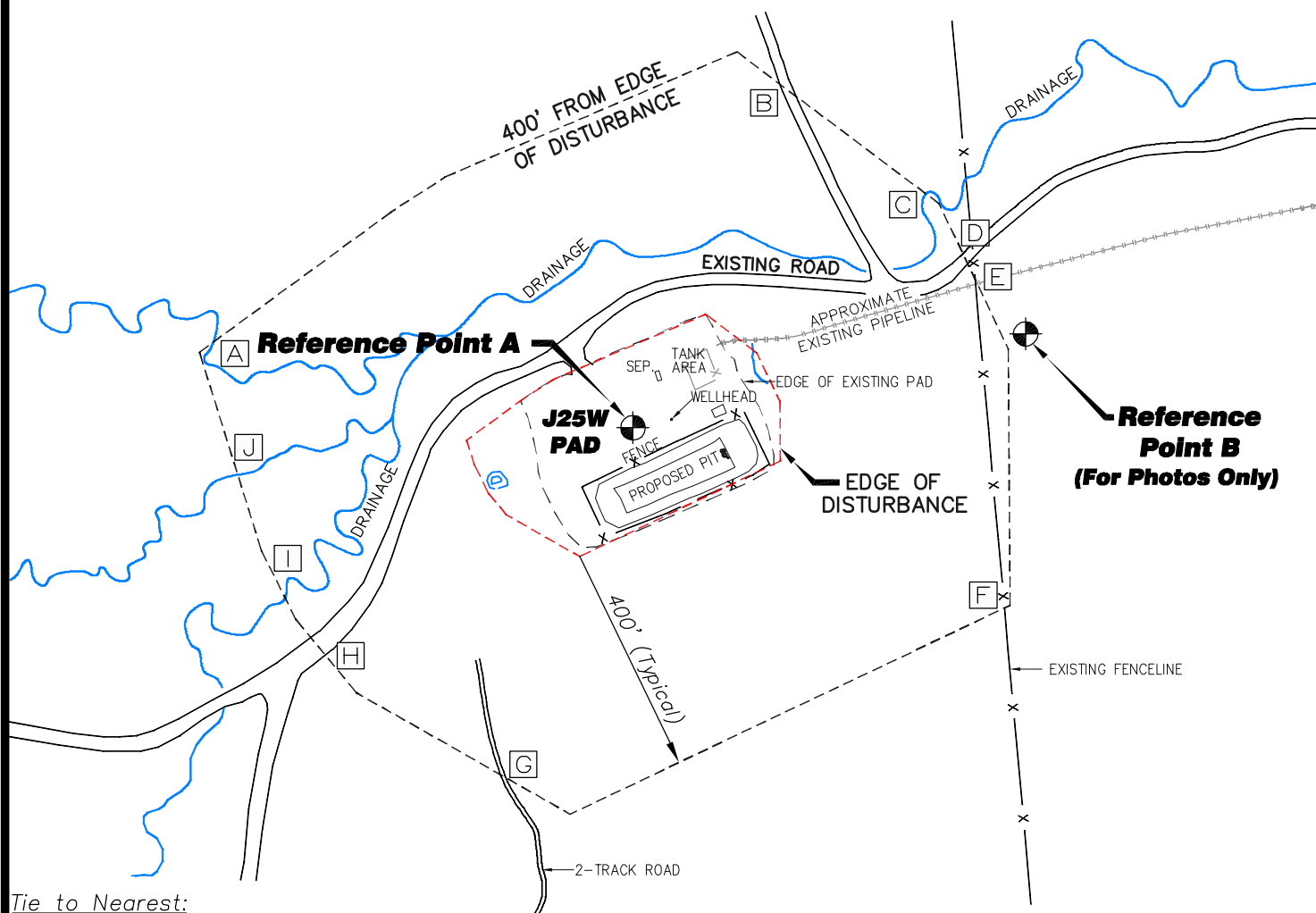

Tie to Nearest:

Building 3150' easterly
Public Road 2800' southeasterly
Property Line 1750' southeast
Above Ground Utility 3300' easterly
Railroad +43,000' northwesterly

Reference Point "A" Data:

Latitude: N 39.414442°
Longitude: W 107.721079°
1618' FSL/1964' FEL
Section 25
PDOP: 1.7
ELEV: 6679.7'
Field observations taken on
7/16/12 by operator Jason Hergert.

Distances listed below are measured from the Reference Point "A"

[A] N78°W, 749' to drainage	[G] S21°W, 649' to 2-track road
[B] N25°E, 649' to centerline road	[H] S55°W, 670' to centerline road
[C] N51°E, 656' to drainage	[I] S64°W, 675' to drainage
[D] N63°E, 653' to centerline road	[J] S83°W, 675' to drainage
[E] N67°E, 650' to fenceline & pipeline	
[F] S64°E, 722' to fenceline	

Reference Point "B" Data:

(Used for Additional Photos Only)
Latitude: N 39.414892°
Longitude: W 107.718649°
PDOP: 1.5
ELEV: 6676.8'
Field observations taken on
7/16/12 by operator Jason Hergert.



SCALE 1" = 300'

Encana Oil & Gas (USA) Inc.
J25W Reserve Water Pit -
Location Drawing
Improvements extending
400' from disturbance

SE1/4 OF SECTION 25
T7S, R93W, 6th P.M.
GARFIELD COUNTY, COLORADO
Project No. 11-04-18 Date: July 30, 2012



906 Main Street
Evanston, Wyoming 82930
Phone No. (307) 789-4545