

CHEVRON U.S.A., INC.

FEE #162Y

**LOCATED IN RIO BLANCO COUNTY, COLORADO
SECTION 28, T2N, R102W, 6th P.M.**

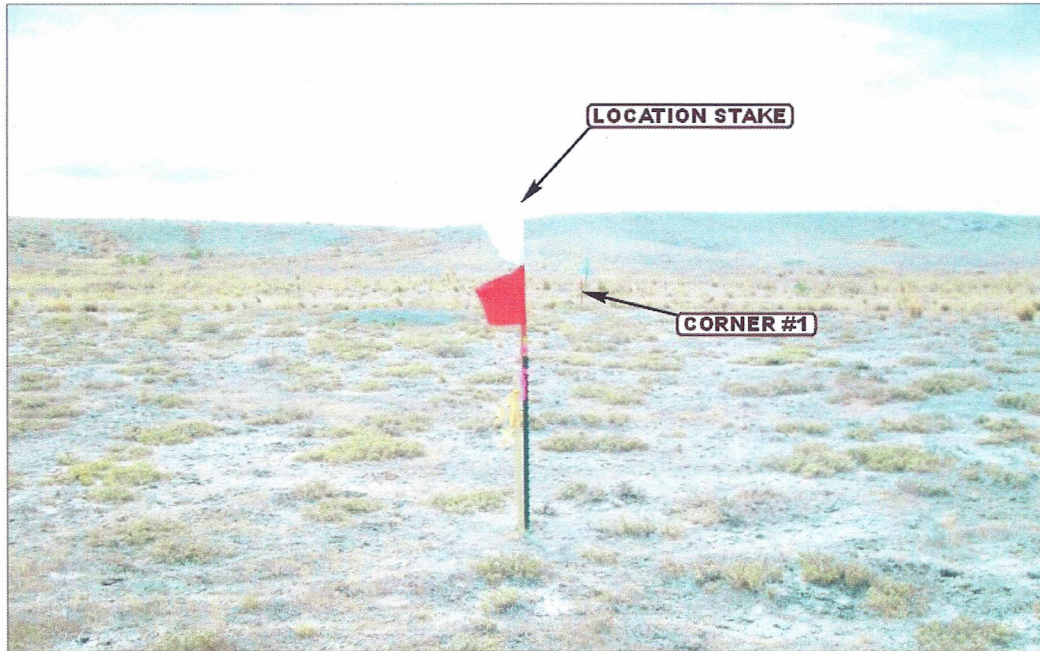

PHOTO: VIEW FROM LOCATION STAKE TO CORNER #1

CAMERA ANGLE: SOUTHWESTERLY



PHOTO: VIEW FROM BEGINNING OF PROPOSED ACCESS

CAMERA ANGLE: NORTHWESTERLY



UELS Uintah Engineering & Land Surveying
85 South 200 East Vernal, Utah 84078
(435) 789-1017 * FAX (435) 789-1813

LOCATION PHOTOS

07 20 12
MONTH DAY YEAR

PHOTO

P1

TAKEN BY: J.F.

DRAWN BY: J.L.G.

REVISED: 00-00-00

CHEVRON U.S.A., INC.

FEE #162Y

LOCATED IN RIO BLANCO COUNTY, COLORADO

SECTION 28, T2N, R102W, 6th P.M.



PHOTO: VIEW OF LOCATION STAKE

CAMERA ANGLE: NORTHERLY



PHOTO: VIEW OF LOCATION STAKE

CAMERA ANGLE: SOUTHERLY



UELS Uintah Engineering & Land Surveying
85 South 200 East Vernal, Utah 84078
(435) 789-1017 * FAX (435) 789-1813

LOCATION PHOTOS

07 20 12
MONTH DAY YEAR

TAKEN BY: J.F. DRAWN BY: J.L.G. REVISED: 00-00-00

PHOTO
P2

CHEVRON U.S.A., INC.

FEE #162Y

LOCATED IN RIO BLANCO COUNTY, COLORADO
SECTION 28, T2N, R102W, 6th P.M.



PHOTO: VIEW OF LOCATION STAKE

CAMERA ANGLE: EASTERLY



PHOTO: VIEW OF LOCATION STAKE

CAMERA ANGLE: WESTERLY



UELS Uintah Engineering & Land Surveying
85 South 200 East Vernal, Utah 84078
(435) 789-1017 * FAX (435) 789-1813

LOCATION PHOTOS

07 20 12
MONTH DAY YEAR

PHOTO
P3

TAKEN BY: J.F. DRAWN BY: J.L.G. REVISED: 00-00-00