

1625 Broadway
Suite 2200.
Denver, CO 80202

Tel: 303.228.4000
Fax: 303.228.4286
www.nobleenergyinc.com



North America Division

July 5, 2012

Mr. John Axelson
Department Of Natural Resources
Oil & Gas Conservation Commission
1120 Lincoln St., Suite 801
Denver CO 80203-2136

RE: Ground water Monitoring Report and Request for No Further Action
Lorenz F22-1, 2
API 05-123-15139
Remediation #5465
Sec. 22, T5N R65W
Weld County, Colorado

Dear Mr. Axelson:

Please find attached the Ground Water Monitoring Report for the Lorenz F22-1,2. Based on the site remedial activities and the attached laboratory analytical results, Noble Energy Inc. is requesting that the COGCC consider this location closed, requiring no further action.

Noble Energy Inc. would like to claim business confidentiality protection for the information submitted in this letter, the supporting materials attached and all previous and subsequent correspondence related to this matter. Please contact the Noble Energy Environmental Department at (303) 228-4158 if you have any questions or require additional information.

Sincerely,

A handwritten signature in blue ink, appearing to read 'Ryan Bruner'.

Ryan Bruner
Environmental and Regulatory Supervisor

Attachments



GROUNDWATER MONITORING REPORT/ NO FURTHER ACTION REQUEST MAY 2012

LORENZ F 22-1 TANK BATTERY COGCC TRACKING #2522902 & REMEDIATION #5465

LT Environmental, Inc. (LTE), under the direction of Noble Energy, Inc. (Noble), conducted groundwater monitoring at the Lorenz F 22-1 Tank Battery (Site) on May 11, 2012. This monitoring event constitutes the fifth post-remediation monitoring event at this Site. Site history, remediation activities, well installation, and historical performance monitoring results have been described in preceding reports.

Monitoring wells (MW01 through MW06) were installed at the Site on April 22, 2011. The site map is presented as Figure 1. Groundwater level measurements were collected from the monitoring wells and are summarized in Table 1.

Depth to groundwater, which ranged from 4.25 feet below top of casing (btoc) in MW05 to 6.11 feet btoc in MW02, was used to calculate well-specific purge volumes. Following purging, groundwater samples were collected and then submitted to Origins Laboratory, Inc. of Denver, Colorado, for analysis of benzene, toluene, ethylbenzene, and total xylenes (BTEX) by United States Environmental Protection Agency Method 8260C.

Groundwater analytical results, presented in Table 1, indicate BTEX concentrations are in compliance with Colorado Department of Public Health and Environment-Water Quality Control Commission Regulation 41-The Basic Standards for Ground Water (WQCC Reg 41). The laboratory analytical report is attached.

The May 2012 groundwater monitoring event constitutes the fourth consecutive quarterly monitoring event in which groundwater analytical results have been in compliance with WQCC Reg 41. As soil and groundwater have been remediated to achieve cleanup goals, Noble respectively requests that the Colorado Oil and Gas Conservation Commission grant a No Further Action status for the Lorenz F 22-1 Tank Battery.

FIGURE

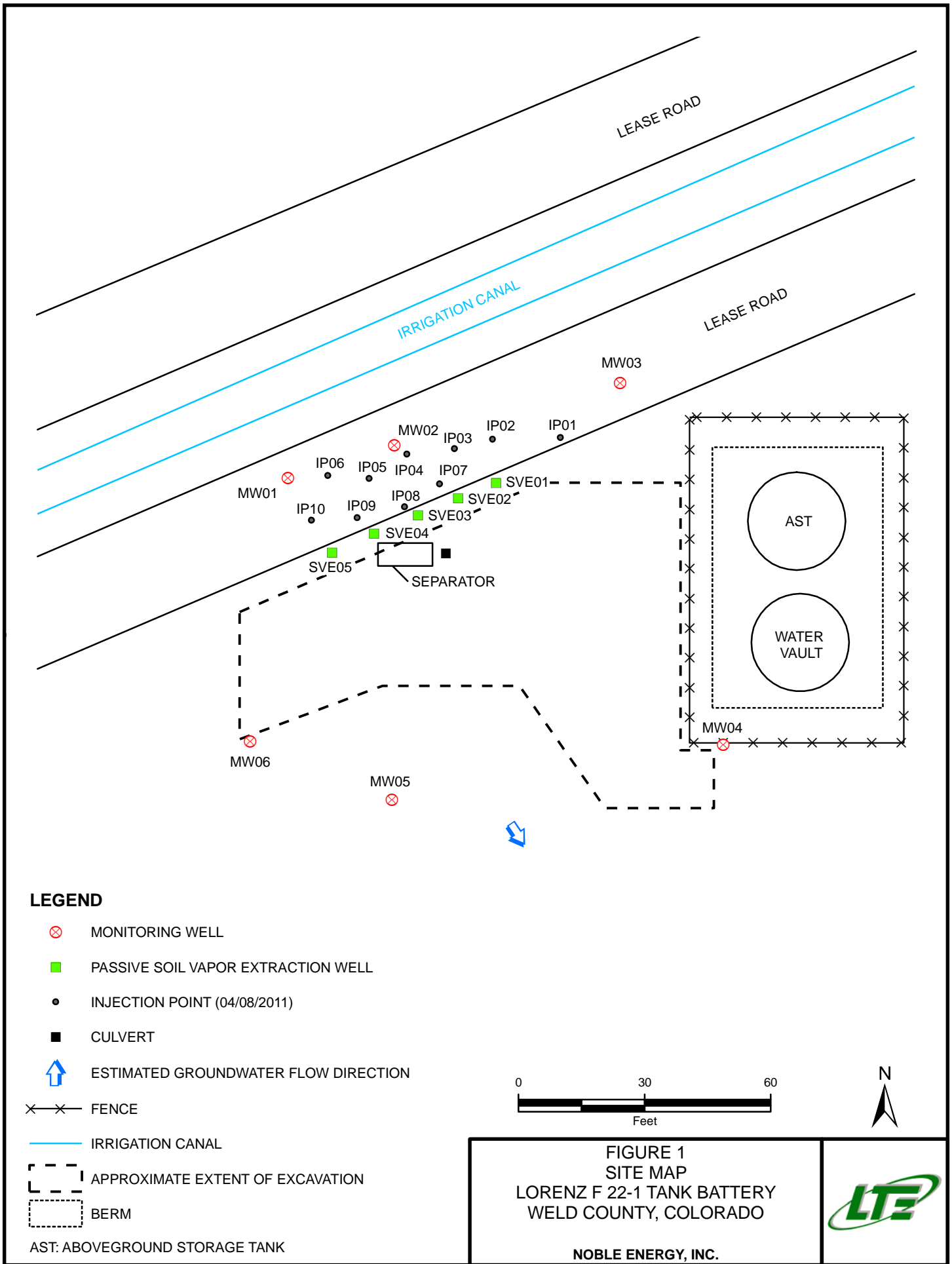

LEGEND

- ⊗ MONITORING WELL
- PASSIVE SOIL VAPOR EXTRACTION WELL
- INJECTION POINT (04/08/2011)
- CULVERT
- ↑ ESTIMATED GROUNDWATER FLOW DIRECTION
- ×-×-× FENCE
- IRRIGATION CANAL
- - - APPROXIMATE EXTENT OF EXCAVATION
- ▭ BERM
- AST: ABOVEGROUND STORAGE TANK

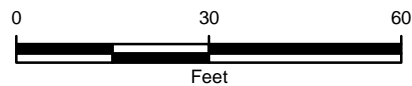

FIGURE 1
SITE MAP
LORENZ F 22-1 TANK BATTERY
WELD COUNTY, COLORADO

NOBLE ENERGY, INC.



TABLE

TABLE 1

**GROUNDWATER ANALYTICAL RESULTS
LORENZ F 22-1 TANK BATTERY
WELD COUNTY, COLORADO
NOBLE ENERGY, INC.**

Well ID	Date	Depth to Water (feet btoc)	Benzene (µg/L)	Toluene (µg/L)	Ethylbenzene (µg/L)	Total Xylenes (µg/L)
MW01	4/26/2011	6.25	<1.0	<1.0	<1.0	<3.0
	7/12/2011	4.69	<1.0	<1.0	<1.0	<3.0
	11/9/2011	5.51	<1.0	<1.0	<1.0	<3.0
	2/9/2012	5.98	<1.0	<1.0	<1.0	<1.0
	5/11/2012	5.85	<1.0	<1.0	<1.0	<1.0
MW02	4/26/2011	6.69	44.3	<1.0	7.4	52.4
	7/12/2011	5.33	<1.0	<1.0	<1.0	<3.0
	11/9/2011	5.96	<1.0	<1.0	<1.0	<3.0
	2/9/2012	6.4	<1.0	<1.0	<1.0	<1.0
	5/11/2012	6.11	<1.0	<1.0	<1.0	<1.0
MW03	4/26/2011	5.81	<1.0	<1.0	<1.0	<3.0
	7/12/2011	4.20	<1.0	<1.0	<1.0	<3.0
	11/9/2011	5.05	<1.0	<1.0	<1.0	<3.0
	2/9/2012	5.51	<1.0	<1.0	<1.0	<1.0
	5/11/2012	5.43	<1.0	<1.0	<1.0	<1.0
MW04	4/26/2011	5.13	<1.0	<1.0	<1.0	<3.0
	7/12/2011	3.52	<1.0	<1.0	<1.0	<3.0
	11/9/2011	4.42	<1.0	<1.0	<1.0	<3.0
	2/9/2012	4.95	<1.0	<1.0	<1.0	<1.0
	5/11/2012	4.83	<1.0	<1.0	<1.0	<1.0
MW05	4/26/2011	5.00	<1.0	<1.0	<1.0	<3.0
	7/12/2011	2.90	<1.0	<1.0	<1.0	<3.0
	11/9/2011	3.76	<1.0	<1.0	<1.0	<3.0
	2/9/2012	4.36	<1.0	<1.0	<1.0	<1.0
	5/11/2012	4.25	<1.0	<1.0	<1.0	<1.0
MW06	4/26/2011	4.59	<1.0	<1.0	1.7	8.6
	7/12/2011	3.03	<1.0	<1.0	<1.0	<3.0
	11/9/2011	3.86	<1.0	<1.0	<1.0	<3.0
	2/9/2012	4.40	<1.0	<1.0	<1.0	<1.0
	5/11/2012	4.27	<1.0	<1.0	<1.0	<1.0
CDPHE WQCC Reg 41			5.0	560	700	1,400

NOTES:

btoc - below top of casing

µg/L - micrograms per liter

< - indicates result is less than the stated laboratory reporting limit

BOLD - indicates result exceeds the applicable standard

Benzene, toluene, ethylbenzene, and total xylenes analyzed by EPA Method 8260C

CDPHE WQCC Reg 41 - Colorado Department of Public Health and Environmental - Water Quality

Control Commission Regulation 41 covering The Basic Standards for Ground Water

ATTACHMENT
LABORATORY ANALYTICAL REPORT



May 16, 2012

LT Environmental, Inc.

Rob Rebel

4600 West 60th Avenue

Arvada CO 80003

Project Name - Noble - Lorenz F22-1

Project Number - NEP1047.01

Attached are you analytical results for Noble - Lorenz F22-1 received by Origins Laboratory, Inc. May 11, 2012. This project is associated with Origins project number X205056-01.

The analytical results in the following report were analyzed under the guidelines of EPA Methods. These methods are identified as follows; "SW" are defined in SW-846, "EPA" are defined in 40CFR part 136 and "SM" are defined in the most current revision of Standard Methods For the Examination of Water and Wastewater.

The analytical results apply specifically to the samples and analyses specified per the attached Chain of Custody. As such, this report shall not be reproduced except in full, without the written approval of Origin's laboratory.

Thank you for selecting Origins for your analytical needs. Please contact us with any questions concerning this report, or if we can help with anything at all.

Origins Laboratory, Inc.
303.433.1322
o-squad@oelabinc.com



1725 Elk Place, Denver, CO 80211 | Phone: 303.433.1322 | Fax: 303.265.9645

LT Environmental, Inc.
4600 West 60th Avenue
Arvada CO 80003

Rob Rebel
Project Number: NEP1047.01
Project: Noble - Lorenz F22-1

CROSS REFERENCE REPORT

Sample ID	Laboratory ID	Matrix	Date Sampled	Date Received
MW-1	X205056-01	Water	May 11, 2012 13:00	05/11/2012 15:08
MW-2	X205056-02	Water	May 11, 2012 13:05	05/11/2012 15:08
MW-3	X205056-03	Water	May 11, 2012 13:10	05/11/2012 15:08
MW-4	X205056-04	Water	May 11, 2012 13:15	05/11/2012 15:08
MW-5	X205056-05	Water	May 11, 2012 13:20	05/11/2012 15:08
MW-6	X205056-06	Water	May 11, 2012 13:25	05/11/2012 15:08

Origins Laboratory, Inc.



Noelle E Doyle, President

The results in this report apply to the samples analyzed in accordance with the chain of custody document. This analytical report must be reproduced in its entirety.

Rob Rebel
Project Number: NEP1047.01
Project: Noble - Lorenz F22-1

ORIGINS

LABORATORY, INC

www.originslaboratory.com

X205056

page 1 of 1

Client: L T E
Address:
Telephone Number: 303-433-4788
Email Address: FRebel@H2v.com

Project Manager: Rob Reibel
Project Name: Local F22-1
Project Number: UEP1047
Samples Collected By: Brandon Fetter

Sample ID Description	Date Sampled	Time Sampled	# of Containers	Preservative				Matrix			Analysis				Sample Instructions
				Unpreserved	HCl	HNO ₃	Other	Groundwater	Soil	Air Summa #	Other				
MW01	5-11-12	1300	3	X				X					X	Lab. Filter	1
MW02		1305													2
MW03		1310													3
MW04		1315													4
MW05		1320													5
MW06		1325													6
															7
															8
															9
															10
Relinquished By: Brandon Fetter	Date: 5-11-12	Time: 15:08		Received By: [Signature]				Date: 5/11/12				Time: 16:08			
Relinquished By:	Date:	Time:		Received By:				Date:				Time:			

1725 Elk Place
Denver, CO 80211
Phone: 303.433.1322
Fax: 303.265.9645

Origins Laboratory, Inc.

Naucke

The results in this report apply to the samples analyzed in accordance with the chain of custody document. This analytical report must be reproduced in its entirety.

LT Environmental, Inc.

4600 West 60th Avenue

Arvada CO 80003

Rob Rebel

Project Number: NEP1047.01

Project: Noble - Lorenz F22-1

Origins Laboratory

F-012207-01-R1
Effective Date: 01/09/12

Sample Receipt Checklist

Origins Work Order: X205056

Client: 51

Client Project ID: LOREZ

Checklist Completed by: R. Rebel

Shipped Via: 4/D HIRK

(UPS, FedEx, Hand Delivered, Pick-up, etc.)

Date/time completed: 5/11/12 15:10

Airbill #: _____

Matrix(s) Received: (Check all that apply):

Soil/Solid

☒ Water

Other: _____

(Describe)

Cooler Number/Temperature: 1 16.7 °C

1 °C

1 °C

1 °C

Thermometer ID: 1001

Requirement Description	Yes	No	N/A	Comments (if any)
If samples require cooling, was the temperature between 0°C to ≤ 5°C ⁽¹⁾ ?		<input checked="" type="checkbox"/>		Sampled same day as receipt - Jpl 05-16-12
Is there ice present (document if blue ice is used)	<input checked="" type="checkbox"/>			
Are custody seals present on cooler? (if so, document in comments if they are signed and dated, broken or intact)		<input checked="" type="checkbox"/>		
Are custody seals present on each sample container? (if so, document in comments if they are signed and dated, broken or intact)		<input checked="" type="checkbox"/>		
Were all samples received intact ⁽¹⁾ ?	<input checked="" type="checkbox"/>			
Was adequate sample volume provided ⁽¹⁾ ?	<input checked="" type="checkbox"/>			
Are short holding time analytes or samples with HTs due within 48 hours present ⁽¹⁾ ?		<input checked="" type="checkbox"/>		
Is a chain-of-custody (COC) present and filled out completely ⁽¹⁾ ?	<input checked="" type="checkbox"/>			
Does the COC agree with the number and type of sample bottles received ⁽¹⁾ ?	<input checked="" type="checkbox"/>			
Do the sample IDs on the bottle labels match the COC ⁽¹⁾ ?	<input checked="" type="checkbox"/>			
Is the COC properly relinquished by the client with date and time recorded ⁽¹⁾ ?	<input checked="" type="checkbox"/>			
For volatiles in water – is there headspace (> ¼ inch bubble) present? If yes, contact client and note in narrative.		<input checked="" type="checkbox"/>		
Are samples preserved that require preservation and was it checked ⁽¹⁾ ? (note ID of confirmation instrument used in comments) / (preservation is not confirmed for subcontracted analyses in order to insure sample integrity) (pH < 2 for samples preserved with HNO ₃ , HCL, H ₂ SO ₄) / (pH > 10 for samples preserved with NaAsO ₂ +NaOH, ZnAc+NaOH)		<input checked="" type="checkbox"/>		Analyzed w/in 7 days of collection - Jpl 05-16-12
Additional Comments (if any):				

⁽¹⁾ If NO, then contact the client before proceeding with analysis and note date/time and person contacted as well as the corrective action to in the additional comments (above) and the case narrative.

Reviewed by (Project Manager) [Signature]

Date/Time Reviewed 05-16-12 1306

Origins Laboratory, Inc.

[Signature]

Noelle E Doyle, President

The results in this report apply to the samples analyzed in accordance with the chain of custody document. This analytical report must be reproduced in its entirety.

LT Environmental, Inc.
4600 West 60th Avenue
Arvada CO 80003

Rob Rebel
Project Number: NEP1047.01
Project: Noble - Lorenz F22-1

MW-1

5/11/2012 1:00:00PM

Analyte	Result	Reporting Limit	Units	Dilution	Batch	Prepared	Analyzed	Notes
---------	--------	--------------------	-------	----------	-------	----------	----------	-------

Origins Laboratory, Inc.
X205056-01 (Water)

BTEX by EPA 8260C

Benzene	ND	1.0	ug/L	1	2E14010	05/14/2012	05/15/2012
Toluene	ND	1.0	"	"	"	"	"
Ethylbenzene	ND	1.0	"	"	"	"	"
Xylenes, total	ND	1.0	"	"	"	"	"

Surrogate: 1,2-Dichloroethane-d4	106 %	70-130	"	"	"
Surrogate: Toluene-d8	92.4 %	70-130	"	"	"
Surrogate: 4-Bromofluorobenzene	83.2 %	70-130	"	"	"

Origins Laboratory, Inc.



The results in this report apply to the samples analyzed in accordance with the chain of custody document. This analytical report must be reproduced in its entirety.

Noelle E Doyle, President

LT Environmental, Inc.
4600 West 60th Avenue
Arvada CO 80003

Rob Rebel
Project Number: NEP1047.01
Project: Noble - Lorenz F22-1

MW-2

5/11/2012 1:05:00PM

Analyte	Result	Reporting		Units	Dilution	Batch	Prepared	Analyzed	Notes
		Limit							

Origins Laboratory, Inc.
X205056-02 (Water)

BTEX by EPA 8260C

Benzene	ND	1.0	ug/L	1	2E14010	05/14/2012	05/15/2012
Toluene	ND	1.0	"	"	"	"	"
Ethylbenzene	ND	1.0	"	"	"	"	"
Xylenes, total	ND	1.0	"	"	"	"	"

Surrogate: 1,2-Dichloroethane-d4	109 %	70-130	"	"	"
Surrogate: Toluene-d8	92.3 %	70-130	"	"	"
Surrogate: 4-Bromofluorobenzene	84.1 %	70-130	"	"	"

Origins Laboratory, Inc.



Noelle E Doyle, President

The results in this report apply to the samples analyzed in accordance with the chain of custody document. This analytical report must be reproduced in its entirety.

LT Environmental, Inc.
4600 West 60th Avenue
Arvada CO 80003

Rob Rebel
Project Number: NEP1047.01
Project: Noble - Lorenz F22-1

MW-3

5/11/2012 1:10:00PM

Analyte	Result	Reporting Limit	Units	Dilution	Batch	Prepared	Analyzed	Notes
---------	--------	--------------------	-------	----------	-------	----------	----------	-------

Origins Laboratory, Inc.
X205056-03 (Water)

BTEX by EPA 8260C

Benzene	ND	1.0	ug/L	1	2E14010	05/14/2012	05/15/2012
Toluene	ND	1.0	"	"	"	"	"
Ethylbenzene	ND	1.0	"	"	"	"	"
Xylenes, total	ND	1.0	"	"	"	"	"

Surrogate: 1,2-Dichloroethane-d4
Surrogate: Toluene-d8
Surrogate: 4-Bromofluorobenzene

109 %
92.7 %
83.1 %

70-130
70-130
70-130

"
"
"

Origins Laboratory, Inc.



The results in this report apply to the samples analyzed in accordance with the chain of custody document. This analytical report must be reproduced in its entirety.

Noelle E Doyle, President

LT Environmental, Inc.
4600 West 60th Avenue
Arvada CO 80003

Rob Rebel
Project Number: NEP1047.01
Project: Noble - Lorenz F22-1

MW-4

5/11/2012 1:15:00PM

Analyte	Result	Reporting		Units	Dilution	Batch	Prepared	Analyzed	Notes
		Limit							

Origins Laboratory, Inc.
X205056-04 (Water)

BTEX by EPA 8260C

Benzene	ND	1.0	ug/L	1	2E14010	05/14/2012	05/16/2012
Toluene	ND	1.0	"	"	"	"	"
Ethylbenzene	ND	1.0	"	"	"	"	"
Xylenes, total	ND	1.0	"	"	"	"	"

Surrogate: 1,2-Dichloroethane-d4	109 %	70-130			"	"	"
Surrogate: Toluene-d8	92.1 %	70-130			"	"	"
Surrogate: 4-Bromofluorobenzene	81.6 %	70-130			"	"	"

Origins Laboratory, Inc.



Noelle E Doyle, President

The results in this report apply to the samples analyzed in accordance with the chain of custody document. This analytical report must be reproduced in its entirety.

LT Environmental, Inc.
4600 West 60th Avenue
Arvada CO 80003

Rob Rebel
Project Number: NEP1047.01
Project: Noble - Lorenz F22-1

MW-5

5/11/2012 1:20:00PM

Analyte	Result	Reporting		Units	Dilution	Batch	Prepared	Analyzed	Notes
		Limit							

Origins Laboratory, Inc.
X205056-05 (Water)

BTEX by EPA 8260C

Benzene	ND	1.0	ug/L	1	2E14010	05/14/2012	05/16/2012
Toluene	ND	1.0	"	"	"	"	"
Ethylbenzene	ND	1.0	"	"	"	"	"
Xylenes, total	ND	1.0	"	"	"	"	"

Surrogate: 1,2-Dichloroethane-d4	110 %	70-130			"	"	"
Surrogate: Toluene-d8	91.7 %	70-130			"	"	"
Surrogate: 4-Bromofluorobenzene	84.4 %	70-130			"	"	"

Origins Laboratory, Inc.



Noelle E Doyle, President

The results in this report apply to the samples analyzed in accordance with the chain of custody document. This analytical report must be reproduced in its entirety.

LT Environmental, Inc.
4600 West 60th Avenue
Arvada CO 80003

Rob Rebel
Project Number: NEP1047.01
Project: Noble - Lorenz F22-1

MW-6

5/11/2012 1:25:00PM

Analyte	Result	Reporting		Units	Dilution	Batch	Prepared	Analyzed	Notes
		Limit							

Origins Laboratory, Inc.
X205056-06 (Water)

BTEX by EPA 8260C

Benzene	ND	1.0	ug/L	1	2E14010	05/14/2012	05/16/2012
Toluene	ND	1.0	"	"	"	"	"
Ethylbenzene	ND	1.0	"	"	"	"	"
Xylenes, total	ND	1.0	"	"	"	"	"

Surrogate: 1,2-Dichloroethane-d4	111 %	70-130	"	"	"
Surrogate: Toluene-d8	97.1 %	70-130	"	"	"
Surrogate: 4-Bromofluorobenzene	84.3 %	70-130	"	"	"

Origins Laboratory, Inc.



Noelle E Doyle, President

The results in this report apply to the samples analyzed in accordance with the chain of custody document. This analytical report must be reproduced in its entirety.

LT Environmental, Inc.

4600 West 60th Avenue

Arvada CO 80003

Rob Rebel

Project Number: NEP1047.01

Project: Noble - Lorenz F22-1

Volatile Organic Compounds by GC/MS SW846 8260C - Quality Control
Origins Laboratory, Inc.

Analyte	Result	Reporting Limit	Units	Spike Level	Source Result	%REC	%REC Limits	RPD	RPD Limit	Notes
---------	--------	-----------------	-------	-------------	---------------	------	-------------	-----	-----------	-------

Batch 2E14010 - EPA 5030B (Water)

Blank (2E14010-BLK1)

Prepared: 05/14/2012 Analyzed: 05/15/2012

Benzene	ND	1.0	ug/L							
Toluene	ND	1.0	"							
Ethylbenzene	ND	1.0	"							
Xylenes, total	ND	1.0	"							
Surrogate: 1,2-Dichloroethane-d4	60		"	62.5	95.6		70-130			
Surrogate: Toluene-d8	60		"	62.5	95.3		70-130			
Surrogate: 4-Bromofluorobenzene	52		"	62.5	83.1		70-130			

Origins Laboratory, Inc.



The results in this report apply to the samples analyzed in accordance with the chain of custody document. This analytical report must be reproduced in its entirety.

Noelle E Doyle, President

LT Environmental, Inc.
4600 West 60th Avenue
Arvada CO 80003

Rob Rebel
Project Number: NEP1047.01
Project: Noble - Lorenz F22-1

Volatile Organic Compounds by GC/MS SW846 8260C - Quality Control
Origins Laboratory, Inc.

Analyte	Result	Reporting Limit	Units	Spike Level	Source Result	%REC	%REC Limits	RPD	RPD Limit	Notes
---------	--------	-----------------	-------	-------------	---------------	------	-------------	-----	-----------	-------

Batch 2E14010 - EPA 5030B (Water)

LCS (2E14010-BS1)

Prepared: 05/14/2012 Analyzed: 05/15/2012

Benzene	102	1.0	ug/L	100	102	70-130
Toluene	97.9	1.0	"	100	97.9	70-130
Ethylbenzene	101	1.0	"	100	101	70-130
m,p-Xylene	219	2.0	"	200	109	70-130
o-Xylene	106	1.0	"	100	106	70-130
Surrogate: 1,2-Dichloroethane-d4	59		"	62.5	94.2	70-130
Surrogate: Toluene-d8	59		"	62.5	95.1	70-130
Surrogate: 4-Bromofluorobenzene	52		"	62.5	83.6	70-130

Origins Laboratory, Inc.



Noelle E Doyle, President

The results in this report apply to the samples analyzed in accordance with the chain of custody document. This analytical report must be reproduced in its entirety.

LT Environmental, Inc.
4600 West 60th Avenue
Arvada CO 80003

Rob Rebel
Project Number: NEP1047.01
Project: Noble - Lorenz F22-1

Volatile Organic Compounds by GC/MS SW846 8260C - Quality Control
Origins Laboratory, Inc.

Analyte	Result	Reporting Limit	Units	Spike Level	Source Result	%REC	%REC Limits	RPD	RPD Limit	Notes
---------	--------	-----------------	-------	-------------	---------------	------	-------------	-----	-----------	-------

Batch 2E14010 - EPA 5030B (Water)

Matrix Spike (2E14010-MS1)		Source: X205041-03			Prepared: 05/14/2012 Analyzed: 05/15/2012					
Benzene	112	1.0	ug/L	100	ND	112	70-130			
Toluene	106	1.0	"	100	ND	106	70-130			
Ethylbenzene	110	1.0	"	100	ND	110	70-130			
m,p-Xylene	234	2.0	"	200	ND	117	70-130			
o-Xylene	113	1.0	"	100	ND	113	70-130			
Surrogate: 1,2-Dichloroethane-d4	60		"	62.5		95.6	70-130			
Surrogate: Toluene-d8	60		"	62.5		96.0	70-130			
Surrogate: 4-Bromofluorobenzene	54		"	62.5		85.7	70-130			

Origins Laboratory, Inc.



Noelle E Doyle, President

The results in this report apply to the samples analyzed in accordance with the chain of custody document. This analytical report must be reproduced in its entirety.

LT Environmental, Inc.
4600 West 60th Avenue
Arvada CO 80003

Rob Rebel
Project Number: NEP1047.01
Project: Noble - Lorenz F22-1

Volatile Organic Compounds by GC/MS SW846 8260C - Quality Control
Origins Laboratory, Inc.

Analyte	Result	Reporting Limit	Units	Spike Level	Source Result	%REC	%REC Limits	RPD	RPD Limit	Notes
---------	--------	-----------------	-------	-------------	---------------	------	-------------	-----	-----------	-------

Batch 2E14010 - EPA 5030B (Water)

Matrix Spike Dup (2E14010-MSD1)		Source: X205041-03			Prepared: 05/14/2012 Analyzed: 05/15/2012					
Benzene	109	1.0	ug/L	100	ND	109	70-130	3.33	20	
Toluene	102	1.0	"	100	ND	102	70-130	3.36	20	
Ethylbenzene	106	1.0	"	100	ND	106	70-130	3.19	20	
m,p-Xylene	222	2.0	"	200	ND	111	70-130	4.89	20	
o-Xylene	109	1.0	"	100	ND	109	70-130	4.15	20	
Surrogate: 1,2-Dichloroethane-d4	59		"	62.5		94.1	70-130			
Surrogate: Toluene-d8	60		"	62.5		95.5	70-130			
Surrogate: 4-Bromofluorobenzene	53		"	62.5		85.1	70-130			

Origins Laboratory, Inc.



The results in this report apply to the samples analyzed in accordance with the chain of custody document. This analytical report must be reproduced in its entirety.

Noelle E Doyle, President

LT Environmental, Inc.

4600 West 60th Avenue

Arvada CO 80003

Rob Rebel

Project Number: NEP1047.01

Project: Noble - Lorenz F22-1

Notes and Definitions

ND Analyte NOT DETECTED at or above the reporting limit

RPD Relative Percent Difference

Origins Laboratory, Inc.



The results in this report apply to the samples analyzed in accordance with the chain of custody document. This analytical report must be reproduced in its entirety.

Noelle E Doyle, President