

## LOCATION DRAWING B&B FARMS 1-19H

SECTION 19, TOWNSHIP 11 SOUTH, RANGE 44 WEST OF THE 6TH PRINCIPAL MERIDIAN

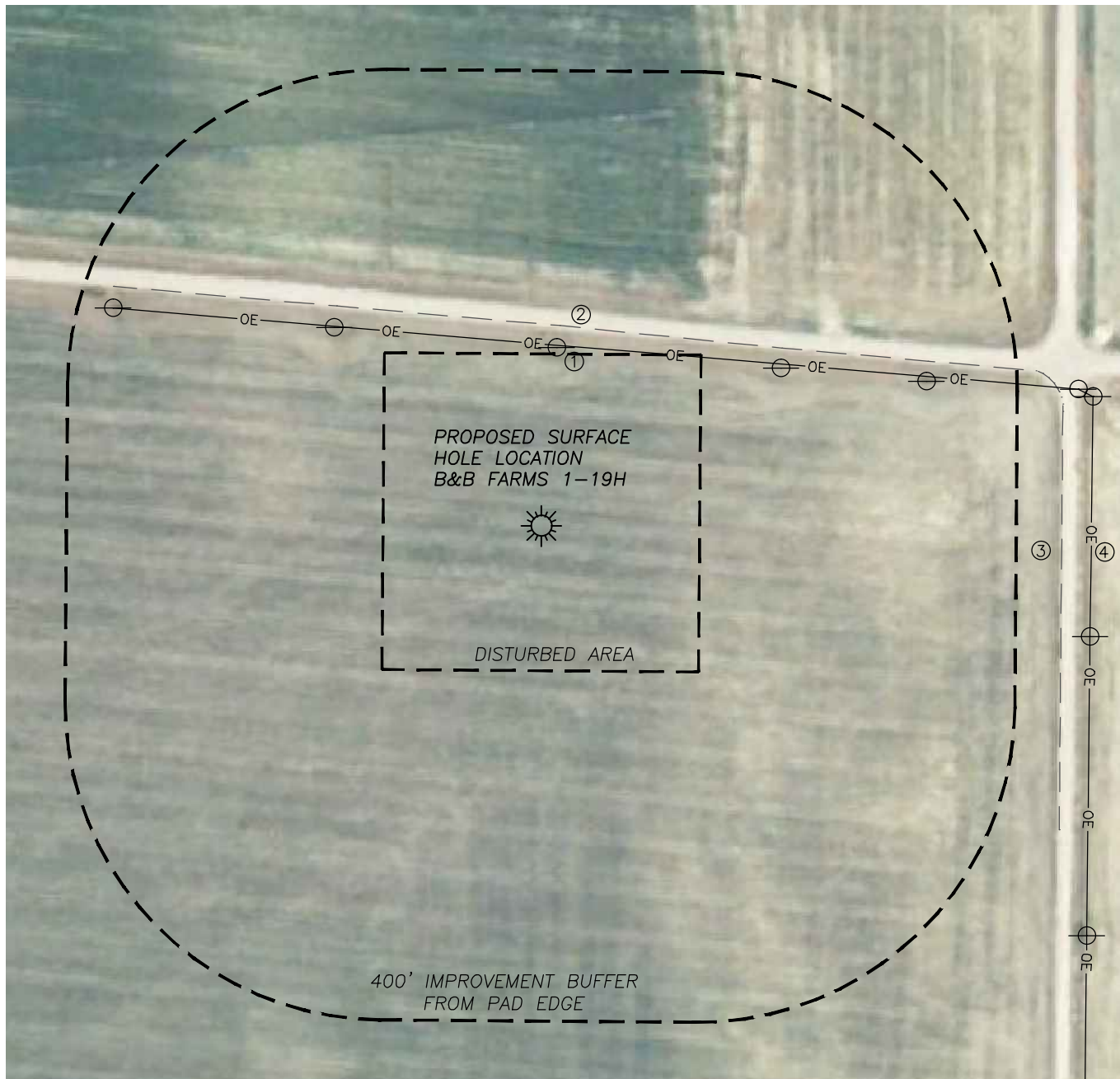

### IMPROVEMENTS

- |                       |         |
|-----------------------|---------|
| 1. O.H. UTILITY:      | 226'± N |
| 2. S EDGE CO. RD. D:  | 254'± N |
| 3. W EDGE CO. RD. 43: | 657'± E |
| 4. O.H. UTILITY:      | 694'± E |

O.H. UTILITY TO NORTH: CLEARANCE=22'±

### DISTANCE TO NEAREST:

- |                     |          |
|---------------------|----------|
| BUILDING:           | 1445'± N |
| PUBLIC ROAD:        | 254'± N  |
| ABOVE GRND UTILITY: | 226'± N  |
| RAILROAD:           | 5280'±   |
| PROP. LINE:         | 260'± N  |

