



Physical Address: 345 Comanche St.
Mail to: Box 384 Kiowa, CO 80117
Ph. 303-621-8672 - Fax 303-621-2717
www.highprairiesurvey.com

Job # 12097-John Craig 6-2
Rev: 5-29-12

Inv # 1944

High Prairie Surveying of Kiowa, Colorado has in accordance with a request from **Nighthawk Production LLC**, has determined the location of **John Craig 6-2** to be 2038 feet FNL, and 2267 feet FWL, (90° off Section lines) of SECTION 2, Township 10s, Range 56w of the 6th Principal Meridian, **Lincoln County**, Colorado.

Date: Staked on 5/29/12 drawn on 5/29/12.

Re: Staked by Keith Westfall
Drawn: Drawn by Elijah Frane

1000' Hydrology Map



There is a pond approx. 594'
South and a windmill approx.
612' South of proposed well pad.

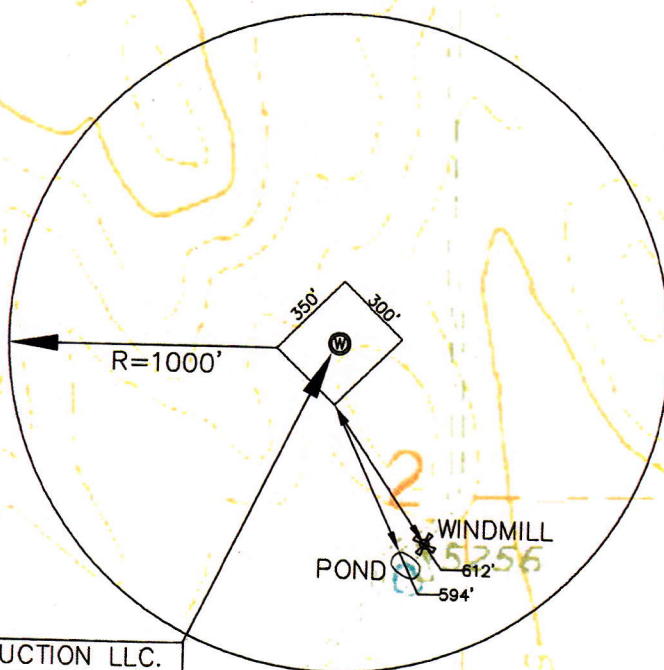

NIGHTHAWK PRODUCTION LLC.
NW 1/4 SEC. 2-10-56W
JOHN CRAIG 6-2
LINCOLN, Co. COLORADO