

KERR-MCGEE OIL & GAS ONSHORE LP

Location: COLORADO Slot: SLOT#23 RATTLER 29N-34HZ (200'FSL & 1927'FWL, SEC.34)
 Field: WELD COUNTY (KERR MCGEE) Well: RATTLER 29N-34HZ
 Facility: SEC.34-T3N-R66W Wellbore: RATTLER 29N-34HZ PWB

Plot reference wellpath is RATTLER 29N-34HZ (REV-B.0) PWP	
True vertical depths are referenced to ENSIGN 145 (RKB)	Grid System: NAD83 / Lambert Colorado SP, Northern Zone (501), US feet
Measured depths are referenced to ENSIGN 145 (RKB)	North Reference: True north
ENSIGN 145 (RKB) to Mean Sea Level: 5003 feet	Scale: True distance
Mean Sea Level to Mud line (At Slot: SLOT#23 RATTLER 29N-34HZ (200'FSL & 1927'FWL, SEC.34)): 0 feet	Depths are in feet
Coordinates are in feet referenced to Slot	Created by: wilsje02 on 5/29/2012

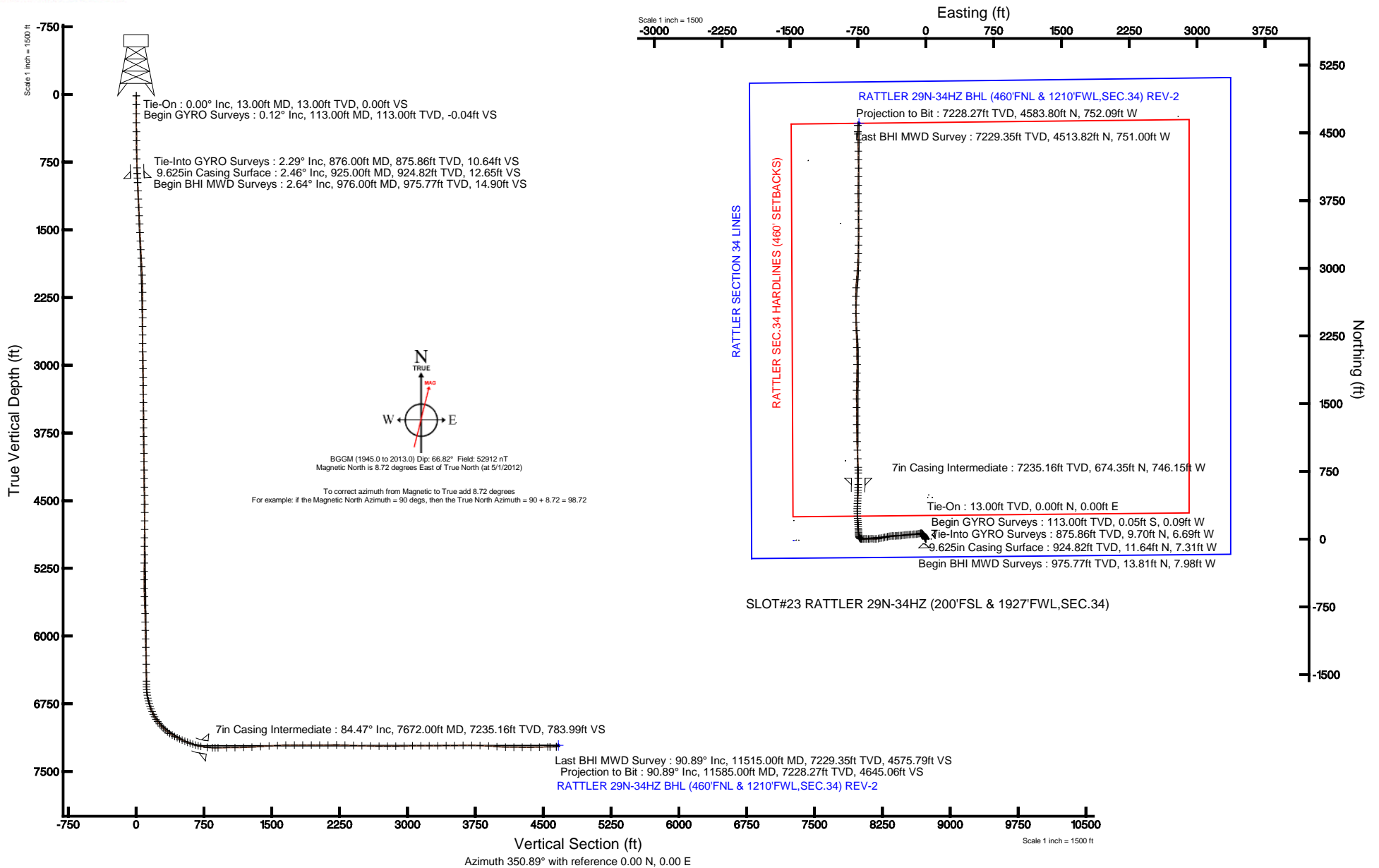

SLOT#23 RATTLER 29N-34HZ (200'FSL & 1927'FWL, SEC.34)



Actual Wellpath Report

RATTLER 29N-34HZ AWP

Page 1 of 7



REFERENCE WELLPATH IDENTIFICATION			
Operator	KERR-MCGEE OIL & GAS ONSHORE LP	Slot	SLOT#23 RATTLER 29N-34HZ (200'FSL & 1927'FWL,SEC.34)
Area	COLORADO	Well	RATTLER 29N-34HZ
Field	WELD COUNTY (KERR MCGEE)	Wellbore	RATTLER 29N-34HZ AWB
Facility	SEC.34-T3N-R66W		

REPORT SETUP INFORMATION			
Projection System	NAD83 / Lambert Colorado SP, Northern Zone (501), US feet	Software System	WellArchitect® 3.0.2
North Reference	True	User	Wilsjef02
Scale	0.999958	Report Generated	5/29/2012 at 08:55:49
Convergence at slot	0.47° East	Database/Source file	WellArchitectDB/RATTLER_29N-34HZ_AWB.xml

WELLPATH LOCATION						
	Local coordinates		Grid coordinates		Geographic coordinates	
	North[ft]	East[ft]	Easting[US ft]	Northing[US ft]	Latitude	Longitude
Slot Location	-1723.50	1274.82	3205148.22	1307415.09	40°10'29.708"N	104°45'57.017"W
Facility Reference Pt			3203859.31	1309127.97	40°10'46.740"N	104°46'13.440"W
Field Reference Pt			3197771.84	1268891.29	40°04'09.600"N	104°47'36.000"W

WELLPATH DATUM			
Calculation method	Minimum curvature	ENSIGN 145 (RKB) to Facility Vertical Datum	5003.00ft
Horizontal Reference Pt	Slot	ENSIGN 145 (RKB) to Mean Sea Level	5003.00ft
Vertical Reference Pt	ENSIGN 145 (RKB)	ENSIGN 145 (RKB) to Mud Line at Slot (SLOT#23 RATTLER 29N-34HZ (200'FSL & 1927'FWL,SEC.34))	5003.00ft
MD Reference Pt	ENSIGN 145 (RKB)	Section Origin	N 0.00, E 0.00 ft
Field Vertical Reference	Mean Sea Level	Section Azimuth	350.68°



Actual Wellpath Report

RATTLER 29N-34HZ AWP

Page 2 of 7



REFERENCE WELLPATH IDENTIFICATION				
Operator	KERR-MCGEE OIL & GAS ONSHORE LP		Slot	SLOT#23 RATTLER 29N-34HZ (200'FSL & 1927'FWL,SEC.34)
Area	COLORADO		Well	RATTLER 29N-34HZ
Field	WELD COUNTY (KERR MCGEE)		Wellbore	RATTLER 29N-34HZ AWB
Facility	SEC.34-T3N-R66W			

WELLPATH DATA (149 stations) † = interpolated/extrapolated station										
MD [ft]	Inclination [°]	Azimuth [°]	TVD [ft]	Vert Sect [ft]	North [ft]	East [ft]	Latitude	Longitude	DLS [°/100ft]	Comments
0.00†	0.000	239.850	0.00	0.00	0.00	0.00	40°10'29.708"N	104°45'57.017"W	0.00	
13.00	0.000	239.850	13.00	0.00	0.00	0.00	40°10'29.708"N	104°45'57.017"W	0.00	Tie-On
113.00	0.120	239.850	113.00	-0.04	-0.05	-0.09	40°10'29.707"N	104°45'57.018"W	0.12	Begin GYRO Surveys
213.00	0.410	338.600	213.00	0.28	0.23	-0.31	40°10'29.710"N	104°45'57.021"W	0.44	
313.00	0.390	297.160	313.00	0.83	0.72	-0.75	40°10'29.715"N	104°45'57.027"W	0.28	
413.00	0.670	289.320	412.99	1.31	1.07	-1.60	40°10'29.719"N	104°45'57.038"W	0.29	
513.00	0.630	328.790	512.99	2.10	1.73	-2.44	40°10'29.725"N	104°45'57.048"W	0.44	
613.00	1.170	319.990	612.97	3.49	2.98	-3.38	40°10'29.737"N	104°45'57.061"W	0.56	
713.00	1.500	339.540	712.95	5.65	4.99	-4.49	40°10'29.757"N	104°45'57.075"W	0.56	
813.00	1.870	329.480	812.90	8.46	7.62	-5.78	40°10'29.783"N	104°45'57.091"W	0.47	
876.00	2.290	341.990	875.86	10.66	9.70	-6.69	40°10'29.804"N	104°45'57.103"W	0.98	Tie-Into GYRO Surveys
976.00	2.640	342.950	975.77	14.92	13.81	-7.98	40°10'29.844"N	104°45'57.120"W	0.35	Begin BHI MWD Surveys
1067.00	2.580	332.550	1066.68	18.94	17.63	-9.54	40°10'29.882"N	104°45'57.140"W	0.52	
1159.00	2.850	335.340	1158.57	23.11	21.54	-11.45	40°10'29.921"N	104°45'57.164"W	0.33	
1251.00	2.680	334.520	1250.47	27.38	25.56	-13.33	40°10'29.961"N	104°45'57.189"W	0.19	
1343.00	3.100	328.680	1342.35	31.76	29.63	-15.55	40°10'30.001"N	104°45'57.217"W	0.56	
1435.00	2.950	331.940	1434.22	36.30	33.84	-17.95	40°10'30.042"N	104°45'57.248"W	0.25	
1530.00	3.030	328.380	1529.09	40.94	38.14	-20.42	40°10'30.085"N	104°45'57.280"W	0.21	
1625.00	3.120	322.130	1623.95	45.54	42.32	-23.32	40°10'30.126"N	104°45'57.317"W	0.37	
1720.00	3.340	317.530	1718.80	50.12	46.40	-26.78	40°10'30.167"N	104°45'57.362"W	0.36	
1815.00	3.650	316.810	1813.63	54.95	50.65	-30.72	40°10'30.208"N	104°45'57.413"W	0.33	
1909.00	3.660	313.180	1907.44	59.82	54.88	-34.95	40°10'30.250"N	104°45'57.467"W	0.25	
2004.00	3.100	310.130	2002.27	64.17	58.61	-39.13	40°10'30.287"N	104°45'57.521"W	0.62	
2099.00	2.990	310.790	2097.14	68.03	61.89	-42.97	40°10'30.320"N	104°45'57.571"W	0.12	
2194.00	2.470	260.270	2192.04	69.91	63.16	-46.86	40°10'30.332"N	104°45'57.621"W	2.50	
2289.00	3.210	268.810	2286.92	70.27	62.76	-51.54	40°10'30.328"N	104°45'57.681"W	0.90	
2384.00	4.600	264.430	2381.70	70.90	62.33	-57.99	40°10'30.324"N	104°45'57.764"W	1.50	
2478.00	5.970	260.170	2475.30	71.10	61.13	-66.56	40°10'30.312"N	104°45'57.874"W	1.52	
2573.00	6.710	256.710	2569.72	70.67	59.01	-76.83	40°10'30.291"N	104°45'58.007"W	0.88	
2668.00	8.140	255.720	2663.92	69.71	56.08	-88.75	40°10'30.262"N	104°45'58.160"W	1.51	
2763.00	8.460	265.080	2757.93	69.66	53.82	-102.23	40°10'30.240"N	104°45'58.334"W	1.46	
2858.00	9.510	267.990	2851.76	71.20	52.94	-117.03	40°10'30.231"N	104°45'58.525"W	1.20	
2953.00	9.690	266.480	2945.43	73.00	52.18	-132.86	40°10'30.224"N	104°45'58.729"W	0.33	
3047.00	9.730	266.760	3038.09	74.64	51.24	-148.68	40°10'30.214"N	104°45'58.932"W	0.07	
3142.00	9.340	266.630	3131.77	76.29	50.34	-164.40	40°10'30.205"N	104°45'59.135"W	0.41	
3237.00	9.190	265.550	3225.53	77.73	49.30	-179.65	40°10'30.195"N	104°45'59.331"W	0.24	
3332.00	8.780	262.730	3319.37	78.64	47.79	-194.41	40°10'30.180"N	104°45'59.522"W	0.63	
3426.00	9.510	265.050	3412.17	79.48	46.21	-209.26	40°10'30.165"N	104°45'59.713"W	0.87	
3521.00	8.430	260.390	3506.01	80.05	44.37	-223.95	40°10'30.146"N	104°45'59.902"W	1.37	
3616.00	9.030	260.480	3599.91	79.98	41.98	-238.17	40°10'30.123"N	104°46'00.085"W	0.63	
3711.00	9.700	265.640	3693.64	80.65	40.13	-253.50	40°10'30.105"N	104°46'00.283"W	1.13	
3806.00	8.860	261.800	3787.40	81.48	38.48	-268.72	40°10'30.088"N	104°46'00.479"W	1.10	
3901.00	8.270	270.200	3881.35	82.76	37.46	-282.80	40°10'30.078"N	104°46'00.660"W	1.45	
3996.00	8.720	269.510	3975.30	84.99	37.43	-296.83	40°10'30.078"N	104°46'00.841"W	0.49	
4091.00	9.010	264.550	4069.17	86.60	36.66	-311.44	40°10'30.070"N	104°46'01.029"W	0.86	



Actual Wellpath Report

RATTLER 29N-34HZ AWP

Page 3 of 7



REFERENCE WELLPATH IDENTIFICATION

Operator	KERR-MCGEE OIL & GAS ONSHORE LP	Slot	SLOT#23 RATTLER 29N-34HZ (200'FSL & 1927'FWL,SEC.34)
Area	COLORADO	Well	RATTLER 29N-34HZ
Field	WELD COUNTY (KERR MCGEE)	Wellbore	RATTLER 29N-34HZ AWB
Facility	SEC.34-T3N-R66W		

WELLPATH DATA (149 stations)

MD [ft]	Inclination [°]	Azimuth [°]	TVD [ft]	Vert Sect [ft]	North [ft]	East [ft]	Latitude	Longitude	DLS [°/100ft]	Comments
4185.00	7.250	266.670	4162.22	87.71	35.61	-324.68	40°10'30.060"N	104°46'01.200"W	1.90	
4280.00	8.110	262.960	4256.37	88.60	34.44	-337.32	40°10'30.048"N	104°46'01.363"W	1.04	
4375.00	8.200	273.510	4350.41	90.38	34.04	-350.73	40°10'30.044"N	104°46'01.535"W	1.58	
4470.00	9.760	272.550	4444.25	93.54	34.81	-365.54	40°10'30.052"N	104°46'01.726"W	1.65	
4565.00	9.720	259.940	4537.89	95.09	33.77	-381.48	40°10'30.042"N	104°46'01.931"W	2.24	
4659.00	9.250	258.480	4630.60	94.69	30.87	-396.70	40°10'30.013"N	104°46'02.128"W	0.56	
4754.00	8.920	258.770	4724.41	94.16	27.91	-411.40	40°10'29.984"N	104°46'02.317"W	0.35	
4849.00	8.340	255.160	4818.34	93.25	24.71	-425.29	40°10'29.952"N	104°46'02.496"W	0.84	
4944.00	8.960	256.380	4912.25	92.03	21.21	-439.14	40°10'29.918"N	104°46'02.674"W	0.68	
5039.00	10.520	259.880	5005.88	91.35	17.94	-454.87	40°10'29.885"N	104°46'02.877"W	1.76	
5134.00	10.310	258.170	5099.32	90.86	14.67	-471.73	40°10'29.853"N	104°46'03.094"W	0.39	
5229.00	10.360	259.380	5192.78	90.29	11.36	-488.44	40°10'29.820"N	104°46'03.309"W	0.23	
5323.00	11.220	258.530	5285.11	89.76	7.98	-505.71	40°10'29.787"N	104°46'03.532"W	0.93	
5418.00	10.600	259.910	5378.40	89.29	4.61	-523.37	40°10'29.754"N	104°46'03.759"W	0.71	
5513.00	11.600	263.780	5471.62	89.69	2.05	-541.47	40°10'29.728"N	104°46'03.993"W	1.31	
5608.00	10.500	270.010	5564.86	91.61	1.01	-559.62	40°10'29.718"N	104°46'04.226"W	1.71	
5703.00	9.820	273.940	5658.37	94.87	1.57	-576.36	40°10'29.723"N	104°46'04.442"W	1.02	
5798.00	9.290	274.340	5752.05	98.54	2.71	-592.09	40°10'29.735"N	104°46'04.645"W	0.56	
5893.00	8.410	265.160	5845.93	100.89	2.70	-606.66	40°10'29.735"N	104°46'04.832"W	1.75	
5987.00	8.690	264.020	5938.88	101.84	1.38	-620.57	40°10'29.722"N	104°46'05.012"W	0.35	
6082.00	8.780	272.680	6032.78	103.77	0.97	-634.95	40°10'29.718"N	104°46'05.197"W	1.39	
6177.00	8.170	273.710	6126.75	106.80	1.75	-648.93	40°10'29.725"N	104°46'05.377"W	0.66	
6272.00	8.430	270.690	6220.75	109.53	2.27	-662.63	40°10'29.730"N	104°46'05.553"W	0.53	
6367.00	8.610	267.090	6314.70	111.53	1.99	-676.70	40°10'29.728"N	104°46'05.735"W	0.59	
6461.00	8.090	267.100	6407.71	113.06	1.30	-690.33	40°10'29.721"N	104°46'05.910"W	0.55	
6556.00	8.350	266.430	6501.73	114.49	0.53	-703.89	40°10'29.713"N	104°46'06.085"W	0.29	
6588.00	8.350	266.050	6533.39	114.94	0.23	-708.53	40°10'29.710"N	104°46'06.145"W	0.17	
6619.00	8.360	270.700	6564.06	115.55	0.10	-713.03	40°10'29.709"N	104°46'06.203"W	2.18	
6651.00	9.100	283.740	6595.69	116.94	0.73	-717.81	40°10'29.715"N	104°46'06.264"W	6.59	
6683.00	10.750	300.340	6627.22	119.84	2.84	-722.85	40°10'29.736"N	104°46'06.329"W	10.27	
6714.00	12.540	314.700	6657.59	124.41	6.67	-727.73	40°10'29.774"N	104°46'06.392"W	10.95	
6746.00	14.130	324.140	6688.73	130.72	12.28	-732.49	40°10'29.829"N	104°46'06.453"W	8.41	
6777.00	14.850	335.230	6718.75	137.93	18.95	-736.37	40°10'29.895"N	104°46'06.503"W	9.23	
6809.00	15.530	343.340	6749.63	146.13	26.78	-739.32	40°10'29.973"N	104°46'06.541"W	6.97	
6841.00	17.750	349.440	6780.29	155.26	35.68	-741.44	40°10'30.061"N	104°46'06.569"W	8.82	
6872.00	20.430	356.030	6809.59	165.37	45.73	-742.68	40°10'30.160"N	104°46'06.585"W	11.08	
6904.00	22.900	358.930	6839.33	177.10	57.53	-743.19	40°10'30.276"N	104°46'06.591"W	8.41	
6936.00	25.690	358.460	6868.49	190.14	70.69	-743.49	40°10'30.406"N	104°46'06.595"W	8.74	
6967.00	28.970	357.820	6896.03	204.25	84.91	-743.96	40°10'30.547"N	104°46'06.601"W	10.62	
6999.00	32.260	357.500	6923.56	220.42	101.19	-744.62	40°10'30.708"N	104°46'06.610"W	10.29	
7031.00	35.730	356.770	6950.09	238.20	119.06	-745.52	40°10'30.884"N	104°46'06.621"W	10.92	
7062.00	39.260	356.250	6974.68	256.97	137.89	-746.67	40°10'31.071"N	104°46'06.636"W	11.43	
7094.00	42.070	355.960	6998.95	277.72	158.69	-748.09	40°10'31.276"N	104°46'06.654"W	8.80	
7125.00	45.330	355.280	7021.36	299.06	180.04	-749.73	40°10'31.487"N	104°46'06.676"W	10.62	
7157.00	49.170	355.210	7043.08	322.48	203.46	-751.68	40°10'31.718"N	104°46'06.701"W	12.00	



Actual Wellpath Report

RATTLER 29N-34HZ AWP

Page 4 of 7



REFERENCE WELLPATH IDENTIFICATION

Operator	KERR-MCGEE OIL & GAS ONSHORE LP	Slot	SLOT#23 RATTLER 29N-34HZ (200'FSL & 1927'FWL,SEC.34)
Area	COLORADO	Well	RATTLER 29N-34HZ
Field	WELD COUNTY (KERR MCGEE)	Wellbore	RATTLER 29N-34HZ AWB
Facility	SEC.34-T3N-R66W		

WELLPATH DATA (149 stations) † = interpolated/extrapolated station

MD [ft]	Inclination [°]	Azimuth [°]	TVD [ft]	Vert Sect [ft]	North [ft]	East [ft]	Latitude	Longitude	DLS [°/100ft]	Comments
7189.00	52.800	355.180	7063.22	347.26	228.23	-753.76	40°10'31.963"N	104°46'06.727"W	11.34	
7220.00	56.330	356.160	7081.19	372.42	253.41	-755.66	40°10'32.212"N	104°46'06.752"W	11.67	
7252.00	59.470	357.740	7098.19	399.36	280.48	-757.10	40°10'32.480"N	104°46'06.771"W	10.67	
7284.00	62.570	359.380	7113.70	427.08	308.45	-757.80	40°10'32.756"N	104°46'06.779"W	10.67	
7315.00	64.100	2.050	7127.61	454.35	336.15	-757.45	40°10'33.030"N	104°46'06.775"W	9.14	
7347.00	64.910	2.650	7141.38	482.64	365.01	-756.26	40°10'33.315"N	104°46'06.760"W	3.04	
7378.00	66.030	2.470	7154.25	510.24	393.18	-755.00	40°10'33.593"N	104°46'06.744"W	3.65	
7410.00	67.670	2.500	7166.83	539.04	422.58	-753.73	40°10'33.884"N	104°46'06.727"W	5.13	
7442.00	69.360	3.050	7178.55	568.15	452.32	-752.29	40°10'34.178"N	104°46'06.709"W	5.52	
7473.00	70.000	2.840	7189.32	596.56	481.35	-750.79	40°10'34.465"N	104°46'06.689"W	2.16	
7505.00	71.340	2.220	7199.91	626.11	511.52	-749.46	40°10'34.763"N	104°46'06.672"W	4.57	
7537.00	73.790	1.290	7209.50	656.07	542.03	-748.53	40°10'35.064"N	104°46'06.660"W	8.14	
7568.00	76.200	1.560	7217.52	685.49	571.96	-747.78	40°10'35.360"N	104°46'06.651"W	7.82	
7600.00	78.530	1.280	7224.52	716.16	603.17	-747.01	40°10'35.668"N	104°46'06.641"W	7.33	
7672.00†	84.472	0.107	7235.16	786.26	674.35	-746.15	40°10'36.372"N	104°46'06.630"W	8.41	7" Casing Point
7730.00	89.260	359.180	7238.33	843.45	732.24	-746.51	40°10'36.944"N	104°46'06.634"W	8.41	
7761.00	89.750	358.640	7238.60	874.13	763.23	-747.10	40°10'37.250"N	104°46'06.642"W	2.35	
7793.00	90.180	358.440	7238.62	905.83	795.22	-747.92	40°10'37.566"N	104°46'06.652"W	1.48	
7888.00	90.300	357.130	7238.22	1000.09	890.15	-751.59	40°10'38.504"N	104°46'06.700"W	1.38	
7982.00	91.100	357.150	7237.07	1093.49	984.02	-756.28	40°10'39.432"N	104°46'06.760"W	0.85	
8077.00	90.920	357.890	7235.40	1187.80	1078.92	-760.39	40°10'40.370"N	104°46'06.813"W	0.80	
8172.00	93.500	359.520	7231.73	1281.79	1173.81	-762.54	40°10'41.308"N	104°46'06.841"W	3.21	
8267.00	93.410	359.810	7226.01	1375.45	1268.64	-763.09	40°10'42.245"N	104°46'06.848"W	0.32	
8362.00	93.770	359.160	7220.06	1469.15	1363.45	-763.94	40°10'43.182"N	104°46'06.859"W	0.78	
8456.00	93.720	359.750	7213.92	1561.85	1457.24	-764.83	40°10'44.108"N	104°46'06.871"W	0.63	
8551.00	91.040	359.610	7209.97	1655.59	1552.15	-765.37	40°10'45.046"N	104°46'06.877"W	2.82	
8646.00	89.900	0.970	7209.20	1749.25	1647.14	-764.88	40°10'45.985"N	104°46'06.871"W	1.87	
8741.00	90.210	1.050	7209.10	1842.71	1742.13	-763.21	40°10'46.924"N	104°46'06.850"W	0.34	
8836.00	89.660	1.420	7209.21	1936.11	1837.10	-761.16	40°10'47.862"N	104°46'06.823"W	0.70	
8931.00	90.030	0.170	7209.47	2029.63	1932.09	-759.84	40°10'48.801"N	104°46'06.807"W	1.37	
9025.00	90.890	358.740	7208.71	2122.52	2026.08	-760.74	40°10'49.730"N	104°46'06.818"W	1.78	
9119.00	89.930	359.030	7208.04	2215.56	2120.06	-762.57	40°10'50.658"N	104°46'06.842"W	1.07	
9214.00	88.180	357.890	7209.61	2309.66	2215.01	-765.12	40°10'51.597"N	104°46'06.875"W	2.20	
9308.00	87.340	357.270	7213.28	2402.91	2308.85	-769.09	40°10'52.524"N	104°46'06.926"W	1.11	
9403.00	87.960	359.200	7217.18	2497.00	2403.72	-772.01	40°10'53.462"N	104°46'06.963"W	2.13	
9498.00	88.520	358.810	7220.10	2590.96	2498.66	-773.66	40°10'54.400"N	104°46'06.985"W	0.72	
9593.00	89.410	359.620	7221.81	2684.89	2593.64	-774.96	40°10'55.338"N	104°46'07.002"W	1.27	
9688.00	90.760	1.470	7221.67	2778.48	2688.63	-774.05	40°10'56.277"N	104°46'06.990"W	2.41	
9783.00	89.380	2.320	7221.55	2871.66	2783.57	-770.91	40°10'57.215"N	104°46'06.949"W	1.71	
9877.00	91.780	5.260	7220.60	2963.19	2877.34	-764.70	40°10'58.142"N	104°46'06.869"W	4.04	
9972.00	92.030	3.700	7217.44	3055.40	2972.00	-757.29	40°10'59.077"N	104°46'06.774"W	1.66	
10067.00	89.350	3.170	7216.30	3148.04	3066.81	-751.59	40°11'00.014"N	104°46'06.701"W	2.88	
10162.00	90.090	2.330	7216.77	3240.93	3161.70	-747.04	40°11'00.952"N	104°46'06.642"W	1.18	
10257.00	90.640	0.950	7216.16	3334.20	3256.66	-744.32	40°11'01.890"N	104°46'06.607"W	1.56	
10352.00	90.830	1.690	7214.94	3427.56	3351.62	-742.13	40°11'02.829"N	104°46'06.579"W	0.80	



Actual Wellpath Report

RATTLER 29N-34HZ AWP

Page 5 of 7



REFERENCE WELLPATH IDENTIFICATION				
Operator	KERR-MCGEE OIL & GAS ONSHORE LP		Slot	SLOT#23 RATTLER 29N-34HZ (200'FSL & 1927'FWL,SEC.34)
Area	COLORADO		Well	RATTLER 29N-34HZ
Field	WELD COUNTY (KERR MCGEE)		Wellbore	RATTLER 29N-34HZ AWB
Facility	SEC.34-T3N-R66W			

WELLPATH DATA (149 stations)										
MD [ft]	Inclination [°]	Azimuth [°]	TVD [ft]	Vert Sect [ft]	North [ft]	East [ft]	Latitude	Longitude	DLS [°/100ft]	Comments
10446.00	90.700	359.580	7213.69	3520.13	3445.60	-741.09	40°11'03.757"N	104°46'06.565"W	2.25	
10541.00	90.890	358.490	7212.37	3614.11	3540.58	-742.69	40°11'04.696"N	104°46'06.586"W	1.16	
10636.00	88.980	358.850	7212.48	3708.18	3635.55	-744.89	40°11'05.634"N	104°46'06.615"W	2.05	
10731.00	88.000	358.500	7214.98	3802.23	3730.49	-747.09	40°11'06.573"N	104°46'06.643"W	1.10	
10826.00	86.280	0.140	7219.72	3896.03	3825.36	-748.22	40°11'07.510"N	104°46'06.657"W	2.50	
10921.00	85.680	0.990	7226.38	3989.39	3920.12	-747.28	40°11'08.447"N	104°46'06.645"W	1.09	
11016.00	88.060	1.240	7231.57	4082.67	4014.95	-745.44	40°11'09.384"N	104°46'06.622"W	2.52	
11111.00	90.240	359.970	7232.98	4176.23	4109.93	-744.43	40°11'10.322"N	104°46'06.609"W	2.66	
11205.00	89.290	359.000	7233.36	4269.12	4203.92	-745.28	40°11'11.251"N	104°46'06.620"W	1.44	
11300.00	90.460	358.800	7233.57	4363.14	4298.90	-747.10	40°11'12.190"N	104°46'06.643"W	1.25	
11395.00	91.380	359.110	7232.04	4457.14	4393.87	-748.83	40°11'13.128"N	104°46'06.666"W	1.02	
11490.00	91.290	358.820	7229.83	4551.12	4488.83	-750.55	40°11'14.067"N	104°46'06.688"W	0.32	
11515.00	90.890	359.110	7229.35	4575.86	4513.82	-751.00	40°11'14.314"N	104°46'06.694"W	1.98	Last BHI MWD Survey
11585.00	90.890	359.110	7228.27	4645.09	4583.80	-752.09	40°11'15.005"N	104°46'06.708"W	0.00	Projection to Bit

HOLE & CASING SECTIONS - Ref Wellbore: RATTLER 29N-34HZ AWB Ref Wellpath: RATTLER 29N-34HZ AWP									
String/Diameter	Start MD [ft]	End MD [ft]	Interval [ft]	Start TVD [ft]	End TVD [ft]	Start N/S [ft]	Start E/W [ft]	End N/S [ft]	End E/W [ft]
12.25in Open Hole	13.00	925.00	912.00	13.00	924.82	0.00	0.00	11.64	-7.31
9.625in Casing Surface	13.00	925.00	912.00	13.00	924.82	0.00	0.00	11.64	-7.31
8.75in Open Hole	925.00	7721.00	6796.00	924.82	7238.16	11.64	-7.31	723.24	-746.40
7in Casing Intermediate	13.00	7672.00	7659.00	13.00	7235.16	0.00	0.00	674.35	-746.15
6.125in Open Hole	7672.00	11585.00	3913.00	7235.16	7228.27	674.35	-746.15	4583.80	-752.09



Actual Wellpath Report

RATTLER 29N-34HZ AWP

Page 6 of 7



REFERENCE WELLPATH IDENTIFICATION			
Operator	KERR-MCGEE OIL & GAS ONSHORE LP	Slot	SLOT#23 RATTLER 29N-34HZ (200'FSL & 1927'FWL,SEC.34)
Area	COLORADO	Well	RATTLER 29N-34HZ
Field	WELD COUNTY (KERR MCGEE)	Wellbore	RATTLER 29N-34HZ AWB
Facility	SEC.34-T3N-R66W		

TARGETS									
Name	MD [ft]	TVD [ft]	North [ft]	East [ft]	Grid East [US ft]	Grid North [US ft]	Latitude	Longitude	Shape
RATTLER SECTION 34 LINES		19.00	-13.72	-1463.45	3203684.99	1307389.26	40°10'29.572"N	104°46'15.870"W	polygon
RATTLER 29N-34HZ BHL (460'FNL & 1210'FWL,SEC.34) REV-2		7213.00	4608.08	-738.98	3204371.14	1312016.69	40°11'15.245"N	104°46'06.539"W	point
RATTLER 29N-34HZ BHL ON PLAT (460'FNL & 1360'FWL,SEC.34) REV-1		7213.00	4608.08	-588.98	3204521.13	1312017.93	40°11'15.245"N	104°46'04.606"W	point
RATTLER SEC.34 HARDLINES (460' SETBACKS)		7219.00	-13.72	-1463.45	3203684.99	1307389.26	40°10'29.572"N	104°46'15.870"W	polygon

WELLPATH COMPOSITION - Ref Wellbore: RATTLER 29N-34HZ AWB Ref Wellpath: RATTLER 29N-34HZ AWP				
Start MD [ft]	End MD [ft]	Positional Uncertainty Model	Log Name/Comment	Wellbore
13.00	876.00	Generic gyro - continuous (Standard)	GYRODATA SURVEYS <113-876>	RATTLER 29N-34HZ AWB
876.00	7600.00	NaviTrak (Standard)	BHI MWD SURVEYS 8 3/4" HOLE <976-7600>	RATTLER 29N-34HZ AWB
7600.00	11515.00	OnTrak (Standard)	BHI MWD SURVEYS 6 1/8" HOLE <7730-11515>	RATTLER 29N-34HZ AWB
11515.00	11585.00	Blind Drilling (std)	Projection to bit	RATTLER 29N-34HZ AWB



Actual Wellpath Report

RATTLER 29N-34HZ AWP

Page 7 of 7



REFERENCE WELLPATH IDENTIFICATION

Operator	KERR-MCGEE OIL & GAS ONSHORE LP	Slot	SLOT#23 RATTLER 29N-34HZ (200'FSL & 1927'FWL,SEC.34)
Area	COLORADO	Well	RATTLER 29N-34HZ
Field	WELD COUNTY (KERR MCGEE)	Wellbore	RATTLER 29N-34HZ AWB
Facility	SEC.34-T3N-R66W		

WELLPATH COMMENTS

MD [ft]	Inclination [°]	Azimuth [°]	TVD [ft]	Comment
13.00	0.000	239.850	13.00	Tie-On
113.00	0.120	239.850	113.00	Begin GYRO Surveys
876.00	2.290	341.990	875.86	Tie-Into GYRO Surveys
976.00	2.640	342.950	975.77	Begin BHI MWD Surveys
7672.00	84.472	0.107	7235.16	7" Casing Point
11515.00	90.890	359.110	7229.35	Last BHI MWD Survey
11585.00	90.890	359.110	7228.27	Projection to Bit