

Encana OIL & GAS (USA) INC.
WELL PAD O12 8100
LOCATED IN GARFIELD COUNTY, COLORADO
SECTION 12, T8S, R100W, 6th P.M.

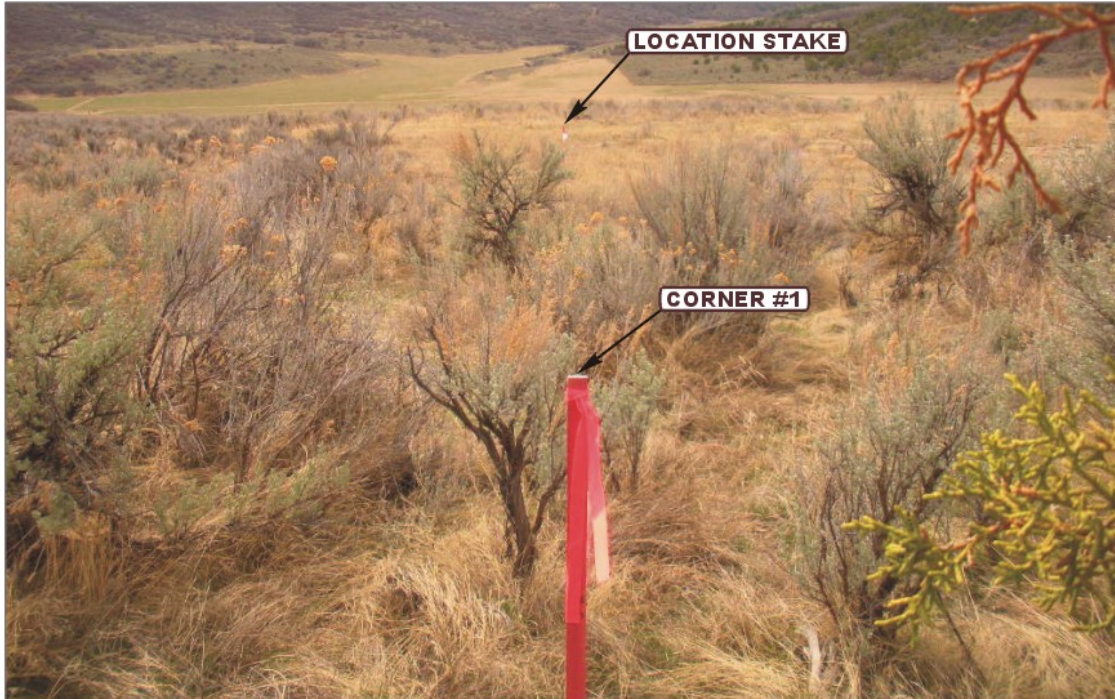

PHOTO: VIEW FROM CORNER 5 TO LOCATION STAKE

CAMERA ANGLE: SOUTHERLY



PHOTO: VIEW FROM BEGINNING OF PROPOSED ACCESS

CAMERA ANGLE: NORTHWESTERLY



- Since 1964 -

UELS Uintah Engineering & Land Surveying
85 South 200 East Vernal, Utah 84078
(435) 789-1017 * FAX (435) 789-1813

LOCATION PHOTOS

04 **26** **12**
MONTH DAY YEAR

TAKEN BY: B.J.

DRAWN BY: J.L.G.

REVISED: 00-00-00

PHOTO
P1

Encana OIL & GAS (USA) INC.
WELL PAD O12 8100
LOCATED IN GARFIELD COUNTY, COLORADO
SECTION 12, T8S, R100W, 6th P.M.



PHOTO: VIEW OF LOCATION STAKE

CAMERA ANGLE: NORTHERLY

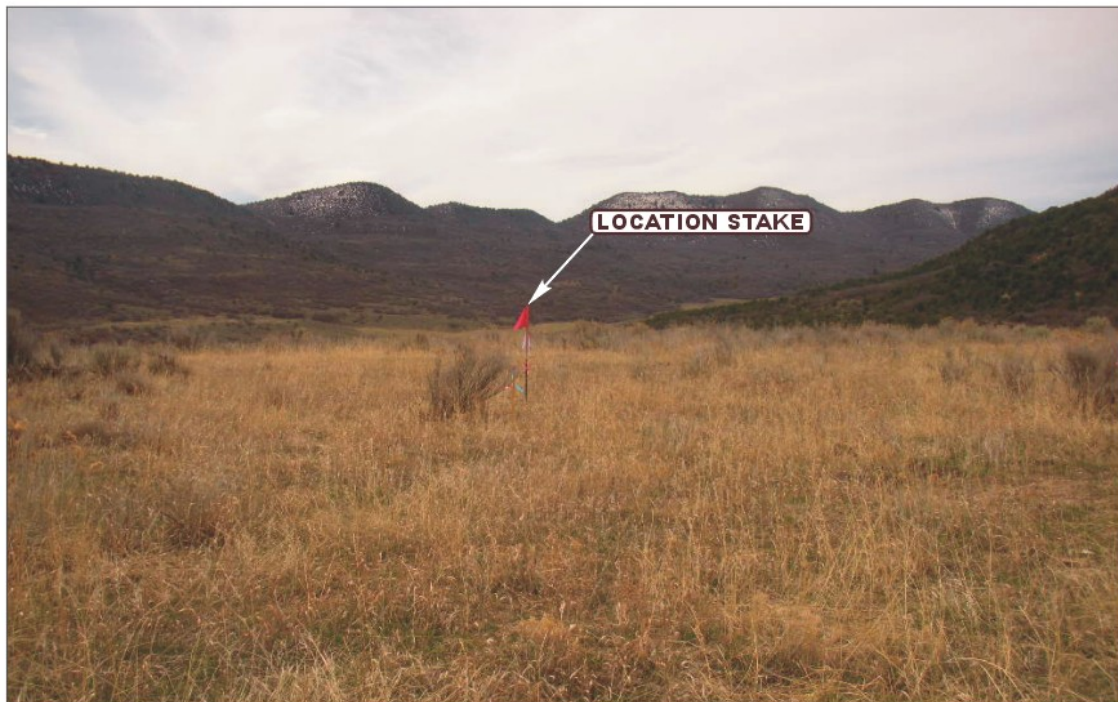

PHOTO: VIEW OF LOCATION STAKE

CAMERA ANGLE: SOUTHERLY



UELS Uintah Engineering & Land Surveying
85 South 200 East Vernal, Utah 84078
(435) 789-1017 * FAX (435) 789-1813

LOCATION PHOTOS

04 **26** **12**
MONTH DAY YEAR

TAKEN BY: B.J.

DRAWN BY: J.L.G.

REVISED: 00-00-00

PHOTO
P2

Encana OIL & GAS (USA) INC.
WELL PAD 012 8100
LOCATED IN GARFIELD COUNTY, COLORADO
SECTION 12, T8S, R100W, 6th P.M.

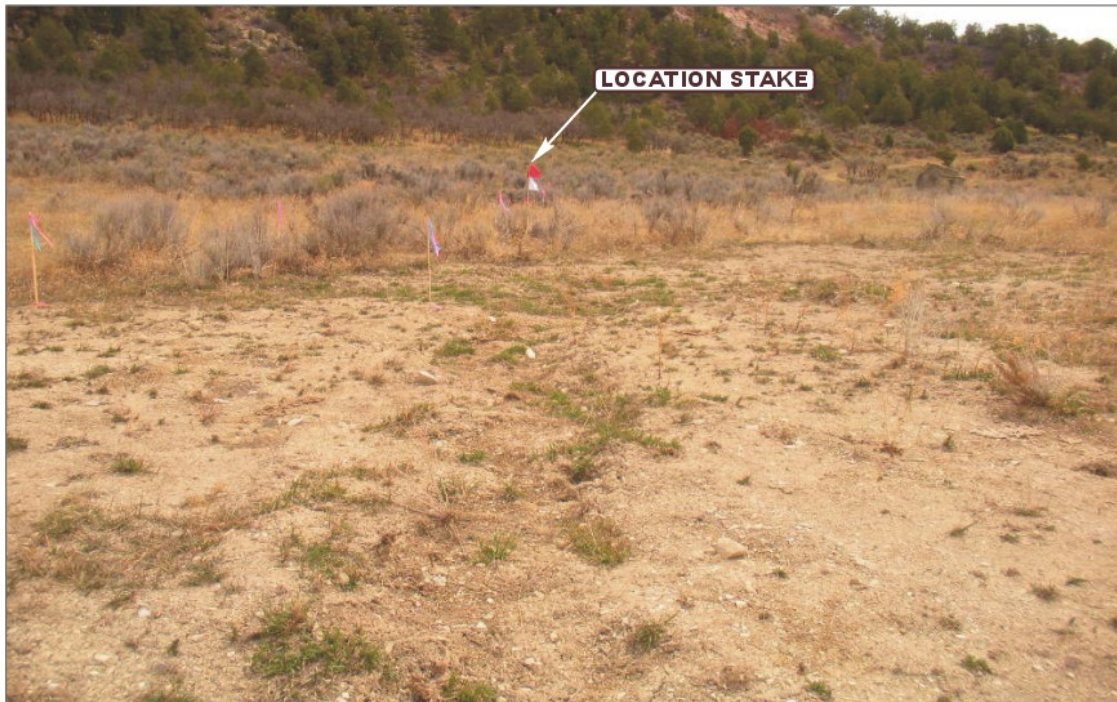

PHOTO: VIEW OF LOCATION STAKE

CAMERA ANGLE: EASTERLY



PHOTO: VIEW OF LOCATION STAKE

CAMERA ANGLE: WESTERLY



U E L S Uintah Engineering & Land Surveying
85 South 200 East Vernal, Utah 84078
(435) 789-1017 * FAX (435) 789-1813

LOCATION PHOTOS

04 **26** **12**
MONTH DAY YEAR

TAKEN BY: B.J. DRAWN BY: J.L.G. REVISED: 00-00-00

PHOTO
P3