

Encana OIL & GAS (USA) INC.

CONSTRUCTION LAYOUT FOR

WELL PAD 012 8100

SECTION 12, T8S, R100W, 6th P.M.

LOT 4

DATE: 01-12-12
DRAWN BY: D.R.B.
Revised: 04-25-12 D.R.B.
Revised: 06-01-12 T.B.

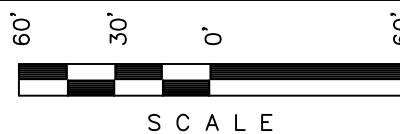

Sheet 3 of 10

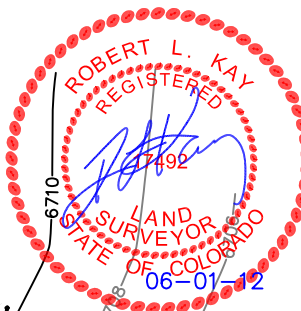

NOTE:

Off-site drainage areas were determined using USGS topo from The Saddle and Winter Flats, Colorado Quad maps (1958 and 1968).

NOTE:

Compact in 6" lifts and seed ECB infilled with Flexterra.

NOTE:

Flare Stack is to be located a min. of 100' from the Well Head.

RUN-ON PROTECTION

LEGEND:

- 1 - OVERFLOW
- 2 - SEWER TANK
- 3 - LIFT STATION
- 4 - SEWER LINE
- 5 - WATER TANK (FIRE SUPPRESSION, 2500 Gals.)
- 6 - FREEZER
- 7 - STORAGE
- 8 - GENERATOR
- 9 - FUEL
- 10 - TRANSFORMER
- 11 - BEAR PROOF TRASH CANS (2) 30 GALLON.
- 12 - WATER TANK

SWMP LEGEND:

- DP - DETENTION POND
- ECB - EROSION CONTROL BLANKET
- LSD - LEVEL SPREADER
- SCE - STABILIZED CONSTRUCTION ENTRANCE
- SedR - SEDIMENT RESERVOIR
- SL - SLASH
- ST - SEDIMENT TRAP
- T - TERRACING
- TB - TOE BERM
- VB - VEGETATED BUFFER
- W - WATTLE
- ECB INFILLED WITH FLEXTERRA

Elev. Ungraded Ground At DHS7C-13 Loc. Stake = 6722.9'
FINISHED GRADE ELEV. AT DHS7C-13 LOC. STAKE = 6724.7'

UINTAH ENGINEERING & LAND SURVEYING
85 So. 200 East * Vernal, Utah 84078 * (435) 789-1017

LOT 4

Sheet 3a of 10

SCE - STABILIZED
CONSTRUCTION
ENTRANCE
W - WATTLE
ST - SEDIMENT TRAP

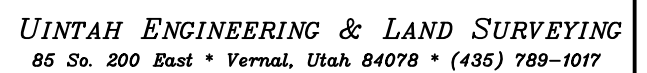

Encana OIL & GAS (USA) INC.
CONSTRUCTION LAYOUT CROSS SECTION FOR
WELL PAD 012 8100
SECTION 12, T8S, R100W, 6th P.M.
LOT 4

Sheet 4 of 10

1" = 40'
X-Section
Scale
1" = 100'

DATE: 01-12-12
DRAWN BY: D.R.B.
Revised: 04-25-12 D.R.B.
Revised: 06-01-12 T.B.



NOTE:

Per NRCS U.S. Soil Survey for Douglas-Plateau Area, Parts of Garfield and Mesa Counties, CO. Site has Silty Clay Loam and Channery, Sandy Loam.

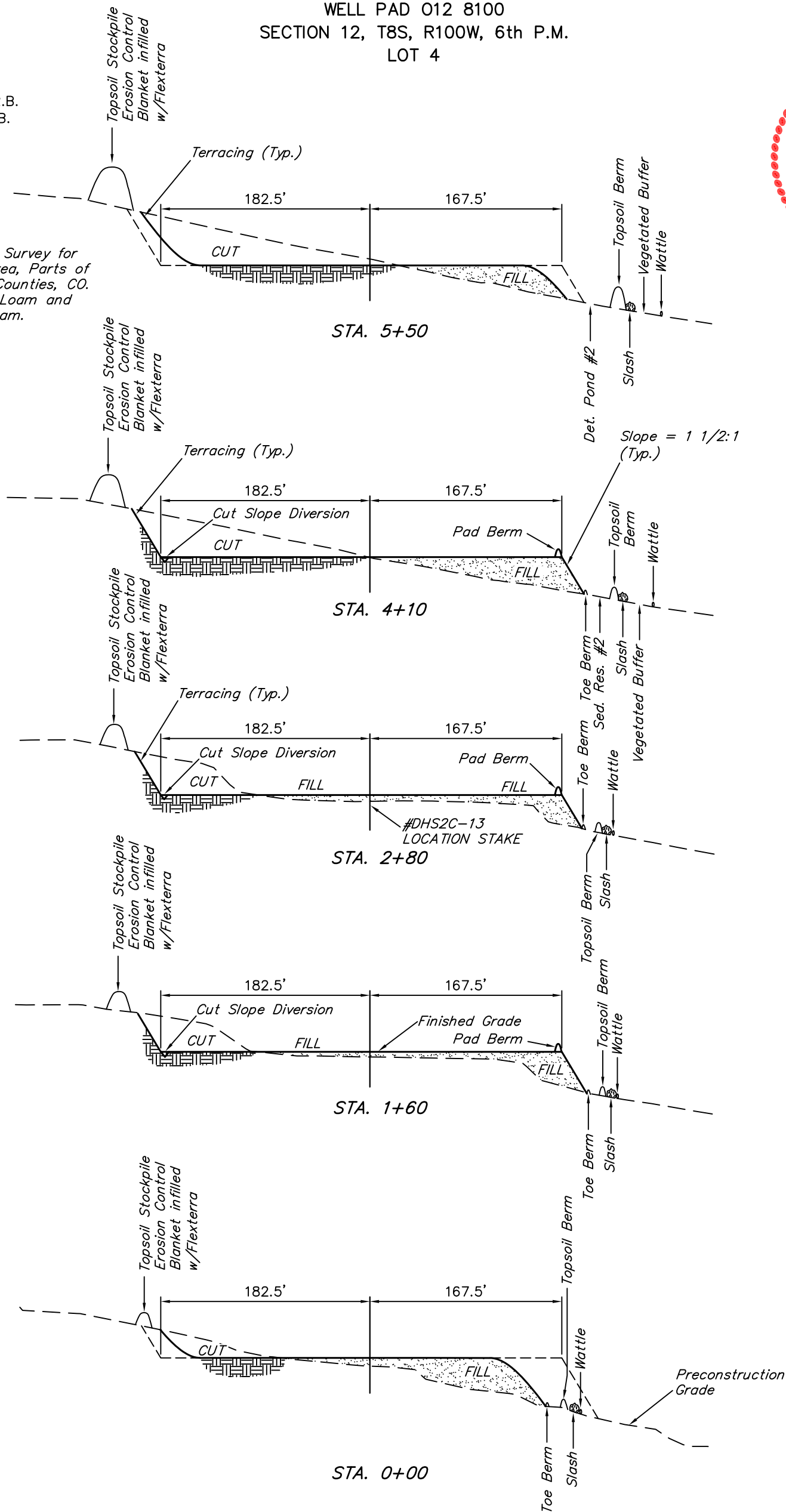

NOTE:

Topsoil should not be Stripped Below Finished Grade on Substructure Area.

* NOTE:

FILL QUANTITY INCLUDES 5% FOR COMPACTION

APPROXIMATE YARDAGES

(6") Topsoil Stripping = 2,740 Cu. Yds.
(New Construction Only)
Remaining Location = 21,220 Cu. Yds.
TOTAL CUT = 23,960 CU.YDS.
FILL = 21,220 CU.YDS.

EXCESS MATERIAL = 2,740 Cu. Yds.
Topsoil = 2,740 Cu. Yds.
EXCESS UNBALANCE = 0 Cu. Yds.
(After Interim Rehabilitation)

Encana OIL & GAS (USA) INC.

PRODUCTION SCHEMATIC FOR

WELL PAD 012 8100

SECTION 12, T8S, R100W, 6th P.M.

LOT 4



SCALE

Sheet 5 of 10

DATE: 06-01-12
DRAWN BY: T.B.

SWMP LEGEND:

FCD - FLOW CONTROL DITCH
RV - REVEGETATION
ST - SEDIMENT TRAP

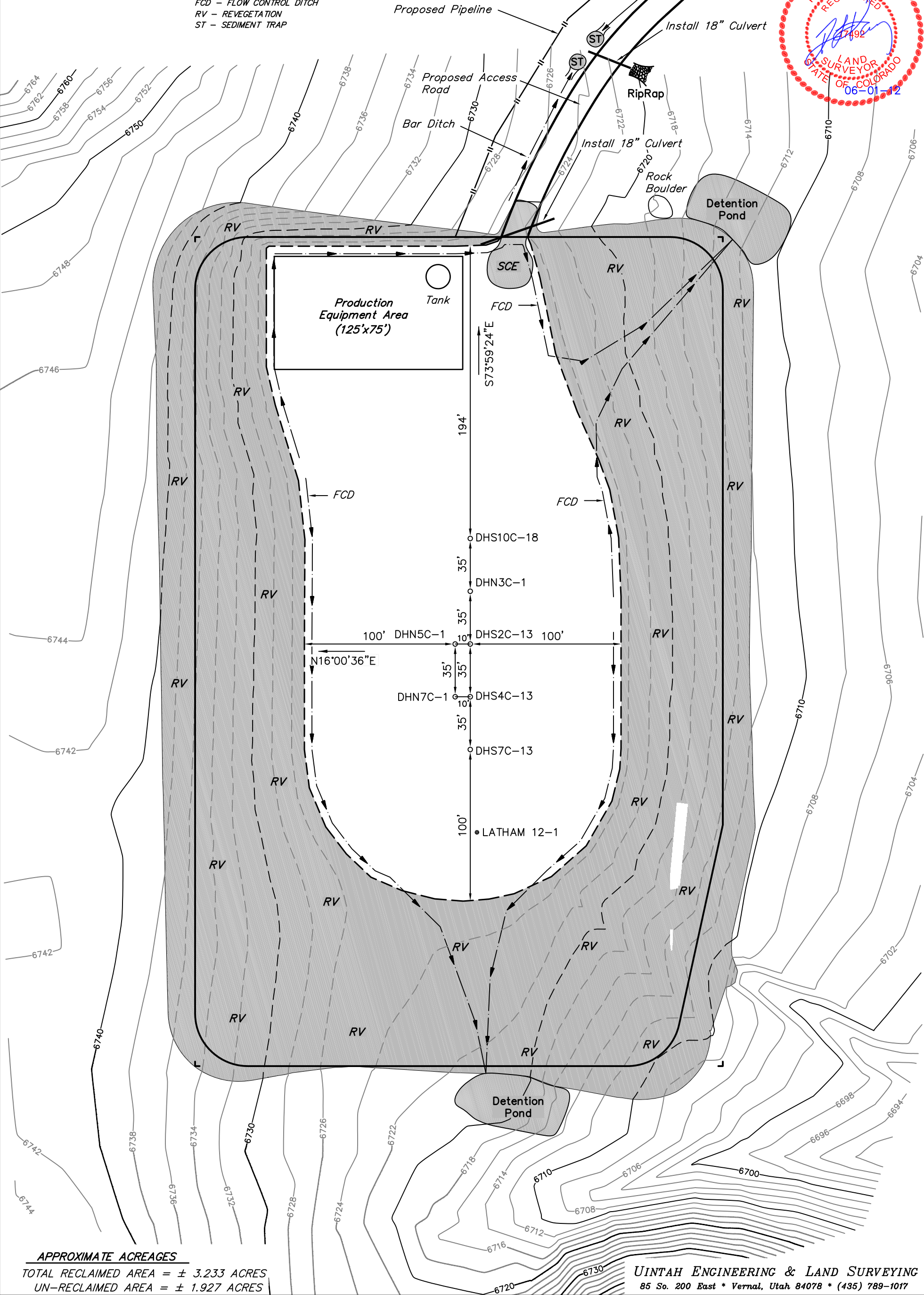

APPROXIMATE ACREAGES

TOTAL RECLAIMED AREA = ± 3.233 ACRES
UN-RECLAIMED AREA = ± 1.927 ACRES

UINTAH ENGINEERING & LAND SURVEYING
85 So. 200 East * Vernal, Utah 84078 * (435) 789-1017

LOT 4

UINTAH ENGINEERING & LAND SURVEYING
85 So. 200 East * Vernal, Utah 84078 * (435) 789-1017