

Savage and Savage *Environmental*

practical solutions for environmental issues

4610 Haystack Drive
Windsor, Colorado 80550

970 674 8080 telephone
970 674 8088 facsimile
savageandsavage@earthlink.net



September 19, 2011

Jim Curry
Noble Energy, Inc.
804 Grand Avenue
Platteville, Colorado 80651

RE: Noble Energy, Nichols J35-32D, 33D Wells Site, Wildlife Investigation

Dear Mr. Curry:

A site investigation of the proposed Nichols J35-32D, 33D drill site was conducted on August 30, 2011 to assess any potential wildlife issues at the site prior to disturbance. The proposed drill site is located approximately 2.25 miles west of La Salle, south of the South Platte River. The site is accessed by proceeding southwest on Weld County Road 394 from the intersection of Weld County Road 394 and 1st Avenue (County Road 375, LaSalle), north on Weld County Road 33.25 to Weld County Road 50, west on Weld County Road 50 to an undeveloped oil and gas access road, then north on the undeveloped oil and gas access road to the site. The site is located within Section 35, Township 5 North, Range 66 West of the 6th Prime Meridian, Weld County, Colorado (Noble Energy Nichols J35-32D, 33D Wells General Location Map).

The proposed Nichols drill pad is located south of the South Platte River in the riparian corridor. Vegetation in the area includes plains cottonwoods and Chinese elms, with an understory of sand dropseed, Western wheatgrass, gumweed, goosefoot, wildrye, smooth brome, beeplant, and ragweed.

During our site investigation a bald eagle was identified flying along the river corridor, a great blue heron was loafing in the area, and a red-tailed hawk was spotted across the river. These sightings are representative of bird species found along the South Platte River corridor.

A review of the Colorado Oil and Gas Conservation Commission wildlife map did not indicate any sensitive wildlife areas or any other areas of concern for this project site. Since the COGCC wildlife map does not specify any sensitive wildlife habitat no seasonal or distance restrictions are recommended for this site. If you have any questions or require further information about the proposed Nichols J35-32D, 33D drill site or red-tailed hawk nest please contact me.

Sincerely,

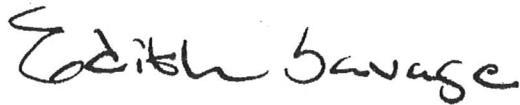
A handwritten signature in black ink that reads "Edith Savage". The signature is written in a cursive, flowing style.

Edith Savage
Principal

attachment: Noble Energy Nichols J35-32D, 33D Wells General Location Map

Noble Energy Nichols J35-32D, 33D Wells General Location Map

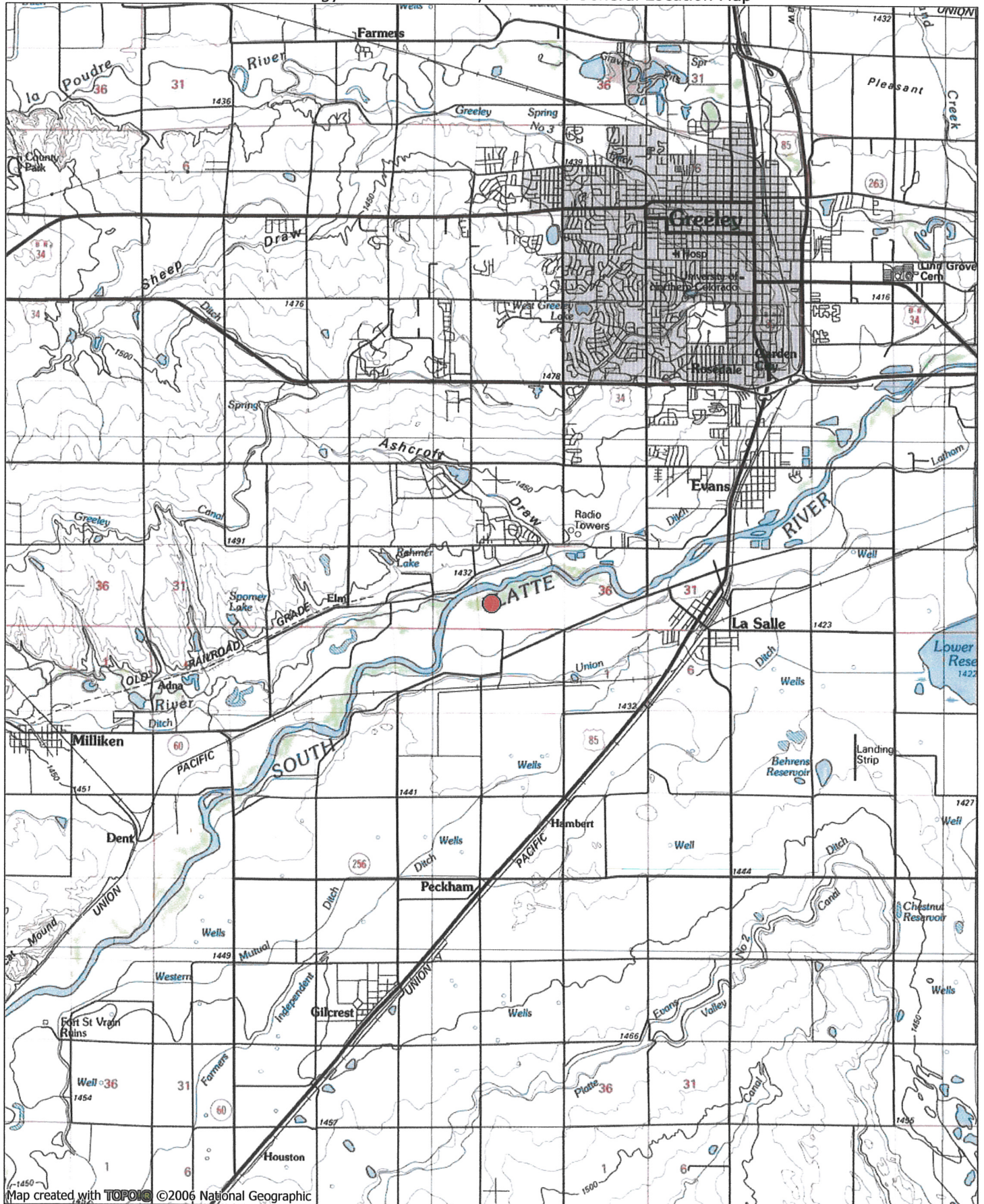

Map created with **TOPO** ©2006 National Geographic



0.0 0.5 1.0 1.5 2.0 2.5 3.0 miles
0 1 2 3 4 5 km

TN MN

91°2'

09/14/11