

Job # 12111 Harley #1

Inv # 1981

High Prairie Surveying of Kiowa, Colorado has in accordance with a request from **Jake Flora, Kuenzler & Flora Reserve Corp.** has determined the location of **Harley #1** to be 1800 feet FNL, and 1945 feet FWL, (90° off Section lines) of SECTION **5**, Township **14s**, Range **44w** of the 6th Principal Meridian, **Cheyenne County**, Colorado.

Date: Staked on 6/12/12 drawn on 6/15/12.

Re: Staked by Keith Westfall

Drawn: Drawn by Elijah Frane

Location Drawing

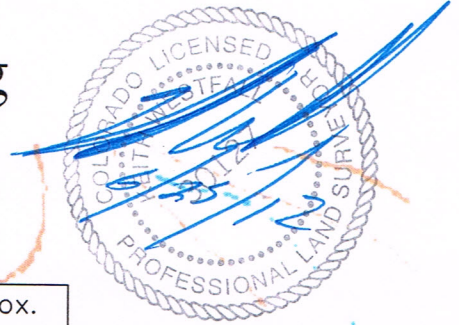

An overhead powerline exists approx. 217' South of proposed well pad, an access road exists approx. 185' south of proposed well pad.

