

2011 ANNUAL PROJECT SUMMARY TABLE

Incident Date	Remediation No.	Well Name	API	Status	NFA Proposed	NFA Approved Date	2011 Site Summary (monitoring/remediation/wells installed or destroyed)	Wells Sampled (Last Quarter) 2011	Wells Exceeding 5 ug/L Benzene (Last Quarter Sampled 2011)	Benzene Range (Last Quarter Sampled 2011)	POC Reached	2012 Recommendations	Well Reduction Request
4/12/2000	473	Alleley 31-34 #1	05-123-13105	Monitoring	NO	N/A	Quarterly groundwater monitoring since May-2000. Carbon slurry (BOS 200) injection completed in Feb-2010. MW04R, MW05, and MW08 were removed from the monitoring program in 2011.	MW01R3, MW02R, MW07R, MW09R, MW10R2, MW11, MW12, RC05	MW01R3, MW10R2	ND - 4,400	YES	Quarterly groundwater monitoring will continue.	N/A

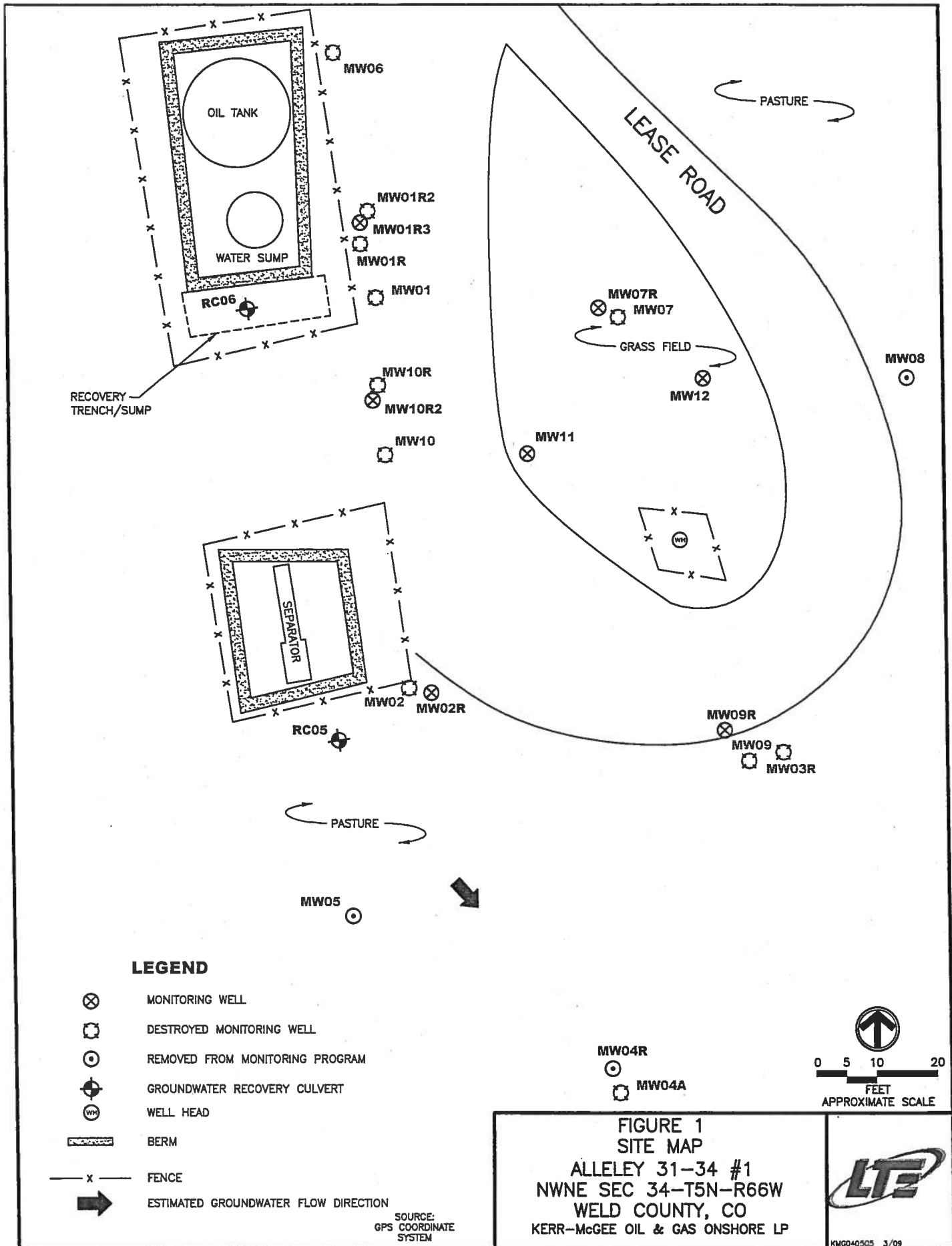

TABLE 1
GROUNDWATER ANALYTICAL AND FIELD RESULTS
ALLELEY 31-34 #1
WELD COUNTY, COLORADO
KERR-McGEE OIL & GAS ONSHORE LP

Well Name	Date	Benzene (ug/L)	Toluene (ug/L)	Ethylbenzene (ug/L)	Xylenes (ug/L)	Depth Water/ (Depth Product) (ft bgs)
MW01	05/11/2000					NM
MW01 destroyed as of 5/11/2000						
MW01R	03/08/2005	1100	85	680	7800	14.75
	06/16/2005	380	7.1	7800	7500	14.95
	09/19/2005	Product - Not Sampled				17.75 (17.65)
	01/06/2006	480	8.1	330	3600	16.85 (14.90)
	03/22/2006	Product - Not Sampled				15.90 (14.35)
	06/28/2006	Product - Not Sampled				16.01 (16.01)
	09/26/2006	Product - Not Sampled				15.00 (14.90)
	12/27/2006	Product - Not Sampled				14.00 (13.70)
	03/27/2007	Not Sampled				PVC Blocked
	06/18/2007	Not Sampled				PVC Blocked
	09/17/2007	Not Sampled				PVC Blocked
	12/04/2007	Product - Not Sampled				14.00 (15.47)
	03/14/2008	Product - Not Sampled				12.93 (12.83)
	06/18/2008	<1.0	<1.0	<1.0	<1.0	12.55
	09/24/2008	Not Found - Not Sampled				Not Found
MW01R destroyed as of 12/2/2008						
MW01R2	06/05/2009	8.4	<1.0	<1.0	<1.0	7.82
	09/29/2009	<1.0	<1.0	6.1	7.7	11.02
	12/14/2009	160	<1.0	<1.0	<1.0	10.19
	03/18/2010	31	<1.0	<1.0	<1.0	8.48
MW01R2 destroyed as of 6/30/2010						
MW01R3	09/21/2010	100	<1.0	160	520	NM
	12/13/2010	17	<1.0	11	70	11.06
	03/18/2011	<1.0	<1.0	<1.0	<1.0	9.42
	06/22/2011	11	<1.0	<1.0	120	10.00
	09/20/2011	53	<1.0	<1.0	160	11.78
	12/20/2011	30	<1.0	5.3	<1.0	11.00



TABLE 1 (Continued)
GROUNDWATER ANALYTICAL AND FIELD RESULTS
ALLELEY 31-34 #1
WELD COUNTY, COLORADO
KERR-McGEE OIL & GAS ONSHORE LP

Well Name	Date	Benzene (ug/L)	Toluene (ug/L)	Ethylbenzene (ug/L)	Xylenes (ug/L)	Depth Water/ (Depth Product) (ft bgs)	
MW02	05/11/2000	5000	9500	600	8600	NM	
	07/25/2000	4200	3100	120	2100	NM	
	11/21/2000	4200	3200	78	4200	NM	
	03/08/2001	1010	310	370	1021	NM	
	04/24/2001	637	ND	1.9	654	NM	
	08/24/2001	730	100	ND	730	NM	
	12/20/2001	1100	690	82	1300	NM	
	03/07/2002	1300	45	79	1250	NM	
	06/03/2002	1900	ND	75	1520	NM	
	09/26/2002	1030	174	80	1220	NM	
	02/11/2003	1240	5.3	131	1510	7.07	
	06/18/2003	Damaged - Not Sampled					Damaged
	12/19/2003	365	<5	32	418	NM	
	03/25/2004	620	1	40.4	482	NM	
	06/25/2004	ND	ND	ND	ND	NM	
	09/24/2004	Dry - Not Sampled					Dry
	12/14/2004	49.00	ND	9.20	110.00	14.28	
	03/08/2005	360	7.2	41	940	13.68	
	06/16/2005	56	<1.0	3.8	26	13.80	
	09/14/2005	130	<1.0	17	540	14.79	
	01/06/2006	93	<1.0	2.4	110	15.20	
	03/22/2006	49	<1.0	<1.0	46	14.70	
	06/28/2006	42	<1.0	72	60	14.84	
	09/26/2006	31	<1.0	78	72	14.10	
	12/27/2006	26	<1.0	1.0	5.6	13.10	
	03/27/2007	14	<1.0	<1.0	4.4	12.36	
	06/18/2007	14	<1.0	7.2	43	NM	
	09/17/2007	4.7	<1.0	<1.0	2.4	NM	
	12/04/2007	2.7	<1.0	<1.0	<1.0	NM	
	03/14/2008	5.0	<1.0	10	33	NM	
	06/18/2008	<1.0	<1.0	<1.0	<1.0	NM	
	09/24/2008	Not Found - Not Sampled					Not Found
MW02 destroyed as of 12/2/2008							



TABLE 1 (Continued)
GROUNDWATER ANALYTICAL AND FIELD RESULTS
ALLELEY 31-34 #1
WELD COUNTY, COLORADO
KERR-McGEE OIL & GAS ONSHORE LP

Well Name	Date	Benzene (ug/L)	Toluene (ug/L)	Ethylbenzene (ug/L)	Xylenes (ug/L)	Depth Water/ (Depth Product) (ft bgs)
MW02R	06/05/2009	<1.0	<1.0	<1.0	19	6.72
	09/29/2009	<1.0	<1.0	<1.0	<1.0	9.98
	12/14/2009	<1.0	<1.0	<1.0	<1.0	9.24
	03/18/2010	<1.0	<1.0	<1.0	<1.0	7.66
	06/30/2010	<1.0	<1.0	<1.0	<1.0	7.74
	09/15/2010	<1.0	<1.0	<1.0	2.0	9.89
	12/13/2010	<1.0	<1.0	<1.0	<1.0	10.13
	03/18/2011	<1.0	<1.0	<1.0	<1.0	8.41
	06/22/2011	<1.0	<1.0	<1.0	<1.0	9.18
	09/20/2011	<1.0	<1.0	1.2	43	10.88
	12/20/2011	<1.0	<1.0	<1.0	<1.0	10.18
MW03	05/11/2000	ND	ND	ND	ND	NM
	07/25/2000	ND	ND	ND	ND	NM
	11/21/2000	Not Sampled				NM
	03/08/2001	ND	ND	ND	ND	NM
	04/24/2001	ND	ND	ND	ND	NM
MW03 destroyed as of 8/24/2001						
MW03R	03/08/2005	<1.0	<1.0	<1.0	12	14.37
	06/16/2005	<1.0	<1.0	<1.0	<2.0	14.58
	09/19/2005	<1.0	<1.0	<1.0	<2.0	15.57
	01/06/2006	<1.0	<1.0	<1.0	<2.0	15.15
	03/22/2006	<1.0	<1.0	<1.0	<1.0	14.38
	06/28/2006	<1.0	<1.0	<1.0	<1.0	14.50
	09/26/2006	Dry - Not Sampled				Dry
	12/27/2006	Dry - Not Sampled				Dry
	03/27/2007	<1.0	<1.0	<1.0	<1.0	PVC Blocked
	06/18/2007	<1.0	<1.0	<1.0	<1.0	PVC Blocked
	09/17/2007	Not Found - Not Sampled				Not Found
	03/14/2008	<1.0	<1.0	<1.0	<1.0	13.31
	06/18/2008	<1.0	<1.0	<1.0	<1.0	12.47
	09/24/2008	<1.0	<1.0	<1.0	<1.0	PVC Bent
12/02/2008	<1.0	<1.0	<1.0	<1.0	10.88	
MW03R destroyed as of 3/12/2009						
MW04	05/11/2000	ND	ND	ND	ND	NM
	07/25/2000	Dry - Not Sampled				Dry
	11/21/2000	ND	ND	ND	ND	NM
MW04 destroyed as of 3/8/2001						



TABLE 1 (Continued)
GROUNDWATER ANALYTICAL AND FIELD RESULTS
ALLELEY 31-34 #1
WELD COUNTY, COLORADO
KERR-McGEE OIL & GAS ONSHORE LP

Well Name	Date	Benzene (ug/L)	Toluene (ug/L)	Ethylbenzene (ug/L)	Xylenes (ug/L)	Depth Water/ (Depth Product) (ft bgs)	
MW04A	03/13/2001	ND	ND	ND	ND	NM	
	04/24/2001	ND	ND	ND	ND	NM	
	08/24/2001	3.2	ND	ND	ND	NM	
	12/20/2001	ND	ND	ND	ND	NM	
	03/07/2002	ND	ND	ND	ND	NM	
	06/03/2002	ND	ND	ND	ND	NM	
	09/26/2002	ND	ND	ND	ND	NM	
	02/11/2003	ND	ND	ND	ND	13.05	
	06/18/2003	ND	ND	ND	ND	NM	
	12/19/2003	ND	ND	ND	ND	NM	
	03/25/2004	ND	ND	ND	ND	NM	
	06/25/2004	ND	ND	ND	ND	NM	
	09/24/2004	Dry - Not Sampled					Dry
	12/14/2004	ND	ND	ND	ND	14.03	
MW04A destroyed as of 3/8/2005							



TABLE 1 (Continued)
GROUNDWATER ANALYTICAL AND FIELD RESULTS
ALLELEY 31-34 #1
WELD COUNTY, COLORADO
KERR-McGEE OIL & GAS ONSHORE LP

Well Name	Date	Benzene (ug/L)	Toluene (ug/L)	Ethylbenzene (ug/L)	Xylenes (ug/L)	Depth Water/ (Depth Product) (ft bgs)
MW04R	03/08/2005	<1.0	<1.0	<1.0	3.1	14.10
	06/16/2005	<1.0	<1.0	<1.0	<2.0	14.15
	01/06/2006	<1.0	<1.0	<1.0	<2.0	14.37
	03/22/2006	<1.0	<1.0	<1.0	<1.0	13.85
	06/28/2006	<1.0	<1.0	<1.0	<1.0	14.00
	09/26/2006	Dry - Not Sampled				Dry
	12/27/2006	Dry - Not Sampled				Dry
	03/27/2007	<1.0	<1.0	<1.0	<1.0	NM
	06/18/2007	<1.0	<1.0	<1.0	<1.0	11.27
	09/17/2007	<1.0	<1.0	<1.0	<1.0	11.95
	12/04/2007	Not Sampled				PVC Blocked
	03/14/2008	<1.0	<1.0	<1.0	<1.0	13.49
	06/18/2008	<1.0	<1.0	<1.0	<1.0	16.20
	09/24/2008	<1.0	<1.0	<1.0	<1.0	12.56
	12/02/2008	<1.0	<1.0	<1.0	<1.0	10.51
	03/12/2009	<1.0	<1.0	<1.0	<1.0	8.75
	06/05/2009	<1.0	<1.0	<1.0	<1.0	6.59
	09/29/2009	<1.0	<1.0	<1.0	<1.0	9.36
	12/14/2009	<1.0	<1.0	<1.0	<1.0	9.28
	03/18/2010	<1.0	<1.0	<1.0	<1.0	8.09
	06/30/2010	<1.0	<1.0	<1.0	<1.0	7.96
	09/15/2010	<1.0	<1.0	<1.0	<1.0	9.97
	12/13/2010	<1.0	<1.0	<1.0	<1.0	10.23
	03/18/2011	<1.0	<1.0	<1.0	<1.0	8.74
	06/22/2011	<1.0	<1.0	<1.0	<1.0	9.39
	09/20/2011	Removed from monitoring				NM



TABLE 1 (Continued)
GROUNDWATER ANALYTICAL AND FIELD RESULTS
ALLELEY 31-34 #1
WELD COUNTY, COLORADO
KERR-McGEE OIL & GAS ONSHORE LP

Well Name	Date	Benzene (ug/L)	Toluene (ug/L)	Ethylbenzene (ug/L)	Xylenes (ug/L)	Depth Water/ (Depth Product) (ft bgs)
MW05	03/08/2005	<1.0	<1.0	<1.0	<2.0	13.52
	06/16/2005	<1.0	<1.0	<1.0	<2.0	13.80
	09/14/2005	<1.0	<1.0	<1.0	9.3	14.84
	01/06/2006	<1.0	<1.0	<1.0	<2.0	14.06
	03/22/2006	<1.0	<1.0	<1.0	<1.0	14.42
	06/28/2006	<1.0	<1.0	<1.0	<1.0	14.57
	09/26/2006	<1.0	<1.0	<1.0	<1.0	14.15
	12/27/2006	<1.0	<1.0	<1.0	<1.0	13.15
	03/27/2007	<1.0	<1.0	<1.0	<1.0	12.42
	06/18/2007	<1.0	<1.0	<1.0	<1.0	12.05
	09/17/2007	<1.0	<1.0	<1.0	<1.0	13.75
	12/04/2007	<1.0	<1.0	<1.0	<1.0	13.63
	03/14/2008	<1.0	<1.0	<1.0	<1.0	12.49
	06/18/2008	<1.0	<1.0	<1.0	<1.0	13.05
	09/24/2008	<1.0	<1.0	<1.0	<1.0	12.62
	12/02/2008	<1.0	<1.0	<1.0	<1.0	11.23
	03/12/2009	<1.0	<1.0	<1.0	<1.0	7.90
	06/05/2009	<1.0	<1.0	<1.0	<1.0	6.72
	09/29/2009	<1.0	<1.0	<1.0	<1.0	9.72
	12/14/2009	<1.0	<1.0	<1.0	<1.0	PVC Bent
	03/18/2010	<1.0	<1.0	<1.0	<1.0	PVC Bent
	06/30/2010	<1.0	<1.0	<1.0	<1.0	PVC Bent
	09/15/2010	<1.0	<1.0	<1.0	<1.0	PVC Blocked
	12/13/2010	<1.0	<1.0	<1.0	<1.0	PVC Bent
	03/18/2011	<1.0	<1.0	<1.0	<1.0	PVC Bent
	06/22/2011	<1.0	<1.0	<1.0	<1.0	PVC Bent
	09/20/2011	Removed from monitoring				NM



TABLE 1 (Continued)
GROUNDWATER ANALYTICAL AND FIELD RESULTS
ALLELEY 31-34 #1

WELD COUNTY, COLORADO
KERR-McGEE OIL & GAS ONSHORE LP

Well Name	Date	Benzene (ug/L)	Toluene (ug/L)	Ethylbenzene (ug/L)	Xylenes (ug/L)	Depth Water/ (Depth Product) (ft bgs)
MW06	09/14/2005	<1.0	<1.0	<1.0	2.9	17.08
	01/06/2006	<1.0	<1.0	<1.0	<2.0	16.60
	03/22/2006	<1.0	<1.0	<1.0	<1.0	16.10
	06/28/2006	<1.0	<1.0	<1.0	<1.0	16.26
	09/26/2006	<1.0	<1.0	<1.0	<1.0	16.39
	12/27/2006	<1.0	<1.0	<1.0	<1.0	15.39
	03/27/2007	<1.0	<1.0	<1.0	<1.0	14.55
	06/18/2007	<1.0	<1.0	<1.0	<1.0	14.30
	09/17/2007	<1.0	<1.0	<1.0	<1.0	15.90
	12/04/2007	<1.0	<1.0	<1.0	<1.0	15.79
	03/14/2008	<1.0	<1.0	<1.0	<1.0	14.65
	06/18/2008	<1.0	<1.0	<1.0	<1.0	14.29
	09/24/2008	<1.0	<1.0	<1.0	<1.0	14.18
	12/02/2008	<1.0	<1.0	<1.0	<1.0	11.72
MW06 destroyed as of 3/12/2009						
MW07	09/14/2005	330	5.4	29	390	16.78
	01/06/2006	280	16	53	630	PVC Bent
	03/22/2006	62	1.8	13	150	PVC Bent
	06/28/2006	Dry - Not Sampled				Dry
	09/26/2006	Damaged - Not Sampled				Damaged
MW07 destroyed as of 12/27/2006						
MW07R	12/04/2007	71	<1.0	13	180	15.68
	03/14/2008	42	<1.0	3.3	70	12.68
	06/18/2008	<1.0	<1.0	<1.0	<1.0	12.38
	09/24/2008	21	<1.0	<1.0	<1.0	13.74
	12/02/2008	26	<1.0	<1.0	<1.0	11.38
	03/12/2009	520	<1.0	35	170	9.55
	06/05/2009	590	<1.0	44	140	8.34
	09/29/2009	590	<1.0	44	71	12.23
	12/14/2009	78	<1.0	1.2	9.0	10.26
	03/18/2010	220	<1.0	<1.0	<1.0	8.92
	06/30/2010	<1.0	<1.0	<1.0	<1.0	8.62
	09/15/2010	1.6	<1.0	<1.0	<1.0	9.49
	12/13/2010	<1.0	<1.0	<1.0	<1.0	11.10
	03/18/2011	<1.0	<1.0	<1.0	<1.0	9.52
	06/22/2011	25	<1.0	1.7	<1.0	10.14
09/20/2011	<1.0	<1.0	<1.0	<1.0	11.87	
12/20/2011	<1.0	<1.0	<1.0	<1.0	11.14	



TABLE 1 (Continued)
GROUNDWATER ANALYTICAL AND FIELD RESULTS
ALLELEY 31-34 #1

WELD COUNTY, COLORADO
KERR-McGEE OIL & GAS ONSHORE LP

Well Name	Date	Benzene (ug/L)	Toluene (ug/L)	Ethylbenzene (ug/L)	Xylenes (ug/L)	Depth Water/ (Depth Product) (ft bgs)
MW08	09/17/2007	<1.0	<1.0	<1.0	<1.0	15.45
	12/04/2007	<1.0	<1.0	<1.0	<1.0	12.34
	03/14/2008	<1.0	<1.0	<1.0	<1.0	12.35
	06/18/2008	<1.0	<1.0	9.2	180	13.55
	09/24/2008	<1.0	<1.0	<1.0	<1.0	13.97
	12/02/2008	<1.0	<1.0	<1.0	<1.0	11.93
	03/12/2009	<1.0	<1.0	<1.0	<1.0	9.11
	06/05/2009	<1.0	<1.0	<1.0	<1.0	9.13
	09/29/2009	<1.0	<1.0	<1.0	<1.0	11.89
	12/14/2009	<1.0	<1.0	<1.0	<1.0	10.53
	03/18/2010	<1.0	<1.0	<1.0	<1.0	9.32
	06/30/2010	<1.0	<1.0	<1.0	<1.0	9.13
	09/15/2010	<1.0	<1.0	<1.0	<1.0	11.18
	12/13/2010	<1.0	<1.0	<1.0	<1.0	11.36
	03/18/2011	<1.0	<1.0	<1.0	<1.0	9.93
	06/22/2011	<1.0	<1.0	<1.0	<1.0	10.52
	09/20/2011	Removed from monitoring				
MW09	09/17/2007	<1.0	<1.0	1.2	42	14.55
	12/04/2007	<1.0	<1.0	4.3	120	14.34
	03/14/2008	<1.0	<1.0	12	160	13.34
	06/18/2008	120	21	<1.0	130	13.03
	09/24/2008	<1.0	<1.0	<1.0	41	12.77
	12/02/2008	<1.0	<1.0	<1.0	29	10.43
	MW09 destroyed as of 3/12/2009					
MW09R	06/05/2009	<1.0	<1.0	<1.0	<1.0	7.77
	09/29/2009	<1.0	<1.0	1.6	5.1	10.89
	12/14/2009	<1.0	<1.0	<1.0	<1.0	9.80
	03/18/2010	<1.0	<1.0	<1.0	<1.0	8.55
	06/30/2010	<1.0	<1.0	<1.0	<1.0	8.38
	09/15/2010	<1.0	<1.0	<1.0	<1.0	10.68
	12/13/2010	<1.0	<1.0	<1.0	<1.0	10.71
	03/18/2011	<1.0	<1.0	<1.0	<1.0	9.23
	06/22/2011	<1.0	<1.0	<1.0	<1.0	9.82
	09/20/2011	<1.0	<1.0	<1.0	<1.0	11.45
	12/20/2011	<1.0	<1.0	<1.0	<1.0	10.69



TABLE 1 (Continued)
GROUNDWATER ANALYTICAL AND FIELD RESULTS
ALLELEY 31-34 #1

WELD COUNTY, COLORADO
KERR-McGEE OIL & GAS ONSHORE LP

Well Name	Date	Benzene (ug/L)	Toluene (ug/L)	Ethylbenzene (ug/L)	Xylenes (ug/L)	Depth Water/ (Depth Product) (ft bgs)
MW10	12/04/2007	67	180	6.4	110	13.70
	03/14/2008	1300	440	65	860	13.16
	06/18/2008	860	200	7.9	3500	12.69
	09/24/2008	440	35	<1.0	100	12.80
	12/02/2008	380	14	<1.0	57	9.73
MW10 destroyed as of 3/12/2009						
MW10R	06/05/2009	160	340	98	790	7.87
	09/29/2009	1100	1200	180	1900	10.51
	12/14/2009	180	67	34	320	9.37
	03/18/2010	<1.0	<1.0	<1.0	<1.0	8.50
MW10R destroyed as of 6/30/2010						
MW10R2	09/21/2010	6300	2900	2500	13000	NM
	12/13/2010	2000	1800	740	8200	10.14
	03/18/2011	1800	680	640	5500	8.41
	06/22/2011	5800	1200	670	9300	9.21
	09/20/2011	4400	1100	780	8300	10.94
	12/20/2011	Not Found - Not Sampled				Not Found
MW11	12/30/2009	20	<1.0	43	410	NM
	03/18/2010	Inaccessible - Not Sampled				Inaccessible
	03/26/2010	43	<1.0	<1.0	190	NM
	06/30/2010	24	<1.0	<1.0	13	7.85
	09/15/2010	36	<1.0	<1.0	<1.0	10.03
	12/13/2010	<1.0	<1.0	<1.0	<1.0	10.30
	03/18/2011	<1.0	<1.0	<1.0	<1.0	8.64
	06/22/2011	93	<1.0	<1.0	<1.0	9.26
	09/20/2011	55	<1.0	<1.0	16	10.97
	12/20/2011	<1.0	<1.0	<1.0	<1.0	10.30
MW12	12/30/2009	<1.0	<1.0	<1.0	3.5	NM
	03/18/2010	<1.0	<1.0	<1.0	<1.0	8.61
	06/30/2010	<1.0	<1.0	<1.0	<1.0	PVC Bent
	09/15/2010	<1.0	<1.0	<1.0	<1.0	PVC Blocked
	12/13/2010	<1.0	<1.0	<1.0	<1.0	PVC Bent
	03/18/2011	<1.0	<1.0	<1.0	<1.0	Damaged
	06/22/2011	<1.0	<1.0	<1.0	<1.0	PVC Bent
	09/20/2011	<1.0	<1.0	<1.0	<1.0	11.26
	12/20/2011	<1.0	<1.0	<1.0	<1.0	11.42



TABLE 1 (Continued)
GROUNDWATER ANALYTICAL AND FIELD RESULTS
ALLELEY 31-34 #1
WELD COUNTY, COLORADO
KERR-McGEE OIL & GAS ONSHORE LP

Well Name	Date	Benzene (ug/L)	Toluene (ug/L)	Ethylbenzene (ug/L)	Xylenes (ug/L)	Depth Water/ (Depth Product) (ft bgs)
RC05	06/18/2003	1460	2020	31.8	1130	NM
	12/19/2003	Dry - Not Sampled				Dry
	06/25/2004	Dry - Not Sampled				Dry
	09/24/2004	Dry - Not Sampled				Dry
	12/14/2004	Dry - Not Sampled				Dry
	03/08/2005	Dry - Not Sampled				Dry
	06/16/2005	Dry - Not Sampled				Dry
	09/14/2005	Dry - Not Sampled				Dry
	01/06/2006	Dry - Not Sampled				Dry
	03/22/2006	Dry - Not Sampled				Dry
	06/28/2006	Dry - Not Sampled				Dry
	09/26/2006	Dry - Not Sampled				Dry
	12/27/2006	Dry - Not Sampled				Dry
	03/27/2007	Dry - Not Sampled				Dry
	06/18/2007	<1.0	<1.0	<1.0	<1.0	11.58
	09/17/2007	Dry - Not Sampled				Dry
	12/04/2007	Dry - Not Sampled				Dry
	03/14/2008	Dry - Not Sampled				Dry
	06/18/2008	Dry - Not Sampled				Dry
	09/24/2008	Dry - Not Sampled				Dry
	12/02/2008	<1.0	<1.0	2.3	9.1	9.38
	03/12/2009	Dry - Not Sampled				Dry
	06/05/2009	Dry - Not Sampled				Dry
	09/29/2009	Dry - Not Sampled				Dry
	12/14/2009	Dry - Not Sampled				Dry
	03/18/2010	<1.0	<1.0	<1.0	<1.0	6.88
	06/30/2010	<1.0	<1.0	<1.0	<1.0	6.95
	09/15/2010	3.4	<1.0	<1.0	<1.0	9.22
	12/13/2010	<1.0	<1.0	<1.0	<1.0	9.40
	03/18/2011	<1.0	<1.0	<1.0	<1.0	7.90
	06/22/2011	Dry - Not Sampled				Dry
	09/20/2011	<1.0	<1.0	<1.0	<1.0	10.20
	12/20/2011	<1.0	<1.0	<1.0	<1.0	9.54



TABLE 1 (Continued)
GROUNDWATER ANALYTICAL AND FIELD RESULTS
ALLELEY 31-34 #1
WELD COUNTY, COLORADO
KERR-McGEE OIL & GAS ONSHORE LP

Well Name	Date	Benzene (ug/L)	Toluene (ug/L)	Ethylbenzene (ug/L)	Xylenes (ug/L)	Depth Water/ (Depth Product) (ft bgs)
RC06	06/22/0201					NM
	06/25/2004	Dry - Not Sampled				Dry
	12/14/2004	Dry - Not Sampled				Dry
	03/08/2005	Dry - Not Sampled				Dry
	06/16/2005	Dry - Not Sampled				Dry
	09/14/2005	Dry - Not Sampled				Dry
	01/06/2006	Dry - Not Sampled				Dry
	03/22/2006	Dry - Not Sampled				Dry
	06/28/2006	Dry - Not Sampled				Dry
	09/26/2006	Dry - Not Sampled				Dry
	12/27/2006	Dry - Not Sampled				Dry
	03/27/2007	Dry - Not Sampled				Dry
	06/18/2007	Dry - Not Sampled				Dry
	09/17/2007	Dry - Not Sampled				Dry
	12/04/2007	Dry - Not Sampled				Dry
	03/14/2008	Dry - Not Sampled				Dry
	06/18/2008	Dry - Not Sampled				Dry
	09/24/2008	Dry - Not Sampled				Dry
	12/02/2008	Dry - Not Sampled				Dry
	03/12/2009	Dry - Not Sampled				Dry
	06/05/2009	Dry - Not Sampled				Dry
	09/29/2009	Dry - Not Sampled				Dry
	12/14/2009	Dry - Not Sampled				Dry
	03/18/2010	Dry - Not Sampled				Dry
	06/30/2010	Dry - Not Sampled				Dry
	09/15/2010	Dry - Not Sampled				Dry
	12/13/2010	Dry - Not Sampled				Dry
	03/18/2011	Dry - Not Sampled				Dry
	06/22/2011	Dry - Not Sampled				Dry
	09/20/2011	Dry - Not Sampled				Dry
	12/20/2011	Dry - Not Sampled				Dry
Colo GW Quality Standards		5	1000	680	10000	

Notes: NM - Not Measured
ug/L - micrograms per Liter
NA - Not Analyzed/Not Available

GW - Groundwater ft bgs - feet below ground surface
< - less than laboratory reporting limit
Bold numbers indicate result equaled or exceeded standard.

