

Facilities and Construction Layout Drawing Gentry B Pad Extension Section 17, Township 6 South, Range 92 West

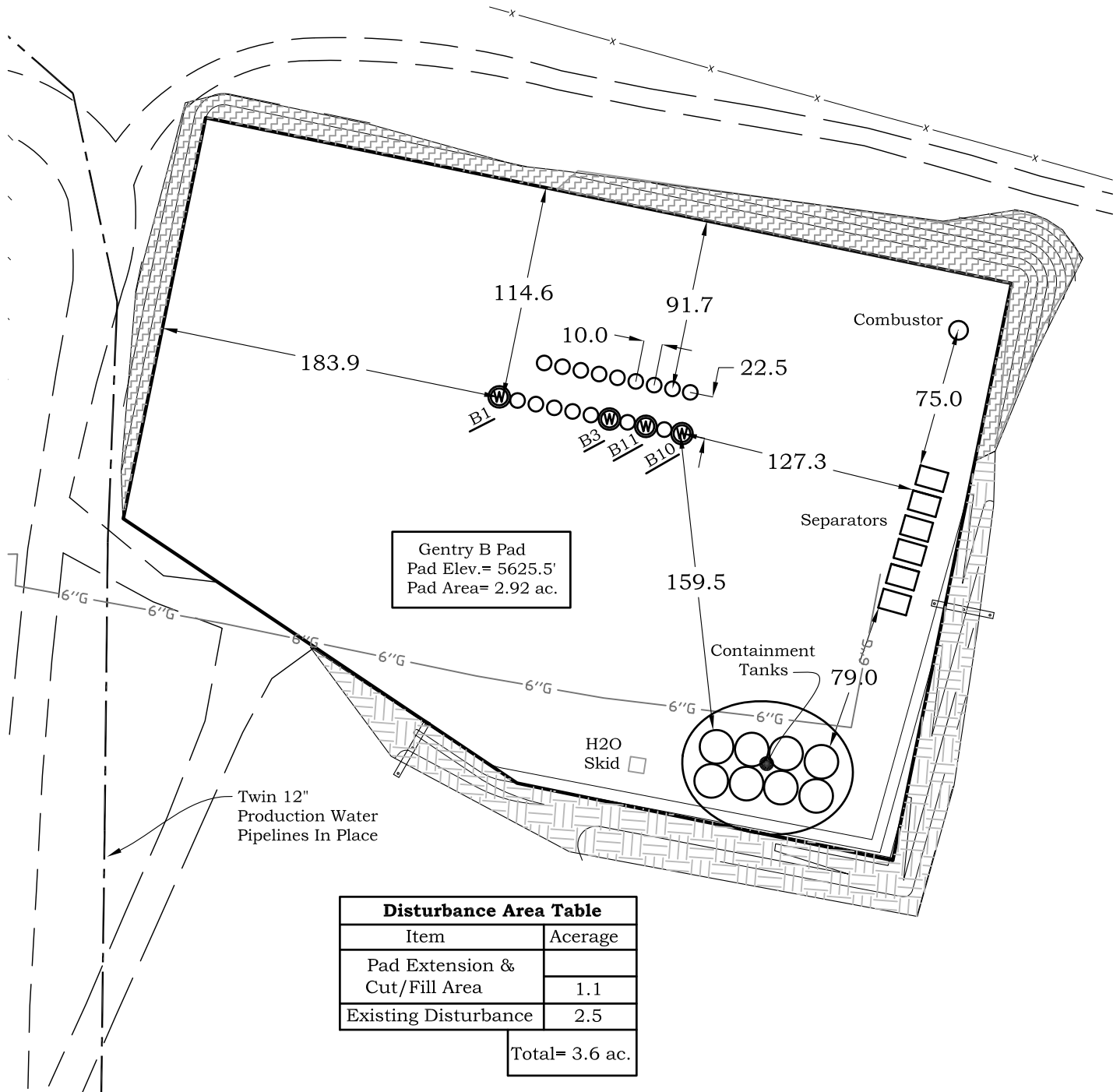

Disturbance Area Table	
Item	Acerage
Pad Extension & Cut/Fill Area	1.1
Existing Disturbance	2.5
Total= 3.6 ac.	

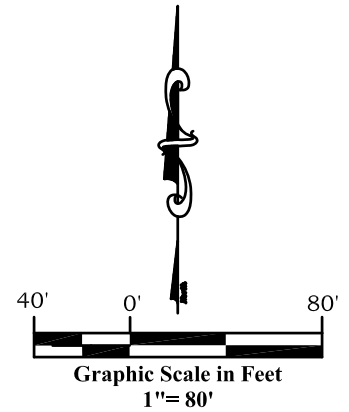

River Valley Survey, Inc.
110 East 3rd. Street, Suite 213
Rifle, Colorado 81650
Ph: 970-379-7846

Project: Gentry B Pad

Proj. No. 06001-11

Field Date: 02-21-12

Scale: 1"= 80'

Date: 05-24-12

Sheet: 4 of 10

**Well Location Plat
Prepared For** Antero Resources

Situate In:
SE1/4NW1/4 Section 17, T6S., R. 92 W.
of the 6th P.M., Garfield County,
Colorado

