

# Hydrology Map

## DAVIS 42-12

SE¼ NE¼ SECTION 12, TOWNSHIP 17 SOUTH, RANGE 53 WEST OF THE 6TH PRINCIPAL MERIDIAN

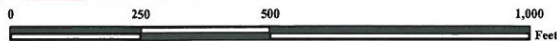
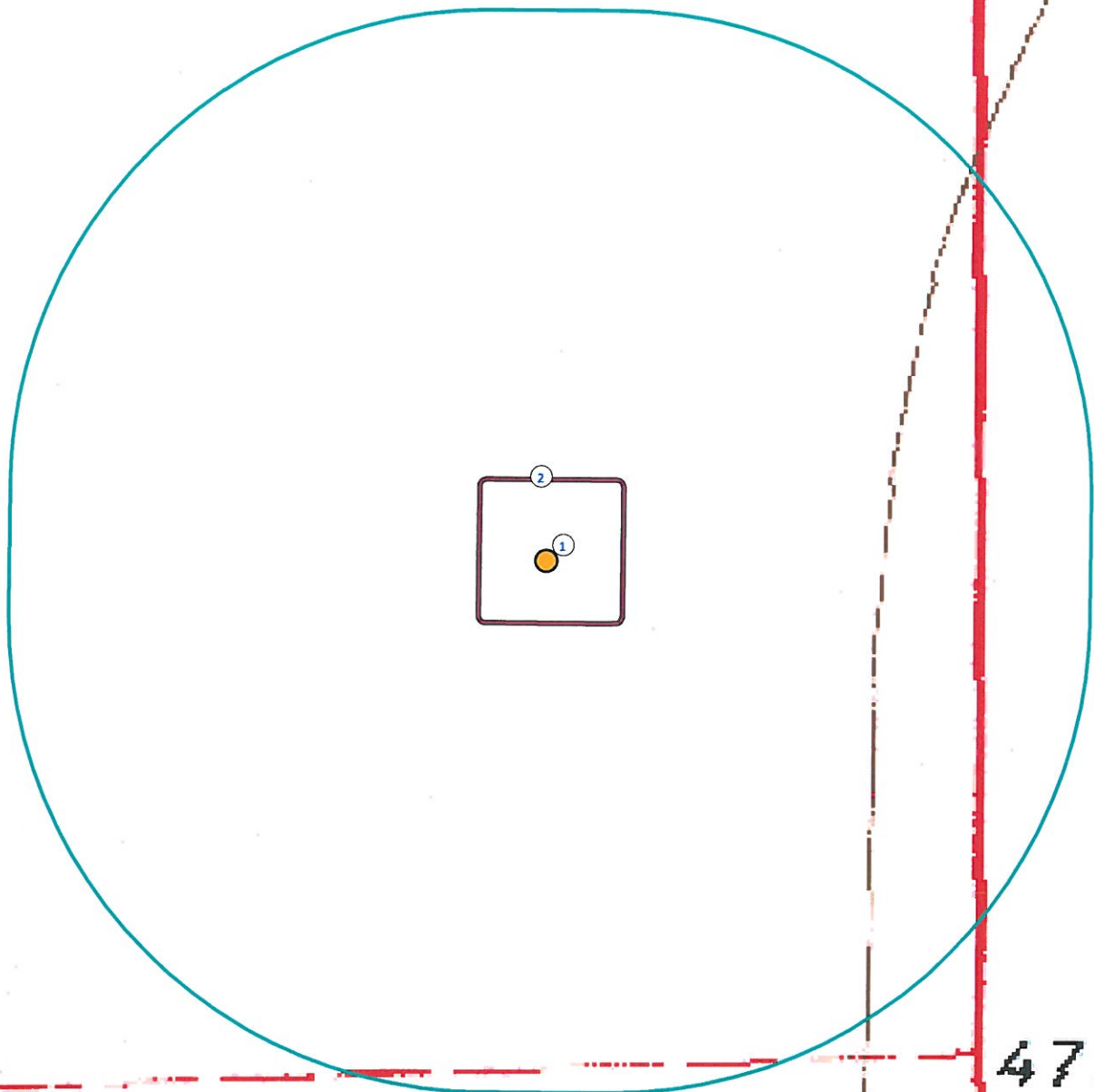

1. Proposed well DAVIS 42-12.

2. Operational Disturbance Area.

There are no visible surface waters within a 1000' radius of the disturbance area of the proposed oil and gas location.

### Legend

- Proposed Well
- Disturbance Area
- 1000' Radius

### Reference Location

\*\* All Measurements are Made from Reference Well DAVIS 42-12 \*\*

Lat: 38.592585° Long: -103.286111° (NAD83)  
Elevation: 4761 Feet



Use our resources to find yours!  
[www.petro-fs.com](http://www.petro-fs.com)  
(303) 928-7128

Field Date: 05/09/2012  
Drafting Date: 05/22/2012  
Drafter: DMM  
Checked By: BHF

Data Sources:  
TOPO courtesy USGS

Prepared for:

**PIONEER**  
NATURAL RESOURCES

PIONEER NATURAL RESOURCES USA INC