



May 10, 2012

Mr. John Axelson  
Northeast Region Environmental Protection Specialist  
Colorado Oil and Gas Conservation Commission  
1120 Lincoln Street, Suite 801  
Denver, Colorado 80203

**RE: Groundwater Monitoring Report/No Further Action Request  
Petroleum Development Corporation  
Jason 1, 2, 34-31 Tank Battery  
API: 05-123-12387  
Spill #2213393  
Remediation #6010  
NWSE Sec. 31-T6N-R64W 6 PM  
Weld County, Colorado**

Dear Mr. Axelson:

LT Environmental, Inc. (LTE), under the direction of Petroleum Development Corporation (PDC), conducted groundwater sampling activities at the Jason 1, 2, 34-31 tank battery (Site) on January 30, 2012. This monitoring event comprises the fourth consecutive monitoring event at this Site with analytical results that are in compliance with Colorado Department of Public Health and Environment (CDPHE) Water Quality Control Commission (WQCC) Regulation 41 (Reg 41). The Site is located approximately 0.4 miles west of County Road 62½ and County Road 51 in Weld County, Colorado. The legal site description is the northwest quarter of the southeast quarter of Section 31, Township 6 North, and Range 64 West of the 6<sup>th</sup> Principal Meridian. A Site Location Map is provided as Figure 1.

### **Source Removal Activities**

During equipment upgrades at the Site in January and March 2011, PDC discovered impacted soil beneath the Site. The source of the release was determined to be a leaking condensate dump line. Once the dump line and on-site equipment were removed, approximately 530 cubic yards of impacted soil above Colorado Oil and Gas Conservation Commission (COGCC) Table 910-1 Concentration Levels were excavated and transported to the Waste Management landfill in Ault, Colorado for disposal.

Soil samples were collected from the extents of two separate excavations (SS01 through SS11) and submitted for laboratory analysis of benzene, toluene, ethylbenzene, and total xylenes (BTEX), total petroleum hydrocarbons (TPH)-gasoline range organics (GRO), and naphthalene by United States Environmental Protection Agency (EPA) Method 8260B and TPH-diesel range organics (DRO) by EPA Modified Method 8015. Laboratory results indicated BTEX, TPH-GRO, TPH-DRO, and naphthalene concentrations for all samples collected from the excavations



are below reporting limits and in compliance with COGCC Table 910-1 Concentration Levels (Table 1).

Groundwater samples were collected from the two excavations and from six downgradient potholes (GW01 through GW08) and submitted for analysis of BTEX by EPA Method 8260B (Figure 2). Laboratory results indicated the benzene concentration exceeded the CDPHE WQCC Reg 41 standard in GW01 and GW03 (Table 2). Analytical results also indicate the toluene concentration exceeded the CDPHE WQCC Reg 41 standard in GW01.

Before backfilling the excavations, activated carbon was applied to the groundwater and exposed smear zone soils to remediate residual hydrocarbons remaining in the excavations. A topographic map and a site map are provided as Figures 1 and 2. Soil and groundwater analytical results are summarized in Tables 1 and 2. The laboratory analytical reports are included as an attachment.

### **Quarterly Groundwater Monitoring**

Monitoring wells MW01 through MW05 were installed at the Site on April 11, 2011 (Figure 2). Following installation, each well was developed and purged. Groundwater samples were collected from the wells on a quarterly basis and submitted for laboratory analysis of BTEX by EPA Method 8260B from April 2011 through January 2012. Laboratory analytical results indicate BTEX levels in groundwater have been in compliance with CDPHE WQCC Reg 41 standards for four consecutive quarters. As soil and groundwater has now been remediated to achieve COGCC cleanup goals, PDC is requesting a No Further Action determination for the Site.

Should you have any questions, please contact Brandon Bruns with PDC at (303) 831-3971.

Sincerely,

LT ENVIRONMENTAL, INC.

Devin Girtin, G.I.T.  
Staff Geologist

Brian Dodek, P.G.  
Client Manager/Senior Geologist

Attachments:

Figure 1 – Site Location Map

Figure 2 – Site Map

Table 1 – Soil Sample Analytical Results

Table 2 – Groundwater Analytical Results

Attachment – Laboratory Analytical Reports

## **FIGURES**

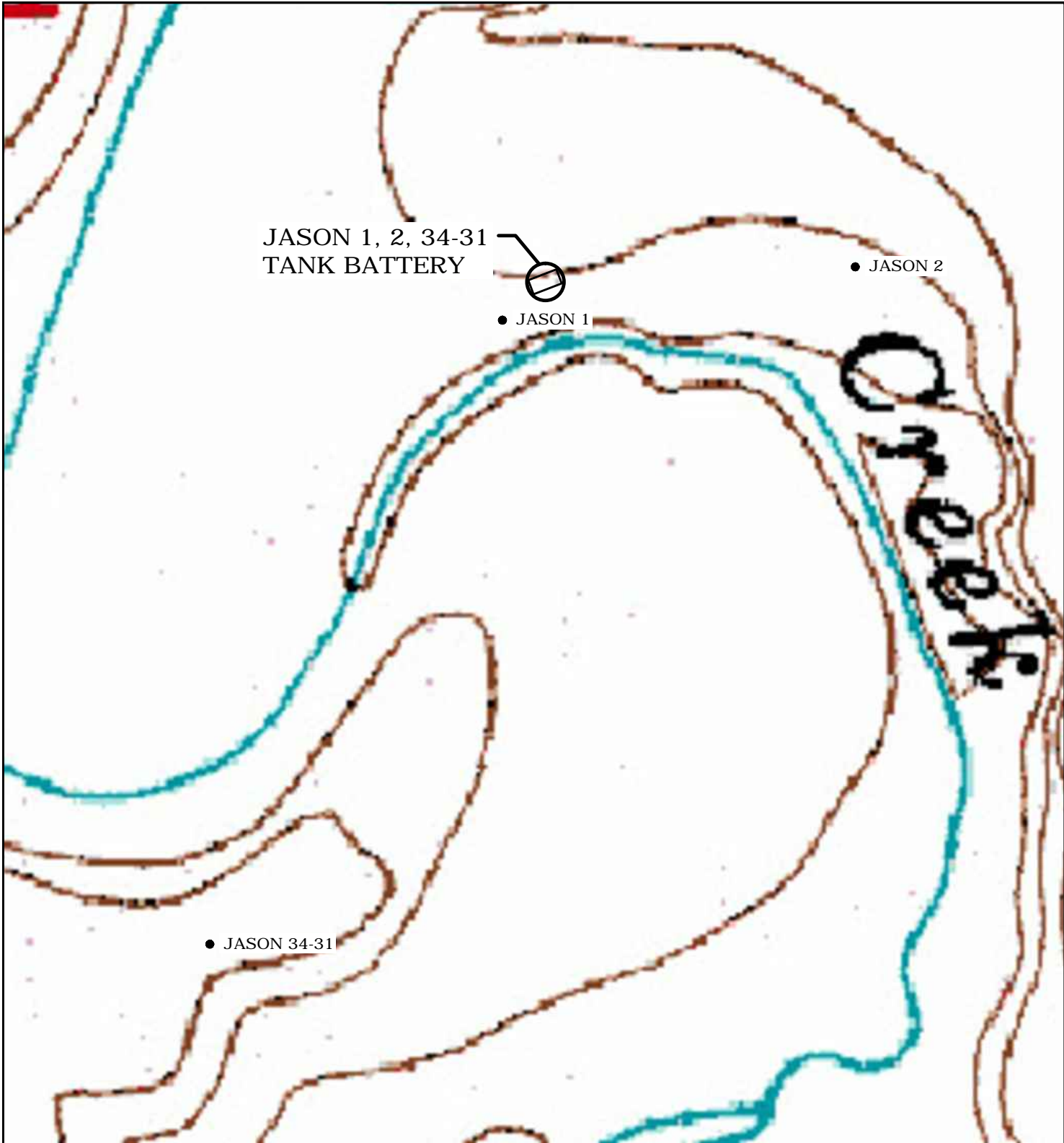

JASON 1, 2, 34-31  
TANK BATTERY

● JASON 2

● JASON 1

● JASON 34-31

LEGEND

- TANK BATTERY
- WELL

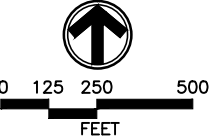

SOURCE: TOPOZONE.COM  
USGS 7.5" QUADRANGLE  
(NAD27)

FIGURE 1  
SITE LOCATION MAP  
JASON 1, 2, 34-31  
NWSE 31-T6N-R64W  
WELD COUNTY, CO  
PETROLEUM DEVELOPMENT CORPORATION



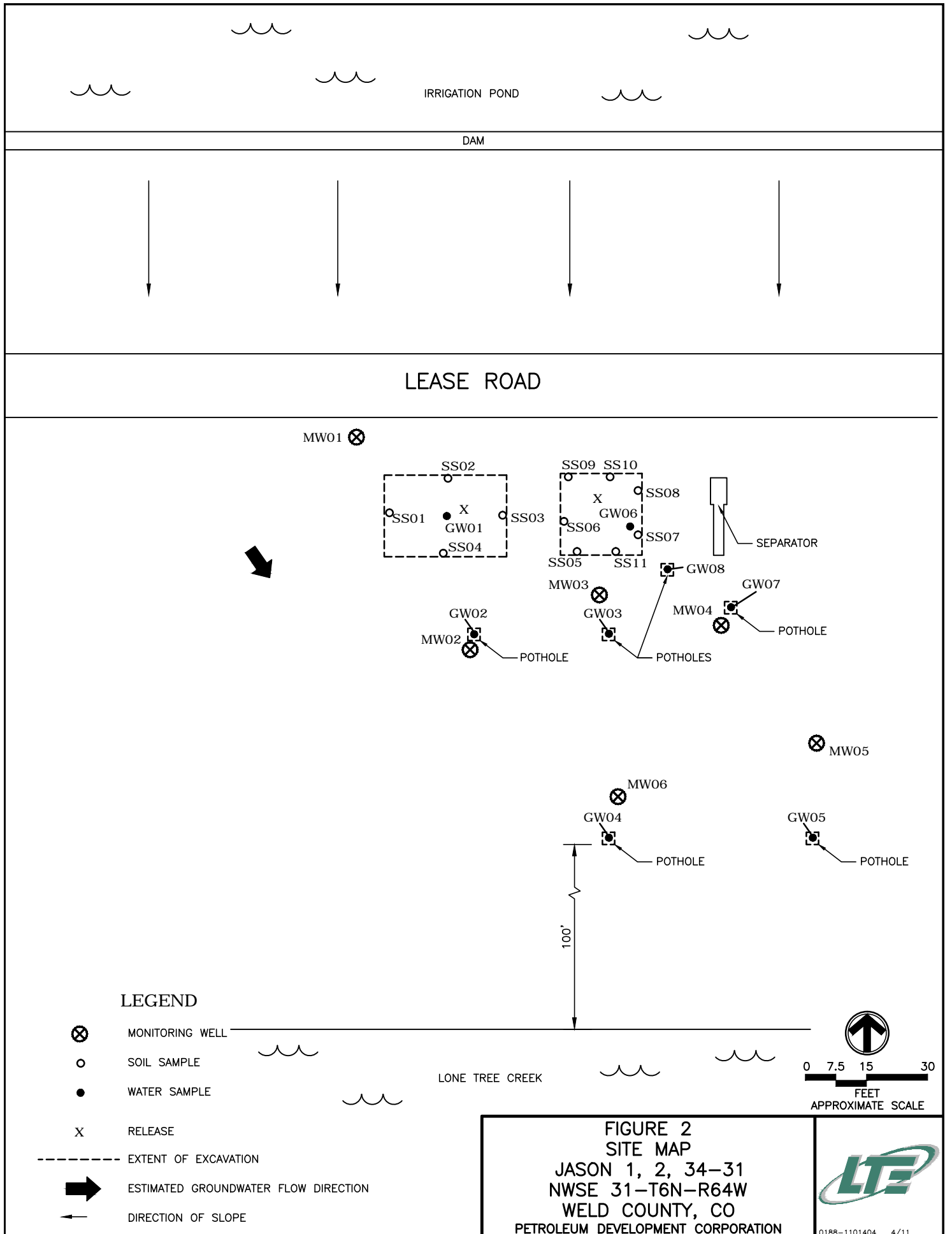

IRRIGATION POND

DAM

LEASE ROAD

MW01

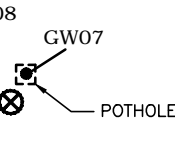
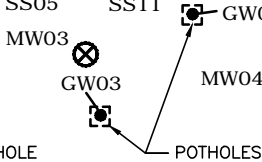
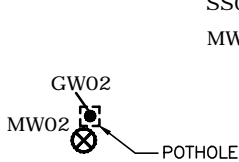
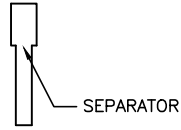
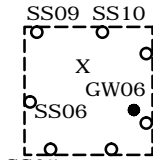
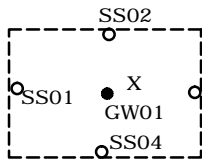

MW05

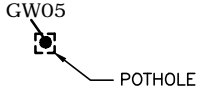
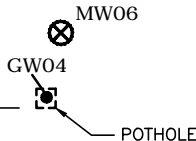

LEGEND

⊗ MONITORING WELL

○ SOIL SAMPLE

● WATER SAMPLE

X RELEASE

--- EXTENT OF EXCAVATION

➔ ESTIMATED GROUNDWATER FLOW DIRECTION

↔ DIRECTION OF SLOPE

LONE TREE CREEK

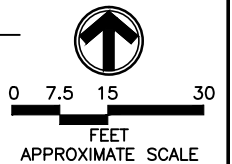

FIGURE 2  
 SITE MAP  
 JASON 1, 2, 34-31  
 NWSE 31-T6N-R64W  
 WELD COUNTY, CO  
 PETROLEUM DEVELOPMENT CORPORATION



## **TABLES**

**TABLE 1**  
**SOIL SAMPLE ANALYTICAL RESULTS**  
**JASON 1, 2, 34-31 (API No. 05-123-12387)**  
**WELD COUNTY, COLORADO**  
**PETROLEUM DEVELOPMENT CORPORATION**

Sample ID	Depth (ft bgs)	Date Sampled	Benzene (mg/kg)	Toluene (mg/kg)	Ethyl-benzene (mg/kg)	Total Xylenes (mg/kg)	Naphthalene (mg/kg)	TPH (mg/kg)
SS01	10	01/27/2011	<0.0050	<0.0050	<0.0050	<0.015	<0.0050	<50.5
SS02	9	01/27/2011	<0.0050	<0.0050	<0.0050	<0.015	<0.0050	<50.5
SS03	10	01/27/2011	<0.0050	<0.0050	<0.0050	<0.015	<0.0050	<50.5
SS04	10	01/27/2011	<0.0050	<0.0050	<0.0050	<0.015	<0.0050	<50.5
SS05	10	03/30/2011	<0.0050	<0.0050	<0.0050	<0.0050	<0.0050	<50.5
SS06	10	03/30/2011	<0.0050	<0.0050	<0.0050	<0.015	<0.0050	<50.5
SS07	10	03/30/2011	<0.0050	<0.0050	<0.0050	<0.015	<0.0050	<50.5
SS08	10	03/30/2011	<0.0050	<0.0050	<0.0050	<0.015	<0.0050	<50.5
SS09	10	03/30/2011	<0.0050	<0.0050	<0.0050	<0.015	<0.0050	<50.5
SS10	10	03/30/2011	<0.0050	<0.0050	<0.0050	<0.015	<0.0050	<50.5
SS11	10	03/31/2011	<0.0050	<0.0050	<0.0050	<0.015	<0.0050	<50.5
<b>Basic Standards for Soil</b>			<b>0.17</b>	<b>85</b>	<b>100</b>	<b>175</b>	<b>23</b>	<b>500</b>

**Notes:**

API - American Petroleum Institute

mg/kg - milligrams per kilogram

TPH - total petroleum hydrocarbons (C6-C28)

ft bgs - feet below ground surface

NA - not analyzed

< - less than stated laboratory reporting limit

Basic Standards for Soil are taken from 2 CCR 404-1, Table 910-1, effective April 1, 2009.

Bold indicates result equaled or exceeded standard.



**TABLE 2**  
**GROUNDWATER ANALYTICAL RESULTS**  
**JASON 1, 2, 34-31 (API No. 05-123-12387)**  
**WELD COUNTY, COLORADO**  
**PETROLEUM DEVELOPMENT CORPORATION**

Sample ID	Date Sampled	Benzene (ug/L)	Toluene (ug/L)	Ethyl-benzene (ug/L)	Total Xylenes (ug/L)	Depth to Water (ft btoc)
GW01	01/26/2011	<b>1400</b>	<b>2300</b>	65	680	NM
GW02	01/27/2011	<1.0	<1.0	<1.0	<1.0	NM
GW03	01/27/2011	<b>270</b>	<1.0	<1.0	<1.0	NM
GW04	02/04/2011	<1.0	<1.0	<1.0	<1.0	NM
GW05	02/04/2011	<1.0	<1.0	<1.0	<1.0	NM
GW06	03/30/2011	<1.0	<1.0	<1.0	<1.0	NM
GW07	03/30/2011	<1.0	<1.0	<1.0	<1.0	NM
GW08	03/30/2011	<1.0	<1.0	<1.0	<1.0	NM
MW01	04/12/2011	<1.0	<1.0	<1.0	<1.0	13.10
	07/19/2011	<1.0	<1.0	<1.0	<1.0	12.23
	10/18/2011	<1.0	<1.0	<1.0	<1.0	12.50
	01/30/2012	<1.0	<1.0	<1.0	<1.0	12.43
MW02	04/12/2011	<1.0	<1.0	<1.0	<1.0	9.47
	07/19/2011	<1.0	<1.0	<1.0	<1.0	9.50
	10/18/2011	<1.0	<1.0	<1.0	<1.0	9.75
	01/30/2012	<1.0	<1.0	<1.0	<1.0	9.68
MW03	04/12/2011	<1.0	<1.0	<1.0	<1.0	9.67
	07/19/2011	<1.0	<1.0	<1.0	<1.0	7.53
MW04	04/12/2011	<1.0	<1.0	<1.0	<1.0	6.91
	07/19/2011	<1.0	<1.0	<1.0	<1.0	6.84
	10/18/2011	<1.0	<1.0	<1.0	<1.0	6.94
	01/30/2012	<1.0	<1.0	<1.0	<1.0	6.89
MW05	04/12/2011	<1.0	<1.0	<1.0	<1.0	10.70
	07/19/2011	<1.0	<1.0	<1.0	<1.0	10.56
<b>Basic Standards for Groundwater:</b>		<b>5</b>	<b>560</b>	<b>700</b>	<b>1400</b>	

**Notes:**

API - American Petroleum Institute  
NA - not analyzed/not available  
ug/L - micrograms per Liter

ft btoc - feet below top of casing  
NM - not measured  
< - less than stated laboratory reporting limit

Basic Standards for Ground Water are from the Colorado Department of Health and Environment -  
Water Quality Control Commission Regulation 41, effective 4/1/2009.

Bold indicates result equaled or exceeded standard.



**ATTACHMENT**  
**LABORATORY ANALYTICAL REPORTS**

# Summit Scientific

---

741 Corporate Circle – Suite I ♦ Golden, Colorado 80401

303.277.9310 - laboratory ♦ 303.277.9531 - fax

February 13, 2012

Brian Dodek  
LT Environmental, Inc.  
4600 West 60th Avenue  
Arvada, CO 80003  
RE: PDC - Jason 1,2,34-31

Enclosed are the results of analyses for samples received by Summit Scientific on 01/31/12 17:00. If you have any questions concerning this report, please feel free to contact me.

Sincerely,



Paul Shrewsbury For Ben Shrewsbury  
President / Laboratory Director



LT Environmental, Inc.  
4600 West 60th Avenue  
Arvada CO, 80003

Project: PDC - Jason 1,2,34-31

Project Number: 0188-11014  
Project Manager: Brian Dodek

**Reported:**  
02/13/12 14:31

### ANALYTICAL REPORT FOR SAMPLES

Sample ID	Laboratory ID	Matrix	Date Sampled	Date Received
MW01	R202003-01	Water	01/30/12 15:30	01/31/12 17:00
MW02	R202003-02	Water	01/30/12 15:40	01/31/12 17:00
MW04	R202003-03	Water	01/30/12 15:50	01/31/12 17:00

Summit Scientific

*The results in this report apply to the samples analyzed in accordance with the chain of custody document. This analytical report must be reproduced in its entirety.*





LT Environmental, Inc.  
 4600 West 60th Avenue  
 Arvada CO, 80003

Project: PDC - Jason 1,2,34-31

Project Number: 0188-11014  
 Project Manager: Brian Dodek

**Reported:**  
 02/13/12 14:31

**MW01**  
**R202003-01 (Water)**

**Summit Scientific**

**Volatile Organic Compounds by EPA Method 8260B**

Date Sampled: **01/30/12 15:30**

Analyte	Result	Reporting Limit	Units	Dilution	Batch	Prepared	Analyzed	Method	Notes
Benzene	ND	1.0	ug/l	1	2021003	02/10/12	02/11/12	EPA 8260B	
Toluene	ND	1.0	"	"	"	"	"	"	
Ethylbenzene	ND	1.0	"	"	"	"	"	"	
Xylenes (total)	ND	1.0	"	"	"	"	"	"	

Date Sampled: **01/30/12 15:30**

Analyte	Result	Reporting Limit	Units	Dilution	Batch	Prepared	Analyzed	Method	Notes
Surrogate: 1,2-Dichloroethane-d4		89.2 %	57.9-139		"	"	"	"	
Surrogate: Toluene-d8		95.3 %	83.1-115		"	"	"	"	
Surrogate: 4-Bromofluorobenzene		90.3 %	80.8-120		"	"	"	"	

Summit Scientific

*The results in this report apply to the samples analyzed in accordance with the chain of custody document. This analytical report must be reproduced in its entirety.*



LT Environmental, Inc.  
 4600 West 60th Avenue  
 Arvada CO, 80003

Project: PDC - Jason 1,2,34-31

Project Number: 0188-11014  
 Project Manager: Brian Dodek

**Reported:**  
 02/13/12 14:31

**MW02**  
**R202003-02 (Water)**

**Summit Scientific**

**Volatile Organic Compounds by EPA Method 8260B**

Date Sampled: **01/30/12 15:40**

Analyte	Result	Reporting Limit	Units	Dilution	Batch	Prepared	Analyzed	Method	Notes
Benzene	ND	1.0	ug/l	1	2021003	02/10/12	02/11/12	EPA 8260B	
Toluene	ND	1.0	"	"	"	"	"	"	
Ethylbenzene	ND	1.0	"	"	"	"	"	"	
Xylenes (total)	ND	1.0	"	"	"	"	"	"	

Date Sampled: **01/30/12 15:40**

Analyte	Result	Reporting Limit	Units	Dilution	Batch	Prepared	Analyzed	Method	Notes
<i>Surrogate: 1,2-Dichloroethane-d4</i>		93.9 %	57.9-139		"	"	"	"	
<i>Surrogate: Toluene-d8</i>		97.7 %	83.1-115		"	"	"	"	
<i>Surrogate: 4-Bromofluorobenzene</i>		90.4 %	80.8-120		"	"	"	"	

Summit Scientific

*The results in this report apply to the samples analyzed in accordance with the chain of custody document. This analytical report must be reproduced in its entirety.*



LT Environmental, Inc.  
 4600 West 60th Avenue  
 Arvada CO, 80003

Project: PDC - Jason 1,2,34-31

Project Number: 0188-11014  
 Project Manager: Brian Dodek

**Reported:**  
 02/13/12 14:31

**MW04**  
**R202003-03 (Water)**

**Summit Scientific**

**Volatile Organic Compounds by EPA Method 8260B**

Date Sampled: **01/30/12 15:50**

Analyte	Result	Reporting Limit	Units	Dilution	Batch	Prepared	Analyzed	Method	Notes
Benzene	ND	1.0	ug/l	1	2021003	02/10/12	02/11/12	EPA 8260B	
Toluene	ND	1.0	"	"	"	"	"	"	
Ethylbenzene	ND	1.0	"	"	"	"	"	"	
Xylenes (total)	ND	1.0	"	"	"	"	"	"	

Date Sampled: **01/30/12 15:50**

Analyte	Result	Reporting Limit	Units	Dilution	Batch	Prepared	Analyzed	Method	Notes
<i>Surrogate: 1,2-Dichloroethane-d4</i>		89.6 %	57.9-139		"	"	"	"	
<i>Surrogate: Toluene-d8</i>		94.1 %	83.1-115		"	"	"	"	
<i>Surrogate: 4-Bromofluorobenzene</i>		91.7 %	80.8-120		"	"	"	"	

Summit Scientific

*The results in this report apply to the samples analyzed in accordance with the chain of custody document. This analytical report must be reproduced in its entirety.*



LT Environmental, Inc.  
4600 West 60th Avenue  
Arvada CO, 80003

Project: PDC - Jason 1,2,34-31

Project Number: 0188-11014  
Project Manager: Brian Dodek

**Reported:**  
02/13/12 14:31

### Volatile Organic Compounds by EPA Method 8260B - Quality Control

#### Summit Scientific

Analyte	Reporting			Spike Level	Source		%REC		RPD		Notes
	Result	Limit	Units		Result	%REC	Limits	RPD	Limit		

#### Batch 2021003 - EPA 5030 Water MS

##### Blank (2021003-BLK1)

Prepared & Analyzed: 02/10/12

Benzene	ND	1.0	ug/l								
Toluene	ND	1.0	"								
Ethylbenzene	ND	1.0	"								
Xylenes (total)	ND	1.0	"								
Surrogate: 1,2-Dichloroethane-d4	11.9		"	13.2	90.2	57.9-139					
Surrogate: Toluene-d8	12.8		"	13.3	95.9	83.1-115					
Surrogate: 4-Bromofluorobenzene	11.8		"	13.3	88.9	80.8-120					

##### Blank (2021003-BLK2)

Prepared & Analyzed: 02/10/12

Benzene	ND	1.0	ug/l								
Toluene	ND	1.0	"								
Ethylbenzene	ND	1.0	"								
Xylenes (total)	ND	1.0	"								
Surrogate: 1,2-Dichloroethane-d4	12.0		"	13.2	90.6	57.9-139					
Surrogate: Toluene-d8	12.7		"	13.3	95.0	83.1-115					
Surrogate: 4-Bromofluorobenzene	12.4		"	13.3	92.8	80.8-120					

##### LCS (2021003-BS1)

Prepared & Analyzed: 02/10/12

Benzene	26.3	1.0	ug/l	33.3	79.0	60.1-131			10.9		
Toluene	27.9	1.0	"	33.3	83.6	65.9-127			11.3		
Ethylbenzene	26.4	1.0	"	33.3	79.2	65.1-129			20		
m,p-Xylene	57.6	2.0	"	66.7	86.4	66.8-127			20		
o-Xylene	29.0	1.0	"	33.3	87.1	61.2-120			20		
Surrogate: 1,2-Dichloroethane-d4	12.1		"	13.2	91.3	57.9-139					
Surrogate: Toluene-d8	12.8		"	13.3	96.3	83.1-115					
Surrogate: 4-Bromofluorobenzene	12.2		"	13.3	91.7	80.8-120					

##### LCS (2021003-BS2)

Prepared & Analyzed: 02/10/12

Benzene	27.3	1.0	ug/l	33.3	81.9	60.1-131			10.9		
Toluene	29.0	1.0	"	33.3	87.0	65.9-127			11.3		
Ethylbenzene	27.1	1.0	"	33.3	81.2	65.1-129			20		
m,p-Xylene	58.6	2.0	"	66.7	87.8	66.8-127			20		
o-Xylene	29.8	1.0	"	33.3	89.5	61.2-120			20		
Surrogate: 1,2-Dichloroethane-d4	12.2		"	13.2	92.1	57.9-139					
Surrogate: Toluene-d8	13.1		"	13.3	98.5	83.1-115					
Surrogate: 4-Bromofluorobenzene	12.3		"	13.3	92.2	80.8-120					

Summit Scientific

The results in this report apply to the samples analyzed in accordance with the chain of custody document. This analytical report must be reproduced in its entirety.



LT Environmental, Inc.  
4600 West 60th Avenue  
Arvada CO, 80003

Project: PDC - Jason 1,2,34-31

Project Number: 0188-11014  
Project Manager: Brian Dodek

**Reported:**  
02/13/12 14:31

**Volatile Organic Compounds by EPA Method 8260B - Quality Control**  
**Summit Scientific**

Analyte	Reporting			Spike	Source	%REC			RPD	Notes
	Result	Limit	Units	Level	Result	%REC	Limits	RPD	Limit	

**Batch 2021003 - EPA 5030 Water MS**

**LCS Dup (2021003-BSD1)**

Prepared & Analyzed: 02/10/12

Benzene	27.5	1.0	ug/l	33.3		82.6	60.1-131	4.53	10.9	
Toluene	29.1	1.0	"	33.3		87.4	65.9-127	4.46	11.3	
Ethylbenzene	27.2	1.0	"	33.3		81.5	65.1-129	2.76	20	
m,p-Xylene	58.9	2.0	"	66.7		88.4	66.8-127	2.25	20	
o-Xylene	29.8	1.0	"	33.3		89.5	61.2-120	2.72	20	
Surrogate: 1,2-Dichloroethane-d4	12.3		"	13.2		92.8	57.9-139			
Surrogate: Toluene-d8	13.4		"	13.3		101	83.1-115			
Surrogate: 4-Bromofluorobenzene	12.4		"	13.3		93.2	80.8-120			

**LCS Dup (2021003-BSD2)**

Prepared & Analyzed: 02/10/12

Benzene	27.6	1.0	ug/l	33.3		82.7	60.1-131	0.984	10.9	
Toluene	29.0	1.0	"	33.3		87.0	65.9-127	0.00	11.3	
Ethylbenzene	28.2	1.0	"	33.3		84.5	65.1-129	3.95	20	
m,p-Xylene	61.1	2.0	"	66.7		91.6	66.8-127	4.21	20	
o-Xylene	30.8	1.0	"	33.3		92.3	61.2-120	3.00	20	
Surrogate: 1,2-Dichloroethane-d4	12.2		"	13.2		92.2	57.9-139			
Surrogate: Toluene-d8	13.2		"	13.3		98.9	83.1-115			
Surrogate: 4-Bromofluorobenzene	12.5		"	13.3		93.7	80.8-120			

**Matrix Spike (2021003-MS1)**

Source: R201214-01

Prepared & Analyzed: 02/10/12

Benzene	28.3	1.0	ug/l	33.3	ND	84.8	52.7-130		19.3	
Toluene	29.9	1.0	"	33.3	ND	89.8	57-127		18.7	
Ethylbenzene	27.9	1.0	"	33.3	ND	83.6	59.2-127		20	
m,p-Xylene	60.9	2.0	"	66.7	ND	91.3	53.2-132		20	
o-Xylene	30.8	1.0	"	33.3	ND	92.3	56.3-117		20	
Surrogate: 1,2-Dichloroethane-d4	12.2		"	13.2		92.4	57.9-139			
Surrogate: Toluene-d8	13.2		"	13.3		99.3	83.1-115			
Surrogate: 4-Bromofluorobenzene	12.2		"	13.3		91.1	80.8-120			

Summit Scientific

The results in this report apply to the samples analyzed in accordance with the chain of custody document. This analytical report must be reproduced in its entirety.



LT Environmental, Inc.  
4600 West 60th Avenue  
Arvada CO, 80003

Project: PDC - Jason 1,2,34-31

Project Number: 0188-11014  
Project Manager: Brian Dodek

**Reported:**  
02/13/12 14:31

**Volatile Organic Compounds by EPA Method 8260B - Quality Control**  
**Summit Scientific**

Analyte	Reporting			Spike	Source		%REC		RPD	Notes
	Result	Limit	Units	Level	Result	%REC	Limits	RPD	Limit	

**Batch 2021003 - EPA 5030 Water MS**

**Matrix Spike (2021003-MS2)**

Source: R201214-02 Prepared: 02/10/12 Analyzed: 02/11/12

Benzene	27.1	1.0	ug/l	33.3	ND	81.4	52.7-130		19.3	
Toluene	28.7	1.0	"	33.3	ND	86.1	57-127		18.7	
Ethylbenzene	27.2	1.0	"	33.3	ND	81.8	59.2-127		20	
m,p-Xylene	58.9	2.0	"	66.7	ND	88.4	53.2-132		20	
o-Xylene	29.5	1.0	"	33.3	ND	88.6	56.3-117		20	
Surrogate: 1,2-Dichloroethane-d4	12.3		"	13.2		93.2	57.9-139			
Surrogate: Toluene-d8	13.2		"	13.3		98.6	83.1-115			
Surrogate: 4-Bromofluorobenzene	12.5		"	13.3		93.8	80.8-120			

**Matrix Spike Dup (2021003-MSD1)**

Source: R201214-01 Prepared: 02/10/12 Analyzed: 02/11/12

Benzene	27.8	1.0	ug/l	33.3	ND	83.5	52.7-130	1.53	19.3	
Toluene	29.6	1.0	"	33.3	ND	88.9	57-127	0.974	18.7	
Ethylbenzene	27.6	1.0	"	33.3	ND	82.9	59.2-127	0.901	20	
m,p-Xylene	59.9	2.0	"	66.7	ND	89.8	53.2-132	1.69	20	
o-Xylene	30.3	1.0	"	33.3	ND	90.9	56.3-117	1.51	20	
Surrogate: 1,2-Dichloroethane-d4	12.3		"	13.2		93.1	57.9-139			
Surrogate: Toluene-d8	13.4		"	13.3		100	83.1-115			
Surrogate: 4-Bromofluorobenzene	12.4		"	13.3		93.4	80.8-120			

**Matrix Spike Dup (2021003-MSD2)**

Source: R201214-02 Prepared: 02/10/12 Analyzed: 02/11/12

Benzene	27.6	1.0	ug/l	33.3	ND	82.7	52.7-130	1.61	19.3	
Toluene	29.3	1.0	"	33.3	ND	87.8	57-127	1.90	18.7	
Ethylbenzene	26.7	1.0	"	33.3	ND	80.2	59.2-127	1.96	20	
m,p-Xylene	57.9	2.0	"	66.7	ND	86.9	53.2-132	1.71	20	
o-Xylene	29.0	1.0	"	33.3	ND	87.1	56.3-117	1.78	20	
Surrogate: 1,2-Dichloroethane-d4	12.5		"	13.2		94.2	57.9-139			
Surrogate: Toluene-d8	13.2		"	13.3		99.1	83.1-115			
Surrogate: 4-Bromofluorobenzene	12.2		"	13.3		91.7	80.8-120			

Summit Scientific

The results in this report apply to the samples analyzed in accordance with the chain of custody document. This analytical report must be reproduced in its entirety.



LT Environmental, Inc.  
4600 West 60th Avenue  
Arvada CO, 80003

Project: PDC - Jason 1,2,34-31

Project Number: 0188-11014  
Project Manager: Brian Dodek

**Reported:**  
02/13/12 14:31

### Notes and Definitions

DET Analyte DETECTED  
ND Analyte NOT DETECTED at or above the reporting limit  
NR Not Reported  
dry Sample results reported on a dry weight basis  
RPD Relative Percent Difference

---

Summit Scientific

*The results in this report apply to the samples analyzed in accordance with the chain of custody document. This analytical report must be reproduced in its entirety.*

# Summit Scientific

---

741 Corporate Circle – Suite I ♦ Golden, Colorado 80401

303.277.9310 - laboratory ♦ 303.277.9531 - fax

October 21, 2011

Brian Dodek  
LT Environmental, Inc.  
4600 West 60th Avenue  
Arvada, CO 80003  
RE: PDC - Jason 1,2,34-31

Enclosed are the results of analyses for samples received by Summit Scientific on 10/18/11 16:55. If you have any questions concerning this report, please feel free to contact me.

Sincerely,



Paul Shrewsbury For Ben Shrewsbury  
President / Laboratory Director



LT Environmental, Inc.  
4600 West 60th Avenue  
Arvada CO, 80003

Project: PDC - Jason 1,2,34-31

Project Number: 0188-11014  
Project Manager: Brian Dodek

**Reported:**  
10/21/11 09:07

### ANALYTICAL REPORT FOR SAMPLES

Sample ID	Laboratory ID	Matrix	Date Sampled	Date Received
MW01	R110111-01	Water	10/18/11 13:15	10/18/11 16:55
MW02	R110111-02	Water	10/18/11 13:40	10/18/11 16:55
MW04	R110111-03	Water	10/18/11 13:30	10/18/11 16:55

Summit Scientific

*The results in this report apply to the samples analyzed in accordance with the chain of custody document. This analytical report must be reproduced in its entirety.*





LT Environmental, Inc.  
 4600 West 60th Avenue  
 Arvada CO, 80003

Project: PDC - Jason 1,2,34-31

Project Number: 0188-11014  
 Project Manager: Brian Dodek

**Reported:**  
 10/21/11 09:07

**MW01**  
**R110111-01 (Water)**

**Summit Scientific**

**Volatile Organic Compounds by EPA Method 8260B**

Date Sampled: 10/18/11 13:15

Analyte	Result	Reporting Limit	Units	Dilution	Batch	Prepared	Analyzed	Method	Notes
Benzene	ND	1.0	ug/l	1	1101909	10/19/11	10/20/11	EPA 8260B	
Toluene	ND	1.0	"	"	"	"	"	"	
Ethylbenzene	ND	1.0	"	"	"	"	"	"	
Xylenes (total)	ND	1.0	"	"	"	"	"	"	

Date Sampled: 10/18/11 13:15

Analyte	Result	Reporting Limit	Units	Dilution	Batch	Prepared	Analyzed	Method	Notes
Surrogate: 1,2-Dichloroethane-d4		84.7 %	57.9-139		"	"	"	"	
Surrogate: Toluene-d8		95.6 %	83.1-115		"	"	"	"	
Surrogate: 4-Bromofluorobenzene		97.1 %	80.8-120		"	"	"	"	

Summit Scientific

*The results in this report apply to the samples analyzed in accordance with the chain of custody document. This analytical report must be reproduced in its entirety.*



LT Environmental, Inc.  
 4600 West 60th Avenue  
 Arvada CO, 80003

Project: PDC - Jason 1,2,34-31

Project Number: 0188-11014  
 Project Manager: Brian Dodek

**Reported:**  
 10/21/11 09:07

**MW02**  
**R110111-02 (Water)**

**Summit Scientific**

**Volatile Organic Compounds by EPA Method 8260B**

Date Sampled: **10/18/11 13:40**

Analyte	Result	Reporting Limit	Units	Dilution	Batch	Prepared	Analyzed	Method	Notes
Benzene	ND	1.0	ug/l	1	1101909	10/19/11	10/20/11	EPA 8260B	
Toluene	ND	1.0	"	"	"	"	"	"	
Ethylbenzene	ND	1.0	"	"	"	"	"	"	
Xylenes (total)	ND	1.0	"	"	"	"	"	"	

Date Sampled: **10/18/11 13:40**

Analyte	Result	Reporting Limit	Units	Dilution	Batch	Prepared	Analyzed	Method	Notes
<i>Surrogate: 1,2-Dichloroethane-d4</i>		85.1 %	57.9-139		"	"	"	"	
<i>Surrogate: Toluene-d8</i>		97.0 %	83.1-115		"	"	"	"	
<i>Surrogate: 4-Bromofluorobenzene</i>		96.2 %	80.8-120		"	"	"	"	

Summit Scientific

*The results in this report apply to the samples analyzed in accordance with the chain of custody document. This analytical report must be reproduced in its entirety.*



LT Environmental, Inc.  
 4600 West 60th Avenue  
 Arvada CO, 80003

Project: PDC - Jason 1,2,34-31

Project Number: 0188-11014  
 Project Manager: Brian Dodek

**Reported:**  
 10/21/11 09:07

**MW04**  
**R110111-03 (Water)**

**Summit Scientific**

**Volatile Organic Compounds by EPA Method 8260B**

Date Sampled: **10/18/11 13:30**

Analyte	Result	Reporting Limit	Units	Dilution	Batch	Prepared	Analyzed	Method	Notes
Benzene	ND	1.0	ug/l	1	1101909	10/19/11	10/20/11	EPA 8260B	
Toluene	ND	1.0	"	"	"	"	"	"	
Ethylbenzene	ND	1.0	"	"	"	"	"	"	
Xylenes (total)	ND	1.0	"	"	"	"	"	"	

Date Sampled: **10/18/11 13:30**

Analyte	Result	Reporting Limit	Units	Dilution	Batch	Prepared	Analyzed	Method	Notes
<i>Surrogate: 1,2-Dichloroethane-d4</i>		86.0 %	57.9-139		"	"	"	"	
<i>Surrogate: Toluene-d8</i>		96.2 %	83.1-115		"	"	"	"	
<i>Surrogate: 4-Bromofluorobenzene</i>		96.1 %	80.8-120		"	"	"	"	

Summit Scientific

*The results in this report apply to the samples analyzed in accordance with the chain of custody document. This analytical report must be reproduced in its entirety.*



LT Environmental, Inc.  
4600 West 60th Avenue  
Arvada CO, 80003

Project: PDC - Jason 1,2,34-31

Project Number: 0188-11014  
Project Manager: Brian Dodek

**Reported:**  
10/21/11 09:07

**Volatile Organic Compounds by EPA Method 8260B - Quality Control**

**Summit Scientific**

Analyte	Reporting			Spike	Source	%REC		RPD		Notes
	Result	Limit	Units	Level	Result	%REC	Limits	RPD	Limit	

**Batch 1101909 - EPA 5030 Water MS**

**Blank (1101909-BLK1)**

Prepared & Analyzed: 10/19/11

Benzene	ND	1.0	ug/l							
Toluene	ND	1.0	"							
Ethylbenzene	ND	1.0	"							
Xylenes (total)	ND	1.0	"							
Surrogate: 1,2-Dichloroethane-d4	15.5		"	13.3		116	57.9-139			
Surrogate: Toluene-d8	13.6		"	13.3		102	83.1-115			
Surrogate: 4-Bromofluorobenzene	13.8		"	13.3		103	80.8-120			

**LCS (1101909-BS1)**

Prepared & Analyzed: 10/19/11

Benzene	32.9	1.0	ug/l	33.3		98.8	60.1-131		10.9	
Toluene	33.0	1.0	"	33.3		99.0	65.9-127		11.3	
Ethylbenzene	31.6	1.0	"	33.3		94.8	65.1-129		20	
m,p-Xylene	62.8	2.0	"	66.7		94.3	66.8-127		20	
o-Xylene	32.2	1.0	"	33.3		96.6	61.2-120		20	
Surrogate: 1,2-Dichloroethane-d4	14.8		"	13.3		111	57.9-139			
Surrogate: Toluene-d8	13.4		"	13.3		101	83.1-115			
Surrogate: 4-Bromofluorobenzene	13.1		"	13.3		98.1	80.8-120			

**LCS Dup (1101909-BSD1)**

Prepared & Analyzed: 10/19/11

Benzene	33.8	1.0	ug/l	33.3		101	60.1-131	2.46	10.9	
Toluene	33.4	1.0	"	33.3		100	65.9-127	1.29	11.3	
Ethylbenzene	32.7	1.0	"	33.3		98.0	65.1-129	3.33	20	
m,p-Xylene	65.2	2.0	"	66.7		97.7	66.8-127	3.61	20	
o-Xylene	33.3	1.0	"	33.3		99.8	61.2-120	3.27	20	
Surrogate: 1,2-Dichloroethane-d4	14.4		"	13.3		108	57.9-139			
Surrogate: Toluene-d8	13.2		"	13.3		99.2	83.1-115			
Surrogate: 4-Bromofluorobenzene	13.0		"	13.3		97.2	80.8-120			

Summit Scientific

The results in this report apply to the samples analyzed in accordance with the chain of custody document. This analytical report must be reproduced in its entirety.



LT Environmental, Inc.  
4600 West 60th Avenue  
Arvada CO, 80003

Project: PDC - Jason 1,2,34-31

Project Number: 0188-11014  
Project Manager: Brian Dodek

**Reported:**  
10/21/11 09:07

**Volatile Organic Compounds by EPA Method 8260B - Quality Control**  
**Summit Scientific**

Analyte	Reporting			Spike	Source		%REC		RPD	Notes
	Result	Limit	Units	Level	Result	%REC	Limits	RPD	Limit	

**Batch 1101909 - EPA 5030 Water MS**

<b>Matrix Spike (1101909-MS1)</b>	<b>Source: R110107-01</b>			<b>Prepared &amp; Analyzed: 10/19/11</b>						
Benzene	34.8	1.0	ug/l	33.3	ND	104	52.7-130		19.3	
Toluene	35.2	1.0	"	33.3	ND	106	57-127		18.7	
Ethylbenzene	34.3	1.0	"	33.3	ND	103	59.2-127		20	
m,p-Xylene	68.2	2.0	"	66.7	ND	102	53.2-132		20	
o-Xylene	34.1	1.0	"	33.3	ND	102	56.3-117		20	
<i>Surrogate: 1,2-Dichloroethane-d4</i>	<i>11.3</i>		<i>"</i>	<i>13.3</i>		<i>84.9</i>	<i>57.9-139</i>			
<i>Surrogate: Toluene-d8</i>	<i>13.5</i>		<i>"</i>	<i>13.3</i>		<i>101</i>	<i>83.1-115</i>			
<i>Surrogate: 4-Bromofluorobenzene</i>	<i>12.7</i>		<i>"</i>	<i>13.3</i>		<i>95.0</i>	<i>80.8-120</i>			

<b>Matrix Spike Dup (1101909-MSD1)</b>	<b>Source: R110107-01</b>			<b>Prepared &amp; Analyzed: 10/19/11</b>						
Benzene	33.9	1.0	ug/l	33.3	ND	102	52.7-130	2.59	19.3	
Toluene	34.3	1.0	"	33.3	ND	103	57-127	2.45	18.7	
Ethylbenzene	34.5	1.0	"	33.3	ND	103	59.2-127	0.465	20	
m,p-Xylene	69.1	2.0	"	66.7	ND	104	53.2-132	1.27	20	
o-Xylene	34.7	1.0	"	33.3	ND	104	56.3-117	1.86	20	
<i>Surrogate: 1,2-Dichloroethane-d4</i>	<i>10.9</i>		<i>"</i>	<i>13.3</i>		<i>82.0</i>	<i>57.9-139</i>			
<i>Surrogate: Toluene-d8</i>	<i>13.1</i>		<i>"</i>	<i>13.3</i>		<i>98.0</i>	<i>83.1-115</i>			
<i>Surrogate: 4-Bromofluorobenzene</i>	<i>12.7</i>		<i>"</i>	<i>13.3</i>		<i>95.5</i>	<i>80.8-120</i>			

Summit Scientific

*The results in this report apply to the samples analyzed in accordance with the chain of custody document. This analytical report must be reproduced in its entirety.*



LT Environmental, Inc.  
4600 West 60th Avenue  
Arvada CO, 80003

Project: PDC - Jason 1,2,34-31

Project Number: 0188-11014  
Project Manager: Brian Dodek

**Reported:**  
10/21/11 09:07

### Notes and Definitions

DET Analyte DETECTED  
ND Analyte NOT DETECTED at or above the reporting limit  
NR Not Reported  
dry Sample results reported on a dry weight basis  
RPD Relative Percent Difference

---

Summit Scientific

*The results in this report apply to the samples analyzed in accordance with the chain of custody document. This analytical report must be reproduced in its entirety.*

# Summit Scientific

---

741 Corporate Circle – Suite I ♦ Golden, Colorado 80401

303.277.9310 - laboratory ♦ 303.277.9531 - fax

August 28, 2011

Brian Dodek  
LT Environmental, Inc.  
4600 West 60th Avenue  
Arvada, CO 80003  
RE: PDC - Jason1,2,34-31

Enclosed are the results of analyses for samples received by Summit Scientific on 08/26/11 17:00. If you have any questions concerning this report, please feel free to contact me.

Sincerely,



Paul Shrewsbury For Ben Shrewsbury  
President / Laboratory Director



LT Environmental, Inc.  
4600 West 60th Avenue  
Arvada CO, 80003

Project: PDC - Jason1,2,34-31

Project Number: 0188-11014.005  
Project Manager: Brian Dodek

**Reported:**  
08/28/11 17:23

### ANALYTICAL REPORT FOR SAMPLES

Sample ID	Laboratory ID	Matrix	Date Sampled	Date Received
SS01	R108175-01	Soil	08/26/11 14:50	08/26/11 17:00
SS02	R108175-02	Soil	08/26/11 14:55	08/26/11 17:00
SS03	R108175-03	Soil	08/26/11 15:00	08/26/11 17:00
SS04	R108175-04	Soil	08/26/11 15:05	08/26/11 17:00
FS01	R108175-05	Soil	08/26/11 15:10	08/26/11 17:00

Summit Scientific

*The results in this report apply to the samples analyzed in accordance with the chain of custody document. This analytical report must be reproduced in its entirety.*





LT Environmental, Inc.  
4600 West 60th Avenue  
Arvada CO, 80003

Project: PDC - Jason1,2,34-31

Project Number: 0188-11014.005  
Project Manager: Brian Dodek

**Reported:**  
08/28/11 17:23

**SS01**  
**R108175-01 (Soil)**

**Summit Scientific**

**Extractable Petroleum Hydrocarbons by 8015**

Date Sampled: **08/26/11 14:50**

Analyte	Result	Reporting Limit	Units	Dilution	Batch	Prepared	Analyzed	Method	Notes
C10-C28 (DRO)	ND	50	mg/kg	1	1082607	08/26/11	08/27/11	8015 Full Carbon Chain	

Date Sampled: **08/26/11 14:50**

Analyte	Result	Reporting Limit	Units	Dilution	Batch	Prepared	Analyzed	Method	Notes
Surrogate: <i>o</i> -Terphenyl		103 %	88.8-124		"	"	"	"	

**Volatile Organic Compounds by EPA Method 8260B**

Date Sampled: **08/26/11 14:50**

Analyte	Result	Reporting Limit	Units	Dilution	Batch	Prepared	Analyzed	Method	Notes
Naphthalene	ND	0.0050	mg/kg	1	1082606	08/26/11	08/27/11	EPA 8260B	
Benzene	ND	0.0050	"	"	"	"	"	"	
Toluene	ND	0.0050	"	"	"	"	"	"	
Ethylbenzene	ND	0.0050	"	"	"	"	"	"	
m,p-Xylene	ND	0.010	"	"	"	"	"	"	
<i>o</i> -Xylene	ND	0.0050	"	"	"	"	"	"	
Gasoline Range Hydrocarbons	ND	0.50	"	"	"	"	"	"	

Date Sampled: **08/26/11 14:50**

Analyte	Result	Reporting Limit	Units	Dilution	Batch	Prepared	Analyzed	Method	Notes
Surrogate: 1,2-Dichloroethane-d4		118 %	67.4-143		"	"	"	"	
Surrogate: Toluene-d8		92.1 %	77.3-114		"	"	"	"	
Surrogate: 4-Bromofluorobenzene		93.2 %	78.4-125		"	"	"	"	

Summit Scientific

The results in this report apply to the samples analyzed in accordance with the chain of custody document. This analytical report must be reproduced in its entirety.



LT Environmental, Inc.  
4600 West 60th Avenue  
Arvada CO, 80003

Project: PDC - Jason1,2,34-31

Project Number: 0188-11014.005  
Project Manager: Brian Dodek

**Reported:**  
08/28/11 17:23

**SS02**  
**R108175-02 (Soil)**

**Summit Scientific**

**Extractable Petroleum Hydrocarbons by 8015**

Date Sampled: **08/26/11 14:55**

Analyte	Result	Reporting Limit	Units	Dilution	Batch	Prepared	Analyzed	Method	Notes
C10-C28 (DRO)	ND	50	mg/kg	1	1082607	08/26/11	08/27/11	8015 Full Carbon Chain	

Date Sampled: **08/26/11 14:55**

Analyte	Result	Reporting Limit	Units	Dilution	Batch	Prepared	Analyzed	Method	Notes
Surrogate: <i>o</i> -Terphenyl		102 %	88.8-124		"	"	"	"	

**Volatile Organic Compounds by EPA Method 8260B**

Date Sampled: **08/26/11 14:55**

Analyte	Result	Reporting Limit	Units	Dilution	Batch	Prepared	Analyzed	Method	Notes
Naphthalene	ND	0.0050	mg/kg	1	1082606	08/26/11	08/27/11	EPA 8260B	
Benzene	ND	0.0050	"	"	"	"	"	"	
Toluene	ND	0.0050	"	"	"	"	"	"	
Ethylbenzene	ND	0.0050	"	"	"	"	"	"	
m,p-Xylene	ND	0.010	"	"	"	"	"	"	
o-Xylene	ND	0.0050	"	"	"	"	"	"	
Gasoline Range Hydrocarbons	ND	0.50	"	"	"	"	"	"	

Date Sampled: **08/26/11 14:55**

Analyte	Result	Reporting Limit	Units	Dilution	Batch	Prepared	Analyzed	Method	Notes
Surrogate: 1,2-Dichloroethane-d4		108 %	67.4-143		"	"	"	"	
Surrogate: Toluene-d8		81.4 %	77.3-114		"	"	"	"	
Surrogate: 4-Bromofluorobenzene		104 %	78.4-125		"	"	"	"	

Summit Scientific

The results in this report apply to the samples analyzed in accordance with the chain of custody document. This analytical report must be reproduced in its entirety.



LT Environmental, Inc.  
4600 West 60th Avenue  
Arvada CO, 80003

Project: PDC - Jason1,2,34-31

Project Number: 0188-11014.005  
Project Manager: Brian Dodek

**Reported:**  
08/28/11 17:23

**SS03**  
**R108175-03 (Soil)**

**Summit Scientific**

**Extractable Petroleum Hydrocarbons by 8015**

Date Sampled: **08/26/11 15:00**

Analyte	Result	Reporting Limit	Units	Dilution	Batch	Prepared	Analyzed	Method	Notes
C10-C28 (DRO)	ND	50	mg/kg	1	1082607	08/26/11	08/27/11	8015 Full Carbon Chain	

Date Sampled: **08/26/11 15:00**

Analyte	Result	Reporting Limit	Units	Dilution	Batch	Prepared	Analyzed	Method	Notes
Surrogate: <i>o</i> -Terphenyl		101 %	88.8-124		"	"	"	"	

**Volatile Organic Compounds by EPA Method 8260B**

Date Sampled: **08/26/11 15:00**

Analyte	Result	Reporting Limit	Units	Dilution	Batch	Prepared	Analyzed	Method	Notes
Naphthalene	ND	0.0050	mg/kg	1	1082606	08/26/11	08/27/11	EPA 8260B	
Benzene	ND	0.0050	"	"	"	"	"	"	
Toluene	ND	0.0050	"	"	"	"	"	"	
Ethylbenzene	ND	0.0050	"	"	"	"	"	"	
m,p-Xylene	ND	0.010	"	"	"	"	"	"	
o-Xylene	ND	0.0050	"	"	"	"	"	"	
Gasoline Range Hydrocarbons	ND	0.50	"	"	"	"	"	"	

Date Sampled: **08/26/11 15:00**

Analyte	Result	Reporting Limit	Units	Dilution	Batch	Prepared	Analyzed	Method	Notes
Surrogate: 1,2-Dichloroethane-d4		99.0 %	67.4-143		"	"	"	"	
Surrogate: Toluene-d8		88.0 %	77.3-114		"	"	"	"	
Surrogate: 4-Bromofluorobenzene		100 %	78.4-125		"	"	"	"	

Summit Scientific

The results in this report apply to the samples analyzed in accordance with the chain of custody document. This analytical report must be reproduced in its entirety.



LT Environmental, Inc.  
4600 West 60th Avenue  
Arvada CO, 80003

Project: PDC - Jason1,2,34-31

Project Number: 0188-11014.005  
Project Manager: Brian Dodek

**Reported:**  
08/28/11 17:23

**SS04**  
**R108175-04 (Soil)**

**Summit Scientific**

**Extractable Petroleum Hydrocarbons by 8015**

Date Sampled: **08/26/11 15:05**

Analyte	Result	Reporting Limit	Units	Dilution	Batch	Prepared	Analyzed	Method	Notes
C10-C28 (DRO)	ND	50	mg/kg	1	1082607	08/26/11	08/27/11	8015 Full Carbon Chain	

Date Sampled: **08/26/11 15:05**

Analyte	Result	Reporting Limit	Units	Dilution	Batch	Prepared	Analyzed	Method	Notes
Surrogate: <i>o</i> -Terphenyl		103 %	88.8-124		"	"	"	"	

**Volatile Organic Compounds by EPA Method 8260B**

Date Sampled: **08/26/11 15:05**

Analyte	Result	Reporting Limit	Units	Dilution	Batch	Prepared	Analyzed	Method	Notes
Naphthalene	ND	0.0050	mg/kg	1	1082606	08/26/11	08/27/11	EPA 8260B	
Benzene	ND	0.0050	"	"	"	"	"	"	
Toluene	ND	0.0050	"	"	"	"	"	"	
Ethylbenzene	ND	0.0050	"	"	"	"	"	"	
m,p-Xylene	ND	0.010	"	"	"	"	"	"	
o-Xylene	ND	0.0050	"	"	"	"	"	"	
Gasoline Range Hydrocarbons	ND	0.50	"	"	"	"	"	"	

Date Sampled: **08/26/11 15:05**

Analyte	Result	Reporting Limit	Units	Dilution	Batch	Prepared	Analyzed	Method	Notes
Surrogate: 1,2-Dichloroethane-d4		102 %	67.4-143		"	"	"	"	
Surrogate: Toluene-d8		71.6 %	77.3-114		"	"	"	"	
Surrogate: 4-Bromofluorobenzene		104 %	78.4-125		"	"	"	"	

Summit Scientific

The results in this report apply to the samples analyzed in accordance with the chain of custody document. This analytical report must be reproduced in its entirety.



LT Environmental, Inc.  
4600 West 60th Avenue  
Arvada CO, 80003

Project: PDC - Jason1,2,34-31

Project Number: 0188-11014.005  
Project Manager: Brian Dodek

**Reported:**  
08/28/11 17:23

**FS01**  
**R108175-05 (Soil)**

**Summit Scientific**

**Extractable Petroleum Hydrocarbons by 8015**

Date Sampled: **08/26/11 15:10**

Analyte	Result	Reporting Limit	Units	Dilution	Batch	Prepared	Analyzed	Method	Notes
C10-C28 (DRO)	ND	50	mg/kg	1	1082607	08/26/11	08/27/11	8015 Full Carbon Chain	

Date Sampled: **08/26/11 15:10**

Analyte	Result	Reporting Limit	Units	Dilution	Batch	Prepared	Analyzed	Method	Notes
Surrogate: <i>o</i> -Terphenyl		104 %	88.8-124		"	"	"	"	

**Volatile Organic Compounds by EPA Method 8260B**

Date Sampled: **08/26/11 15:10**

Analyte	Result	Reporting Limit	Units	Dilution	Batch	Prepared	Analyzed	Method	Notes
Naphthalene	ND	0.0050	mg/kg	1	1082606	08/26/11	08/27/11	EPA 8260B	
Benzene	ND	0.0050	"	"	"	"	"	"	
Toluene	ND	0.0050	"	"	"	"	"	"	
Ethylbenzene	ND	0.0050	"	"	"	"	"	"	
m,p-Xylene	ND	0.010	"	"	"	"	"	"	
o-Xylene	ND	0.0050	"	"	"	"	"	"	
Gasoline Range Hydrocarbons	ND	0.50	"	"	"	"	"	"	

Date Sampled: **08/26/11 15:10**

Analyte	Result	Reporting Limit	Units	Dilution	Batch	Prepared	Analyzed	Method	Notes
Surrogate: 1,2-Dichloroethane-d4		126 %	67.4-143		"	"	"	"	
Surrogate: Toluene-d8		98.6 %	77.3-114		"	"	"	"	
Surrogate: 4-Bromofluorobenzene		96.5 %	78.4-125		"	"	"	"	

Summit Scientific

The results in this report apply to the samples analyzed in accordance with the chain of custody document. This analytical report must be reproduced in its entirety.



LT Environmental, Inc.  
4600 West 60th Avenue  
Arvada CO, 80003

Project: PDC - Jason1,2,34-31

Project Number: 0188-11014.005  
Project Manager: Brian Dodek

**Reported:**  
08/28/11 17:23

**Extractable Petroleum Hydrocarbons by 8015 - Quality Control**  
**Summit Scientific**

Analyte	Reporting			Spike Level	Source		%REC		RPD		Notes
	Result	Limit	Units		Result	%REC	Limits	RPD	Limit		

**Batch 1082607 - EPA 3550A**

<b>Blank (1082607-BLK1)</b>				Prepared & Analyzed: 08/26/11							
C10-C28 (DRO)	ND	50	mg/kg								
<i>Surrogate: o-Terphenyl</i>	<i>13.0</i>		<i>"</i>	<i>12.5</i>	<i>104</i>	<i>88.8-124</i>					
<b>LCS (1082607-BS1)</b>				Prepared: 08/26/11 Analyzed: 08/27/11							
C10-C28 (DRO)	527	50	mg/kg	501	105	81.4-129				9.26	
<b>LCS Dup (1082607-BSD1)</b>				Prepared: 08/26/11 Analyzed: 08/27/11							
C10-C28 (DRO)	488	50	mg/kg	501	97.4	81.4-129	7.61			9.26	
<b>Matrix Spike (1082607-MS1)</b>				Source: R108175-01 Prepared: 08/26/11 Analyzed: 08/27/11							
C10-C28 (DRO)	492	50	mg/kg	501	29.8	92.4	77.8-133			8.48	
<b>Matrix Spike Dup (1082607-MSD1)</b>				Source: R108175-01 Prepared: 08/26/11 Analyzed: 08/27/11							
C10-C28 (DRO)	459	50	mg/kg	501	29.8	85.7	77.8-133	7.01		8.48	

Summit Scientific

*The results in this report apply to the samples analyzed in accordance with the chain of custody document. This analytical report must be reproduced in its entirety.*



LT Environmental, Inc.  
4600 West 60th Avenue  
Arvada CO, 80003

Project: PDC - Jason1,2,34-31

Project Number: 0188-11014.005  
Project Manager: Brian Dodek

**Reported:**  
08/28/11 17:23

**Volatile Organic Compounds by EPA Method 8260B - Quality Control**  
**Summit Scientific**

Analyte	Reporting			Spike	Source	%REC			RPD	Notes
	Result	Limit	Units	Level	Result	%REC	Limits	RPD	Limit	

**Batch 1082606 - EPA 5030 Soil MS**

**Blank (1082606-BLK1)**

Prepared: 08/26/11 Analyzed: 08/27/11

Naphthalene	ND	0.0050	mg/kg							
Benzene	ND	0.0050	"							
Toluene	ND	0.0050	"							
Ethylbenzene	ND	0.0050	"							
m,p-Xylene	ND	0.010	"							
o-Xylene	ND	0.0050	"							
Gasoline Range Hydrocarbons	ND	0.50	"							
<i>Surrogate: 1,2-Dichloroethane-d4</i>	<i>0.0449</i>		<i>"</i>	<i>0.0400</i>		<i>112</i>	<i>67.4-143</i>			
<i>Surrogate: Toluene-d8</i>	<i>0.0394</i>		<i>"</i>	<i>0.0400</i>		<i>98.4</i>	<i>77.3-114</i>			
<i>Surrogate: 4-Bromofluorobenzene</i>	<i>0.0377</i>		<i>"</i>	<i>0.0400</i>		<i>94.4</i>	<i>78.4-125</i>			

**LCS (1082606-BS1)**

Prepared: 08/26/11 Analyzed: 08/27/11

Naphthalene	ND	0.0050	mg/kg				67.8-151		20	
Benzene	0.100	0.0050	"	0.100		100	61-139	2.10	11.1	
Toluene	0.105	0.0050	"	0.100		105	64-132	2.56	10.9	
Ethylbenzene	0.115	0.0050	"	0.100		115	68.7-135	4.31	20	
m,p-Xylene	0.228	0.010	"	0.200		114	70.4-129	3.16	20	
o-Xylene	0.108	0.0050	"	0.100		108	66.9-126	3.42	20	
<i>Surrogate: 1,2-Dichloroethane-d4</i>	<i>0.0449</i>		<i>"</i>	<i>0.0400</i>		<i>112</i>	<i>67.4-143</i>			
<i>Surrogate: Toluene-d8</i>	<i>0.0389</i>		<i>"</i>	<i>0.0400</i>		<i>97.3</i>	<i>77.3-114</i>			
<i>Surrogate: 4-Bromofluorobenzene</i>	<i>0.0382</i>		<i>"</i>	<i>0.0400</i>		<i>95.4</i>	<i>78.4-125</i>			

**LCS Dup (1082606-BSD1)**

Prepared: 08/26/11 Analyzed: 08/27/11

Naphthalene	ND	0.0050	mg/kg				67.8-151		20	
Benzene	0.102	0.0050	"	0.100		102	61-139	2.10	11.1	
Toluene	0.108	0.0050	"	0.100		108	64-132	2.56	10.9	
Ethylbenzene	0.120	0.0050	"	0.100		120	68.7-135	4.31	20	
m,p-Xylene	0.235	0.010	"	0.200		118	70.4-129	3.16	20	
o-Xylene	0.112	0.0050	"	0.100		112	66.9-126	3.42	20	
<i>Surrogate: 1,2-Dichloroethane-d4</i>	<i>0.0458</i>		<i>"</i>	<i>0.0400</i>		<i>115</i>	<i>67.4-143</i>			
<i>Surrogate: Toluene-d8</i>	<i>0.0395</i>		<i>"</i>	<i>0.0400</i>		<i>98.8</i>	<i>77.3-114</i>			
<i>Surrogate: 4-Bromofluorobenzene</i>	<i>0.0402</i>		<i>"</i>	<i>0.0400</i>		<i>100</i>	<i>78.4-125</i>			

Summit Scientific

*The results in this report apply to the samples analyzed in accordance with the chain of custody document. This analytical report must be reproduced in its entirety.*



LT Environmental, Inc.  
4600 West 60th Avenue  
Arvada CO, 80003

Project: PDC - Jason1,2,34-31

Project Number: 0188-11014.005  
Project Manager: Brian Dodek

**Reported:**  
08/28/11 17:23

**Volatile Organic Compounds by EPA Method 8260B - Quality Control**  
**Summit Scientific**

Analyte	Reporting			Spike	Source		%REC		RPD	
	Result	Limit	Units	Level	Result	%REC	Limits	RPD	Limit	Notes

**Batch 1082606 - EPA 5030 Soil MS**

**Matrix Spike (1082606-MS1)**

Source: R108175-01 Prepared: 08/26/11 Analyzed: 08/27/11

Naphthalene	ND	0.0050	mg/kg	0.00	0.00		26.4-144		20	
Benzene	0.0997	0.0050	"	0.100	0.00	99.7	42.9-137		17.9	
Toluene	0.102	0.0050	"	0.100	0.00	102	42.6-130		11.9	
Ethylbenzene	0.112	0.0050	"	0.100	0.00	112	39-133		20	
m,p-Xylene	0.223	0.010	"	0.200	0.00	112	34.7-134		20	
o-Xylene	0.106	0.0050	"	0.100	0.00	106	41.3-126		20	
Surrogate: 1,2-Dichloroethane-d4	0.0476		"	0.0400		119	67.4-143			
Surrogate: Toluene-d8	0.0381		"	0.0400		95.3	77.3-114			
Surrogate: 4-Bromofluorobenzene	0.0409		"	0.0400		102	78.4-125			

**Matrix Spike Dup (1082606-MSD1)**

Source: R108175-01 Prepared: 08/26/11 Analyzed: 08/27/11

Naphthalene	ND	0.0050	mg/kg	0.00	0.00		26.4-144		20	
Benzene	0.103	0.0050	"	0.100	0.00	103	42.9-137	3.26	17.9	
Toluene	0.105	0.0050	"	0.100	0.00	105	42.6-130	2.78	11.9	
Ethylbenzene	0.115	0.0050	"	0.100	0.00	115	39-133	2.52	20	
m,p-Xylene	0.224	0.010	"	0.200	0.00	112	34.7-134	0.523	20	
o-Xylene	0.109	0.0050	"	0.100	0.00	109	41.3-126	2.77	20	
Surrogate: 1,2-Dichloroethane-d4	0.0507		"	0.0400		127	67.4-143			
Surrogate: Toluene-d8	0.0400		"	0.0400		99.9	77.3-114			
Surrogate: 4-Bromofluorobenzene	0.0402		"	0.0400		100	78.4-125			

Summit Scientific

The results in this report apply to the samples analyzed in accordance with the chain of custody document. This analytical report must be reproduced in its entirety.



LT Environmental, Inc.  
4600 West 60th Avenue  
Arvada CO, 80003

Project: PDC - Jason1,2,34-31

Project Number: 0188-11014.005  
Project Manager: Brian Dodek

**Reported:**  
08/28/11 17:23

### Notes and Definitions

DET Analyte DETECTED  
ND Analyte NOT DETECTED at or above the reporting limit  
NR Not Reported  
dry Sample results reported on a dry weight basis  
RPD Relative Percent Difference

---

Summit Scientific

*The results in this report apply to the samples analyzed in accordance with the chain of custody document. This analytical report must be reproduced in its entirety.*

# Summit Scientific

---

741 Corporate Circle – Suite I ♦ Golden, Colorado 80401

303.277.9310 - laboratory ♦ 303.277.9531 - fax

July 25, 2011

Brian Dodek  
LT Environmental, Inc.  
4600 West 60th Avenue  
Arvada, CO 80003  
RE: PDC - Jason1,2,34-31

Enclosed are the results of analyses for samples received by Summit Scientific on 07/19/11 16:45. If you have any questions concerning this report, please feel free to contact me.

Sincerely,



Paul Shrewsbury For Ben Shrewsbury  
President / Laboratory Director



LT Environmental, Inc.  
4600 West 60th Avenue  
Arvada CO, 80003

Project: PDC - Jason1,2,34-31

Project Number: 0188-11014  
Project Manager: Brian Dodek

**Reported:**  
07/25/11 08:31

### ANALYTICAL REPORT FOR SAMPLES

Sample ID	Laboratory ID	Matrix	Date Sampled	Date Received
MW01	R107112-01	Water	07/19/11 11:45	07/19/11 16:45
MW02	R107112-02	Water	07/19/11 11:50	07/19/11 16:45
MW03	R107112-03	Water	07/19/11 11:55	07/19/11 16:45
MW04	R107112-04	Water	07/19/11 12:00	07/19/11 16:45
MW05	R107112-05	Water	07/19/11 12:05	07/19/11 16:45

Summit Scientific

*The results in this report apply to the samples analyzed in accordance with the chain of custody document. This analytical report must be reproduced in its entirety.*



LT Environmental, Inc.  
4600 West 60th Avenue  
Arvada CO, 80003

Project: PDC - Jason1,2,34-31

Project Number: 0188-11014  
Project Manager: Brian Dodek

Reported:  
07/25/11 08:31

R107112

# Summit Scientific

741 Corporate Circle Suite 1 • Golden, Colorado 80401  
303-277-9310 • 303-277-9531 Fax

Page 1 of 1

Client: LT Environmental, Inc. Project Manager: Brian Dodek  
Address: 4600 West 60th Avenue E-Mail: bdodek@ltenv.com  
City/State/Zip: Arvada, CO 80003 Project Name: Jason 1,2,34-31  
Phone: (303) 433-9788 Fax: (303) 433-1432 Project Number: 018811014  
Sampler Name: J. Kagan

Sample Description	Date Sampled	Time Sampled	Number of Containers	Preservative				Matrix				Analyze For:				Special Instructions	Notes		
				HCl	HNO <sub>3</sub>	None	Other (Specify)	Groundwater	Soil	Air - Canister Serial #	Other (Specify)	DRO	GBTX	BTEX	Table 9.10 Full			Table 9.10 Short	PH / EC
M1001	7/19	1145	3	X	X			X	X	X									
M1002		1150	3	X	X			X	X	X									
M1003		1155	3	X	X			X	X	X									
M1004		1200	3	X	X			X	X	X									
M1005		1205	3	X	X			X	X	X									
Relinquished by:	Date/Time:	7/19/11	1645	Received by:	Date/Time:	7/19/11		Turn Around Time (Check)											
Relinquished by:	Date/Time:			Received by:	Date/Time:			Same Day	24 Hours	48 Hours									
Relinquished by:	Date/Time:			Received in Lab by:	Date/Time:			Sample Integrity:											
								Temperature Upon Receipt:											
								Inact:											

www.szscientific.com



LT Environmental, Inc.  
 4600 West 60th Avenue  
 Arvada CO, 80003

Project: PDC - Jason1,2,34-31

Project Number: 0188-11014  
 Project Manager: Brian Dodek

**Reported:**  
 07/25/11 08:31

**MW01**  
**R107112-01 (Water)**

**Summit Scientific**

**Volatile Organic Compounds by EPA Method 8260B**

Date Sampled: 07/19/11 11:45

Analyte	Result	Reporting Limit	Units	Dilution	Batch	Prepared	Analyzed	Method	Notes
Benzene	ND	1.0	ug/l	1	1072106	07/21/11	07/22/11	EPA 8260B	
Toluene	ND	1.0	"	"	"	"	"	"	
Ethylbenzene	ND	1.0	"	"	"	"	"	"	
Xylenes (total)	ND	1.0	"	"	"	"	"	"	

Date Sampled: 07/19/11 11:45

Analyte	Result	Reporting Limit	Units	Dilution	Batch	Prepared	Analyzed	Method	Notes
Surrogate: 1,2-Dichloroethane-d4		101 %	57.9-139		"	"	"	"	
Surrogate: Toluene-d8		92.5 %	83.1-115		"	"	"	"	
Surrogate: 4-Bromofluorobenzene		97.9 %	80.8-120		"	"	"	"	

Summit Scientific

*The results in this report apply to the samples analyzed in accordance with the chain of custody document. This analytical report must be reproduced in its entirety.*



LT Environmental, Inc.  
 4600 West 60th Avenue  
 Arvada CO, 80003

Project: PDC - Jason1,2,34-31

Project Number: 0188-11014  
 Project Manager: Brian Dodek

**Reported:**  
 07/25/11 08:31

**MW02**  
**R107112-02 (Water)**

**Summit Scientific**

**Volatile Organic Compounds by EPA Method 8260B**

Date Sampled: **07/19/11 11:50**

Analyte	Result	Reporting Limit	Units	Dilution	Batch	Prepared	Analyzed	Method	Notes
Benzene	ND	1.0	ug/l	1	1072106	07/21/11	07/22/11	EPA 8260B	
Toluene	ND	1.0	"	"	"	"	"	"	
Ethylbenzene	ND	1.0	"	"	"	"	"	"	
Xylenes (total)	ND	1.0	"	"	"	"	"	"	

Date Sampled: **07/19/11 11:50**

Analyte	Result	Reporting Limit	Units	Dilution	Batch	Prepared	Analyzed	Method	Notes
<i>Surrogate: 1,2-Dichloroethane-d4</i>		102 %	57.9-139		"	"	"	"	
<i>Surrogate: Toluene-d8</i>		93.6 %	83.1-115		"	"	"	"	
<i>Surrogate: 4-Bromofluorobenzene</i>		101 %	80.8-120		"	"	"	"	

Summit Scientific

*The results in this report apply to the samples analyzed in accordance with the chain of custody document. This analytical report must be reproduced in its entirety.*



LT Environmental, Inc.  
 4600 West 60th Avenue  
 Arvada CO, 80003

Project: PDC - Jason1,2,34-31

Project Number: 0188-11014  
 Project Manager: Brian Dodek

**Reported:**  
 07/25/11 08:31

**MW03**  
**R107112-03 (Water)**

**Summit Scientific**

**Volatile Organic Compounds by EPA Method 8260B**

Date Sampled: **07/19/11 11:55**

Analyte	Result	Reporting Limit	Units	Dilution	Batch	Prepared	Analyzed	Method	Notes
Benzene	ND	1.0	ug/l	1	1072106	07/21/11	07/22/11	EPA 8260B	
Toluene	ND	1.0	"	"	"	"	"	"	
Ethylbenzene	ND	1.0	"	"	"	"	"	"	
Xylenes (total)	ND	1.0	"	"	"	"	"	"	

Date Sampled: **07/19/11 11:55**

Analyte	Result	Reporting Limit	Units	Dilution	Batch	Prepared	Analyzed	Method	Notes
<i>Surrogate: 1,2-Dichloroethane-d4</i>		104 %	57.9-139		"	"	"	"	
<i>Surrogate: Toluene-d8</i>		94.1 %	83.1-115		"	"	"	"	
<i>Surrogate: 4-Bromofluorobenzene</i>		99.9 %	80.8-120		"	"	"	"	

Summit Scientific

*The results in this report apply to the samples analyzed in accordance with the chain of custody document. This analytical report must be reproduced in its entirety.*



LT Environmental, Inc.  
 4600 West 60th Avenue  
 Arvada CO, 80003

Project: PDC - Jason1,2,34-31

Project Number: 0188-11014  
 Project Manager: Brian Dodek

**Reported:**  
 07/25/11 08:31

**MW04**  
**R107112-04 (Water)**

**Summit Scientific**

**Volatile Organic Compounds by EPA Method 8260B**

Date Sampled: **07/19/11 12:00**

Analyte	Result	Reporting Limit	Units	Dilution	Batch	Prepared	Analyzed	Method	Notes
Benzene	ND	1.0	ug/l	1	1072106	07/21/11	07/22/11	EPA 8260B	
Toluene	ND	1.0	"	"	"	"	"	"	
Ethylbenzene	ND	1.0	"	"	"	"	"	"	
Xylenes (total)	ND	1.0	"	"	"	"	"	"	

Date Sampled: **07/19/11 12:00**

Analyte	Result	Reporting Limit	Units	Dilution	Batch	Prepared	Analyzed	Method	Notes
<i>Surrogate: 1,2-Dichloroethane-d4</i>		105 %	57.9-139		"	"	"	"	
<i>Surrogate: Toluene-d8</i>		95.2 %	83.1-115		"	"	"	"	
<i>Surrogate: 4-Bromofluorobenzene</i>		97.8 %	80.8-120		"	"	"	"	

Summit Scientific

*The results in this report apply to the samples analyzed in accordance with the chain of custody document. This analytical report must be reproduced in its entirety.*



LT Environmental, Inc.  
 4600 West 60th Avenue  
 Arvada CO, 80003

Project: PDC - Jason1,2,34-31

Project Number: 0188-11014  
 Project Manager: Brian Dodek

**Reported:**  
 07/25/11 08:31

**MW05**  
**R107112-05 (Water)**

**Summit Scientific**

**Volatile Organic Compounds by EPA Method 8260B**

Date Sampled: **07/19/11 12:05**

Analyte	Result	Reporting Limit	Units	Dilution	Batch	Prepared	Analyzed	Method	Notes
Benzene	ND	1.0	ug/l	1	1072106	07/21/11	07/22/11	EPA 8260B	
Toluene	ND	1.0	"	"	"	"	"	"	
Ethylbenzene	ND	1.0	"	"	"	"	"	"	
Xylenes (total)	ND	1.0	"	"	"	"	"	"	

Date Sampled: **07/19/11 12:05**

Analyte	Result	Reporting Limit	Units	Dilution	Batch	Prepared	Analyzed	Method	Notes
<i>Surrogate: 1,2-Dichloroethane-d4</i>		101 %	57.9-139		"	"	"	"	
<i>Surrogate: Toluene-d8</i>		92.4 %	83.1-115		"	"	"	"	
<i>Surrogate: 4-Bromofluorobenzene</i>		95.6 %	80.8-120		"	"	"	"	

Summit Scientific

*The results in this report apply to the samples analyzed in accordance with the chain of custody document. This analytical report must be reproduced in its entirety.*



LT Environmental, Inc.  
4600 West 60th Avenue  
Arvada CO, 80003

Project: PDC - Jason1,2,34-31

Project Number: 0188-11014  
Project Manager: Brian Dodek

**Reported:**  
07/25/11 08:31

**Volatile Organic Compounds by EPA Method 8260B - Quality Control**

**Summit Scientific**

Analyte	Reporting			Spike	Source	%REC		RPD		Notes
	Result	Limit	Units	Level	Result	%REC	Limits	RPD	Limit	

**Batch 1072106 - EPA 5030 Water MS**

**Blank (1072106-BLK1)**

Prepared: 07/21/11 Analyzed: 07/22/11

Benzene	ND	1.0	ug/l							
Toluene	ND	1.0	"							
Ethylbenzene	ND	1.0	"							
Xylenes (total)	ND	1.0	"							
Surrogate: 1,2-Dichloroethane-d4	13.0		"	13.3		97.8	57.9-139			
Surrogate: Toluene-d8	12.4		"	13.3		93.2	83.1-115			
Surrogate: 4-Bromofluorobenzene	13.2		"	13.3		99.4	80.8-120			

**LCS (1072106-BS1)**

Prepared: 07/21/11 Analyzed: 07/22/11

Benzene	30.1	1.0	ug/l	33.3		90.4	60.1-131		10.9	
Toluene	29.4	1.0	"	33.3		88.1	65.9-127		11.3	
Ethylbenzene	32.4	1.0	"	33.3		97.1	65.1-129		20	
m,p-Xylene	65.9	2.0	"	66.7		98.8	66.8-127		20	
o-Xylene	33.2	1.0	"	33.3		99.6	61.2-120		20	
Surrogate: 1,2-Dichloroethane-d4	13.4		"	13.3		100	57.9-139			
Surrogate: Toluene-d8	12.6		"	13.3		94.9	83.1-115			
Surrogate: 4-Bromofluorobenzene	12.9		"	13.3		96.6	80.8-120			

**LCS Dup (1072106-BSD1)**

Prepared: 07/21/11 Analyzed: 07/22/11

Benzene	30.4	1.0	ug/l	33.3		91.4	60.1-131	1.02	10.9	
Toluene	30.1	1.0	"	33.3		90.4	65.9-127	2.56	11.3	
Ethylbenzene	31.8	1.0	"	33.3		95.3	65.1-129	1.87	20	
m,p-Xylene	65.1	2.0	"	66.7		97.7	66.8-127	1.15	20	
o-Xylene	32.2	1.0	"	33.3		96.7	61.2-120	3.00	20	
Surrogate: 1,2-Dichloroethane-d4	13.3		"	13.3		99.7	57.9-139			
Surrogate: Toluene-d8	12.8		"	13.3		95.8	83.1-115			
Surrogate: 4-Bromofluorobenzene	12.9		"	13.3		97.1	80.8-120			

Summit Scientific

The results in this report apply to the samples analyzed in accordance with the chain of custody document. This analytical report must be reproduced in its entirety.



LT Environmental, Inc.  
4600 West 60th Avenue  
Arvada CO, 80003

Project: PDC - Jason1,2,34-31

Project Number: 0188-11014  
Project Manager: Brian Dodek

**Reported:**  
07/25/11 08:31

**Volatile Organic Compounds by EPA Method 8260B - Quality Control**  
**Summit Scientific**

Analyte	Reporting			Spike	Source		%REC		RPD		Notes
	Result	Limit	Units	Level	Result	%REC	Limits	RPD	Limit		

**Batch 1072106 - EPA 5030 Water MS**

<b>Matrix Spike (1072106-MS1)</b>	<b>Source: R107111-01</b>			<b>Prepared: 07/21/11</b>		<b>Analyzed: 07/22/11</b>					
Benzene	31.0	1.0	ug/l	33.3	ND	92.9	52.7-130			19.3	
Toluene	29.8	1.0	"	33.3	ND	89.4	57-127			18.7	
Ethylbenzene	32.5	1.0	"	33.3	ND	97.5	59.2-127			20	
m,p-Xylene	66.9	2.0	"	66.7	ND	100	53.2-132			20	
o-Xylene	33.6	1.0	"	33.3	ND	101	56.3-117			20	
<i>Surrogate: 1,2-Dichloroethane-d4</i>	<i>13.6</i>		<i>"</i>	<i>13.3</i>		<i>102</i>	<i>57.9-139</i>				
<i>Surrogate: Toluene-d8</i>	<i>12.6</i>		<i>"</i>	<i>13.3</i>		<i>94.6</i>	<i>83.1-115</i>				
<i>Surrogate: 4-Bromofluorobenzene</i>	<i>13.1</i>		<i>"</i>	<i>13.3</i>		<i>98.6</i>	<i>80.8-120</i>				
<b>Matrix Spike Dup (1072106-MSD1)</b>	<b>Source: R107111-01</b>			<b>Prepared: 07/21/11</b>		<b>Analyzed: 07/22/11</b>					
Benzene	31.1	1.0	ug/l	33.3	ND	93.4	52.7-130	0.548		19.3	
Toluene	30.6	1.0	"	33.3	ND	91.8	57-127	2.68		18.7	
Ethylbenzene	32.8	1.0	"	33.3	ND	98.6	59.2-127	1.10		20	
m,p-Xylene	66.3	2.0	"	66.7	ND	99.5	53.2-132	0.885		20	
o-Xylene	33.6	1.0	"	33.3	ND	101	56.3-117	0.179		20	
<i>Surrogate: 1,2-Dichloroethane-d4</i>	<i>13.8</i>		<i>"</i>	<i>13.3</i>		<i>104</i>	<i>57.9-139</i>				
<i>Surrogate: Toluene-d8</i>	<i>12.9</i>		<i>"</i>	<i>13.3</i>		<i>96.5</i>	<i>83.1-115</i>				
<i>Surrogate: 4-Bromofluorobenzene</i>	<i>12.9</i>		<i>"</i>	<i>13.3</i>		<i>97.0</i>	<i>80.8-120</i>				

Summit Scientific

*The results in this report apply to the samples analyzed in accordance with the chain of custody document. This analytical report must be reproduced in its entirety.*



LT Environmental, Inc.  
4600 West 60th Avenue  
Arvada CO, 80003

Project: PDC - Jason1,2,34-31

Project Number: 0188-11014  
Project Manager: Brian Dodek

**Reported:**  
07/25/11 08:31

### Notes and Definitions

DET Analyte DETECTED  
ND Analyte NOT DETECTED at or above the reporting limit  
NR Not Reported  
dry Sample results reported on a dry weight basis  
RPD Relative Percent Difference

---

Summit Scientific

*The results in this report apply to the samples analyzed in accordance with the chain of custody document. This analytical report must be reproduced in its entirety.*

# Summit Scientific

---

741 Corporate Circle – Suite I ♦ Golden, Colorado 80401

303.277.9310 - laboratory ♦ 303.277.9531 - fax

April 18, 2011

Brian Dodek  
LT Environmental, Inc.  
4600 West 60th Avenue  
Arvada, CO 80003  
RE: PDC - Jason1,2,34-31

Enclosed are the results of analyses for samples received by Summit Scientific on 04/12/11 16:30. If you have any questions concerning this report, please feel free to contact me.

Sincerely,

A handwritten signature in black ink, appearing to be 'PS', with a long horizontal flourish extending to the right.

Paul Shrewsbury For Ben Shrewsbury  
President / Laboratory Director



LT Environmental, Inc.  
4600 West 60th Avenue  
Arvada CO, 80003

Project: PDC - Jason1,2,34-31

Project Number: 0188-11014  
Project Manager: Brian Dodek

**Reported:**  
04/18/11 15:14

### ANALYTICAL REPORT FOR SAMPLES

Sample ID	Laboratory ID	Matrix	Date Sampled	Date Received
MW01	R104069-01	Water	04/12/11 13:00	04/12/11 16:30
MW02	R104069-02	Water	04/12/11 13:20	04/12/11 16:30
MW03	R104069-03	Water	04/12/11 13:40	04/12/11 16:30
MW04	R104069-04	Water	04/12/11 14:00	04/12/11 16:30
MW05	R104069-05	Water	04/12/11 14:20	04/12/11 16:30

Summit Scientific

*The results in this report apply to the samples analyzed in accordance with the chain of custody document. This analytical report must be reproduced in its entirety.*





LT Environmental, Inc.  
 4600 West 60th Avenue  
 Arvada CO, 80003

Project: PDC - Jason1,2,34-31

Project Number: 0188-11014  
 Project Manager: Brian Dodek

**Reported:**  
 04/18/11 15:14

**MW01**  
**R104069-01 (Water)**

**Summit Scientific**

**Volatile Organic Compounds by EPA Method 8260B**

Date Sampled: **04/12/11 13:00**

Analyte	Result	Reporting Limit	Units	Dilution	Batch	Prepared	Analyzed	Method	Notes
Benzene	ND	1.0	ug/l	1	1041503	04/15/11	04/16/11	EPA 8260B	
Toluene	ND	1.0	"	"	"	"	"	"	
Ethylbenzene	ND	1.0	"	"	"	"	"	"	
Xylenes (total)	ND	1.0	"	"	"	"	"	"	

Date Sampled: **04/12/11 13:00**

Analyte	Result	Reporting Limit	Units	Dilution	Batch	Prepared	Analyzed	Method	Notes
<i>Surrogate: 1,2-Dichloroethane-d4</i>		102 %	57.9-139		"	"	"	"	
<i>Surrogate: Toluene-d8</i>		99.2 %	83.1-115		"	"	"	"	
<i>Surrogate: 4-Bromofluorobenzene</i>		98.9 %	80.8-120		"	"	"	"	

Summit Scientific

*The results in this report apply to the samples analyzed in accordance with the chain of custody document. This analytical report must be reproduced in its entirety.*



LT Environmental, Inc.  
 4600 West 60th Avenue  
 Arvada CO, 80003

Project: PDC - Jason1,2,34-31

Project Number: 0188-11014  
 Project Manager: Brian Dodek

**Reported:**  
 04/18/11 15:14

**MW02**  
**R104069-02 (Water)**

**Summit Scientific**

**Volatile Organic Compounds by EPA Method 8260B**

Date Sampled: **04/12/11 13:20**

Analyte	Result	Reporting Limit	Units	Dilution	Batch	Prepared	Analyzed	Method	Notes
Benzene	ND	1.0	ug/l	1	1041503	04/15/11	04/16/11	EPA 8260B	
Toluene	ND	1.0	"	"	"	"	"	"	
Ethylbenzene	ND	1.0	"	"	"	"	"	"	
Xylenes (total)	ND	1.0	"	"	"	"	"	"	

Date Sampled: **04/12/11 13:20**

Analyte	Result	Reporting Limit	Units	Dilution	Batch	Prepared	Analyzed	Method	Notes
<i>Surrogate: 1,2-Dichloroethane-d4</i>		102 %	57.9-139		"	"	"	"	
<i>Surrogate: Toluene-d8</i>		98.9 %	83.1-115		"	"	"	"	
<i>Surrogate: 4-Bromofluorobenzene</i>		99.5 %	80.8-120		"	"	"	"	

Summit Scientific

*The results in this report apply to the samples analyzed in accordance with the chain of custody document. This analytical report must be reproduced in its entirety.*



LT Environmental, Inc.  
 4600 West 60th Avenue  
 Arvada CO, 80003

Project: PDC - Jason1,2,34-31

Project Number: 0188-11014  
 Project Manager: Brian Dodek

**Reported:**  
 04/18/11 15:14

**MW03**  
**R104069-03 (Water)**

**Summit Scientific**

**Volatile Organic Compounds by EPA Method 8260B**

Date Sampled: **04/12/11 13:40**

Analyte	Result	Reporting Limit	Units	Dilution	Batch	Prepared	Analyzed	Method	Notes
Benzene	ND	1.0	ug/l	1	1041503	04/15/11	04/16/11	EPA 8260B	
Toluene	ND	1.0	"	"	"	"	"	"	
Ethylbenzene	ND	1.0	"	"	"	"	"	"	
Xylenes (total)	ND	1.0	"	"	"	"	"	"	

Date Sampled: **04/12/11 13:40**

Analyte	Result	Reporting Limit	Units	Dilution	Batch	Prepared	Analyzed	Method	Notes
<i>Surrogate: 1,2-Dichloroethane-d4</i>		101 %	57.9-139		"	"	"	"	
<i>Surrogate: Toluene-d8</i>		98.6 %	83.1-115		"	"	"	"	
<i>Surrogate: 4-Bromofluorobenzene</i>		98.3 %	80.8-120		"	"	"	"	

Summit Scientific

*The results in this report apply to the samples analyzed in accordance with the chain of custody document. This analytical report must be reproduced in its entirety.*



LT Environmental, Inc.  
 4600 West 60th Avenue  
 Arvada CO, 80003

Project: PDC - Jason1,2,34-31

Project Number: 0188-11014  
 Project Manager: Brian Dodek

**Reported:**  
 04/18/11 15:14

**MW04**  
**R104069-04 (Water)**

**Summit Scientific**

**Volatile Organic Compounds by EPA Method 8260B**

Date Sampled: **04/12/11 14:00**

Analyte	Result	Reporting Limit	Units	Dilution	Batch	Prepared	Analyzed	Method	Notes
Benzene	ND	1.0	ug/l	1	1041503	04/15/11	04/16/11	EPA 8260B	
Toluene	ND	1.0	"	"	"	"	"	"	
Ethylbenzene	ND	1.0	"	"	"	"	"	"	
Xylenes (total)	ND	1.0	"	"	"	"	"	"	

Date Sampled: **04/12/11 14:00**

Analyte	Result	Reporting Limit	Units	Dilution	Batch	Prepared	Analyzed	Method	Notes
<i>Surrogate: 1,2-Dichloroethane-d4</i>		101 %	57.9-139		"	"	"	"	
<i>Surrogate: Toluene-d8</i>		99.1 %	83.1-115		"	"	"	"	
<i>Surrogate: 4-Bromofluorobenzene</i>		98.4 %	80.8-120		"	"	"	"	

Summit Scientific

*The results in this report apply to the samples analyzed in accordance with the chain of custody document. This analytical report must be reproduced in its entirety.*



LT Environmental, Inc.  
 4600 West 60th Avenue  
 Arvada CO, 80003

Project: PDC - Jason1,2,34-31

Project Number: 0188-11014  
 Project Manager: Brian Dodek

**Reported:**  
 04/18/11 15:14

**MW05**  
**R104069-05 (Water)**

**Summit Scientific**

**Volatile Organic Compounds by EPA Method 8260B**

Date Sampled: **04/12/11 14:20**

Analyte	Result	Reporting Limit	Units	Dilution	Batch	Prepared	Analyzed	Method	Notes
Benzene	ND	1.0	ug/l	1	1041503	04/15/11	04/16/11	EPA 8260B	
Toluene	ND	1.0	"	"	"	"	"	"	
Ethylbenzene	ND	1.0	"	"	"	"	"	"	
Xylenes (total)	ND	1.0	"	"	"	"	"	"	

Date Sampled: **04/12/11 14:20**

Analyte	Result	Reporting Limit	Units	Dilution	Batch	Prepared	Analyzed	Method	Notes
<i>Surrogate: 1,2-Dichloroethane-d4</i>		102 %	57.9-139		"	"	"	"	
<i>Surrogate: Toluene-d8</i>		98.3 %	83.1-115		"	"	"	"	
<i>Surrogate: 4-Bromofluorobenzene</i>		98.9 %	80.8-120		"	"	"	"	

Summit Scientific

*The results in this report apply to the samples analyzed in accordance with the chain of custody document. This analytical report must be reproduced in its entirety.*



LT Environmental, Inc.  
4600 West 60th Avenue  
Arvada CO, 80003

Project: PDC - Jason1,2,34-31

Project Number: 0188-11014  
Project Manager: Brian Dodek

**Reported:**  
04/18/11 15:14

**Volatile Organic Compounds by EPA Method 8260B - Quality Control**

**Summit Scientific**

Analyte	Reporting			Spike	Source	%REC		RPD		Notes
	Result	Limit	Units	Level	Result	%REC	Limits	RPD	Limit	

**Batch 1041503 - EPA 5030 Water MS**

**Blank (1041503-BLK1)**

Prepared & Analyzed: 04/15/11

Benzene	ND	1.0	ug/l							
Toluene	ND	1.0	"							
Ethylbenzene	ND	1.0	"							
Xylenes (total)	ND	1.0	"							
Surrogate: 1,2-Dichloroethane-d4	13.4		"	13.3	100	57.9-139				
Surrogate: Toluene-d8	13.2		"	13.3	99.3	83.1-115				
Surrogate: 4-Bromofluorobenzene	13.0		"	13.3	97.2	80.8-120				

**LCS (1041503-BS1)**

Prepared & Analyzed: 04/15/11

Benzene	32.2	1.0	ug/l	33.3	96.7	60.1-131		10.9
Toluene	36.5	1.0	"	33.3	109	65.9-127		11.3
Ethylbenzene	39.6	1.0	"	33.3	119	65.1-129		20
m,p-Xylene	80.2	2.0	"	66.7	120	66.8-127		20
o-Xylene	39.9	1.0	"	33.3	120	61.2-120		20
Surrogate: 1,2-Dichloroethane-d4	13.5		"	13.3	101	57.9-139		
Surrogate: Toluene-d8	13.3		"	13.3	99.6	83.1-115		
Surrogate: 4-Bromofluorobenzene	13.2		"	13.3	99.0	80.8-120		

**LCS Dup (1041503-BSD1)**

Prepared & Analyzed: 04/15/11

Benzene	32.0	1.0	ug/l	33.3	96.1	60.1-131	0.685	10.9
Toluene	36.0	1.0	"	33.3	108	65.9-127	1.21	11.3
Ethylbenzene	39.7	1.0	"	33.3	119	65.1-129	0.227	20
m,p-Xylene	79.7	2.0	"	66.7	120	66.8-127	0.538	20
o-Xylene	39.1	1.0	"	33.3	117	61.2-120	1.97	20
Surrogate: 1,2-Dichloroethane-d4	13.5		"	13.3	101	57.9-139		
Surrogate: Toluene-d8	13.4		"	13.3	100	83.1-115		
Surrogate: 4-Bromofluorobenzene	13.2		"	13.3	99.2	80.8-120		

Summit Scientific

The results in this report apply to the samples analyzed in accordance with the chain of custody document. This analytical report must be reproduced in its entirety.



LT Environmental, Inc.  
4600 West 60th Avenue  
Arvada CO, 80003

Project: PDC - Jason1,2,34-31

Project Number: 0188-11014  
Project Manager: Brian Dodek

**Reported:**  
04/18/11 15:14

**Volatile Organic Compounds by EPA Method 8260B - Quality Control**  
**Summit Scientific**

Analyte	Reporting			Spike	Source		%REC		RPD	
	Result	Limit	Units	Level	Result	%REC	Limits	RPD	Limit	Notes

**Batch 1041503 - EPA 5030 Water MS**

<b>Matrix Spike (1041503-MS1)</b>	<b>Source: R104070-01</b>			<b>Prepared &amp; Analyzed: 04/15/11</b>						
Benzene	30.2	1.0	ug/l	33.3	ND	90.6	52.7-130			19.3
Toluene	34.2	1.0	"	33.3	ND	102	57-127			18.7
Ethylbenzene	37.4	1.0	"	33.3	ND	112	59.2-127			20
m,p-Xylene	75.4	2.0	"	66.7	ND	113	53.2-132			20
o-Xylene	37.8	1.0	"	33.3	ND	114	56.3-117			20
<i>Surrogate: 1,2-Dichloroethane-d4</i>	<i>13.7</i>		<i>"</i>	<i>13.3</i>		<i>103</i>	<i>57.9-139</i>			
<i>Surrogate: Toluene-d8</i>	<i>13.2</i>		<i>"</i>	<i>13.3</i>		<i>99.4</i>	<i>83.1-115</i>			
<i>Surrogate: 4-Bromofluorobenzene</i>	<i>13.4</i>		<i>"</i>	<i>13.3</i>		<i>100</i>	<i>80.8-120</i>			

<b>Matrix Spike Dup (1041503-MSD1)</b>	<b>Source: R104070-01</b>			<b>Prepared: 04/15/11</b>		<b>Analyzed: 04/16/11</b>				
Benzene	29.4	1.0	ug/l	33.3	ND	88.1	52.7-130	2.75		19.3
Toluene	32.8	1.0	"	33.3	ND	98.5	57-127	3.97		18.7
Ethylbenzene	36.1	1.0	"	33.3	ND	108	59.2-127	3.51		20
m,p-Xylene	73.0	2.0	"	66.7	ND	109	53.2-132	3.21		20
o-Xylene	36.5	1.0	"	33.3	ND	109	56.3-117	3.66		20
<i>Surrogate: 1,2-Dichloroethane-d4</i>	<i>13.8</i>		<i>"</i>	<i>13.3</i>		<i>103</i>	<i>57.9-139</i>			
<i>Surrogate: Toluene-d8</i>	<i>13.2</i>		<i>"</i>	<i>13.3</i>		<i>98.9</i>	<i>83.1-115</i>			
<i>Surrogate: 4-Bromofluorobenzene</i>	<i>13.0</i>		<i>"</i>	<i>13.3</i>		<i>97.7</i>	<i>80.8-120</i>			

Summit Scientific

*The results in this report apply to the samples analyzed in accordance with the chain of custody document. This analytical report must be reproduced in its entirety.*



LT Environmental, Inc.  
4600 West 60th Avenue  
Arvada CO, 80003

Project: PDC - Jason1,2,34-31

Project Number: 0188-11014  
Project Manager: Brian Dodek

**Reported:**  
04/18/11 15:14

### Notes and Definitions

DET Analyte DETECTED  
ND Analyte NOT DETECTED at or above the reporting limit  
NR Not Reported  
dry Sample results reported on a dry weight basis  
RPD Relative Percent Difference

---

Summit Scientific

*The results in this report apply to the samples analyzed in accordance with the chain of custody document. This analytical report must be reproduced in its entirety.*

# Summit Scientific

---

741 Corporate Circle – Suite I ♦ Golden, Colorado 80401

303.277.9310 - laboratory ♦ 303.277.9531 - fax

April 07, 2011

Brian Dodek  
LT Environmental, Inc.  
4600 West 60th Avenue  
Arvada, CO 80003  
RE: PDC - Jason1,2,34-31

Enclosed are the results of analyses for samples received by Summit Scientific on 03/31/11 16:45. If you have any questions concerning this report, please feel free to contact me.

Sincerely,

A handwritten signature in black ink, appearing to be 'PS', with a long horizontal flourish extending to the right.

Paul Shrewsbury For Ben Shrewsbury  
President / Laboratory Director





LT Environmental, Inc.  
4600 West 60th Avenue  
Arvada CO, 80003

Project: PDC - Jason1,2,34-31

Project Number: 0188-11014.05  
Project Manager: Brian Dodek

**Reported:**  
04/07/11 14:12

**SS11@10'**  
**R104001-01 (Soil)**

**Summit Scientific**

**Total Petroleum Hydrocarbons by 8015**

Date Sampled: **03/31/11 11:25**

Analyte	Result	Reporting Limit	Units	Dilution	Batch	Prepared	Analyzed	Method	Notes
C10-C28 (DRO)	ND	50	mg/kg	1	1040106	04/01/11	04/01/11	8015 DRO	

Date Sampled: **03/31/11 11:25**

Analyte	Result	Reporting Limit	Units	Dilution	Batch	Prepared	Analyzed	Method	Notes
Surrogate: <i>o</i> -Terphenyl		125 %	88.8-124		"	"	"	"	

**Volatile Organic Compounds by EPA Method 8260B**

Date Sampled: **03/31/11 11:25**

Analyte	Result	Reporting Limit	Units	Dilution	Batch	Prepared	Analyzed	Method	Notes
Naphthalene	ND	0.0050	mg/kg	1	1040104	04/01/11	04/02/11	EPA 8260B	
Benzene	ND	0.0050	"	"	"	"	"	"	
Toluene	ND	0.0050	"	"	"	"	"	"	
Ethylbenzene	ND	0.0050	"	"	"	"	"	"	
m,p-Xylene	ND	0.010	"	"	"	"	"	"	
o-Xylene	ND	0.0050	"	"	"	"	"	"	
Gasoline Range Hydrocarbons	ND	0.50	"	"	"	"	"	"	

Date Sampled: **03/31/11 11:25**

Analyte	Result	Reporting Limit	Units	Dilution	Batch	Prepared	Analyzed	Method	Notes
Surrogate: 1,2-Dichloroethane-d4		105 %	67.4-143		"	"	"	"	
Surrogate: Toluene-d8		97.6 %	77.3-114		"	"	"	"	
Surrogate: 4-Bromofluorobenzene		91.4 %	78.4-125		"	"	"	"	

Summit Scientific

*The results in this report apply to the samples analyzed in accordance with the chain of custody document. This analytical report must be reproduced in its entirety.*



LT Environmental, Inc.  
 4600 West 60th Avenue  
 Arvada CO, 80003

Project: PDC - Jason1,2,34-31

Project Number: 0188-11014.05  
 Project Manager: Brian Dodek

**Reported:**  
 04/07/11 14:12

**Total Petroleum Hydrocarbons by 8015 - Quality Control**  
**Summit Scientific**

Analyte	Reporting			Spike Level	Source		%REC		RPD		Notes
	Result	Limit	Units		Result	%REC	Limits	RPD	Limit		

**Batch 1040106 - EPA 3550A**

<b>Blank (1040106-BLK1)</b>				Prepared & Analyzed: 04/01/11							
C10-C28 (DRO)	ND	50	mg/kg								
<i>Surrogate: o-Terphenyl</i>	16.2		"	12.5	130	88.8-124					
<b>LCS (1040106-BS1)</b>				Prepared & Analyzed: 04/01/11							
C10-C28 (DRO)	776	50	mg/kg	501	155	81.4-129				9.26	
<b>LCS Dup (1040106-BSD1)</b>				Prepared & Analyzed: 04/01/11							
C10-C28 (DRO)	671	50	mg/kg	501	134	81.4-129			14.5	9.26	
<b>Matrix Spike (1040106-MS1)</b>				<b>Source: R104001-01</b>		Prepared & Analyzed: 04/01/11					
C10-C28 (DRO)	690	50	mg/kg	501	32.9	131	77.8-133				8.48
<b>Matrix Spike Dup (1040106-MSD1)</b>				<b>Source: R104001-01</b>		Prepared & Analyzed: 04/01/11					
C10-C28 (DRO)	681	50	mg/kg	501	32.9	129	77.8-133		1.34	8.48	

Summit Scientific

*The results in this report apply to the samples analyzed in accordance with the chain of custody document. This analytical report must be reproduced in its entirety.*



LT Environmental, Inc.  
4600 West 60th Avenue  
Arvada CO, 80003

Project: PDC - Jason1,2,34-31

Project Number: 0188-11014.05  
Project Manager: Brian Dodek

**Reported:**  
04/07/11 14:12

**Volatile Organic Compounds by EPA Method 8260B - Quality Control**  
**Summit Scientific**

Analyte	Reporting			Spike	Source	%REC			RPD	Notes
	Result	Limit	Units	Level	Result	%REC	Limits	RPD	Limit	

**Batch 1040104 - EPA 5030 Soil MS**

**Blank (1040104-BLK1)**

Prepared: 04/01/11 Analyzed: 04/02/11

Naphthalene	ND	0.0050	mg/kg							
Benzene	ND	0.0050	"							
Toluene	ND	0.0050	"							
Ethylbenzene	ND	0.0050	"							
m,p-Xylene	ND	0.010	"							
o-Xylene	ND	0.0050	"							
Gasoline Range Hydrocarbons	ND	0.50	"							
<i>Surrogate: 1,2-Dichloroethane-d4</i>	<i>0.0395</i>		<i>"</i>	<i>0.0400</i>		<i>98.8</i>	<i>67.4-143</i>			
<i>Surrogate: Toluene-d8</i>	<i>0.0390</i>		<i>"</i>	<i>0.0400</i>		<i>97.5</i>	<i>77.3-114</i>			
<i>Surrogate: 4-Bromofluorobenzene</i>	<i>0.0347</i>		<i>"</i>	<i>0.0400</i>		<i>86.8</i>	<i>78.4-125</i>			

**LCS (1040104-BS1)**

Prepared: 04/01/11 Analyzed: 04/02/11

Naphthalene	ND	0.0050	mg/kg				67.8-151		20	
Benzene	0.128	0.0050	"	0.100		128	61-139		11.1	
Toluene	0.123	0.0050	"	0.100		123	64-132		10.9	
Ethylbenzene	0.131	0.0050	"	0.100		131	68.7-135		20	
m,p-Xylene	0.245	0.010	"	0.200		122	70.4-129		20	
o-Xylene	0.113	0.0050	"	0.100		113	66.9-126		20	
<i>Surrogate: 1,2-Dichloroethane-d4</i>	<i>0.0402</i>		<i>"</i>	<i>0.0400</i>		<i>100</i>	<i>67.4-143</i>			
<i>Surrogate: Toluene-d8</i>	<i>0.0405</i>		<i>"</i>	<i>0.0400</i>		<i>101</i>	<i>77.3-114</i>			
<i>Surrogate: 4-Bromofluorobenzene</i>	<i>0.0326</i>		<i>"</i>	<i>0.0400</i>		<i>81.6</i>	<i>78.4-125</i>			

**LCS Dup (1040104-BSD1)**

Prepared: 04/01/11 Analyzed: 04/02/11

Naphthalene	ND	0.0050	mg/kg				67.8-151		20	
Benzene	0.126	0.0050	"	0.100		126	61-139	1.28	11.1	
Toluene	0.125	0.0050	"	0.100		125	64-132	1.55	10.9	
Ethylbenzene	0.135	0.0050	"	0.100		135	68.7-135	3.37	20	
m,p-Xylene	0.254	0.010	"	0.200		127	70.4-129	3.53	20	
o-Xylene	0.117	0.0050	"	0.100		117	66.9-126	3.62	20	
<i>Surrogate: 1,2-Dichloroethane-d4</i>	<i>0.0399</i>		<i>"</i>	<i>0.0400</i>		<i>99.8</i>	<i>67.4-143</i>			
<i>Surrogate: Toluene-d8</i>	<i>0.0410</i>		<i>"</i>	<i>0.0400</i>		<i>102</i>	<i>77.3-114</i>			
<i>Surrogate: 4-Bromofluorobenzene</i>	<i>0.0358</i>		<i>"</i>	<i>0.0400</i>		<i>89.4</i>	<i>78.4-125</i>			

Summit Scientific

*The results in this report apply to the samples analyzed in accordance with the chain of custody document. This analytical report must be reproduced in its entirety.*



LT Environmental, Inc.  
4600 West 60th Avenue  
Arvada CO, 80003

Project: PDC - Jason1,2,34-31

Project Number: 0188-11014.05  
Project Manager: Brian Dodek

**Reported:**  
04/07/11 14:12

**Volatile Organic Compounds by EPA Method 8260B - Quality Control**  
**Summit Scientific**

Analyte	Reporting			Spike	Source	%REC			RPD	Notes
	Result	Limit	Units	Level	Result	%REC	Limits	RPD	Limit	

**Batch 1040104 - EPA 5030 Soil MS**

**Matrix Spike (1040104-MS1)**

**Source: R103184-01**

Prepared: 04/01/11

Analyzed: 04/02/11

Naphthalene	ND	0.0050	mg/kg	0.00	0.00	127	26.4-144		20	
Benzene	0.127	0.0050	"	0.100	0.00	127	42.9-137		17.9	
Toluene	0.124	0.0050	"	0.100	0.00	124	42.6-130		11.9	
Ethylbenzene	0.136	0.0050	"	0.100	0.00	136	39-133		20	
m,p-Xylene	0.252	0.010	"	0.200	0.00	126	34.7-134		20	
o-Xylene	0.118	0.0050	"	0.100	0.00	118	41.3-126		20	
Surrogate: 1,2-Dichloroethane-d4	0.0443		"	0.0400		111	67.4-143			
Surrogate: Toluene-d8	0.0377		"	0.0400		94.2	77.3-114			
Surrogate: 4-Bromofluorobenzene	0.0368		"	0.0400		92.0	78.4-125			

**Matrix Spike Dup (1040104-MSD1)**

**Source: R103184-01**

Prepared: 04/01/11

Analyzed: 04/02/11

Naphthalene	ND	0.0050	mg/kg	0.00	0.00	131	26.4-144		20	
Benzene	0.131	0.0050	"	0.100	0.00	131	42.9-137	3.14	17.9	
Toluene	0.128	0.0050	"	0.100	0.00	128	42.6-130	3.51	11.9	
Ethylbenzene	0.137	0.0050	"	0.100	0.00	137	39-133	0.483	20	
m,p-Xylene	0.255	0.010	"	0.200	0.00	128	34.7-134	1.16	20	
o-Xylene	0.122	0.0050	"	0.100	0.00	122	41.3-126	3.15	20	
Surrogate: 1,2-Dichloroethane-d4	0.0440		"	0.0400		110	67.4-143			
Surrogate: Toluene-d8	0.0399		"	0.0400		99.8	77.3-114			
Surrogate: 4-Bromofluorobenzene	0.0391		"	0.0400		97.6	78.4-125			

Summit Scientific

*The results in this report apply to the samples analyzed in accordance with the chain of custody document. This analytical report must be reproduced in its entirety.*



LT Environmental, Inc.  
4600 West 60th Avenue  
Arvada CO, 80003

Project: PDC - Jason1,2,34-31

Project Number: 0188-11014.05  
Project Manager: Brian Dodek

**Reported:**  
04/07/11 14:12

### Notes and Definitions

DET Analyte DETECTED  
ND Analyte NOT DETECTED at or above the reporting limit  
NR Not Reported  
dry Sample results reported on a dry weight basis  
RPD Relative Percent Difference

---

Summit Scientific

*The results in this report apply to the samples analyzed in accordance with the chain of custody document. This analytical report must be reproduced in its entirety.*

# Summit Scientific

---

741 Corporate Circle – Suite I ♦ Golden, Colorado 80401

303.277.9310 - laboratory ♦ 303.277.9531 - fax

April 07, 2011

Brian Dodek  
LT Environmental, Inc.  
4600 West 60th Avenue  
Arvada, CO 80003  
RE: PDC - Jason1,2,34-31

Enclosed are the results of analyses for samples received by Summit Scientific on 03/30/11 17:25. If you have any questions concerning this report, please feel free to contact me.

Sincerely,

A handwritten signature in black ink, appearing to be 'PS', with a long horizontal flourish extending to the right.

Paul Shrewsbury For Ben Shrewsbury  
President / Laboratory Director



LT Environmental, Inc.  
4600 West 60th Avenue  
Arvada CO, 80003

Project: PDC - Jason1,2,34-31

Project Number: 0188-  
Project Manager: Brian Dodek

**Reported:**  
04/07/11 09:34

### ANALYTICAL REPORT FOR SAMPLES

Sample ID	Laboratory ID	Matrix	Date Sampled	Date Received
SS05@10'	R103184-01	Soil	03/30/11 12:30	03/30/11 17:25
SS06@10'	R103184-02	Soil	03/30/11 12:35	03/30/11 17:25
SS07@10'	R103184-03	Soil	03/30/11 12:40	03/30/11 17:25
SS08@10'	R103184-04	Soil	03/30/11 12:45	03/30/11 17:25
SS09@10'	R103184-05	Soil	03/30/11 12:50	03/30/11 17:25
SS010@10'	R103184-06	Soil	03/30/11 12:55	03/30/11 17:25
GW06	R103184-07	Water	03/30/11 13:10	03/30/11 17:25
GW07	R103184-08	Water	03/30/11 13:20	03/30/11 17:25
GW08	R103184-09	Water	03/30/11 14:15	03/30/11 17:25

Summit Scientific

*The results in this report apply to the samples analyzed in accordance with the chain of custody document. This analytical report must be reproduced in its entirety.*





LT Environmental, Inc.  
4600 West 60th Avenue  
Arvada CO, 80003

Project: PDC - Jason1,2,34-31

Project Number: 0188-  
Project Manager: Brian Dodek

**Reported:**  
04/07/11 09:34

**SS05@10'**  
**R103184-01 (Soil)**

**Summit Scientific**

**Total Petroleum Hydrocarbons by 8015**

Date Sampled: **03/30/11 12:30**

Analyte	Result	Reporting Limit	Units	Dilution	Batch	Prepared	Analyzed	Method	Notes
C10-C28 (DRO)	ND	50	mg/kg	1	1033109	03/31/11	04/01/11	8015 DRO	

Date Sampled: **03/30/11 12:30**

Analyte	Result	Reporting Limit	Units	Dilution	Batch	Prepared	Analyzed	Method	Notes
Surrogate: <i>o</i> -Terphenyl		130 %	88.8-124		"	"	"	"	

**Volatile Organic Compounds by EPA Method 8260B**

Date Sampled: **03/30/11 12:30**

Analyte	Result	Reporting Limit	Units	Dilution	Batch	Prepared	Analyzed	Method	Notes
Benzene	ND	0.0050	mg/kg	1	1040104	04/01/11	04/02/11	EPA 8260B	
Toluene	ND	0.0050	"	"	"	"	"	"	
Ethylbenzene	ND	0.0050	"	"	"	"	"	"	
Xylenes (total)	ND	0.0050	"	"	"	"	"	"	
Gasoline Range Hydrocarbons	ND	0.50	"	"	"	"	"	"	

Date Sampled: **03/30/11 12:30**

Analyte	Result	Reporting Limit	Units	Dilution	Batch	Prepared	Analyzed	Method	Notes
Surrogate: 1,2-Dichloroethane-d4		126 %	67.4-143		"	"	"	"	
Surrogate: Toluene-d8		93.0 %	77.3-114		"	"	"	"	
Surrogate: 4-Bromofluorobenzene		88.0 %	78.4-125		"	"	"	"	

Date Sampled: **03/30/11 12:30**

Analyte	Result	Reporting Limit	Units	Dilution	Batch	Prepared	Analyzed	Method	Notes
Naphthalene	ND	0.0050	"	"	"	04/01/11	"	"	
Benzene	ND	0.0050	"	"	"	"	"	"	
Toluene	ND	0.0050	"	"	"	"	"	"	
Ethylbenzene	ND	0.0050	"	"	"	"	"	"	

Summit Scientific

The results in this report apply to the samples analyzed in accordance with the chain of custody document. This analytical report must be reproduced in its entirety.



LT Environmental, Inc.  
 4600 West 60th Avenue  
 Arvada CO, 80003

Project: PDC - Jason1,2,34-31

Project Number: 0188-  
 Project Manager: Brian Dodek

**Reported:**  
 04/07/11 09:34

**SS05@10'**  
**R103184-01 (Soil)**

**Summit Scientific**

**Volatile Organic Compounds by EPA Method 8260B**

m,p-Xylene	ND	0.010	mg/kg	1	1040104	04/01/11	04/02/11	EPA 8260B
o-Xylene	ND	0.0050	"	"	"	"	"	"
Gasoline Range Hydrocarbons	ND	0.50	"	"	"	"	"	"

Date Sampled: **03/30/11 12:30**

Analyte	Result	Reporting Limit	Units	Dilution	Batch	Prepared	Analyzed	Method	Notes
Surrogate: 1,2-Dichloroethane-d4		126 %	67.4-143		"	"	"	"	
Surrogate: Toluene-d8		93.0 %	77.3-114		"	"	"	"	
Surrogate: 4-Bromofluorobenzene		88.0 %	78.4-125		"	"	"	"	

Summit Scientific

*The results in this report apply to the samples analyzed in accordance with the chain of custody document. This analytical report must be reproduced in its entirety.*



LT Environmental, Inc.  
4600 West 60th Avenue  
Arvada CO, 80003

Project: PDC - Jason1,2,34-31

Project Number: 0188-  
Project Manager: Brian Dodek

**Reported:**  
04/07/11 09:34

**SS06@10'**  
**R103184-02 (Soil)**

**Summit Scientific**

**Total Petroleum Hydrocarbons by 8015**

Date Sampled: **03/30/11 12:35**

Analyte	Result	Reporting Limit	Units	Dilution	Batch	Prepared	Analyzed	Method	Notes
C10-C28 (DRO)	ND	50	mg/kg	1	1033109	03/31/11	04/01/11	8015 DRO	

Date Sampled: **03/30/11 12:35**

Analyte	Result	Reporting Limit	Units	Dilution	Batch	Prepared	Analyzed	Method	Notes
Surrogate: <i>o</i> -Terphenyl		130 %	88.8-124		"	"	"	"	

**Volatile Organic Compounds by EPA Method 8260B**

Date Sampled: **03/30/11 12:35**

Analyte	Result	Reporting Limit	Units	Dilution	Batch	Prepared	Analyzed	Method	Notes
Naphthalene	ND	0.0050	mg/kg	1	1040104	04/01/11	04/02/11	EPA 8260B	
Benzene	ND	0.0050	"	"	"	"	"	"	
Toluene	ND	0.0050	"	"	"	"	"	"	
Ethylbenzene	ND	0.0050	"	"	"	"	"	"	
m,p-Xylene	ND	0.010	"	"	"	"	"	"	
o-Xylene	ND	0.0050	"	"	"	"	"	"	
Gasoline Range Hydrocarbons	ND	0.50	"	"	"	"	"	"	

Date Sampled: **03/30/11 12:35**

Analyte	Result	Reporting Limit	Units	Dilution	Batch	Prepared	Analyzed	Method	Notes
Surrogate: 1,2-Dichloroethane-d4		101 %	67.4-143		"	"	"	"	
Surrogate: Toluene-d8		99.8 %	77.3-114		"	"	"	"	
Surrogate: 4-Bromofluorobenzene		95.0 %	78.4-125		"	"	"	"	

Summit Scientific

The results in this report apply to the samples analyzed in accordance with the chain of custody document. This analytical report must be reproduced in its entirety.



LT Environmental, Inc.  
4600 West 60th Avenue  
Arvada CO, 80003

Project: PDC - Jason1,2,34-31

Project Number: 0188-  
Project Manager: Brian Dodek

**Reported:**  
04/07/11 09:34

**SS07@10'**  
**R103184-03 (Soil)**

**Summit Scientific**

**Total Petroleum Hydrocarbons by 8015**

Date Sampled: **03/30/11 12:40**

Analyte	Result	Reporting Limit	Units	Dilution	Batch	Prepared	Analyzed	Method	Notes
C10-C28 (DRO)	ND	50	mg/kg	1	1033109	03/31/11	04/01/11	8015 DRO	

Date Sampled: **03/30/11 12:40**

Analyte	Result	Reporting Limit	Units	Dilution	Batch	Prepared	Analyzed	Method	Notes
Surrogate: <i>o</i> -Terphenyl		119 %	88.8-124		"	"	"	"	

**Volatile Organic Compounds by EPA Method 8260B**

Date Sampled: **03/30/11 12:40**

Analyte	Result	Reporting Limit	Units	Dilution	Batch	Prepared	Analyzed	Method	Notes
Naphthalene	ND	0.0050	mg/kg	1	1040104	04/01/11	04/02/11	EPA 8260B	
Benzene	ND	0.0050	"	"	"	"	"	"	
Toluene	ND	0.0050	"	"	"	"	"	"	
Ethylbenzene	ND	0.0050	"	"	"	"	"	"	
m,p-Xylene	ND	0.010	"	"	"	"	"	"	
<i>o</i> -Xylene	ND	0.0050	"	"	"	"	"	"	
Gasoline Range Hydrocarbons	ND	0.50	"	"	"	"	"	"	

Date Sampled: **03/30/11 12:40**

Analyte	Result	Reporting Limit	Units	Dilution	Batch	Prepared	Analyzed	Method	Notes
Surrogate: 1,2-Dichloroethane-d4		116 %	67.4-143		"	"	"	"	
Surrogate: Toluene-d8		103 %	77.3-114		"	"	"	"	
Surrogate: 4-Bromofluorobenzene		97.6 %	78.4-125		"	"	"	"	

Summit Scientific

The results in this report apply to the samples analyzed in accordance with the chain of custody document. This analytical report must be reproduced in its entirety.



LT Environmental, Inc.  
4600 West 60th Avenue  
Arvada CO, 80003

Project: PDC - Jason1,2,34-31

Project Number: 0188-  
Project Manager: Brian Dodek

**Reported:**  
04/07/11 09:34

**SS08@10'**  
**R103184-04 (Soil)**

**Summit Scientific**

**Total Petroleum Hydrocarbons by 8015**

Date Sampled: **03/30/11 12:45**

Analyte	Result	Reporting Limit	Units	Dilution	Batch	Prepared	Analyzed	Method	Notes
C10-C28 (DRO)	ND	50	mg/kg	1	1033109	03/31/11	04/01/11	8015 DRO	

Date Sampled: **03/30/11 12:45**

Analyte	Result	Reporting Limit	Units	Dilution	Batch	Prepared	Analyzed	Method	Notes
Surrogate: <i>o</i> -Terphenyl		125 %	88.8-124		"	"	"	"	

**Volatile Organic Compounds by EPA Method 8260B**

Date Sampled: **03/30/11 12:45**

Analyte	Result	Reporting Limit	Units	Dilution	Batch	Prepared	Analyzed	Method	Notes
Naphthalene	ND	0.0050	mg/kg	1	1040104	04/01/11	04/02/11	EPA 8260B	
Benzene	ND	0.0050	"	"	"	"	"	"	
Toluene	ND	0.0050	"	"	"	"	"	"	
Ethylbenzene	ND	0.0050	"	"	"	"	"	"	
m,p-Xylene	ND	0.010	"	"	"	"	"	"	
o-Xylene	ND	0.0050	"	"	"	"	"	"	
Gasoline Range Hydrocarbons	ND	0.50	"	"	"	"	"	"	

Date Sampled: **03/30/11 12:45**

Analyte	Result	Reporting Limit	Units	Dilution	Batch	Prepared	Analyzed	Method	Notes
Surrogate: 1,2-Dichloroethane-d4		106 %	67.4-143		"	"	"	"	
Surrogate: Toluene-d8		95.5 %	77.3-114		"	"	"	"	
Surrogate: 4-Bromofluorobenzene		92.6 %	78.4-125		"	"	"	"	

Summit Scientific

The results in this report apply to the samples analyzed in accordance with the chain of custody document. This analytical report must be reproduced in its entirety.



LT Environmental, Inc.  
4600 West 60th Avenue  
Arvada CO, 80003

Project: PDC - Jason1,2,34-31

Project Number: 0188-  
Project Manager: Brian Dodek

**Reported:**  
04/07/11 09:34

**SS09@10'**  
**R103184-05 (Soil)**

**Summit Scientific**

**Total Petroleum Hydrocarbons by 8015**

Date Sampled: **03/30/11 12:50**

Analyte	Result	Reporting Limit	Units	Dilution	Batch	Prepared	Analyzed	Method	Notes
C10-C28 (DRO)	ND	50	mg/kg	1	1033109	03/31/11	04/01/11	8015 DRO	

Date Sampled: **03/30/11 12:50**

Analyte	Result	Reporting Limit	Units	Dilution	Batch	Prepared	Analyzed	Method	Notes
Surrogate: <i>o</i> -Terphenyl		147 %	88.8-124		"	"	"	"	

**Volatile Organic Compounds by EPA Method 8260B**

Date Sampled: **03/30/11 12:50**

Analyte	Result	Reporting Limit	Units	Dilution	Batch	Prepared	Analyzed	Method	Notes
Naphthalene	ND	0.0050	mg/kg	1	1040104	04/01/11	04/02/11	EPA 8260B	
Benzene	ND	0.0050	"	"	"	"	"	"	
Toluene	ND	0.0050	"	"	"	"	"	"	
Ethylbenzene	ND	0.0050	"	"	"	"	"	"	
m,p-Xylene	ND	0.010	"	"	"	"	"	"	
o-Xylene	ND	0.0050	"	"	"	"	"	"	
Gasoline Range Hydrocarbons	ND	0.50	"	"	"	"	"	"	

Date Sampled: **03/30/11 12:50**

Analyte	Result	Reporting Limit	Units	Dilution	Batch	Prepared	Analyzed	Method	Notes
Surrogate: 1,2-Dichloroethane-d4		105 %	67.4-143		"	"	"	"	
Surrogate: Toluene-d8		99.8 %	77.3-114		"	"	"	"	
Surrogate: 4-Bromofluorobenzene		96.6 %	78.4-125		"	"	"	"	

Summit Scientific

The results in this report apply to the samples analyzed in accordance with the chain of custody document. This analytical report must be reproduced in its entirety.



LT Environmental, Inc.  
4600 West 60th Avenue  
Arvada CO, 80003

Project: PDC - Jason1,2,34-31

Project Number: 0188-  
Project Manager: Brian Dodek

**Reported:**  
04/07/11 09:34

**SS010@10'**  
**R103184-06 (Soil)**

**Summit Scientific**

**Total Petroleum Hydrocarbons by 8015**

Date Sampled: **03/30/11 12:55**

Analyte	Result	Reporting Limit	Units	Dilution	Batch	Prepared	Analyzed	Method	Notes
C10-C28 (DRO)	ND	50	mg/kg	1	1033109	03/31/11	04/01/11	8015 DRO	

Date Sampled: **03/30/11 12:55**

Analyte	Result	Reporting Limit	Units	Dilution	Batch	Prepared	Analyzed	Method	Notes
Surrogate: <i>o</i> -Terphenyl		120 %	88.8-124		"	"	"	"	

**Volatile Organic Compounds by EPA Method 8260B**

Date Sampled: **03/30/11 12:55**

Analyte	Result	Reporting Limit	Units	Dilution	Batch	Prepared	Analyzed	Method	Notes
Naphthalene	ND	0.0050	mg/kg	1	1040104	04/01/11	04/02/11	EPA 8260B	
Benzene	ND	0.0050	"	"	"	"	"	"	
Toluene	ND	0.0050	"	"	"	"	"	"	
Ethylbenzene	ND	0.0050	"	"	"	"	"	"	
m,p-Xylene	ND	0.010	"	"	"	"	"	"	
o-Xylene	ND	0.0050	"	"	"	"	"	"	
Gasoline Range Hydrocarbons	ND	0.50	"	"	"	"	"	"	

Date Sampled: **03/30/11 12:55**

Analyte	Result	Reporting Limit	Units	Dilution	Batch	Prepared	Analyzed	Method	Notes
Surrogate: 1,2-Dichloroethane-d4		108 %	67.4-143		"	"	"	"	
Surrogate: Toluene-d8		97.5 %	77.3-114		"	"	"	"	
Surrogate: 4-Bromofluorobenzene		91.8 %	78.4-125		"	"	"	"	

Summit Scientific

The results in this report apply to the samples analyzed in accordance with the chain of custody document. This analytical report must be reproduced in its entirety.



LT Environmental, Inc.  
 4600 West 60th Avenue  
 Arvada CO, 80003

Project: PDC - Jason1,2,34-31

Project Number: 0188-  
 Project Manager: Brian Dodek

**Reported:**  
 04/07/11 09:34

**GW06**  
**R103184-07 (Water)**

**Summit Scientific**

**Volatile Organic Compounds by EPA Method 8260B**

Date Sampled: **03/30/11 13:10**

Analyte	Result	Reporting Limit	Units	Dilution	Batch	Prepared	Analyzed	Method	Notes
Benzene	ND	1.0	ug/l	1	1033006	03/30/11	03/31/11	EPA 8260B	
Toluene	ND	1.0	"	"	"	"	"	"	
Ethylbenzene	ND	1.0	"	"	"	"	"	"	
Xylenes (total)	ND	1.0	"	"	"	"	"	"	

Date Sampled: **03/30/11 13:10**

Analyte	Result	Reporting Limit	Units	Dilution	Batch	Prepared	Analyzed	Method	Notes
<i>Surrogate: 1,2-Dichloroethane-d4</i>		112 %	57.9-139		"	"	"	"	
<i>Surrogate: Toluene-d8</i>		95.4 %	83.1-115		"	"	"	"	
<i>Surrogate: 4-Bromofluorobenzene</i>		120 %	80.8-120		"	"	"	"	

Summit Scientific

*The results in this report apply to the samples analyzed in accordance with the chain of custody document. This analytical report must be reproduced in its entirety.*



LT Environmental, Inc.  
 4600 West 60th Avenue  
 Arvada CO, 80003

Project: PDC - Jason1,2,34-31

Project Number: 0188-  
 Project Manager: Brian Dodek

**Reported:**  
 04/07/11 09:34

**GW07**  
**R103184-08 (Water)**

**Summit Scientific**

**Volatile Organic Compounds by EPA Method 8260B**

Date Sampled: **03/30/11 13:20**

Analyte	Result	Reporting Limit	Units	Dilution	Batch	Prepared	Analyzed	Method	Notes
Benzene	ND	1.0	ug/l	1	1033006	03/30/11	03/30/11	EPA 8260B	
Toluene	ND	1.0	"	"	"	"	"	"	
Ethylbenzene	ND	1.0	"	"	"	"	"	"	
Xylenes (total)	ND	1.0	"	"	"	"	"	"	

Date Sampled: **03/30/11 13:20**

Analyte	Result	Reporting Limit	Units	Dilution	Batch	Prepared	Analyzed	Method	Notes
<i>Surrogate: 1,2-Dichloroethane-d4</i>		108 %	57.9-139		"	"	"	"	
<i>Surrogate: Toluene-d8</i>		96.1 %	83.1-115		"	"	"	"	
<i>Surrogate: 4-Bromofluorobenzene</i>		101 %	80.8-120		"	"	"	"	

Summit Scientific

*The results in this report apply to the samples analyzed in accordance with the chain of custody document. This analytical report must be reproduced in its entirety.*



LT Environmental, Inc.  
 4600 West 60th Avenue  
 Arvada CO, 80003

Project: PDC - Jason1,2,34-31

Project Number: 0188-  
 Project Manager: Brian Dodek

**Reported:**  
 04/07/11 09:34

**GW08**  
**R103184-09 (Water)**

**Summit Scientific**

**Volatile Organic Compounds by EPA Method 8260B**

Date Sampled: **03/30/11 14:15**

Analyte	Result	Reporting Limit	Units	Dilution	Batch	Prepared	Analyzed	Method	Notes
Benzene	ND	1.0	ug/l	1	1033006	03/30/11	03/30/11	EPA 8260B	
Toluene	ND	1.0	"	"	"	"	"	"	
Ethylbenzene	ND	1.0	"	"	"	"	"	"	
Xylenes (total)	ND	1.0	"	"	"	"	"	"	

Date Sampled: **03/30/11 14:15**

Analyte	Result	Reporting Limit	Units	Dilution	Batch	Prepared	Analyzed	Method	Notes
<i>Surrogate: 1,2-Dichloroethane-d4</i>		115 %	57.9-139		"	"	"	"	
<i>Surrogate: Toluene-d8</i>		98.3 %	83.1-115		"	"	"	"	
<i>Surrogate: 4-Bromofluorobenzene</i>		95.9 %	80.8-120		"	"	"	"	

Summit Scientific

*The results in this report apply to the samples analyzed in accordance with the chain of custody document. This analytical report must be reproduced in its entirety.*



LT Environmental, Inc.  
 4600 West 60th Avenue  
 Arvada CO, 80003

Project: PDC - Jason1,2,34-31

Project Number: 0188-  
 Project Manager: Brian Dodek

**Reported:**  
 04/07/11 09:34

**Total Petroleum Hydrocarbons by 8015 - Quality Control**  
**Summit Scientific**

Analyte	Reporting			Spike Level	Source		%REC		RPD		Notes
	Result	Limit	Units		Result	%REC	Limits	RPD	Limit		

**Batch 1033109 - EPA 3550A**

<b>Blank (1033109-BLK1)</b>				Prepared: 03/31/11		Analyzed: 04/01/11					
C10-C28 (DRO)	ND	50	mg/kg								
<i>Surrogate: o-Terphenyl</i>	14.3		"	12.5		115	88.8-124				
<b>LCS (1033109-BS1)</b>				Prepared: 03/31/11		Analyzed: 04/01/11					
C10-C28 (DRO)	511	50	mg/kg	501		102	81.4-129			9.26	
<b>LCS Dup (1033109-BSD1)</b>				Prepared: 03/31/11		Analyzed: 04/01/11					
C10-C28 (DRO)	534	50	mg/kg	501		107	81.4-129	4.41		9.26	
<b>Matrix Spike (1033109-MS1)</b>				<b>Source: R103191-05</b>		Prepared: 03/31/11		Analyzed: 04/01/11			
C10-C28 (DRO)	577	50	mg/kg	501	20.3	111	77.8-133			8.48	
<b>Matrix Spike Dup (1033109-MSD1)</b>				<b>Source: R103191-05</b>		Prepared: 03/31/11		Analyzed: 04/01/11			
C10-C28 (DRO)	537	50	mg/kg	501	20.3	103	77.8-133	7.30		8.48	

Summit Scientific

*The results in this report apply to the samples analyzed in accordance with the chain of custody document. This analytical report must be reproduced in its entirety.*



LT Environmental, Inc.  
4600 West 60th Avenue  
Arvada CO, 80003

Project: PDC - Jason1,2,34-31

Project Number: 0188-  
Project Manager: Brian Dodek

**Reported:**  
04/07/11 09:34

**Volatile Organic Compounds by EPA Method 8260B - Quality Control**  
**Summit Scientific**

Analyte	Reporting			Spike	Source	%REC		RPD		Notes
	Result	Limit	Units	Level	Result	%REC	Limits	RPD	Limit	

**Batch 1033006 - EPA 5030 Water MS**

**Blank (1033006-BLK1)**

Prepared & Analyzed: 03/30/11

Benzene	ND	1.0	ug/l							
Toluene	ND	1.0	"							
Ethylbenzene	ND	1.0	"							
Xylenes (total)	ND	1.0	"							
<i>Surrogate: 1,2-Dichloroethane-d4</i>	<i>15.0</i>		<i>"</i>	<i>13.3</i>		<i>112</i>	<i>57.9-139</i>			
<i>Surrogate: Toluene-d8</i>	<i>14.0</i>		<i>"</i>	<i>13.3</i>		<i>105</i>	<i>83.1-115</i>			
<i>Surrogate: 4-Bromofluorobenzene</i>	<i>11.6</i>		<i>"</i>	<i>13.3</i>		<i>87.2</i>	<i>80.8-120</i>			

**LCS (1033006-BS1)**

Prepared & Analyzed: 03/30/11

Benzene	37.7	1.0	ug/l	33.3		113	60.1-131		10.9	
Toluene	36.5	1.0	"	33.3		110	65.9-127		11.3	
Ethylbenzene	37.2	1.0	"	33.3		112	65.1-129		20	
m,p-Xylene	70.8	2.0	"	66.7		106	66.8-127		20	
o-Xylene	37.0	1.0	"	33.3		111	61.2-120		20	
<i>Surrogate: 1,2-Dichloroethane-d4</i>	<i>14.2</i>		<i>"</i>	<i>13.3</i>		<i>106</i>	<i>57.9-139</i>			
<i>Surrogate: Toluene-d8</i>	<i>13.2</i>		<i>"</i>	<i>13.3</i>		<i>98.8</i>	<i>83.1-115</i>			
<i>Surrogate: 4-Bromofluorobenzene</i>	<i>12.3</i>		<i>"</i>	<i>13.3</i>		<i>92.1</i>	<i>80.8-120</i>			

**LCS Dup (1033006-BSD1)**

Prepared & Analyzed: 03/30/11

Benzene	36.7	1.0	ug/l	33.3		110	60.1-131	2.64	10.9	
Toluene	35.8	1.0	"	33.3		107	65.9-127	2.10	11.3	
Ethylbenzene	34.9	1.0	"	33.3		105	65.1-129	6.43	20	
m,p-Xylene	66.4	2.0	"	66.7		99.6	66.8-127	6.43	20	
o-Xylene	35.0	1.0	"	33.3		105	61.2-120	5.53	20	
<i>Surrogate: 1,2-Dichloroethane-d4</i>	<i>14.7</i>		<i>"</i>	<i>13.3</i>		<i>110</i>	<i>57.9-139</i>			
<i>Surrogate: Toluene-d8</i>	<i>13.4</i>		<i>"</i>	<i>13.3</i>		<i>100</i>	<i>83.1-115</i>			
<i>Surrogate: 4-Bromofluorobenzene</i>	<i>12.2</i>		<i>"</i>	<i>13.3</i>		<i>91.3</i>	<i>80.8-120</i>			

Summit Scientific

*The results in this report apply to the samples analyzed in accordance with the chain of custody document. This analytical report must be reproduced in its entirety.*



LT Environmental, Inc.  
4600 West 60th Avenue  
Arvada CO, 80003

Project: PDC - Jason1,2,34-31

Project Number: 0188-  
Project Manager: Brian Dodek

**Reported:**  
04/07/11 09:34

**Volatile Organic Compounds by EPA Method 8260B - Quality Control**  
**Summit Scientific**

Analyte	Reporting			Spike	Source	%REC		RPD		Notes
	Result	Limit	Units	Level	Result	%REC	Limits	RPD	Limit	

**Batch 1040104 - EPA 5030 Soil MS**

**Blank (1040104-BLK1)**

Prepared: 04/01/11 Analyzed: 04/02/11

Naphthalene	ND	0.0050	mg/kg							
Benzene	ND	0.0050	"							
Benzene	ND	0.0050	"							
Toluene	ND	0.0050	"							
Ethylbenzene	ND	0.0050	"							
Toluene	ND	0.0050	"							
Ethylbenzene	ND	0.0050	"							
m,p-Xylene	ND	0.010	"							
o-Xylene	ND	0.0050	"							
Xylenes (total)	ND	0.0050	"							
Gasoline Range Hydrocarbons	ND	0.50	"							
Gasoline Range Hydrocarbons	ND	0.50	"							
<i>Surrogate: 1,2-Dichloroethane-d4</i>	<i>0.0395</i>		<i>"</i>	<i>0.0400</i>		<i>98.8</i>	<i>67.4-143</i>			
<i>Surrogate: 1,2-Dichloroethane-d4</i>	<i>0.0395</i>		<i>"</i>	<i>0.0400</i>		<i>98.8</i>	<i>67.4-143</i>			
<i>Surrogate: Toluene-d8</i>	<i>0.0390</i>		<i>"</i>	<i>0.0400</i>		<i>97.5</i>	<i>77.3-114</i>			
<i>Surrogate: Toluene-d8</i>	<i>0.0390</i>		<i>"</i>	<i>0.0400</i>		<i>97.5</i>	<i>77.3-114</i>			
<i>Surrogate: 4-Bromofluorobenzene</i>	<i>0.0347</i>		<i>"</i>	<i>0.0400</i>		<i>86.8</i>	<i>78.4-125</i>			
<i>Surrogate: 4-Bromofluorobenzene</i>	<i>0.0347</i>		<i>"</i>	<i>0.0400</i>		<i>86.8</i>	<i>78.4-125</i>			

**LCS (1040104-BS1)**

Prepared: 04/01/11 Analyzed: 04/02/11

Benzene	0.128	0.0050	mg/kg	0.100		128	61-139		11.1	
Naphthalene	ND	0.0050	"				67.8-151		20	
Toluene	0.123	0.0050	"	0.100		123	64-132		10.9	
Benzene	0.128	0.0050	"	0.100		128	61-139		11.1	
Ethylbenzene	0.131	0.0050	"	0.100		131	68.7-135		20	
Toluene	0.123	0.0050	"	0.100		123	64-132		10.9	
m,p-Xylene	0.245	0.010	"	0.200		122	70.4-129		20	
Ethylbenzene	0.131	0.0050	"	0.100		131	68.7-135		20	
o-Xylene	0.113	0.0050	"	0.100		113	66.9-126		20	
m,p-Xylene	0.245	0.010	"	0.200		122	70.4-129		20	
o-Xylene	0.113	0.0050	"	0.100		113	66.9-126		20	
<i>Surrogate: 1,2-Dichloroethane-d4</i>	<i>0.0402</i>		<i>"</i>	<i>0.0400</i>		<i>100</i>	<i>67.4-143</i>			
<i>Surrogate: 1,2-Dichloroethane-d4</i>	<i>0.0402</i>		<i>"</i>	<i>0.0400</i>		<i>100</i>	<i>67.4-143</i>			
<i>Surrogate: Toluene-d8</i>	<i>0.0405</i>		<i>"</i>	<i>0.0400</i>		<i>101</i>	<i>77.3-114</i>			
<i>Surrogate: Toluene-d8</i>	<i>0.0405</i>		<i>"</i>	<i>0.0400</i>		<i>101</i>	<i>77.3-114</i>			
<i>Surrogate: 4-Bromofluorobenzene</i>	<i>0.0326</i>		<i>"</i>	<i>0.0400</i>		<i>81.6</i>	<i>78.4-125</i>			
<i>Surrogate: 4-Bromofluorobenzene</i>	<i>0.0326</i>		<i>"</i>	<i>0.0400</i>		<i>81.6</i>	<i>78.4-125</i>			

Summit Scientific

*The results in this report apply to the samples analyzed in accordance with the chain of custody document. This analytical report must be reproduced in its entirety.*



LT Environmental, Inc.  
4600 West 60th Avenue  
Arvada CO, 80003

Project: PDC - Jason1,2,34-31

Project Number: 0188-  
Project Manager: Brian Dodek

**Reported:**  
04/07/11 09:34

**Volatile Organic Compounds by EPA Method 8260B - Quality Control**  
**Summit Scientific**

Analyte	Reporting			Spike	Source	%REC			RPD	Notes
	Result	Limit	Units	Level	Result	%REC	Limits	RPD	Limit	

**Batch 1040104 - EPA 5030 Soil MS**

**LCS Dup (1040104-BSD1)**

Prepared: 04/01/11 Analyzed: 04/02/11

Benzene	0.126	0.0050	mg/kg	0.100	126	61-139	1.28	11.1	
Naphthalene	ND	0.0050	"			67.8-151		20	
Toluene	0.125	0.0050	"	0.100	125	64-132	1.55	10.9	
Benzene	0.126	0.0050	"	0.100	126	61-139	1.28	11.1	
Toluene	0.125	0.0050	"	0.100	125	64-132	1.55	10.9	
Ethylbenzene	0.135	0.0050	"	0.100	135	68.7-135	3.37	20	
m,p-Xylene	0.254	0.010	"	0.200	127	70.4-129	3.53	20	
Ethylbenzene	0.135	0.0050	"	0.100	135	68.7-135	3.37	20	
m,p-Xylene	0.254	0.010	"	0.200	127	70.4-129	3.53	20	
o-Xylene	0.117	0.0050	"	0.100	117	66.9-126	3.62	20	
o-Xylene	0.117	0.0050	"	0.100	117	66.9-126	3.62	20	
<i>Surrogate: 1,2-Dichloroethane-d4</i>	<i>0.0399</i>		<i>"</i>	<i>0.0400</i>		<i>99.8</i>	<i>67.4-143</i>		
<i>Surrogate: 1,2-Dichloroethane-d4</i>	<i>0.0399</i>		<i>"</i>	<i>0.0400</i>		<i>99.8</i>	<i>67.4-143</i>		
<i>Surrogate: Toluene-d8</i>	<i>0.0410</i>		<i>"</i>	<i>0.0400</i>		<i>102</i>	<i>77.3-114</i>		
<i>Surrogate: Toluene-d8</i>	<i>0.0410</i>		<i>"</i>	<i>0.0400</i>		<i>102</i>	<i>77.3-114</i>		
<i>Surrogate: 4-Bromofluorobenzene</i>	<i>0.0358</i>		<i>"</i>	<i>0.0400</i>		<i>89.4</i>	<i>78.4-125</i>		
<i>Surrogate: 4-Bromofluorobenzene</i>	<i>0.0358</i>		<i>"</i>	<i>0.0400</i>		<i>89.4</i>	<i>78.4-125</i>		

**Matrix Spike (1040104-MS1)**

Source: R103184-01

Prepared: 04/01/11 Analyzed: 04/02/11

Naphthalene	ND	0.0050	mg/kg	0.00	0.00	26.4-144		20	
Benzene	0.127	0.0050	"	0.100	ND	42.9-137		17.9	
Benzene	0.127	0.0050	"	0.100	0.00	42.9-137		17.9	
Toluene	0.124	0.0050	"	0.100	ND	42.6-130		11.9	
Toluene	0.124	0.0050	"	0.100	0.00	42.6-130		11.9	
Ethylbenzene	0.136	0.0050	"	0.100	ND	39-133		20	
Ethylbenzene	0.136	0.0050	"	0.100	0.00	39-133		20	
m,p-Xylene	0.252	0.010	"	0.200	ND	34.7-134		20	
m,p-Xylene	0.252	0.010	"	0.200	0.00	34.7-134		20	
o-Xylene	0.118	0.0050	"	0.100	ND	41.3-126		20	
o-Xylene	0.118	0.0050	"	0.100	0.00	41.3-126		20	
<i>Surrogate: 1,2-Dichloroethane-d4</i>	<i>0.0443</i>		<i>"</i>	<i>0.0400</i>		<i>111</i>	<i>67.4-143</i>		
<i>Surrogate: 1,2-Dichloroethane-d4</i>	<i>0.0443</i>		<i>"</i>	<i>0.0400</i>		<i>111</i>	<i>67.4-143</i>		
<i>Surrogate: Toluene-d8</i>	<i>0.0377</i>		<i>"</i>	<i>0.0400</i>		<i>94.2</i>	<i>77.3-114</i>		
<i>Surrogate: Toluene-d8</i>	<i>0.0377</i>		<i>"</i>	<i>0.0400</i>		<i>94.2</i>	<i>77.3-114</i>		
<i>Surrogate: 4-Bromofluorobenzene</i>	<i>0.0368</i>		<i>"</i>	<i>0.0400</i>		<i>92.0</i>	<i>78.4-125</i>		
<i>Surrogate: 4-Bromofluorobenzene</i>	<i>0.0368</i>		<i>"</i>	<i>0.0400</i>		<i>92.0</i>	<i>78.4-125</i>		

Summit Scientific

*The results in this report apply to the samples analyzed in accordance with the chain of custody document. This analytical report must be reproduced in its entirety.*



LT Environmental, Inc.  
4600 West 60th Avenue  
Arvada CO, 80003

Project: PDC - Jason1,2,34-31

Project Number: 0188-  
Project Manager: Brian Dodek

**Reported:**  
04/07/11 09:34

**Volatile Organic Compounds by EPA Method 8260B - Quality Control**  
**Summit Scientific**

Analyte	Reporting			Spike	Source	%REC			RPD	Notes
	Result	Limit	Units	Level	Result	%REC	Limits	RPD	Limit	

**Batch 1040104 - EPA 5030 Soil MS**

<b>Matrix Spike Dup (1040104-MSD1)</b>	<b>Source: R103184-01</b>			Prepared: 04/01/11	Analized: 04/02/11						
Benzene	0.131	0.0050	mg/kg	0.100	ND	131	42.9-137	3.14	17.9		
Naphthalene	ND	0.0050	"		0.00		26.4-144		20		
Benzene	0.131	0.0050	"	0.100	0.00	131	42.9-137	3.14	17.9		
Toluene	0.128	0.0050	"	0.100	ND	128	42.6-130	3.51	11.9		
Ethylbenzene	0.137	0.0050	"	0.100	ND	137	39-133	0.483	20		
Toluene	0.128	0.0050	"	0.100	0.00	128	42.6-130	3.51	11.9		
m,p-Xylene	0.255	0.010	"	0.200	ND	128	34.7-134	1.16	20		
Ethylbenzene	0.137	0.0050	"	0.100	0.00	137	39-133	0.483	20		
o-Xylene	0.122	0.0050	"	0.100	ND	122	41.3-126	3.15	20		
m,p-Xylene	0.255	0.010	"	0.200	0.00	128	34.7-134	1.16	20		
o-Xylene	0.122	0.0050	"	0.100	0.00	122	41.3-126	3.15	20		
<i>Surrogate: 1,2-Dichloroethane-d4</i>	<i>0.0440</i>		<i>"</i>	<i>0.0400</i>		<i>110</i>	<i>67.4-143</i>				
<i>Surrogate: 1,2-Dichloroethane-d4</i>	<i>0.0440</i>		<i>"</i>	<i>0.0400</i>		<i>110</i>	<i>67.4-143</i>				
<i>Surrogate: Toluene-d8</i>	<i>0.0399</i>		<i>"</i>	<i>0.0400</i>		<i>99.8</i>	<i>77.3-114</i>				
<i>Surrogate: Toluene-d8</i>	<i>0.0399</i>		<i>"</i>	<i>0.0400</i>		<i>99.8</i>	<i>77.3-114</i>				
<i>Surrogate: 4-Bromofluorobenzene</i>	<i>0.0391</i>		<i>"</i>	<i>0.0400</i>		<i>97.6</i>	<i>78.4-125</i>				
<i>Surrogate: 4-Bromofluorobenzene</i>	<i>0.0391</i>		<i>"</i>	<i>0.0400</i>		<i>97.6</i>	<i>78.4-125</i>				

Summit Scientific

*The results in this report apply to the samples analyzed in accordance with the chain of custody document. This analytical report must be reproduced in its entirety.*



LT Environmental, Inc.  
4600 West 60th Avenue  
Arvada CO, 80003

Project: PDC - Jason1,2,34-31

Project Number: 0188-  
Project Manager: Brian Dodek

**Reported:**  
04/07/11 09:34

### Notes and Definitions

DET Analyte DETECTED  
ND Analyte NOT DETECTED at or above the reporting limit  
NR Not Reported  
dry Sample results reported on a dry weight basis  
RPD Relative Percent Difference

---

Summit Scientific

*The results in this report apply to the samples analyzed in accordance with the chain of custody document. This analytical report must be reproduced in its entirety.*

# Summit Scientific

---

741 Corporate Circle – Suite I ♦ Golden, Colorado 80401

303.277.9310 - laboratory ♦ 303.277.9531 - fax

February 07, 2011

Brian Dodek

LT Environmental, Inc.

4600 West 60th Avenue

Arvada, CO 80003

RE: PDC - Jason1,2,34-31

Enclosed are the results of analyses for samples received by Summit Scientific on 02/04/11 17:00. If you have any questions concerning this report, please feel free to contact me.

Sincerely,

A handwritten signature in black ink, appearing to be 'LS' with a long horizontal flourish extending to the right.

Logan Shrewsbury For Ben Shrewsbury  
President / Laboratory Director



LT Environmental, Inc.  
4600 West 60th Avenue  
Arvada CO, 80003

Project: PDC - Jason1,2,34-31

Project Number: 0188-11014.05  
Project Manager: Brian Dodek

**Reported:**  
02/07/11 15:27

### ANALYTICAL REPORT FOR SAMPLES

Sample ID	Laboratory ID	Matrix	Date Sampled	Date Received
GW04	R102024-01	Water	02/04/11 09:30	02/04/11 17:00
GW05	R102024-02	Water	02/04/11 09:40	02/04/11 17:00

Summit Scientific

*The results in this report apply to the samples analyzed in accordance with the chain of custody document. This analytical report must be reproduced in its entirety.*





LT Environmental, Inc.  
 4600 West 60th Avenue  
 Arvada CO, 80003

Project: PDC - Jason1,2,34-31

Project Number: 0188-11014.05  
 Project Manager: Brian Dodek

**Reported:**  
 02/07/11 15:27

**GW04**  
**R102024-01 (Water)**

**Summit Scientific**

**Volatile Organic Compounds by EPA Method 8260B**

Date Sampled: **02/04/11 09:30**

Analyte	Result	Reporting Limit	Units	Dilution	Batch	Prepared	Analyzed	Method	Notes
Benzene	ND	1.0	ug/l	1	1020501	02/05/11	02/06/11	EPA 8260B	
Toluene	ND	1.0	"	"	"	"	"	"	
Ethylbenzene	ND	1.0	"	"	"	"	"	"	
Xylenes (total)	ND	1.0	"	"	"	"	"	"	

Date Sampled: **02/04/11 09:30**

Analyte	Result	Reporting Limit	Units	Dilution	Batch	Prepared	Analyzed	Method	Notes
Surrogate: 1,2-Dichloroethane-d4		105 %	57.9-139		"	"	"	"	
Surrogate: Toluene-d8		95.6 %	83.1-115		"	"	"	"	
Surrogate: 4-Bromofluorobenzene		95.6 %	80.8-120		"	"	"	"	

Summit Scientific

*The results in this report apply to the samples analyzed in accordance with the chain of custody document. This analytical report must be reproduced in its entirety.*



LT Environmental, Inc.  
 4600 West 60th Avenue  
 Arvada CO, 80003

Project: PDC - Jason1,2,34-31

Project Number: 0188-11014.05  
 Project Manager: Brian Dodek

**Reported:**  
 02/07/11 15:27

**GW05**  
**R102024-02 (Water)**

**Summit Scientific**

**Volatile Organic Compounds by EPA Method 8260B**

Date Sampled: **02/04/11 09:40**

Analyte	Result	Reporting Limit	Units	Dilution	Batch	Prepared	Analyzed	Method	Notes
Benzene	ND	1.0	ug/l	1	1020501	02/05/11	02/06/11	EPA 8260B	
Toluene	ND	1.0	"	"	"	"	"	"	
Ethylbenzene	ND	1.0	"	"	"	"	"	"	
Xylenes (total)	ND	1.0	"	"	"	"	"	"	

Date Sampled: **02/04/11 09:40**

Analyte	Result	Reporting Limit	Units	Dilution	Batch	Prepared	Analyzed	Method	Notes
<i>Surrogate: 1,2-Dichloroethane-d4</i>		105 %	57.9-139		"	"	"	"	
<i>Surrogate: Toluene-d8</i>		96.7 %	83.1-115		"	"	"	"	
<i>Surrogate: 4-Bromofluorobenzene</i>		99.5 %	80.8-120		"	"	"	"	

Summit Scientific

*The results in this report apply to the samples analyzed in accordance with the chain of custody document. This analytical report must be reproduced in its entirety.*



LT Environmental, Inc.  
4600 West 60th Avenue  
Arvada CO, 80003

Project: PDC - Jason1,2,34-31

Project Number: 0188-11014.05  
Project Manager: Brian Dodek

Reported:  
02/07/11 15:27

**Volatile Organic Compounds by EPA Method 8260B - Quality Control**

**Summit Scientific**

Analyte	Reporting			Spike Level	Source		%REC		RPD		Notes
	Result	Limit	Units		Result	%REC	Limits	RPD	Limit		

**Batch 1020501 - EPA 5030 Water MS**

**Blank (1020501-BLK1)**

Prepared: 02/05/11 Analyzed: 02/07/11

Benzene	ND	1.0	ug/l								
Toluene	ND	1.0	"								
Ethylbenzene	ND	1.0	"								
Xylenes (total)	ND	1.0	"								
Surrogate: 1,2-Dichloroethane-d4	15.2		"	13.3		114	57.9-139				
Surrogate: Toluene-d8	12.8		"	13.3		96.2	83.1-115				
Surrogate: 4-Bromofluorobenzene	13.0		"	13.3		97.6	80.8-120				

**LCS (1020501-BS1)**

Prepared: 02/05/11 Analyzed: 02/07/11

Benzene	30.8	1.0	ug/l	33.3		92.4	60.1-131		10.9		
Toluene	30.5	1.0	"	33.3		91.5	65.9-127		11.3		
Ethylbenzene	33.0	1.0	"	33.3		99.1	65.1-129		20		
m,p-Xylene	62.3	2.0	"	66.7		93.5	66.8-127		20		
o-Xylene	31.7	1.0	"	33.3		95.0	61.2-120		20		
Surrogate: 1,2-Dichloroethane-d4	14.5		"	13.3		109	57.9-139				
Surrogate: Toluene-d8	13.2		"	13.3		98.9	83.1-115				
Surrogate: 4-Bromofluorobenzene	12.5		"	13.3		93.6	80.8-120				

**LCS Dup (1020501-BSD1)**

Prepared: 02/05/11 Analyzed: 02/07/11

Benzene	28.6	1.0	ug/l	33.3		85.7	60.1-131	7.48	10.9		
Toluene	28.5	1.0	"	33.3		85.4	65.9-127	6.92	11.3		
Ethylbenzene	30.3	1.0	"	33.3		91.0	65.1-129	8.56	20		
m,p-Xylene	57.6	2.0	"	66.7		86.4	66.8-127	7.92	20		
o-Xylene	29.3	1.0	"	33.3		87.9	61.2-120	7.77	20		
Surrogate: 1,2-Dichloroethane-d4	14.6		"	13.3		109	57.9-139				
Surrogate: Toluene-d8	13.0		"	13.3		97.5	83.1-115				
Surrogate: 4-Bromofluorobenzene	12.6		"	13.3		94.7	80.8-120				

Summit Scientific

The results in this report apply to the samples analyzed in accordance with the chain of custody document. This analytical report must be reproduced in its entirety.



LT Environmental, Inc.  
4600 West 60th Avenue  
Arvada CO, 80003

Project: PDC - Jason1,2,34-31

Project Number: 0188-11014.05  
Project Manager: Brian Dodek

**Reported:**  
02/07/11 15:27

### Notes and Definitions

DET Analyte DETECTED  
ND Analyte NOT DETECTED at or above the reporting limit  
NR Not Reported  
dry Sample results reported on a dry weight basis  
RPD Relative Percent Difference

---

Summit Scientific

*The results in this report apply to the samples analyzed in accordance with the chain of custody document. This analytical report must be reproduced in its entirety.*

# Summit Scientific

---

741 Corporate Circle – Suite I ♦ Golden, Colorado 80401

303.277.9310 - laboratory ♦ 303.277.9531 - fax

January 29, 2011

Brian Dodek  
LT Environmental, Inc.  
4600 West 60th Avenue  
Arvada, CO 80003  
RE: PDC - Jason1,2,34-31

Enclosed are the results of analyses for samples received by Summit Scientific on 01/27/11 17:00. If you have any questions concerning this report, please feel free to contact me.

Sincerely,

A handwritten signature in black ink, appearing to be 'PS', with a long horizontal flourish extending to the right.

Paul Shrewsbury For Ben Shrewsbury  
President / Laboratory Director



LT Environmental, Inc.  
4600 West 60th Avenue  
Arvada CO, 80003

Project: PDC - Jason1,2,34-31

Project Number: 0188-11014.05  
Project Manager: Brian Dodek

**Reported:**  
01/29/11 10:11

### ANALYTICAL REPORT FOR SAMPLES

Sample ID	Laboratory ID	Matrix	Date Sampled	Date Received
SS01	R101146-01	Soil	01/27/11 12:10	01/27/11 17:00
SS02	R101146-02	Soil	01/27/11 12:15	01/27/11 17:00
SS03	R101146-03	Soil	01/27/11 12:20	01/27/11 17:00
SS04	R101146-04	Soil	01/27/11 12:25	01/27/11 17:00
GW02	R101146-05	Water	01/27/11 12:40	01/27/11 17:00
GW03	R101146-06	Water	01/27/11 13:30	01/27/11 17:00

Summit Scientific

*The results in this report apply to the samples analyzed in accordance with the chain of custody document. This analytical report must be reproduced in its entirety.*



LT Environmental, Inc.  
4600 West 60th Avenue  
Arvada CO, 80003

Project: PDC - Jason1,2,3,4-31

Project Number: 0188-11014.05  
Project Manager: Brian Dodek

Reported:  
01/29/11 10:11

# Summit Scientific

741 Corporate Circle Suite 1 ♦ Golden, Colorado 80401  
303-277-9310 ♦ 303-277-9531 Fax

Page | of |

Client: LT Environmental, Inc. Project Manager: Brian Dodek  
Address: 4600 West 60th Avenue E-Mail: bdodek@ltenv.com  
City/State/Zip: Arvada, CO 80003 Project Name: PDC Jason 1, 2, 3, 4-31  
Phone: (303) 433-9788 Fax: (303) 433-4432 Project Number: 0188/11014.05  
Sampler Name: Devin Griffin

Sample Description	Date Sampled	Time Sampled	Number of Containers	Preservative				Matrix				Analyze For:					Special Instructions	Notes:								
				HCl	HNO <sub>3</sub>	None	Other (Specify)	Groundwater	Soil	Air - Canister Serial #	Other (Specify)	DRO	GBTEX / MP6	BTEX	Table 9.10 Full	Table 9.10 Short			PH / EC	SAR						
S501	1-27-11	1210	1		X			X					X													
S503		1215	1																							
S503		1230	1																							
S504		1235	1																							
GW02		1240	3	X				X																		
GW03		1330	1	X				X																		
Relinquished by:	Date/Time:	Received by:	Date/Time:	Turn Around Time (Check)																						
Devin Griffin	1-27-11	Devin Griffin	1-27-11	Same Day																						
				24 Hours																						
				48 Hours																						
Relinquished by:	Date/Time:	Received in Lab by:	Date/Time:	Sample Integrity:																						
				Temperature Upon Receipt:																						
				Intact: Yes/No																						

www.s2scientific.com



LT Environmental, Inc.  
4600 West 60th Avenue  
Arvada CO, 80003

Project: PDC - Jason1,2,34-31

Project Number: 0188-11014.05  
Project Manager: Brian Dodek

**Reported:**  
01/29/11 10:11

**SS01**  
**R101146-01 (Soil)**

**Summit Scientific**

**Total Petroleum Hydrocarbons by 8015**

Date Sampled: **01/27/11 12:10**

Analyte	Result	Reporting Limit	Units	Dilution	Batch	Prepared	Analyzed	Method	Notes
C10-C28 (DRO)	ND	50	mg/kg	1	1012701	01/27/11	01/28/11	8015 DRO	

Date Sampled: **01/27/11 12:10**

Analyte	Result	Reporting Limit	Units	Dilution	Batch	Prepared	Analyzed	Method	Notes
Surrogate: <i>o</i> -Terphenyl		108 %	88.8-124		"	"	"	"	

**Volatile Organic Compounds by EPA Method 8260B**

Date Sampled: **01/27/11 12:10**

Analyte	Result	Reporting Limit	Units	Dilution	Batch	Prepared	Analyzed	Method	Notes
Naphthalene	ND	0.0050	mg/kg	1	1012702	01/27/11	01/28/11	EPA 8260B	
Benzene	ND	0.0050	"	"	"	"	"	"	
Toluene	ND	0.0050	"	"	"	"	"	"	
Ethylbenzene	ND	0.0050	"	"	"	"	"	"	
m,p-Xylene	ND	0.010	"	"	"	"	"	"	
o-Xylene	ND	0.0050	"	"	"	"	"	"	
Gasoline Range Hydrocarbons	ND	0.50	"	"	"	"	"	"	

Date Sampled: **01/27/11 12:10**

Analyte	Result	Reporting Limit	Units	Dilution	Batch	Prepared	Analyzed	Method	Notes
Surrogate: 1,2-Dichloroethane-d4		110 %	67.4-143		"	"	"	"	
Surrogate: Toluene-d8		97.4 %	77.3-114		"	"	"	"	
Surrogate: 4-Bromofluorobenzene		97.7 %	78.4-125		"	"	"	"	

Summit Scientific

*The results in this report apply to the samples analyzed in accordance with the chain of custody document. This analytical report must be reproduced in its entirety.*



LT Environmental, Inc.  
4600 West 60th Avenue  
Arvada CO, 80003

Project: PDC - Jason1,2,34-31

Project Number: 0188-11014.05  
Project Manager: Brian Dodek

**Reported:**  
01/29/11 10:11

**SS02**  
**R101146-02 (Soil)**

**Summit Scientific**

**Total Petroleum Hydrocarbons by 8015**

Date Sampled: **01/27/11 12:15**

Analyte	Result	Reporting Limit	Units	Dilution	Batch	Prepared	Analyzed	Method	Notes
C10-C28 (DRO)	ND	50	mg/kg	1	1012701	01/27/11	01/28/11	8015 DRO	

Date Sampled: **01/27/11 12:15**

Analyte	Result	Reporting Limit	Units	Dilution	Batch	Prepared	Analyzed	Method	Notes
Surrogate: <i>o</i> -Terphenyl		109 %	88.8-124		"	"	"	"	

**Volatile Organic Compounds by EPA Method 8260B**

Date Sampled: **01/27/11 12:15**

Analyte	Result	Reporting Limit	Units	Dilution	Batch	Prepared	Analyzed	Method	Notes
Naphthalene	ND	0.0050	mg/kg	1	1012702	01/27/11	01/28/11	EPA 8260B	
Benzene	ND	0.0050	"	"	"	"	"	"	
Toluene	ND	0.0050	"	"	"	"	"	"	
Ethylbenzene	ND	0.0050	"	"	"	"	"	"	
m,p-Xylene	ND	0.010	"	"	"	"	"	"	
o-Xylene	ND	0.0050	"	"	"	"	"	"	
Gasoline Range Hydrocarbons	ND	0.50	"	"	"	"	"	"	

Date Sampled: **01/27/11 12:15**

Analyte	Result	Reporting Limit	Units	Dilution	Batch	Prepared	Analyzed	Method	Notes
Surrogate: 1,2-Dichloroethane-d4		115 %	67.4-143		"	"	"	"	
Surrogate: Toluene-d8		97.0 %	77.3-114		"	"	"	"	
Surrogate: 4-Bromofluorobenzene		99.7 %	78.4-125		"	"	"	"	

Summit Scientific

*The results in this report apply to the samples analyzed in accordance with the chain of custody document. This analytical report must be reproduced in its entirety.*



LT Environmental, Inc.  
4600 West 60th Avenue  
Arvada CO, 80003

Project: PDC - Jason1,2,34-31

Project Number: 0188-11014.05  
Project Manager: Brian Dodek

**Reported:**  
01/29/11 10:11

**SS03**  
**R101146-03 (Soil)**

**Summit Scientific**

**Total Petroleum Hydrocarbons by 8015**

Date Sampled: **01/27/11 12:20**

Analyte	Result	Reporting Limit	Units	Dilution	Batch	Prepared	Analyzed	Method	Notes
C10-C28 (DRO)	ND	50	mg/kg	1	1012701	01/27/11	01/28/11	8015 DRO	

Date Sampled: **01/27/11 12:20**

Analyte	Result	Reporting Limit	Units	Dilution	Batch	Prepared	Analyzed	Method	Notes
Surrogate: <i>o</i> -Terphenyl		108 %	88.8-124		"	"	"	"	

**Volatile Organic Compounds by EPA Method 8260B**

Date Sampled: **01/27/11 12:20**

Analyte	Result	Reporting Limit	Units	Dilution	Batch	Prepared	Analyzed	Method	Notes
Naphthalene	ND	0.0050	mg/kg	1	1012702	01/27/11	01/28/11	EPA 8260B	
Benzene	ND	0.0050	"	"	"	"	"	"	
Toluene	ND	0.0050	"	"	"	"	"	"	
Ethylbenzene	ND	0.0050	"	"	"	"	"	"	
m,p-Xylene	ND	0.010	"	"	"	"	"	"	
o-Xylene	ND	0.0050	"	"	"	"	"	"	
Gasoline Range Hydrocarbons	ND	0.50	"	"	"	"	"	"	

Date Sampled: **01/27/11 12:20**

Analyte	Result	Reporting Limit	Units	Dilution	Batch	Prepared	Analyzed	Method	Notes
Surrogate: 1,2-Dichloroethane-d4		113 %	67.4-143		"	"	"	"	
Surrogate: Toluene-d8		96.8 %	77.3-114		"	"	"	"	
Surrogate: 4-Bromofluorobenzene		99.8 %	78.4-125		"	"	"	"	

Summit Scientific

The results in this report apply to the samples analyzed in accordance with the chain of custody document. This analytical report must be reproduced in its entirety.



LT Environmental, Inc.  
4600 West 60th Avenue  
Arvada CO, 80003

Project: PDC - Jason1,2,34-31

Project Number: 0188-11014.05  
Project Manager: Brian Dodek

**Reported:**  
01/29/11 10:11

**SS04**  
**R101146-04 (Soil)**

**Summit Scientific**

**Total Petroleum Hydrocarbons by 8015**

Date Sampled: **01/27/11 12:25**

Analyte	Result	Reporting Limit	Units	Dilution	Batch	Prepared	Analyzed	Method	Notes
C10-C28 (DRO)	ND	50	mg/kg	1	1012701	01/27/11	01/28/11	8015 DRO	

Date Sampled: **01/27/11 12:25**

Analyte	Result	Reporting Limit	Units	Dilution	Batch	Prepared	Analyzed	Method	Notes
Surrogate: <i>o</i> -Terphenyl		110 %	88.8-124		"	"	"	"	

**Volatile Organic Compounds by EPA Method 8260B**

Date Sampled: **01/27/11 12:25**

Analyte	Result	Reporting Limit	Units	Dilution	Batch	Prepared	Analyzed	Method	Notes
Naphthalene	ND	0.0050	mg/kg	1	1012702	01/27/11	01/28/11	EPA 8260B	
Benzene	ND	0.0050	"	"	"	"	"	"	
Toluene	ND	0.0050	"	"	"	"	"	"	
Ethylbenzene	ND	0.0050	"	"	"	"	"	"	
m,p-Xylene	ND	0.010	"	"	"	"	"	"	
o-Xylene	ND	0.0050	"	"	"	"	"	"	
Gasoline Range Hydrocarbons	ND	0.50	"	"	"	"	"	"	

Date Sampled: **01/27/11 12:25**

Analyte	Result	Reporting Limit	Units	Dilution	Batch	Prepared	Analyzed	Method	Notes
Surrogate: 1,2-Dichloroethane-d4		91.3 %	67.4-143		"	"	"	"	
Surrogate: Toluene-d8		95.1 %	77.3-114		"	"	"	"	
Surrogate: 4-Bromofluorobenzene		91.0 %	78.4-125		"	"	"	"	

Summit Scientific

The results in this report apply to the samples analyzed in accordance with the chain of custody document. This analytical report must be reproduced in its entirety.



LT Environmental, Inc.  
 4600 West 60th Avenue  
 Arvada CO, 80003

Project: PDC - Jason1,2,34-31

Project Number: 0188-11014.05  
 Project Manager: Brian Dodek

**Reported:**  
 01/29/11 10:11

**GW02**  
**R101146-05 (Water)**

**Summit Scientific**

**Volatile Organic Compounds by EPA Method 8260B**

Date Sampled: **01/27/11 12:40**

Analyte	Result	Reporting Limit	Units	Dilution	Batch	Prepared	Analyzed	Method	Notes
Benzene	ND	1.0	ug/l	1	1012703	01/27/11	01/28/11	EPA 8260B	
Toluene	ND	1.0	"	"	"	"	"	"	
Ethylbenzene	ND	1.0	"	"	"	"	"	"	
Xylenes (total)	ND	1.0	"	"	"	"	"	"	

Date Sampled: **01/27/11 12:40**

Analyte	Result	Reporting Limit	Units	Dilution	Batch	Prepared	Analyzed	Method	Notes
<i>Surrogate: 1,2-Dichloroethane-d4</i>		102 %	57.9-139		"	"	"	"	
<i>Surrogate: Toluene-d8</i>		99.2 %	83.1-115		"	"	"	"	
<i>Surrogate: 4-Bromofluorobenzene</i>		97.1 %	80.8-120		"	"	"	"	

Summit Scientific

*The results in this report apply to the samples analyzed in accordance with the chain of custody document. This analytical report must be reproduced in its entirety.*



LT Environmental, Inc.  
 4600 West 60th Avenue  
 Arvada CO, 80003

Project: PDC - Jason1,2,34-31

Project Number: 0188-11014.05  
 Project Manager: Brian Dodek

**Reported:**  
 01/29/11 10:11

**GW03**  
**R101146-06 (Water)**

**Summit Scientific**

**Volatile Organic Compounds by EPA Method 8260B**

Date Sampled: **01/27/11 13:30**

Analyte	Result	Reporting Limit	Units	Dilution	Batch	Prepared	Analyzed	Method	Notes
<b>Benzene</b>	<b>270</b>	1.0	ug/l	1	1012703	01/27/11	01/28/11	EPA 8260B	
Toluene	ND	1.0	"	"	"	"	"	"	
Ethylbenzene	ND	1.0	"	"	"	"	"	"	
Xylenes (total)	ND	1.0	"	"	"	"	"	"	

Date Sampled: **01/27/11 13:30**

Analyte	Result	Reporting Limit	Units	Dilution	Batch	Prepared	Analyzed	Method	Notes
<i>Surrogate: 1,2-Dichloroethane-d4</i>		104 %	57.9-139		"	"	"	"	
<i>Surrogate: Toluene-d8</i>		99.2 %	83.1-115		"	"	"	"	
<i>Surrogate: 4-Bromofluorobenzene</i>		98.0 %	80.8-120		"	"	"	"	

Summit Scientific

*The results in this report apply to the samples analyzed in accordance with the chain of custody document. This analytical report must be reproduced in its entirety.*



LT Environmental, Inc.  
4600 West 60th Avenue  
Arvada CO, 80003

Project: PDC - Jason1,2,34-31

Project Number: 0188-11014.05  
Project Manager: Brian Dodek

**Reported:**  
01/29/11 10:11

**Total Petroleum Hydrocarbons by 8015 - Quality Control**  
**Summit Scientific**

Analyte	Reporting			Spike Level	Source		%REC		RPD		Notes
	Result	Limit	Units		Result	%REC	Limits	RPD	Limit		

**Batch 1012701 - EPA 3550A**

<b>Blank (1012701-BLK1)</b>				Prepared: 01/27/11		Analyzed: 01/28/11					
C10-C28 (DRO)	ND	50	mg/kg								
Surrogate: <i>o</i> -Terphenyl	14.5		"	12.5		116	88.8-124				
<b>Blank (1012701-BLK2)</b>				Prepared: 01/27/11		Analyzed: 01/28/11					
C10-C28 (DRO)	ND	50	mg/kg								
Surrogate: <i>o</i> -Terphenyl	13.9		"	12.5		111	88.8-124				
<b>LCS (1012701-BS1)</b>				Prepared: 01/27/11		Analyzed: 01/28/11					
C10-C28 (DRO)	501	50	mg/kg	501		100	81.4-129			9.26	
<b>LCS (1012701-BS2)</b>				Prepared: 01/27/11		Analyzed: 01/28/11					
C10-C28 (DRO)	49.7	50	mg/kg				81.4-129			9.26	
<b>LCS Dup (1012701-BSD1)</b>				Prepared: 01/27/11		Analyzed: 01/28/11					
C10-C28 (DRO)	474	50	mg/kg	501		94.6	81.4-129	5.49		9.26	
<b>LCS Dup (1012701-BSD2)</b>				Prepared: 01/27/11		Analyzed: 01/28/11					
C10-C28 (DRO)	50.7	50	mg/kg				81.4-129	1.90		9.26	
<b>Matrix Spike (1012701-MS1)</b>				Source: R101142-01		Prepared: 01/27/11		Analyzed: 01/28/11			
C10-C28 (DRO)	471	50	mg/kg	501	23.4	89.3	77.8-133			8.48	
<b>Matrix Spike (1012701-MS2)</b>				Source: R101139-01		Prepared: 01/27/11		Analyzed: 01/28/11			
C10-C28 (DRO)	48.4	50	mg/kg		22.2		77.8-133			8.48	
<b>Matrix Spike Dup (1012701-MSD1)</b>				Source: R101142-01		Prepared: 01/27/11		Analyzed: 01/28/11			
C10-C28 (DRO)	478	50	mg/kg	501	23.4	90.8	77.8-133	1.49		8.48	

Summit Scientific

*The results in this report apply to the samples analyzed in accordance with the chain of custody document. This analytical report must be reproduced in its entirety.*



LT Environmental, Inc.  
 4600 West 60th Avenue  
 Arvada CO, 80003

Project: PDC - Jason1,2,34-31

Project Number: 0188-11014.05  
 Project Manager: Brian Dodek

**Reported:**  
 01/29/11 10:11

**Total Petroleum Hydrocarbons by 8015 - Quality Control**  
**Summit Scientific**

Analyte	Reporting			Spike	Source	%REC		RPD		Notes
	Result	Limit	Units	Level	Result	%REC	Limits	RPD	Limit	

**Batch 1012701 - EPA 3550A**

<b>Matrix Spike Dup (1012701-MSD2)</b>	<b>Source: R101139-01</b>			Prepared: 01/27/11	Analyzed: 01/28/11						
C10-C28 (DRO)	48.4	50	mg/kg	22.2	77.8-133	0.00	8.48				

Summit Scientific

*The results in this report apply to the samples analyzed in accordance with the chain of custody document. This analytical report must be reproduced in its entirety.*



LT Environmental, Inc.  
4600 West 60th Avenue  
Arvada CO, 80003

Project: PDC - Jason1,2,34-31

Project Number: 0188-11014.05  
Project Manager: Brian Dodek

**Reported:**  
01/29/11 10:11

**Volatile Organic Compounds by EPA Method 8260B - Quality Control**  
**Summit Scientific**

Analyte	Reporting			Spike	Source	%REC			RPD	Notes
	Result	Limit	Units	Level	Result	%REC	Limits	RPD	Limit	

**Batch 1012702 - EPA 5030 Soil MS**

**Blank (1012702-BLK1)**

Prepared: 01/27/11 Analyzed: 01/28/11

Naphthalene	ND	0.0050	mg/kg							
Benzene	ND	0.0050	"							
Toluene	ND	0.0050	"							
Ethylbenzene	ND	0.0050	"							
m,p-Xylene	ND	0.010	"							
o-Xylene	ND	0.0050	"							
Gasoline Range Hydrocarbons	ND	0.50	"							
<i>Surrogate: 1,2-Dichloroethane-d4</i>	<i>0.0404</i>		<i>"</i>	<i>0.0400</i>		<i>101</i>	<i>67.4-143</i>			
<i>Surrogate: Toluene-d8</i>	<i>0.0387</i>		<i>"</i>	<i>0.0400</i>		<i>96.8</i>	<i>77.3-114</i>			
<i>Surrogate: 4-Bromofluorobenzene</i>	<i>0.0389</i>		<i>"</i>	<i>0.0400</i>		<i>97.2</i>	<i>78.4-125</i>			

**LCS (1012702-BS1)**

Prepared: 01/27/11 Analyzed: 01/28/11

Naphthalene	ND	0.0050	mg/kg				67.8-151		20	
Benzene	0.102	0.0050	"	0.100		102	61-139	2.32	11.1	
Toluene	0.103	0.0050	"	0.100		103	64-132	1.98	10.9	
Ethylbenzene	0.107	0.0050	"	0.100		107	68.7-135	1.50	20	
m,p-Xylene	0.219	0.010	"	0.200		110	70.4-129	1.25	20	
o-Xylene	0.107	0.0050	"	0.100		107	66.9-126	2.47	20	
<i>Surrogate: 1,2-Dichloroethane-d4</i>	<i>0.0415</i>		<i>"</i>	<i>0.0400</i>		<i>104</i>	<i>67.4-143</i>			
<i>Surrogate: Toluene-d8</i>	<i>0.0390</i>		<i>"</i>	<i>0.0400</i>		<i>97.6</i>	<i>77.3-114</i>			
<i>Surrogate: 4-Bromofluorobenzene</i>	<i>0.0408</i>		<i>"</i>	<i>0.0400</i>		<i>102</i>	<i>78.4-125</i>			

**LCS Dup (1012702-BSD1)**

Prepared: 01/27/11 Analyzed: 01/28/11

Naphthalene	ND	0.0050	mg/kg				67.8-151		20	
Benzene	0.105	0.0050	"	0.100		105	61-139	2.32	11.1	
Toluene	0.105	0.0050	"	0.100		105	64-132	1.98	10.9	
Ethylbenzene	0.109	0.0050	"	0.100		109	68.7-135	1.50	20	
m,p-Xylene	0.222	0.010	"	0.200		111	70.4-129	1.25	20	
o-Xylene	0.110	0.0050	"	0.100		110	66.9-126	2.47	20	
<i>Surrogate: 1,2-Dichloroethane-d4</i>	<i>0.0414</i>		<i>"</i>	<i>0.0400</i>		<i>104</i>	<i>67.4-143</i>			
<i>Surrogate: Toluene-d8</i>	<i>0.0393</i>		<i>"</i>	<i>0.0400</i>		<i>98.2</i>	<i>77.3-114</i>			
<i>Surrogate: 4-Bromofluorobenzene</i>	<i>0.0400</i>		<i>"</i>	<i>0.0400</i>		<i>100</i>	<i>78.4-125</i>			

Summit Scientific

*The results in this report apply to the samples analyzed in accordance with the chain of custody document. This analytical report must be reproduced in its entirety.*



LT Environmental, Inc.  
4600 West 60th Avenue  
Arvada CO, 80003

Project: PDC - Jason1,2,34-31

Project Number: 0188-11014.05  
Project Manager: Brian Dodek

**Reported:**  
01/29/11 10:11

**Volatile Organic Compounds by EPA Method 8260B - Quality Control**  
**Summit Scientific**

Analyte	Reporting			Spike	Source	%REC			RPD	Notes
	Result	Limit	Units	Level	Result	%REC	Limits	RPD	Limit	

**Batch 1012702 - EPA 5030 Soil MS**

**Matrix Spike (1012702-MS1)**

Source: R101143-01

Prepared: 01/27/11

Analyzed: 01/28/11

Naphthalene	ND	0.0050	mg/kg		0.00		26.4-144		20	
Benzene	0.100	0.0050	"	0.100	0.00	100	42.9-137		17.9	
Toluene	0.101	0.0050	"	0.100	0.00	101	42.6-130		11.9	
Ethylbenzene	0.0903	0.0050	"	0.100	0.00	90.3	39-133		20	
m,p-Xylene	0.186	0.010	"	0.200	0.00	93.1	34.7-134		20	
o-Xylene	0.0976	0.0050	"	0.100	0.00	97.6	41.3-126		20	
Surrogate: 1,2-Dichloroethane-d4	0.0509		"	0.0400		127	67.4-143			
Surrogate: Toluene-d8	0.0391		"	0.0400		97.8	77.3-114			
Surrogate: 4-Bromofluorobenzene	0.0422		"	0.0400		105	78.4-125			

**Matrix Spike Dup (1012702-MSD1)**

Source: R101143-01

Prepared: 01/27/11

Analyzed: 01/28/11

Naphthalene	ND	0.0050	mg/kg		0.00		26.4-144		20	
Benzene	0.0977	0.0050	"	0.100	0.00	97.7	42.9-137	2.64	17.9	
Toluene	0.0968	0.0050	"	0.100	0.00	96.8	42.6-130	3.89	11.9	
Ethylbenzene	0.0866	0.0050	"	0.100	0.00	86.6	39-133	4.17	20	
m,p-Xylene	0.184	0.010	"	0.200	0.00	92.0	34.7-134	1.20	20	
o-Xylene	0.0948	0.0050	"	0.100	0.00	94.8	41.3-126	2.87	20	
Surrogate: 1,2-Dichloroethane-d4	0.0490		"	0.0400		122	67.4-143			
Surrogate: Toluene-d8	0.0395		"	0.0400		98.8	77.3-114			
Surrogate: 4-Bromofluorobenzene	0.0417		"	0.0400		104	78.4-125			

**Batch 1012703 - EPA 5030 Water MS**

**Blank (1012703-BLK1)**

Prepared: 01/27/11

Analyzed: 01/28/11

Benzene	ND	1.0	ug/l							
Toluene	ND	1.0	"							
Ethylbenzene	ND	1.0	"							
Xylenes (total)	ND	1.0	"							
Surrogate: 1,2-Dichloroethane-d4	13.5		"	13.3		101	57.9-139			
Surrogate: Toluene-d8	13.2		"	13.3		99.2	83.1-115			
Surrogate: 4-Bromofluorobenzene	12.9		"	13.3		96.8	80.8-120			

Summit Scientific

The results in this report apply to the samples analyzed in accordance with the chain of custody document. This analytical report must be reproduced in its entirety.



LT Environmental, Inc.  
4600 West 60th Avenue  
Arvada CO, 80003

Project: PDC - Jason1,2,34-31

Project Number: 0188-11014.05  
Project Manager: Brian Dodek

**Reported:**  
01/29/11 10:11

**Volatile Organic Compounds by EPA Method 8260B - Quality Control**  
**Summit Scientific**

Analyte	Reporting			Spike	Source	%REC		RPD		Notes
	Result	Limit	Units	Level	Result	%REC	Limits	RPD	Limit	

**Batch 1012703 - EPA 5030 Water MS**

**LCS (1012703-BS1)**

Prepared: 01/27/11 Analyzed: 01/28/11

Benzene	34.1	1.0	ug/l	33.3	102	60.1-131		10.9	
Toluene	33.9	1.0	"	33.3	102	65.9-127		11.3	
Ethylbenzene	35.2	1.0	"	33.3	106	65.1-129		20	
m,p-Xylene	72.8	2.0	"	66.7	109	66.8-127		20	
o-Xylene	35.6	1.0	"	33.3	107	61.2-120		20	
Surrogate: 1,2-Dichloroethane-d4	12.0		"	13.3	90.3	57.9-139			
Surrogate: Toluene-d8	13.1		"	13.3	98.4	83.1-115			
Surrogate: 4-Bromofluorobenzene	13.4		"	13.3	100	80.8-120			

**LCS Dup (1012703-BSD1)**

Prepared: 01/27/11 Analyzed: 01/28/11

Benzene	36.6	1.0	ug/l	33.3	110	60.1-131	7.04	10.9	
Toluene	36.6	1.0	"	33.3	110	65.9-127	7.71	11.3	
Ethylbenzene	37.9	1.0	"	33.3	114	65.1-129	7.30	20	
m,p-Xylene	78.2	2.0	"	66.7	117	66.8-127	7.19	20	
o-Xylene	38.0	1.0	"	33.3	114	61.2-120	6.66	20	
Surrogate: 1,2-Dichloroethane-d4	13.7		"	13.3	103	57.9-139			
Surrogate: Toluene-d8	13.2		"	13.3	99.1	83.1-115			
Surrogate: 4-Bromofluorobenzene	13.1		"	13.3	98.3	80.8-120			

Summit Scientific

*The results in this report apply to the samples analyzed in accordance with the chain of custody document. This analytical report must be reproduced in its entirety.*



LT Environmental, Inc.  
4600 West 60th Avenue  
Arvada CO, 80003

Project: PDC - Jason1,2,34-31

Project Number: 0188-11014.05  
Project Manager: Brian Dodek

**Reported:**  
01/29/11 10:11

### Notes and Definitions

DET Analyte DETECTED  
ND Analyte NOT DETECTED at or above the reporting limit  
NR Not Reported  
dry Sample results reported on a dry weight basis  
RPD Relative Percent Difference

---

Summit Scientific

*The results in this report apply to the samples analyzed in accordance with the chain of custody document. This analytical report must be reproduced in its entirety.*

# Summit Scientific

---

741 Corporate Circle – Suite I ♦ Golden, Colorado 80401

303.277.9310 - laboratory ♦ 303.277.9531 - fax

January 27, 2011

Brian Dodek  
LT Environmental, Inc.  
4600 West 60th Avenue  
Arvada, CO 80003  
RE: PDC - Jason1,2,34-31

Enclosed are the results of analyses for samples received by Summit Scientific on 01/26/11 17:00. If you have any questions concerning this report, please feel free to contact me.

Sincerely,

A handwritten signature in black ink, appearing to be 'PS', with a long horizontal flourish extending to the right.

Paul Shrewsbury For Ben Shrewsbury  
President / Laboratory Director





LT Environmental, Inc.  
 4600 West 60th Avenue  
 Arvada CO, 80003

Project: PDC - Jason1,2,34-31

Project Number: 0188-11014.05  
 Project Manager: Brian Dodek

**Reported:**  
 01/27/11 08:31

**GW01**  
**R101134-01 (Water)**

**Summit Scientific**

**Volatile Organic Compounds by EPA Method 8260B**

Date Sampled: **01/26/11 10:10**

Analyte	Result	Reporting Limit	Units	Dilution	Batch	Prepared	Analyzed	Method	Notes
<b>Benzene</b>	<b>1400</b>	100	ug/l	100	1012508	01/26/11	01/26/11	EPA 8260B	
<b>Toluene</b>	<b>2300</b>	100	"	"	"	"	"	"	
<b>Ethylbenzene</b>	<b>65</b>	1.0	"	1	"	"	01/26/11	"	
<b>Xylenes (total)</b>	<b>680</b>	1.0	"	"	"	"	"	"	

Date Sampled: **01/26/11 10:10**

Analyte	Result	Reporting Limit	Units	Dilution	Batch	Prepared	Analyzed	Method	Notes
<i>Surrogate: 1,2-Dichloroethane-d4</i>		118 %	57.9-139		"	"	"	"	
<i>Surrogate: Toluene-d8</i>		91.5 %	83.1-115		"	"	"	"	
<i>Surrogate: 4-Bromofluorobenzene</i>		92.9 %	80.8-120		"	"	"	"	

Summit Scientific

*The results in this report apply to the samples analyzed in accordance with the chain of custody document. This analytical report must be reproduced in its entirety.*



LT Environmental, Inc.  
4600 West 60th Avenue  
Arvada CO, 80003

Project: PDC - Jason1,2,34-31

Project Number: 0188-11014.05  
Project Manager: Brian Dodek

**Reported:**  
01/27/11 08:31

**Volatile Organic Compounds by EPA Method 8260B - Quality Control**

**Summit Scientific**

Analyte	Reporting			Spike	Source	%REC		RPD		Notes
	Result	Limit	Units	Level	Result	%REC	Limits	RPD	Limit	

**Batch 1012508 - EPA 5030 Water MS**

**Blank (1012508-BLK1)**

Prepared: 01/25/11 Analyzed: 01/26/11

Benzene	ND	1.0	ug/l							
Toluene	ND	1.0	"							
Ethylbenzene	ND	1.0	"							
Xylenes (total)	ND	1.0	"							
Surrogate: 1,2-Dichloroethane-d4	14.4		"	13.3	108	57.9-139				
Surrogate: Toluene-d8	12.6		"	13.3	94.4	83.1-115				
Surrogate: 4-Bromofluorobenzene	13.0		"	13.3	97.3	80.8-120				

**LCS (1012508-BS1)**

Prepared: 01/25/11 Analyzed: 01/26/11

Benzene	35.1	1.0	ug/l	33.3	105	60.1-131		10.9		
Toluene	35.3	1.0	"	33.3	106	65.9-127		11.3		
Ethylbenzene	33.7	1.0	"	33.3	101	65.1-129		20		
m,p-Xylene	62.1	2.0	"	66.7	93.1	66.8-127		20		
o-Xylene	35.9	1.0	"	33.3	108	61.2-120		20		
Surrogate: 1,2-Dichloroethane-d4	14.8		"	13.3	111	57.9-139				
Surrogate: Toluene-d8	12.8		"	13.3	95.9	83.1-115				
Surrogate: 4-Bromofluorobenzene	12.9		"	13.3	96.8	80.8-120				

**LCS Dup (1012508-BSD1)**

Prepared: 01/25/11 Analyzed: 01/26/11

Benzene	33.2	1.0	ug/l	33.3	99.8	60.1-131	5.50	10.9		
Toluene	33.0	1.0	"	33.3	98.9	65.9-127	6.86	11.3		
Ethylbenzene	31.2	1.0	"	33.3	93.7	65.1-129	7.70	20		
m,p-Xylene	57.1	2.0	"	66.7	85.6	66.8-127	8.43	20		
o-Xylene	32.6	1.0	"	33.3	97.7	61.2-120	9.70	20		
Surrogate: 1,2-Dichloroethane-d4	12.9		"	13.3	96.9	57.9-139				
Surrogate: Toluene-d8	12.9		"	13.3	96.8	83.1-115				
Surrogate: 4-Bromofluorobenzene	12.7		"	13.3	95.0	80.8-120				

Summit Scientific

The results in this report apply to the samples analyzed in accordance with the chain of custody document. This analytical report must be reproduced in its entirety.



LT Environmental, Inc.  
4600 West 60th Avenue  
Arvada CO, 80003

Project: PDC - Jason1,2,34-31

Project Number: 0188-11014.05  
Project Manager: Brian Dodek

**Reported:**  
01/27/11 08:31

**Volatile Organic Compounds by EPA Method 8260B - Quality Control**  
**Summit Scientific**

Analyte	Reporting			Spike	Source		%REC		RPD		Notes
	Result	Limit	Units	Level	Result	%REC	Limits	RPD	Limit		

**Batch 1012508 - EPA 5030 Water MS**

<b>Matrix Spike (1012508-MS1)</b>	<b>Source: R101117-01</b>			Prepared: 01/25/11		Analyzed: 01/26/11					
Benzene	38.3	1.0	ug/l	33.3	6.49	95.4	52.7-130			19.3	
Toluene	24.1	1.0	"	33.3	ND	72.3	57-127			18.7	
Ethylbenzene	28.7	1.0	"	33.3	ND	86.2	59.2-127			20	
m,p-Xylene	50.3	2.0	"	66.7	1.32	73.5	53.2-132			20	
o-Xylene	19.3	1.0	"	33.3	ND	58.0	56.3-117			20	
<i>Surrogate: 1,2-Dichloroethane-d4</i>	<i>14.7</i>		<i>"</i>	<i>13.3</i>		<i>110</i>	<i>57.9-139</i>				
<i>Surrogate: Toluene-d8</i>	<i>11.3</i>		<i>"</i>	<i>13.3</i>		<i>84.9</i>	<i>83.1-115</i>				
<i>Surrogate: 4-Bromofluorobenzene</i>	<i>7.57</i>		<i>"</i>	<i>13.3</i>		<i>56.8</i>	<i>80.8-120</i>				

<b>Matrix Spike Dup (1012508-MSD1)</b>	<b>Source: R101117-01</b>			Prepared: 01/25/11		Analyzed: 01/26/11					
Benzene	24.1	1.0	ug/l	33.3	6.49	52.7	52.7-130	45.6		19.3	
Toluene	21.1	1.0	"	33.3	ND	63.2	57-127	13.4		18.7	
Ethylbenzene	28.6	1.0	"	33.3	ND	86.0	59.2-127	0.244		20	
m,p-Xylene	57.9	2.0	"	66.7	1.32	84.8	53.2-132	14.0		20	
o-Xylene	42.1	1.0	"	33.3	ND	126	56.3-117	74.2		20	
<i>Surrogate: 1,2-Dichloroethane-d4</i>	<i>12.6</i>		<i>"</i>	<i>13.3</i>		<i>94.3</i>	<i>57.9-139</i>				
<i>Surrogate: Toluene-d8</i>	<i>9.34</i>		<i>"</i>	<i>13.3</i>		<i>70.1</i>	<i>83.1-115</i>				
<i>Surrogate: 4-Bromofluorobenzene</i>	<i>14.9</i>		<i>"</i>	<i>13.3</i>		<i>112</i>	<i>80.8-120</i>				

Summit Scientific

*The results in this report apply to the samples analyzed in accordance with the chain of custody document. This analytical report must be reproduced in its entirety.*



LT Environmental, Inc.  
4600 West 60th Avenue  
Arvada CO, 80003

Project: PDC - Jason1,2,34-31

Project Number: 0188-11014.05  
Project Manager: Brian Dodek

**Reported:**  
01/27/11 08:31

### Notes and Definitions

DET Analyte DETECTED  
ND Analyte NOT DETECTED at or above the reporting limit  
NR Not Reported  
dry Sample results reported on a dry weight basis  
RPD Relative Percent Difference

---

Summit Scientific

*The results in this report apply to the samples analyzed in accordance with the chain of custody document. This analytical report must be reproduced in its entirety.*